

Quicksilver™ Corner Bead

Hot-dipped Metal Corner Bead

Installation:

Metal corner beads can be installed using a variety of methods. You may choose to do a combination of all three. For regular metal corner bead, the drywall does not need to be set back.



Method 1: Staples

1. Measure the wall height and subtract 1/2". Measure and cut the corner bead using aviator snips. Dry fit to ensure accuracy.
2. Position the bead on the corner and staple each mud flange every 6" to 10" with 1/2" staples.
3. Using an 8" taping knife, apply the first coat of joint compound to the surface of the corner bead. The use of lightweight or setting-type compound in this step will reduce shrinkage and speed up drying time. Let this dry completely, for several hours or overnight.
4. Using an 8" or 10" taping knife, apply a light finish coat of joint compound. Feather the compound beyond the previous coat. The use of all-purpose or topping compound will make for a more durable finish. Let this dry completely, for several hours or overnight.
5. Sand lightly with 120 grit sandpaper.

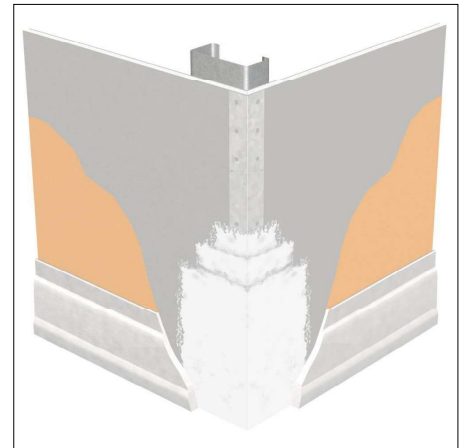

Method 2: Screws or Nails

1. Measure the wall height and subtract 1/2". Measure and cut the corner bead using aviator snips. Dry fit to ensure accuracy.
2. Position the bead on corner and fasten the bead with screws or nails using the smaller nail holes on each mud flange.
3. Using an 8" taping knife, apply the first coat of joint compound to the surface of the corner bead. The use of lightweight or setting-type compound in this step will reduce shrinkage and speed up drying time. Let this dry completely, for several hours or overnight.
4. Using an 8" or 10" taping knife, apply a light finish coat of joint compound. Feather the compound beyond the previous coat. The use of all-purpose or topping compound will make for a more durable finish. Let this dry completely, for several hours or overnight.
5. Sand lightly with 120 grit sandpaper.

Method 3: Clinch-On Tool

1. Measure the wall height and subtract 1/2". Measure and cut the corner bead using aviator snips. Dry fit to ensure accuracy.
2. Position the bead on the corner. Place the clinch-on tool over the bead.
3. Hit the tool with a rubber mallet to crimp the bead to the corner, repeating every 8" to 10" for optimum fastening.
4. Using an 8" taping knife, apply the first coat of joint compound to the surface of the corner bead. The use of lightweight or setting-type compound in this step will reduce shrinkage and speed up drying time. Let this dry completely, for several hours or overnight.
5. Using an 8" or 10" taping knife, apply a light finish coat of joint compound. Feather the compound beyond the previous coat. The use of all-purpose or topping compound will make for a more durable finish. Let this dry completely, for several hours or overnight.
6. Sand lightly with 120 grit sandpaper.