

SHOWER DOOR

SLIDING ASHMORE STYLE WITH 8 MM GLASS 48" SHOWER TRACK

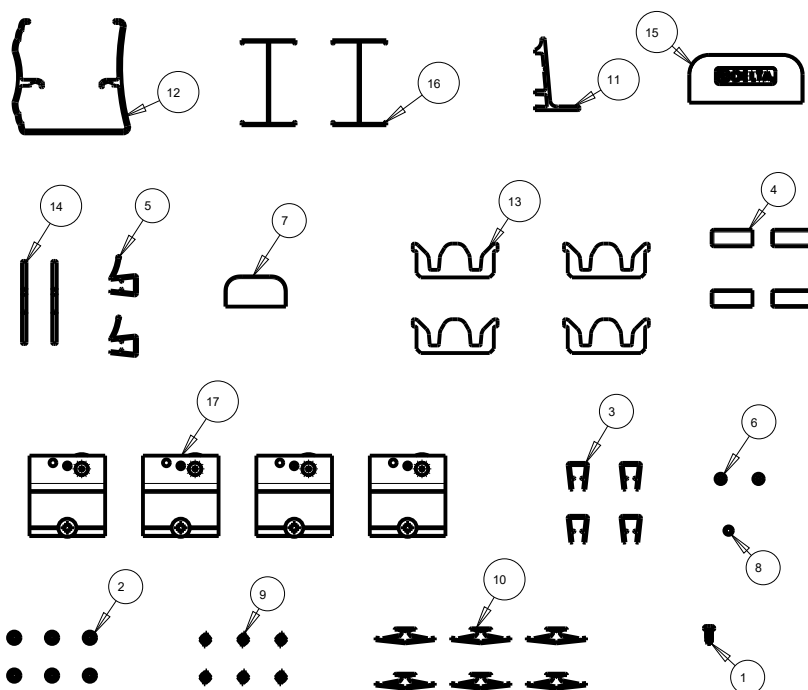
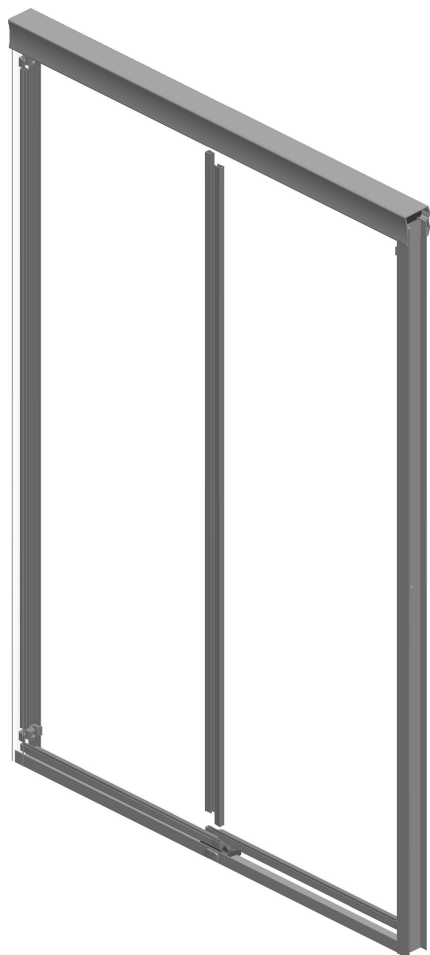

ID	DESCRIPTION	QTY	MATERIAL
1	#6 x 3/8 TYPE BT SS	1	SS
2	#8-18 X 1.5" LONG PHILLIPS HEAD	6	SS
3	8MM SIDE SEAL	4	PVC
4	8MM CORNER GLAZING	4	PVC
5	8MM WATER 48" RETENTION BOTTOM GLAZING EXTR	2	PVC
6	M3.5X0.8 PHILIPS TRUSS HEAD SCREW	2	SS
7	MOD CENTER GUIDE OVER	1	NYLON
8	MOD NYLON O RING	1	NYLON
9	SCREW ANCHOR	6	PVC
10	TOGGLE WALL ANCHOR	6	POLYPROPYLENE
11	TRAD 48" 8MM BOTTOM TRACK	1	PVC
12	TRAD 48" 8MM TOP TRACK	1	AL6463
13	TRAD 8MM GRAB BUMPER	4	PVC
14	TRAD 8MM T-STRAP HOLD DOWN	2	NYLON
15	TRADITIONAL 8MM CENTER GUIDE	1	NYLON
16	TRADITIONAL 8MM WALL JAMB	2	AL6463
17	TROLLEY ASSEMBLY	4	ASSEMBLY

MATERIALS: Anodized Aluminum Extrusions (Track) and Zinc Die Cast (Mounting Brackets).
"Oil Rubbed Bronze and Matte Black" are Powder Coated.

INSTALLATION: Detailed Instructions, Templates and Hardware Included for Easy Installation.

UNIQUE FEATURES: Constructed of Corrosion Resistant Anodized Aluminum.
48" Track Assembly Kit.
Fits 48" Shower Doors with an Opening min/max of 44" - 48" (111.8cm-121.9cm),
with a Height of 74-3/8" (188.9cm).

NOTE: Height of 77" (195.6cm) Required for Installation.

WARRANTY: 5 Year Limited Warranty.



see what Delta can do

SHOWER DOOR

5/16" (8mm) SLIDING SHOWER
48" GLASS PANELS

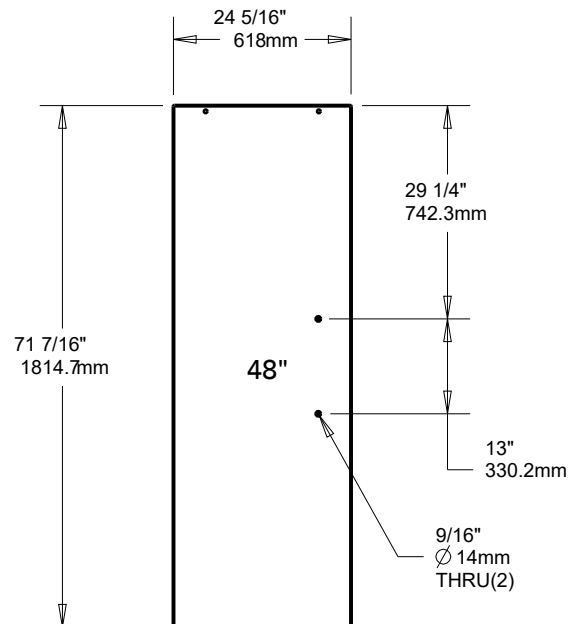

MATERIALS: 5/16" (8mm) Tempered Glass Panels.

UNIQUE FEATURES: Spot Guard Easy Clean Coating on Both Sides.

WARRANTY: 5 Year Limited Warranty.



see what Delta can do

SHOWER DOOR

VERTICAL LYNDALL™ HANDLE

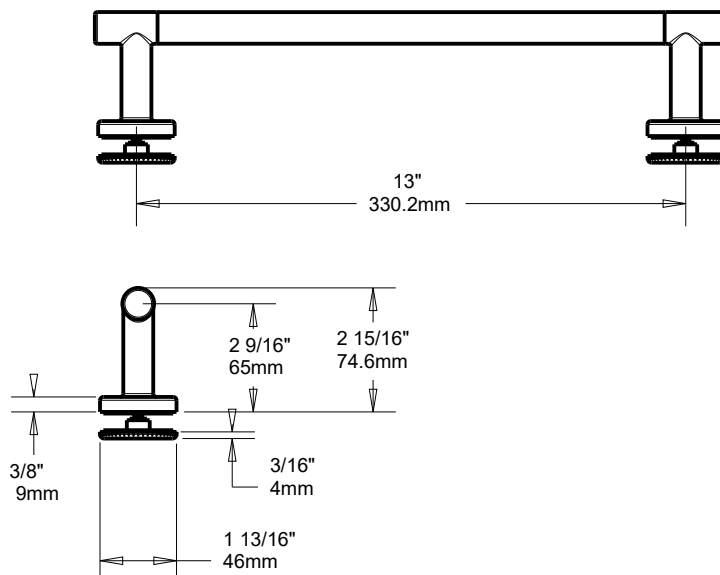

MATERIALS: Zinc Posts for All, Stainless Steel Bars for Polished Chrome, Aluminum Bars for Brushed Nickel, Oil Rubbed Bronze and Matte Black.

UNIQUE FEATURES: Coordinates with Delta® Faucets and Bath Hardware.

WARRANTY: 5 Year Limited Warranty.



see what Delta can do