

INSTALLATION | SHADOW RAIL CONNECTOR™ Stair

IMPORTANT

UPPER (A) and LOWER (B) Shadow Rail Connector™ Stair assemblies look similar but are in fact **UNIQUE**. Each Stair assembly contains a **MALE** and **FEMALE** part specifically for UPPER and LOWER ends of the RAIL. Familiarize yourself with the corresponding Stair assembly and the end of the RAIL it was designed for.

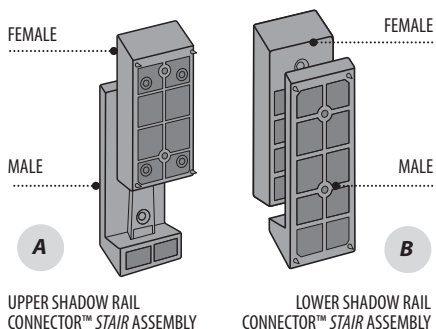

1 START

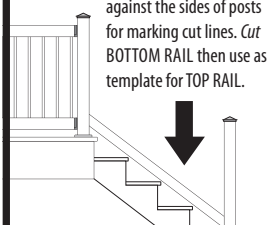

2

Cut 1-1/2" from ONE SIDE ONLY of BOTTOM & TOP RAILS, to allow installation space for BOTH Stair connector assemblies.

3

Screw the FEMALE connectors of UPPER (A) and LOWER (B) Stair assemblies to the ends of the RAIL.

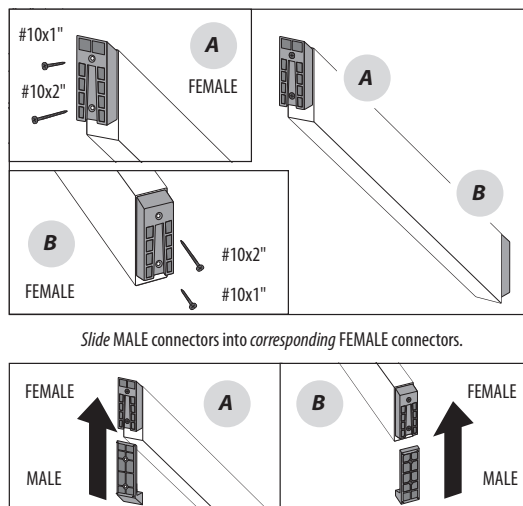

4

Dry fit the BOTTOM RAIL with Stair connector assemblies in place (Step 3) between posts.

Move posts apart slightly and then press back together.



The MALE GRIPPING CONES will make impression marks into posts for relocating the MALE connectors.

5

Remove the BOTTOM RAIL and slide apart MALE connectors. Relocate and screw MALE connectors to posts.

Impression marks from gripping cones will help. Verify the corresponding UPPER (A) and LOWER (B) MALE connectors.

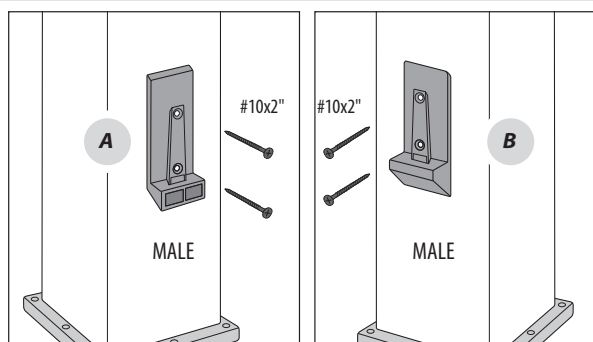

6

Install a baluster on each side of BOTTOM RAIL. Dry fit TOP RAIL with Stair connector assemblies in place.

Press TOP RAIL against posts to leave impression marks.

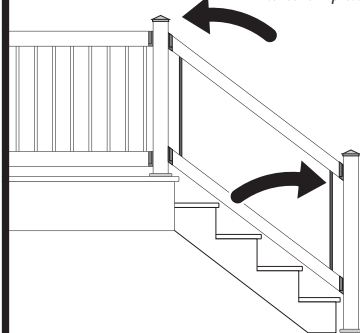

7

Remove the TOP RAIL. Install balusters. Relocate and screw MALE connectors to posts.

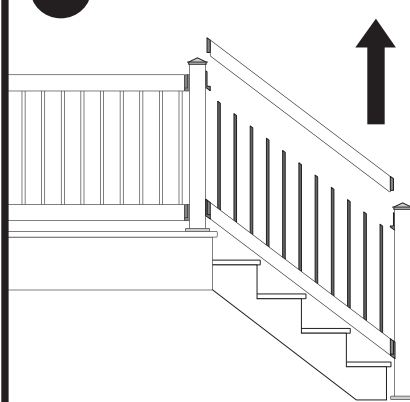

8

Slide the TOP RAIL into alignment with MALE connectors and balusters.

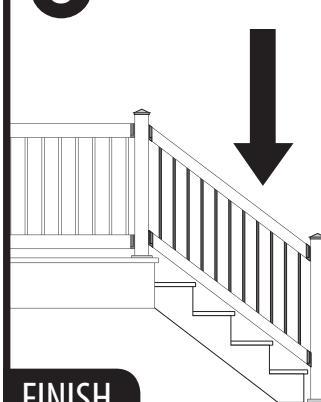

FINISH

TOLL FREE 1-866-577-8868

titanbuildingproducts.com

TITAN®
THE ART OF BUILDING

