

Includes: 4 Screws 4 Expanded Plugs

Fitting instructions

1. Inside the key safe are 5 holes for installation (5 hole diameter=6mm)
2. Place the key safe in the desired position and mark with a pencil
3. Using a suitable drill bit, drill holes into the marked positions
4. Place plastic expanded plugs [for masonry] into the holes that have just been drilled
5. Move the key safe into position and screw to fix

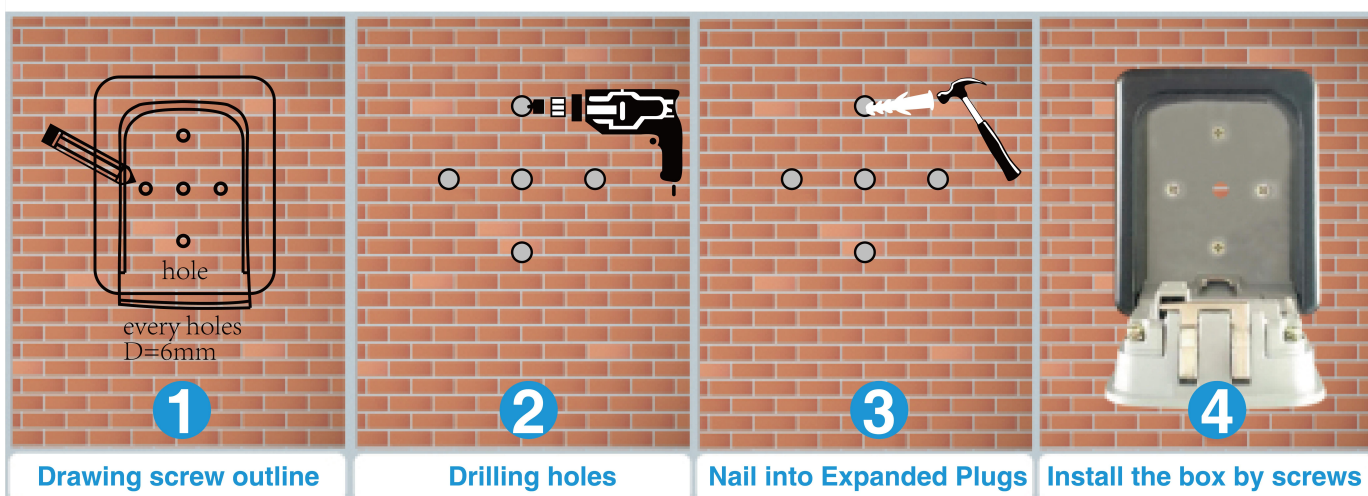

Installed on the wall