

SHOKZ

OPENRUN PRO 2

BONE CONDUCTION SPORTS HEADPHONES 

Redefining the Sound of Sports



Groundbreaking Audio Improvement

Dual Drivers, Doubled Performance

Meet OpenRun Pro 2, the all-new flagship headphone from Shokz that rewrites the rules of open-ear audio, superpowered by Shokz DualPitch. This innovative technology combines bone conduction for precise mids and highs with a dedicated air conduction speaker for controlled, deep bass. The result is an unparalleled listening experience that's as clear as it is powerful.



Bone Conduction Driver for Clear Highs

High Sensitivity & Rigidity Driver

All-metal, ultra-thin bone-conduction driver delivers clearer highs and full, natural mids.

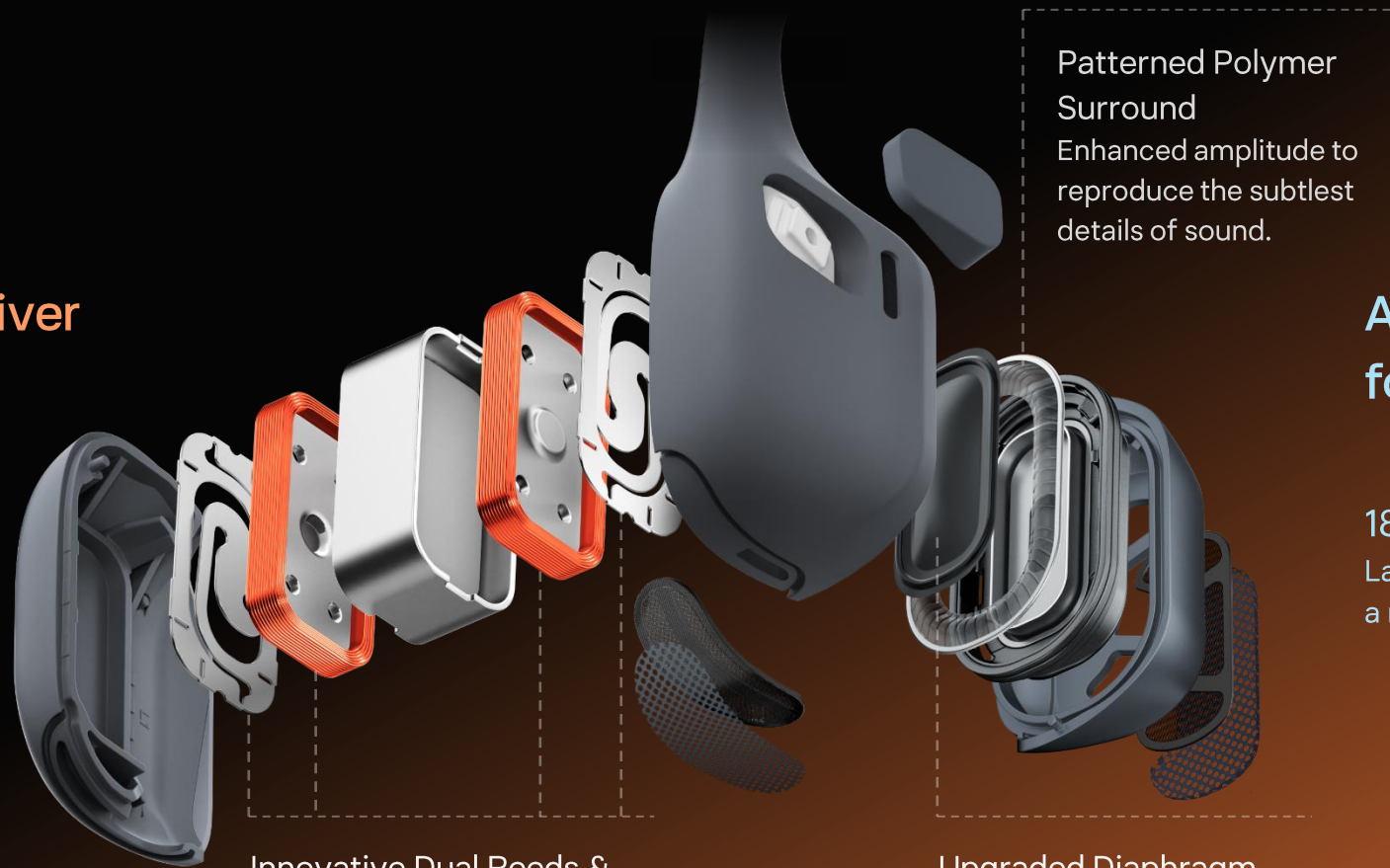

**Innovative Dual Reeds &
Coils Design**
A more stable vibration system
for a purer vocal sound.

**Patterned Polymer
Surround**
Enhanced amplitude to
reproduce the subtlest
details of sound.

Air Conduction Driver for Surging bass

18x11mm Powerful Unit
Larger low-frequency speaker for
a more booming, deep bass.

Upgraded Diaphragm
The strengthened, featherlight,
dome-shaped diaphragm attains
greater amplitude without
compromising audio balance.

3D Audio Perfection

Forget flat audio and muddled frequencies. OpenRun Pro 2's custom algorithm assigns each sound element to a dedicated driver, crafting a balanced, dynamic, and immersive 3D soundscape. And to ensure every note rings true, DRC technology silences distortion even at peak volume.



Signature Shokz Open-Ear ^[1]

Music On, Still Connected

Featuring Shokz's signature open-ear design, OpenRun Pro 2 keeps you immersed in your workout while staying grounded in your surroundings. Traffic, fellow joggers, that epic bird call – every essential sound finds its way in, ensuring your safety and enriching your listening experience. OpenRun Pro 2 intelligently optimizes volume range, making your audio clearer even if you are out and about.



Eliud Kipchoge

Eliud Kipchoge

Shokz Global Ambassador

Leak-Free Audio

Shokz OpenRun Pro 2's bone conduction unit adopts an integrated design with components encased in one protective metal compartment and an acoustic sound leakage EQ adjustment algorithm to effectively control sound leakage, while DirectPitch technology minimizes air conduction unit leakage for enhanced privacy. Along with the drivers' decoupled design to ensure independent functionality, your audio remains for your ears only.



Secure Beats, Untamed Spirit

Engineered for the extremes, OpenRun Pro 2's ergonomic ear hooks and unibody frame provide a secure, comfortable fit that defies slips and adjustments. Experience unshakeable stability thanks to the weight-optimized design, while integrated Ni-Ti alloy memory wire delivers a clamping force that's secure without being uncomfortable – even during intense activities.



Cloud-Comfort Fit

Maximize the Comfort:

Shokz open-ear design is known for keeping your ears clean, and together with our latest technology DualPitch substantially reducing vibrations, the headphones are now even more comfortable to wear for extended periods so you can train with peace of mind.

Minimize the Squeeze

16% Reduction in Clamping Force

Enjoy total comfort with our OpenRun Pro 2. Engineered with a precisely adjusted 4° core contact area and a 16%^[2] reduction in clamping force, they gently hug your ears for a feather-light fit. Thanks to an expanded contact area that distributes pressure evenly and a streamlined band, your OpenRun Pro 2 ensures comfort that lasts as long as your playlist.

Optimize the weight

Crafted with ultra-lightweight, high-strength material with a soft silicone finish, OpenRun Pro 2 delivers a cloud-like fit so comfortable, you'll forget you're even wearing headphones.





IP55 Water Resistant ^[3]

Rain, sweat, splashes – bring it on. An IP55 water-resistant design, including a double-layer mesh structure and nano-hydrophobic coating, ensures durability against the elements.



Crystal Clear Voice, Minimal Noise

Enjoy crystal-clear communication with a cutting-edge AI noise reduction algorithm that filters out 96.5%^[4] of the chaos. Strategically positioned dual microphones capture even the subtlest inflections, ensuring your every word rings true, from bustling streets to noisy cafés.



Wind at Your Back, Voice at the Forefront

Taking calls in windy conditions? With a meticulously engineered wind-resistant microphone placed in the optimal low-wind zone, and dual-balanced sound vents with winding sound channels, OpenRun Pro 2 ensures crystal-clear communication even at speeds up to 25 km/h^[5].

Power Beyond Limits

The larger battery, coupled with dual smart drivers assigned specific roles, improves battery life while also reducing power consumption.

Enjoy up to
12 hours ^[6]
of music playback with one
full charge.

A Quick **5-minute**
charge ^[7] provides **2.5**
hours of playtime



Shokz App

Install the Shokz App for more OpenRun Pro 2 functions and customization options.



MultiPoint Pairing to seamlessly switch from 2 devices without pairing hassle.



4 preset EQs to choose
2 custom modes to tailor your experience.

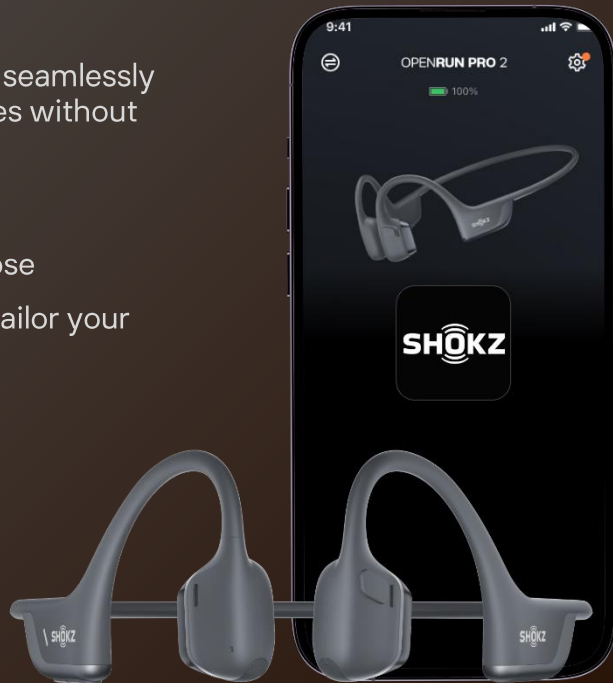

Pair. Play. Run. It's That Easy.



OpenRun Pro 2 pairs instantly just by turning it on. Plus, with a 10-meter Bluetooth 5.3 range, you can roam freely without worrying about dropouts. Stay in the zone, not tangled in wires.

Two Sizes for a Seamless Fit

Choose your perfect fit, standard or mini, for worry-free listening.





Part number	Standard: SHOKZ S820 Mini: SHOKZ S821
Speaker type	Air conduction speaker Bone conduction speaker
Frequency response	20Hz - 20kHz
Speaker sensitivity	Air conduction speaker: 96dB ± 2.5dB Bone conduction speaker: 101.3dB ± 3dB
Microphone sensitivity	-38 dB ± 1dB
Bluetooth® version	Bluetooth® V5.3
Compatible profiles	A2DP, AVRCP, HFP

Materials	Headphones: full titanium, silicone, plastic, nickel-titanium alloy
Charge voltage	5V ± 5%
Frequency band	2400 - 2483.5MHz
Battery	Li-Polymer battery
Continuous play	Up to 12 hours of listening time with a single charge ^[8]
Standby time	Up to 10days
Charging time	60 minutes ^[9]
Quick charge	A 5-minute charge gives 2.5 hours of battery life (for music) ^[10]
Weight	Standard: 30.3 ± 0.5g Mini: 30 ± 0.3g ^[11]
Warranty	2 years
Sweat resistance	IP55
Battery capacity	150mAh/0.581Wh
Audio codecs supported	SBC
Wireless range	33ft (10m)



SHOKZ



1. Always wear OpenRun Pro 2 securely and adjust the volume to maintain awareness of your surroundings during outdoor activities. Using headphones while cycling or driving can significantly impair your ability to hear traffic, potentially leading to accidents. It may also violate local laws and regulations. Please ensure you comply with all local traffic laws and regulations when using this product.
2. Shokz OpenRun Pro 2 delivers a 16% reduction in clamping force compared to the previous generation, based on internal testing conducted by Shokz Lab and supported by mechanical formula calculations.
3. OpenRun Pro 2 is designed to resist sweat and water splashes, making it suitable for most workouts and activities except water sports. Internal testing confirms it meets the IP55 rating under the IEC 60529 standard for dust and water resistance. Note that sweat and water resistance can degrade over time with normal wear and tear. To avoid damage, do not charge the OpenRun Pro 2 when wet, and avoid using it while swimming or showering.
4. Shokz OpenRun Pro 2 features AI noise cancellation technology designed to reduce environmental noise while preserving human voices. Internal simulations conducted by Shokz Lab suggest that this technology can achieve a signal-to-noise ratio improvement of approximately 29 dB, corresponding to a potential 96.5% reduction in ambient noise, along with effective reduction of loud echoes. Note that actual performance may vary depending on environmental conditions.
5. Internal testing conducted by Shokz Lab in controlled outdoor conditions simulated a cyclist riding at 25 km/h on a flat, quiet road. The results suggest that the OpenRun Pro 2 can effectively reduce wind noise, potentially improving call quality. However, real-world conditions may vary, and wind noise reduction may be less effective in different environments.

6. The data referenced in this product information is based on internal testing conducted by Shokz Lab in a controlled environment with a temperature of $25^{\circ}\text{C} \pm 2^{\circ}\text{C}$. During testing, WAV-encoded audio was played at 75% volume with all other features set to default.
7. Quick Charge data is based on internal testing conducted by Shokz Lab in a controlled environment with a temperature of $25^{\circ}\text{C} \pm 2^{\circ}\text{C}$. Under these conditions, a 5-minute charge can provide approximately 150 minutes of playback time for SBC mode audio at 75% volume. However, real-world battery life may vary depending on factors such as volume level, audio source, environmental interference, enabled features, usage habits, and others.
8. This music endurance data was collected at the Shokz Laboratory in a temperature-controlled environment of $25 \pm 2^{\circ}\text{C}$, playing SBC-encoded audio at a 75% volume with all other features set to default. Actual battery life depends on the volume, sound source, degree of environmental interference, product features, usage habits, and other factors.
9. This data was collected from Shokz Laboratory in a temperature-controlled environment of $25 \pm 2^{\circ}\text{C}$. Actual battery life depends on the volume, sound source, degree of environmental interference, product features, usage habits, and other factors.
10. The quick charge data was collected at the Shokz Laboratory in a temperature-controlled environment of $25 \pm 2^{\circ}\text{C}$. By default, if you charge the headphones for 5 minutes, you can play SBC mode audio at 75% volume for 150 minutes. Actual battery life after charging is affected by volume, audio source, degree of environmental interference, product features, and usage habits.
11. Due to product configuration and manufacturing processes, the actual weight of the product may vary.