

PORTER CABLE®

FOLDING MITER SAW STAND

**SUPPORT PLIABLE DE SCIE À
ONGLET**

**PEDESTAL DE SIERRA DE INGLETE
PLEGADIZO**

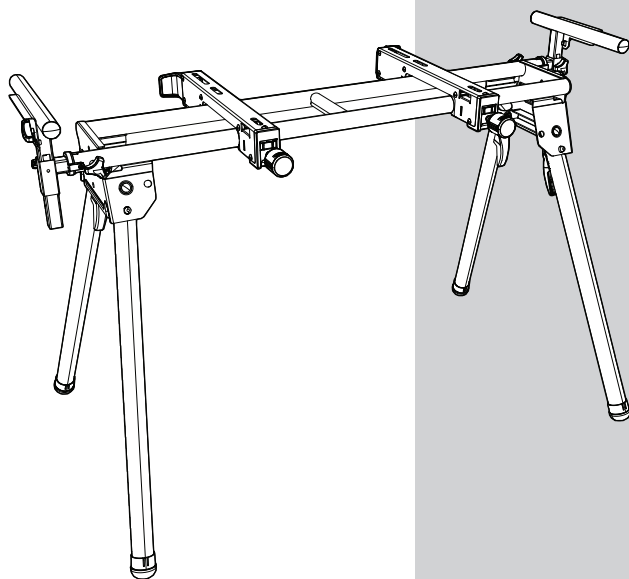

Instruction Manual

Manuel d'instructions

Manual de instrucciones

www.portercable.com

INSTRUCTIVO DE OPERACIÓN,
CENTROS DE SERVICIO Y PÓLIZA
DE GARANTÍA.

⚠ ADVERTENCIA: LÉASE ESTE
INSTRUCTIVO ANTES DE USAR EL
PRODUCTO.

**CATALOG NUMBER
PCXB900ST**

TABLE OF CONTENTS

SECTION	PAGE
PRODUCT SPECIFICATIONS.....	2
SAFETY GUIDELINES - DEFINITIONS	3
GENERAL SAFETY	4
MITER SAW STAND SAFETY	5
CARTON CONTENTS	8
TOOLS NEEDED FOR ASSEMBLY	8
UNPACKING YOUR STAND	8
KNOW YOUR STAND	9
ASSEMBLY AND ADJUSTMENTS	10
OPERATION	12
MAINTENANCE	15
PARTS LIST	16
WARRANTY	20

PRODUCT SPECIFICATIONS

Stand height (ground to saw mounting brackets)	34-3/14 in. (869 mm)
Stand bed size	44-7/8 in. x 8-1/2 in. (1,140 mm x 217 mm)
Size of the folded stand	52-3/4 in. (L) x 18-15/32 in. (W) x 10-5/8 in. (H) (1,340 mm x 470 mm x 270 mm)
Size of the extended stand	52-3/4 in. (L) x 31-21/32 in. (W) x 36-25/32 in. (H) (1,340 mm x 805 mm x 935 mm)
Maximum weight load of stand	400 lbs (181 KGS) *Do not place heavier load on this stand.
Maximum length of the material to be cut	115-7/8 in. (2,945 mm) *Do not apply a longer material.
Net weight of stand	40 lbs (18.3 KGS)

SAFETY GUIDELINES - DEFINITIONS

WARNING ICONS

Your power tool and its Instruction Manual may contain “WARNING ICONS” (a picture symbol intended to alert you to and/or instruct you how to avoid a potentially hazardous condition). Understanding and heeding these symbols will help you operate your tool better and safer. Shown below are some of the symbols you may see.



SAFETY ALERT: Precautions that involve your safety.



PROHIBITION



WEAR EYE PROTECTION: Always wear safety goggles or safety glasses with side shields.



WEAR RESPIRATORY AND HEARING PROTECTION: Always wear respiratory and hearing protection.



READ AND UNDERSTAND INSTRUCTION MANUAL: To reduce the risk of injury, user and all bystanders must read and understand instruction manual before using this product.



KEEP HANDS AWAY FROM THE MOVING PART AND CUTTING SURFACE: Failure to keep your hands away from the moving part and cutting surface will result in serious personal injury.



SUPPORT AND CLAMP WORK



DANGER

DANGER: Indicates an imminently hazardous situation which, if not avoided, will result in death or serious injury.



WARNING

WARNING: Indicates a potentially hazardous situation which, if not avoided, could result in death or serious injury.



CAUTION

CAUTION: Indicates a potentially hazardous situation which, if not avoided, may result in minor or moderate injury.



NOTICE

NOTICE: Used without the safety alert symbol indicates potentially hazardous situation which, if not avoided, may result in property damage.



WARNING

Some dust created by power sanding, sawing, grinding, drilling and other construction activities contains chemicals known to the state of California to cause cancer, birth defects or other reproductive harm. Some examples of these chemicals are:

- Lead from lead-based paints,
- Crystalline silica from bricks and cement and other masonry products, and
- Arsenic and chromium from chemically-treated lumber.

Your risk from these exposures varies, depending on how often you do this type of work. To reduce your exposure to these chemicals: work in a well ventilated area, and work with approved safety equipment, such as those dust masks that are specially designed to filter out microscopic particles. Avoid prolonged contact with dust from power sanding, sawing, grinding, drilling, and other construction activities. Wear protective clothing and wash exposed areas with soap and water. Allowing dust to get into your mouth, eyes, or lay on the skin may promote absorption of harmful chemicals.



WARNING

Use of this tool can generate and/or disperse dust, which may cause serious and permanent respiratory or other injury. Always use NIOSH/OSHA approved respiratory protection appropriate for the dust exposure. Direct particles away from face and body.

GENERAL SAFETY

WARNING

GENERAL SAFETY INFORMATION

Read and understand all warnings and operating instructions before using any tool or equipment. When using tools or equipment, basic safety precautions should always be followed to reduce the risk of personal injury. Improper operation, maintenance or modification of tools or equipment could result in serious injury and property damage. There are certain applications for which tools and equipment are designed. Do not modify the stand in any manner, or use the stand for unintended purpose.

WARNING

- Failure to follow these rules may result in serious personal injury.
- To reduce the risk of injury, keep both hands on handle when raising and lowering the stand.
- Before folding the stand, the miter saw MUST be removed from the stand.
- Use only with Porter-Cable mounting brackets. Mounting brackets offered by other than Porter-Cable have not been tested with this stand and use of them could be hazardous.

Please read and understand this entire manual before attempting to assemble, operate or install the product. These safety instructions are not meant to cover every possible condition that could occur.

MITER SAW STAND SAFETY

GENERAL SAFETY INFORMATION

⚠ WARNING

Read and understand all warnings and operating instructions before using any tool or equipment. When using tools or equipment, basic safety precautions should always be followed to reduce the risk of personal injury. Improper operation, maintenance or modification of tools or equipment could result in serious injury and property damage. There are certain applications for which tools and equipment are designed. It is strongly recommended that this product NOT be modified and/ or used for any application other than for which it was designed.

⚠ WARNING

- Failure to follow these rules may result in serious personal injury.
- To reduce the risk of injury, keep both hands on handle when raising and lowering the stand.

Please read and understand this entire manual before attempting to assemble, operate or install the product. These safety instructions are not meant to cover every possible condition that could occur.

1. This product was designed to be used as a stand for miter saws. The stand will support up to 400 lbs. (181 kg). Any misuse or abuse can result in product damage or personal injury.
2. Do not stand on the work table. It is unsafe to climb, sit or stand on the stand. Do not use the extension support arms as a ladder or scaffolding.
3. Properly secure the miter saw, scroll saw, planer, benchtop sander or grinder to the stand before operation. Follow the mounting instructions carefully. Fasten the tool to the saw mounting rails securely as instructed.
4. Take care during the raising and lowering of the stand to reduce the hazard of pinching hands and fingers.

5. Check the legs and other supports to see that they are properly locked in place before operation.
6. Do not modify or use the stand for any operation for which it is not intended.
7. When hauling the stand in a vehicle, securely tie it down to prevent movement and possible damage.
8. ALWAYS use eye protection. All users and bystanders must wear eye protection that conforms to ANSI Z87.1.
9. ALWAYS use safety glasses. Everyday eyeglasses are NOT safety glasses. Also use face or dust mask if cutting operation is dusty. ALWAYS WEAR CERTIFIED SAFETY EQUIPMENT:
 - ANSI Z87.1 eye protection (CAN/CSA Z94.3).
 - ANSI S12.6 (S3.19) hearing protection.
 - NIOSH/OSHA/MSHA respiratory protection.

SAFETY INSTRUCTIONS FOR USING THE MITER SAW STAND

1. Keep children away. All visitors should be kept at a safe distance from the work area.
2. Always keep work area clean. Cluttered areas and benches invite accidents.
3. Before you use the stand, make sure no parts of the stand are damaged or deformed.
4. Before you use the stand, make sure all the parts or components of the stand are properly installed.
5. Don't use in dangerous environment. Don't use the stand in damp or wet locations, or expose them to rain. Keep work area well lighted.

6. Always use the stand on a flat and level surface. Do not use it at an uneven or unstable surface. Also, do not use the stand on slippery surface. It will greatly reduce the stand loading capacity.
7. The stand is designed to be used as a stand for miter saws and has a capacity of up to 400 lbs (181kgs). The total weight of the miter saw and workpiece must not exceed the capacity of this stand. Any misuse or abuse can result in product damage or personal injury.
8. Do not sit or stand on the stand. Do not hang or put anything on it other than the miter saw on the stand.
9. Do not modify the stand in any manner, or do not use the stand for any purpose other than for mounting a miter saw.
10. The stand should be used only for miter saws with a blade diameter up to 12 in. (305 mm).
11. The miter saw should be firmly mounted with the stand as per the instruction manual.
12. Align the position and balance of the miter saw as per this instruction manual after mounting the miter saw on the stand.
13. Take care during the raising and lowering of the stand to reduce the hazard of pinching hands and fingers.
14. Disconnect the power plug from the receptacle when mounting or dismounting the miter saw from the stand.
15. Mount the miter saw on the stand with the help of two or more people for your safety.
16. When you mount the miter saw on the stand, hold the miter saw firmly by hands until the mounting bracket cam latches tightly secured to prevent the miter saw from falling down from the stand rails.
17. After mounting the miter saw on the stand, make sure the stand will not fall over or be unintentionally moved by vibration, wind, impact or other foreseeable external forces. If this cannot be fulfilled, then stability shall be obtained by special safety measures. For example, securely anchor to the stand to the ground or foundation.
18. Occasionally check that the stand and the miter saw, making sure the mounting of the miter saw is still tight. A loose stand is unstable and may shift while in use causing serious injury.
19. Before operating the mounted miter saw, read carefully the instruction manual for the miter saw.
20. Before operating the miter saw, confirm that the locking knobs on both mounting brackets are firmly fastened so that the miter saw is securely mounted on the stand.
21. To prevent the miter saw from falling over from the stand, neatly layout the power cable on the ground to prevent operator or by standers from getting caught up by the cable.
22. Wear proper apparel. Do not wear loose clothing, gloves, neckties, rings, bracelets, or other jewelry which may get caught in moving parts. Nonslip footwear is recommended. Wear protective hair covering to contain long hair.
23. Always wear eye protection with side shields that meets the requirements of ANSI Z87.1 when working with the miter saw to prevent eye injury. Ordinary eyeglasses do not provide adequate protection because they do not contain impact resistant safety glass. Also, use a face mask for additional safety and wear a dust mask if the cutting operation produces dust.
24. Don't overreach. Keep proper footing and balance at all times.

25. When cutting a long piece of wood, be careful about the material supporting position because the cut material may lose its balance and fall down from the stand. Also, if workpiece is placed beyond the work support, the leg on the other side of the stand may be suddenly lifted up due to unbalance of weight. To prevent such occurrence, firmly hold the opposite side and use extra support before starting cutting operation.
26. To detach the miter saw from the stand, confirm the cutting head is pulled forward and locked in the down position, then unlock the mounting bracket locking knobs while holding the miter saw firmly by hands to prevent the miter saw from falling down from the stand rails. Remove the miter saw with the mounting brackets carefully with the help of two or more people.
27. When transporting the stand in a vehicle, securely tie it down to prevent movement and possible damage.
28. To reduce the risk of injury, periodically check that all fasteners are attached and adjusted according to the assembly instructions included in this manual.
29. When service the stand, use only identical Porter-Cable replacement parts. Repairs should be conducted only by a Porter-Cable authorized service center.

CARTON CONTENTS

UNPACKING YOUR STAND

This product requires assembly.

1. Remove the stand and all parts from the carton.
2. Place the stand on the ground.
3. Separate all parts from the packing material. Check each one with the list and illustration below to make certain all items are accounted for before discarding any packing material.

⚠ WARNING

If any part is missing or damaged, do not attempt to assemble the stand until the missing or damaged part is correctly replaced.

TABLE OF LOOSE PARTS

<u>ITEM</u>	<u>DESCRIPTION</u>	<u>QUANTITY</u>
A	Stand	1
B	Miter saw mounting bracket	2
C	Extension support arm + stop plate assembly	2 set
D	Mounting bracket hardware bag	1

TOOLS NEEDED FOR ASSEMBLY

Not Supplied



Adjustable wrench



5 mm hex wrench

UNPACKING YOUR STAND

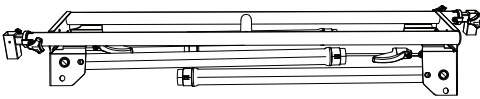

A

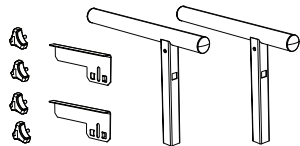

C

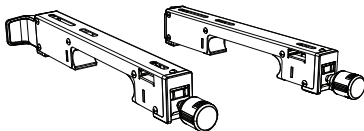

Left

Right

B

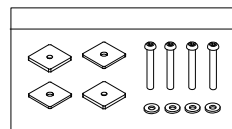

D

KNOW YOUR STAND

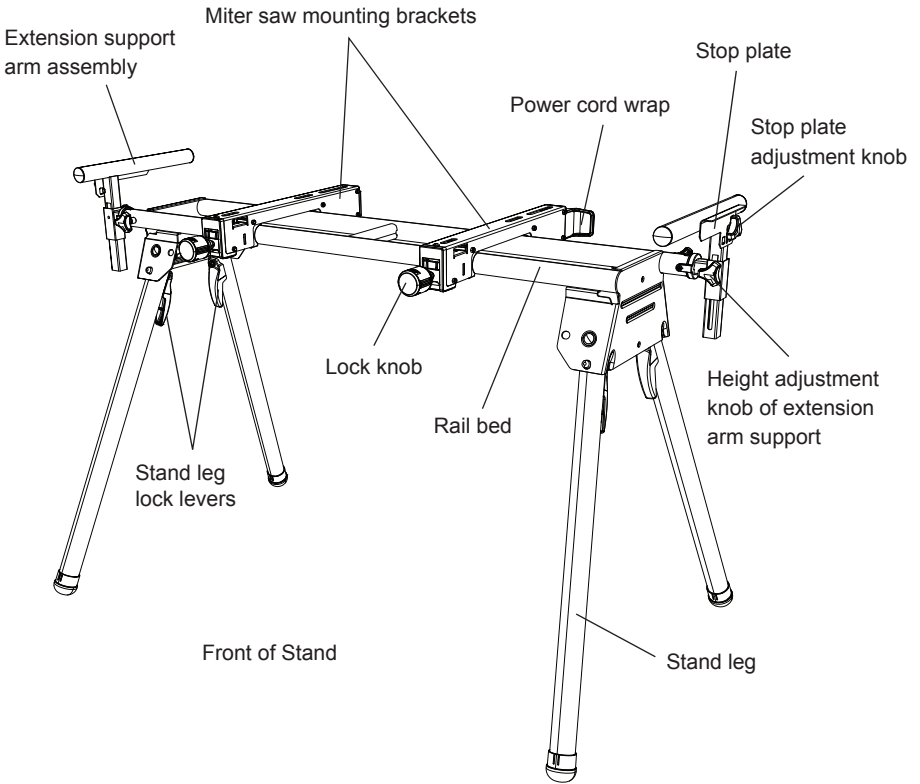

ASSEMBLY AND ADJUSTMENTS

Estimated Assembly Time: 5 - 10 Minutes.

ASSEMBLY INSTRUCTIONS

⚠ WARNING

For your own safety, never connect miter saw plug to any power source outlet until all assembly and adjustment steps are completed, and you have read and understood the safety and operating instructions.

INSTALLING THE EXTENSION SUPPORT ARM ASSEMBLY (FIG. A)

1. Insert one extension arm support (1) into the extension support arm (2), and secure with the height adjustment knob (3).
2. Repeat the above step for the other extension arm support.

NOTE: The longer end of the extension arm support should point to the front of the stand.

Fig. A

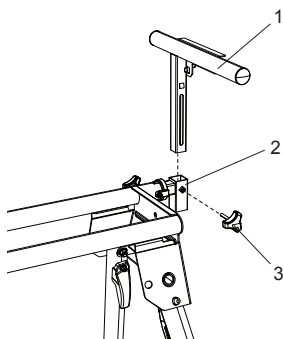

INSTALLING THE STOP PLATE (FIG. B)

1. Attach one stop plate (1) on one extension support arm (2).
2. Insert the lock knob (3) through the slot (4) on the stop plate and the threaded hole (5) on the extension support arm.
3. Tighten the lock knob (3) by turning it clockwise.
4. Repeat steps 1~3 for installing the other side stop plate.

Fig. B

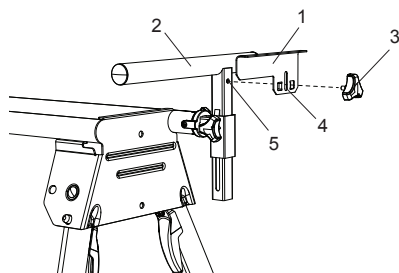

INSTALLING THE MITER SAW MOUNTING BRACKETS (FIG. C)

1. Turn the lock knob (1) counterclockwise to lose the tension of mounting brackets (2).
2. Place the front holding clamp (3) on the front rail of the stand, and then lower the back end of the bracket over the back rail of the stand.

NOTE: Place the saw mounting brackets with the power cord wrap towards to the left on the left side; the power cord wrap towards to right on the right side.

3. Slide the saw mounting bracket to the desired position, and then turn the lock knob (1) clockwise to lock.
4. Repeat the above steps for the other saw mounting bracket.

Fig. C

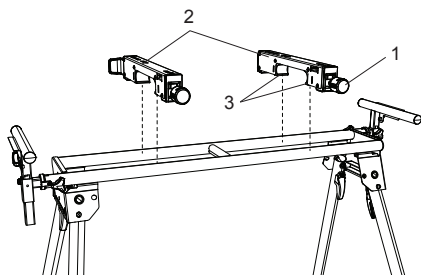

POWER CORD HOOKS (FIG. D)

Storage for the power cord is located on the ends of the saw mounting brackets (1). Wrap the power cord onto the hooks (2) when the saw is not in use. This can prevent damage to the power cord.

Fig. D

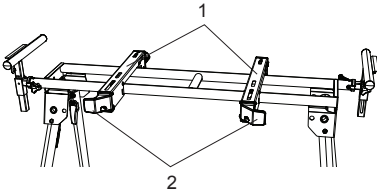

ADJUSTING THE MITER SAW MOUNTING BRACKETS (FIG. F)

If the miter saw mounting brackets can slide over the top rails or be removed from the top rails, the brackets need to be tightened by turning the lock knobs (1) clockwise. If the saw mounting brackets will not fit over the top rails, loosen the lock knob (1), adjust the bracket to proper position and tighten the lock knob (1).

Fig. F

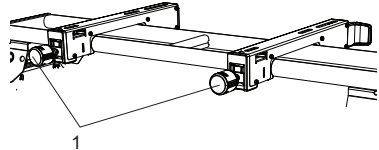

ADJUSTMENT INSTRUCTIONS

ADJUSTING THE EXTENSION SUPPORTS (FIG. E)

The extension support helps keep the workpiece level and stable during cutting operations.

1. Loosen the extension support lock knob (1) and slide the extension support to the desired length. Tighten the extension support lock knob (1).
2. Loosen the height adjustment knob (2) to adjust the extension support arm (3) to the desired height and then tighten the knob (2).
3. If repetitive cutting is required, loosen the plate adjustment knob (4) to adjust the work stop plate (5) to the desired height, and then tighten the knob (4).
4. Repeat for the other extension support.

Fig. E

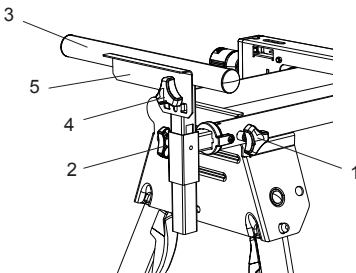

OPERATION

OPERATING INSTRUCTION

⚠ WARNING

Take care when setting up and folding the stand to reduce the hazard of pinching hands and fingers.

SETTING UP THE STAND (FIG. G, H)

1. Lift up the stand, and press the stand leg lock levers (1) to unfold the stand legs. The location pin should be locked into the lower slot (2).
2. Rest the opened legs onto the floor, and repeat step 1 to release the other side stand legs.

⚠ WARNING

To properly lock the stand legs, the lock lever **MUST** be secured in the slot on the stand legs.

Fig. G

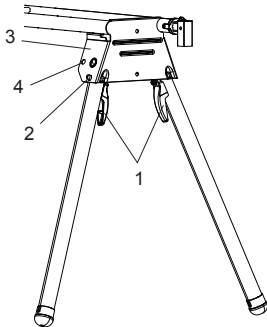

⚠ WARNING

- Do not mount the miter saw unless the stand top is set up securely.
- Ensure the stand is stable and level before operating the miter saw to prevent the injury. Set up the stand on a level area so that all four legs are touching the ground.

Fig. H

Setting up the stand

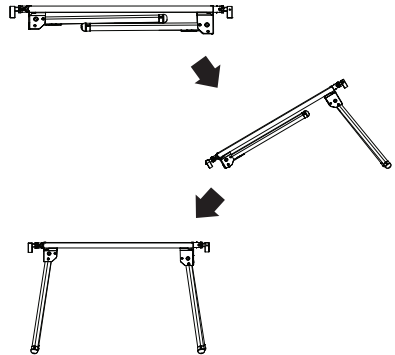

FOLDING THE STAND (FIG. G, I)

⚠ WARNING

Before folding the stand, remove the miter saw from the stand together with the mounting brackets with the help of two or more people.

1. First fold the side with shorter leg plate (3) by releasing the stand leg lock lever (2) into the higher slot (4).

NOTE: To avoid pinching fingers when folding the stand, please stand at the stand handle end of the stand.

2. Rest the folded side of the stand onto the floor, and repeat step 1 to fold the other side stand legs.

Fig. I

Folding the stand

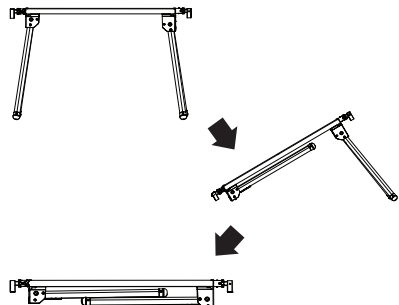

MOUNTING THE MITER SAW TO THE STAND (FIG. J)

⚠ WARNING

- Do not mount the miter saw to the stand without first ensuring the stand is extended fully and locked securely. To set up the stand, follow the instruction in section “**SETTING UP THE STAND**” on page 12. Failure to do so may result in possible injury and damage to the stand and the miter saw.
 - Always use the saw mounting brackets when mounting the miter saw to the stand.
 - The cutting head on all sliding miter saws must be locked in both the forward and down positions before mount to the stand. Failure to do so may result in serious personal injury.
 - Stay alert. The stand and miter saw may fall down during this procedure and cause serious injury.
 - Do not use the miter saw on the stand when the legs of stand are folded.
 - Layout the power cable neatly to prevent the power cable causing the stand to tip over when performing the cutting operation.
 - Before operating the miter saw, read carefully the instruction manual for the miter saw.
1. Attach the saw mounting bracket (1) by placing the front end of the bracket on the front bed rail and then place the rear end of the mounting bracket onto the rear bed rail of the stand. The front and rear holding clamps of the saw mounting bracket **MUST** seat fully on the front and rear rails.
 2. Lock the saw mounting bracket in position by turning the lock knob (2) clockwise.
 3. Repeat above steps for attaching the other saw mounting bracket.

⚠ WARNING

Ensure that the saw mounting brackets are clamped securely on the stand before mounting the miter saw.

4. Unplug the miter saw and lock the cutting head to its down position. If the miter saw has a sliding rail, lock the cutting head in the down and forward position. Put the miter saw on the mounting brackets.

NOTE: For your own safety, position the miter saw on the brackets with the help of two or more people.

5. Insert the bolts (3) through the washers (4), the mounting holes (5) of the miter saw and the slots of the saw mounting brackets (1) into the square nuts (6) to mount and lock the miter saw to the saw mounting brackets (1).
6. Tighten all bolts (3) using a 5 mm hex wrench.

Fig. J

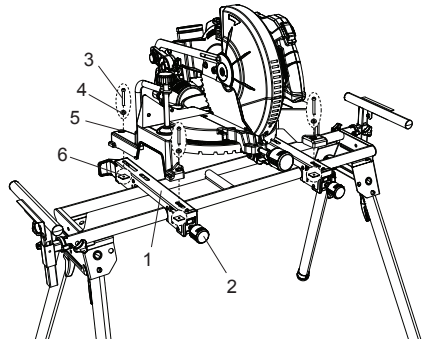

7. After securely mounting the miter saw, unlock the hold-down latch of the miter saw and carefully move the cutting head up and down. If the stand tends to fall down, reposition the miter saw.
8. Unlock the slide carriage lock knob of the miter saw and carefully slide the cutting head forward. If the stand tends to fall down, reposition the miter saw for more stable position on the brackets.
9. Carefully perform sliding movement test at the maximum miter and bevel angles to ensure the stability of the stand and the miter saw.

⚠ WARNING

When dismantling the miter saw, remove the miter saw together with the saw mounting brackets, so that you can put the miter saw and the mounting brackets all together for next time using. Be sure to have assistance of two or more people when you mount or dismantle the miter saw.

**UNIVERSAL MITER SAW MOUNTING
(FIG. K, L)**

⚠ WARNING

- To reduce the risk of injury, turn unit off, disconnect machine from power source before assembling the miter saw to the miter saw stand. An accidental start-up can cause injury.
- **Stability Hazard.** You must use the plywood mounting method described in the following instructions when mounting a miter saw that is not the Porter-Cable 10" miter saw to this miter saw stand.
- To reduce the risk of personal injury, be sure the miter saw is fully anchored on the stand.
- For your own safety, read and understand the miter saw instruction manual before using. Failure to heed these warnings may result in personal injury and serious damage to the miter saw and the accessory.

NOTE: If you do not have a Porter-Cable 10" miter saw, you must use 3/4" (19 mm) plywood to mount your miter saw. The plywood must be a minimum of 4" (101.6 mm) wider than the largest width of the miter saw base. The plywood should be at least as deep as the smallest depth of the miter saw base or a minimum of 16" (406.4 mm) if miter saw base is smaller. Ensure the plywood is square. The plywood is not supplied.

1. Once the plywood size has been determined, drill 3/8" (9.5 mm) holes 1" (25.5 mm) from the front corners of plywood, 15" (381 mm) apart and 1" (25.5 mm) from the sides.
2. Place plywood onto mounting brackets and align drilled holes with slots in mounting brackets.
3. Use an adjustable wrench to tighten hardware.
4. The miter saw should be mounted to plywood using holes in the miter saw base. The hardware size will be determined by the holes in the miter saw base. Hardware should be 1-1/4" (31.8 mm) longer than the maximum height of the miter saw base at each mounting location.

Fig. K

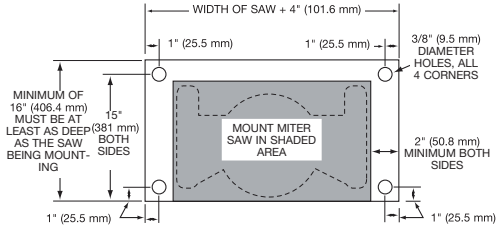

- a. Transfer location of mounting holes from miter saw base to plywood.
 - b. Drill holes accordingly to the size of the hardware chosen.
- NOTE:** Hardware must be purchased to mount miter saw to plywood, it is not supplied with the stand. All purchased hardware should be a minimum of Grade 5 or Class 8.8.

- c. Secure miter saw to plywood as shown in Fig. L:

- (1) Saw base
- (2) 3/4" (19 mm) plywood
- (3) Flat washer
- (4) Lock washer
- (5) Nut

NOTE: Ensure a flat washer (3) is used between plywood (2) and lock washer (4).

- d. Tighten all hardware.

Fig. L

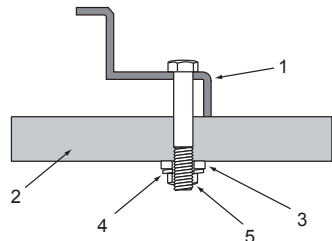

MAINTENANCE

⚠ WARNING

- Always wear safety goggles or safety glasses with side shields and dust mask during power tool operation or when blowing dust.
- Occasionally check the saw mounting brackets, making sure the mounting brackets are tight by following “**ADJUSTING THE MITER SAW MOUNTING BRACKETS**” on page 11.

GENERAL MAINTENANCE

Remove the miter saw when servicing or cleaning the stand. Use clean cloths to remove dirt, dust, oil, grease and etc. Avoid using solvents when cleaning plastic parts. Most plastics are susceptible to damage from various types of commercial solvents and may be damaged by their use.

⚠ WARNING

Do not use the brake fluids, gasoline, petroleum-based products, penetrating oils and so on to contact with plastic parts. Chemical can damage, weaken or destroy plastic which may cause serious personal injury.

SERVICE AND REPAIRS

All quality tools will eventually require servicing and/or replacement of parts. For information about Porter-Cable, its factory service centers or authorized warranty service centers, visit our website at www.portercable.com or call our Customer Care Center at (888) 609-9779. All repairs made by our service centers are fully guaranteed against defective material and workmanship. We cannot guarantee repairs made or attempted by others.

You can also write to us for information at Power Tool Specialists, Inc. 684 Huey Road, Rock Hill, SC 29730, - Attention: Product Service. Be sure to include all of the information shown on the nameplate of your tool (model number, type, serial number, etc.).

PLEASE READ THE FOLLOWING: The manufacturer and/or distributor is providing the buyer with a parts list and assembly diagram in this manual as a reference tool only. Neither the manufacturer nor distributor make any representation or warranty of any kind to the buyer regarding the accuracy of the list or diagram or that buyer is qualified and able to make any repairs or replace any parts of the product. The manufacturer and/or distributor expressly recommend: that all repairs and/or part replacements only be undertaken by a certified and licensed technician, and not by the buyer. The buyer assumes all risk and liability, including injuries to persons and damage to property, associated with and arising out of any attempt of the buyer at repairs or replacement of parts to the product.

FREE WARNING LABEL REPLACEMENT: If your warning labels become illegible or are missing, call 1-888-609-9779 for a free replacement.

PORTER CABLE	
PORTERCABLE MODEL NO. 10 30000 30000 1 WEL DATE: (DATE DE FABRICATION) PORTER-CABLE and the PORTER-CABLE logo are registered trademarks of PORTER-CABLE and are used under license. All rights reserved. PORTER-CABLE et le logo PORTER-CABLE sont des marques commerciales de PORTER-CABLE et sont utilisés sous licence. Tous droits réservés. PORTER-CABLE et le logo PORTER-CABLE sont des marques commerciales de PORTER-CABLE et sont utilisés sous licence. Tous droits réservés.	PORTER TOOL SPECIALISTS, INC. ROCK HILL, SC 29730 U.S.A. MADE IN CHINA FABRIQUE EN CHINE 1-888-609-9779
⚠ WARNING FOR THE USER: READ THE INSTRUCTION MANUAL BEFORE USING THE TOOL. PORTER-CABLE and the PORTER-CABLE logo are registered trademarks of PORTER-CABLE and are used under license. All rights reserved. PORTER-CABLE et le logo PORTER-CABLE sont des marques commerciales de PORTER-CABLE et sont utilisés sous licence. Tous droits réservés. PORTER-CABLE et le logo PORTER-CABLE sont des marques commerciales de PORTER-CABLE et sont utilisés sous licence. Tous droits réservés.	
1. ALWAYS WEAR YOUR SAFETY GOGGLES OR SAFETY GLASSES WITH SIDE SHIELDS AND DUST MASK DURING POWER TOOL OPERATION OR WHEN BLOWING DUST. 2. OCCASIONALLY CHECK THE SAW MOUNTING BRACKETS, MAKING SURE THE MOUNTING BRACKETS ARE TIGHT BY FOLLOWING "ADJUSTING THE MITER SAW MOUNTING BRACKETS" ON PAGE 11.	1. TOUJOURS PORTER VOS LUNETTES DE SÉCURITÉ AVEC ÉCRANS LATÉRAUX ET MASQUE À POUSSIERE LORS DE L'UTILISATION DE L'OUTIL À PNEU. OU LORS DE LA SOUFFLÉE DE LA POUSSIERE. 2. VÉRIFIEZ OCCASIONNELLEMENT LES BRACKETS DE MONTAGE DE LA SCIE, EN S'ASSURANT QU'ILS SONT BIEN SERRÉS EN SUIVANT "ADJUSTING THE MITER SAW MOUNTING BRACKETS" À LA PAGE 11.

⚠ WARNING 1. ALWAYS WEAR YOUR SAFETY GOGGLES OR SAFETY GLASSES WITH SIDE SHIELDS AND DUST MASK DURING POWER TOOL OPERATION OR WHEN BLOWING DUST. 2. OCCASIONALLY CHECK THE SAW MOUNTING BRACKETS, MAKING SURE THE MOUNTING BRACKETS ARE TIGHT BY FOLLOWING "ADJUSTING THE MITER SAW MOUNTING BRACKETS" ON PAGE 11.	⚠ AVERTISSEMENT 1. TOUJOURS PORTER VOS LUNETTES DE SÉCURITÉ AVEC ÉCRANS LATÉRAUX ET MASQUE À POUSSIERE LORS DE L'UTILISATION DE L'OUTIL À PNEU. OU LORS DE LA SOUFFLÉE DE LA POUSSIERE. 2. VÉRIFIEZ OCCASIONNELLEMENT LES BRACKETS DE MONTAGE DE LA SCIE, EN S'ASSURANT QU'ILS SONT BIEN SERRÉS EN SUIVANT "ADJUSTING THE MITER SAW MOUNTING BRACKETS" À LA PAGE 11.	⚠ ADVERTENCIA 1. SIEMPRE USAR SUS GOGGLES DE SEGURIDAD O GAFAS DE SEGURIDAD CON PANTALLAS Y MÁSCA DE POLVO DURANTE EL USO DE LA HERRAMIENTA O AL SOPLAR POLVO. 2. VERIFIQUE OCCASIONALMENTE LOS BRACKETS DE MONTAJE DE LA SIERRA, ASEGURÁNDOSE DE QUE ESTÁN BIEN AJUSTADOS SIGUIENDO "AJUSTANDO LOS BRACKETS DE MONTAJE DE LA SIERRA" EN LA PÁGINA 11.
---	---	---

⚠ AVERTISSEMENT 1. TOUJOURS PORTER VOS LUNETTES DE SÉCURITÉ AVEC ÉCRANS LATÉRAUX ET MASQUE À POUSSIERE LORS DE L'UTILISATION DE L'OUTIL À PNEU. OU LORS DE LA SOUFFLÉE DE LA POUSSIERE. 2. VÉRIFIEZ OCCASIONNELLEMENT LES BRACKETS DE MONTAGE DE LA SCIE, EN S'ASSURANT QU'ILS SONT BIEN SERRÉS EN SUIVANT "ADJUSTING THE MITER SAW MOUNTING BRACKETS" À LA PAGE 11.	⚠ ADVERTENCIA 1. SIEMPRE USAR SUS GOGGLES DE SEGURIDAD O GAFAS DE SEGURIDAD CON PANTALLAS Y MÁSCA DE POLVO DURANTE EL USO DE LA HERRAMIENTA O AL SOPLAR POLVO. 2. VERIFIQUE OCCASIONALMENTE LOS BRACKETS DE MONTAJE DE LA SIERRA, ASEGURÁNDOSE DE QUE ESTÁN BIEN AJUSTADOS SIGUIENDO "AJUSTANDO LOS BRACKETS DE MONTAJE DE LA SIERRA" EN LA PÁGINA 11.
---	---



PARTS LIST

FOLDING MITER SAW STAND PARTS LIST

I.D. NO.	Description	Size	Q'ty
057M	SPRING		4
0KDJ	CR. RE. PAN HD. SCREW	M5*0.8-12	4
0KQX	LOCK NUT	M6*1.0 T=6	4
0KQY	LOCK NUT	M8*1.25 T=8	4
20V5	HEX. SOC. TRUSS HD. SCREW	M8*1.25-60	4
32NA	WARNING LABEL		2
32RF	FLAT WASHER	φ8*18-2	4
33N6	FLAT WASHER	φ6*13-1.5	4
3AYP	FLAT WASHER	φ8.1*16-2	4
3F31	SQUARE NUT		4
3F9S	CAP HD. SQ.NECK BOLT	M8*1.25-62	4
3M17	FENCE		2
3M1E	LOCATION PIN		4
3M1F	PLUG-BUTTON		4
3M1S	STAND LEG		2
3U5N	HANDLE		2
3U5P	HANDLE		2
3U5W	STAND LEG		2
3U5Z	TABLE ASS'Y		1
3U6C	PLUG-BUTTON		2
3UK3	HANDLE		2
3UGF	SAW MOUNTING BRACKET (RIGHT)		1
3UGG	SAW MOUNTING BRACKET (LEFT)		1
3UGJ	EXTENSION WING ASS'Y		2
3UGK	EXTENSION WING ASS'Y		2
3UWS	TRADEMARK LABEL		2
3UWU	LABEL		1
3UWV	WARNING LABEL		1
3UWW	WARNING LABEL		2
3UWY	INSTRUCTION MANUAL		1
3UXK	PLUNGER HANDLE		4

WARRANTY

THREE YEAR LIMITED WARRANTY

PORTER-CABLE will repair, without charge, any defects due to faulty materials or workmanship for three years from the date of purchase. This warranty does not cover part failure due to normal wear or tool abuse. For further detail of warranty coverage and warranty repair information, visit www.portercable.com or call (888) 609-9779. This warranty does not apply to accessories or damage caused where repairs have been made or attempted by others. This warranty gives you specific legal rights and you may have other rights which vary in certain states or provinces.

In addition to the warranty, PORTER-CABLE tools are covered by our:

1 YEAR FREE SERVICE: PORTER-CABLE will maintain the tool and replace worn parts caused by normal use, for free, any time during the first year after purchase.

90 DAYS MONEY BACK GUARANTEE: If you are not completely satisfied with the performance of your PORTER-CABLE Power Tool for any reason, you can return it within 90 days from the date of purchase with a receipt for a full refund – no questions asked.

LATIN AMERICA: This warranty does not apply to products sold in Latin America. For products sold in Latin America, see country specific warranty information contained in the packaging, call the local company or see website for warranty information.

To register your tool for warranty service visit our website at www.portercable.com.

WARNING LABEL REPLACEMENT

If your warning labels become illegible or are missing, call (888) 609-9779 for a free replacement.

The following are PORTER-CABLE trademarks for one or more power tools and accessories: a gray and black color scheme; a “four point star” design; and three contrasting/outlined longitudinal stripes. The following are also trademarks for one or more Porter-Cable and Delta products: 2 BY 4[®], 890[™], Air America[®], AIRBOSS[™], Auto-Set[®], B.O.S.S.[®], Bammer[®], Biesemeyer[®], Builders Saw[®], Charge Air[®], Charge Air Pro[®], CONTRACTOR SUPERDUTY[®], Contractor’s Saw[®], Delta[®], DELTA[®], Delta Industrial[®], DELTA MACHINERY & DESIGN[™], Delta Shopmaster and Design[®], Delta X5[®], Deltacraft[®], DELTAGRAM[®], Do It. Feel it.[®], DUAL LASERLOC AND DESIGN[®], EASY AIR[®], EASY AIR TO GO[™], ENDURADIAMOND[®], Ex-Cell[®], Front Bevel Lock[®], Get Yours While the Sun Shines[®], Grip to Fit[®], GRIPVAC[™], GTF[®], HICKORY WOODWORKING[®], Homecraft[®], HP FRAMER HIGH PRESSURE[®], IMPACT SERIES[™], Innovation That Works[®], Jet-Lock[®], Job Boss[®], Kickstand[®], LASERLOC[®], LONG-LASTING WORK LIFE[®], MAX FORCE[™], MAX LIFE[®], Micro-Set[®], Midi-Lathe[®], Monsoon[®], MONSTER-CARBIDE[™], Network[®], OLDHAM[®], Omnijig[®], PC EDGE[®], Performance Crew[™], Performance Gear[®], Pocket Cutter[®], Porta-Band[®], Porta-Plane[®], Porter-Cable[®], Porter-Cable Professional Power Tools[®], Powerback[®], POZI-STOP[™], Pressure Wave[®], PRO 4000[®], Proair[®], Quicksand and Design[®], Quickset II[®], QUIET DRIVE TECHNOLOGY[™], QUIET DRIVE TECHNOLOGY AND DESIGN[™], Quick-Change[®], QUIK-TILT[®], RAPID-RELEASE[™], RAZOR[®], Redefining Performance[®], Riptide[®], Safe Guard II[®], Sand Trap and Design[®], Sanding Center[®], Saw Boss[®], Shop Boss[®], Sidekick[®], Site Boss[®], Speed-Bloc[®], Speedmatic[®], Stair Ease[®], Steel Driver Series[®], SUPERDUTY[®], T4 & DESIGN[®], THE AMERICAN WOODSHOP[®], THE PROFESSIONAL EDGE[®], Thin-Line[®], Tiger Saw[®], TIGERCLAW[®], TIGERCLAW AND DESIGN[®], Torq-Buster[®], TRU-MATCH[®], T-Square[®], Twinlaser[®], Unifence[®], Uniguard[®], UNIRIP[®], UNISAW[®], UNITED STATES SAW[®], Veri-Set[®], Versa-Feeder[®], VIPER[®], VT[™], VT RAZOR[™], Water Driver[®], WATER VROOM[®], Waveform[®], Whisper Series[®], X5[®], YOUR ACHIEVEMENT. OUR TOOLS[®]. Trademarks noted with ® are registered in the United States Patent and Trademark Office and may also be registered in other countries. Other trademarks may apply.

PORTER-CABLE and the PORTER-CABLE logo are registered trademarks of PORTER-CABLE and are used under license. All rights reserved.

PORTER  CABLE.

Power Tool Specialists, Inc.
684 Huey Road, Rock Hill, SC 29730
(888) 609-9779
www.portercable.com