

# ASSEMBLY INSTRUCTIONS

---

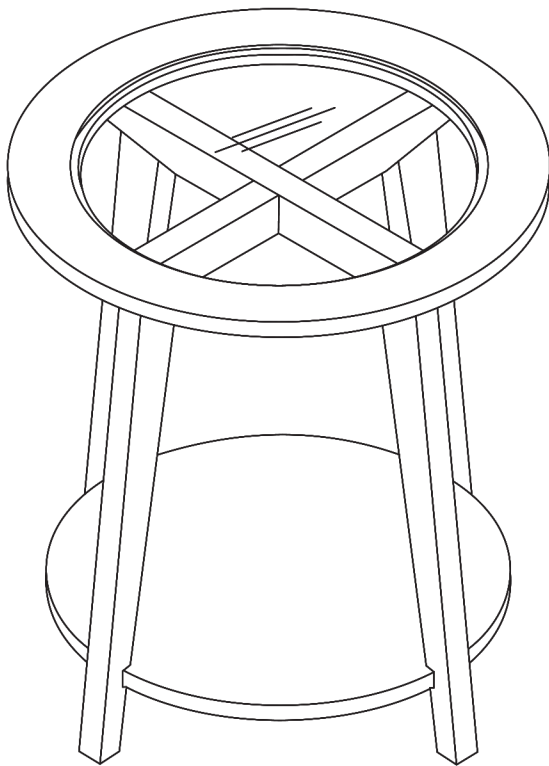

## TOOLS REQUIRED



**Allen Wrench**

(Included)



**2 - People  
Recommended**

## ASSEMBLY RATING



EASY ————— DIFFICULT

The Assembly Rating is a 5-point system showing the level of effort needed to assemble a specific product.



## **CHECK BEFORE STARTING**



### **Are you missing anything?**

Double-check all parts, hardware and accessories listed on Page 6 are accounted for.



### **Should we send any replacements?**

Are there any irregularities or flaws in the parts? We can send replacements!



### **Check out our Quick Tips!**

We recommend reviewing the pre-assembly handouts. Even experts need a refresher now and then!



### **Prep Time!**

Please review the assembly instructions and all diagrams prior to assembling. Arrange parts as recommended on Page 7 and group identical hardware together to make assembling easier.

# PRE ASSEMBLY INTRODUCTION

We understand building ready-to-assemble furniture can be a challenging experience for some. To help avoid confusion, we have provided some helpful tips that may speed up the process.

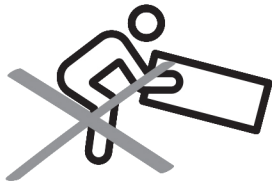

## Teamwork

ALWAYS have at least two people to help with transporting and assembling the product to avoid potential injury and/or damage.

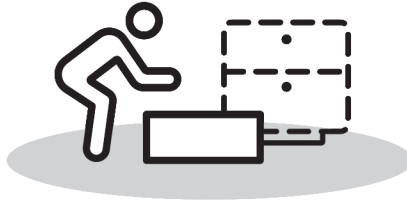
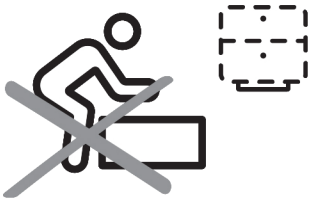

## Suitable Location

Assembling near the area of the intended location is highly recommended.



## Sufficient Space

Make sure you have enough space to move around during the assembly.



## Avoid Scratches

Use cardboard, blankets or a carpeted area while assembling furniture to prevent scratches.

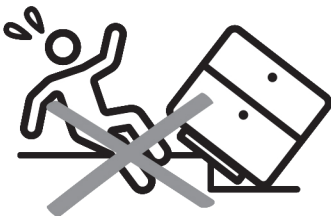

## Flat Surface

Make sure the furniture rests on a flat and level surface with each leg evenly touching the floor.

# ASSEMBLY AND CARE ADVICE



**FAILURE TO FOLLOW THE GUIDELINES BELOW MAY  
RESULT IN INJURY AND/OR PROPERTY DAMAGE.**



Position each part correctly  
and insert screws or bolts into  
their respective holes.

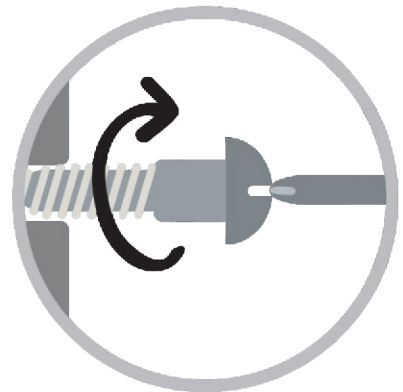

Turn clockwise to tighten and  
only tighten when step is  
completed or when instructed  
to do so.



Use the appropriate hand tools  
or power tools for assembly.  
Select steps, such as tightening  
screws and/or bolts, may require  
hand tools to avoid causing  
damage during assembly.



Save the instructions and store  
any supplied tools for later  
maintenance.

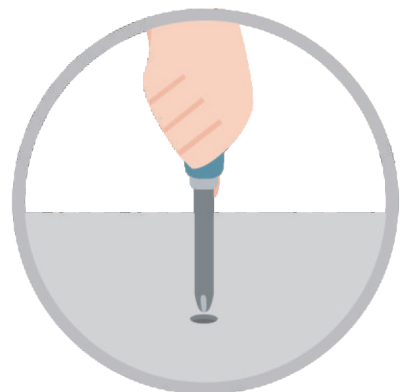

After two weeks, check and  
tighten any loose hardware and  
repeat again every six months  
thereafter.

**IT IS THE USER'S RESPONSIBILITY TO MAINTAIN THE FURNITURE. THE HARDWARE MAY LOOSEN OVER TIME AND MAY CAUSE THE FURNITURE TO BE WOBBLY AND UNABLE TO SUPPORT ITS INTENDED WEIGHT CAPACITY. THIS MAY LEAD TO COLLAPSE AND MAY CAUSE SERIOUS INJURY.**

# END TABLE

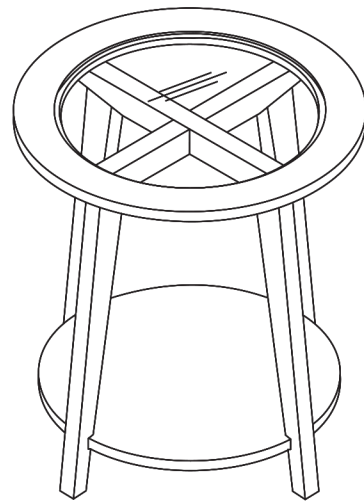
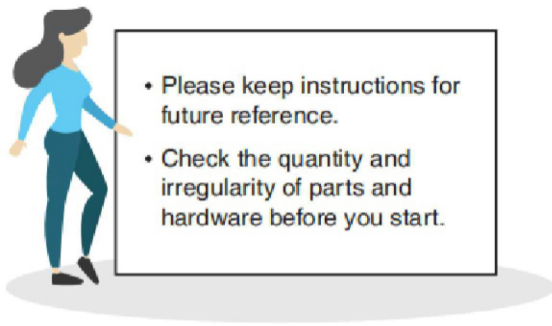

## PARTS

#1 1pc

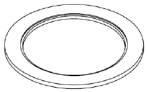

Top Table

#2 1pc

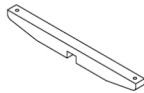

Top Support

#3 1pc

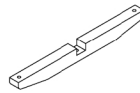

Bottom Support

#4 4pcs



Table Legs

#5 1pc



Shelf

#6 1pc



Glass

## HARDWARE

#A 5pcs



Long Bolt Ø1/4"x1-1/2"

#B 13pcs



Spring Washer Ø1/4"x10mm

#C 5pcs



Flat Washer Ø1/4"x19mm

#D 4pcs



Wood Dowel Ø10x40mm

#E 4pcs



Long Bolt Ø1/4"x2"

#F 8pcs



Flat Washer Ø1/4"x16mm

#G 8pcs



Short Bolt Ø1/4"x5/8"

#H 4pcs



Metal Plate

#I 1pc



Allen Wrench 4mm

# Exploded View

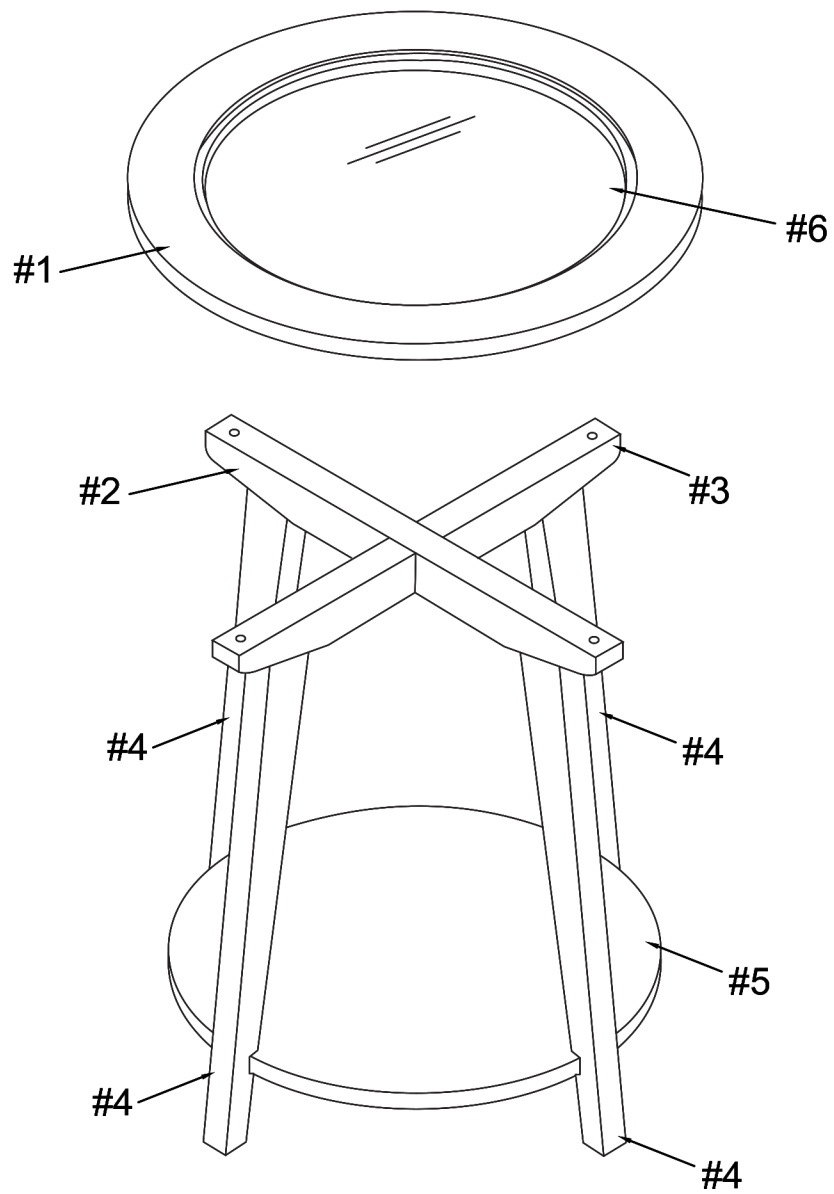

# ASSEMBLY INSTRUCTIONS

1

Part #2 x1pc

Part #3 x1pc

Hardware #A x1pc

Hardware #B x1pc

Hardware #C x1pc

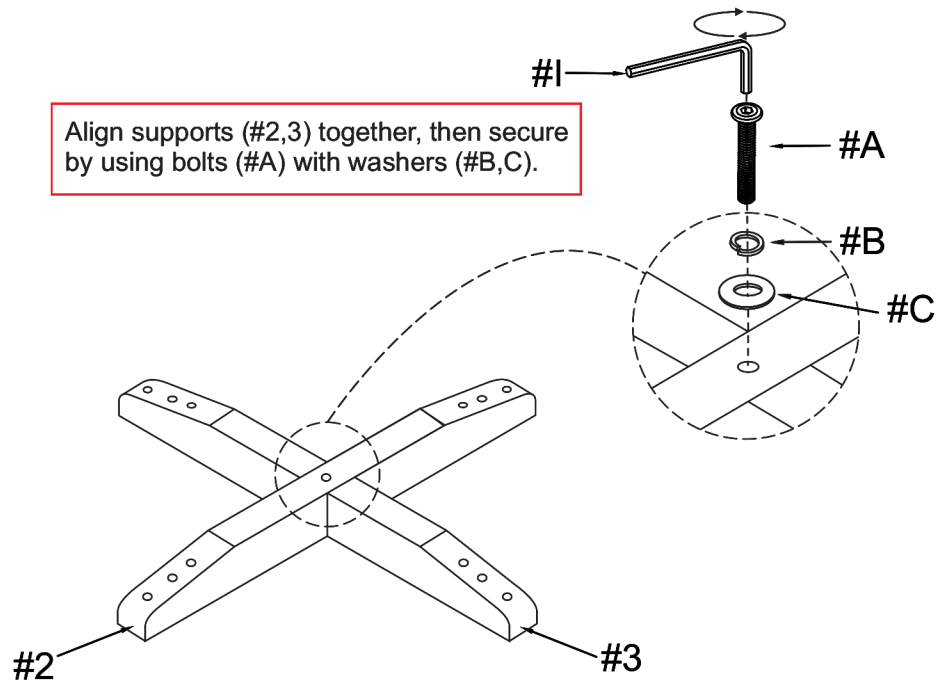

2

Part #1 x1pc

Hardware #A x4pcs

Hardware #B x4pcs

Hardware #C x4pcs

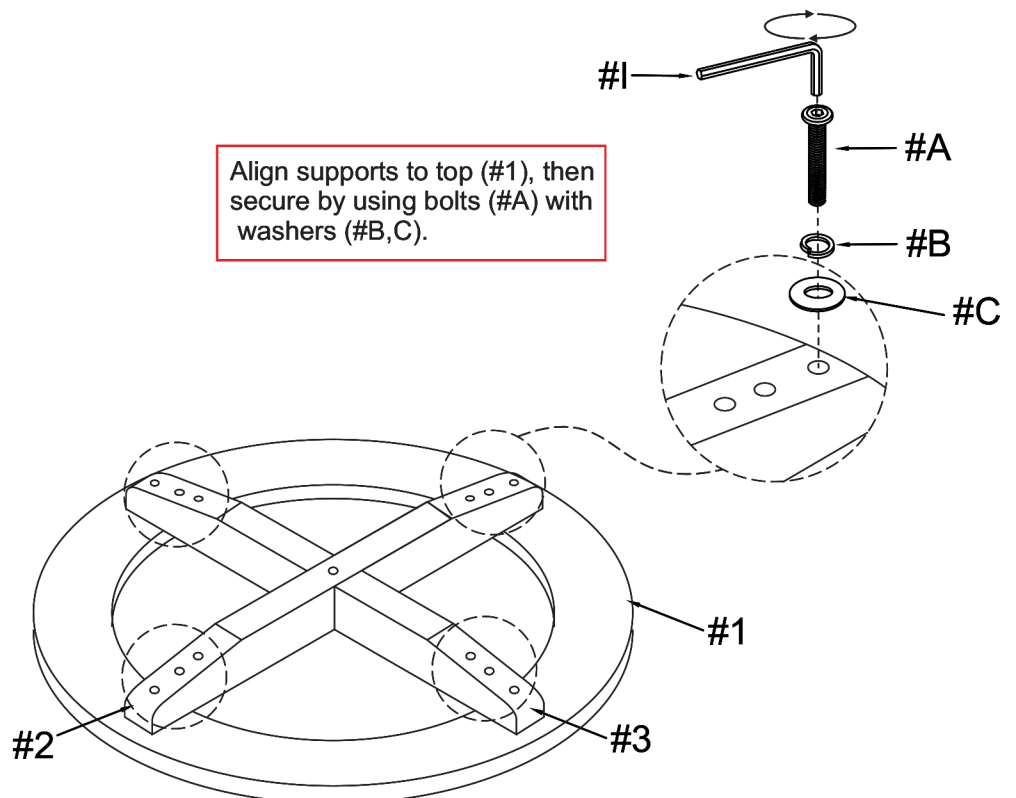

# ASSEMBLY INSTRUCTIONS

## 3

Part #4 x3pcs

Hardware #D x3pcs

Insert dowels (#D) to supports (#2,3), then align 3 legs (#4) to the supports.

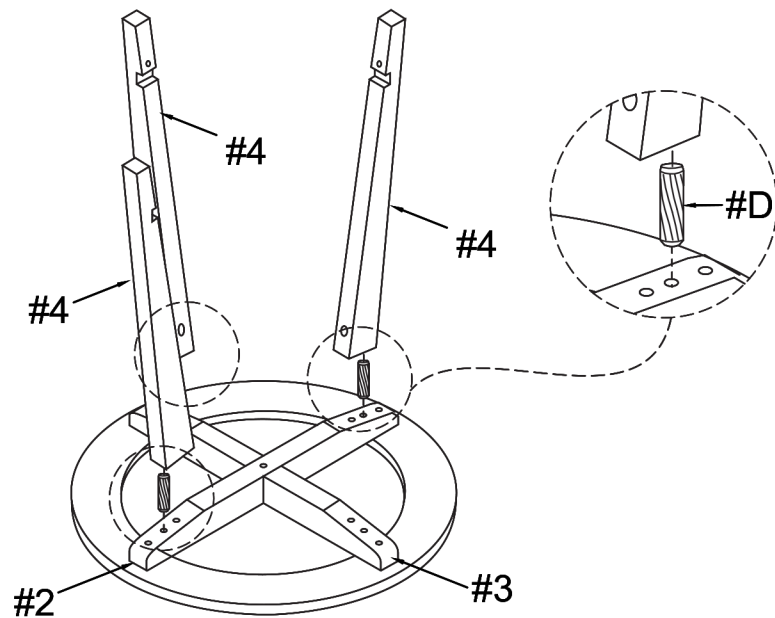

## 4

Hardware #E x3pcs

Secure legs (#4) to supports by using bolts (#E) .

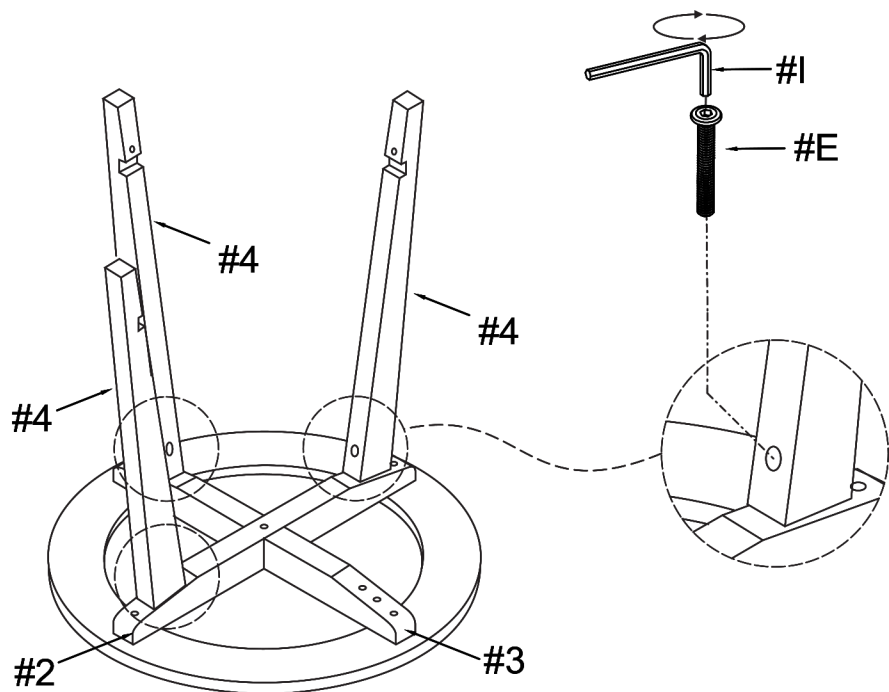

# ASSEMBLY INSTRUCTIONS

5

Part #5 x1pc

Align shelf (#5) to the legs.

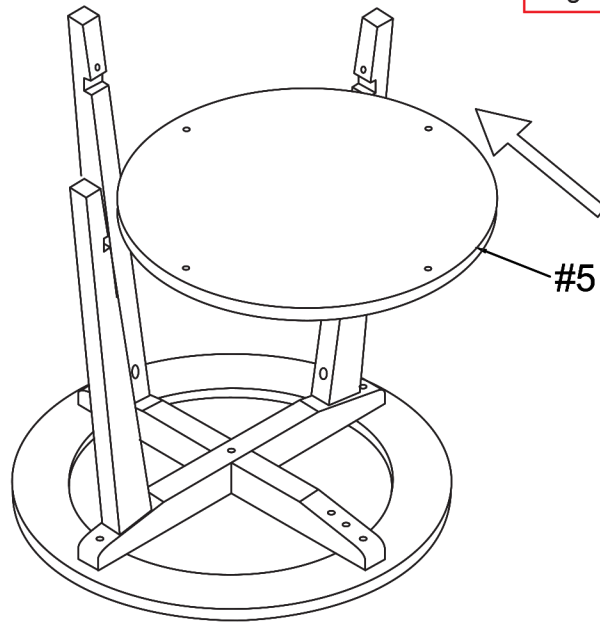

6

Part #4 x1pc

Hardware #D x1pc

Hardware #E x1pc

Insert dowel (#D) to support, then align last leg (#4) to the support. Secure by using bolts (#E).

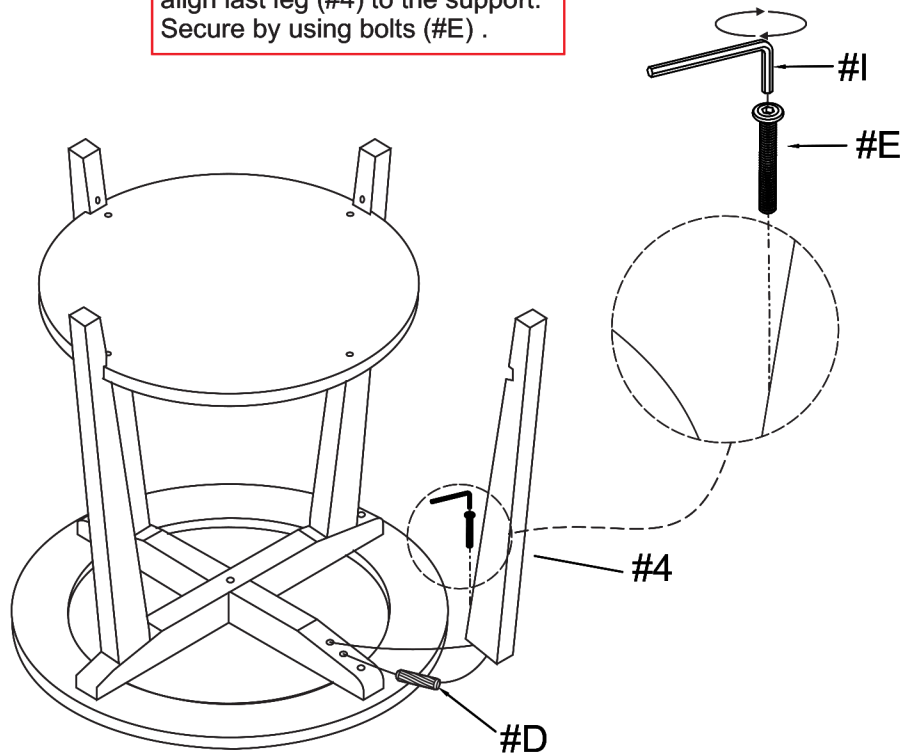

# ASSEMBLY INSTRUCTIONS

7

Hardware **#B** x8pcs

Hardware **#F** x8pcs

Hardware **#G** x8pcs

Hardware **#H** x4pcs

Align brackets (**#H**) to the shelf and legs, then secure by using bolts (**#G**) with washers (**#B**, **F**).

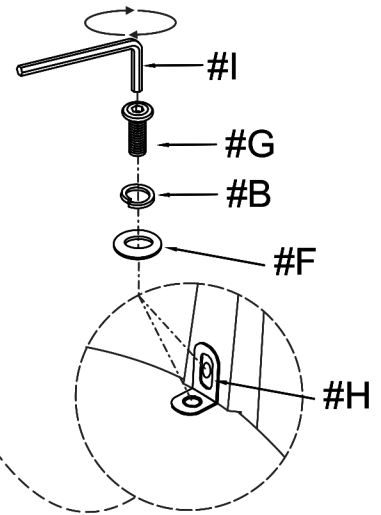
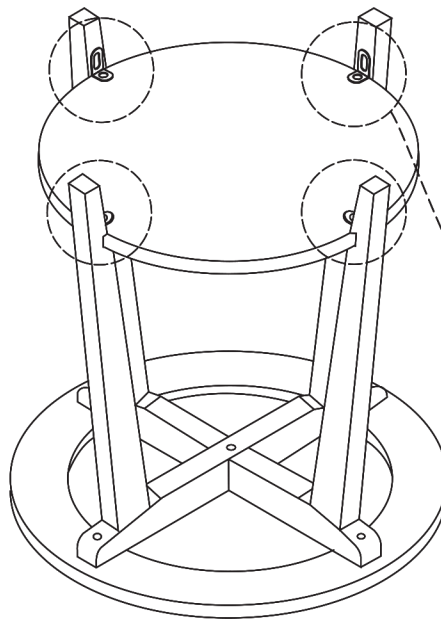

8

Part **#6** x1pc



Carefully place glass (**#6**).

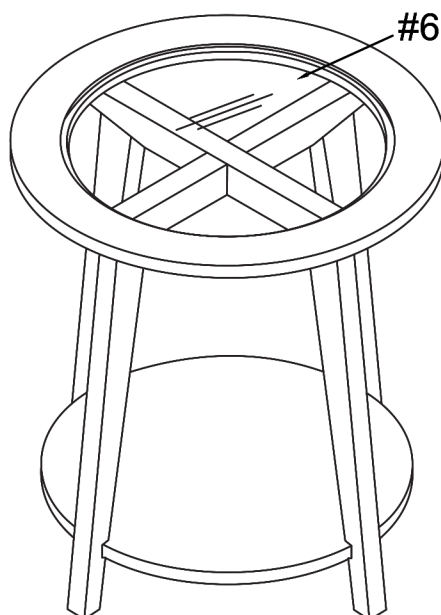

## ASSEMBLY COMPLETED



Please ensure the furniture rests on an even and flat surface. If the product wobbles or feels loose, double-check all bolts and/or screws are properly tightened and secured.



### Keep this handy!

Please retain this instruction manual and any order-related information for future reference.



### Lift, don't drag!

To avoid damage to product please always LIFT the product when transporting or adjusting the placement.