



Double sided



Double sided tool. We recommend you to use the convex top for our screen door product, as the concave side is more suitable for larger groove.



Remove the old screen and spline with the screw driver, and clean the surface.



Measure the size you wish to cover with screen. Add 2 inch to both length and width of desired size (e.g. if you wish to cover a 30" * 76" area, the right size should be 32" * 78")



Use the screen roller's convex top to push the spline and screen into the groove.

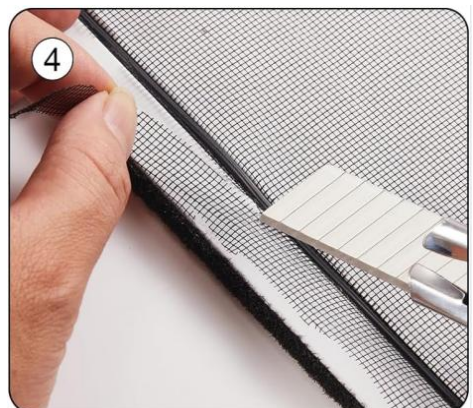

Cut off the unnecessary screen and spline.