



Additional Tools You Will Need

- ~Measuring Tape
- ~A Drill
- ~ A Level
- ~ 4-inch screws
- ~3-inch screws
- ~1-inch washers
- ~2-inch screws
- ~Big stretch caulk
- ~A Caulking gun
- ~A caulking tool
- ~Loctite 3x grab glue
- ~A Saw (Hand Saw, Circular Saw or Jig Saw)
- ~Chalk Line
- ~Framing Square
- ~Paint brush
- ~Sponge
- ~Matching Paint
- ~Masking Tape
- ~Pencil
- ~Marker
- ~Ledger Board
- ~Metal Cleats (included and sold separately)

Additional Recommended Tools-
Upper Cutter Table Topper
(Available at
www.snaptightproducts.com)



SNAPTIGHT
PRODUCTS
★ INSULATED BUILDING PRODUCTS ★

Insulated Stucco Wall Panels.

These Patent-Pending Insulated Stucco Wall Panels are made with 2 ½" of EPS Foam, which adds an additional insulation value of an R-12 to your home or business. They are also treated with a fire retardant. They do not absorb moisture, which makes them mold resistant. These insulated stucco wall panels are eco-friendly and made from recyclable materials, which helps lowers the carbon footprint. They can be installed in any weather condition. They are manufactured in a controlled environment, then shipped out to job sites and/or stores. These insulated stucco wall panels are simple to install to a home or business. They are designed to go over any wood, masonry, and siding surfaces. Follow the manufactures instructions provided to complete your installation of these insulated stucco wall panels. These insulated stucco wall panels are designed to be installed beginning on the right or left end of building. Just flip the insulated stucco wall panel around so that the leading edge (Female side) goes right or left. See wall panel image to the right.

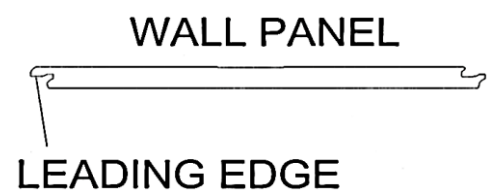

Measure the width of the wall that you are planning to cover with the insulated stucco wall panels, divide this measurement in half to find your center of the exterior wall, this is an important step to be able to cut your starting panel (first panel to install) on to the left or right corner of the building, whichever corner you decide to start with. The starter panel should be cut to the same width as your ending panel (last panel to install) (See Fig 2) *Example: exterior wall is 20ft wide, so center will be at 10ft, each wall panel is 4ft wide, at your center going to the right of the building you will then need two 4 ft panels, and then one 2ft panel, this 2ft panel will be your starting panel that you will cut the excess width off. This would be the same for your center to the left of the building two 4ft panels and a 2 ft panel which is then your ending panel, so 2ft will need to be cut off the starting panel and ending panel.*

Fig. 2

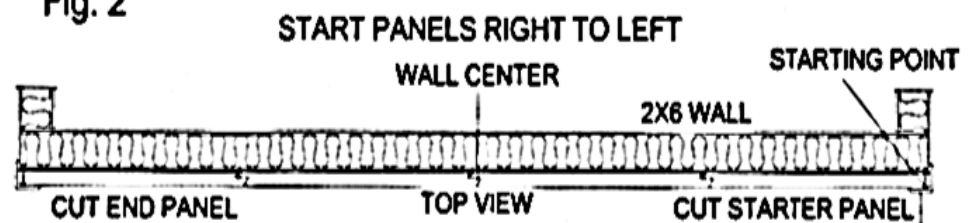

Measure the height of the exterior wall and the height of the insulated wall panels. Cut the excess height off the wall panels with a saw. *Example: Exterior wall is 9ft tall. Insulated stucco wall panel is 10ft tall. Cut off 1ft of each insulated stucco wall panel.*

Screw on a ledger board (using a level) to give you a ledge for the bottom of the panel to rest on. Make a vertical mark with a marker on exterior wall where every vertical joint comes together. These marks are where you will install the 2- foot horizontal cleats to the exterior wall. (If

installing on a wood structure use 2-inch screws.) Measure up the back side of the insulated stucco wall panel from the bottom up to the first horizontal cleat groove that is cut into the back side of the insulated stucco wall panel (there are 4 cleat grooves cut into the back of each wall panel) You will need to take 4 measurements per cleat groove, this tells you where to screw your horizontal cleats to the exterior wall. (See Fig 3)

Fig. 3

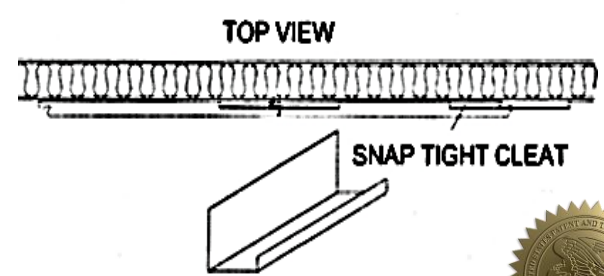



**SnapTight
Products LLC**

**Customer Service
208.252.7285**

www.SNAPTIGHTPRODUCTS.com

Email

Snaptightproducts@gmail.com

Instagram
[snaptightproducts](https://www.instagram.com/snaptightproducts)

Facebook
[@snaptightproducts](https://www.facebook.com/snaptightproducts)

YouTube
[SnapTight Products](https://www.youtube.com/SnapTightProducts)



Using a level take your cleat and screw cleat to the exterior wall or snap a horizontal line across the entire wall from right to left for each row of cleats. Continue installing the horizontal cleats where every panel comes together one foot of the cleat will snap into the right side of one panel and the remaining one foot of the cleat will snap into the left side of next panel. (See Fig 4)

Fig. 4

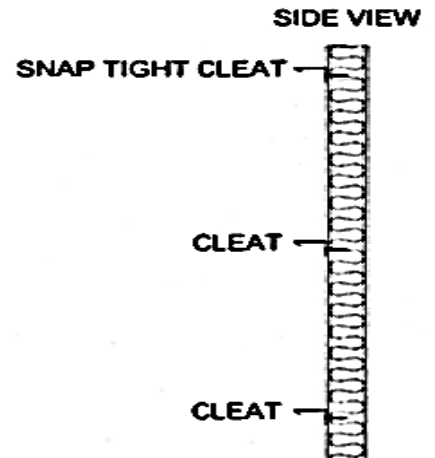
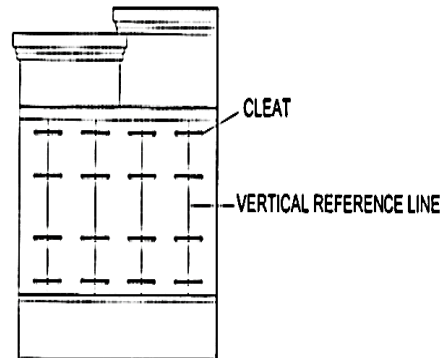

Apply a generous amount of glue to the wall cleat and make S pattern to the back of the wall panel with the glue. Where the two panels join together run a bead of Loctite 3x grab only glue down the leading edge of your panel and now, you're ready for the next panel and so on and so on.

Set bottom of insulated stucco wall on the ledger board, then push the wall panel to the exterior wall. The Insulated **stucco** wall panel should align with the cleats to the groove cut into the back of the wall panel. (The only glue to be used is Loctite 3x grab. Any other construction adhesive will damage the foam and void your warranty.) (See Fig 5)

Fig. 5

BACK OF 4' X 10' INSULATED STUCCO WALL PANEL

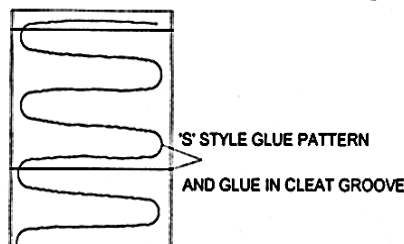

Once the cleat has started into the back of panel, push the wall panel all the way to the exterior wall. The Insulated stucco wall panel will now be set to the exterior wall. Then check wall panel to make sure it is plumb and level. (See figure 6)

Fig. 6

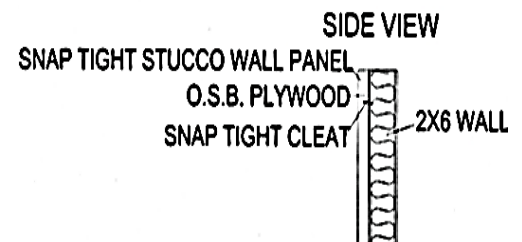

Starting with the leading edge of the insulated stucco wall panel take a 3-inch screw with a 1-inch washer, every 16 inches, install a screw vertically through the leading edge of the insulated stucco wall panel. (See figure 7)

TOP VIEW

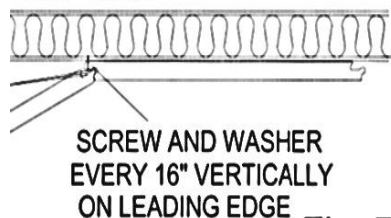
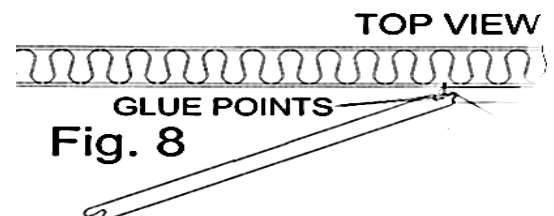

Fig. 7

Next panel start out on a 45-degree angle and insert the vertical male edge into the leading edge of the starter panels and snap it into place while pushing it into the leading edge and into the cleats on the wall. If your Ledger board is leveled and your starter panel is plumb then the rest of the wall panels should follow and be plumb and level (see Figure 8)





**SnapTight
Products LLC**

**Customer Service
208.252.7285**

www.SNAPTIGHTPRODUCTS.com

Email

Snaptightproducts@gmail.com

Instagram
[snaptightproducts](https://www.instagram.com/snaptightproducts)

Facebook
[@snaptightproducts](https://www.facebook.com/snaptightproducts)

YouTube
[SnapTight Products](https://www.youtube.com/SnapTightProducts)



Once the wall panels are installed, the trim (sold separately) needs to be installed around the doors, windows, and corners. This is done using the same cleat method. The cleats are screwed on over top of the wall panel with 4-inch screws.

Decide where you want the trim to go. Measure and cut to length. The trim has a groove already cut into the back of the foam. Measure the distance of the cutout for the cleat then screw cleat on top of wall and apply glue to the back of the trim and simply snap the trim over the cleat (see Figure 9)

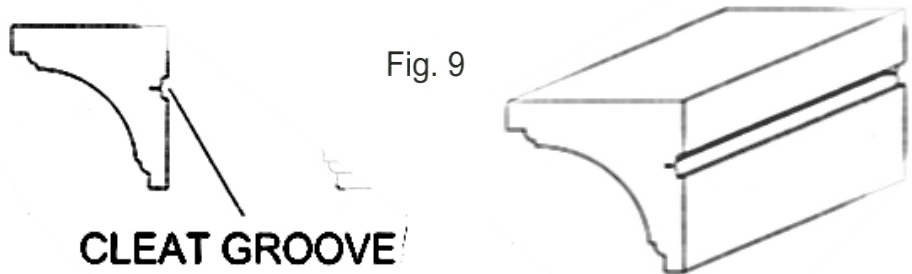

Now that all the wall panels and trim is installed it's time to do the seaming. It's recommended to use big stretch caulk to seam the vertical wall seams and trim. Apply a small amount of caulk. The vertical joints are very tight and will not need a lot of caulk. Apply caulk using a caulk gun. Once the caulk is applied, use a caulking tool to smooth out the caulk. Make sure not to leave a caulked edge, the caulk should be smooth. You can use a damp sponge to wipe off any excess caulk.

Once the caulk has dried, the caulk seams can be painted to match the walls or trim color. All the insulated stucco wall panels and trim are pre painted with matching paint for the seams and can be painted any color you desire. Recommended that when you are seaming and your wall color is a different color then your trim, that you apply masking tape between the two colors before you apply the caulk. Mask off the trim with the masking tape to do the wall color and then paint and remove the tape. Done!!

Enjoy your beautiful prefab stucco home or commercial building!

**Failure to follow the manufactures installation instructions
will void the limited 10-year warranty.**

**Thank You for Supporting Our
Veteran Owned Business.**

**We Hope You Enjoy Your Beautiful Prefab
Insulated Stucco Wall Panels for
Many Years to Come!**



**SNAPTIGHT
PRODUCTS**
★ INSULATED BUILDING PRODUCTS ★

**PRE-FAB INSULATED
STUCCO PANELS**
www.SNAPTIGHTPRODUCTS.com

