



ARIENS



GRAVELY

IKON-X & XD / ZT-X & XL Powered Bagger

Operator's Manual
Manuel du Utilisateur

Models

815045 – 42" / 52" Bagger
(SN 000101 +)

815048 – 48" Bagger
(SN 000101 +)

815049 – 60" Bagger
(SN 000101 +)

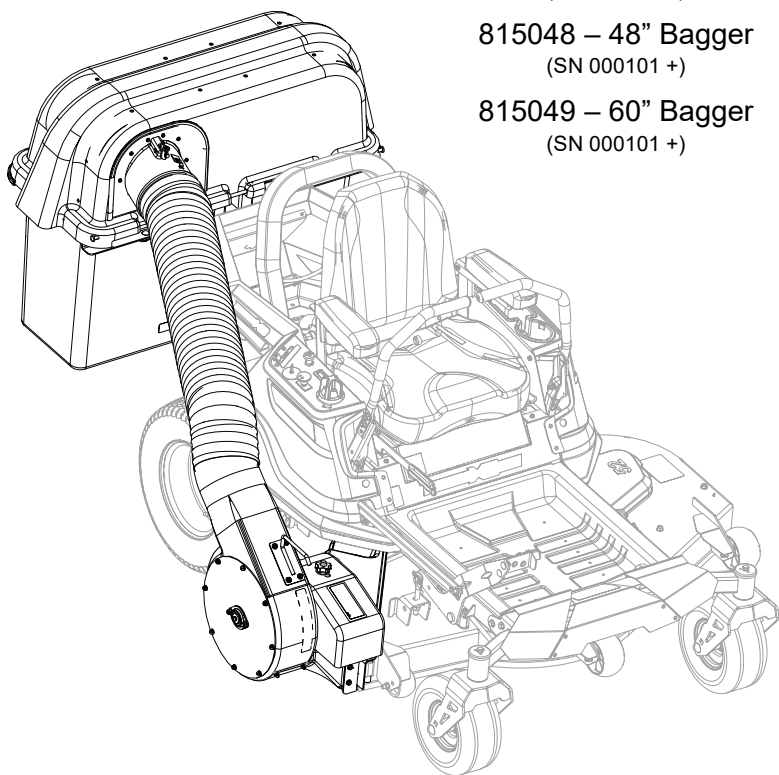

(EN) ENGLISH

(FR) FRANÇAIS

05285200A • 6/20

Printed in USA

TABLE OF CONTENTS

WELCOME	1	OPERATION	18
Register Your Product!	1	Before Each Use	18
SAFETY	2	Bagging	18
Practices & Laws	2	Airflow Indicator	19
Emission Control System	2	Emptying Mesh Bags	19
Required Operator Training	2	Unclog Bagger	19
Safety Alert Symbol	2	Operating Tips	20
Signal Words	2	MAINTENANCE	20
Safety Decals	3	Maintenance Schedule	20
Safety Instructions	5	STORAGE	20
ASSEMBLY	8	TROUBLESHOOTING	21
Removal	9	SPECIFICATIONS	21
Installation	10	WARRANTY	22
Install Grass Bag Assembly	14		
Install Bagger Hose	16		
REMOVAL	18		

WELCOME

Congratulations on your purchase and welcome to the AriensCo family! Every machine in our lineup is designed for long-lasting and unsurpassed performance. We are confident your machine will be part of your family for many years to come.

Have Questions or Need Assistance? www.ariens.com • www.gravely.com

A parts manual for your unit is available for free download or purchase at www.ariens.com or www.gravely.com.

REGISTER YOUR PRODUCT!

It is extremely important to register your product at time of purchase. Product registration activates the warranty and establishes a communication link from AriensCo.

Locate the model and serial number decal on your unit and register those numbers online at www.ariens.com or www.gravely.com. See Figure 1 for decal location. Be aware that the original selling dealer may have already completed product registration on behalf of the original purchaser.

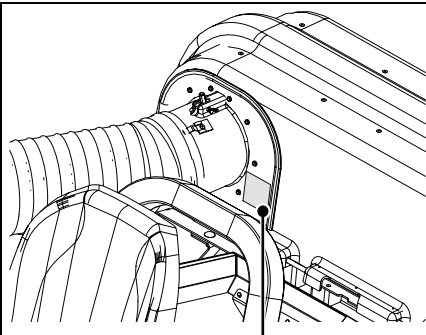

Model & Serial Number Decal

Figure 1

Record model number here.

Record serial number here.

MANUALS

Before operating or servicing the unit, carefully and completely read the manuals provided with the unit. They contain safety instructions and important information about unit controls.

The engine on this unit is covered by a separate manual. Refer to the engine manual for engine service recommendations. Contact the engine manufacturer for a replacement manual if necessary.

Your dealer must review important information in this manual with you before or upon delivery of the unit. It is your responsibility to read and understand all safety precautions and instructions in the manuals. If you do not understand or have difficulty following the instructions, contact your Ariens or Gravely dealer for assistance. To locate your nearest Ariens or Gravely dealer, go to www.ariens.com or www.gravely.com.

DISCLAIMER

AriensCo reserves the right to discontinue, make changes to, and add improvements upon its products at any time without public notice or obligation. The descriptions and specifications contained in this manual were in effect at printing. Equipment described in this manual may be optional. Some illustrations may not be applicable to your unit.

SAFETY

Read these safety rules and follow them closely. Failure to follow these rules could lead to loss of control of unit, severe personal injury or death to you or bystanders, or result in damage to property or the machine.

PRACTICES & LAWS

Practice usual and customary safe working precautions. Learn applicable rules and laws in your area. Always follow the practices set forth in this manual.

EMISSION CONTROL SYSTEM

This equipment and/or its engine may include exhaust and evaporative emissions control system components required to meet U.S. Environmental Protection Agency (EPA) and/or California Air Resources Board (CARB) regulations. Tampering with emission controls and components by unauthorized personnel may result in severe fines or penalties. Emission controls and components can only be adjusted by an Ariens or Gravely dealer or an authorized engine manufacturer's service center. Contact your Ariens or Gravely Equipment Retailer concerning emission controls and component questions.

REQUIRED OPERATOR TRAINING



Read and understand the Operator's Manual and decals on the unit. This information is for your safety and the proper use of your equipment. Failure to follow these

instructions and warnings may cause death or serious injury. If you have purchased this product from an Ariens or Gravely dealer, the dealer can provide you with training.

Familiarize yourself and any other operators with all controls and the safe use of the features of this unit. If you loan, rent or sell this product to others, provide them with all manuals.

If you have any questions, please call our customer support line at 920-756-4688 or contact us at www.ariens.com or www.gravely.com. Do not use this equipment if, after reading the Operator's Manual and the on-board decals, you have any questions about the safe use of this product.



WARNING: AVOID INJURY. This cutting machine is capable of amputating hands and feet and throwing objects. Failure to observe the safety instructions in the manuals and on decals could result in serious injury or death.

SAFETY ALERT SYMBOL



This is the safety alert symbol. It means:

- **ATTENTION!**
- **YOUR SAFETY IS INVOLVED!**

When you see this symbol:

- **BECOME ALERT!**
- **OBEY THE MESSAGE!**

SIGNAL WORDS

The safety alert symbol above and signal words below are used on decals and in this manual. Read and understand all safety messages.

1. Danger



DANGER: Indicates an **IMMINENTLY HAZARDOUS SITUATION!** If not avoided, **WILL RESULT** in death or serious injury.

2. Warning



WARNING: Indicates a **POTENTIALLY HAZARDOUS SITUATION!** If not avoided, **COULD RESULT** in death or serious injury.

3. Caution



CAUTION: Indicates a **POTENTIALLY HAZARDOUS SITUATION!** If not avoided, **MAY RESULT** in minor or moderate injury. It may also be used to alert against unsafe practices.

4. Notice

NOTICE: Indicates information or procedures that are considered important but not hazard related. If not avoided property damage could result.

5. Important

IMPORTANT: Indicates general reference information worthy of special attention.

SAFETY DECALS

The safety decals on your machine are visual reminders of the important safety information in this manual. All messages on your unit must be fully understood and carefully followed. Safety decals on the machine are explained below.

Safety Decal Locations

ALWAYS replace missing or damaged safety decals. Replacement decal part numbers are found in the parts manual for your machine and may be ordered from your dealer.

See Figure 2 for safety decal locations.

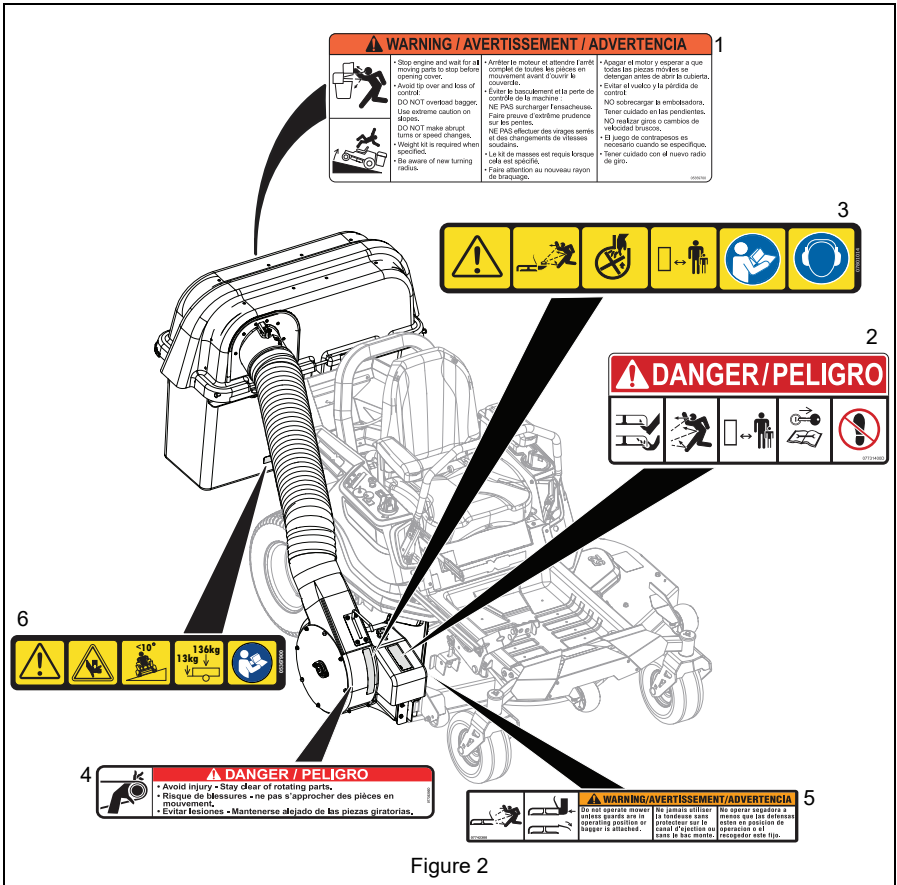

Figure 2

Safety Decal Descriptions

1. WARNING!



Stop engine and wait for all moving parts to stop before opening cover.



Avoid tip over and loss of control:

DO NOT overload bagger.
Use extreme caution on slopes.

DO NOT make abrupt turns or speed changes.

- Weight kit is required when using bagger.
- Be aware of new turning radius.

2. CAUTION



Always keep feet and hands away from rotating parts.



Never direct discharge towards persons or property that may be injured or damaged by thrown objects.



Keep people away from unit while operating.



Shut off engine, remove key, and read manual before you adjust or repair unit.



NO STEP! Always keep feet away from rotating parts.

3. DANGER!



DANGER!



Discharge Hazard - NEVER operate unit without discharge chute in operating position. Thrown objects can cause injury or damage.



ROTATING FAN! Stop engine and remove key before clearing.
Wait for all moving parts to stop.



Keep children and others away from unit while unit is in operation.



Read and understand the operator's manual before operating unit.



ALWAYS wear adequate hearing protection.

4. DANGER



AVOID INJURY. Stay clear of rotating parts.

5. WARNING



Do not operate mower unless guards are in operating position or bagger is attached.

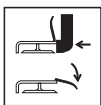

6. CAUTION



CAUTION! Avoid injury.



Pinch point. Keep hands away from moving parts. Moving parts can crush or cut.



DO NOT operate on slopes over 10°.



Maximum tongue weight:
13 kg (29 lb).
Maximum trailer weight:
136 kg (300 lb).



Read and understand the operator's manual before operating unit.

SAFETY INSTRUCTIONS

The following safety instructions are based on B71.1, B71.4 specifications of the American National Standards Institute and ISO 5395 in effect at the time of production.

Safe Practices for Ride-On Mowers

If used improperly, this machine is capable of amputating hands and feet and throwing objects. Failure to observe the following safety instructions could result in serious injury or death. Use only for purposes intended as set forth in the Operator's Manual. Other use is improper and may cause serious injury or death.

General Information

Read, understand, and follow instructions and warnings in this manual and on the machine, engine and attachments.

Only allow operators, who are responsible, trained, familiar with the instructions, and physically capable to operate the machine.

DO NOT carry passengers and keep people or pets away from the mowing area.

DO NOT operate the machine while physically or mentally impaired, feeling tired, ill or under the influence of alcohol or drugs.

Follow the manufacturer's recommendation for wheel weights or counterweights.

DO NOT touch parts which are hot. Allow parts to cool.

Preparation Before Operating

Inspect unit before each use for missing or damaged decals and shields, correctly operating safety interlock system, ROPS and deterioration of grass catchers. Replace or repair as needed.

Clear the operating area of all objects which could be thrown by or interfere with operation of the machine.

Keep the area of operation clear of all bystanders, particularly small children. Stop the machine and attachment(s) if anyone enters the area

DO NOT operate the machine without the entire grass catcher, discharge chute, or other safety devices in place and functioning properly. Check frequently for signs of damage, wear or deterioration and replace as needed.

NEVER tamper with safety devices. Check their proper operation regularly. NEVER do anything to interfere with the intended function of a safety device or to reduce the protection provided by the safety device.

Check parking brake operation frequently. Adjust and service as required.

Wear appropriate personal protective equipment such as safety glasses, hearing protection, and substantial footwear. DO NOT mow barefoot or while wearing sandals.

Operating

Improper use of power equipment can cause serious permanent injury or death to the operator or a bystander. Understand:

- How to operate all controls
- The functions of all controls
- How to STOP in an emergency
- Braking and steering characteristics
- Turning radius and clearances

If the operator or the mechanic cannot read the manual, it is the owner's responsibility to explain it to them. Manuals are available in other languages at www.ariens.com.

Only run the engine in well ventilated areas. Exhaust gases contain carbon monoxide, an odorless deadly poison.

Only operate the machine in daylight or good artificial light.

Avoid holes, ruts, bumps, rocks and other hazards. Uneven terrain could overturn the machine, or cause operator to lose their balance, footing and/or control of the mower.

DO NOT put hands or feet near rotating parts or under the machine. Keep clear of the discharge opening at all times.

Avoid slippery surfaces. ALWAYS be sure of your footing.

Stop engine before removing grass catcher or unclogging chute.

DO NOT direct discharge material toward anyone. Avoid discharging material against a wall or obstruction. Material may ricochet back toward the operator. Stop the blade(s) when crossing gravel surfaces. DO NOT mow into roads or across sidewalks.

DO NOT leave a running machine unattended. ALWAYS park on level ground, disengage the attachment, set parking brake, stop engine and remove key (if applicable) before leaving the operator's position.

DO NOT mow in reverse unless absolutely necessary. ALWAYS look down and behind before and while backing.

Lightning can cause severe injury or death. If lightning is seen or thunder is heard in the area, DO NOT operate the machine; seek shelter.

If you strike a foreign object, stop and inspect the machine. Repair, if necessary, before restarting.

ALWAYS check overhead and side clearances carefully before operation. Keep in mind that your mower deck may be wider than your track width.

Children Specific

Tragic accidents can occur if the operator is not alert to the presence of children. Children are often attracted to the machine and the mowing activity. NEVER assume that children will remain where you last saw them.

Keep children out of the operating area and under the watchful care of a responsible adult other than the operator.

Do not carry children, even with the blade(s) shut off. Children could fall off and be seriously injured or interfere with safe machine operation. Children who have been given rides in the past could suddenly appear in the mowing area for another ride and be run over or backed over.

DO NOT allow children under the age of 18 to operate any outdoor power equipment.

Slope Specific

Slopes are a major factor related to accidents. Operation on slopes requires extra caution. If you feel uneasy on a slope DO NOT mow it. Use the parking brake for emergency stops.

DO NOT operate on slopes of more than 15°.

Do not mow within 1.2 M (4 feet) of a drop off. Do not mow within 1.2 M (4 feet) of a pond or other waterway.

The primary hazard of slope operation is loss of control and/or roll over.

Mow up and down slopes, NEVER across. Exercise caution when changing direction on slopes. Use caution while operating near dropoffs.

Avoid mowing wet grass. Wet surfaces can cause a loss of traction and control.

DO NOT operate machine under any condition where traction, steering, or stability is in question. Tires could slide even if the wheels are stopped.

Always keep the machine in gear when going down slopes. Do not coast downhill.

Avoid starting and stopping on slopes. Avoid making sudden changes in speed or direction. Make turns slowly and gradually.

Use extra care while operating machine with a grass catcher or other attachment(s). They can affect the stability of the machine.

Fire and Fuel Specific

Extinguish all cigarettes, cigars, pipes and other sources of ignition.

Use only an approved fuel container.

DO NOT remove fuel cap or add fuel with the engine running or while hot.

DO NOT refuel indoors or in enclosed spaces.

DO NOT store the machine or fuel container, or refuel, where there is an open flame, spark, or pilot light such as on a water heater or other appliance.

If fuel is spilled, DO NOT attempt to start the engine and avoid creating any source of ignition until fuel vapors have dissipated.

To help prevent fires: keep machine free of grass, leaves, or other debris build up; clean up oil or fuel spillage and remove any fuel soaked debris; allow engine to cool before storing.

Use extra care in handling gasoline and other fuels. They are flammable and vapors are explosive.

Hauling

Use a single full-width ramp for loading and unloading a machine for transport. Secure with appropriate straps.

Towing

Follow the manufacturer's recommendation for weight limits for towed equipment and towing on slopes.

Service

Keep machine in good working order. Replace worn or damaged parts.

Use caution when servicing blades. Wrap the blade(s) or wear gloves. Replace damaged blades. DO NOT repair or alter blade(s).

Disconnect spark plug wire(s) and the negative battery cable before making any repairs.

Use only attachments recommended by AriensCo that are appropriate to your use and can be used safely in your application.

The use of non-genuine replacement parts or accessories could adversely affect machine operation and safety.

DO NOT change engine governor setting or overspeed the engine.

ASSEMBLY



WARNING: AVOID INJURY.
Read and understand the entire *Safety* section before proceeding.

Remove contents from carton carefully. Place bagger hood and frame parts on a flat piece of cardboard to avoid scratching.

Package Contents:

Check the contents of your kit for the parts listed below. See Figure 3.

Item	Description	Qty	Part Number
1	1/4"-20 x 3/4" Round Head Square Neck Bolt	1	06200307
2	Belt Cover Bracket (Model 815045)	1	04865451
3	Belt Cover Bracket (Models 815048, 815049)	1	05137051
4	1/4"-20 Hex Top-Lock Flange Nut	1	06500903
5	3/8" x 1 1/2" Flat Steel Washer	3	06401028
6	Clamping Knob	3	07534800
7	Sheave Adapter	1	05273100
8	V-Pulley (Models 815045, 815048) V-Pulley (Model 815049)	1 1	07344900 07349700
9	1/4" Locking Washer	2	06401009
10	1/4"-20 x 1/2" Hex Bolt	2	05901705
11	5/16"-18 x 1" Grade 8 Hex Bolt	1	05901802
12	5/16"-18 Hex Jam Nut	2	06500909
13	11/16" x 1 3/4" Flat Steel Washer	1	06401032
14	5/16"-18 x 3/4" Tapping Screw	2	07400127
15	Blower Assembly	1	51514700

Item	Description	Qty	Part Number
16	V-Belt (52" Deck)	1	07200042
	V-Belt (42" Deck)	1	07210200
	V-Belt (48" Deck)	1	07200905
	V-Belt (60" Deck)	1	07200728
17	Belt Cover (Model 815045)	1	51586500
	Belt Cover (Model 815048)	1	51536400
	Belt Cover (Model 815049)	1	51532000
18	20 1/2" 25-degree Mower Blade (Model 815049)	3	04964800
19	5/16" x 1 1/2" Round Head Square Neck Bolt	1	06200233
20	Hitch	1	71514900
21	Trailer Hitch Decal	1	05367900
22	Bagger Mount Post	1	04795751
23	Studded Wing Knob	1	07500226
24	1/2"-13 x 2 3/4" Hex Bolt	1	05901836
25	1/2" x 1 1/4" Flat Steel Washer	1	06401015
26	Hood Assembly	1	51577800
27	3/8"-16 x 1" Round Head Square Neck Bolt	2	06200235
28	3/8"-16 Jam Nut	1	06500910
29	Support Strap	1	05172651
30	3/8"-16 Wing Nut	1	06502300
31	3/8" x 3/32" Lock Washer	1	06300116
32	3/8"-16 Locking Top Flange Nut	7	06500822
33	Bag Frame	2	00663200
34	Mesh Bag	2	03862900
35	Weight Bracket	1	04850851
36	3/8"-16 x 3/4" Round Head Square Neck Bolt	6	06200312
37	Weight Plate	6	04850951

38	1/2"-13 Locking Nylon Flange Nut	2	06500907
39	1/2"-13 x 2 1/4" Hex Bolt	2	05901835
40	56" Hose	1	05284100
41	3/8" x 1/2" x 3" Plastic Tube	2	00677000
42	1/2" x 1" Flat Steel Washer	1	06401112
43	7/16" x 1" x 3/32" Flat Steel Washer	1	06401008

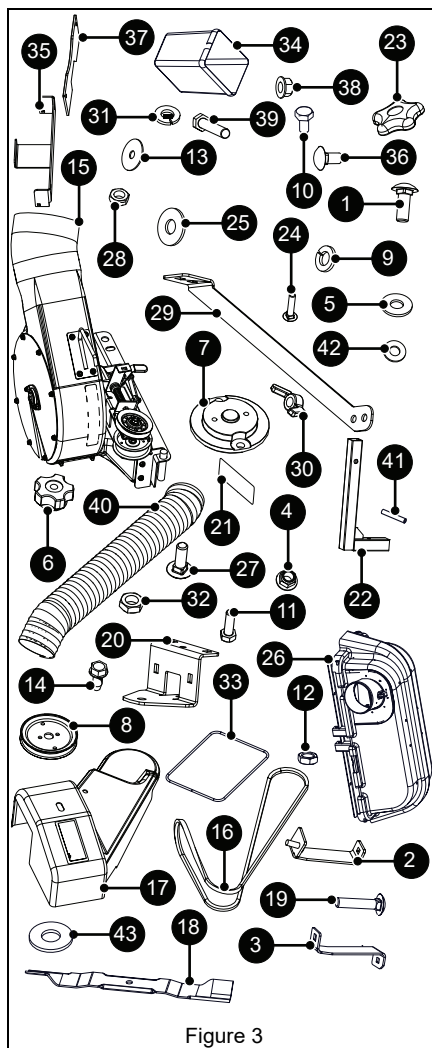

REMOVAL

1. Stop engine, remove key and engage parking brake. Wait for moving parts to stop and for hot parts to cool.
2. Disconnect spark plug wires.



WARNING: Always chock wheel and know all jack stands are strong and secure and will hold weight of unit during maintenance.



WARNING: Do not operate machine without the entire grass catcher, discharge guard, belt guard, or other safety protective devices in place and working.

3. Raise the front of the unit to gain access to the underside of deck. Securely support the unit.
4. Remove two 5/16" hex nuts retaining discharge chute and remove assembly. Retain all parts for operation without bagger. See Figure 4.

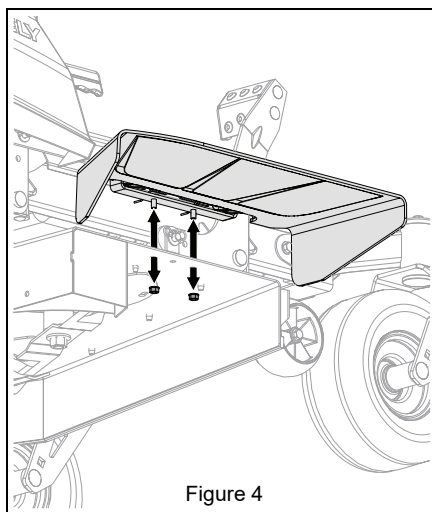

5. *All Decks Except 60"*: Remove three 1/4" tapping screws retaining belt cover and remove belt cover. Retain all parts for operation without bagger. See Figure 5.

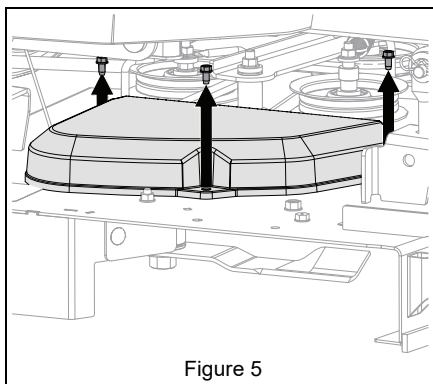

Figure 5

6. *60" Decks Only*: Remove three 3/8" center locking flange nuts retaining belt cover and remove belt cover. Retain all parts for operation without bagger. See Figure 6.

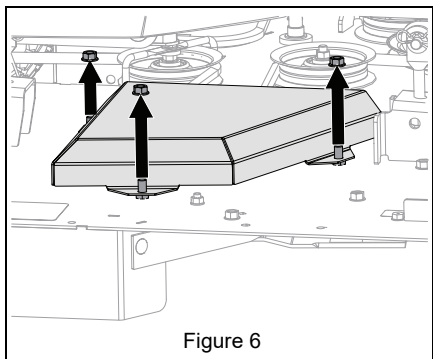

Figure 6

Remove Mower Blades (Model 815049)



CAUTION: Rotating one blade will cause all blades to rotate. Mower blades are sharp. Use heavy gloves or cover blades with tape.

1. Remove and retain hex nuts and Belleville washers retaining mower blades. Note orientation of washers for installation. Retain blades for operation without bagger. See Figure 7.

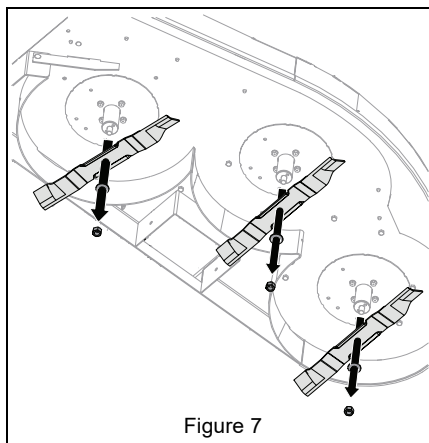

Figure 7

INSTALLATION

Install Mower Blades (Model 815049)



CAUTION: Rotating one blade will cause all blades to rotate. Mower blades are sharp. Use heavy gloves or cover blades with tape.

See Figure 8.

1. Install three 25-degree blades (item 18) using hardware removed earlier. Ensure concave side of washer faces mower blade.
2. Using a sturdy block of wood or other suitable device, block blades from turning and torque nuts to 136 N•m – 163 N•m (100 lb-ft – 120 lb-ft).

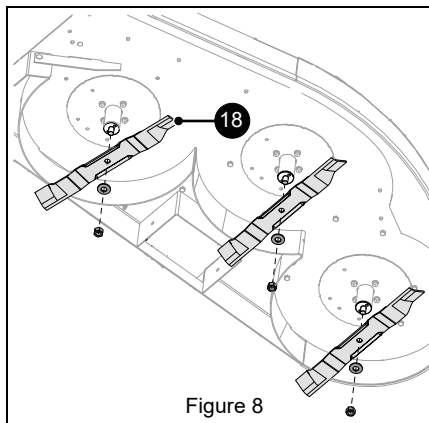

Figure 8

Install Drive Pulley

See Figure 9.

1. Align holes of bagger sheave adapter (item 7) with holes in spindle pulley and position adapter on sheave. The cupped surface in the adapter faces down.
2. Retain the adapter with two 5/16" x 3/4" tapping screws (item 14).



CAUTION: Rotating one blade will cause all blades to rotate. Mower blades are sharp. Use heavy gloves or cover blades with tape.

3. Using a sturdy block of wood or other suitable device, block blades from turning and tighten tapping screws. Torque to 28.6 N•m (21 lb-ft).

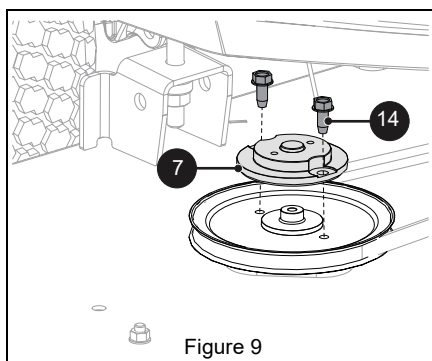

Figure 9

See Figure 10.

4. Position V-pulley (item 8) on adapter and retain with two 1/4" locking washers (item 9) and two 1/4" x 1/2" hex bolts (item 10).
5. Torque hex bolts to 9.5 N•m (7 lb-ft).

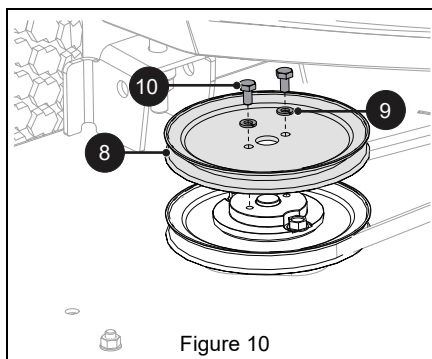

Figure 10

Install Belt Cover Support

Model 815049

1. Install 5/16" x 1 1/2" round head square neck bolt (item 19) through belt cover bracket (item 3) with 5/16" hex jam nut (item 12) and 7/16" x 1" x 3/32" flat steel washer (item 43). Bolt is installed in tab without trimmed corner. See Figure 11.

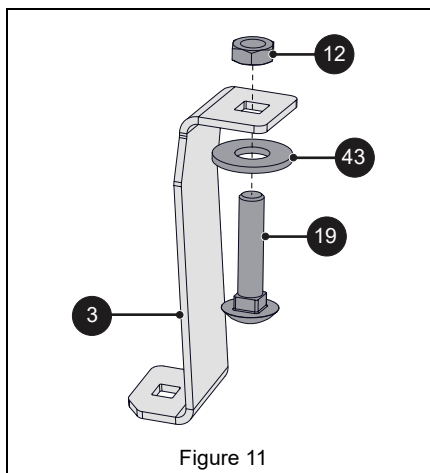

Figure 11

2. Locate 9/32" square hole near discharge opening and remove 5/16" self-tapping screw (if present). Attach belt cover bracket at angle shown using one 1/4" x 3/4" round head square neck bolt (item 1) and one 1/4" top lock flange hex nut (item 4). See Figure 12.

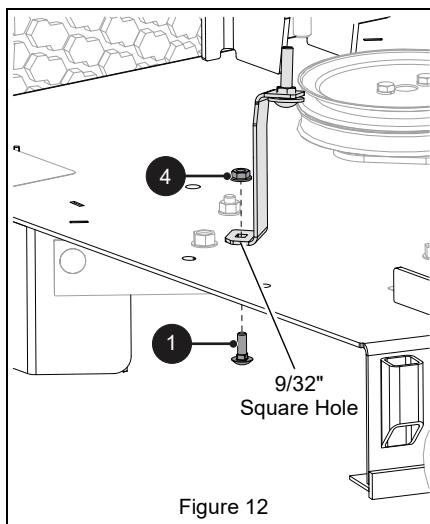
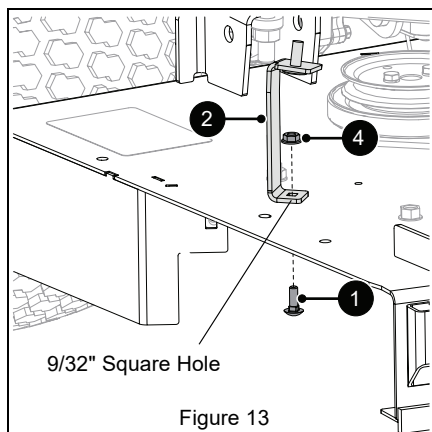

Figure 12

Models 815045, 815048

1. Locate 9/32" square hole near discharge opening and remove 5/16" self-tapping screw (if present). Attach belt cover bracket (item 2) at angle shown using one 1/4" x 3/4" round head square neck bolt (item 1) and one 1/4" top lock flange hex nut (item 4). See Figure 13.



Install Rear Blower Mount

1. From under deck install one 5/16" x 1" hex bolt (item 11) and secure with one 5/16" hex jam nut (item 12). See Figure 14.

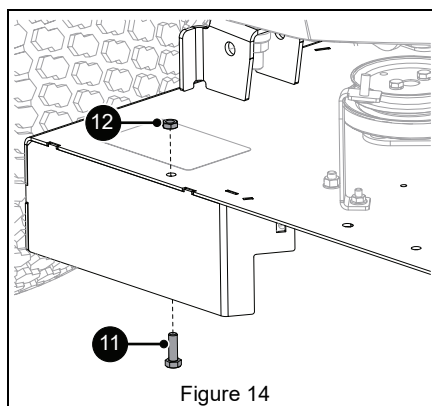

Install Blower Assembly

1. Grasp the blower assembly (item 15) by the handle and insert the front pin into the square tube on the front corner of the deck. Rotate the blower assembly in until the hole in the bracket aligns with the rear mounting stud and lower the blower over the stud. See Figures 15 and 16.

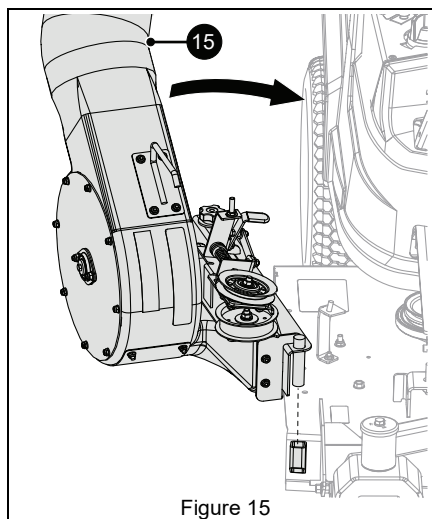

2. Secure the blower assembly to the deck with one 11/16" x 1 3/4" flat washer (item 13) and one clamping knob (item 6). See Figure 16.

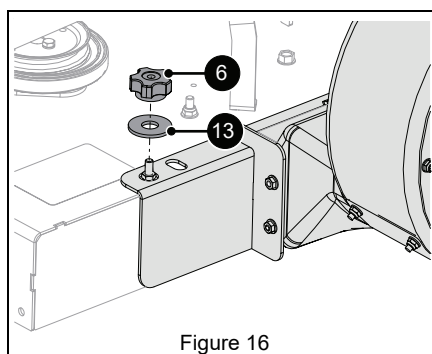

Install Drive Belt

1. Rotate the idler assembly lever to the rear and down until it locks in the down position and fully retracts the idler pulley. See Figure 17.

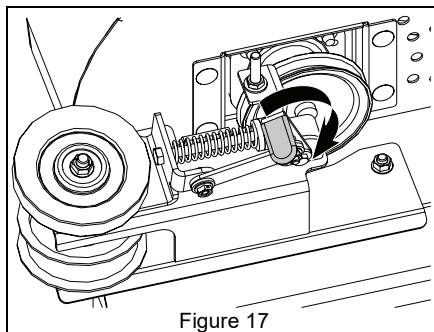

Figure 17

2. Determine the appropriate belt based on mower deck size. The part number is printed on the belt.

52" Decks	07200042
42" Decks	07210200
48" Decks	07200905
60" Decks	07200728

3. Route belt (item 16) over spindle sheave, idler pulleys and blower drive pulley. See Figure 18. for belt routing.

IMPORTANT: Ensure that belt is routed correctly or blower will not operate correctly.

Position "V" side of V-belt in "V" in pulley.

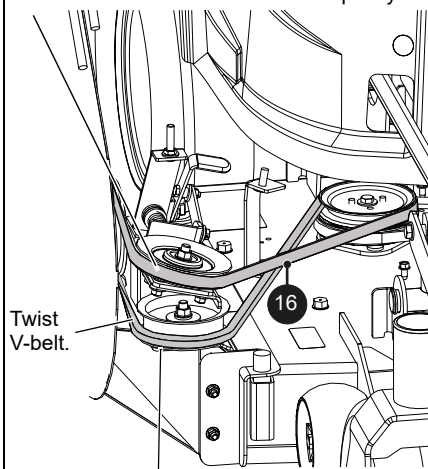

Position flat side of V-belt against idler.

Figure 18

4. Rotate the idler assembly lever up and forward to place tension on the belt. See Figure 19.

IMPORTANT: There must be tension on the belt for the blower to operate.

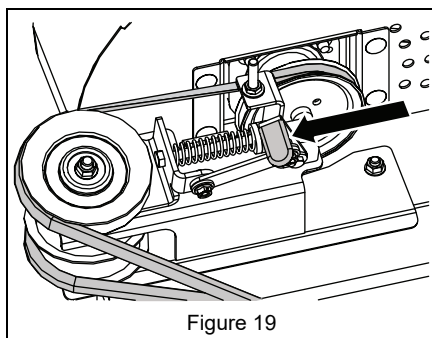

Figure 19

Install Belt Cover

1. Install one 3/8" x 1 1/2" flat washer (item 5) on belt cover bolt on blower assembly. See Figure 20.

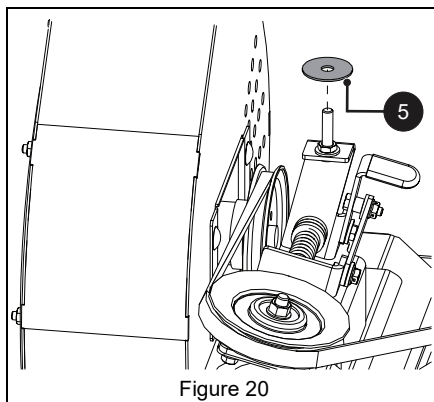

Figure 20

2. Position belt cover (item 17) over deck and idler assembly and secure with two 3/8" x 1 1/2" flat washers (item 5) and two clamping knobs (item 6). See Figure 21.

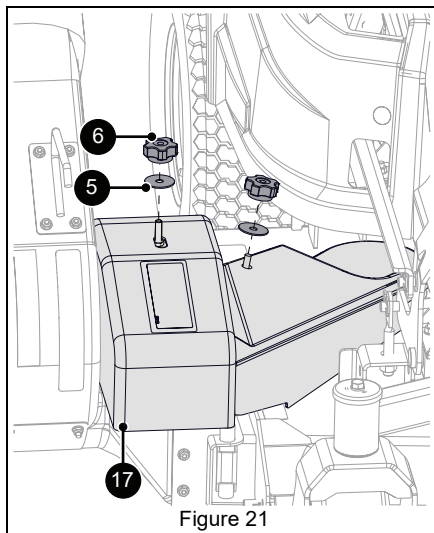

Figure 21

INSTALL GRASS BAG ASSEMBLY

Install Trailer Hitch

1. Install hitch (item 20) onto back of frame with four 3/8" x 3/4" round head square neck bolts (item 36) and 3/8" locking top flange nut (item 32). See Figure 22.

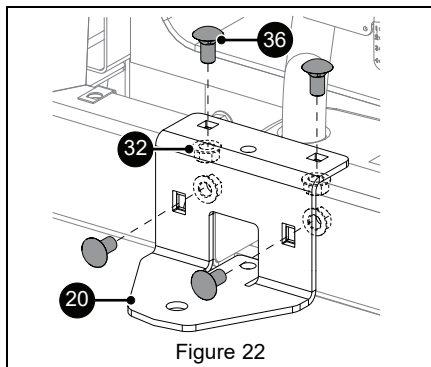

Figure 22

2. Clean bumper surface and install trailer hitch decal (item 21) next to hitch. See Figure 23.

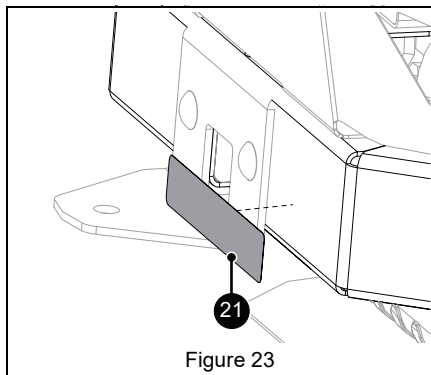
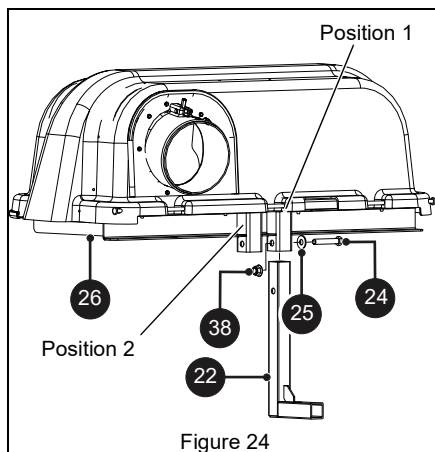

Figure 23

Install Mount Post

1. Insert mount post (item 22) into hood assembly (item 26) pocket position 1 and secure with one 1/2" x 2 3/4" hex bolt (item 24), one 1/2" x 1 1/4" flat washer (item 25) and one 1/2" locking nylon flange nut (item 38). See Figure 24.



2. Insert mount post into pocket in rear bumper and secure with studded wing knob (item 23). See Figure 25.

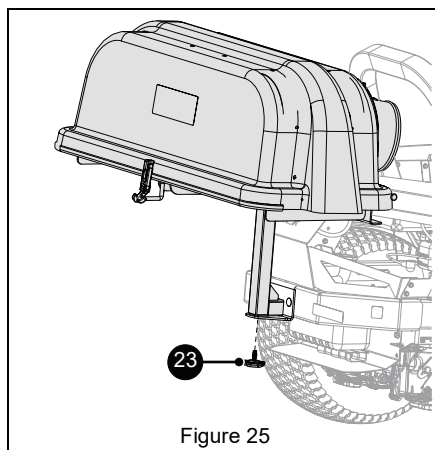

Install Support Strap

See Figure 26 and 27.

1. Mount lower end of support strap (item 29) to frame using one 3/8" wing nut (item 30), 3/8" x 3/32" lock washer (item 31), 3/8" jam nut (item 28), 1/2" x 1" flat steel washer (item 42) and 3/8" x 1" round head square neck bolt (item 27).

NOTICE: Mount support strap (item 29) outside the frame for Gravely models and inside the frame for Ariens models.

NOTICE: It may be necessary to enlarge hole in frame to fit 3/8" mounting bolt. Drill hole using a 13/32" drill.

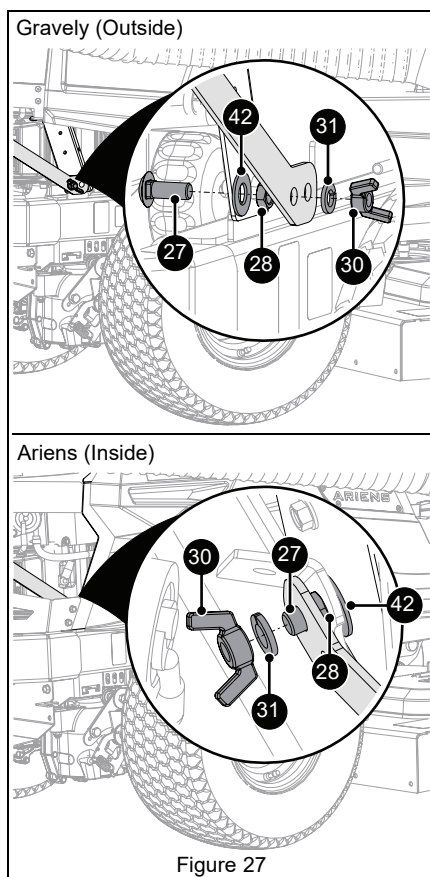
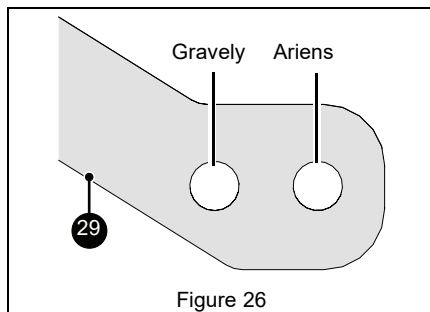

2. Mount upper end of support strap to hood assembly using one 3/8" x 1" round head square neck bolt (item 27) and one 3/8" locking top flange nut (item 32). Ensure hardware is installed in correct hole. See Figure 28.

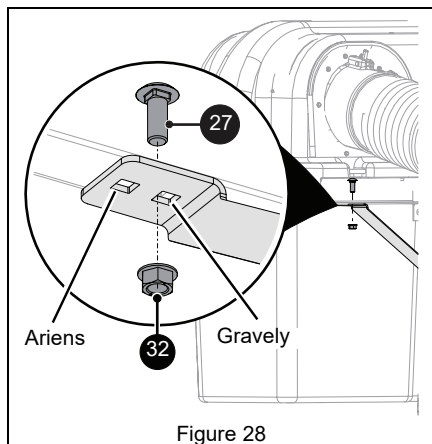

Figure 28

INSTALL BAGGER HOSE

Cut Hose

1. Position bagger hose (item 40) and cut to length if specified in Figure 29.

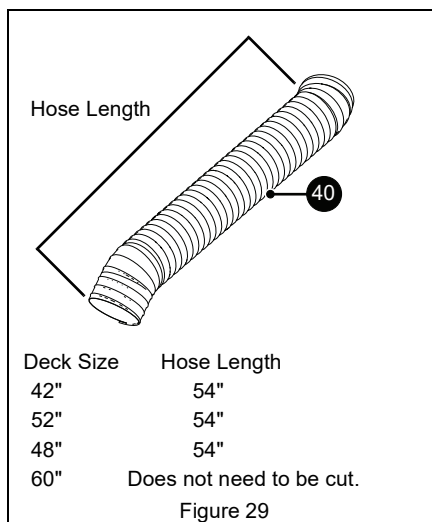

Figure 29

Install Hose

See Figure 30.

1. Install hose fully on blower hose adapter.
2. Open latch on inlet on hood assembly and install hose on inlet. Close latch, making sure that latch attaches to one rib of hose.

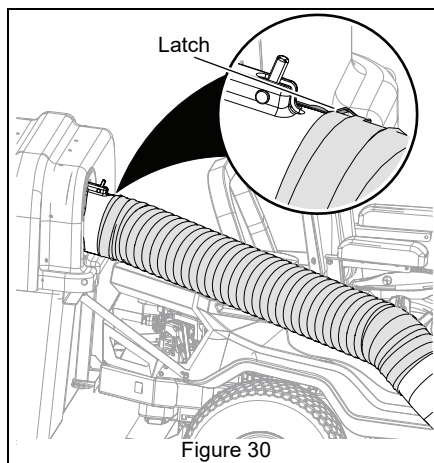

Figure 30

Assemble Mesh Bags

See Figure 31.

1. Install two mesh bags (item 34) onto two bag frames (item 33) by routing the bag frames in the open end of the mesh bags.
2. Install plastic tube (item 41) on both ends of each bag frame and push ends together.



Figure 31

Install Mesh Bag Assemblies

1. Install mesh bag assemblies to hood assembly frame. The smooth heat-resistance surfaces of the mesh bags must face the engine. Close the hood and connect rubber latch. See Figure 32.

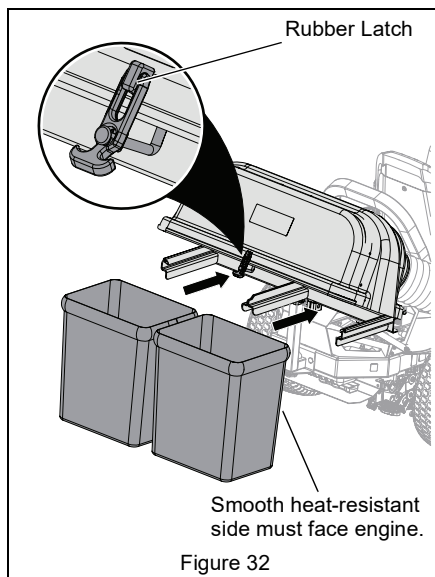

Figure 32

Install Weights



CAUTION: Always install weights on front of mower before operating unit with bagger attached. Always remove weights from front of mower when bagger is removed from the unit.

1. Install weight bracket (item 35) onto frame using two $\frac{3}{8}$ " x $\frac{3}{4}$ " round head square neck bolts (item 36) and two $\frac{3}{8}$ " locking top flange nuts (item 32). See Figure 33.

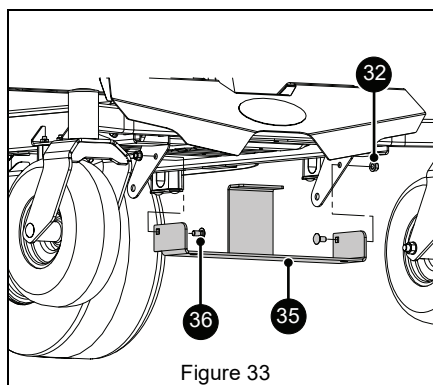

Figure 33

2. Insert six weight plates (item 37) into weight bracket and secure with two $\frac{1}{2}$ " x $2 \frac{1}{4}$ " hex bolts (item 39) and two $\frac{1}{2}$ " locking top flange nuts (item 38). See Figure 34.

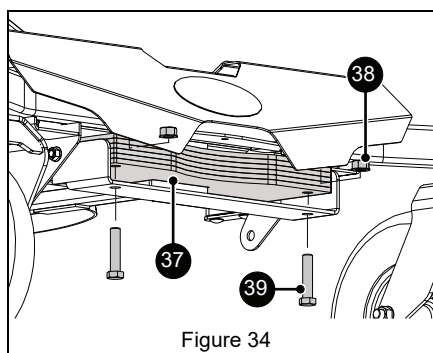

Figure 34

REMOVAL



WARNING: AVOID INJURY.
Read and understand the entire *Safety* section before proceeding.

1. Release thumb latch retaining hose to hood assembly and remove hose from hood assembly and blower adapter. See Figure 30.
2. Remove mesh bags from hood assembly. See Figure 32.
3. Remove 3/8" wing knob retaining support strap and pull strap away from support pin. Do not remove support pin.
4. Remove wing knob from bottom of mount post and remove hood assembly from unit. It is not necessary to remove hitch. See Figure 25.
5. Remove belt cover from mower deck and blower and idler assembly. See Figure 21.
6. Release tension from V-belt and remove V-belt from blower and deck spindle. See Figure 17.
7. Remove blower assembly. See Figures 15 and 16.
8. *Model 815049 Only:* Reinstall original mower blades. See Figure 7.
9. Install right belt cover on mower deck. It is not necessary to remove sheave adapter. See Figures 5 and 6.



CAUTION: Deflected material may cause injury. ALWAYS operate mower with hood assembly closed and secured, blower assembly fastened securely, or with chute deflector in operating position.



CAUTION: Always install front weights before operating unit with bagger attached. Always remove front weights when bagger is removed from the unit.

10. Remove weights and hardware and retain. It is not necessary to remove weight bracket. See Figure 34.

11. Ensure that mesh bags are empty, clean and dry before storing.

OPERATION



WARNING: AVOID INJURY.
Read and understand the entire *Safety* section before proceeding.

BEFORE EACH USE

1. Check bagger parts for wear, deterioration or damage. Only replace with original service parts before operating.
2. Make sure front weights are installed.
3. Ensure all hardware is tight.

IMPORTANT: Check hardware often. Tighten as needed.

4. Remove any grass buildup from bagger parts.
5. Ensure hose is installed securely on hood assembly and blower adapter.
6. Ensure mesh bags are installed and the hood assembly is closed and secure latched.

BAGGING

Starting

1. Start engine and engage PTO according to unit owner's manual.
2. Set throttle to full speed.
3. Set mower deck height.
4. Choose a slow ground speed.

Stopping

1. Allow the mower blades to run for at least 30 seconds to clear blower assembly and hose of debris.
2. Disengage PTO.
3. Stop unit according to unit Owner/Operator's manual.



WARNING: Lower attachment, stop engine, and remove key to prevent unauthorized use. DO NOT park on slopes.

AIRFLOW INDICATOR

See Figure 35.

When the airflow indicator is pointed straight up, the air is restricted which indicates one or more possible problems:

- The mesh bags are full and need to be emptied. See *Emptying Mesh Bags* on page 19.
- There is a clog in the bagger. See *Unclog Bagger* on page 19.

When the airflow indicator is facing forward, the air is unrestricted indicating that the mesh bags are not full and there are no clogs in the bagger.

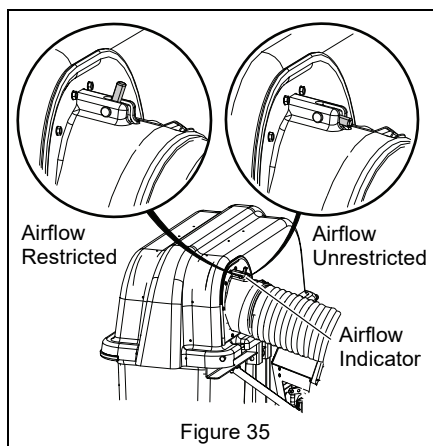

EMPTYING MESH BAGS

If bagger stops picking up grass clippings, the mesh bags are likely full.



WARNING: NEVER open hood assembly while the engine is running and the PTO is engaged. ALWAYS shut off engine before emptying mesh bags.

To empty mesh bags:

1. Disengage PTO, stop engine and remove ignition key. Wait for all moving parts to stop before leaving operator's position.
2. Disconnect rubber latch and open hood.
3. Remove each mesh bag from hood assembly.
4. Empty the grass from each mesh bag.



CAUTION: MAKE SURE the heat-resistant smooth surface of the mesh bags are facing the engine.

5. Install mesh bag on hood assembly with the heat-resistant smooth surface of the bags facing the engine.
6. Close and latch hood assembly.

UNCLOG BAGGER



WARNING: MOVING PARTS can cut or amputate body parts. NEVER attempt to clear blower assembly while engine is running. ALWAYS stop engine, remove key, and wait for moving parts to stop. Sharp edges can cut. Movement of parts can cut off fingers or a hand. Wrap blade(s), wear sturdy gloves and use extreme caution when working near blades or impeller.



WARNING: PINCH POINT! Use extreme caution when unclogging blower assembly. Impeller can cut or pinch your hand, even when not in operation. Wear sturdy gloves when working near impeller.

If hose or blower assembly becomes clogged, stop forward motion and allow unit to clear itself. If unit will not clear itself, unclog the hose and/or blower assembly manually:

1. Stop engine and remove ignition key. Wait for all moving parts to stop.
2. Open the latch retaining hose to bagger inlet and disconnect hose.
3. Remove hose from blower assembly.
4. Remove grass from clogged area.
5. Reinstall hose.

NOTE: Perform steps 6 and 7 if clog is in blower assembly.



WARNING: Blades rotate when impeller rotates. Impeller rotates when blades rotate. Block blades to prevent rotation before proceeding.

6. Clear grass from blower assembly.
7. Reinstall hose and tighten hose clamp.

OPERATING TIPS

IMPORTANT: Do not remove more than 3.2 cm (1 1/4") of grass when bagging.

- Cut grass when it is dry.
- Cut grass in two passes when cutting thick, long, or wet grass. Make the first cut higher than desired. Make the second cut at desired height.
- Always use full throttle when bagging.
- Adjust ground speed as necessary to allow the bagger to pick up clippings.

MAINTENANCE



WARNING: AVOID INJURY. Read and understand the entire *Safety* section before proceeding.

Your Ariens dealer can provide service and adjustments to keep your unit operating at peak efficiency.

Contact an authorized engine manufacturer's service center for engine service.

MAINTENANCE SCHEDULE

Service Performed	Each Use	Every 10 hrs.
Check Front Weight	•	
Check Hose	•	
Check Mesh Bags	•	
Check Fasteners	•	
Inspect Bagger Parts	•	
Clean Unit	•	
Check V-Belt		•

Replace V-Belt

1. Remove belt cover.
2. Release belt tensioner.
3. Remove belt from spindle pulley and blower assembly.
4. Install new V-belt. See *Install Drive Belt* on page 13.
5. Reinstall belt cover.

STORAGE



WARNING: AVOID INJURY. Read and understand the entire *Safety* section before proceeding.

IMPORTANT: NEVER spray unit with high-pressure water. DO NOT store unit outdoors.

- Clean plastic surfaces with sponge and mild detergent. Dry with a soft cloth.
- Remove all debris from hopper before storing.
- Remove all dirt, grease, leaves, etc. from unit.
- Store in a clean, dry area.
- Ensure all fasteners are properly tightened. Inspect moving parts and belts for damage and wear.
- Touch up all rusted or chipped painted surfaces.

TROUBLESHOOTING

Problem	Probable Cause	Correction
Airflow indicator points straight up.	Air flow is restricted.	Mesh bags are full See <i>Emptying Mesh Bags</i> on page 19.
		Bagger is clogged See <i>Unclog Bagger</i> on page 19.
Bagger fails to pick up grass or leaves.	The mesh bags are full.	Empty mesh bags See <i>Emptying Mesh Bags</i> on page 19.
	Bagger is clogged.	Unclog bagger See <i>Unclog Bagger</i> on page 19.
	V-belt not routed properly.	Ensure V-belt is correctly installed. See <i>Install Drive Belt</i> on page 13.
Blower assembly stops or slows.	Blower assembly clogged.	Unclog bagger See <i>Unclog Bagger</i> on page 19.
	V-belt is worn or damaged.	Replace V-belt.

SPECIFICATIONS

Model Number	815045	815048	815049
Description	42"/52" Bagger	48" Bagger	60" Bagger
Added Length to Unit – cm (in)	49.5 (19.5)		
Added Width to Mower Deck – cm (in)	29.2 (11.5)		
Added Weight to Mower – kg (lb)	62.6 (138)		
Capacity – bu (ft ³)	3.7 (4.6)		



ARIENS®

Outdoor Power Equipment Limited Warranty

AriensCo warrants to the **original purchaser** that Ariens brand products purchased on or after 9/1/2019 will be free from defects in material and workmanship for the time period noted in the chart below. Equipment put to personal use around a single household or residence is considered "Residential Use." Equipment put to any business use (agricultural, commercial, or industrial) or used at multiple locations is considered "Commercial Use." If any product is rented or leased, then the duration of these warranties shall be 90 days after the date of purchase.

An authorized Ariens dealer will repair any defect in material or workmanship, and repair or replace any defective part, subject to the conditions, limitations and exclusions set forth herein. Such repair or replacement will be free of charge (labor and parts) to the original purchaser; except as noted below. Pick-up and delivery are at the owner's expense.

The warranty code is found on the model and serial number identification label on the unit.

Warranty Code	Product Group	Warranty Period
AA	Serialized Attachments	1 Year.
CH	Zenith Mowers (Non-European Models)	4 Years or 750 Hours.*
CQ	Zenith Mowers (European Models)	2 Years.
HD	LM-Series Walk-Behind Mowers	3 Years Residential Use. 90 Days Commercial Use.
HE	Edge Mowers	2 Years or 150 Hours.*
HF	Ikon-XD Mowers	3 Years or 300 Hours.*
HH	Apex Mowers	4 Years or 500 Hours.*
PA	921-Series Brushes	3 Years Residential Use. 90 Days Commercial Use.
PB	926-Series Brushes	3 Years Residential Use. 1 Year Commercial Use.
SA	Professional Sno-Thro	3 Years Residential Use. 1 Year Commercial Use.
SB	Compact, Deluxe and Platinum Sno-Thro and Path-Pro	3 Years Residential Use. 90 Days Commercial Use.
SC	S18	2 Years Residential Use. 90 Days Commercial Use.
SD	Deluxe and Platinum EFI Sno-Thro	3 Years Residential Use. 90 Days Commercial Use.
SE	920-Series Classic Sno-Thro	3 Years Residential Use. 90 Days Commercial Use.

* Whichever comes first.

Special Extensions

The chart below details special **extensions** to warranty terms. Warranty terms are total time periods covered. If any product is rented or leased, there are no extensions to the 90-day warranty.

Warranty Code	Warranty Term Extension	Warranty Period
SA	Cast Iron Auger Gear Case	5 Years.
SB, SD	Cast Iron Auger Gear Case	5 Years Residential Use. 1 Year Commercial Use.
SE	Aluminum Auger Gear Case	3 Years Residential Use. 90 Days Commercial Use.



Exclusions and Limitations

The charts below detail special **exclusions and limitations** to this warranty.

Warranty Term Exclusions	Warranty Period
Air filters, auger paddles, brake arms, brake linings, brake shoes, brushes, cutters, fuel filters, headlights, knives, light bulbs, lubricants, mower blades, oil, oil filters, spark plugs, scraper blades, shear bolts and skid shoes.	Components are not covered under warranty.

Hydro-Gear Transaxle Limitation
See Hydro-Gear warranty. The warranty is administrated by AriensCo. Refer to www.ariens.com for warranty statement.

Warranty Term Limitations	Warranty Period
Cloth, Plastic and Rubber Components. Mufflers, Tires and Belts.	Components are covered for manufacturer's defect only, not wear.

Exclusions – Items Not Covered by This Warranty

- Parts that are not genuine Ariens service parts are not covered by this warranty and may void the warranty if the parts result in premature wear or damage to the product.
- Damages resulting from the installation or use of any part, accessory, or attachment which is not approved by AriensCo for use with product(s) identified herein are not covered by this warranty.
- Any misuse, alteration, improper assembly, improper adjustment, neglect, or accident which requires repair is not covered by this warranty.
- Repairs or adjustments required due to failure to use fresh fuel or failure to properly prepare the unit for periods of non-use.
- **Use of gasoline blends exceeding 10% ethanol voids any and all warranties.**
- **Any tampering with the hour meter voids any and all warranties.**
- Products are designed to the specifications in the area that the product was originally distributed. Different areas may have significantly different legal and design requirements. This warranty is limited to the requirements in the area in which the unit was originally distributed. AriensCo does not warrant this product to the requirements of any other area. Warranty service is limited to service within the area originally distributed.
- In countries other than the United States and Canada, contact the AriensCo dealer for warranty policies that govern within your country. Rights may vary from country to country and within any one country.

Evaporative Emissions Control Warranty Exception

As required by the California Air Resources Board (CARB) and the US Environmental Protection Agency (EPA) the evaporative emissions control system is warranted to the ultimate purchaser, and any subsequent owner, for two years.

The CARB and EPA evaporative emissions control system warranty is described in a separate evaporative emission control warranty statement.

Battery Warranty

Battery warranty is one year. Units used for rental or lease have no exceptions to the 90-day warranty. Total battery claim reimbursement will not exceed 45.00 USD.

Engines

The chart below details engine warranty information. Engine warranty terms may vary from the specific terms of this warranty. If inconsistent, the terms of the engine warranty shall apply to the engine and its component parts.

Engine Manufacturer	Detail
Ariens AX	Ariens-branded engines are warranted by the manufacturer and the warranty is administered by AriensCo. Refer to the engine manual or www.ariens.com for warranty statements.
Briggs & Stratton, Kawasaki, Kohler	Covered by the engine manufacturer's warranty. Refer to the engine manufacturer's warranty statements.

Parts and Accessories

Service replacement parts and non-serialized accessories are warranted for 90 days from date of purchase. Parts and accessories must be installed by an authorized Ariens dealer to be covered. Labor is not included.

Customer Responsibilities

Register the product immediately at the time of sale. If the dealer does not register the product, the customer must register the unit on-line at www.ariens.com.

To obtain warranty service, the **original purchaser** must:

- Ensure that the maintenance and adjustments explained in the Operator's Manual are routinely completed.
- Promptly notify AriensCo or an authorized Ariens service representative of the need for warranty service.
- Transport the product to and from the place of warranty service at owner's expense.
- Have the warranty service performed by an authorized Ariens service representative.

To find an authorized dealer use the dealer locator on our websites, or contact us by mail or phone.

Globally (Except Australia or New Zealand):	Australia:	New Zealand:
AriensCo 655 W. Ryan Street Brillion, WI 54110 Phone: (920) 756 - 4688 www.ariensco.com	Masport Australia Pty Ltd 27 Commercial Drive Dandenong South Victoria 3175 Australia Phone: 1300 366 225 www.masport.com.au	Masport Ltd 1-37 Mt. Wellington Highway, Panmure, Auckland 1060 New Zealand Phone: 0800 627 7678 www.masport.co.nz

Disclaimer

AriensCo may from time to time change the design of its products. Nothing contained in this warranty shall be construed as obligating the AriensCo to incorporate such design changes into previously manufactured products, nor shall such changes be construed as an admission that previous designs were defective.

Limitation of Remedy and Damages

AriensCo liability under this warranty, and under any implied warranty that may exist, is limited to repair of any defect in workmanship, and repair or replacement of any defective part. AriensCo shall not be liable for incidental, special, or consequential damages (including lost profits). Some states do not allow the exclusion of incidental or consequential damages, so the above limitation or exclusion may not apply to you.

Australian Consumer Law

The following applies solely to warranties subject to Subsection 102(1) of the Australian Consumer Law: Our goods come with guarantees that cannot be excluded by the Australian Consumer Law. You are entitled to a replacement or refund for a major failure and for compensation for any other reasonably foreseeable loss or damage. You are also entitled to have the goods repaired or replaced if the goods fail to be of acceptable quality and failure does not amount to a major failure.

Disclaimer of Further Warranty

AriensCo makes no warranty, express or implied, other than what is expressly made in this warranty. If the law of your state provides that an implied warranty of merchantability, or an implied warranty of fitness for particular purpose, or any other implied warranty, applies to AriensCo, then any such implied warranty is limited to the duration of this warranty. Some states do not allow limitations on how long an implied warranty lasts, so the above limitation may not apply to you.

This warranty gives you specific legal rights, and you may also have other rights which vary from region to region.



ARIENS



GRAVELY

655 West Ryan Street
Brillion, WI 54110

www.ariens.com
www.gravely.com

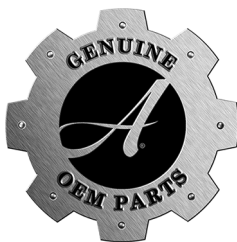

parts.ariens.com

ARIENS|CO

