

## 5 Maintenance

If you plan on not using the system for one week or longer, take out the filter and seal it with plastic wrap. Store the sealed filter in the fridge to protect the system against microbiological growth. To start the system again after the period of non-use, flush the system for at least 10 minutes OR change the filters.

If you will not use the system for two weeks or longer, disconnect the water supply, drain the system, and disconnect the power.

Follow the recommended filter replacement schedule. Replace the filter any time the indicator is on. Note that the actual filter life depends on the family size and water source quality. Failure to replace the filter at the appropriate times can damage the system and potentially cause health hazards.

### 5.1 Filter Cartridge Replacement



#### NOTICE

The life of the filter cartridges depends on the water volume used and the quality of the feed water. For the best performance, please change your filter cartridge according to the filter lifetime indicator or the filter replacement cycle suggested below. When there is a noticeable change in taste, odor, or flow of filtered water, we recommend changing the filters as well.

#### Filter Service Life Table

Filter	Recommended replacement cycle
PCF Filter	12 months/1000 gallons
RO Filter	36 months/3000 gallons

The actual lifetime of the filter cartridge depends on the local tap water quality and daily usage.

The recommended replacement cycle is an average based on different local tap water quality. If the local tap water quality is below the

average, the actual lifetime of the cartridge would differ from the recommended replacement cycle. If the filter cartridge is blocked, please replace it.

### Filter cartridge replacement

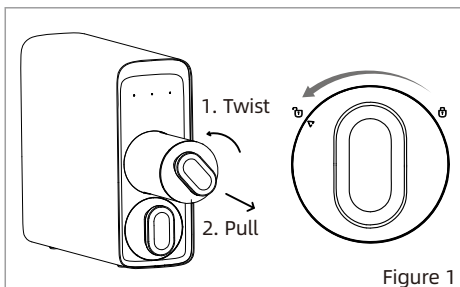

Figure 1

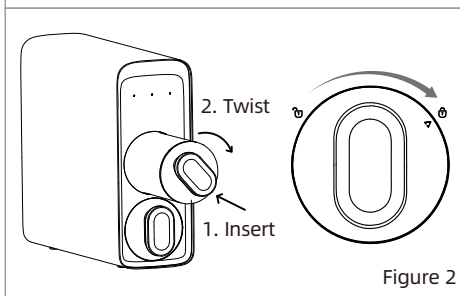

Figure 2

- Turn off the power and water supply before replacing the filter cartridges.
- Twist the filter that needs to be replaced anticlockwise and pull it out (Figure 1).
- Remove the packaging of the new filter and insert the cartridge in the system. Twist it clockwise to align the triangle icon on the filter cartridge with the lock icon on the system (Figure 2).
- Turn on the water supply and re-connect with power. If the RO filter is replaced, turn on the faucet and allow the water to run for 30 minutes. If the PCF filter is replaced, turn on the faucet and allow the water to run for 10 minutes
- Reset the filter lifetime, press and hold the reset button for 3 seconds. You will hear a beep, and the indicator will flash a constant blue light. The filter lifetime has been reset.

## 5.2 Automatic Flushing

While the system is flushing, the faucet indicator will flash blue light. The system will be flushed automatically in one of the following situations:

1. Flush for Power Restore

When power is restored after a blackout, the system will be forced to be flushed automatically for 30 seconds.

2. Flush for Accumulative Time per 24 hours

To maintain and extend the life expectancy of the filters, the system will be automatically flushed for 30 seconds per 24 hours.

The flush mode doesn't affect the user when taking water. If the user decides to take water during the flushing, the system will quit flushing and switch to dispensing.