

PRODUCT INSTRUCTION

AMKF180099-01

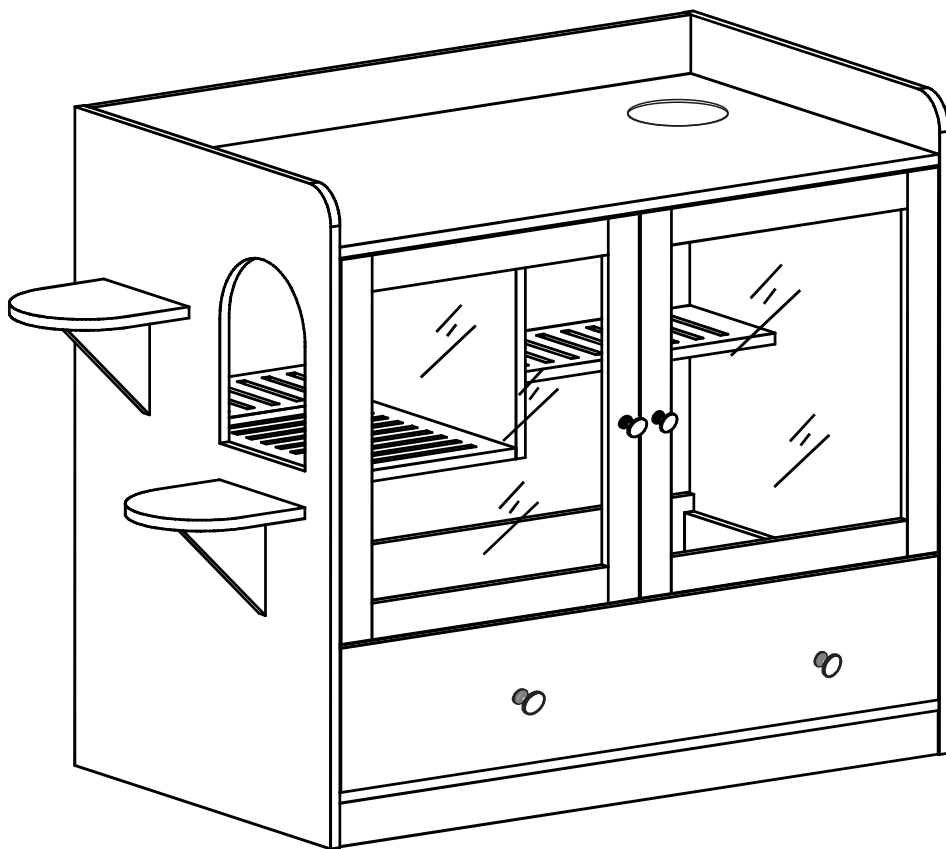

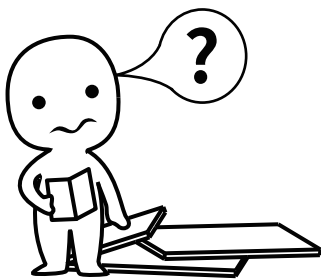

IMPORTANT INFORMATION!

please read the entire manual before starting to assemble and/or using this product. follow the manual thoroughly and keep it for further reference.

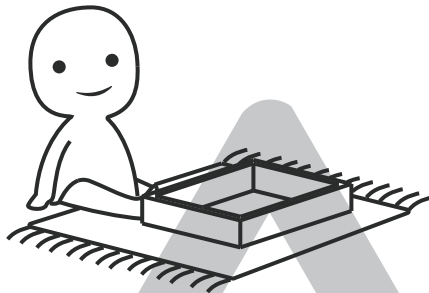
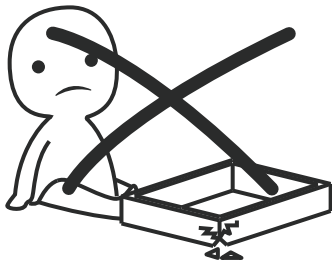

AVOID SCRATCHES!

In order to avoid scratching this furniture should be assembled on a soft layer-could be a rug.

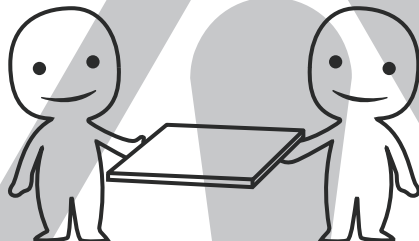

IMPROVE EFFICIENCY !

Try to find a partner to install with you, which can speed up the installation efficiency and shorten the time.

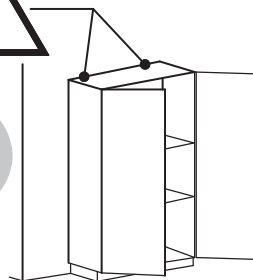
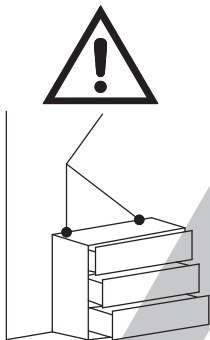

ANTI-TOPPLE WARNING !

Overturned furniture can cause serious or fatal crush injuries. To prevent tipping over, be sure to use the wall attachment, if not included with this product. Please purchase the wall attachment that fit your wall. If unsure, seek professional advice. Please read and follow each step of the instructions carefully.

IMPORTANT !

It is important that any product which is assembled using any kind of screw is re-tightened 2 weeks after assembly, and once every 3 months - in order to assure stability through-out the lifespan of the product.

For regular maintenance and cleaning of the product, for the frame, please use a rag dipped in neutral detergent to fully wipe it, and then dry it with a clean rag. For glass materials, wipe with a rag dampened with water glass cleaner, and then dry with a dry rag.

Do not use an electric screwdriver, and do not use too much force when installing, because the board is easy to break.

Parts List / Teileliste

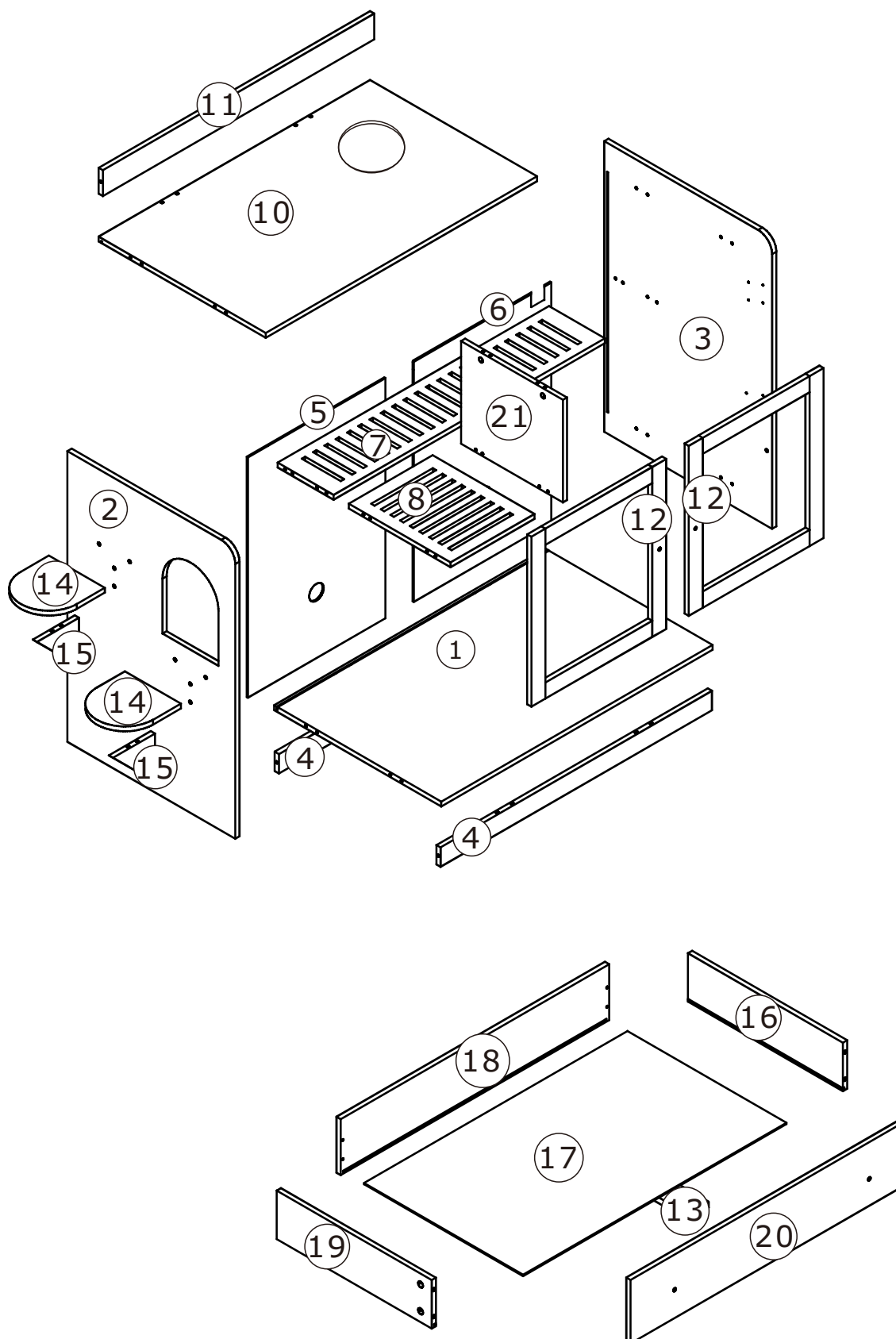

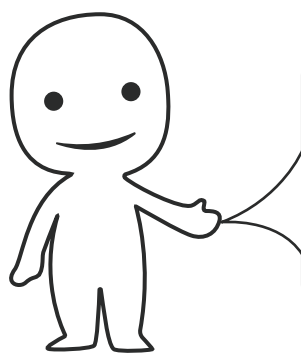

Please prepare the following tools

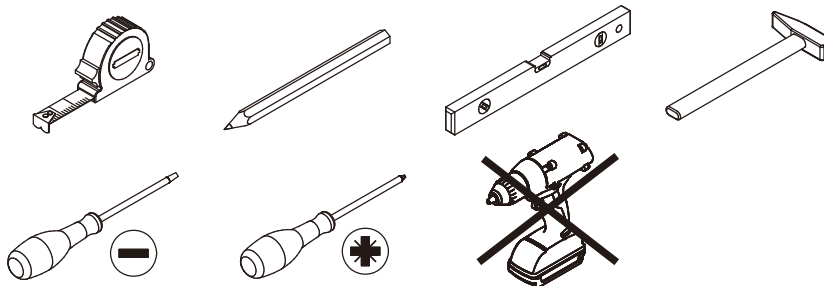

When installing, please carefully confirm whether each screw corresponds to the manual, accessories with similar shapes can be distinguished by size

<p>Ax42+4</p> <p>Ø5 x 31 mm</p>	<p>Bx34+3</p> <p>Ø15x11mm</p>	<p>Cx34+3</p> <p>Ø8x30mm</p>	<p>Dx8</p> <p>Ø15x9.5mm</p>	<p>Ex1</p> <p>Ø3x12mm</p>
<p>Fx4</p> <p>Ø4x30mm</p>	<p>Gx4</p> <p>Ø4x18mm</p>	<p>Hx20</p> <p>Ø3x12mm</p>	<p>Kx42+4</p>	<p>Lx2</p>
<p>Mx4</p> <p>Ø3.5x14mm</p>	<p>Nx1</p> <p>Ø3.5x14mm</p>	<p>Px1</p> <p>Ø3.5x14mm</p>	<p>Qx1</p> <p>Ø4x40mm Ø3.5x14mm</p>	<p>Z x 1</p>
<p>White nut</p> <p>X3</p>				

1

Ax21



Ø 5 x 31 mm

Cx14



Ø8x30mm

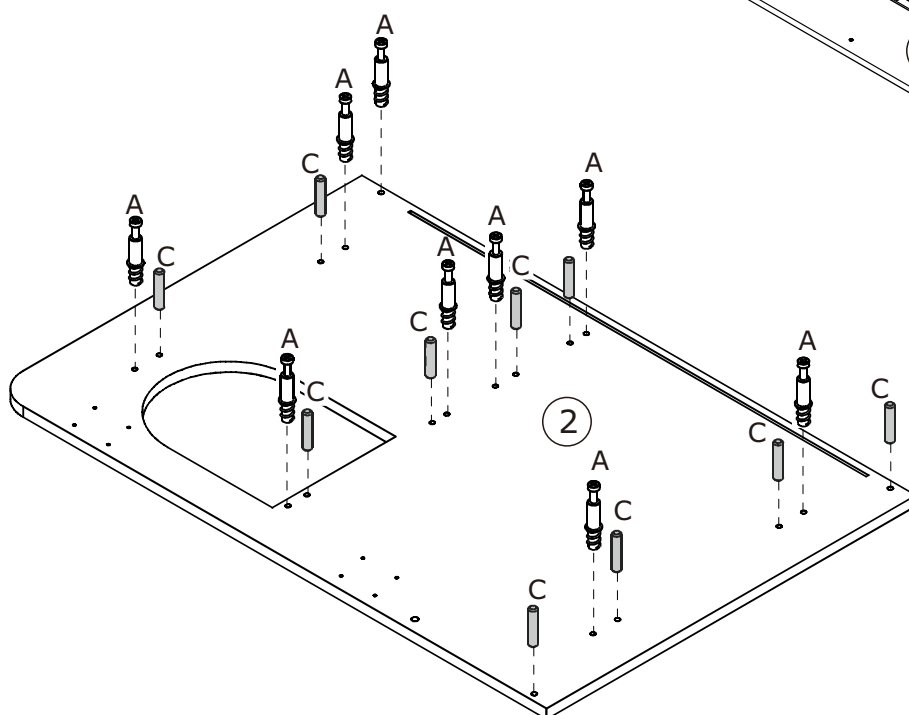
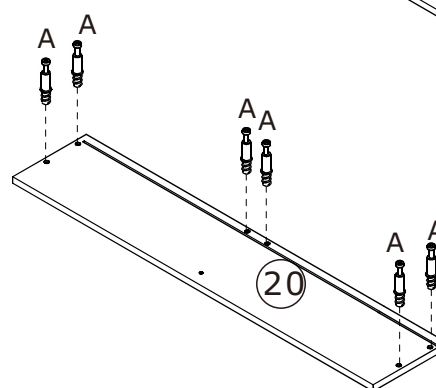
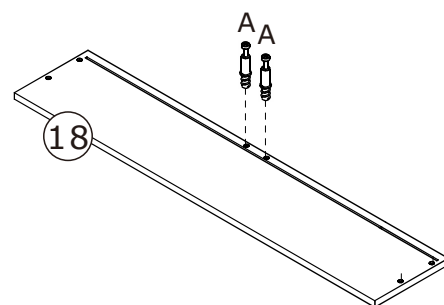
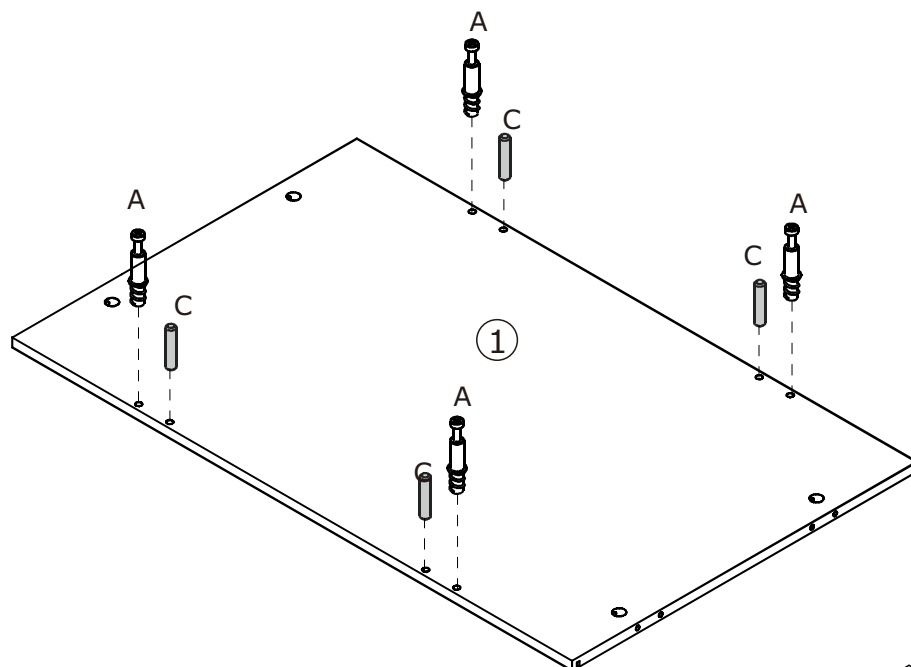
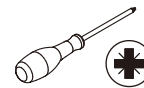

2

AX9



Ø 5 x 31 mm

Bx2



Ø8x30mm

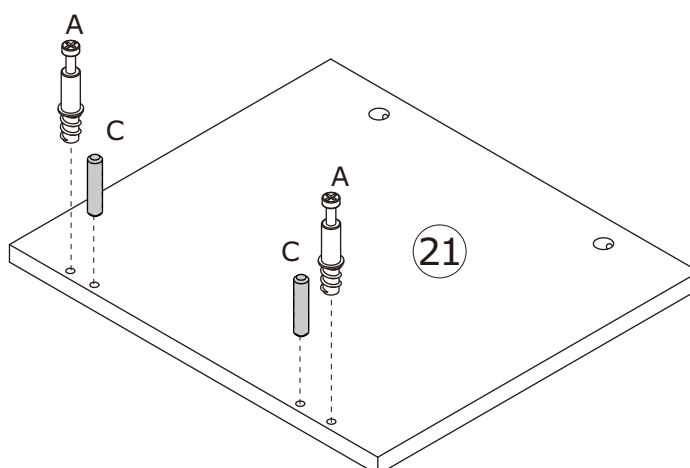
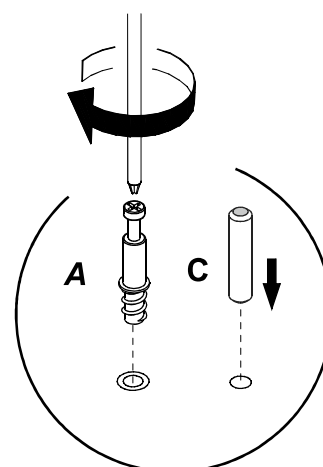
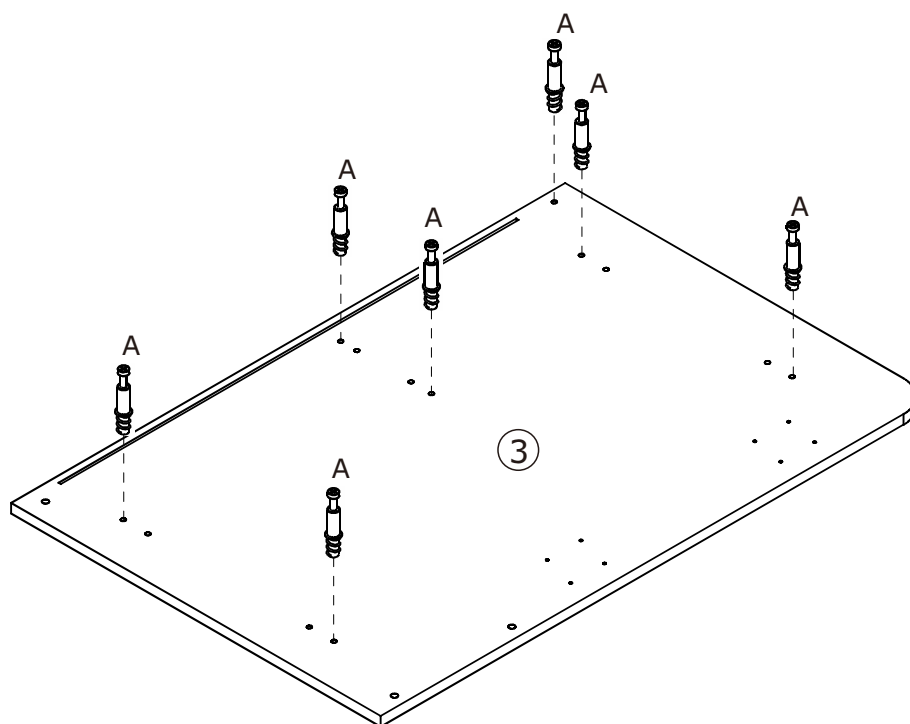
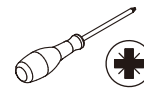

3

Ax6



Ø 5 x 31 mm

Bx6



Ø8x30mm

Ex1

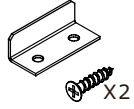

Ø3X12mm

Qx1

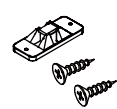

Ø3.5x14mm

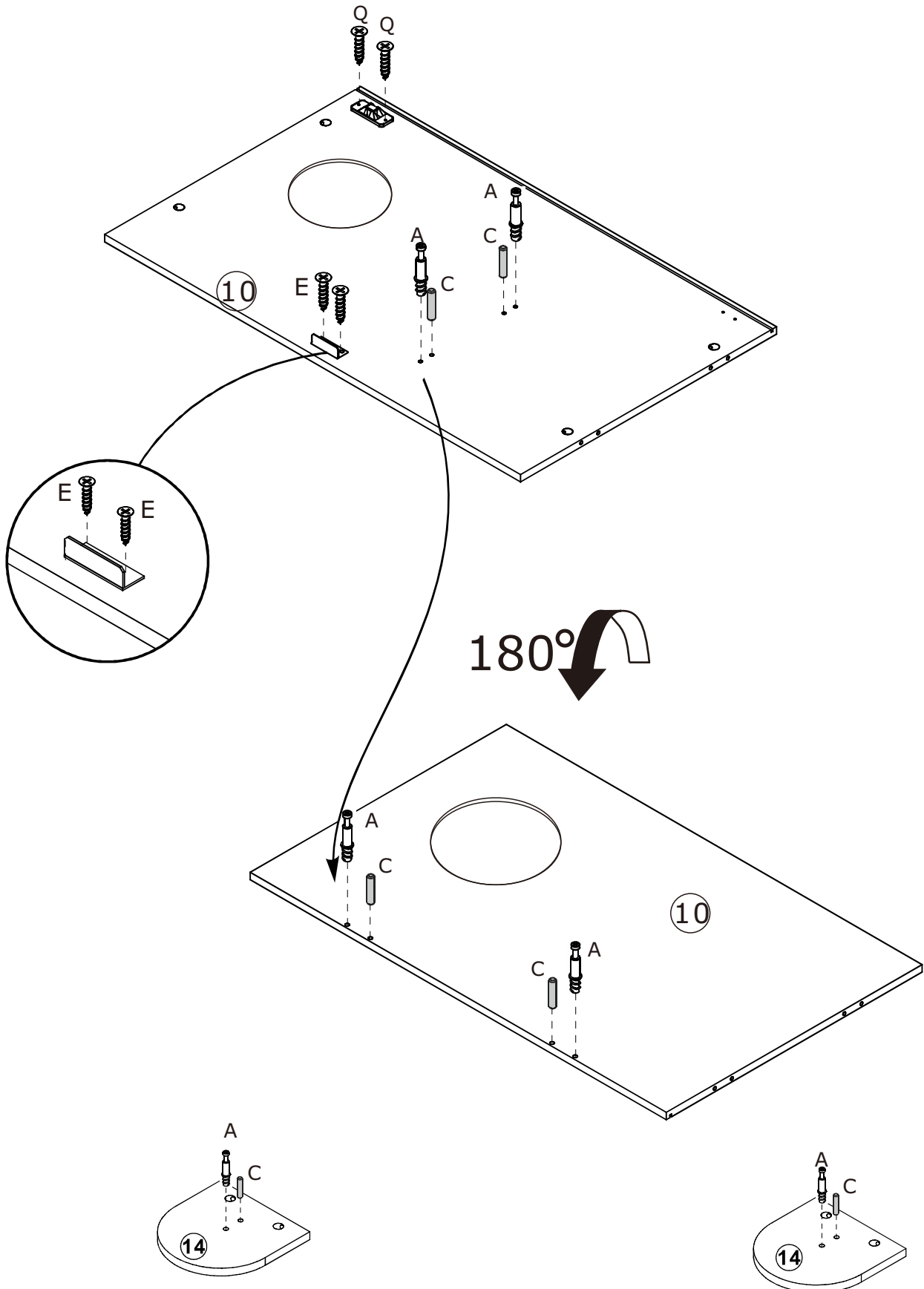
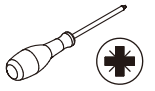

4

Bx2



Cx2

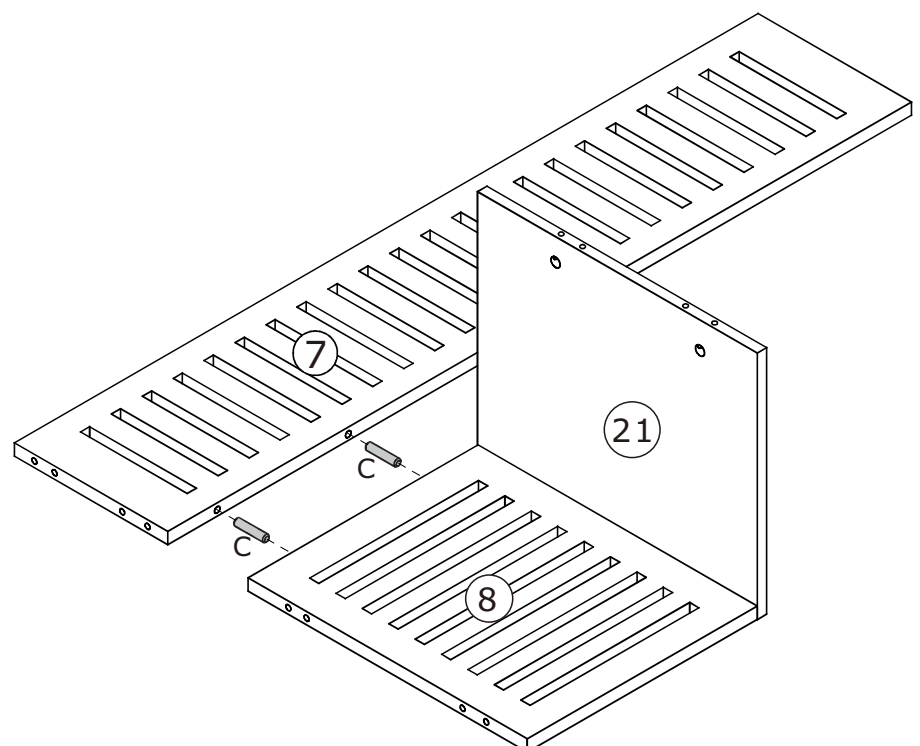
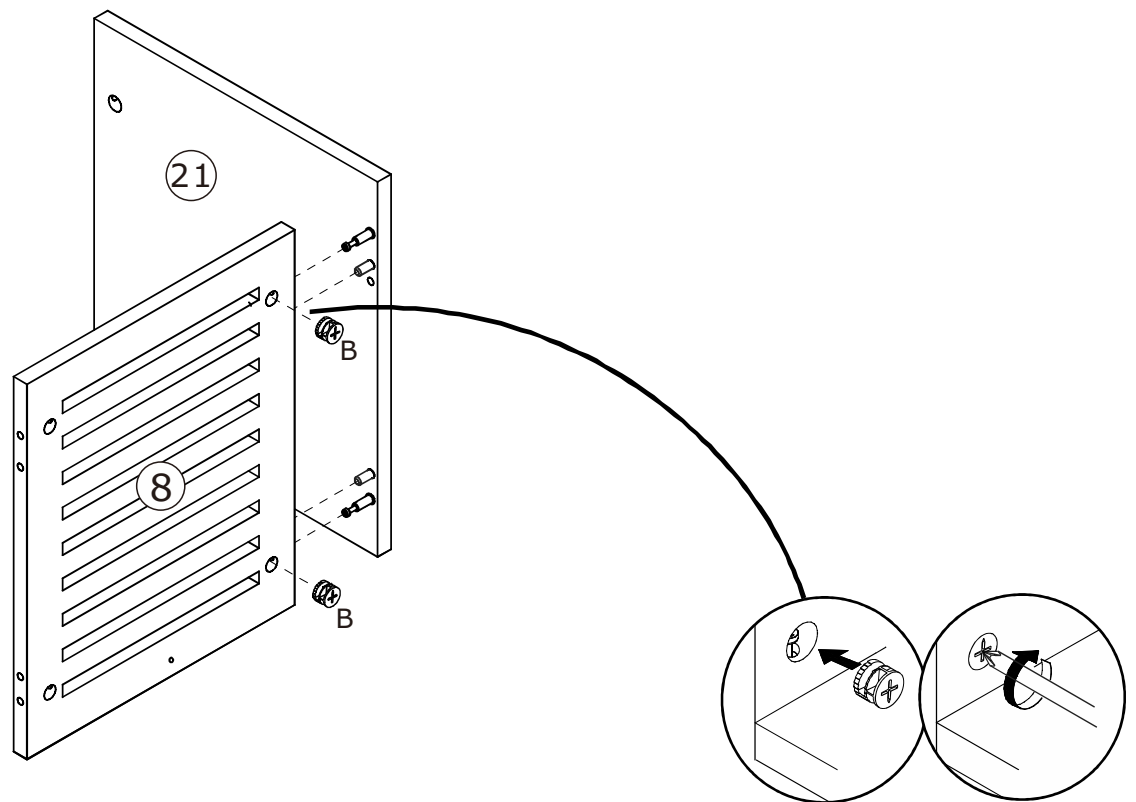
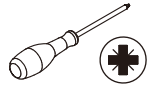
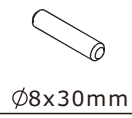

5

Bx2



Ø15x11mm

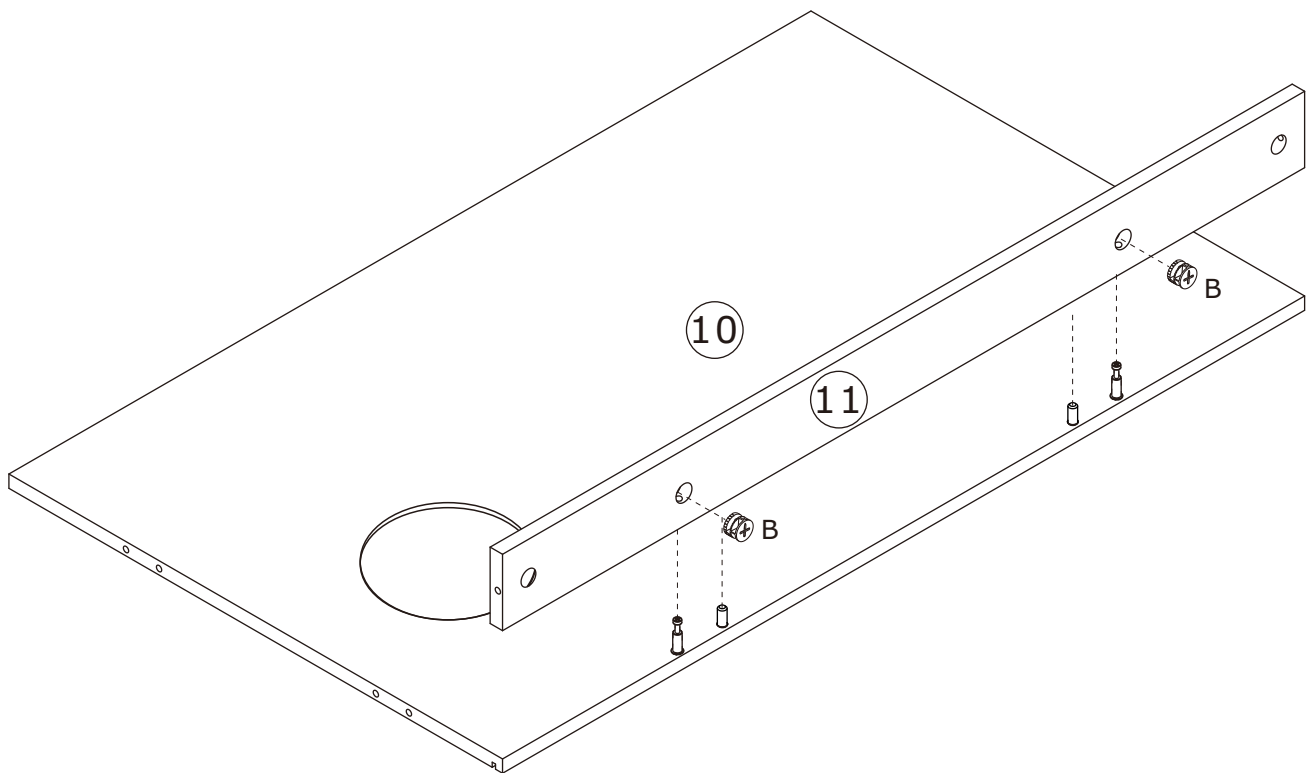
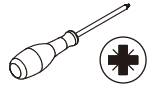

6

BX2



Ø15x11mm

Nx1



Ø3X12mm

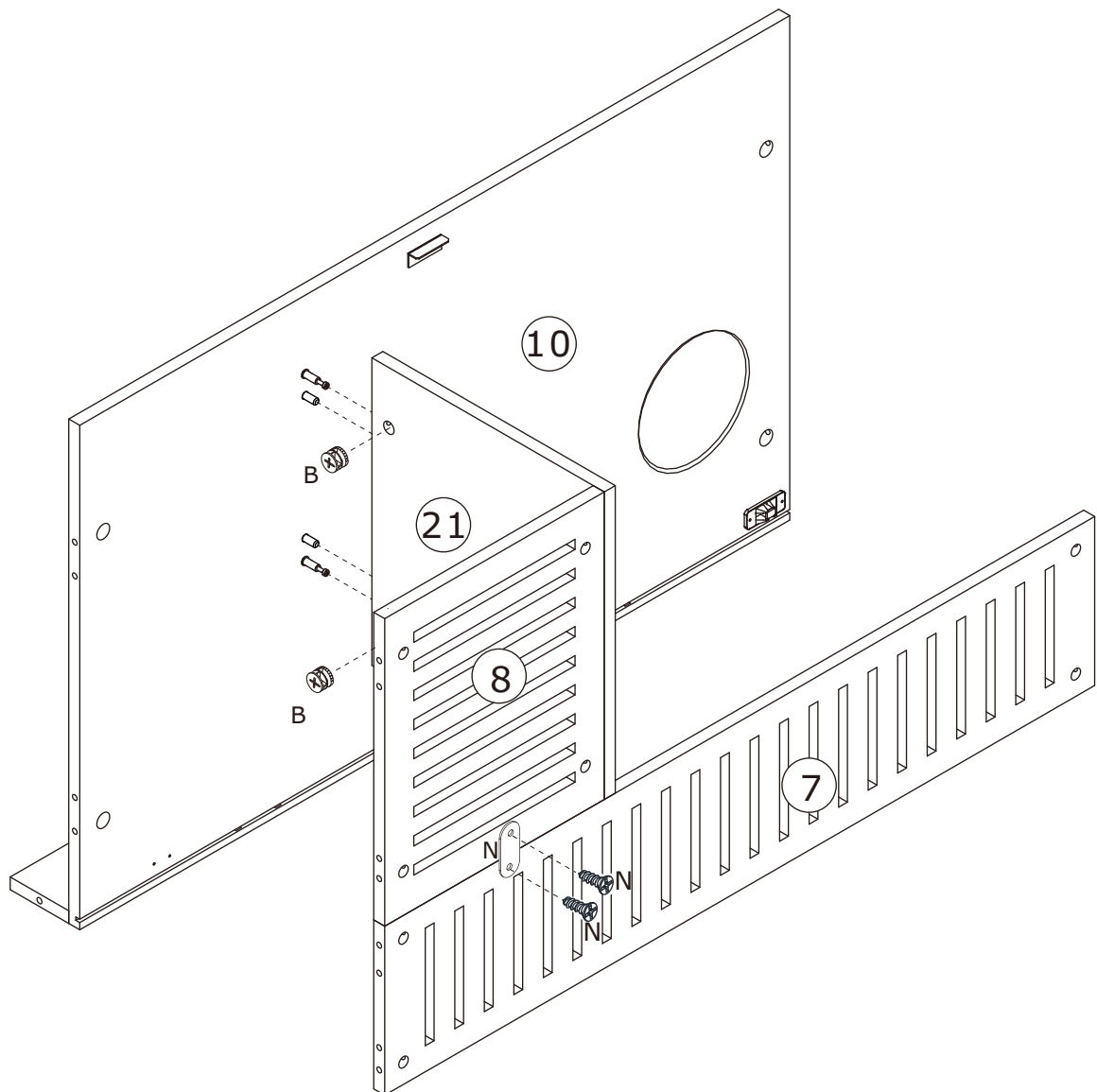
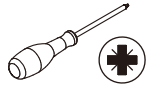

7

Bx6



Ø15x11mm

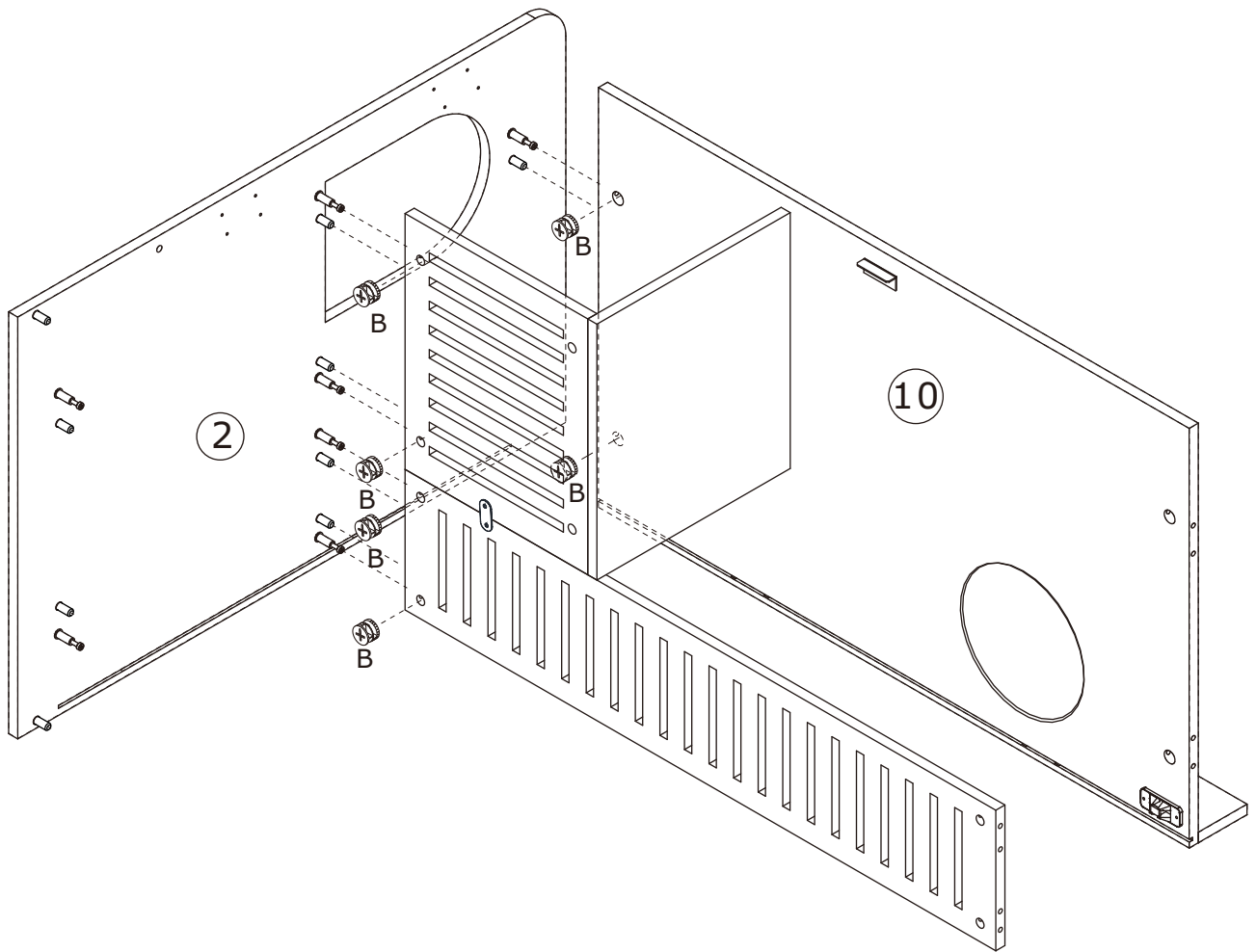
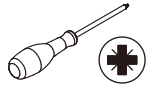

8

Dx4



Ø15x9.5mm

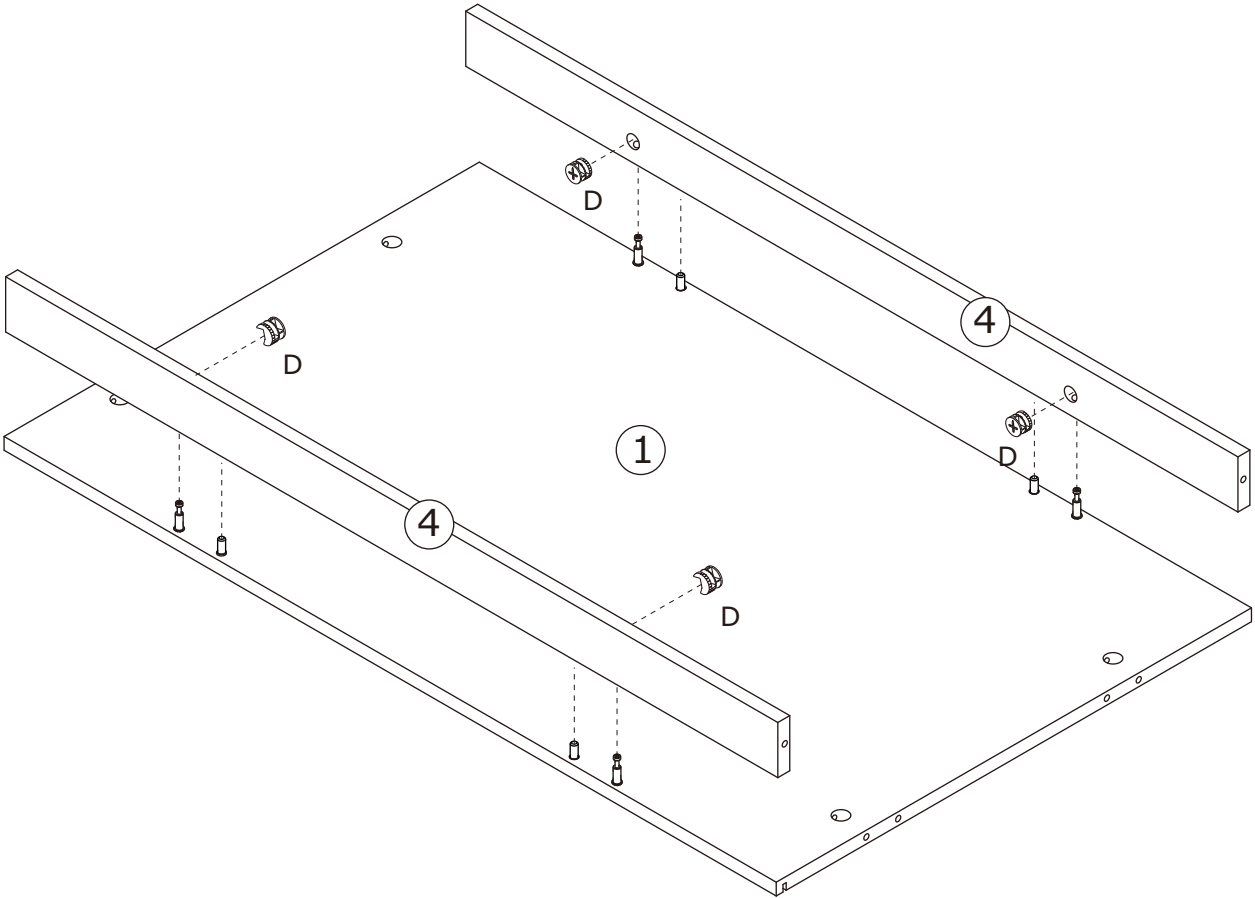

9

Bx2



Ø15x11mm

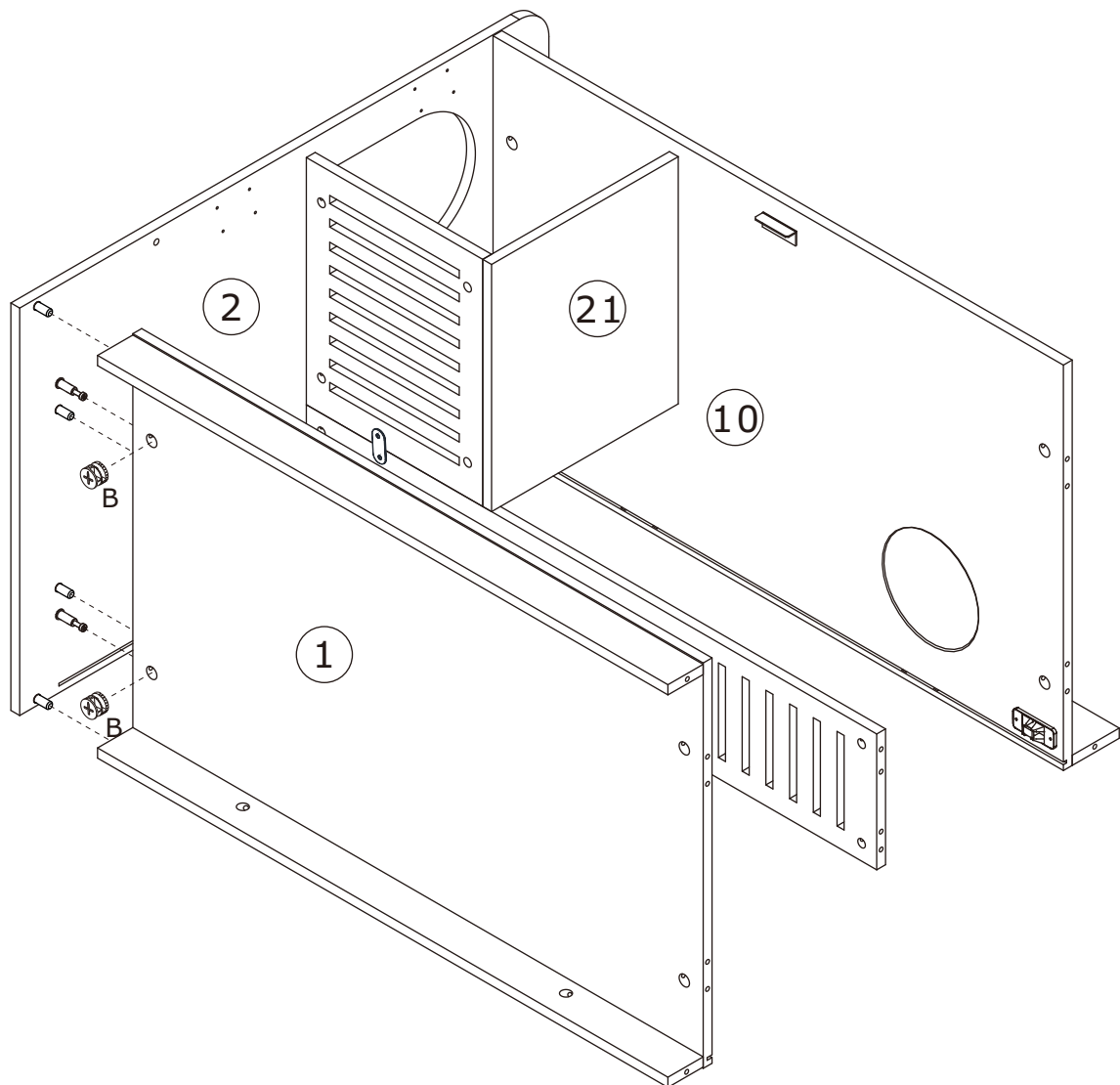

10

Bx2



Ø15x11mm

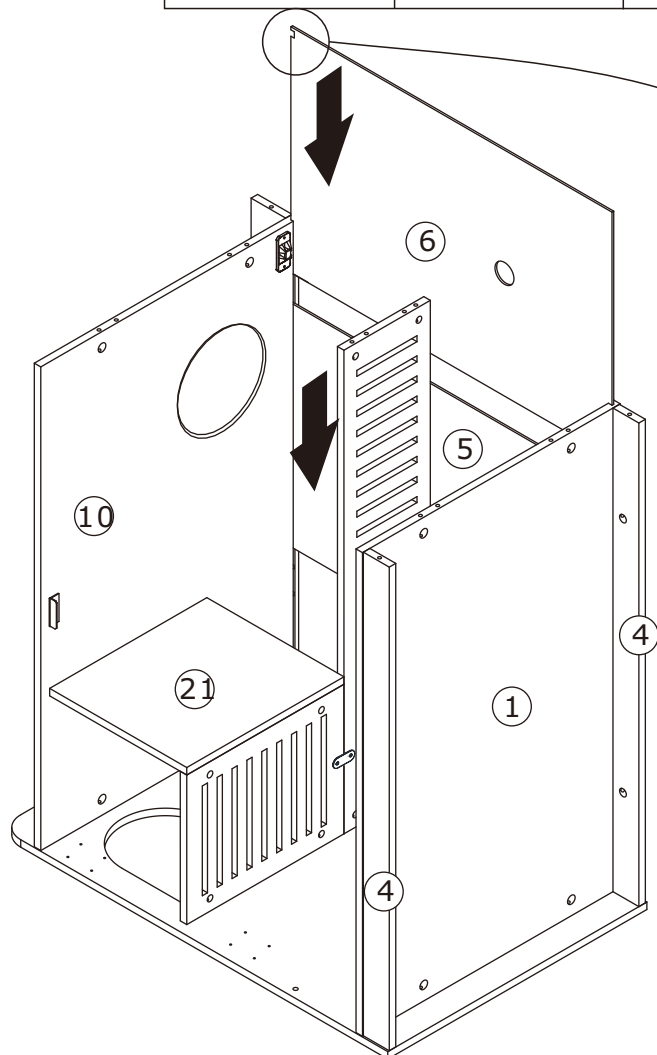
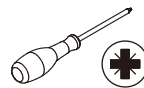

OR

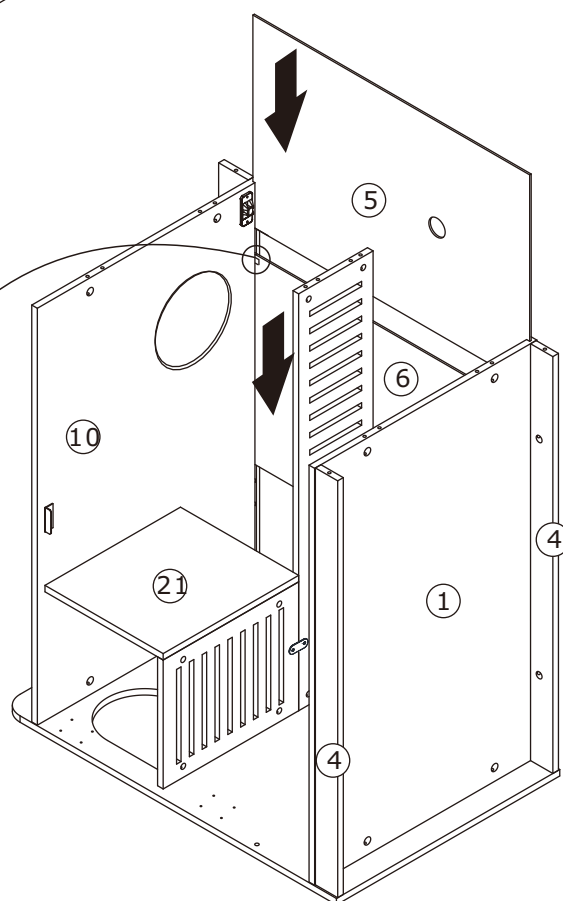
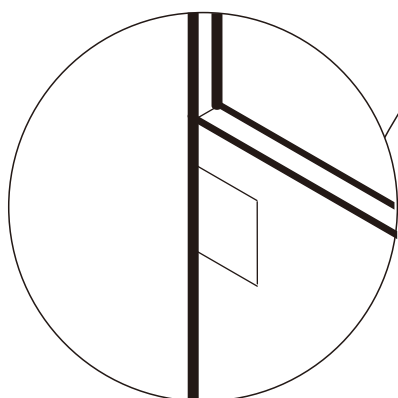

11

Bx6



Ø15x11mm

Bx8



Ø8x30mm

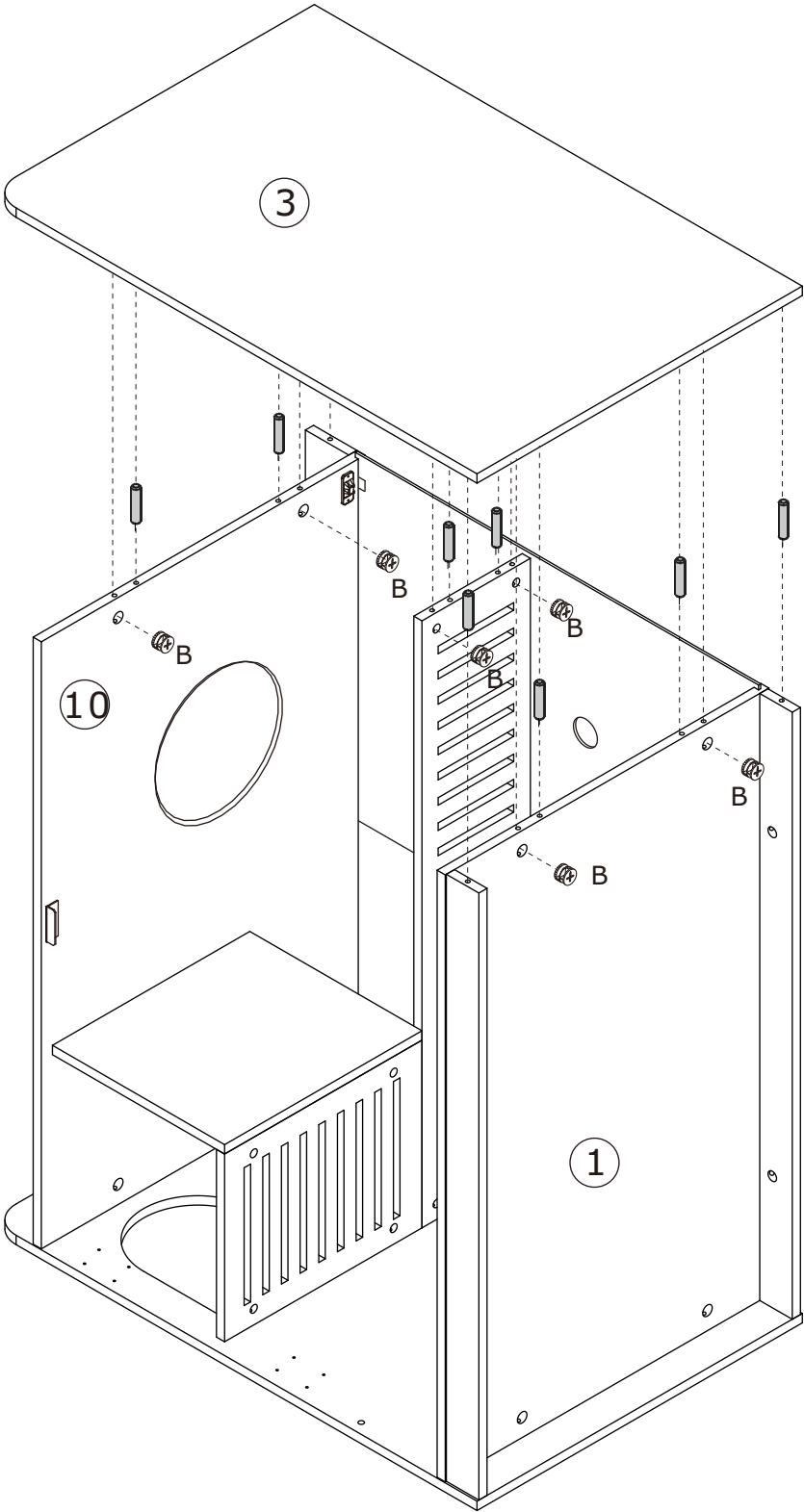

12

Bx2



Ø15x11mm

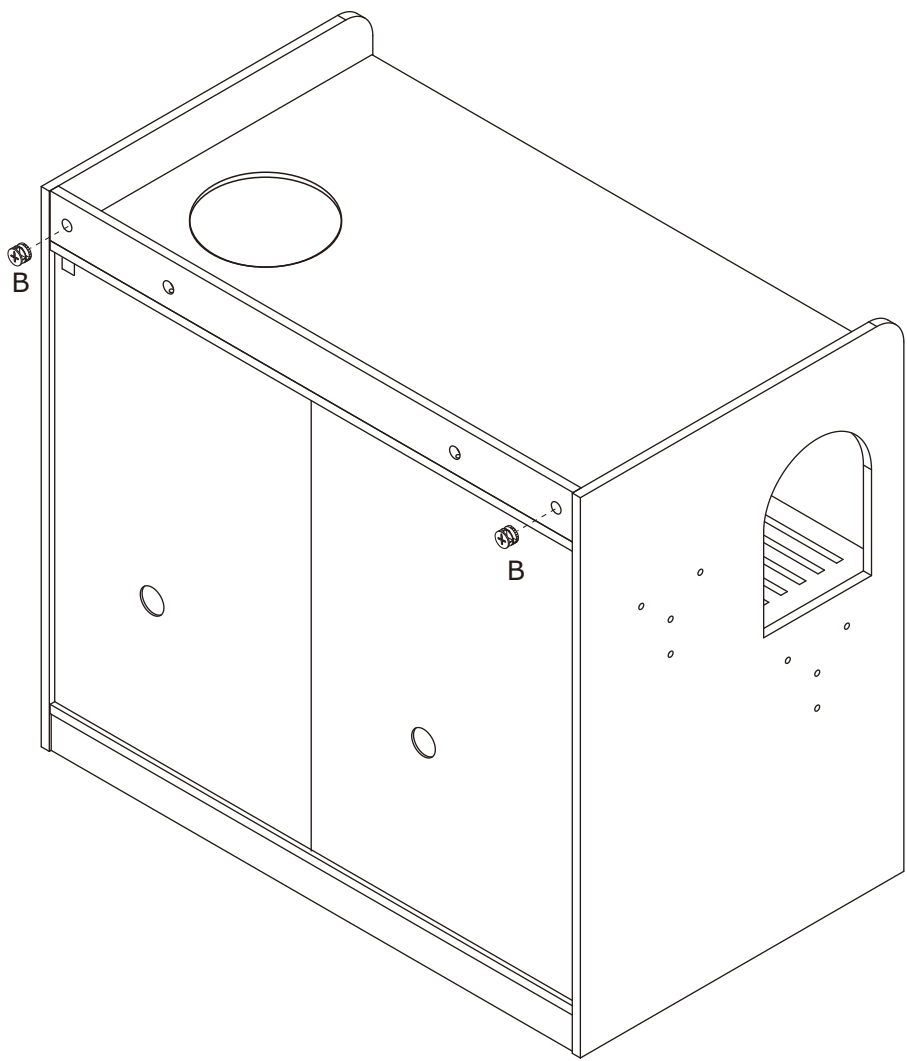
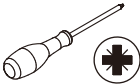

13

Hx10



Ø3X12mm

Bx2



Ø15x11mm

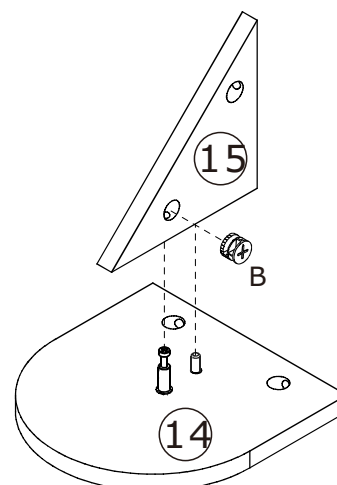
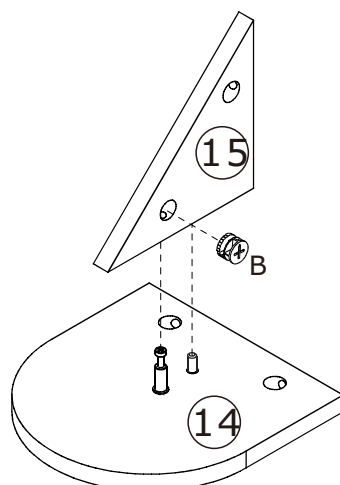
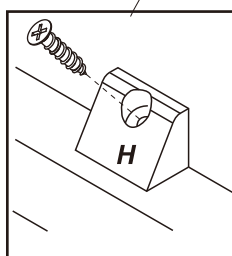
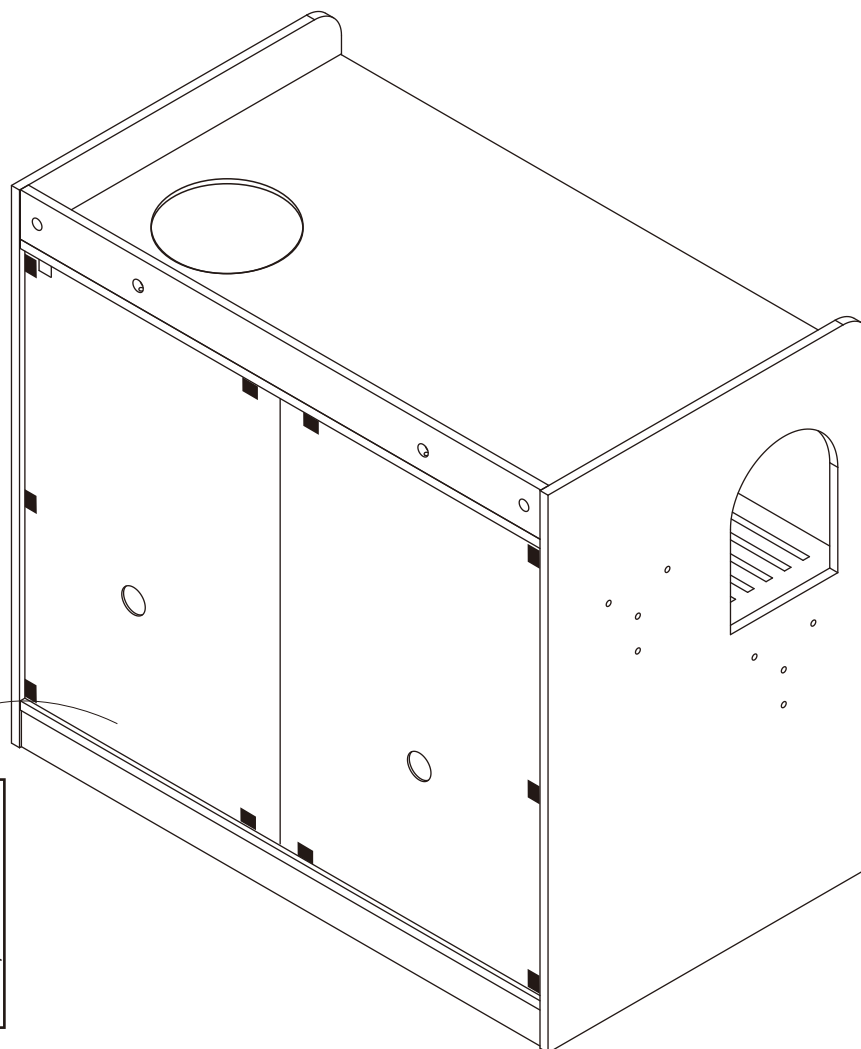

14

Ax6



Ø5x31mm

Bx6



Ø15x11mm

Cx2



Ø8x30mm

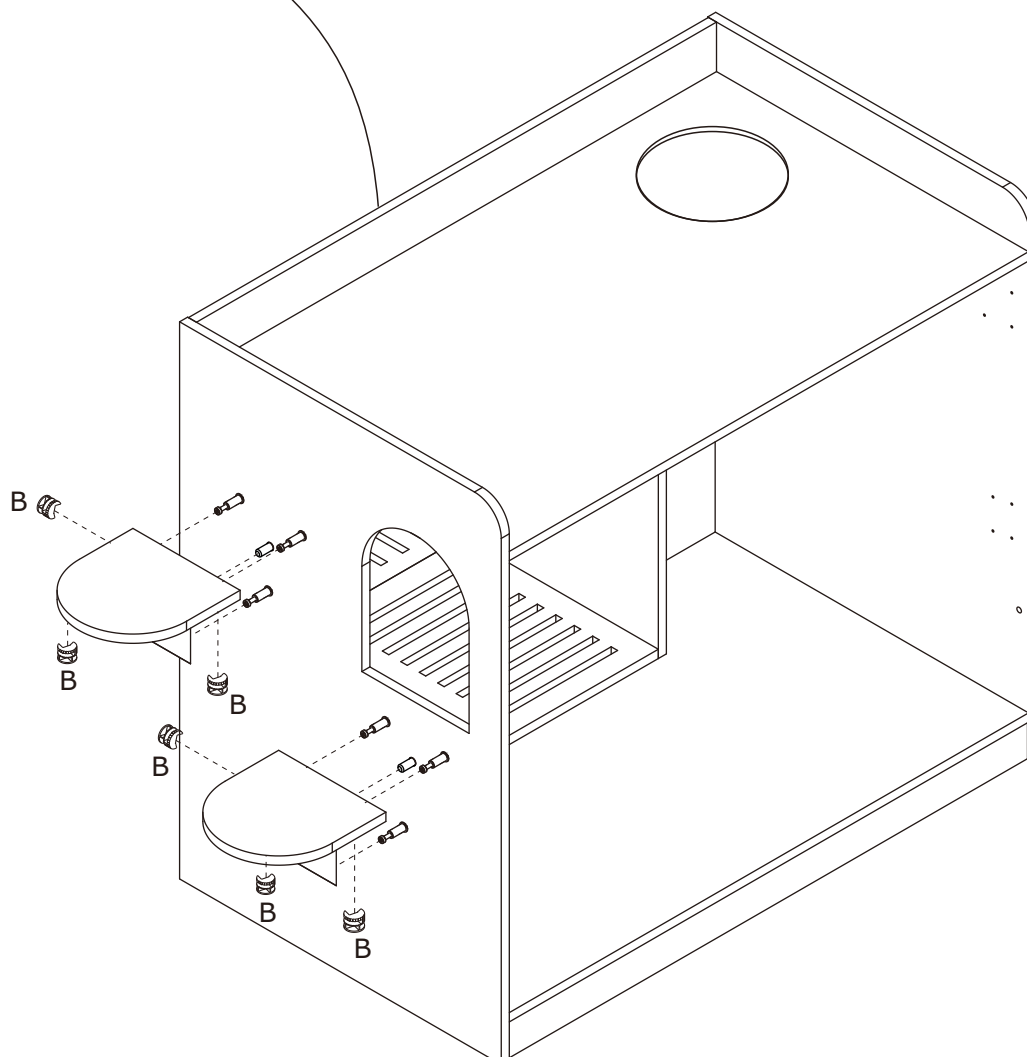
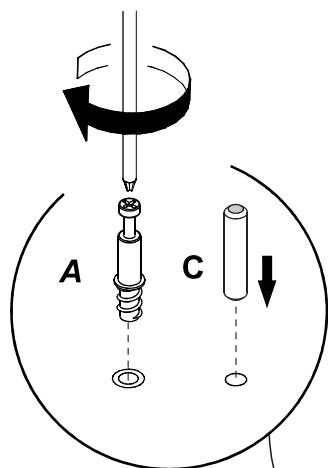
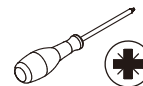

15

MX4



Mx8



Ø3.5x14mm

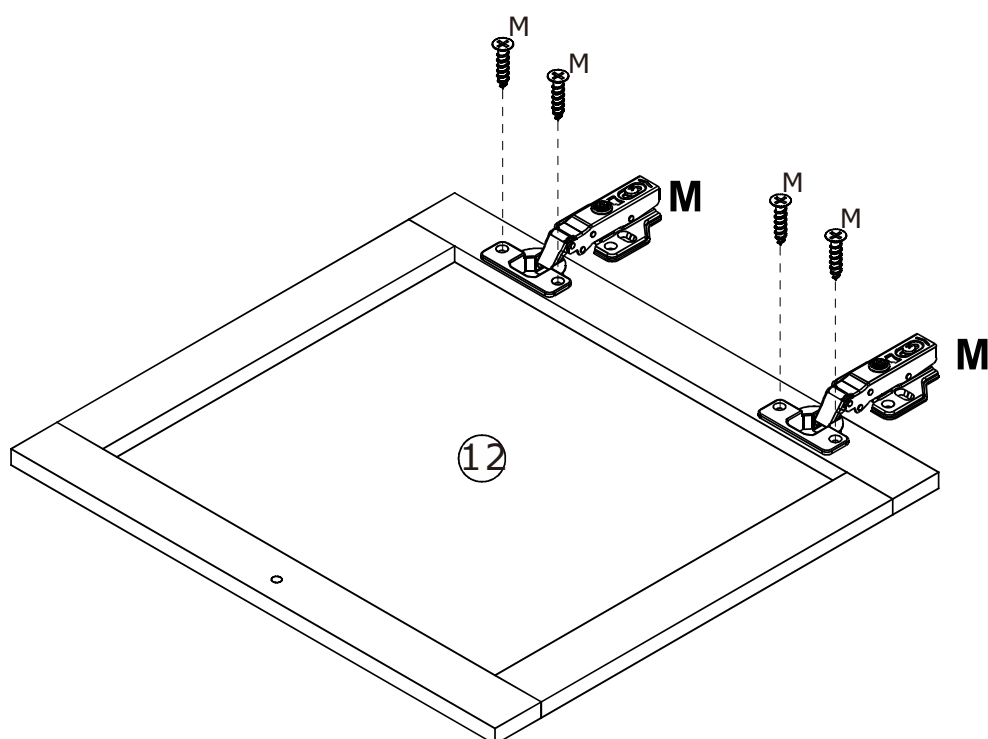
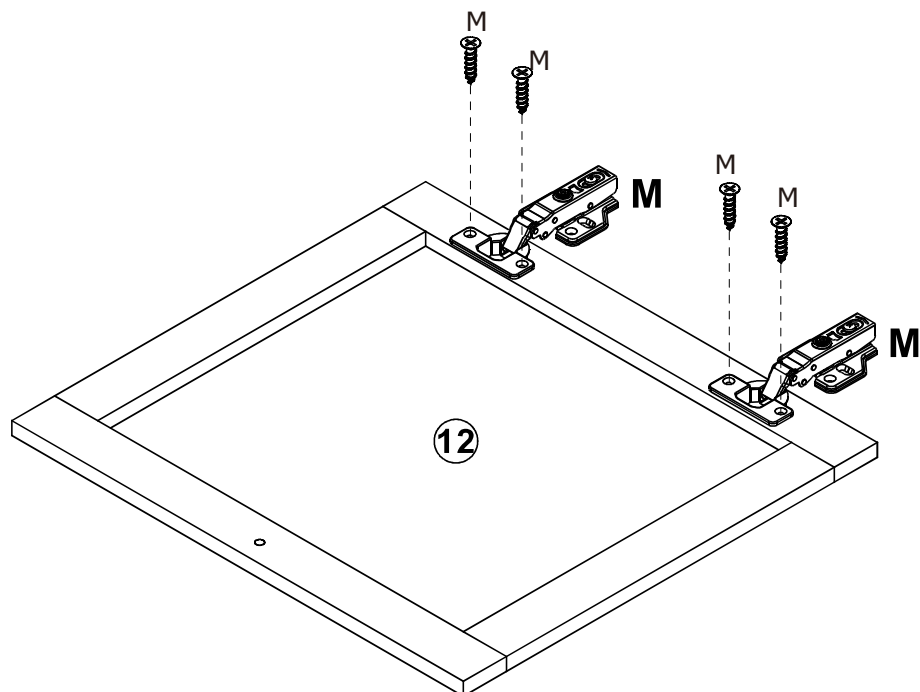
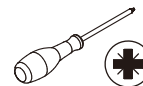

16

Mx16



Ø3.5x14mm



Gx2

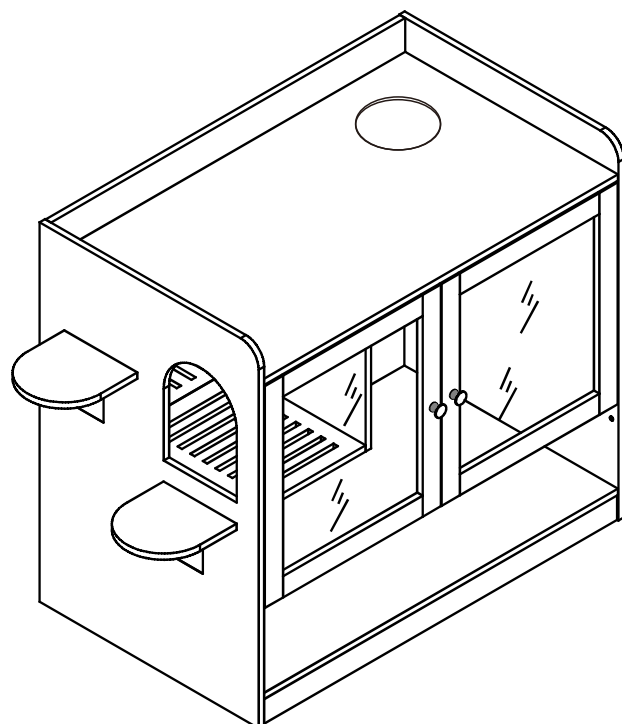
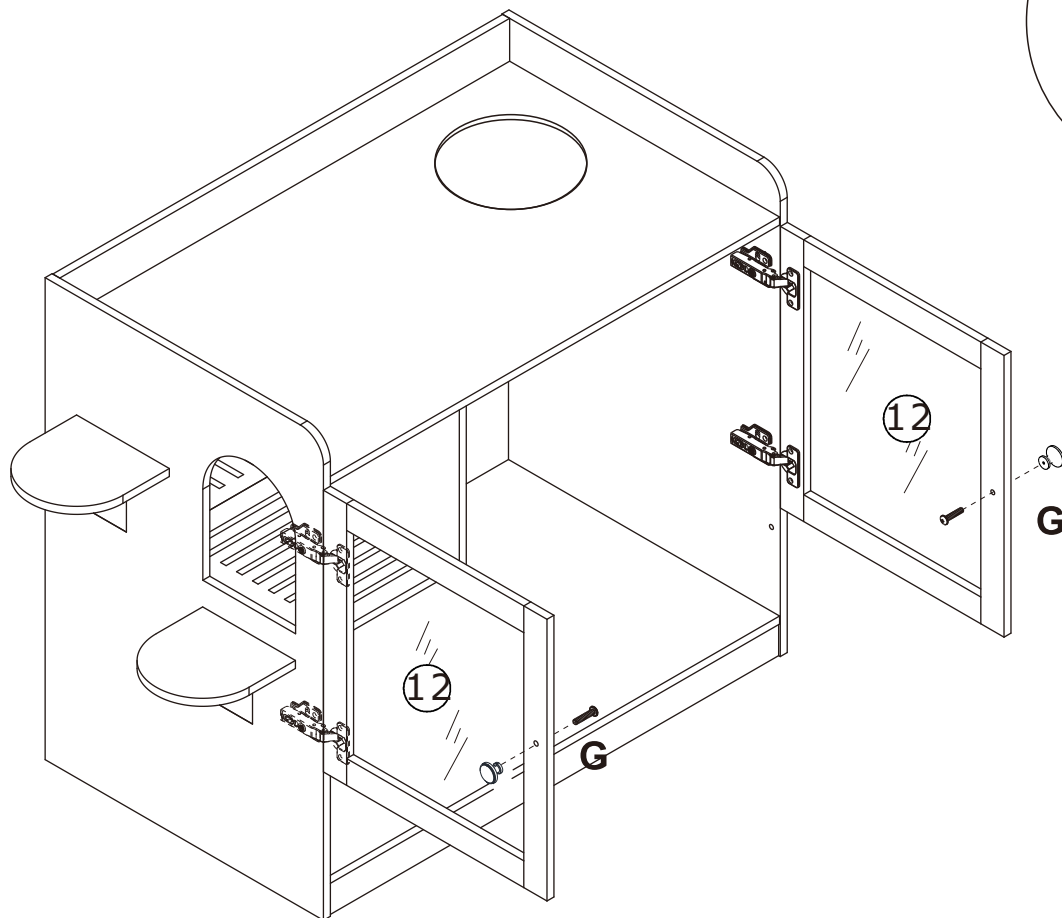
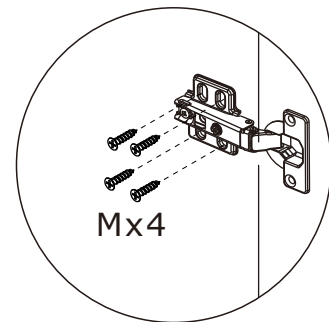
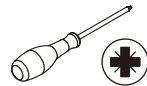

Ø4x18mm

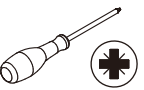

17

Dx4  Ø15x9.5mm	Bx2  Ø15x11mm			
---	--	--	--	---

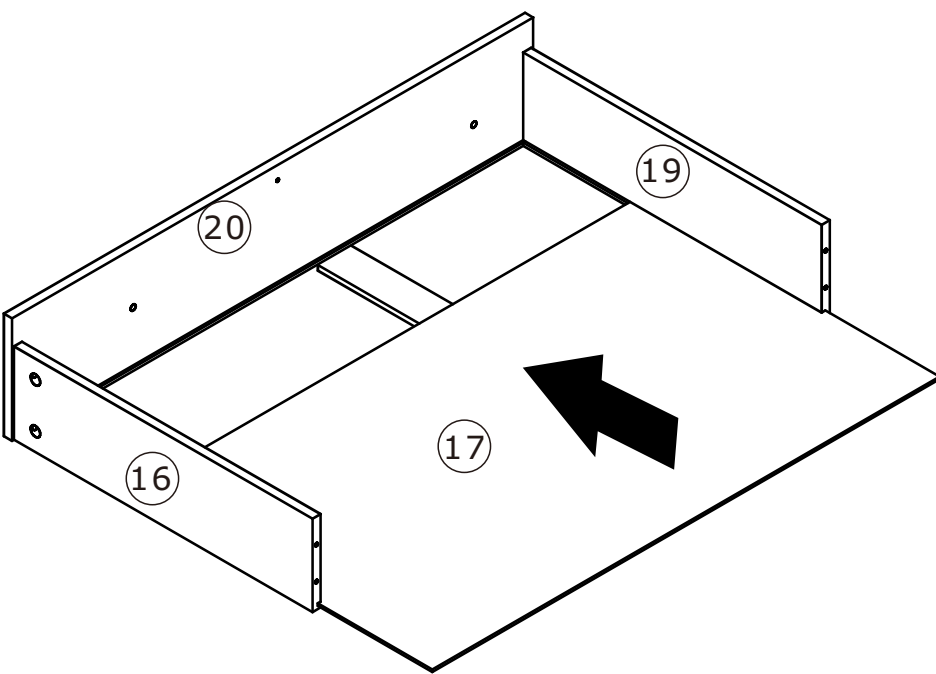
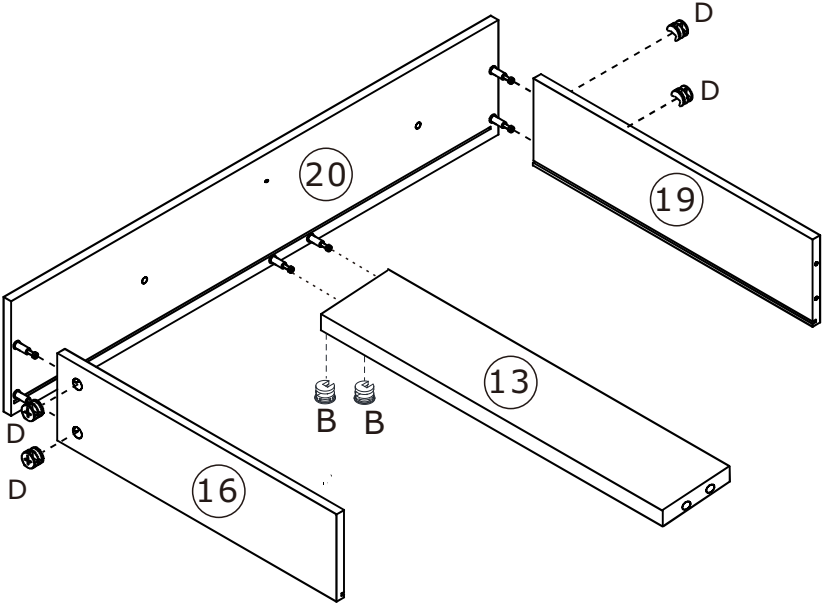

18

FX4



Ø3.5x30mm



Bx2

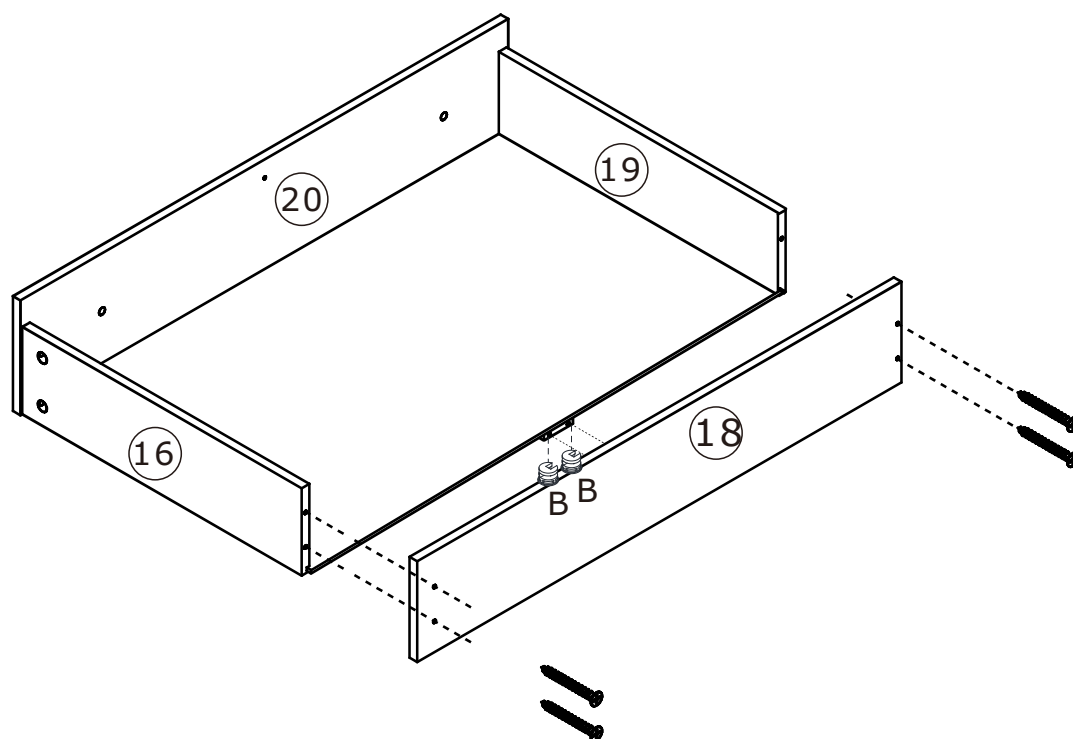
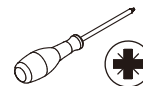

Ø15x11mm

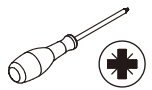

19

<p>Gx2</p>  <p>Ø4x18mm</p>	<p>PX1</p>  <p>Ø3.5x14mm</p>	<p>Hx10</p>  <p>Ø3X12mm</p>		
---	---	--	--	---

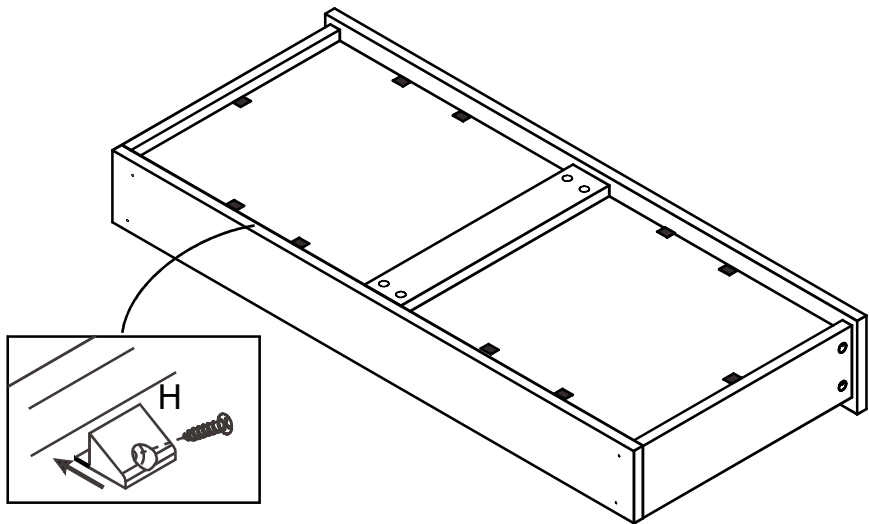
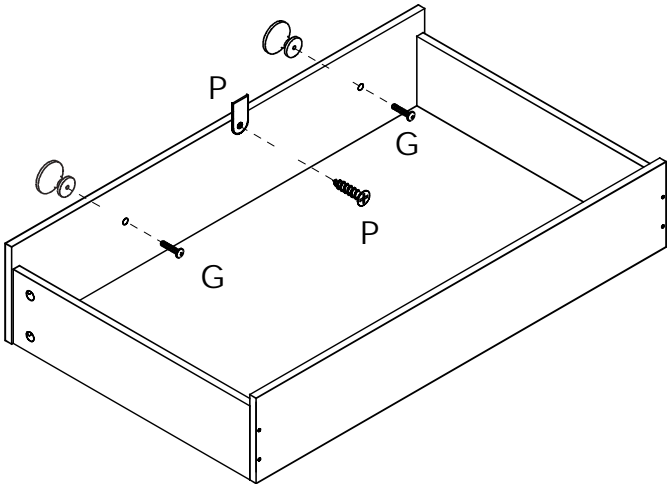

20

Lx2

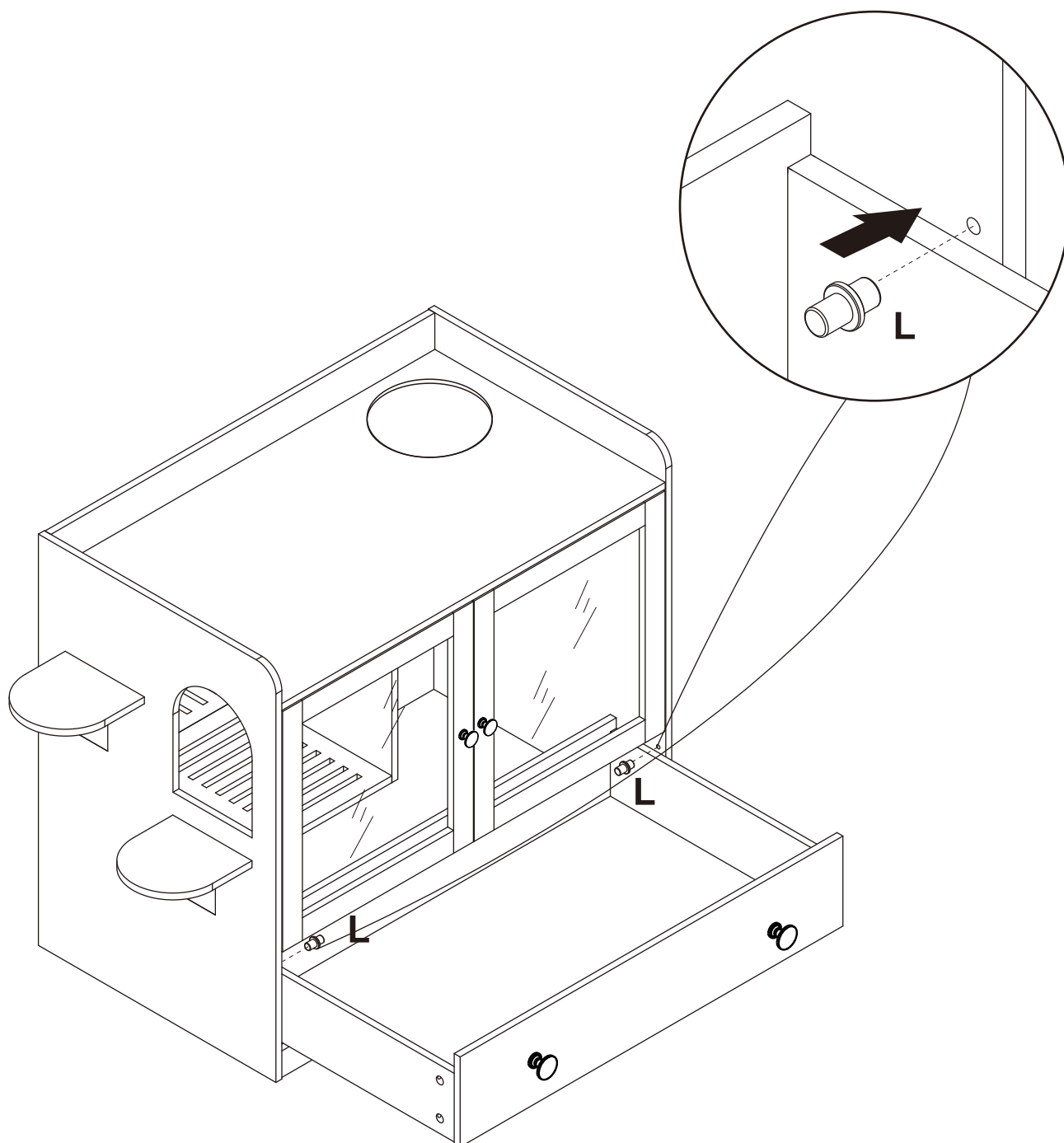
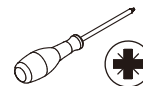

21

Kx2

0

Zx1

Levinöuse



Levinöuse

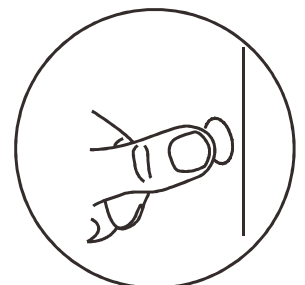
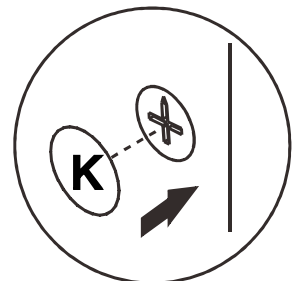
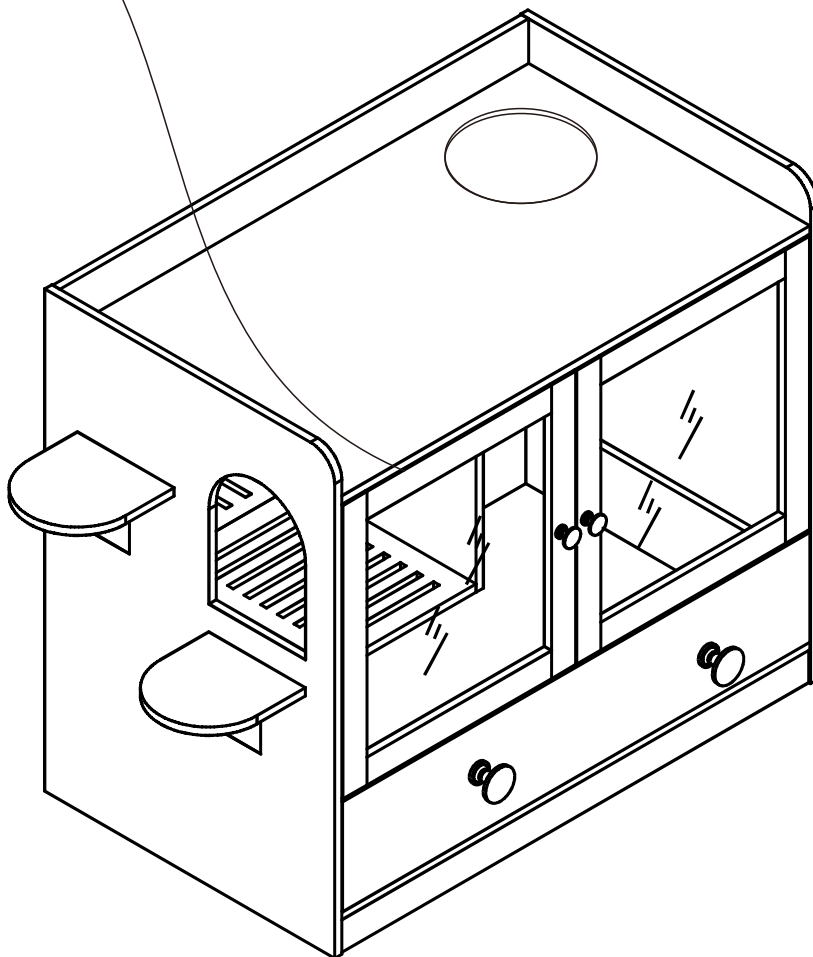

22

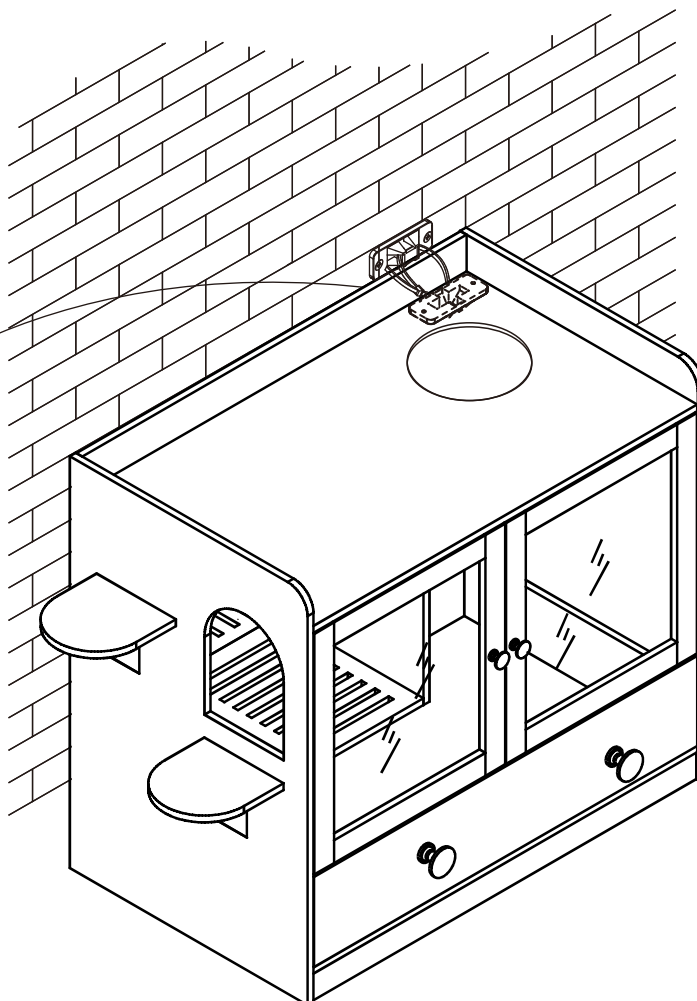
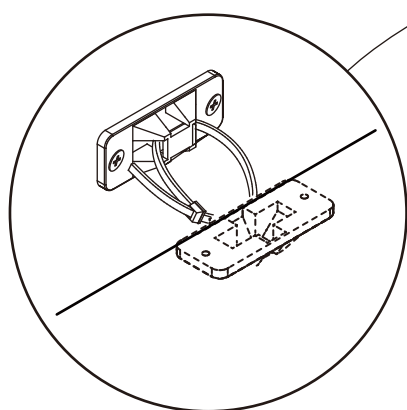
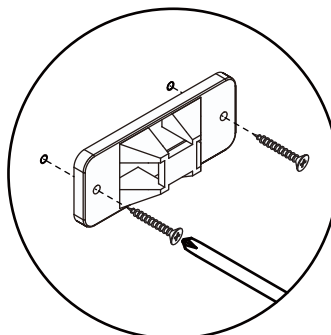
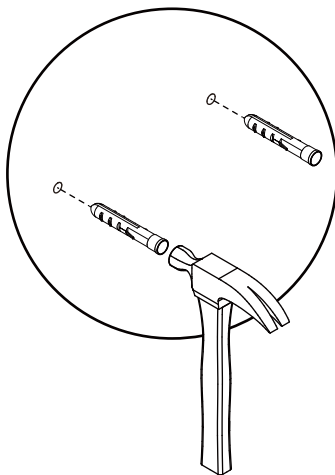
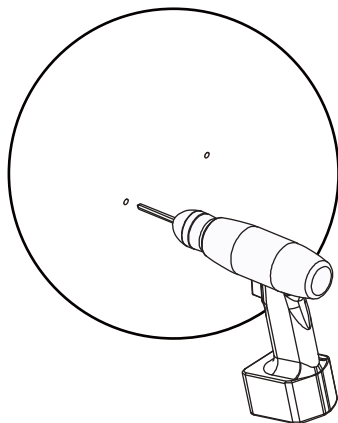
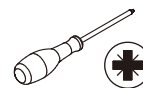
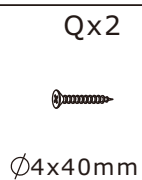
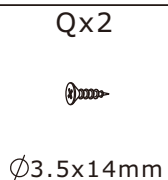
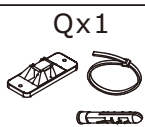

Tips Before You Use

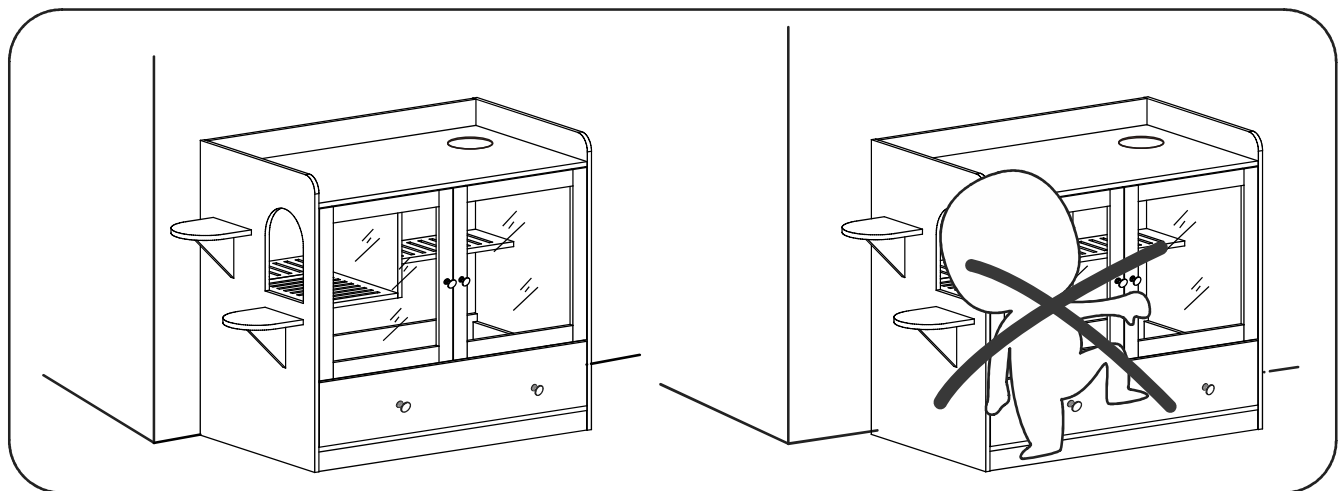
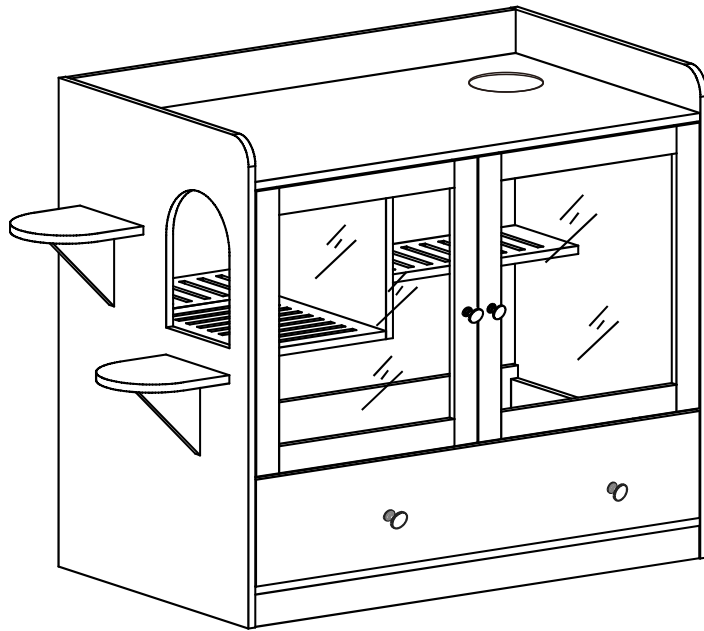

Serious or fatal crushing injuries can occur from furniture tip-over. To further reduce the risk of serious injury and death from tip-overs:

- Place heaviest items in the lower drawer.
- Do not set TVs or other heavy objects on top of this product.
- Never let children climb or hang on drawers, doors, or shelves.

WARRANTY

WARRANTY CLAIMS

- There is a 30-day warranty for broken furniture or any other problems that do not work properly. The warranty will start from the date of purchase which must be verified by proof of purchase.
- Before making a claim, we may be able to answer your query, simply call us. Please leave your purchase order number, along with some details of the problem, if you want a replacement part. We will arrange within 48 hours. If there is out of stock, we will reply with a shipping date.
- The product must be used in accordance with the instructions provided. For health reasons.
- For other reasons, if the furniture needs to be returned, it must be cleaned and dried and operated within 30 days of receipt.

Type of Warranty Claim

- Failure to follow the furniture instructions will invalidate the warranty. Attention please.
- Does not include damage during installation, but includes damage during transportation.

Scope of responsibility

- Shall not bear any responsibility for misuse or user damage and / or loss of parts during the installation of furniture.
- After using, the damage and scratches of the furniture are not covered by the warranty.

The Warranty Relates to All Bought in The Us and Covers The Following Areas

- Sheet parts: 1 month from the date of purchase.
- Electrical parts: 1 month from the date of purchase.

RETURNS

CHANGED YOUR MIND AND NEED TO RETURN YOUR ITEM?

PLEASE FOLLOW THE BELOW INSTRUCTIONS:

- If you have purchased and have simply changed your mind, follow the retailer's instructions for returns.

DEFECTIVE ITEMS

- If your item is defective in any way, i.e. it doesn't work but you can't identify why, in the first instance, please call us.

DAMAGED ITEMS

- If you receive an order with obvious shipping damage from the retailer, then we suggest the delivery is refused. If the delivery has been accepted and then shipping damage is found, please follow the specific instructions advised by the retailer.
In all circumstances please save all packaging material and paperwork for the order. Please be aware that if you dispose of packaging material or attempt to return the merchandise without contacting the fulfiller, you jeopardise your chances of making a claim, and you may not receive a credit for the return.