



# ZIPPITY

*Easy Does It!*

## ALL AMERICAN VINLY PICKET GATE (38"H X 41"W)

## ASSEMBLY INSTRUCTIONS ZP19043

**45 MIN**

*Approximate assembly time*

Want to see a video on how to  
assemble this product?

**Scan the QR code**

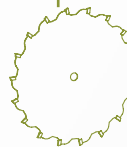
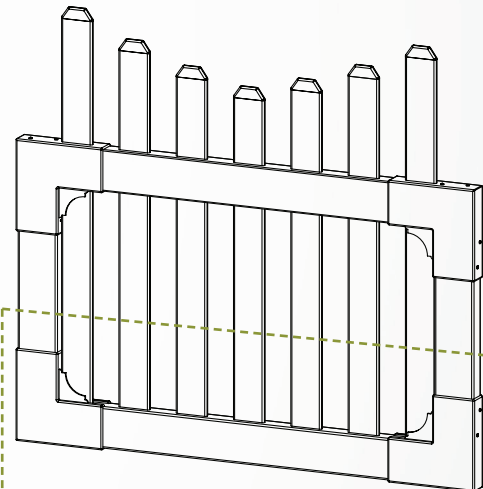

The height of this gate can be  
trimmed to fit custom needs. Use a  
fine tooth saw or hack saw.

## GENERAL INFORMATION



### IMPORTANT

- Check the inside of the larger pieces in your box for other materials packed inside.
- When assembling components, place on a non-abrasive surface (i.e. shipping box) to avoid scratching.
- We recommend an area approximately 5'x 8' for unobstructed assembling.
- You should not need to use excessive force when assembling components.

## MISSING OR DAMAGED PARTS?

### VISIT OUR WEBSITE FIRST, SO WE CAN HELP YOU RIGHT AWAY!

Although great care has been taken to ensure proper packaging and handling of this product, occasionally problems occur. If you discover any missing, damaged or defective parts, please visit our website to order replacement parts. If you experience any further trouble with your product, please contact our customer service department.

 [parts.nychbrands.com](http://parts.nychbrands.com)

 [support@zippity-outdoor.com](mailto:support@zippity-outdoor.com)

 **704-892-5222 / 877-234-6196**

*Customer service agents are available to take calls weekdays from 9am-5pm EST. If you call outside of business hours, please leave a voicemail.*

To help you quickly and accurately, please have reference item number **ZP19043** and the specific part name which can be found on page 5. It is helpful if you can provide the batch lot which is a stamped number inside the box.

## NEED ASSEMBLY HELP?

If you are having problems with the assembly or installation of this product, we are happy to assist you with the process, **so please give us a call at 704-892-5222 / 877-234-6196.**

## NEED TO RETURN?

If for some reason you need to return this product, please allow us to help resolve your issues first. If you still decide to return the product, **you will need to initiate the return from the company you originally purchased from.**

## GENERAL INFORMATION

### 1. Read over fence instructions first.

Your gate and fence will work better together if you first take the time to read and understand your fence.

### 2. Pre-Assemble the gate frame.

Please do not screw the gate frame together until you have temporarily assembled the gate frame. In other words, do a dry run first. This will ensure:

1. That you have everything necessary to complete the gate.
2. That you will have assembled the gate frame in the correct order.
3. All of the pieces fit and function properly.
4. The gate height and width are similar to the measurements shown on page four.

It's easier to troubleshoot when things are not screwed together. After you assemble your gate correctly, please disassemble as necessary, and use the 1¼" self-drilling stainless steel screws to permanently assemble the gate.

### 3. Install your gate posts before your fence posts.

Your fence panels will be more forgiving for a custom fit than your gate. Position and install your gate posts before you do anything else.

### 4. Do not hang your gate system off a single non-supported post.

Your gate will perform better and last longer if your hinge post is connected to a panel of fence that is connected to another post. This way, the weight strain will be transferred onto two posts versus just one. Installing fence panels on both sides of your gate is ideal in all situations. If this is not possible because of space restrictions, please contact us for alternative solutions.

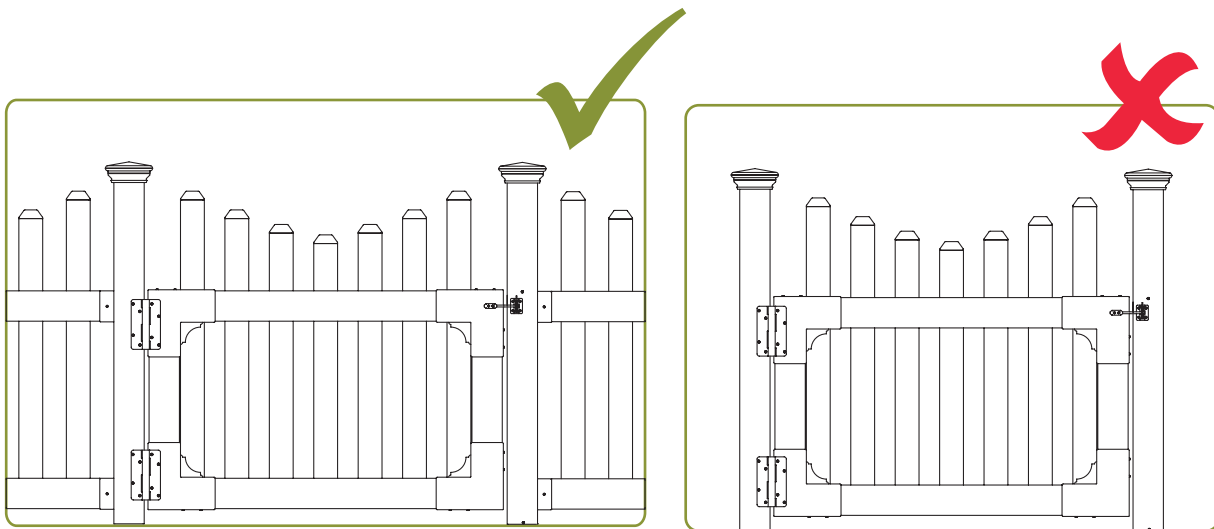

## Detailed Product Dimensions & Specifications

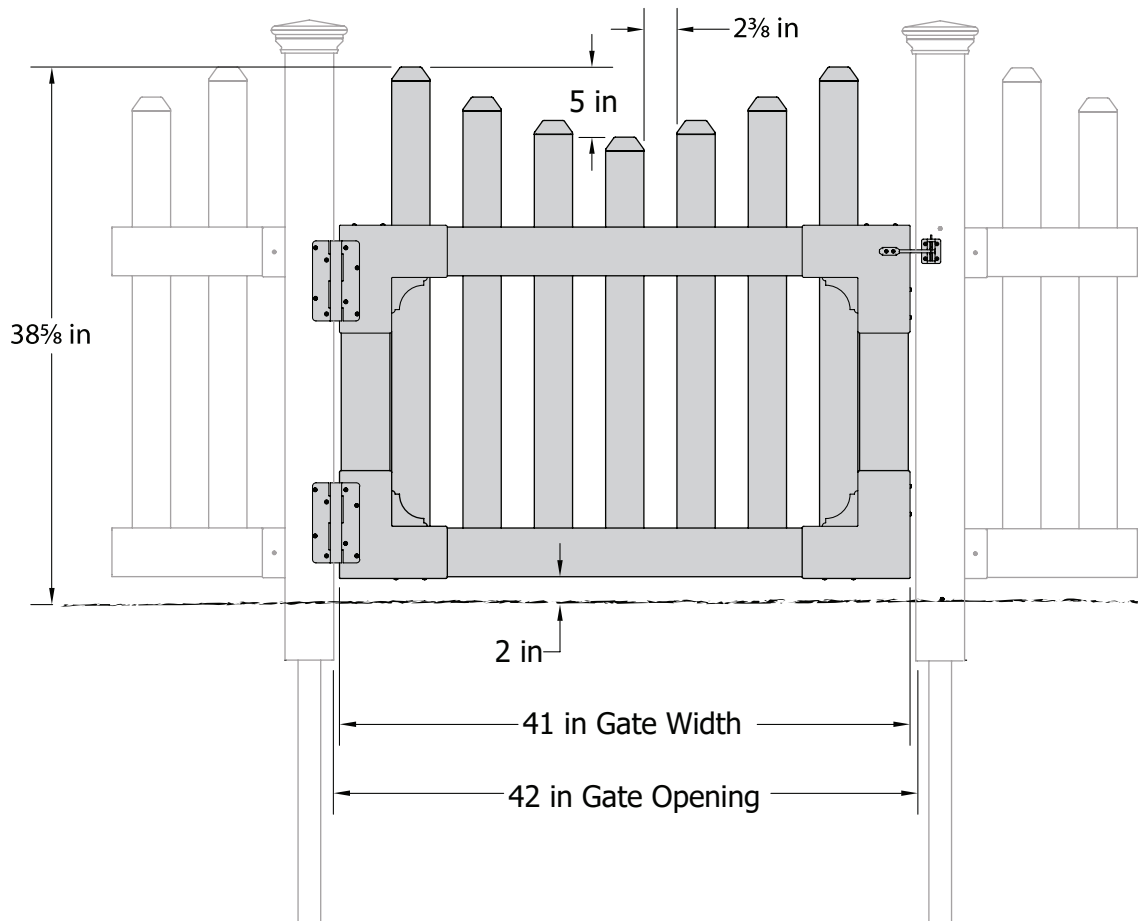

## STEP 1: LAY OUT MATERIALS

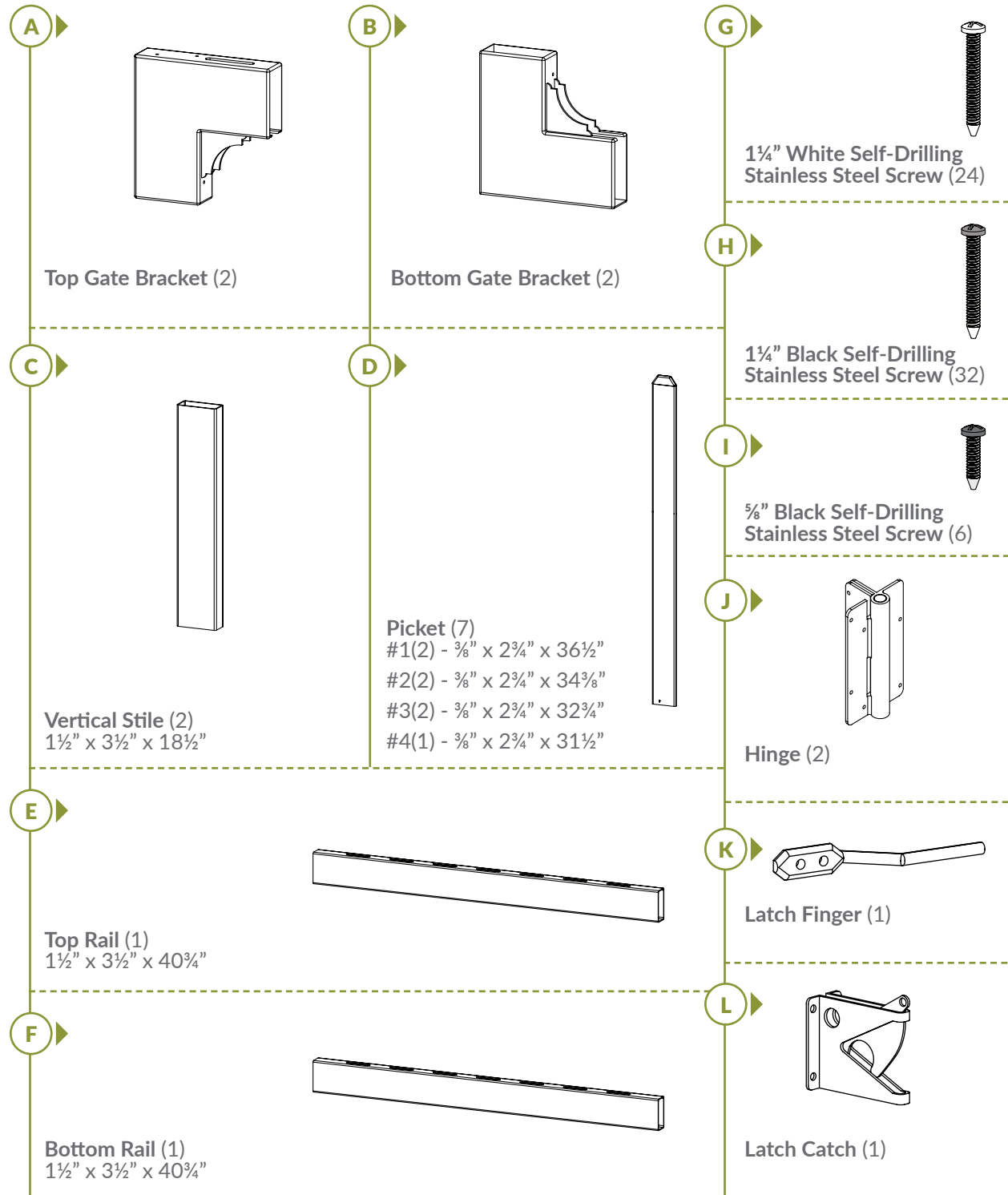

## STEP 2: ASSEMBLE THE GATE FRAME

### STEP 2.1 ▶

- ▶ Insert the Bottom Rail (F) into the first Bottom Gate Bracket (B) as illustrated.

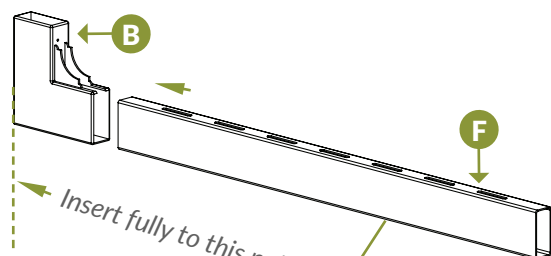

**Note:** The bottom rail doesn't have any picket holes on the bottom.

### STEP 2.2 ▶

- ▶ Insert the bottom rail into the opposite bottom gate bracket as illustrated.

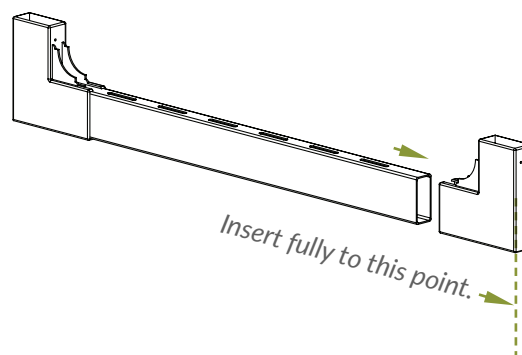

### STEP 2.3 ▶

- ▶ Insert Vertical Stiles (C). They will bottom out against bottom rail.

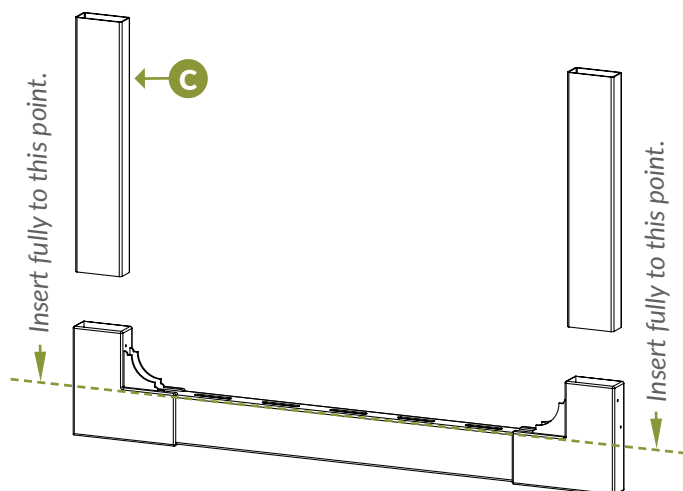

*Assembled gate frame bottom.*

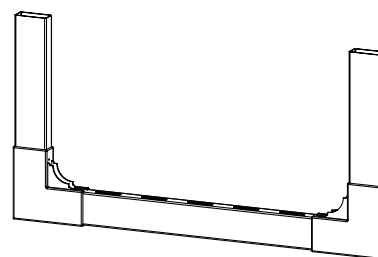

**STEP 2.4** ▶

- ▶ Insert the Top Rail (E) into the first Top Gate Bracket (A) as illustrated.

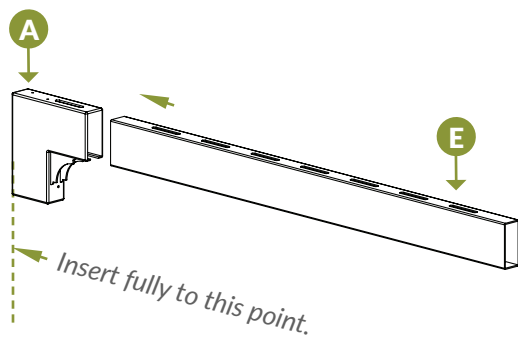
**STEP 2.5** ▶

- ▶ Insert the top rail into the opposite top gate bracket as illustrated.

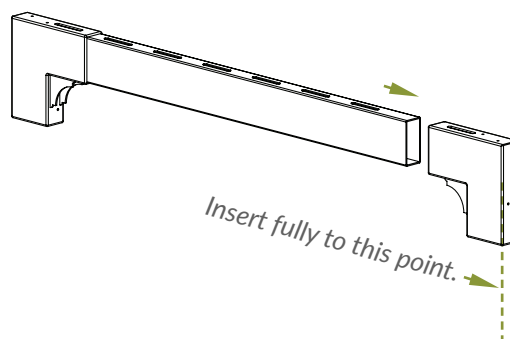
**STEP 2.6** ▶

- ▶ Slide the top gate brackets and the top rail down over the vertical stiles.

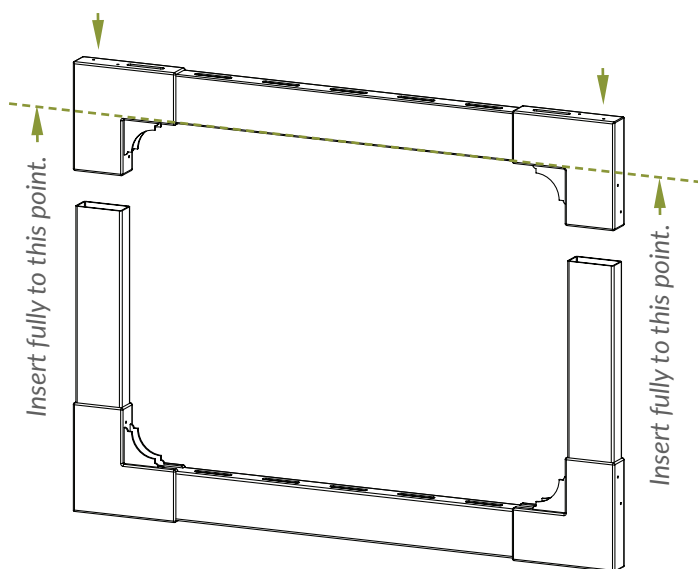

Assembled gate frame.

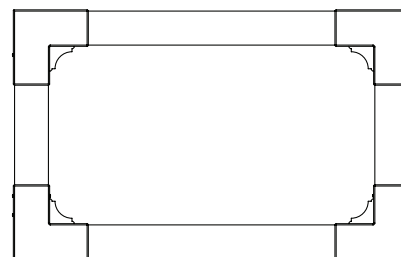

**STEP 2.7** ▶

▶ Fasten the gate brackets to frame with (24) 1¼" White Self-Drilling Stainless Steel Screws (G).

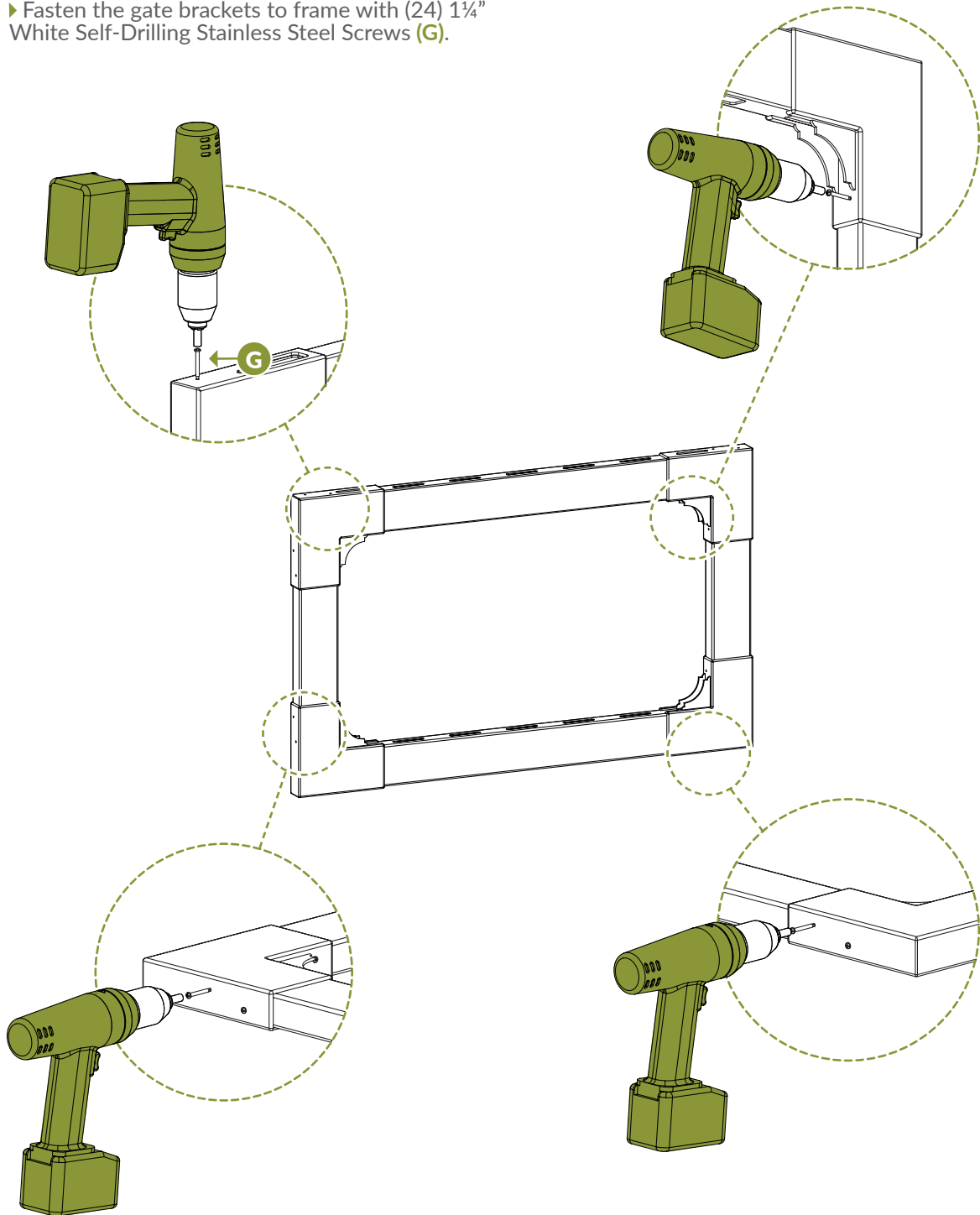



## STEP 3: INSERT PICKETS

### STEP 3.1 ▶

- ▶ Insert Pickets (D) through the top rail down into the bottom rail in the pattern indicated.

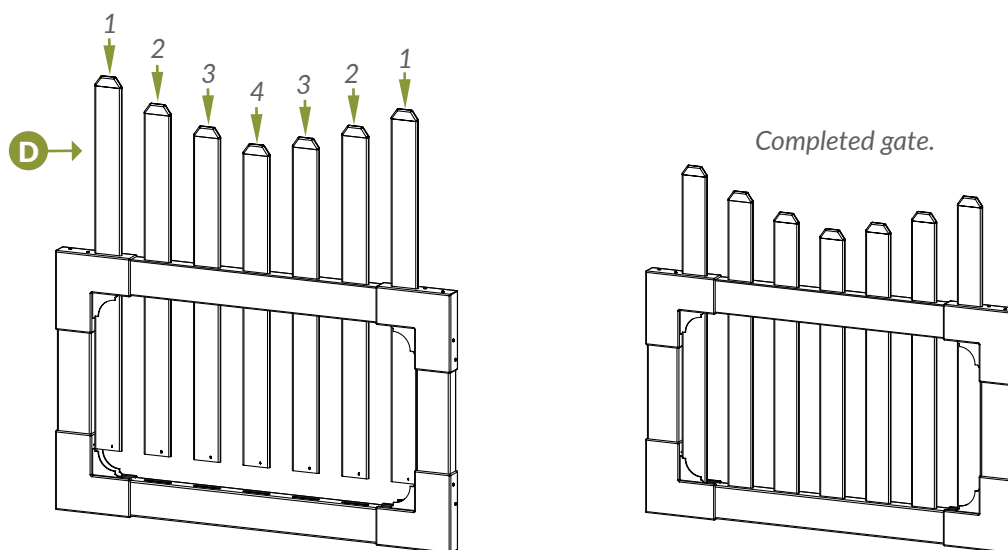

## STEP 4: FASTEN HINGES

### STEP 4.1 ▶

- ▶ Fasten the Hinges (J) onto the gate brackets with (8) 1 1/4" Black Self-Drilling Stainless Steel Screws (H).

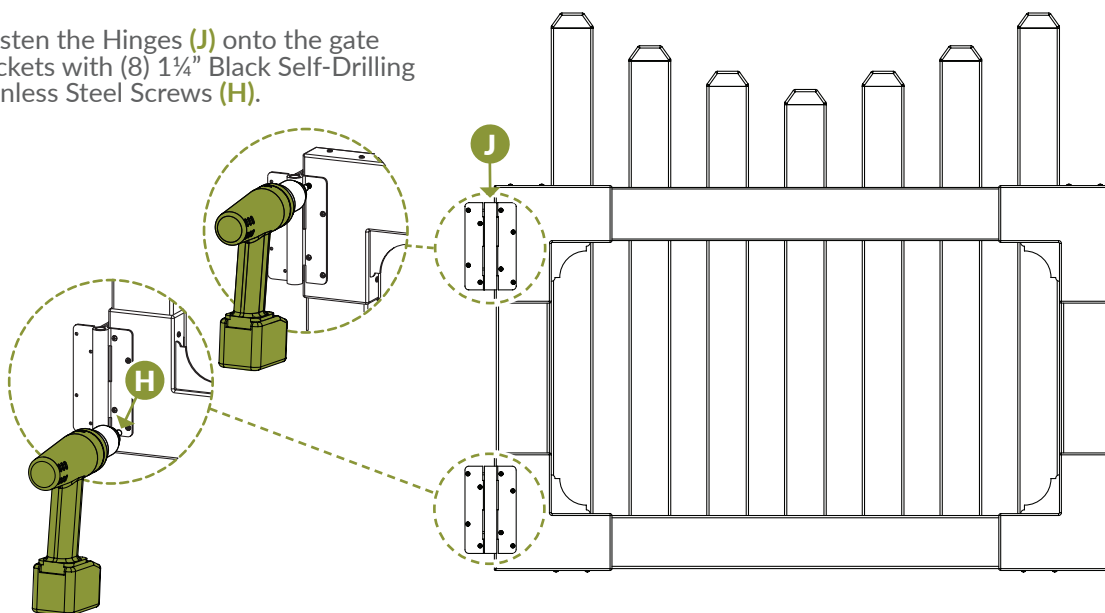

## STEP 5: ATTACH HINGES TO FENCE POSTS

### STEP 5.1 ▶

- ▶ Use temporary spacers or blocks to rest the gate on during installation.

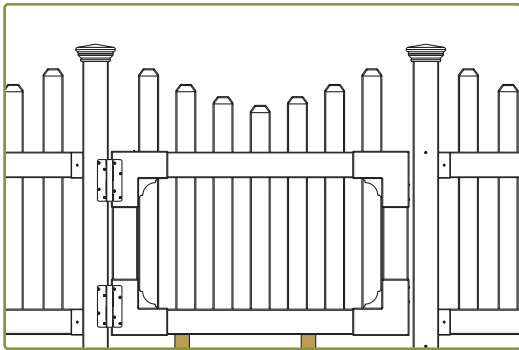

### STEP 5.2 ▶

- ▶ Fasten hinges to the post with (8) 1 1/4" black self-drilling stainless steel screws.

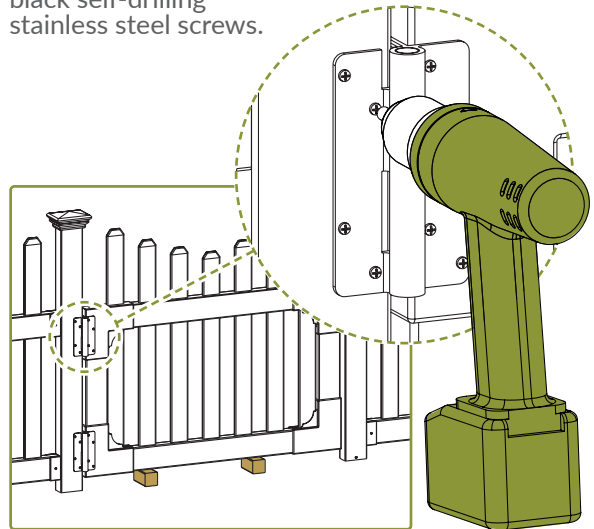

### STEP 5.3 ▶

- ▶ Open the gate and fasten the hinges to the post from the inside with (16) 1 1/4" black self-drilling stainless steel screws.

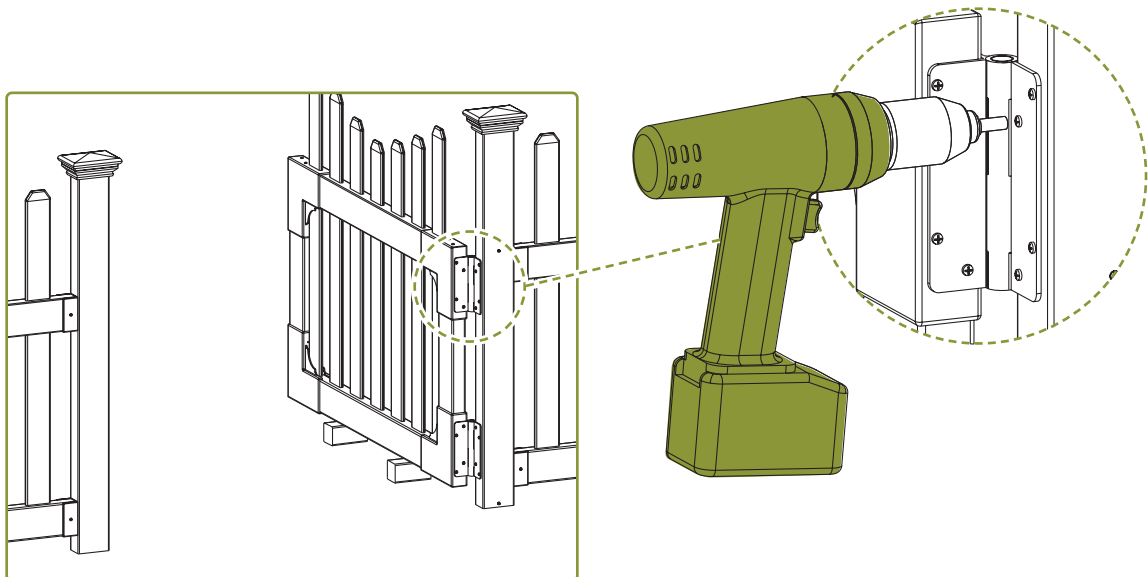

## STEP 6: INSTALL LATCH

### STEP 6.1 ▶▶

▶ Align and fasten the Latch Catch (L) to fit and function with the Latch Finger (K) using the (6)  $\frac{5}{8}$ " Black Self-Drilling Stainless Steel Screws (I).

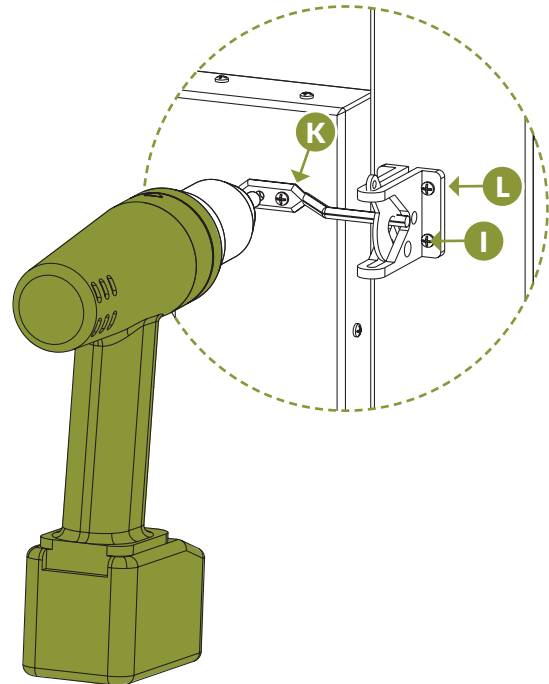
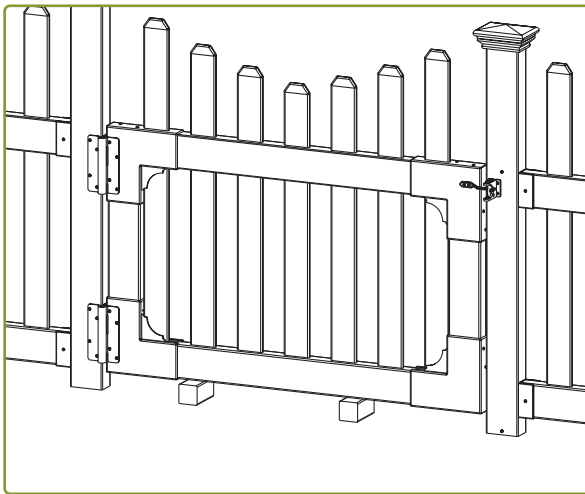

*Finished view of back of gate.*

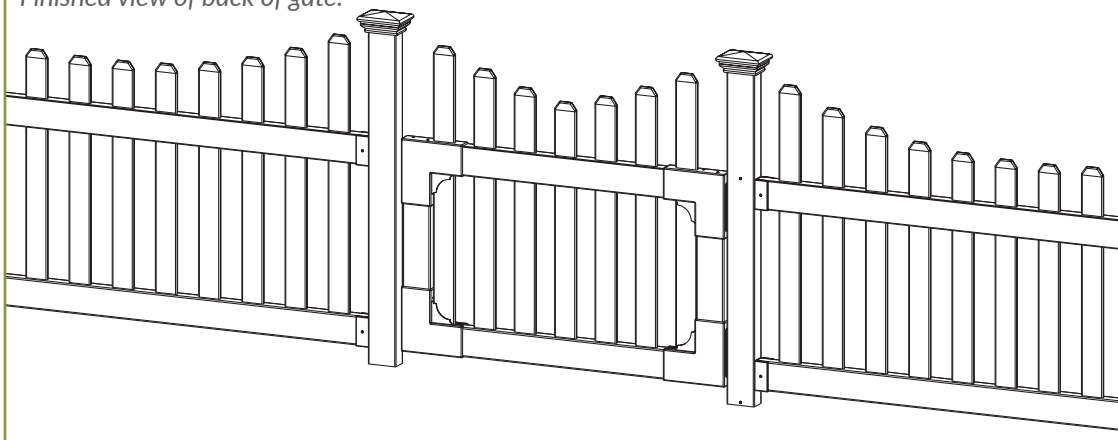



# ZIPPITY

*Easy Does It!*



6935 Reames Rd. Ste. K.  
Charlotte, NC 28216



[support@zippity-outdoor.com](mailto:support@zippity-outdoor.com)

704-892-5222  
877-234-6196



[WWW.ZIPPITY-OUTDOOR.COM](http://WWW.ZIPPITY-OUTDOOR.COM)