

### BEFORE YOU BEGIN

#### HOW TO USE THESE INSTRUCTIONS

Please read these instructions carefully to familiarize yourself with the required tools, materials, and installation sequences. Follow the sections that pertain to your particular installation. This will help you avoid costly mistakes. In addition to proper installation, read all operating and safety instructions.

All information in these instructions is based on the latest product information available at the time of publication. Kohler Co. reserves the right to make changes in product characteristics, packaging, or availability at any time without notice.

These instructions contain important care, cleaning, and warranty information – **please leave for the consumer.**

#### NOTES

- This instruction provides installation details for undercounter sink installations.
- Due to the nature of undercounter installations, Kohler Co. recommends that undercounter sink installations be performed by trained and experienced installers.
- To ensure a safe and damage-free installation, **two people should install the sink.**
- Observe all local plumbing and building codes.
- Shut off the hot and cold water supplies.
- Inspect the waste and supply tubing; replace as needed.
- Prior to installation, unpack the new sink and carefully inspect it for damage. Return the sink to its protective carton until you are ready to install it.
- **For multiple-bowl installations**, additional support will be required between bowls installed in countertops that are less than 1" thick.
- **For multiple-bowl, undercounter installations**, a minimum distance of 3-1/4" is required between cut-outs.
- A minimum countertop thickness of 1" is required if using the anchors provided.

#### TOOLS AND MATERIALS REQUIRED

- Safety glasses
- Pencil
- Scissors
- Tape measure
- Plumbers putty
- Hacksaw
- Sealant
- Hole saw (1-3/8" dia.)
- Keyhole saw or saber saw
- Drill (1/2" dia. drill bit or larger)
- Two adjustable wrenches
- Pipe wrench
- Tubing cutter

# ROUGHING-IN

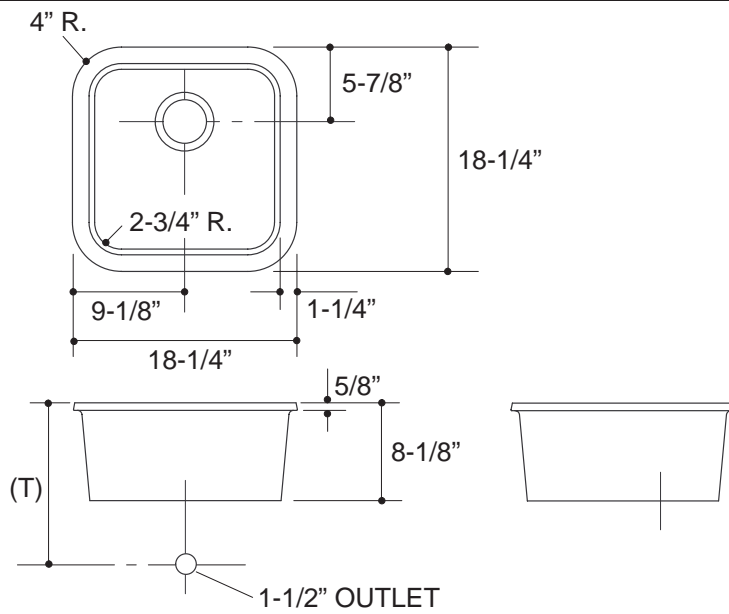
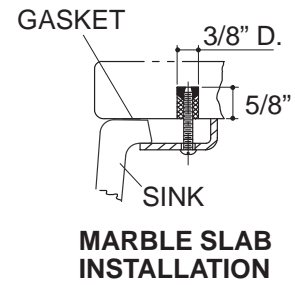

Fig. #1



# INSTALLATION

## FOR ALL INSTALLATIONS

Cut along the inside of the line which is labeled “CUT ALONG THIS LINE”.

Position the template on the countertop. The centerlines are provided on the template to help with alignment. Check for adequate clearance between the fixture, faucet, and backsplash (finished wall), and make sure neither the fixture or faucet will interfere with the cabinet during installation.

**For multiple-bowl installations,** additional support will be required between bowls installed in countertops that are less than 1" thick.

**For multiple-bowl, undercounter installations,** a minimum distance of 3-1/4" is required between cut-outs.

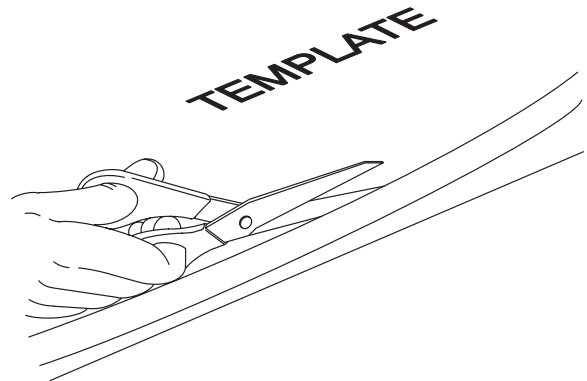

Fig. #2

Trace the cutout opening on the countertop with a soft lead pencil. This is the CUTTING LINE.

Locate the faucet hole centerlines on the countertop. Re-check for adequate clearance between the backsplash, faucet, fixture, and cabinet.

A minimum distance of 2-3/4" is required between the faucet centerline and the edge of the template. Adjust the template as needed. Remove the template, and save it for consumer reference.

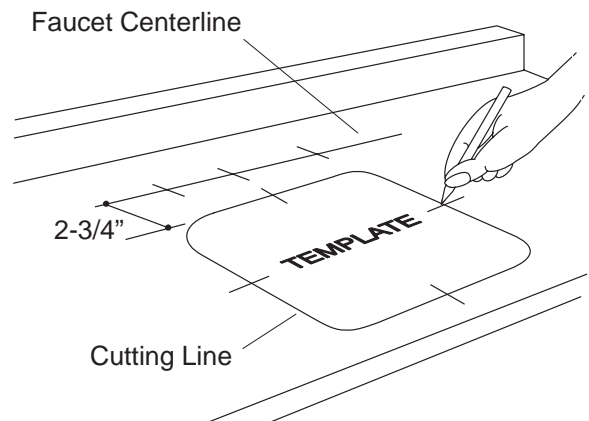

Fig. #3

Cut out all required openings in the countertop by cutting inside the pencil line traced from the template.

**CAUTION: Risk of product damage.** Do not cut, drill, or sand the countertop while it is positioned over the fixture.

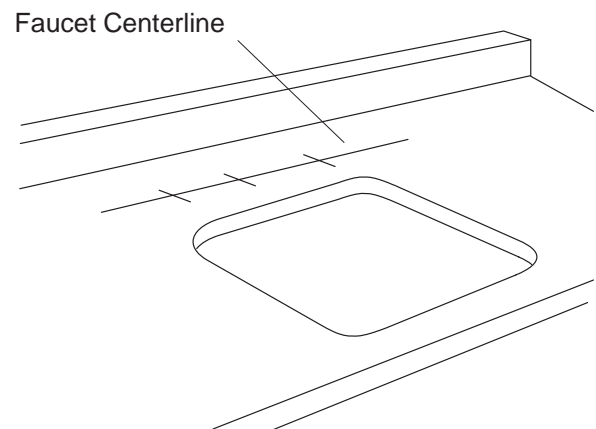
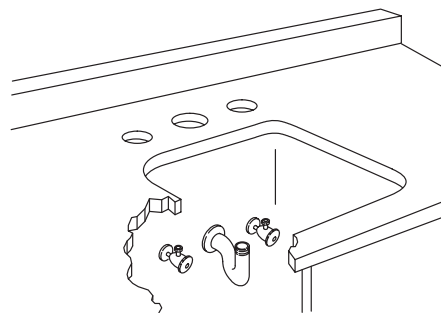

Fig. #4

Drill the required faucet holes, and install the faucet to the countertop according to the faucet manufacturer's instructions.

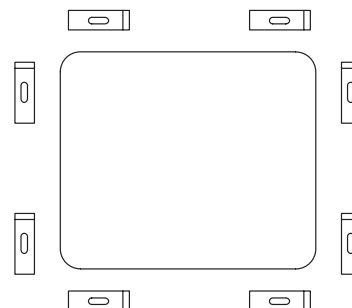

**Fig. #5**

Equally space the clamps, and locate the clamp-mounting holes on the underside of the countertop.

For installation to solid surface countertops, drill 3/8" diameter holes 5/8" deep to accommodate the anchors provided. Install the anchors flush with the countertop bottom surface. Install the clamps.

Turn the clamps parallel to the opening to allow for easy installation of the sink.



**Countertop Opening — Bottom View**

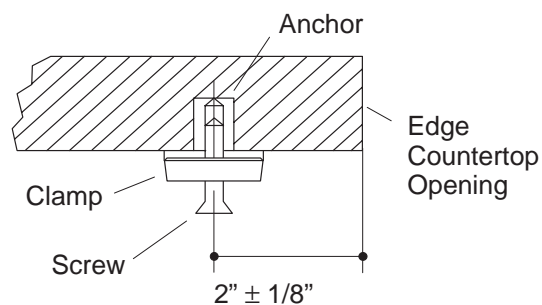
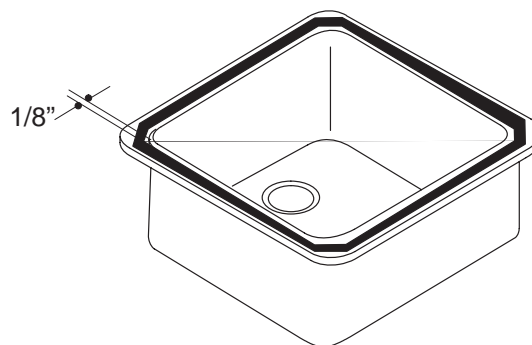

**Fig. #6**

Clean the top of the sink rim with a non-abrasive cleaner (see Important Consumer Information on Page 7).

Clean the underside of the countertop around the cutout area, making sure the surface is smooth, clean, and free of defects.

Remove paper from adhesive side of gasket and apply to top of rim as shown.



**Fig. #7**

Position and align the sink with the countertop cutout.

Rotate the clamps over the sink rim, and carefully tighten them until they are just snug.

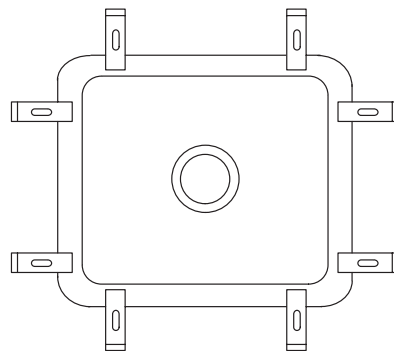

**Bottom View**

**Fig. #8**

Check the alignment of the sink with the cutout. Then securely tighten the clamps.

OPTIONAL: Apply a bead of sealant between the countertop and top of sink rim.

Wipe away any excess sealant with a clean, dry cloth.

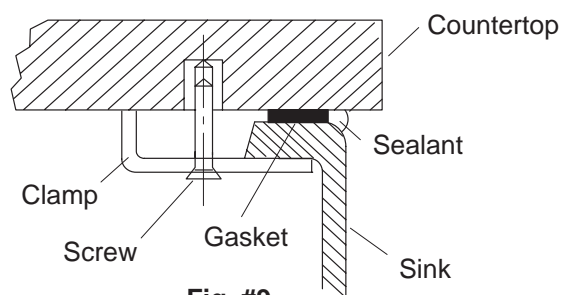
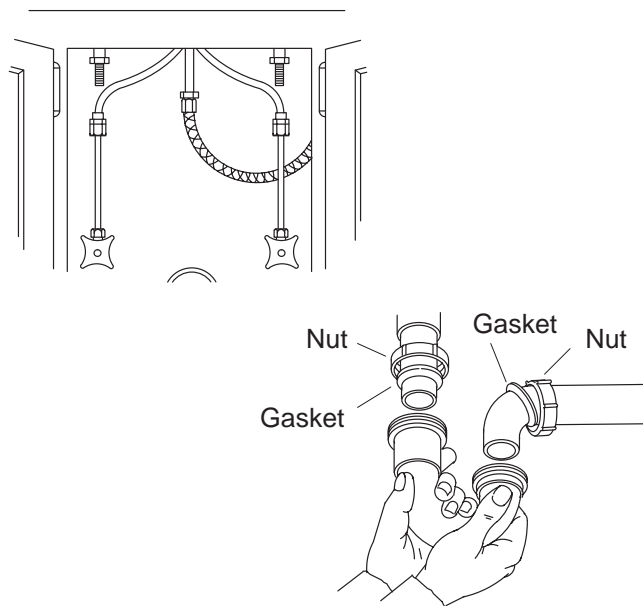

**Fig. #9**

Allow the sealant to set for 30 minutes or more. Follow all instructions listed on the sealant label.

Connect the drain fittings and the faucet supply fittings.

Turn on the water supplies, and check for leaks at all connections. Tighten or repair any connections that leak.

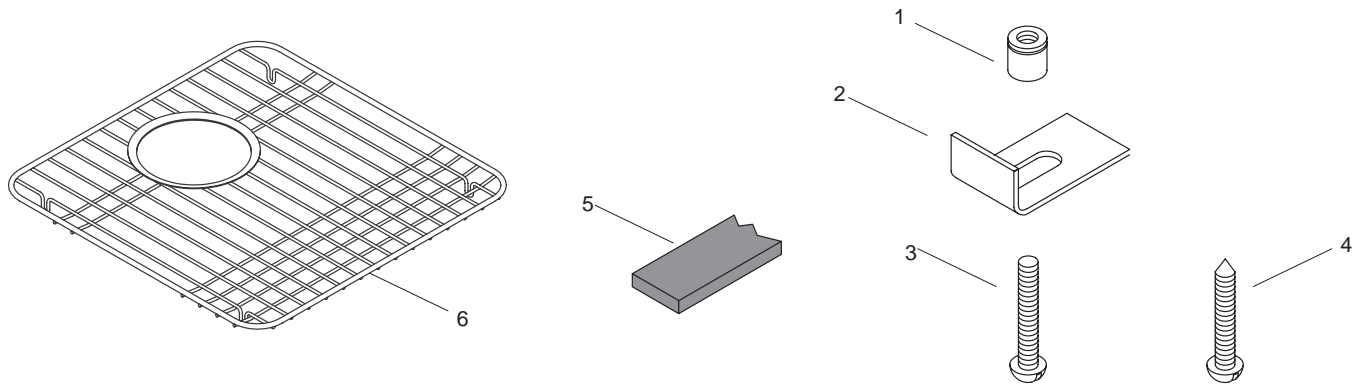

**Fig. #10**

## PARTS INFORMATION

**NOTE:** Part numbers listed refer to service parts and may not correspond to production part numbers packed with fixture.  
Order by service part number only.

ITEM NO.	PART NO.	DESCRIPTION
1	44596	Anchor
2	44597	Clamp
3	44598	Screw
4	68918	Screw
5	84724	Gasket
6	84745	Bottom Basin Rack



## IMPORTANT CONSUMER INFORMATION

### CARE AND CLEANING

A routine cleaning with a mild cleanser, especially if living in a hard water area, will maintain the finish of this sink.

Do not use abrasive cleaners or solvents.

To avoid potential damage to the finish, avoid soaking dishes for a very long time and refrain from leaving coffee grounds and tea bags in the sink.

### REQUESTING SERVICE

Please take a moment to familiarize yourself with the Kohler Warranty, its benefits, and limitations. Kohler Co. and its distributors support you with one of the largest Service Networks of its type. Here's what you need to do if you require service:

**FIRST:** Contact the dealer or contractor who sold and installed the product. They should be able to solve any problems you may have.

**SECOND:** If your dealer or contractor cannot solve the problem, they will contact or supply you with the name of the local Kohler Distributor and the:



**KOHLER TECHNICAL SPECIALIST**

**THIRD:** If you are unable to obtain warranty service through either your contractor or Kohler Co. distributor, please write us directly at Kohler Co., Attn: Customer Service Department, 444 Highland Drive, Kohler, WI 53044 U.S.A.

**FOURTH:** Include all pertinent information regarding your claim, including a complete description of the product, model numbers, colors, finishes, and the date the product was installed. Include a description of the problem, and a photocopy of your invoice for the products involved. Also give us the name of the contractor and distributor.

### LIMITED ONE-YEAR WARRANTY

Kohler plumbing fixtures and fittings are warranted free of manufacturing defects.

Kohler Co. will, at its election repair, replace, or make appropriate adjustment where Kohler Co. inspection discloses any such defects occurring in normal usage within one year after installation. Kohler Co. is not responsible for installation costs.

To obtain warranty service, contact Kohler Co. either through your Dealer or Plumbing Contractor or by writing Kohler Co., Attn: Customer Service Department, 444 Highland Drive, Kohler, WI 53044 U.S.A., or by calling **1-800-4-KOHLER** from within the U.S.A.

**Implied warranties, including that of merchantability and fitness for a particular purpose, are expressly limited in duration to the duration of this warranty. To the extent permitted by law, Kohler Co. disclaims all implied warranties including merchantability and fitness for a particular purpose. Kohler Co. disclaims any liability for special, incidental, or consequential damages.**

Some states do not allow limitations on how long an implied warranty lasts or the exclusion or limitation of incidental or consequential damages, so this limitation and exclusion may not apply to you. This warranty gives you specific legal rights. You may also have rights which vary from state to state.

This is our exclusive written warranty.

KOHLER CO., KOHLER, WISCONSIN 53044

