



QUICK ASSEMBLY SHEET

Models: 7920, 7921, 7924, 7925, 7940

Tools Needed: Two 7/16" wrenches

Hardware

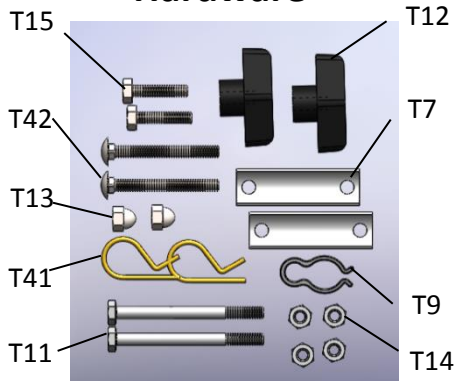

- T15** - 1/4-20 x 1.125" cap screws
- T42** - 1/4-20 x 2.25" carriage bolts
- T13** - Acorn Nut
- T41** - Tine Retaining pins
- T11** - 1/4-20 x 3" hex bolt
- T14** - 1/4-20 two-way lock nut
- T9** - Throttle clip
- T7** - Clamp
- T12** - Knob

Throttle Clip

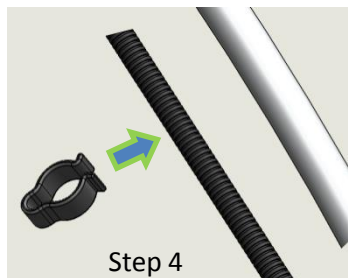

Use the clip **T9** to secure the throttle cable and wire in place on the Right Lower Handle.

Lower Handles

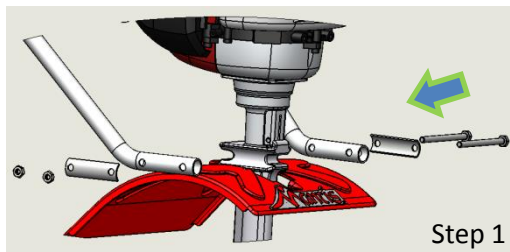

Slide two (2) **T11** bolts through the holes of one Handle Clamp and then through the holes of the Left Lower Handle. Position the bolts so that one bolt is in front and one bolt is behind the recessed channels of the transmission housing. Slide the Right Lower Handle and the second Handle Clamp onto the bolts. Finger tighten the nuts **T14**.

Carry Handle

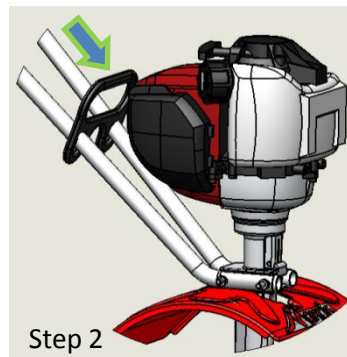

Slide the Carrying Handle over both Lower Handles. Slide it down towards the engine. It will rest about four to six inches above the engine.

Upper Handles

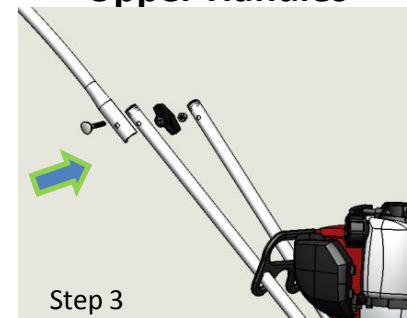

Attach the Upper Throttle Handle onto the Right Lower Handle. Fasten together using the Knob **T12** and carriage bolt **T42**. Place an acorn nut **T13** on the end of the carriage bolt. Repeat this process for the Left Upper Handle.

Handle Brace

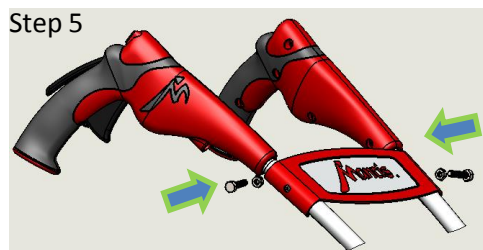

Line up the Handle Brace with the holes on the Upper Handles. Insert cap screws **T15** through the holes in the Handle Brace and through the holes on the Upper Handles. Secure with a lock nut **T14**.

Tighten Hardware

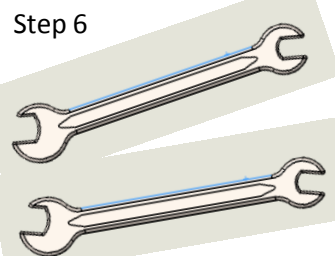

Tighten all lock nuts, cap screws, and bolts firmly and securely using two 7/16" wrenches.
Note: Do not over-tighten the acorn nuts.

Tine Installation

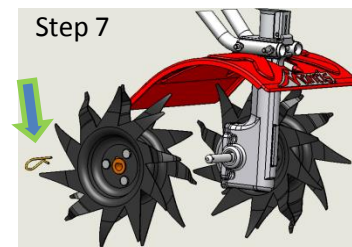

Slide the tines onto the axle shafts. The "D-shaped" hole goes on the outside. Secure each tine to the axle by inserting a tine retaining pin **T41**.



QUICK ASSEMBLY SHEET

Kickstand Assembly for Models 7924, 7925, 7940

Tools Needed: 3/8" wrench.

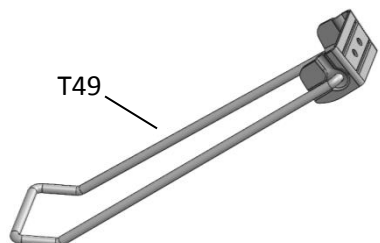
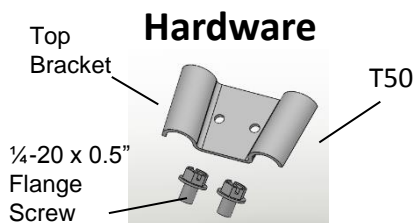

T50- Kickstand bracket and hardware bag
T49- Kickstand Stand Assembly

Top Bracket

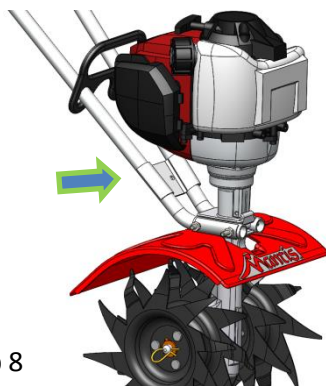

Step 8

Lean the Tiller Handles against a sturdy surface, so the tiller is supported in the upright position. Place the Top Bracket over the Lower Handles and below the Carry Handle.

Bottom Bracket

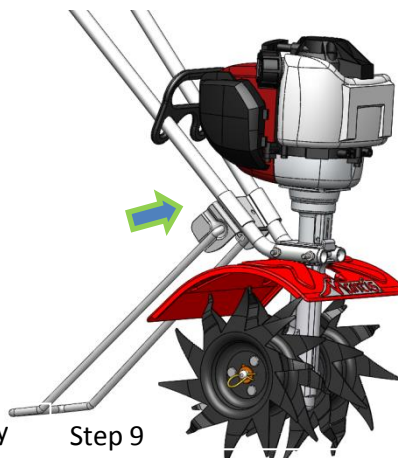

Step 9

Place the Bottom Bracket of the Kickstand Stand Assembly T49 under the Lower Handles and line up the holes in both brackets.

Tighten Hardware

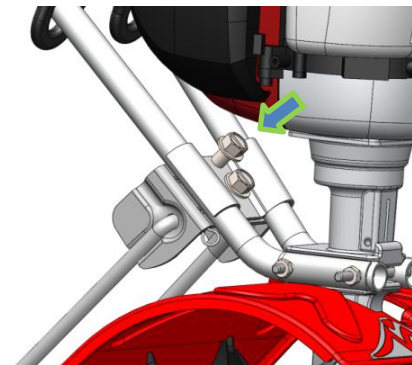

Step 10

Insert two screws through the holes in the Top Bracket and into the threaded inserts of the Lower Bracket. Tighten with the 3/8" wrench.

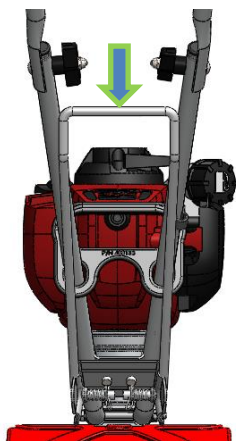

Kickstand Position

Place the Kickstand in the folded position. The Kickstand should be centered between the Lower Handles. If not, loosen the screws slightly, adjust as necessary and retighten the screws.

Step 11

IMPORTANT NOTE:
Read the Safety Rules & Warnings before you use your Mantis tiller

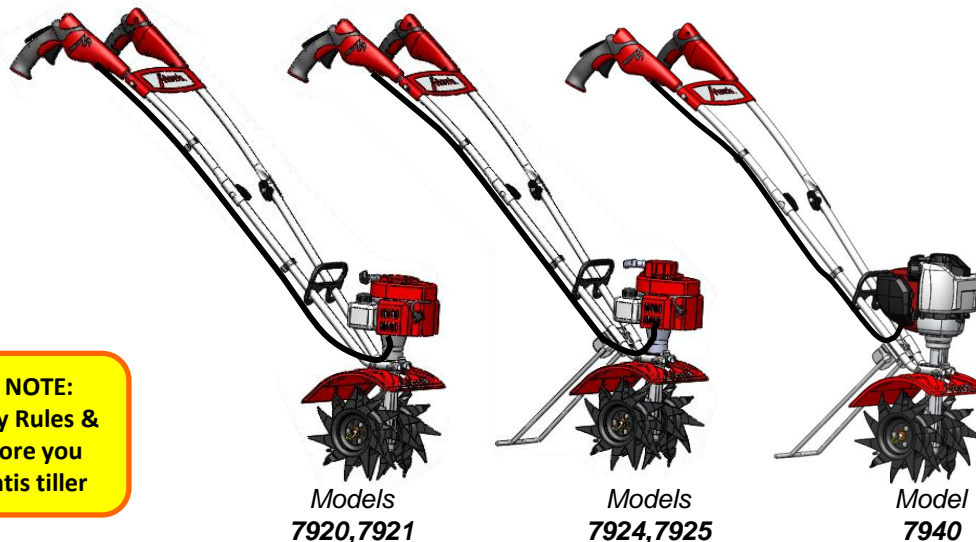

Models
7920, 7921

Models
7924, 7925

Model
7940