

HHM5SRWW

Hotpoint® 4.9 Cu. Ft. Manual Defrost Chest Freezer

DIMENSIONS AND INSTALLATION INFORMATION

AIR CLEARANCE	
Back Air Clearances (in.)	2
Side Air Clearances (in.)	2

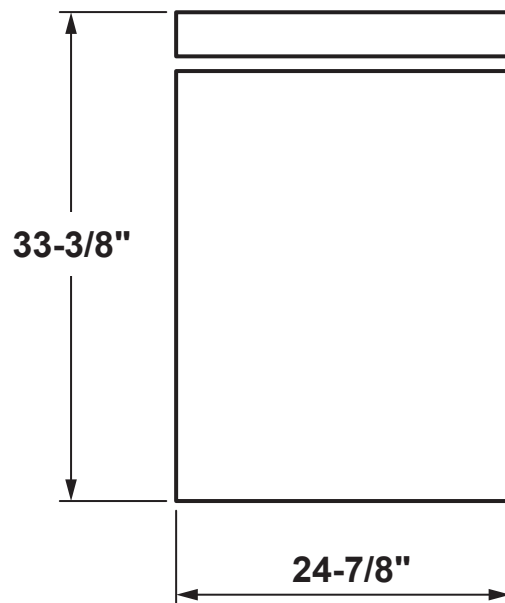

FRONT VIEW

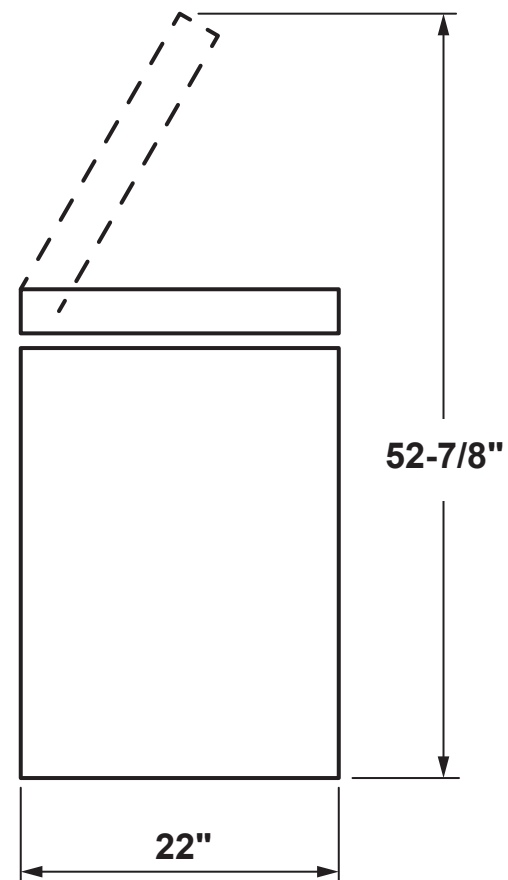

SIDE VIEW

Hotpoint®

For answers to your Monogram, GE Café™, GE Profile™, GE Appliances or Hotpoint product questions, visit our website at geappliances.com or call GE Answer Center® Service, 800.626.2000.



Specification Created 5/21

HHM5SRWW

Hotpoint® 4.9 Cu. Ft. Manual Defrost Chest Freezer

FEATURES AND BENEFITS

Total Capacity: 4.9 Cu Ft

ADA Compliant: No

Energy Star: No

Chest or Upright: Chest

Garage Ready: No

Defrost Type: Manual

Defrost Water Drain: Yes

Temperature Alarm: No

Power On Light: No

Lock w Key: No

Storage Drawer Material: Wire

Shelf Type: Wire

Control Type: Adjustable Temperature Control

Internal Lighting: No

Power/Ratings: Volts/Hertz/Amps, 115V; 60Hz; 1.7A

Model HHM5SRWW – White

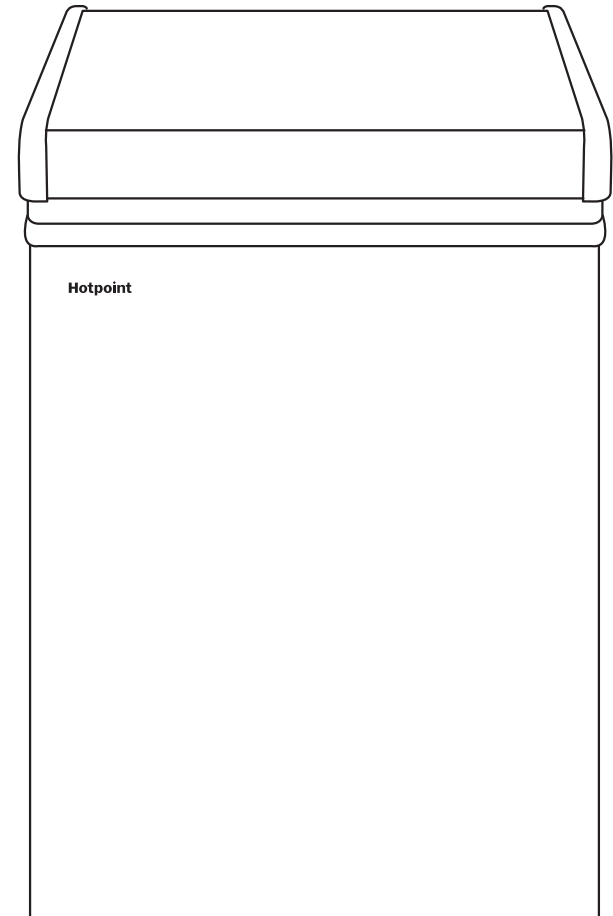

Hotpoint®