

ACCORDION DOOR

INSTALLATION MANUAL

In case of questions or missing parts, please contact

✉ aftersaledoor@outlook.com

If you have purchased a 48"-72" accordion door, you should first refer to page 2 and page 6.

Hardware Included

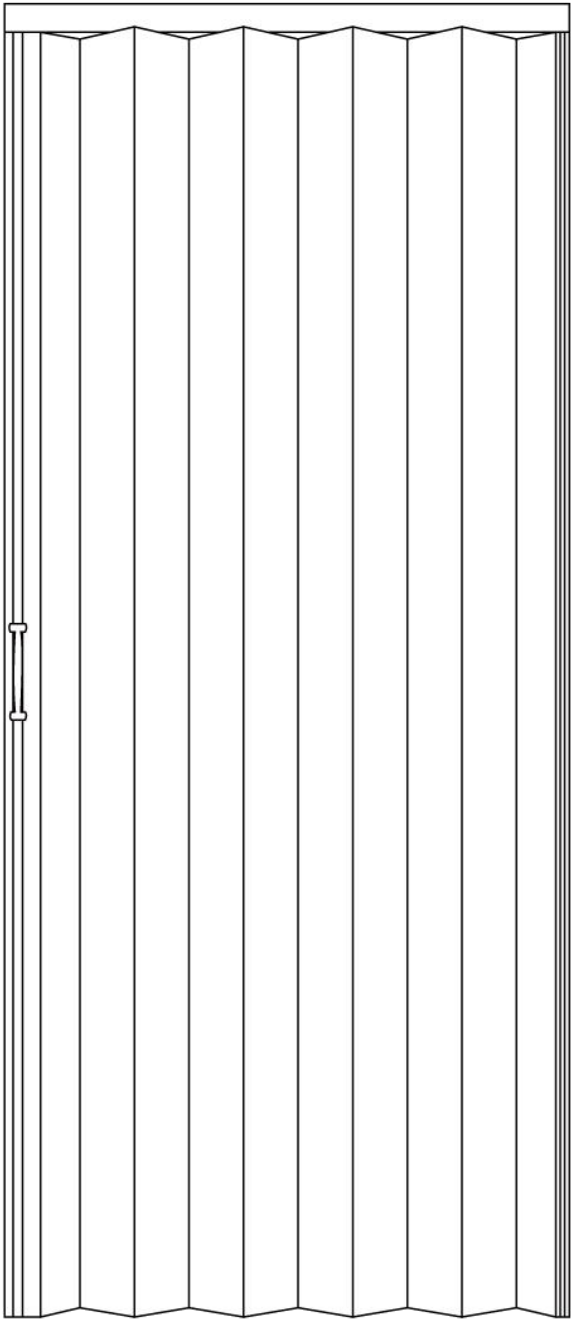

A. Accordion Door



B. Top Track



C. Iron Sheet



D. Handle

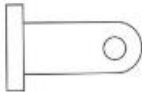

E.T Style Top Glide & Top Glide



F. male&maleScrew Set



G. TA Screw



H. FA Screw

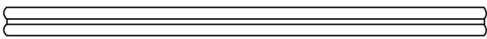

I. Bolt

1 Install the Top Track

Position the top track on the top of the door opening so that it is straight and centered. After making a pilot-hole (with a nail or 3/32" drill bit), drive a 1" track screw through the screw hole nearest the center of the track. Do not tighten. (Tape may be used to hold the track in place while you mark and drill.)

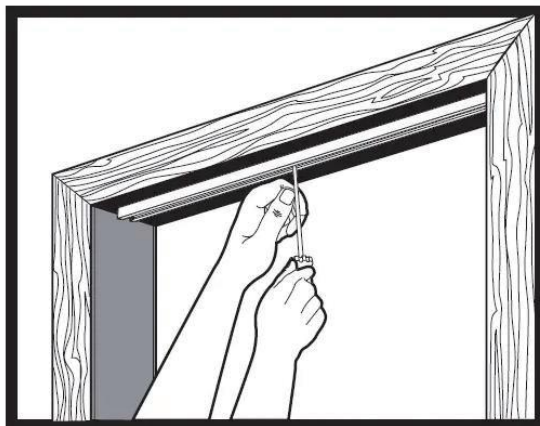

2 Install the Top Track

Install the two parts of pulley E onto the door. Handle is facing towards the opening side.

Pivot one end of the top track outward. Slide all of the top glides onto the top track. Stack the panels together near the center screw and pivot the top track back into place.

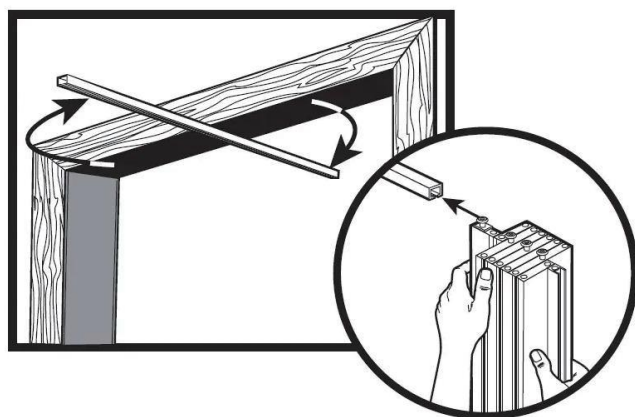
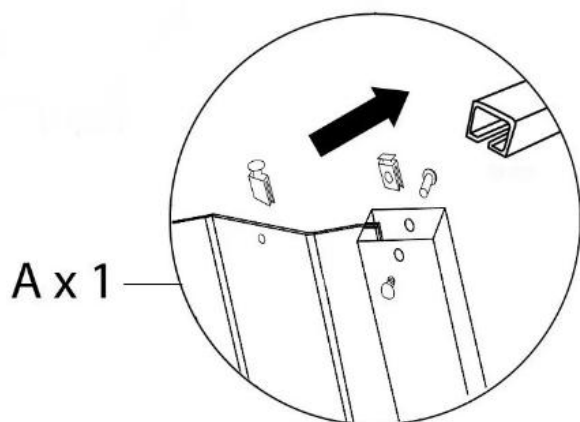

3 Secure the Top Track

Make sure the track is straight. Drill pilot holes through the remaining pre drilled holes in the top track and secure the track with the track screws provided. Set all screws as straight and tight as possible to ensure the smooth operation of the door. Be sure to fully tighten the first screw you installed in the track.

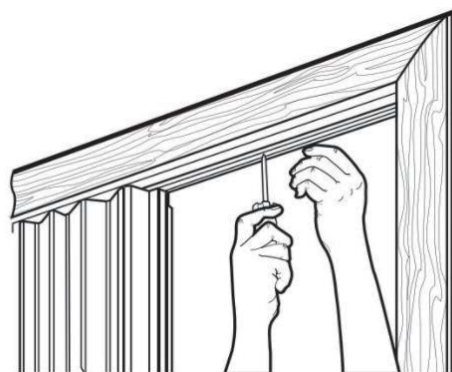

4 Install the Non-opening Side

Please fully open it and secure it using the provided flat-head screws. Attach the door to the door frame through the pre-drilled holes on the non-opening side.

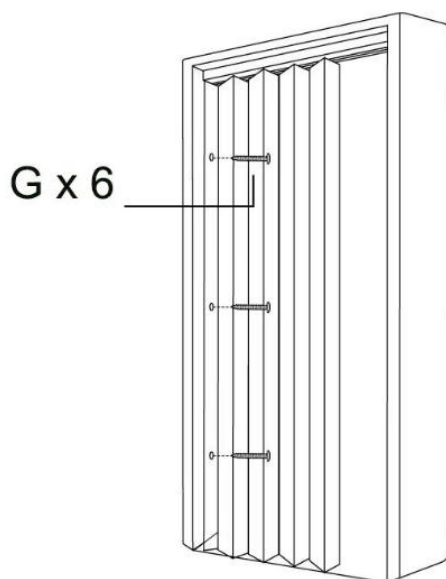

5 Install Handles

To fit the handles insert the two stainless steel pins into the two holes of the door jamb and then fix the pair of handles by pushing the handles onto each relative end of the pins until the handles press firmly against the door.

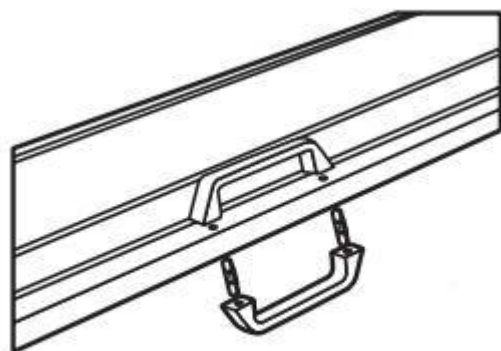

6 Install Magnetic Panel

Install iron sheet on the wall near the opening (on the side with the handle).

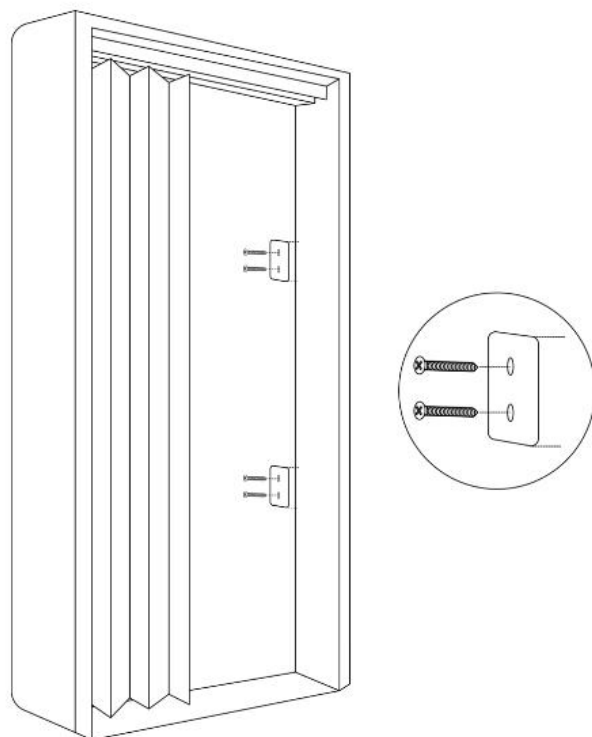

DOUBLE ACCORDION DOOR

Install DOUBLE ACCORDION DOOR

1 Install the First Panel

Follow the single door installation guide from Step 1 to Step 5 to install one side of the door.

Ensure the panel is securely mounted and operates smoothly. Handle is facing towards the opening side.

2 Install the Second Panel

Repeat the same installation process (Steps 1 to 5) for the second panel on the opposite side.

3 Align and Close

Once both panels are installed, align them so that they meet at the center. The doors will close securely using the magnetic switch located on the handle side of each panel.

