



# Stephen

## 60" x 32" Skirted Acrylic Combo Bath

Model Number  
**6032SWASR064**  
 Right Hand Drain Combo Bath in White  
**6032SWASL064**  
 Left Hand Drain Combo Bath in White

### Features

- Color-matched jet trim and air controls
- 10 adjustable hydrotherapy jets
- 20 high output lateral air injectors
- Pillow included
- Constructed of high-gloss durable acrylic
- 3-Speed control for the 9.0 Amp pump
- 12.0 Amp variable speed blower
- Textured floor
- Pre-leveled base for easy installation
- Made in the USA



**\*All dimensions are +/- 1/2" and subject to change without notice\***  
**Confirm specifications before installation**

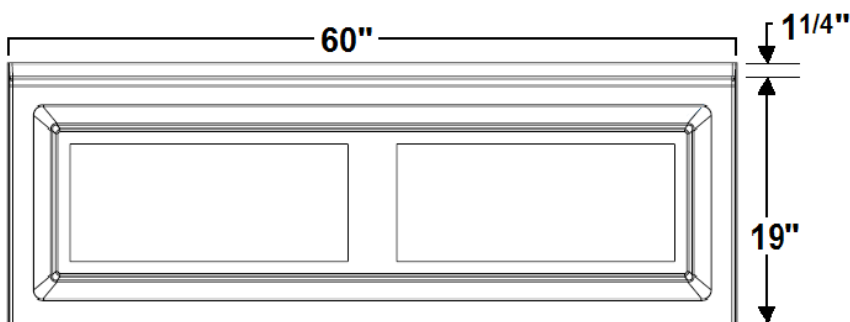
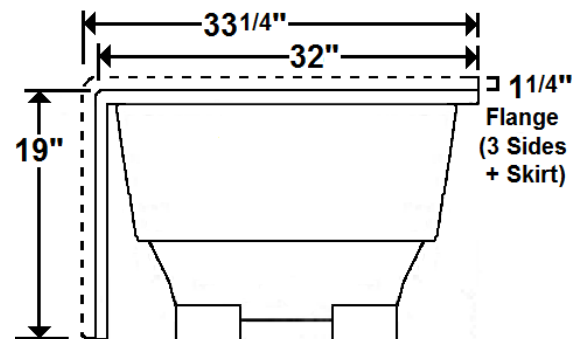
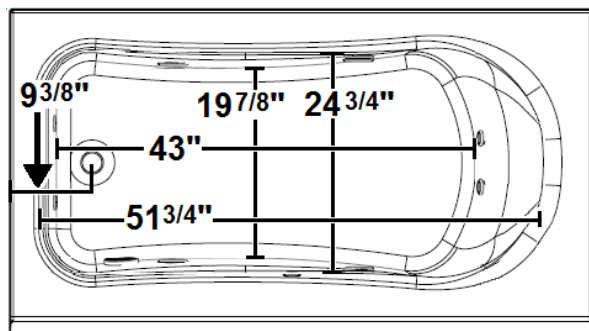

Standard (S) Pump Location

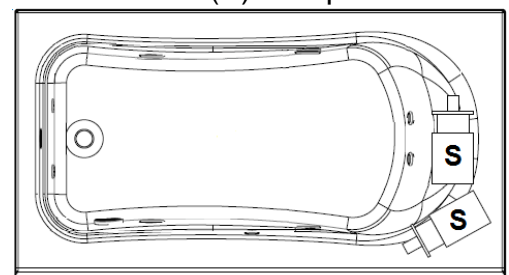

### Technical Information

- Weight: 192 lbs.
- Water Depth to Overflow: 13 5/8"
- Operating Capacity: 31 gal.
- Water Capacity: 53 gal.
- Sump Dimension: 43" x 19 7/8"

### Electrical Requirements

- Standard Pump: 9.0 Amps
- Standard Blower: 12.0 Amps
- 2, 20amp Dedicated GFCI's required