

ZIPPITY

Easy Does It!

WOODTEK POOLSIDE ORGANIZER (38" W X 51" L X 41" H)

ASSEMBLY INSTRUCTIONS ZP19078

60 MIN

Approximate assembly time

Want to see a video on how to
assemble this product?
Scan the QR code

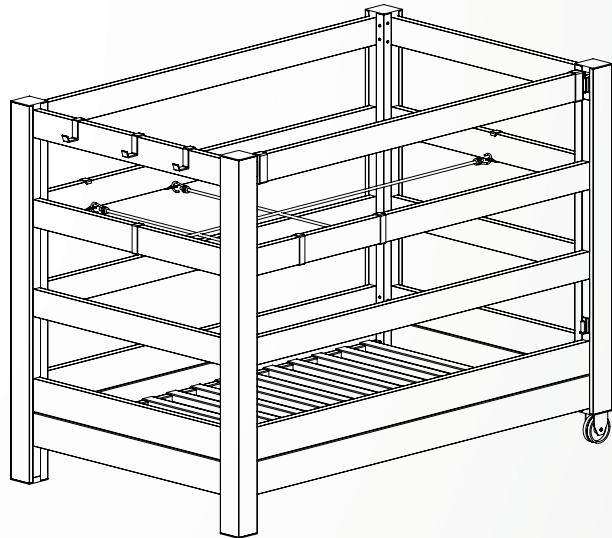

GENERAL INFORMATION

MISSING OR DAMAGED PARTS?



➤ **Visit Our Website**
so we can help you right away!
parts.nychbrands.com

* You can also reach us via phone or email.

Hours of Operation - **Weekdays 9am-5pm EST**

To better help you, **please have the following**

- Your product number (**ZP19078**)
- Your affected part letters (**page 4-7**)
- Your original product box

NEED ASSEMBLY HELP?

If you are having problems with assembly or installation of this product,
please contact at:

📞 **704-892-5222 / 877-234-6196** ✉ **support@zippity-outdoor.com**

NEED TO RETURN?

If for some reason you need to return this product, please allow us to help resolve your issues first. If you still decide to return the product, **you will need to initiate the return from the company you originally purchased from.**

Detailed Product Dimensions & Specifications

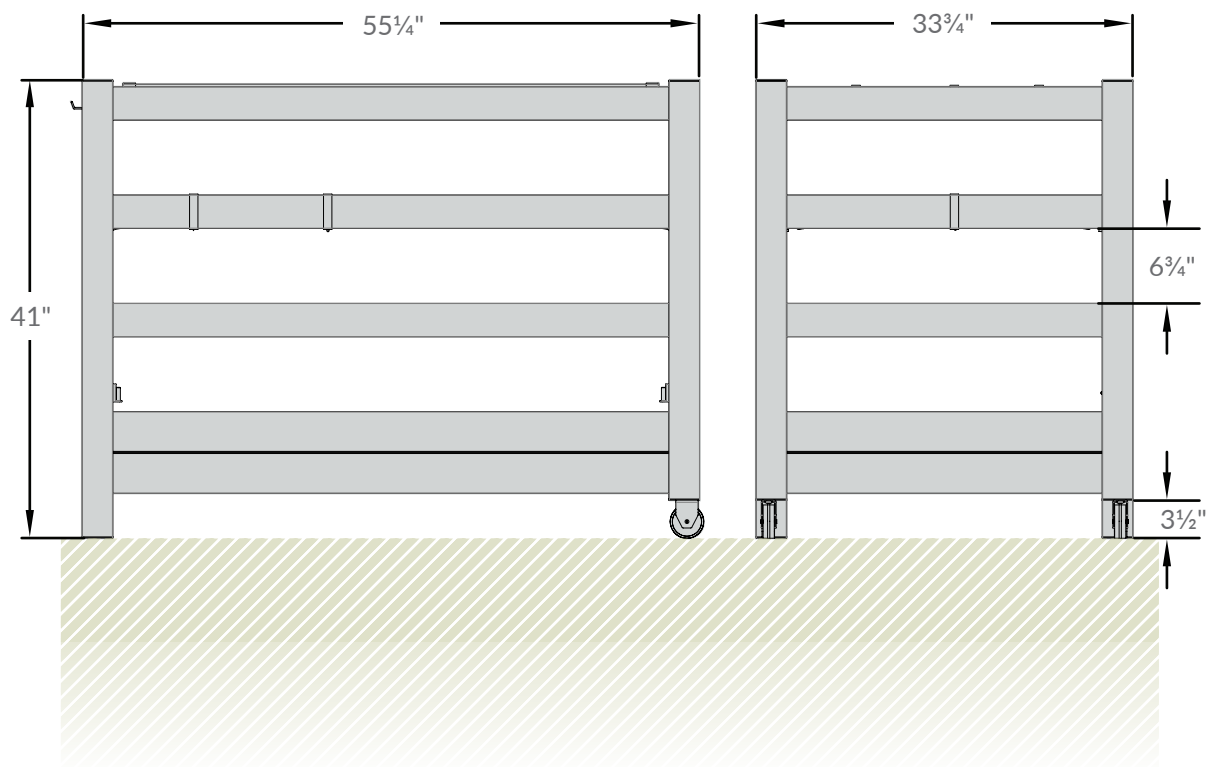

LAY OUT MATERIALS

► Tools required for a smoother installation experience.

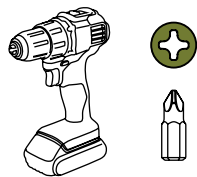

► Drill with Phillips bit

POSTS



A

Post A (1)
2 3/4" x 2 3/4" x 41"

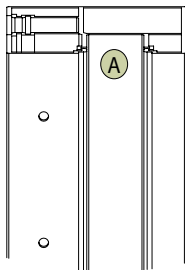

B

Post B (1)
2 3/4" x 2 3/4" x 41"

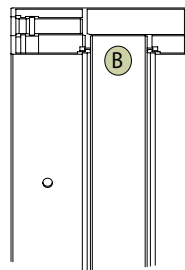

C

Post C (1)
2 3/4" x 2 3/4" x 41"

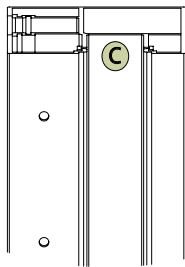

D

Post D (1)
2 3/4" x 2 3/4" x 41"

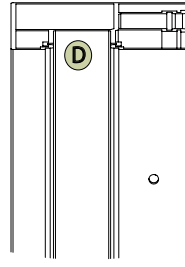

LAY OUT MATERIALS

WALLS

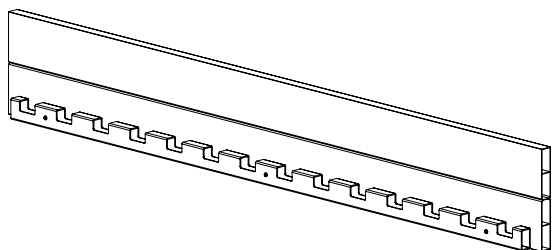

E

Long Bottom Board (2)
1 3/4" x 7 3/8" x 52"

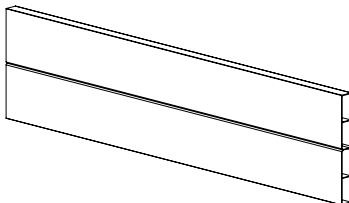

F

Short Bottom Board (2)
7 3/8" x 7 3/8" x 30 1/2"

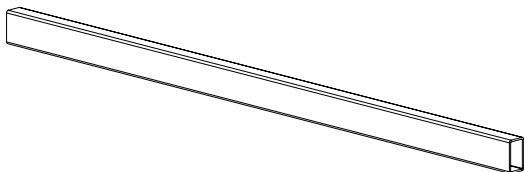

G

Floor Boards (14)
1 1/2" x 7 3/8" x 30 3/4"

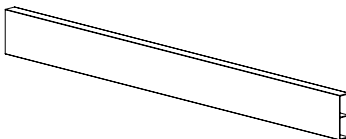

H

Short Slats (6)
3" x 7 3/8" x 30 1/2"

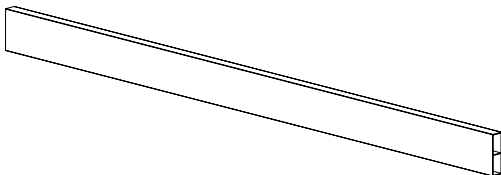

I

Long Adjustable Slat (1)
3" x 7 3/8" x 47 3/4"

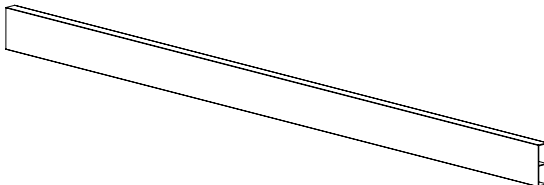

J

Long Slats (5)
3" x 7 3/8" x 52"

LAY OUT MATERIALS

SPACERS

K

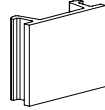

Spacer K (4)
 $\frac{7}{8}" \times 1\frac{1}{4}" \times \frac{3}{8}"$

L

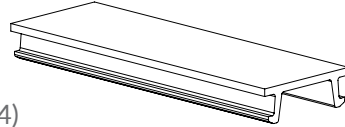

Spacer L (4)
 $3\frac{1}{2}" \times 1\frac{1}{4}" \times \frac{3}{8}"$

M

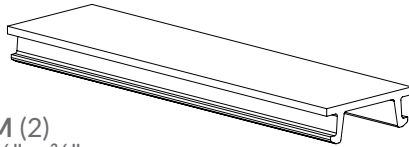

Spacer M (2)
 $4\frac{1}{4}" \times 1\frac{1}{4}" \times \frac{3}{8}"$

N

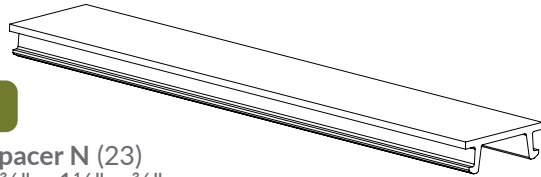

Spacer N (23)
 $6\frac{3}{4}" \times 1\frac{1}{4}" \times \frac{3}{8}"$

SMALL PARTS

O

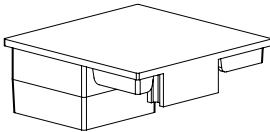

Post Cap (4)
 $2\frac{3}{4}" \times 2\frac{3}{4}" \times 1"$

P

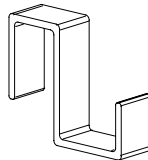

Towel Hook (3)

Q

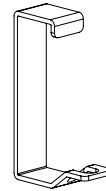

Bungee Bracket (6)

R

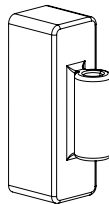

Rail Hinge (2)

S

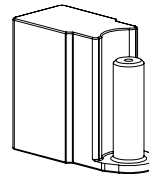

Post Hinge (4)

HARDWARE

T



Long Bungee (1)

U



Short Bungee (2)

V



Short Self-Drilling Screws (4)
 $.75"$

W



Long Self-Drilling Screws (36)
 $2.5"$

USE THIS PAGE TO MEASURE YOUR SPACERS.

N

$6\frac{3}{4}" \times 1\frac{1}{4}" \times \frac{3}{8}"$

M

$4\frac{1}{4}" \times 1\frac{1}{4}" \times \frac{3}{8}"$

L

$3\frac{1}{2}" \times 1\frac{1}{4}" \times \frac{3}{8}"$

K

$4\frac{1}{4}" \times 1\frac{1}{4}" \times \frac{3}{8}"$



ASSEMBLE UNIT

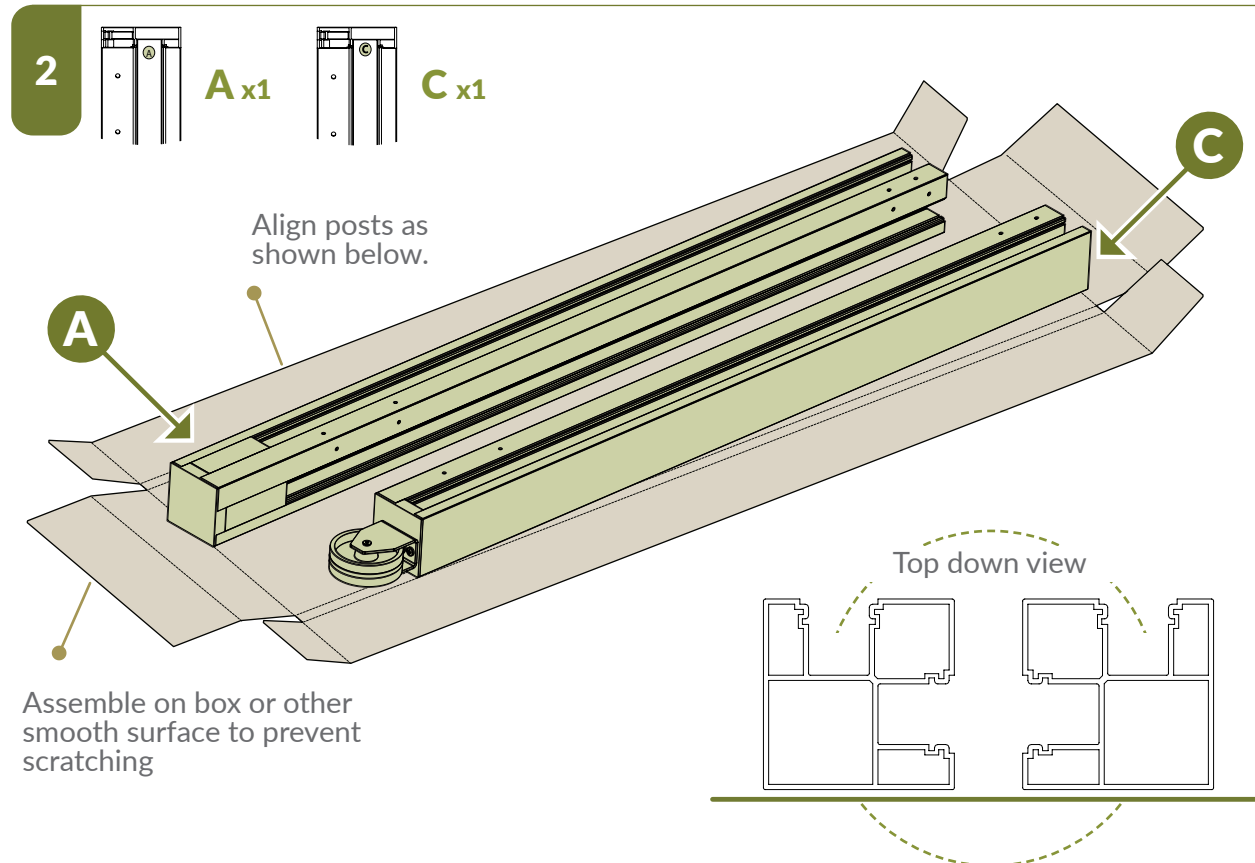
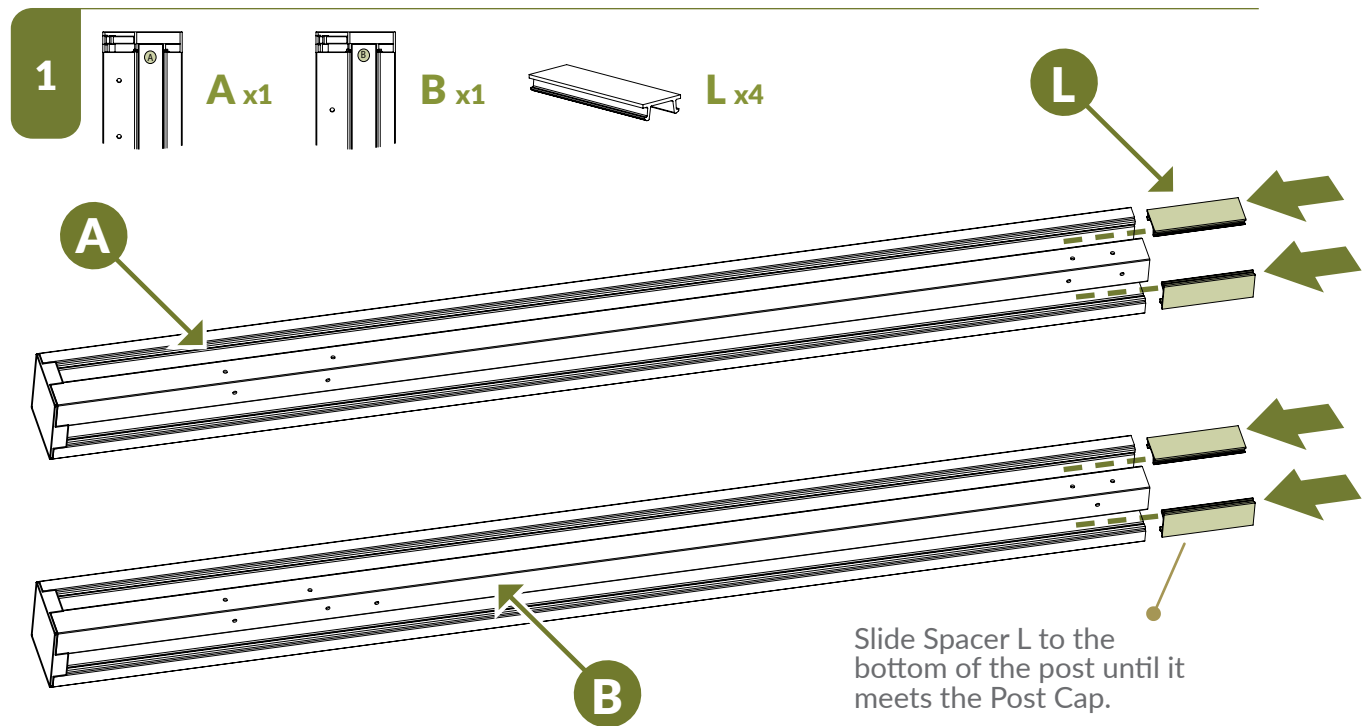

3

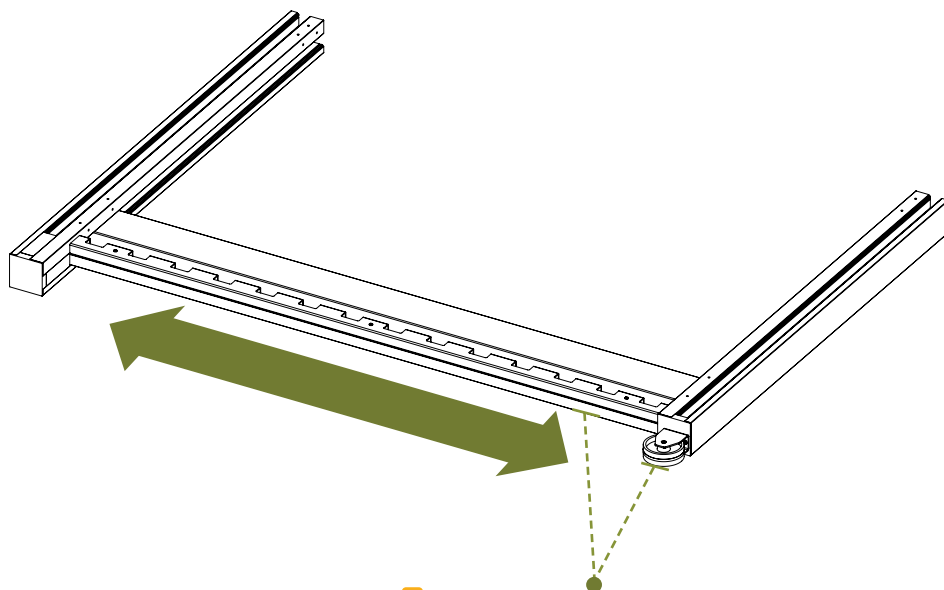
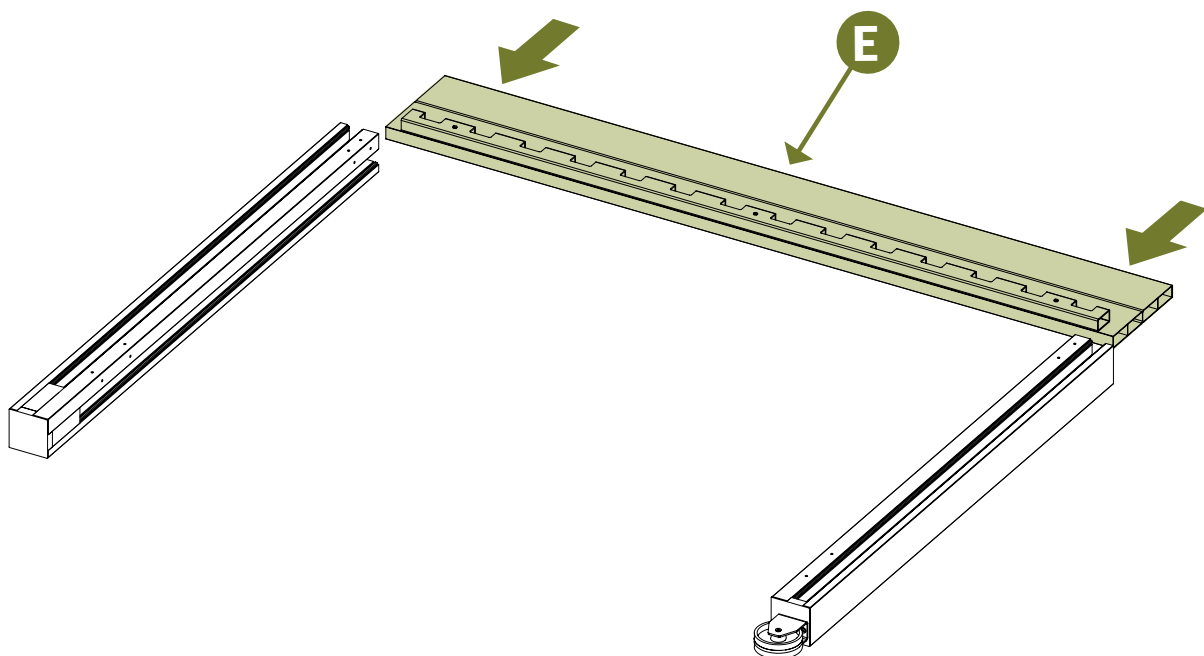
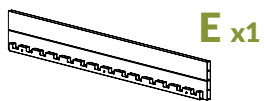

! Ensure that the wheel is inline with the bottom board (E)

4



W x4

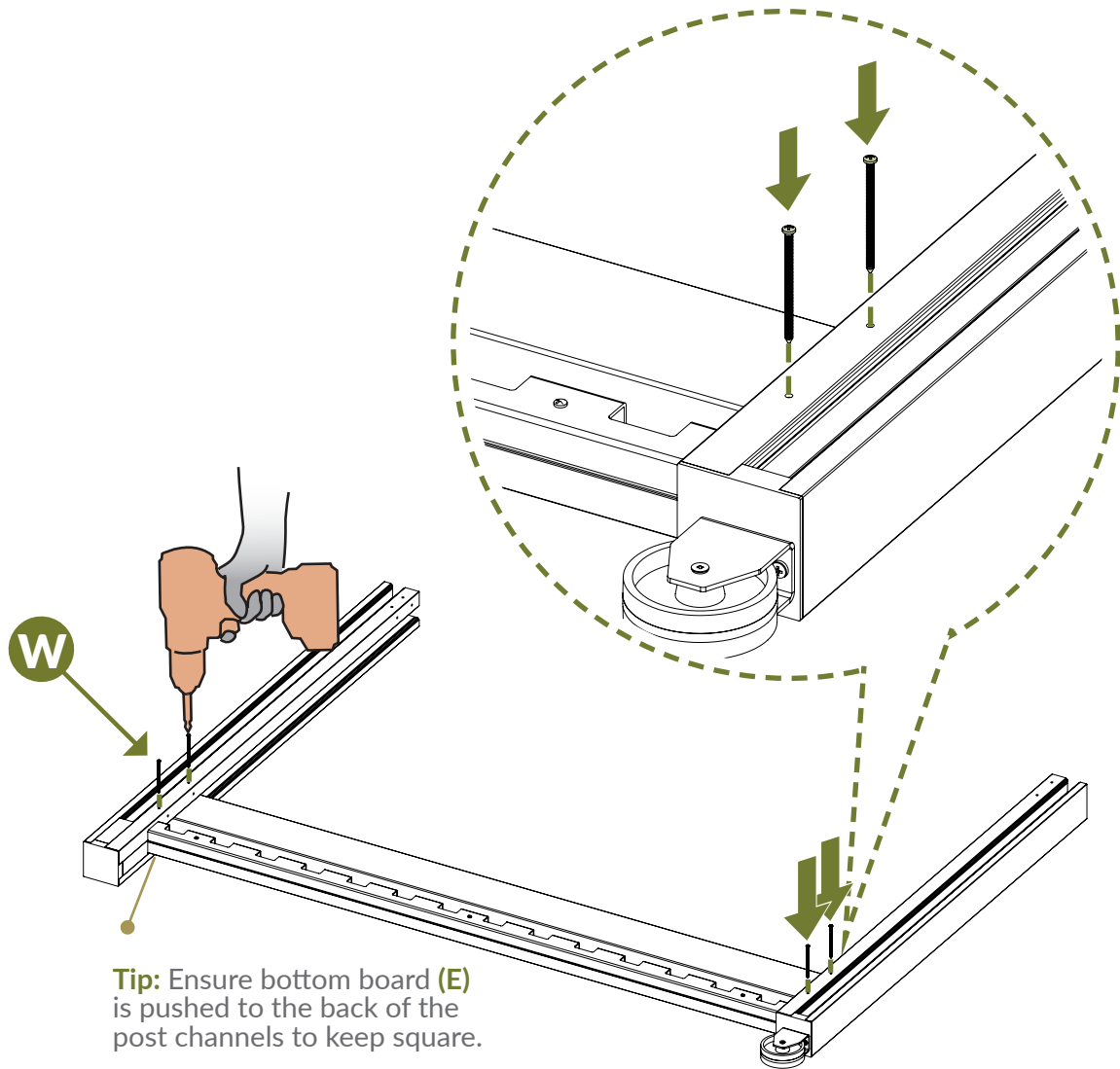

Tip: Ensure bottom board (E) is pushed to the back of the post channels to keep square.

5

Repeat steps 2-3 for opposite side using

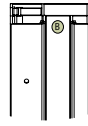

B x1

and

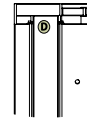

D x1

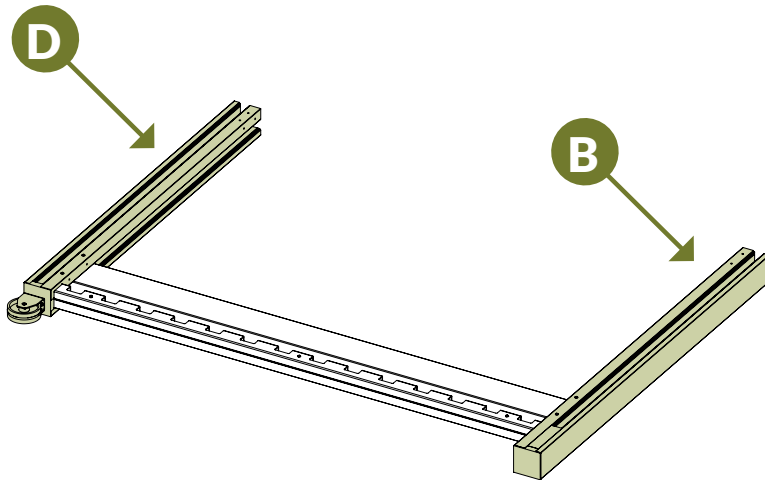

Repeat steps 3-4 to
create second panel

6



F x2

F

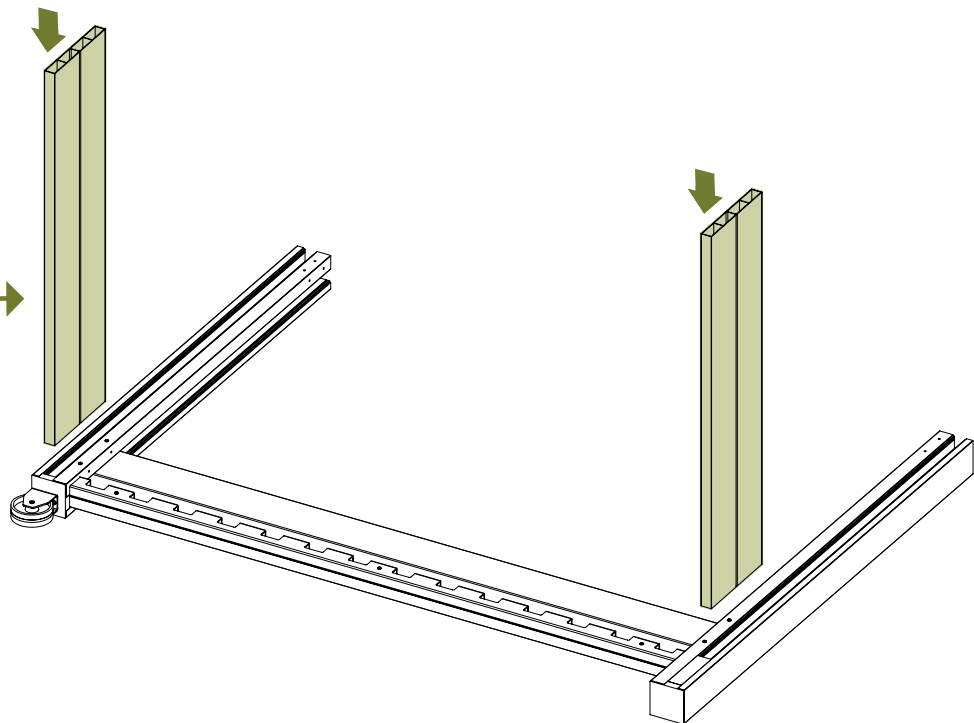

7



W x4

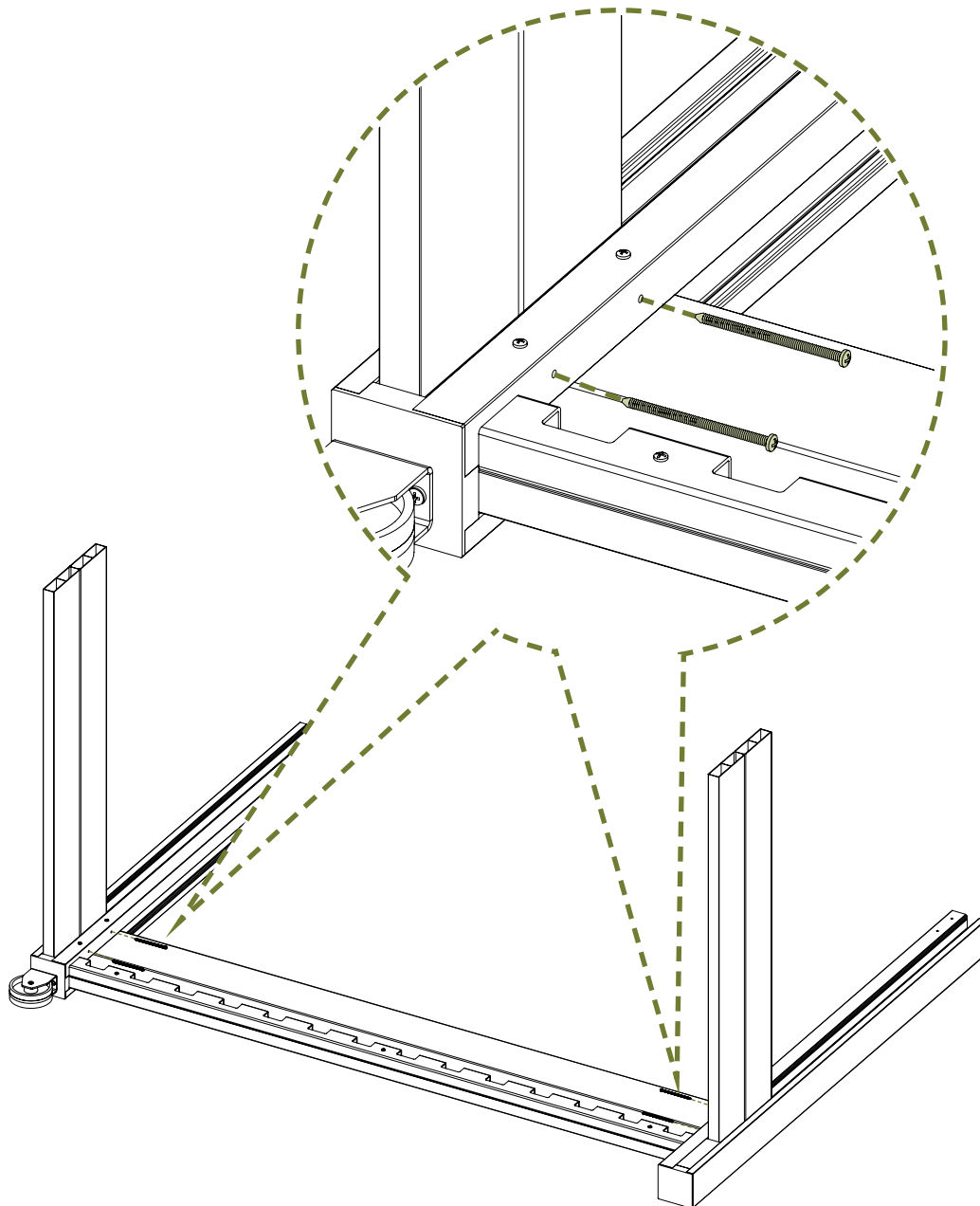

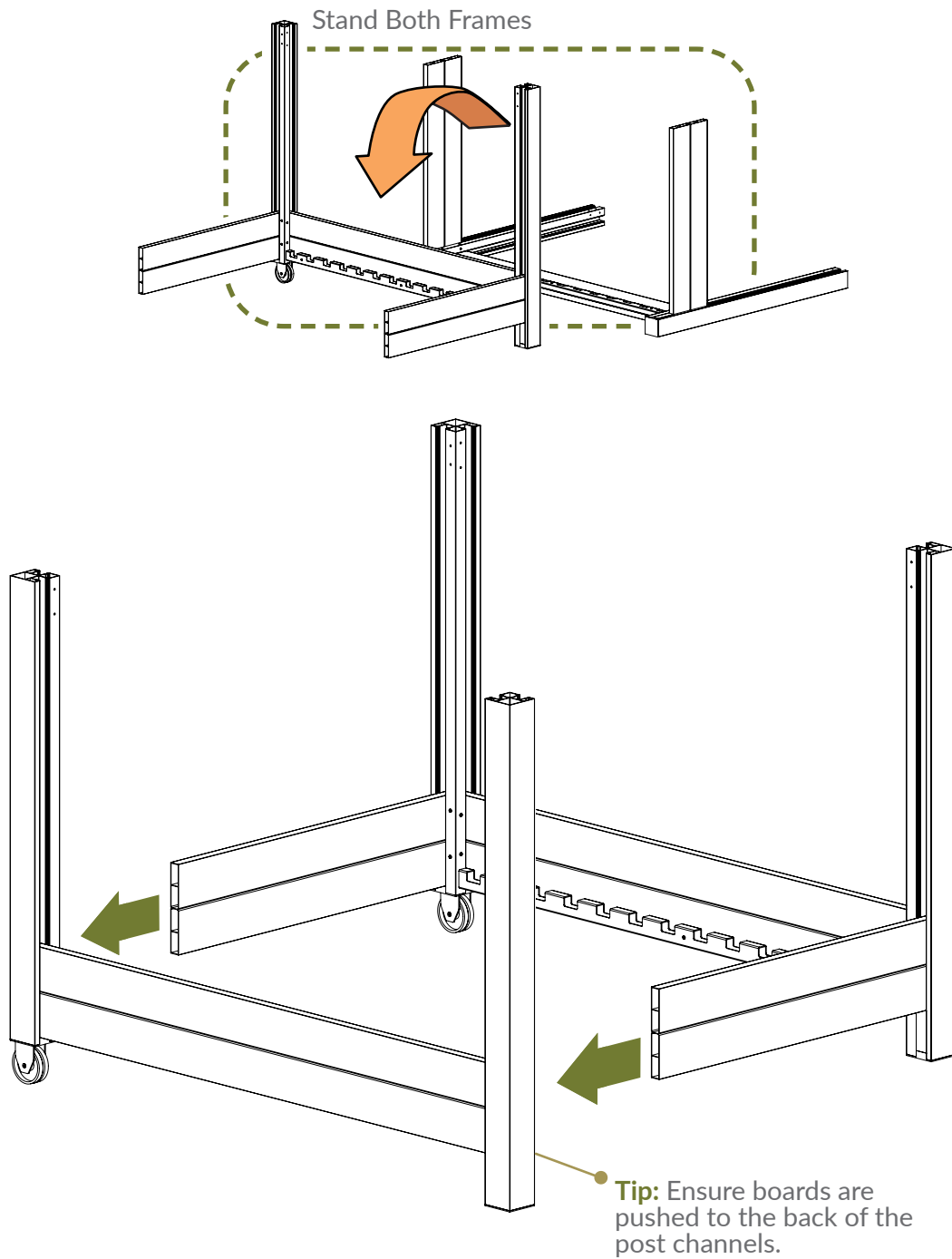

9



W x4

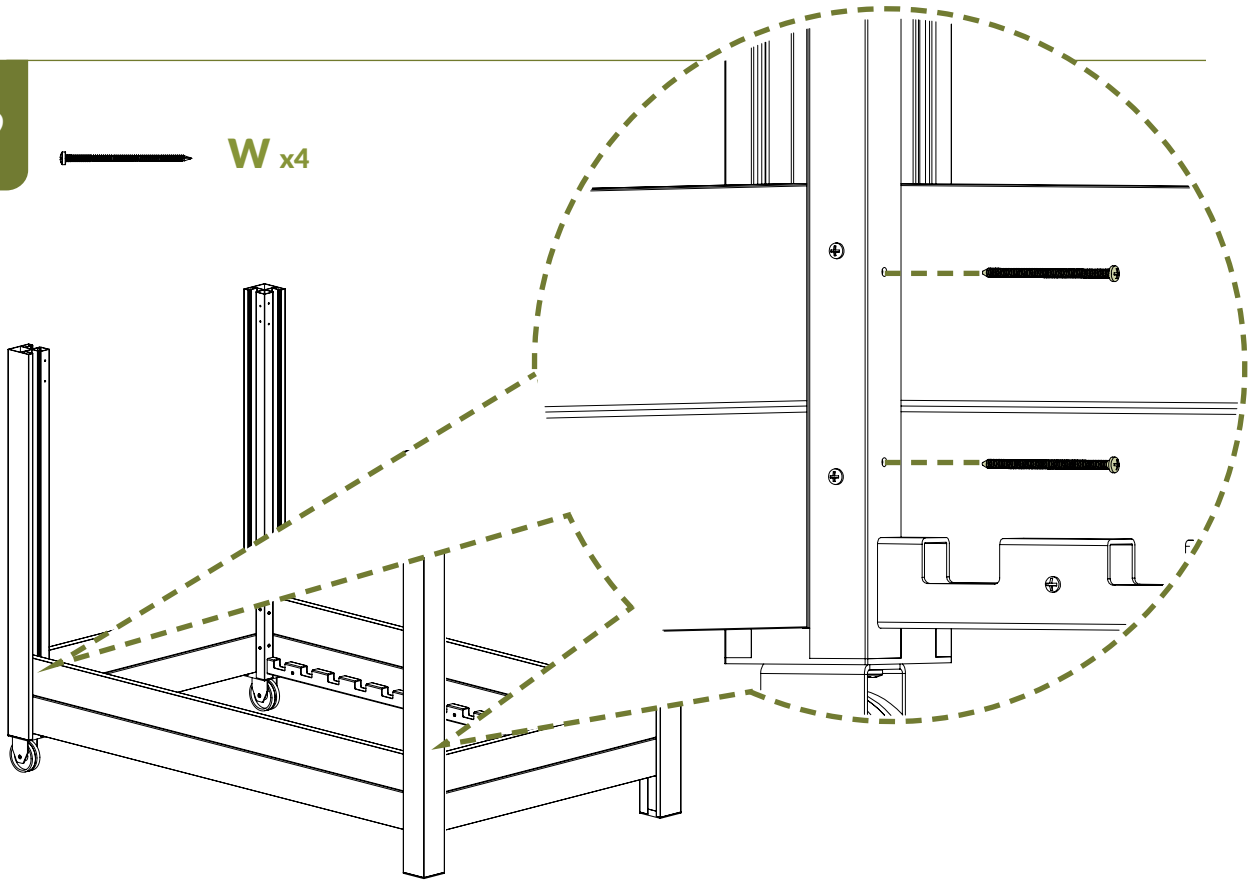

10



G x14

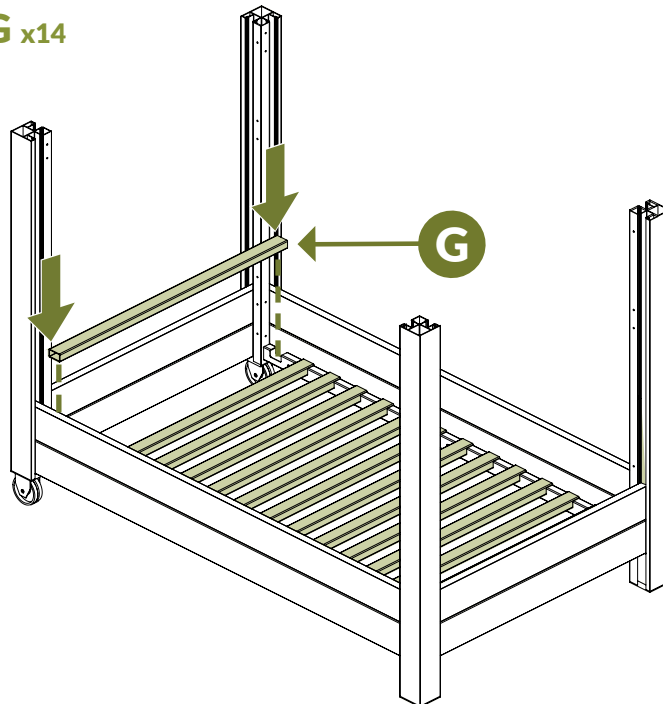

11



N x6

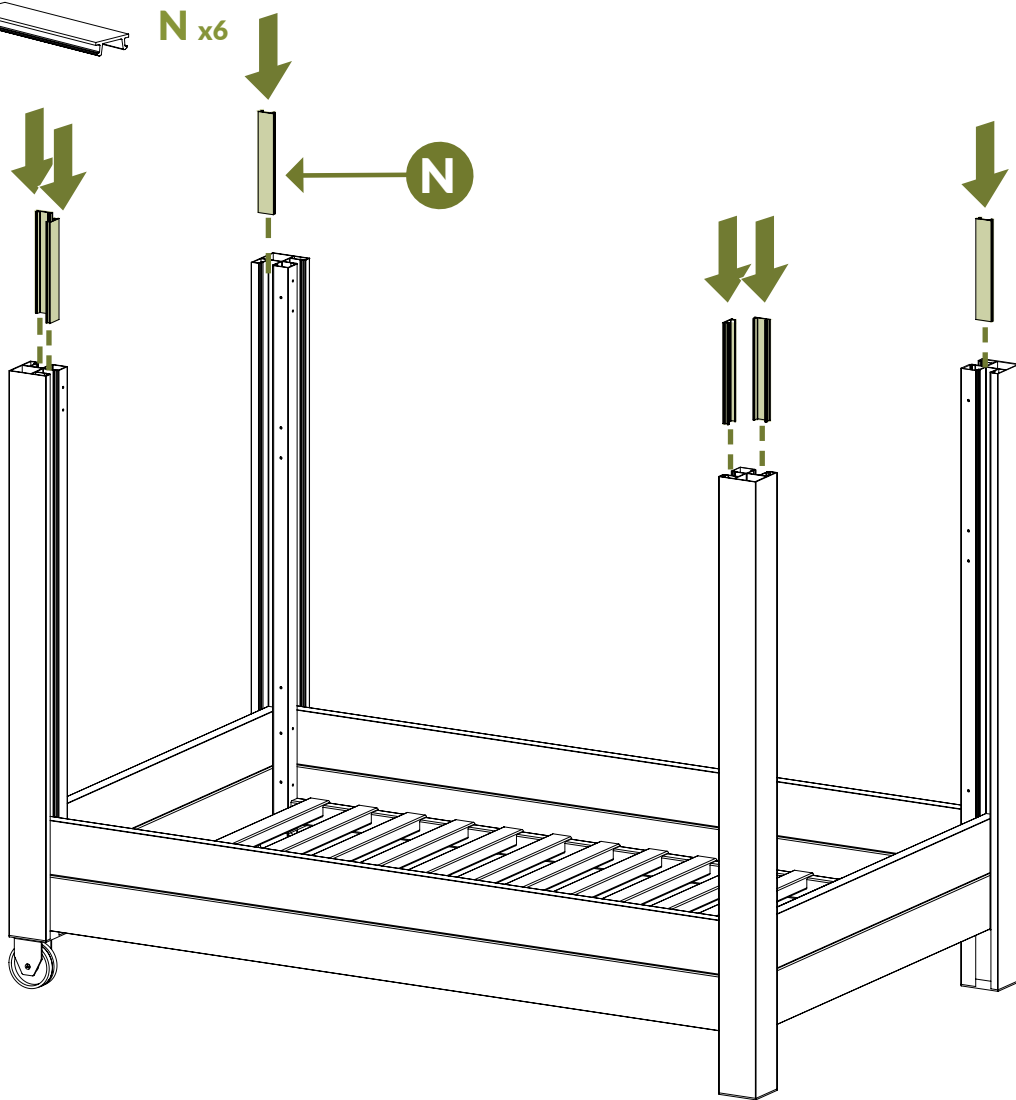

Rotate so that the wheels
are on your right hand side.

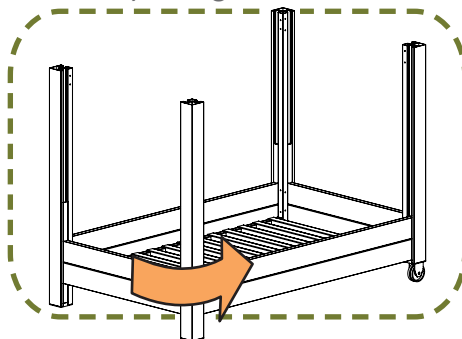

12

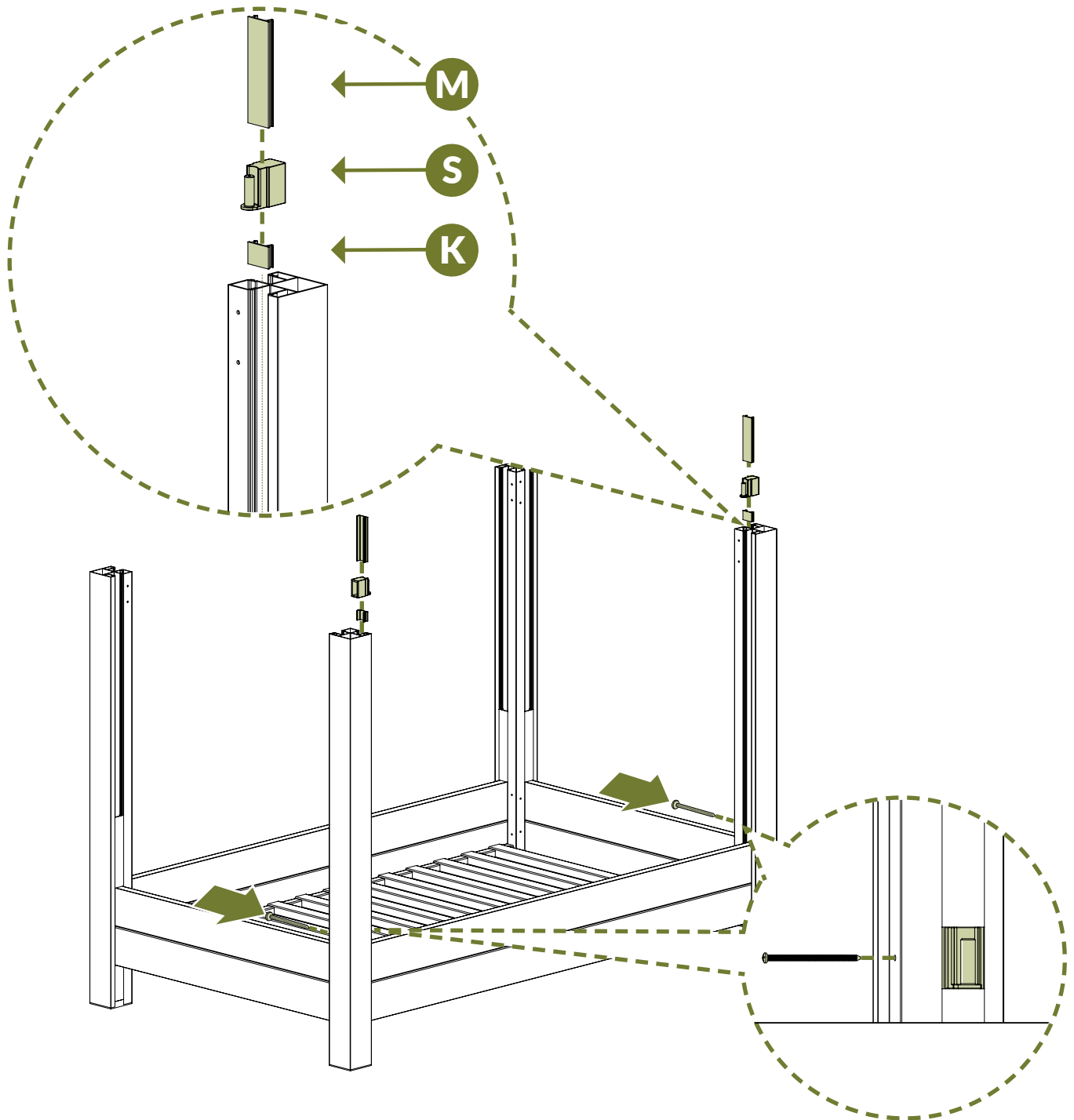
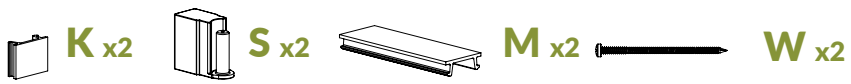

13

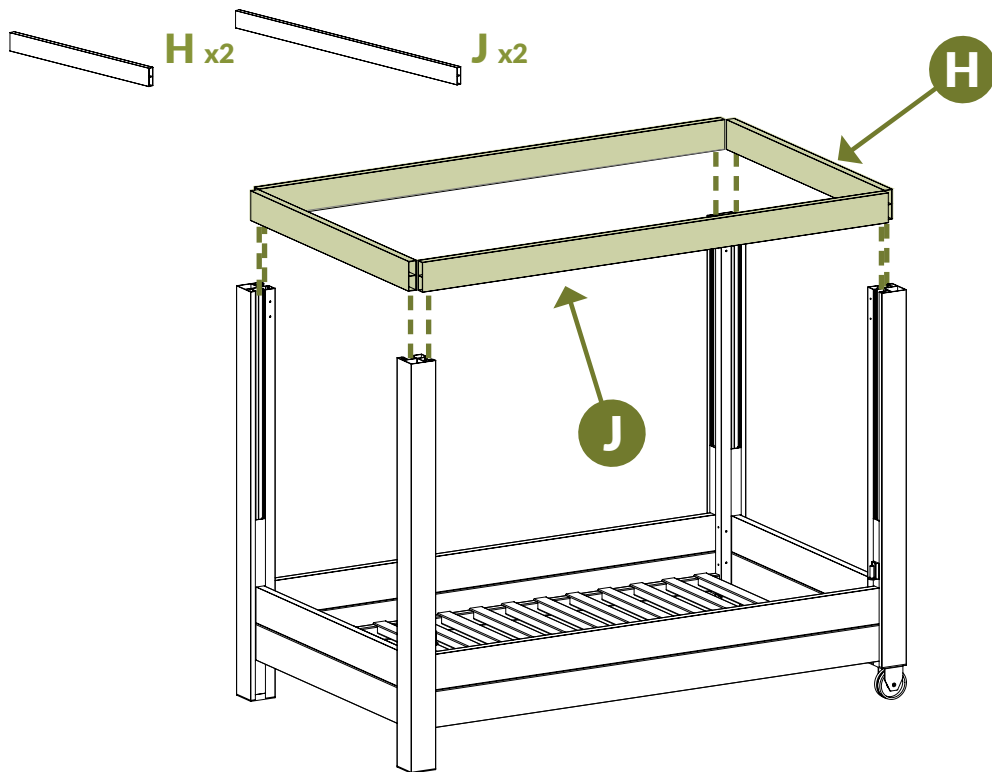

14

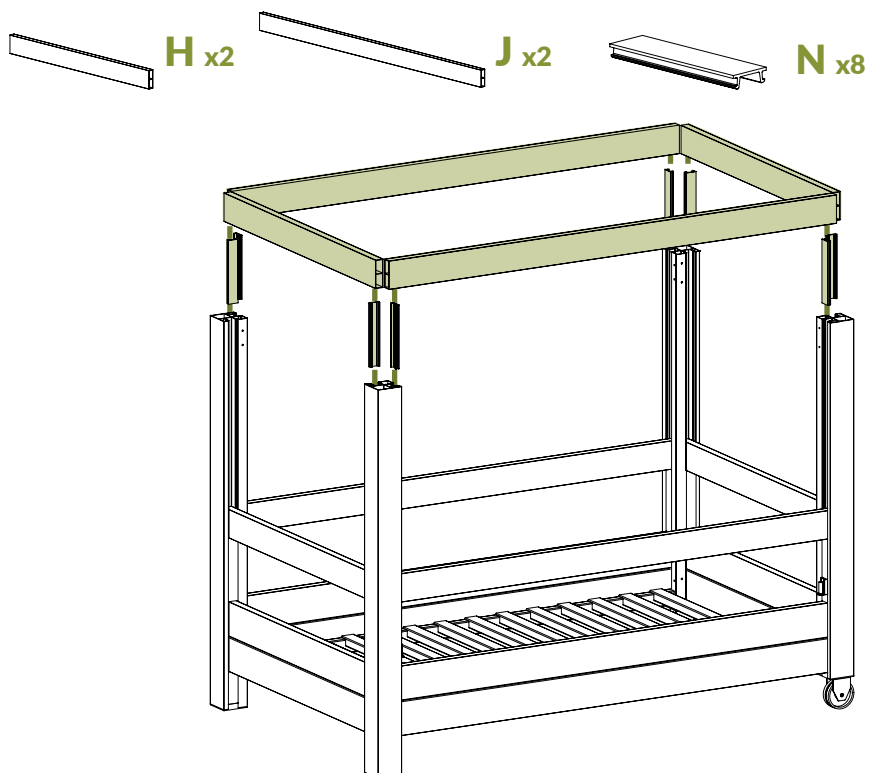

15



N x2



K x2



S x2



W x2

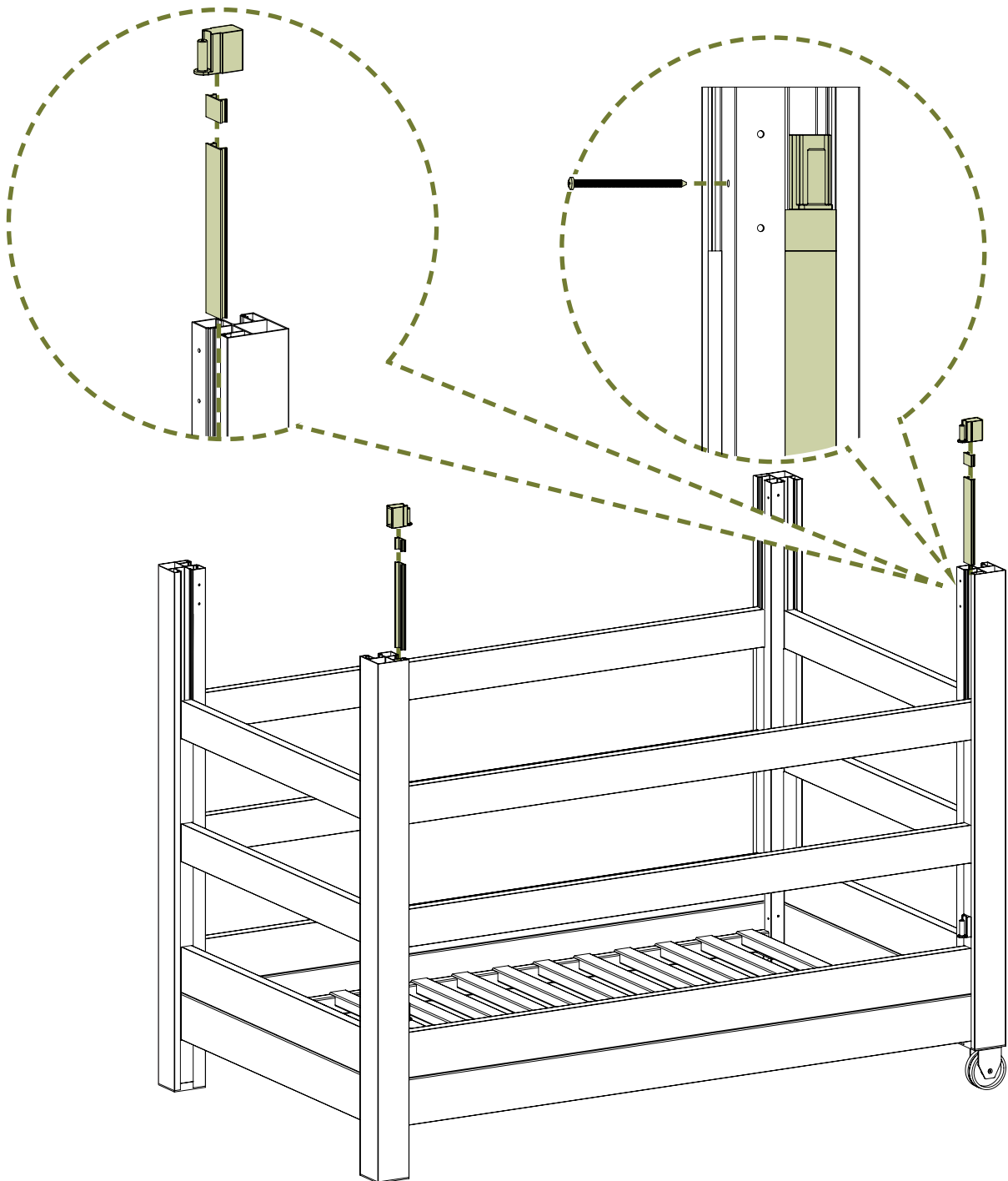

16



N x6

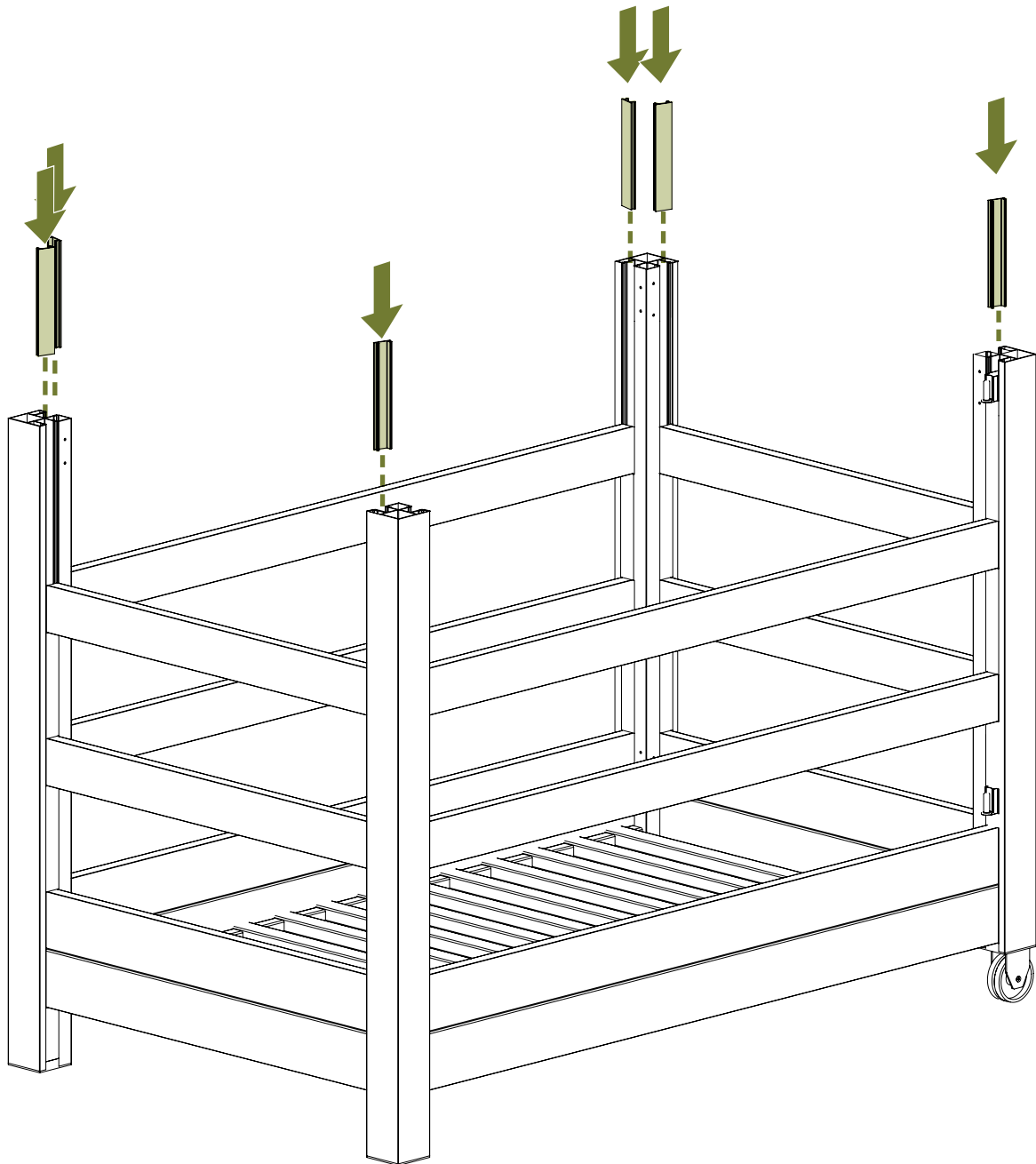

17

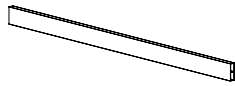

Jx1



W x4

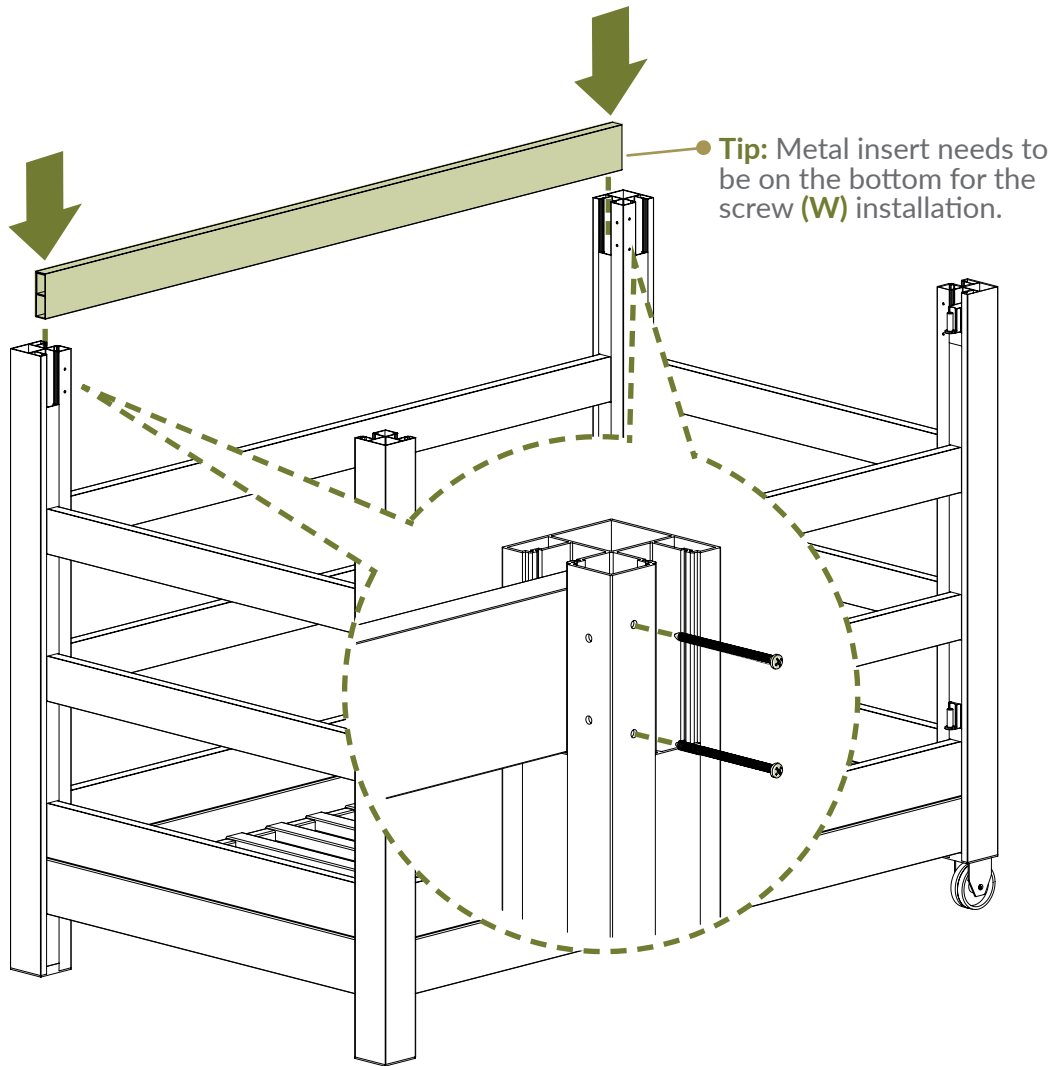

18



H x2



W x8

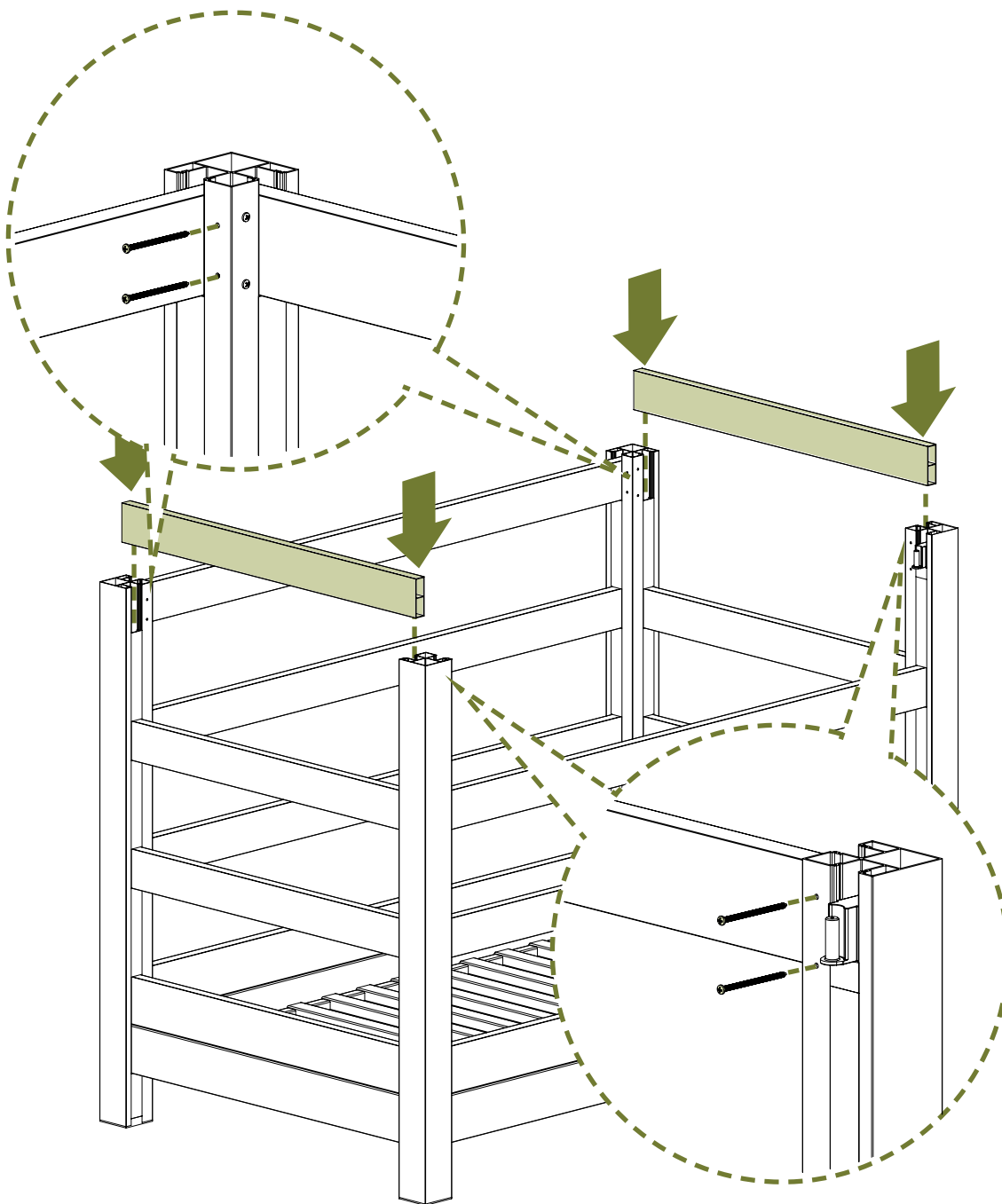

19

 O x4

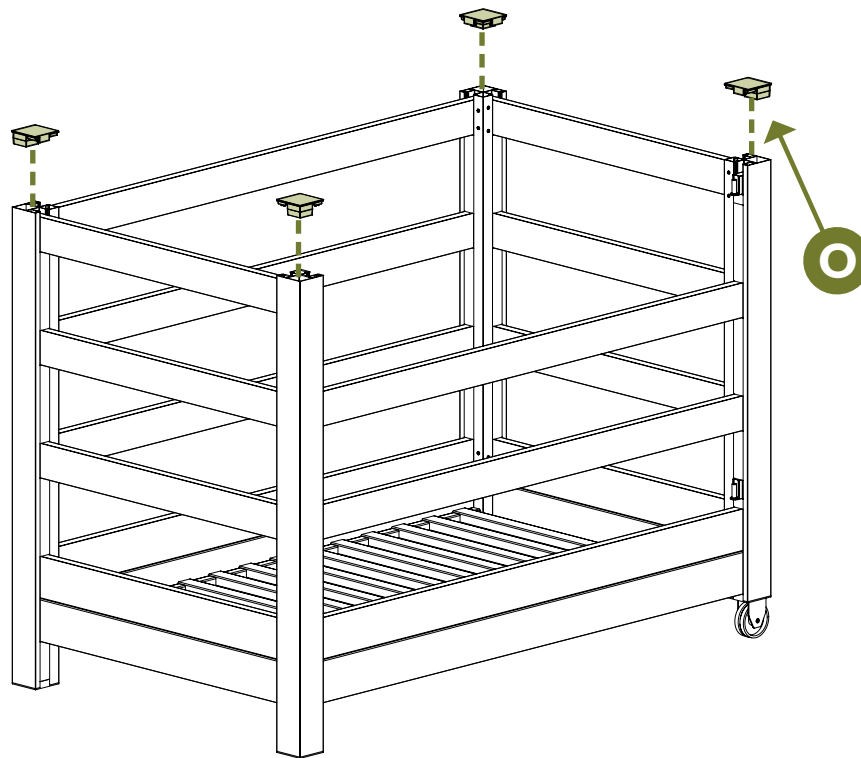

20

 P x3

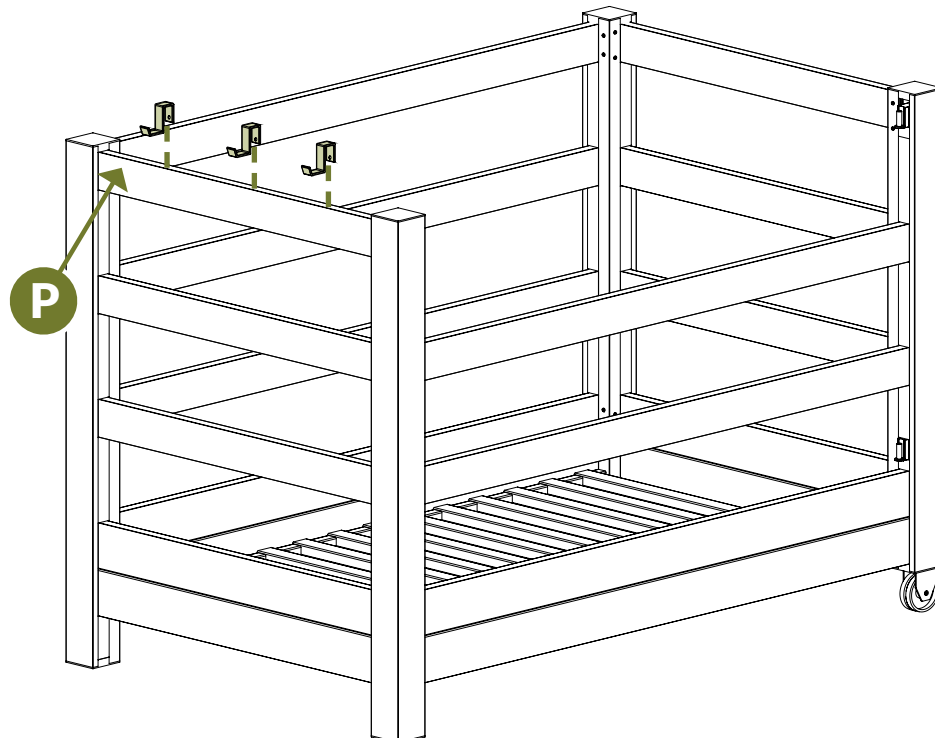

21

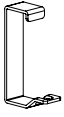

Q x6

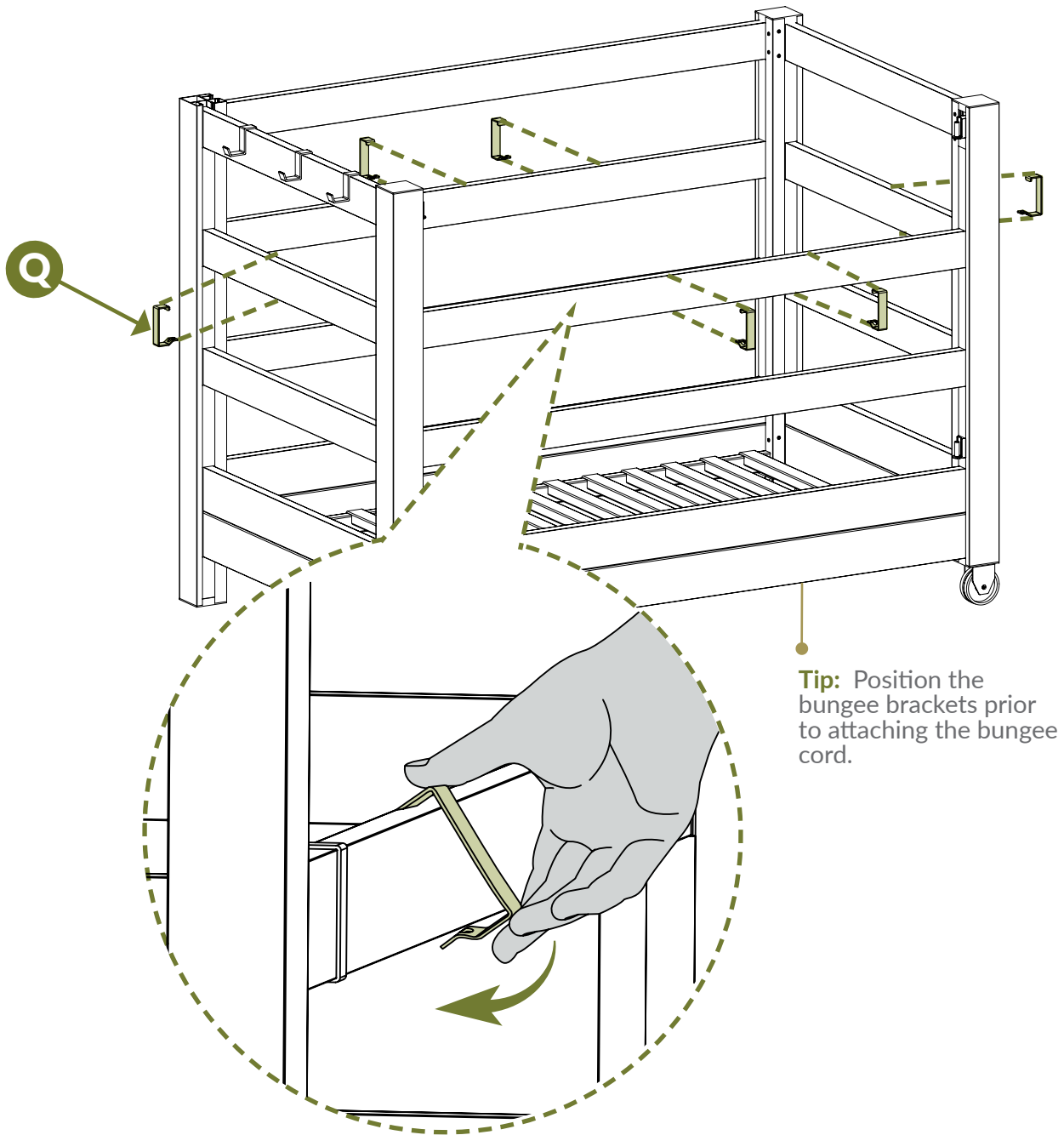

22

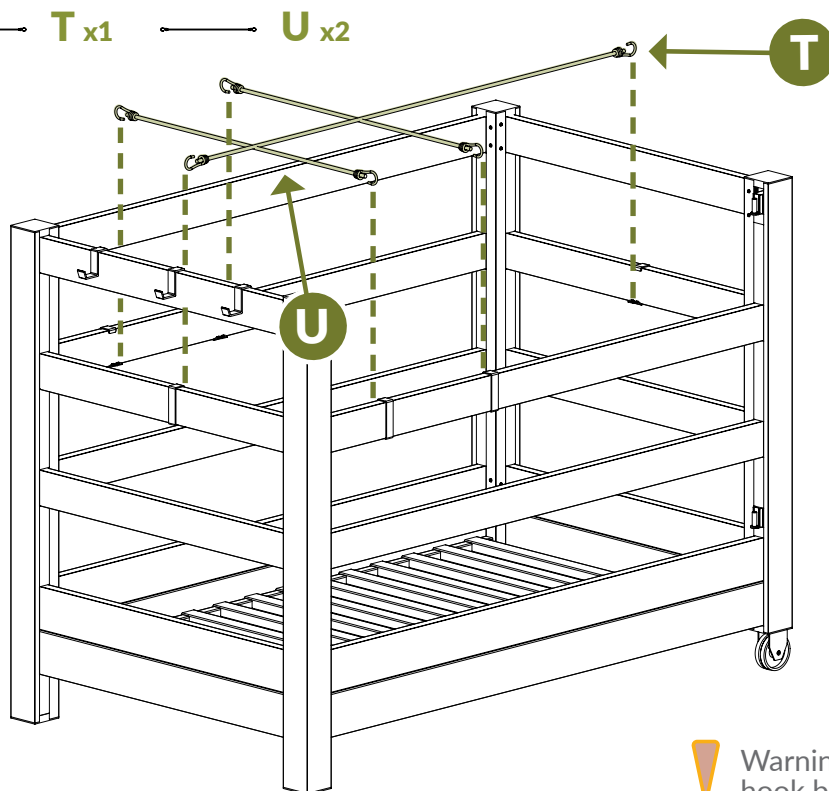

Warning: Do not hook bungee cords from towel hooks.

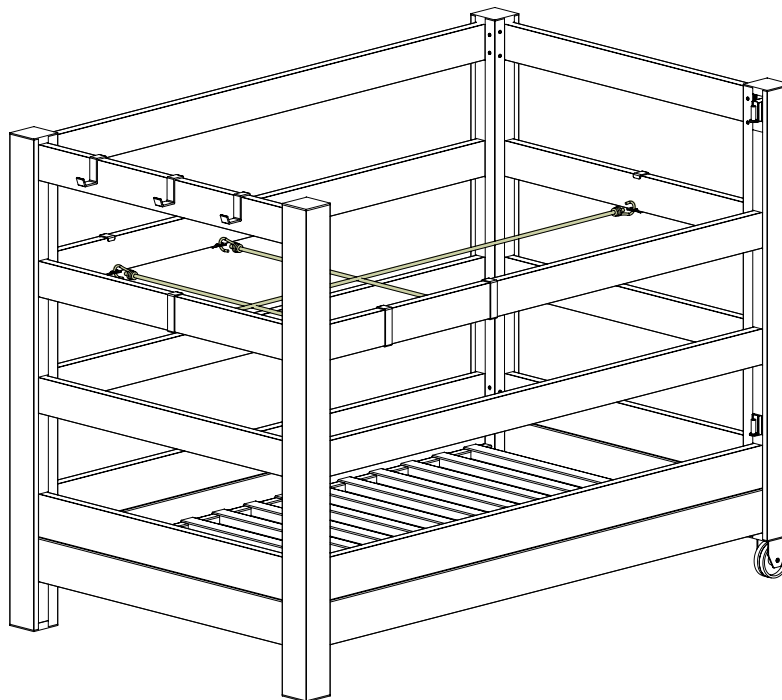

23

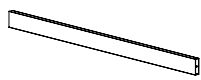

I x1



R x2

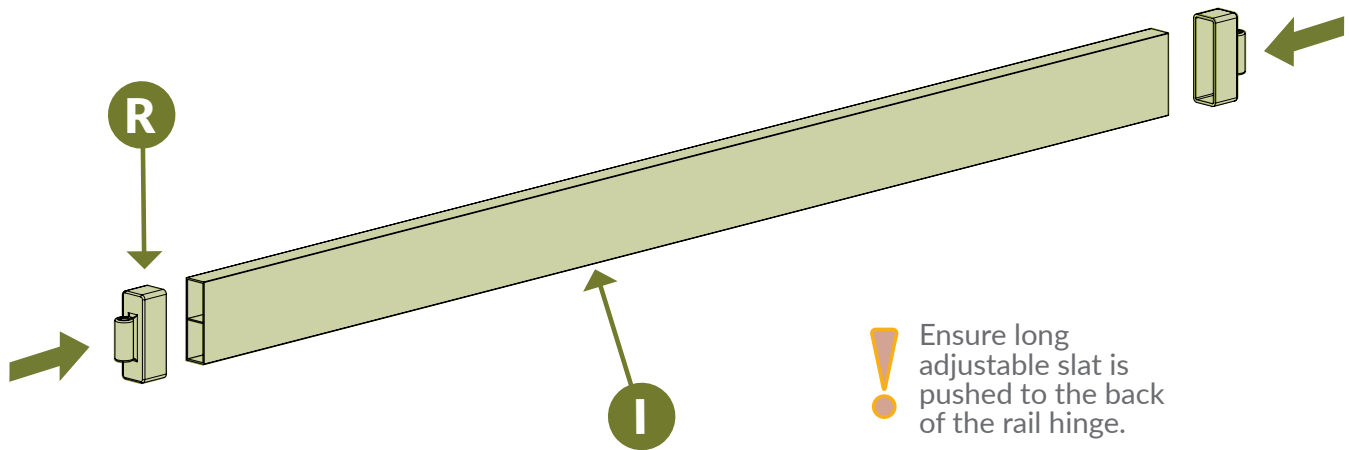

24

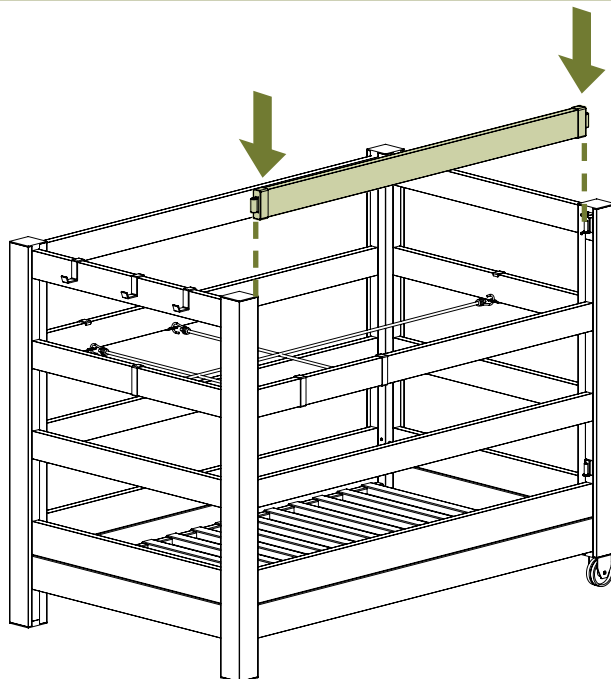

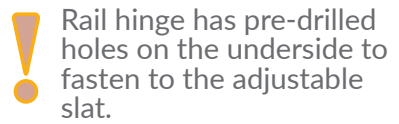
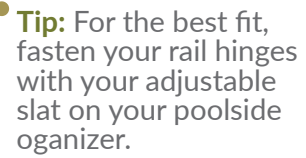
 **V** x4

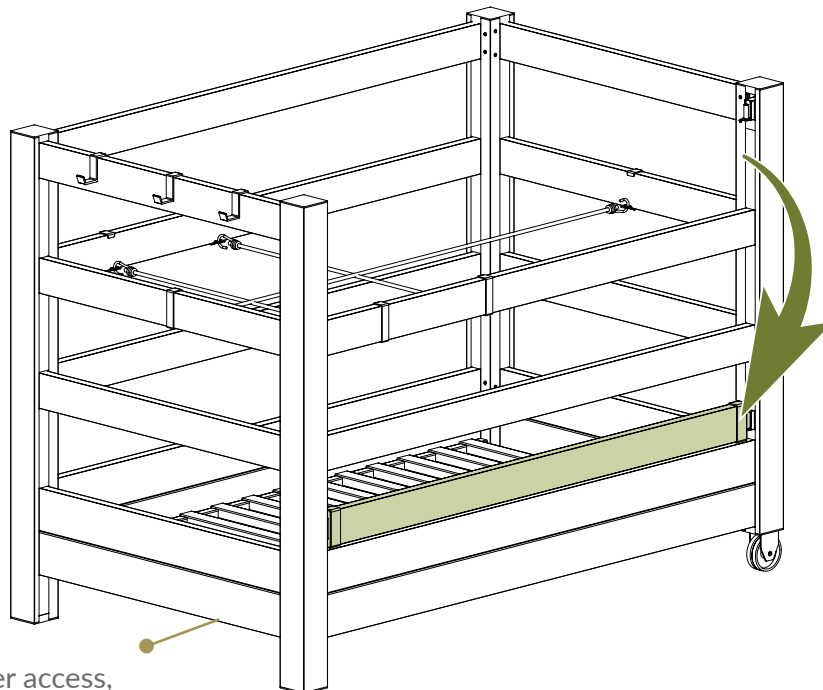
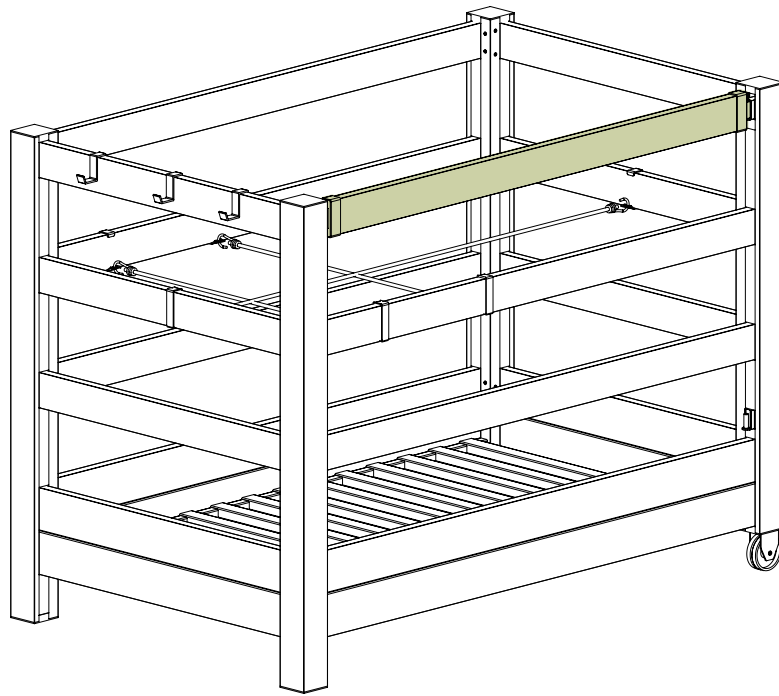

Tip: For easier access,
place the adjustable rail
in the lower position.



ZIPPITY

Easy Does It!



6935 Reames Rd. Ste. K.
Charlotte, NC 28216



support@zippity-outdoor.com

704-892-5222
877-234-6196



WWW.ZIPPITY-OUTDOOR.COM