

Jackson, Wisconsin

Website: www.novuspowerequipment.com

Email: Support@novuspowerequipment.com

Toll-Free Phone: 800-409-7802

2025 V02

24 IN. TWO STAGE GAS POWERED SNOW BLOWER

NV24DSGL

QUICK START GUIDE

2025 V02

UNPACKING

Carefully remove the Snowblower out from the carton/box and place the unit on the ground or other solid surface.
Do not discard the packaging until you have confirmed the following items are present.

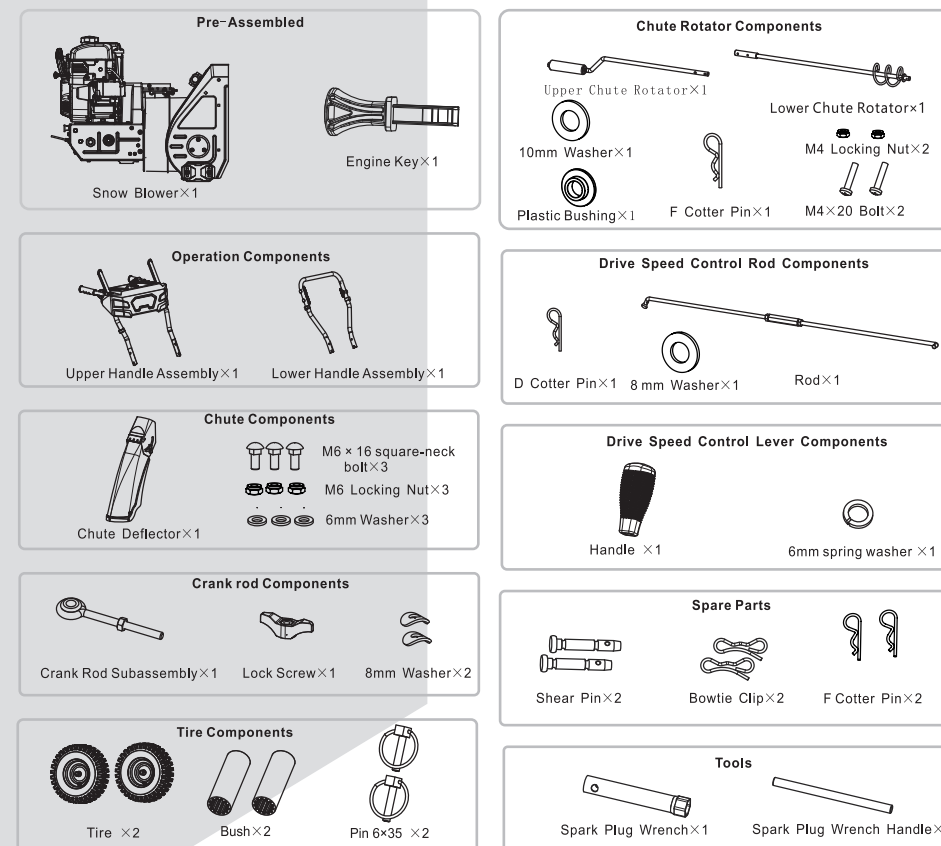

READ AND UNDERSTAND THE OPERATOR'S MANUAL AND ALL SAFETY WARNINGS BEFORE USE

Quick Start Guide Contents

- Unpacking / Package Contents
- Assembly Instructions
- Starting and Operating Procedures

Failure to operate the product correctly can result in damage to the product, personal property and cause serious injury or death

ASSEMBLY

Install the Lower Handle

1. Remove the 4 pre-installed flange bolts (A), lock washer (B), flat washer (C) from the frame case.
2. Using the hardware removed above install the lower handle (D) onto the frame case and tighten the bolts.

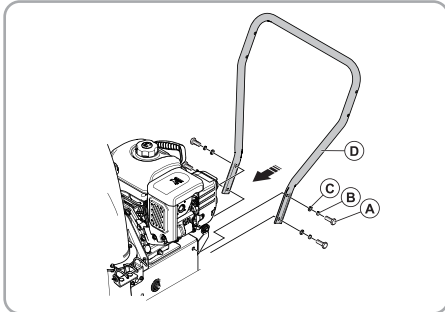

Install the Upper Handle

1. Remove the pre-installed handle bolts (C), wave washers (E), handle knobs (F) and crank rod eyelet (D) on the lower handle (B).
2. With assistance, install the upper handle (A) onto the lower handle (B). Secure in place using the handle bolts (C) crank rod eyelet (D) curved washers (E) and the handle knobs (F).

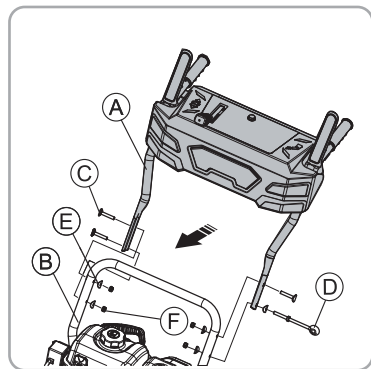

1

2

3. Insert the z-bend end of the auger and drive cables (A) into the lower holes of the left and right engagement levers (B).
4. Install threaded part of the cables (A) with one nut on top and bottom, into the cable holder of the left and right-side handle (C).
5. Lock the cables in place by tightening the M6 nuts (D).

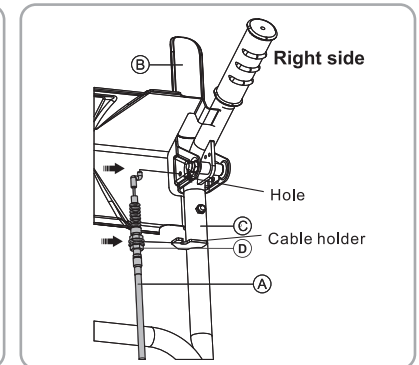
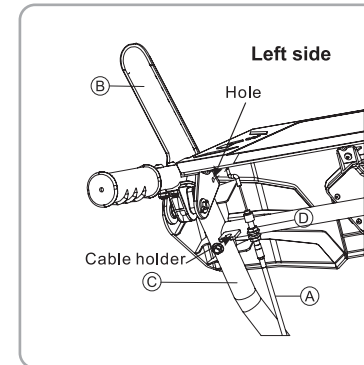

3

Install the Tires

1. Slide the wheel bushing (A) and the Tire (C) onto the axle shaft (B).
2. Align the hole in the wheel with the axle shaft, insert the 6x35 Pin (D) and secure in place.

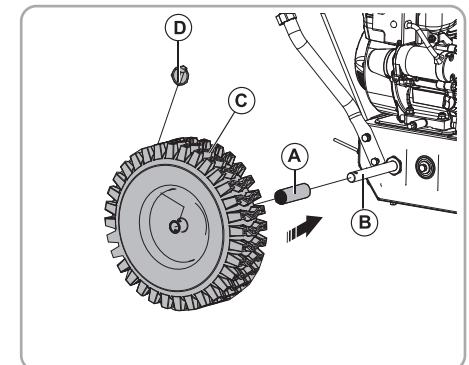

4

Assemble the Chute Deflector and Chute Rotator

1. Insert the plastic bushing (B) into the inside of the front chute rotation bracket.
2. Slide the lower chute rotation rod through the bushing and bracket.
3. Secure with a 10mm flat washer (A) and cotter pin (C).

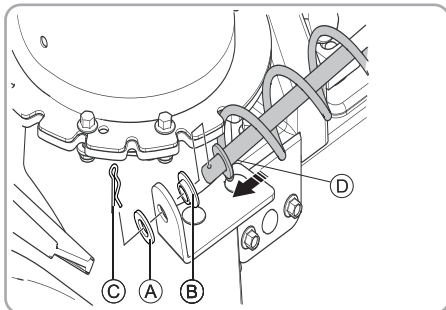

4. Slide the upper chute rotator (A) through the crank rod eyelet (B) and insert into the lower chute rotator (D).
5. Align the holes of the upper and lower chute rotator and secure in place by inserting and tightening 2 x M4x20 bolts and 2 x M4 locknuts.

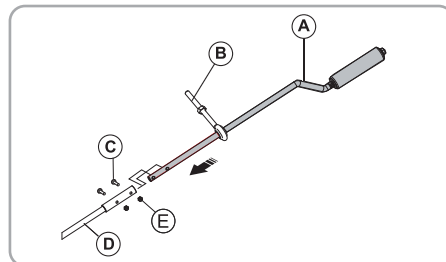

6. Align the 3 mounting holes of the discharge chute (C) with the holes on the chute rotator disk (B).
7. Install the 3 x M6x16 square neck bolts (A) from the inside going outward of the discharge chute.
8. Secure the chute in place using 3 x 6mm washer (D) and 3 x M6 lock nut (E).

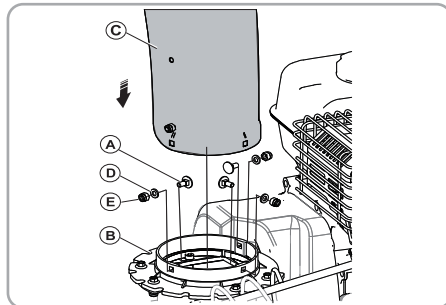

5

Assemble the Drive Speed Control Rod

1. Pull up the shift connecting plate (B) and install the short bent end of the drive speed control rod (A).
2. Install the long bent end of the drive speed control rod (A) to the control panel (B), and attach it with 1 x flat washer (C) and 1 x cotter pin (D).

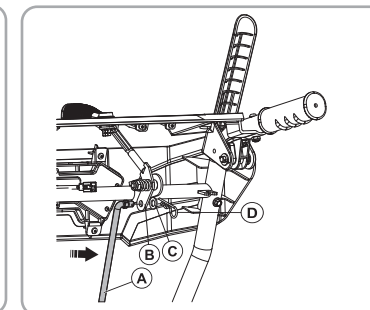
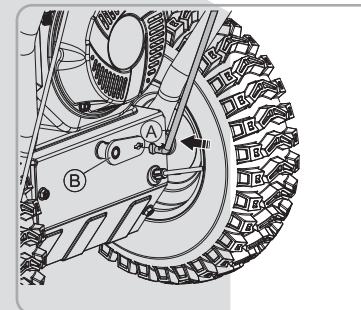

3. Install the speed control handle (A) using the 6mm spring washer (B) and twisting the handle clockwise.

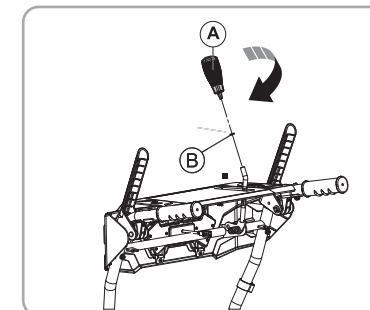

Add Engine Oil

1. Place the snow blower on a flat level surface.
2. Remove oil fill cap/dipstick to add engine oil.
3. Using a funnel, add up to 20 fl. oz (600 ml) of oil and replace oil fill cap/dipstick.
DO NOT OVERFILL
4. Check the engine oil level and add as needed. Securely screw in the oil filler cap/dipstick

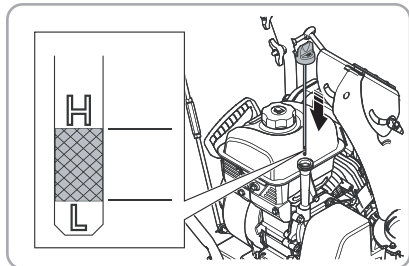

Add Fuel

⚠ DANGER: Gasoline vapors are highly flammable and extremely explosive.

1. Remove the fuel tank cap.
2. Add fresh, clean unleaded fuel with a minimum of 87 octane and a maximum of 10% ethanol to the fuel tank leaving ¼" of space from the top of the tank.
DO NOT OVERFILL. Immediately wipe up any spilled fuel.
3. Reinstall the fuel tank cap by turning clockwise until it stops.

STARTING AND OPERATING PROCEDURES

This section of the quick start guide provides basic instructions on how to start and operate your new Snow Blower. This quick start guide is not a comprehensive guide, we recommend the operator's manual is read and understood before using your new equipment.

STARTING THE ENGINE (Recoil / Pull Start)

1. Insert the ON/OFF key.

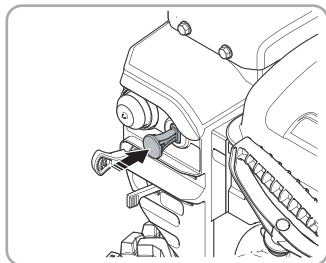

2. Slide the fuel switch lever fully to the right. "ON" position.

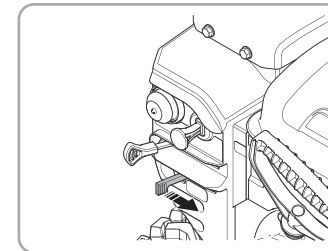

3. Slide the Choke / Throttle control lever to the left. "Choke" position.

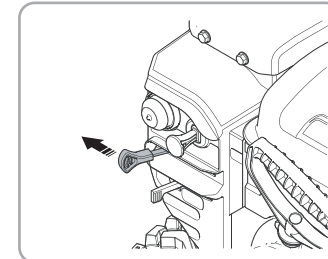

4. Firmly push in the primer 3 times with your thumb, holding the primer in a for a second before releasing it each time.

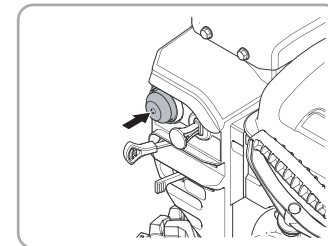

5. Pull the starter handle slowly until resistance felt, then pull rapidly.

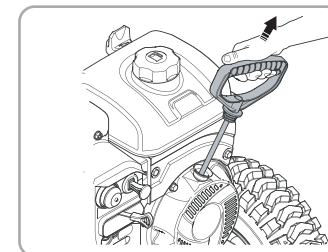

6. Once the engine starts, slowly slide the choke/ throttle control lever to the right into the "Run" position.
7. Allow the engine to run for 30 - 40 seconds before starting to blow snow.

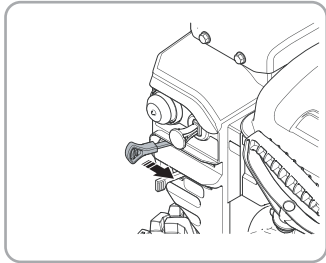

Starting the Engine (Electric Start)

Follow Steps 1, 2, 3 and 4 listed under Recoil / Pull Start.

5. Plug a 3-wire extension cord into the electric start adapter on the snow thrower. Plug the other end of the power cord into a convenient 120V outlet.

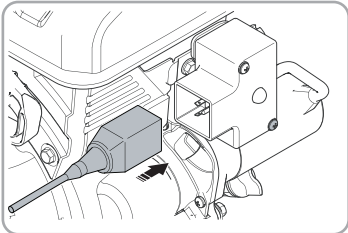

6. Press and hold the start button on the control box for 5 seconds.

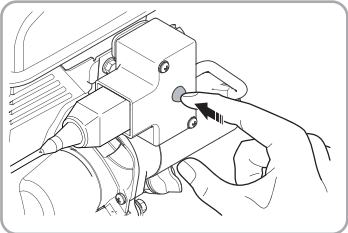

Note: If the engine does not start, wait 5 seconds, then push the start button again.

7. Once the engine starts, slide the choke / throttle lever to the right into the run position.
8. Remove the extension cord from the unit and unplug it from the outlet.
9. Allow the engine to run for 30-40 seconds before starting to throw snow.

11

Operating the Snow Blower

Auger Engagement

1. Squeeze the left-side auger engagement lever to the handle to engage the auger and throw snow.

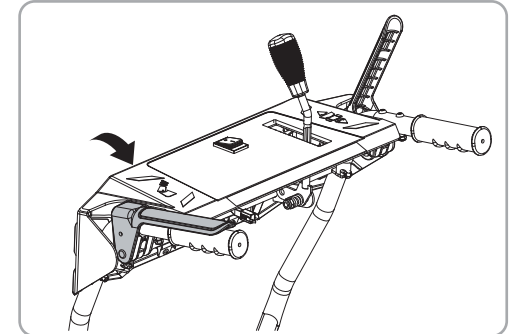

Wheel Drive Engagement

2. Move the drive speed control lever to the front to operate the product forward. Move the drive speed control lever to the back to operate the product rearward.

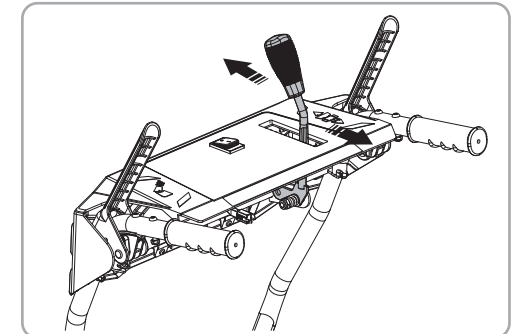

3. Squeeze the right-side drive engagement lever to the handle to engage the drive wheels. The product will move forward or reverse depending on the location of the drive speed control lever.

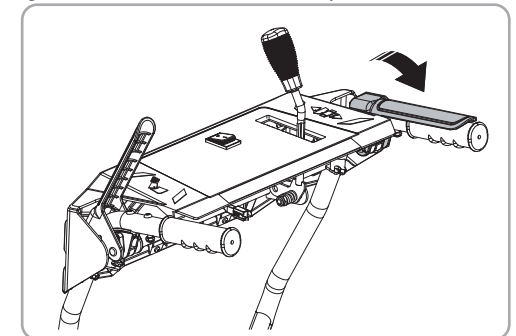

12

Stopping the Snow Blower

1. Release the right-side drive engagement lever to stop the drive wheels.
2. Release the left-side auger engagement lever to disengage the auger and stop throwing snow.
3. Slide the Choke / Throttle control lever fully to the right.
4. Pull outward on the engine key to stop the engine.
5. Slide the fuel switch lever fully to the left. "Closed" position.

