

Product Dimensions

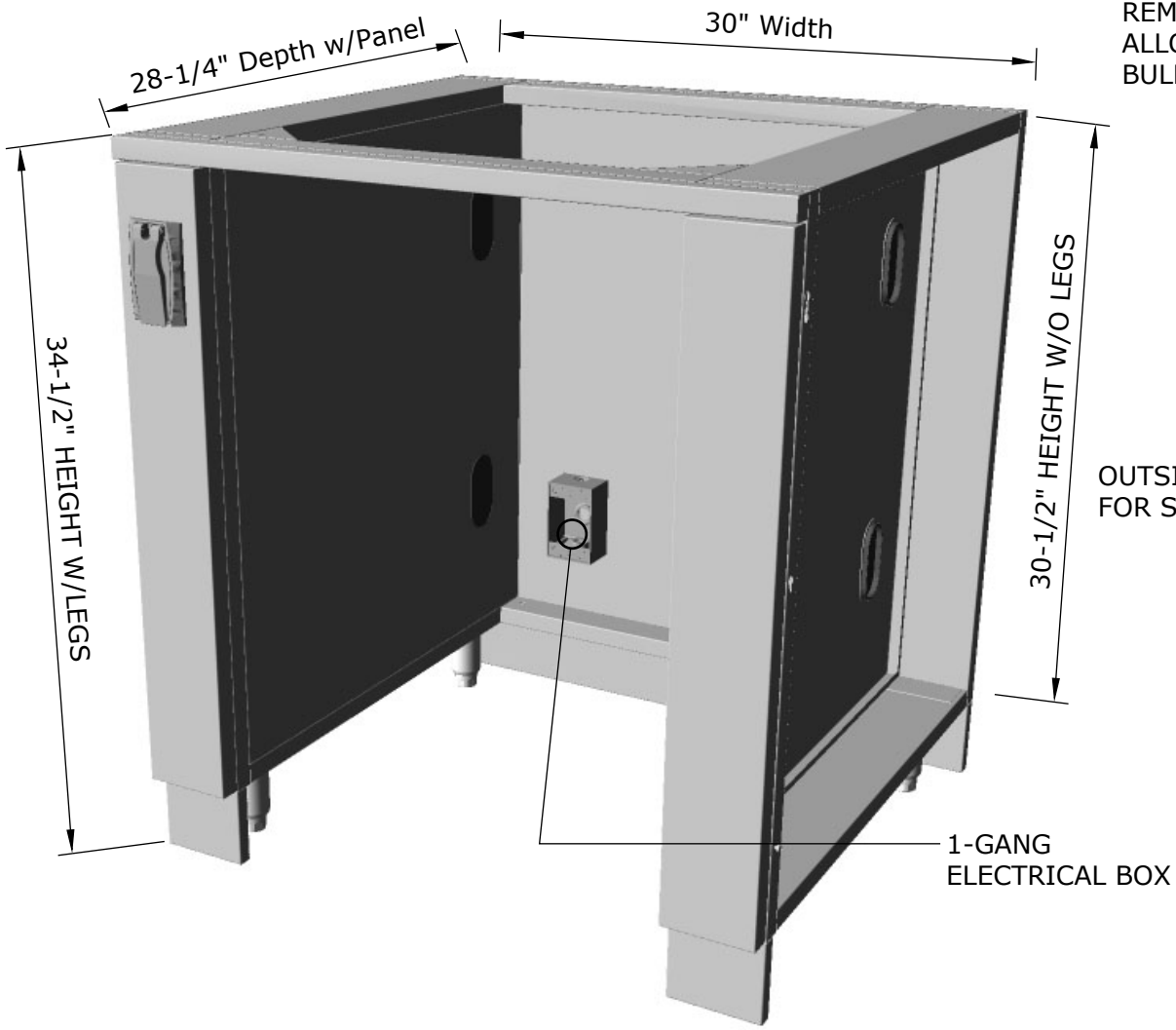

Product Components

REMOVABLE 1" - COUNTER RAIL  
ALLOWS COUNTER TO BE EITHER  
BULLNOSE OR BEVEL EDGE

OUTSIDE ELECTRICAL COVER  
FOR SWITCH OR OUTLET

FITS THE SUNSTONE OUTDOOR  
RATED FRIDGE ITEM NO. FR401  
AND OTHER 21" WIDE FRIDGES  
IN MARKET

KICK PLATE

Product Diagrams

ISO VIEW

FRONT VIEW

TOP VIEW

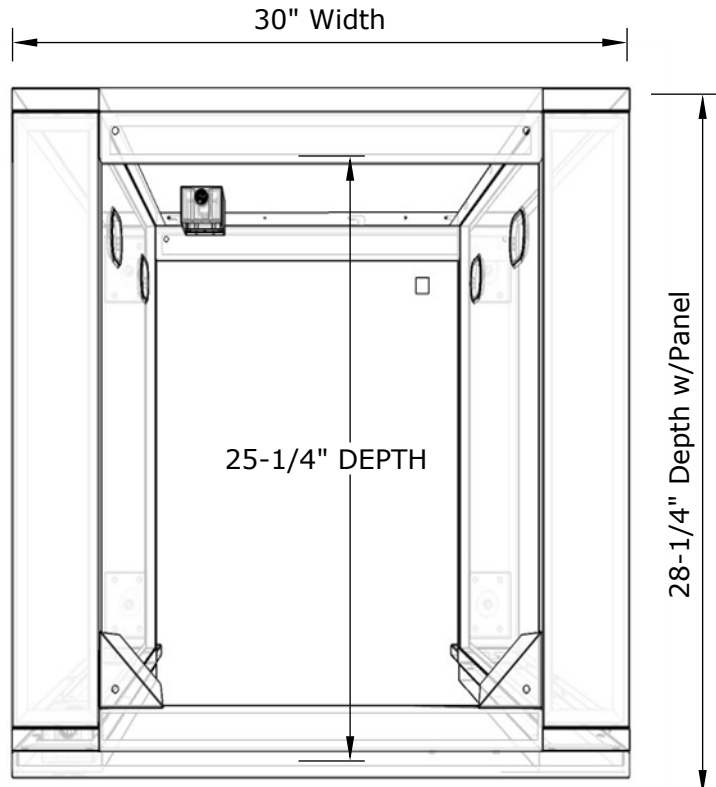
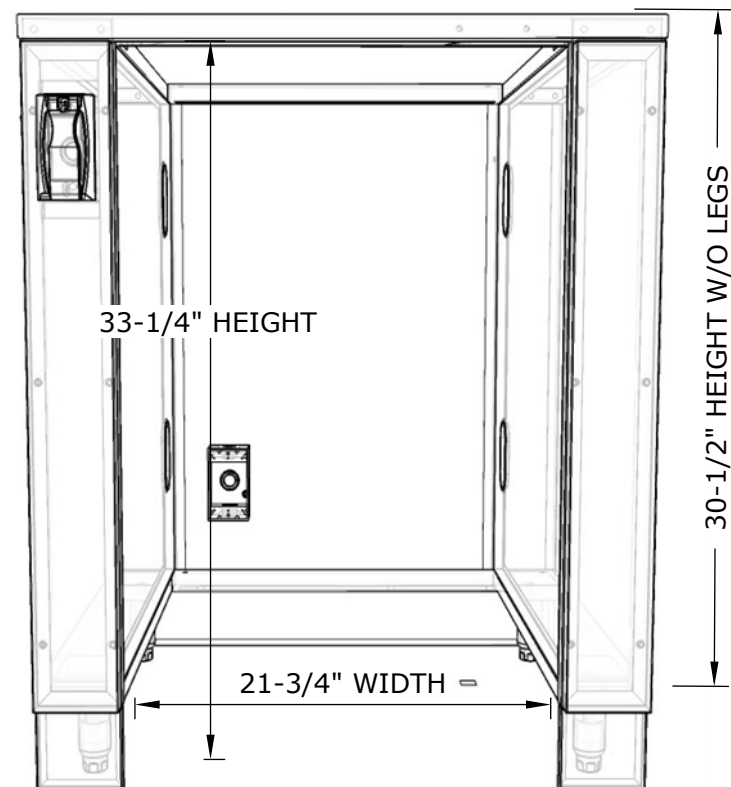
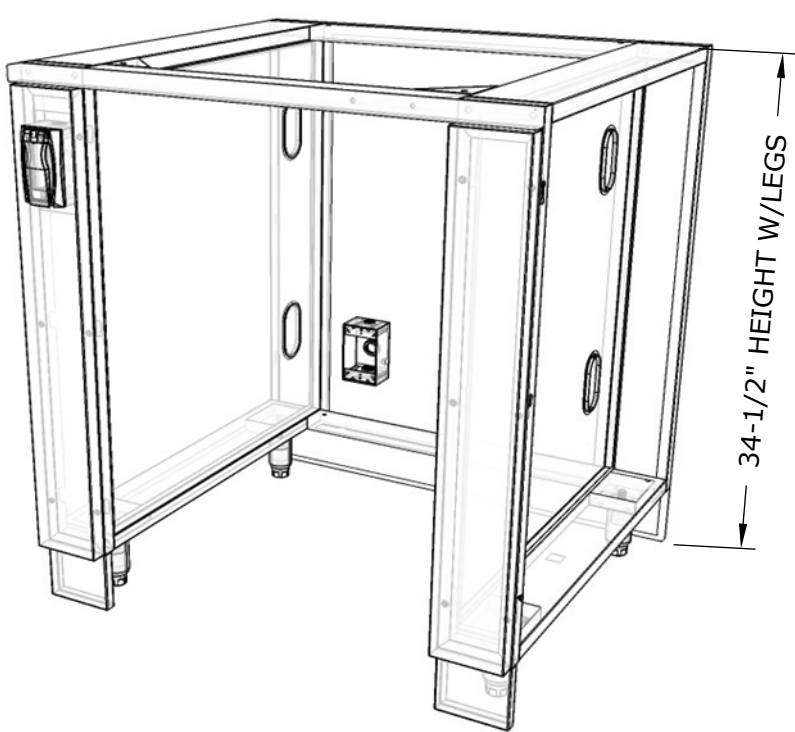

**SUNSTONE METAL PRODUCTS**  
16004 CENTRAL COMMERCE DR.  
PFLUGERVILLE, TEXAS 78660  
Tel: 888.934.9449  
Bus: 512.487.5116  
Fax: 512.487.7016

**PRODUCT**  
30" Appliance Cabinet for up  
to 21" Wide Fridge

**Item No.** SAC30APC

- DESCRIPTION**
- 30" Appliance Cabinet for up to 21" Fridges  
& Ice Makers w/Convenient front Electrical  
Cover & Interior Back Panel 1-Gang  
Electrical Box
- Lifetime Structure Warranty
  - 304 Stainless Steel Structure
  - 304 SS Rod Handles
  - Front & Back Kick-Plates
  - Easy Pin-Lock Installation
  - Soft-Close Drawer Tracks
  - Covered Access Ports
  - Adjustable Peg-Legs
  - Optional Wheel Casters

- INCLUDED COMPONENTS**
- Front Kick Plates
  - Back Solid Kick Plate
  - (4) Adjustable Peg Legs
  - Front Electrical Cover
  - Back Panel Electrical Box

**PRODUCT DIMENSIONS**

30"W x 28-1/4"D (w/Panel) x 34-  
1/2"H (w/Legs) or 30-1/2"H (no  
Legs) or Upto 36" Max Adjustable  
Height

**INSERT DIMENSIONS**

21-3/4" Width x 33-1/4" Height x 25-  
1/4" Depth

**INSERTABLE PRODUCTS**

Works with up to 21" Wide  
Fridges, Wine Coolers & Ice  
Makers

**MATERIAL SPECS**

304 Stainless Steel entire  
structure, 18 Gauge for Door  
Panel , 18 Gauge for Cabinet  
Box, 18 Gauge for Shelf,  
Handles are made of Solid 304  
Stainless Steel Bar.