

ASSEMBLY INSTRUCTIONS

Item No : WF318154

Description : SIDEBOARD

Thank you for purchasing this quality product. Be sure to check all packing material carefully for small part that may have come loose inside carton during shipment.

If you have any questions, please feel free to contact us.
Email: lowes.team@qualfurn.net

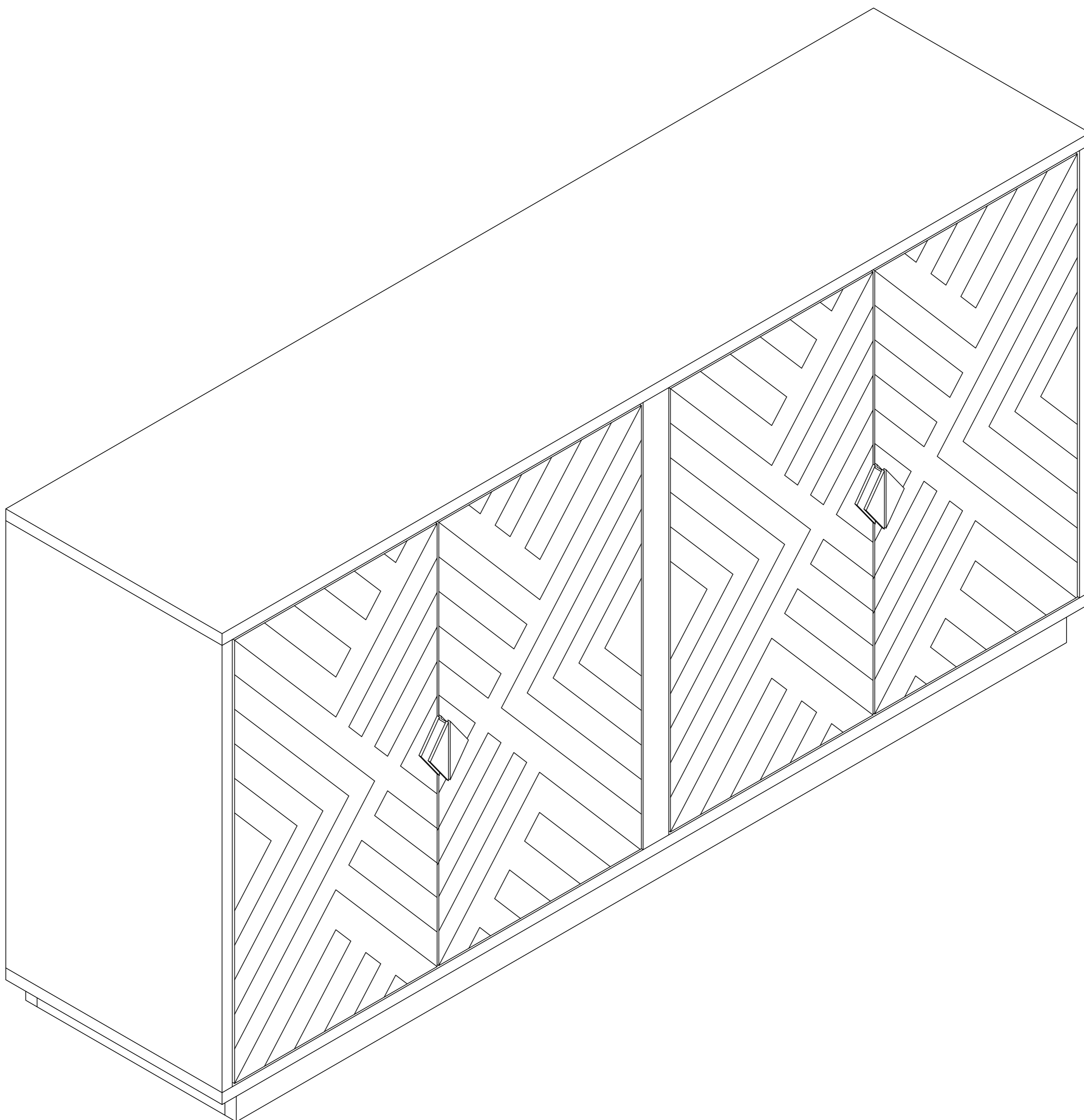

WF318154

ASSEMBLY INSTRUCTIONS

Item No : WF318154

Description : SIDEBOARD

Thank you for purchasing this quality product. Be sure to check all packing material carefully for small part that may have come loose inside carton during shipment.

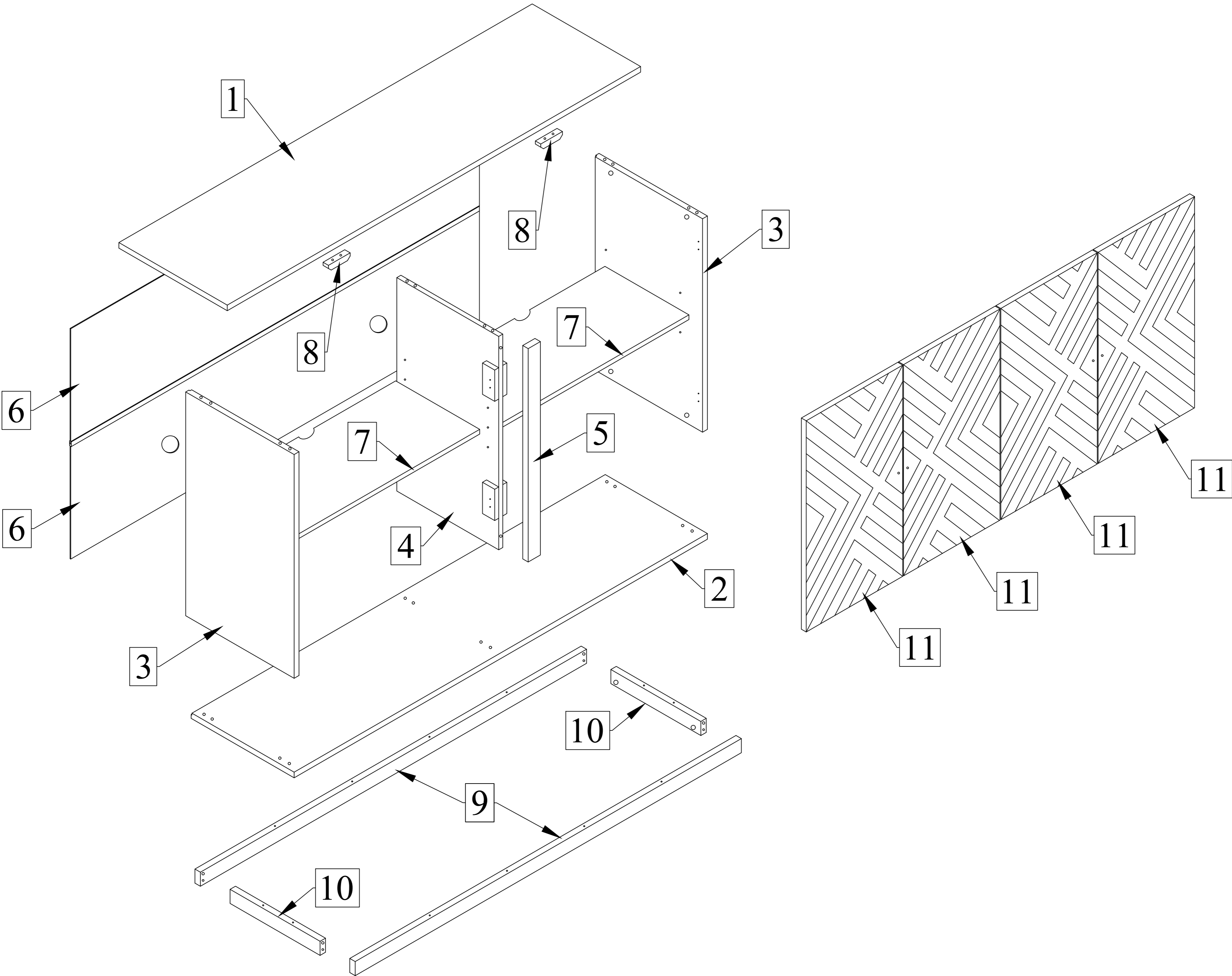

TOOLS REQUIRED (Not provided)

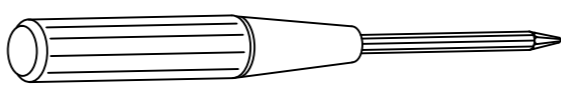

Screwdriver

Hardware List			
No.	Description	Sketch	Quantity
A	Wood Dowel M8x30MM		18PCS
B	Minifix + Cap	B1 B2	18SETS
C	Metal Shelf Support		8PCS
D	Screw M4 x 32MM		16PCS
E	Soft Close Hinges 7/8		8PCS
F	Screw M3.5 x 16MM		48PCS
G	Screw M3 x 12MM		48PCS
H	H Connector		1PC
I	Handle with Screw		4SETS

Part List			
No.	Description	Sketch	Quantity
1	Top Panel		1PC
2	Bottom Panel		1PC
3	Side Panel		2PCS
4	Center Panel		1PC
5	Center Rail		1PC
6	Back Panel		2PCS
7	Shelf		2PCS
8	Door Stopper		2PCS
9	Leg Frame		2PCS
10	Leg Frame		2PCS
11	Door Panel		4PCS

Apply a battery screw machine for better assembly experience.

ASSEMBLY INSTRUCTIONS

Item No : WF318154

Description : SIDEBOARD

Thank you for purchasing this quality product. Be sure to check all packing material carefully for small part that may have come loose inside carton during shipment.

Step 1 : Attach Wood Dowel (A) and Minifix (B1) to parts (1,2,3,4,5,9,10) accordingly. Attach Metal Shelf Support (C) to Center & Side Panels (3,4). Attach Door Stopper (8) to Top Panel (1) using Screw (D). Attach Hinges (E) to Doors (11) with Screw (F).

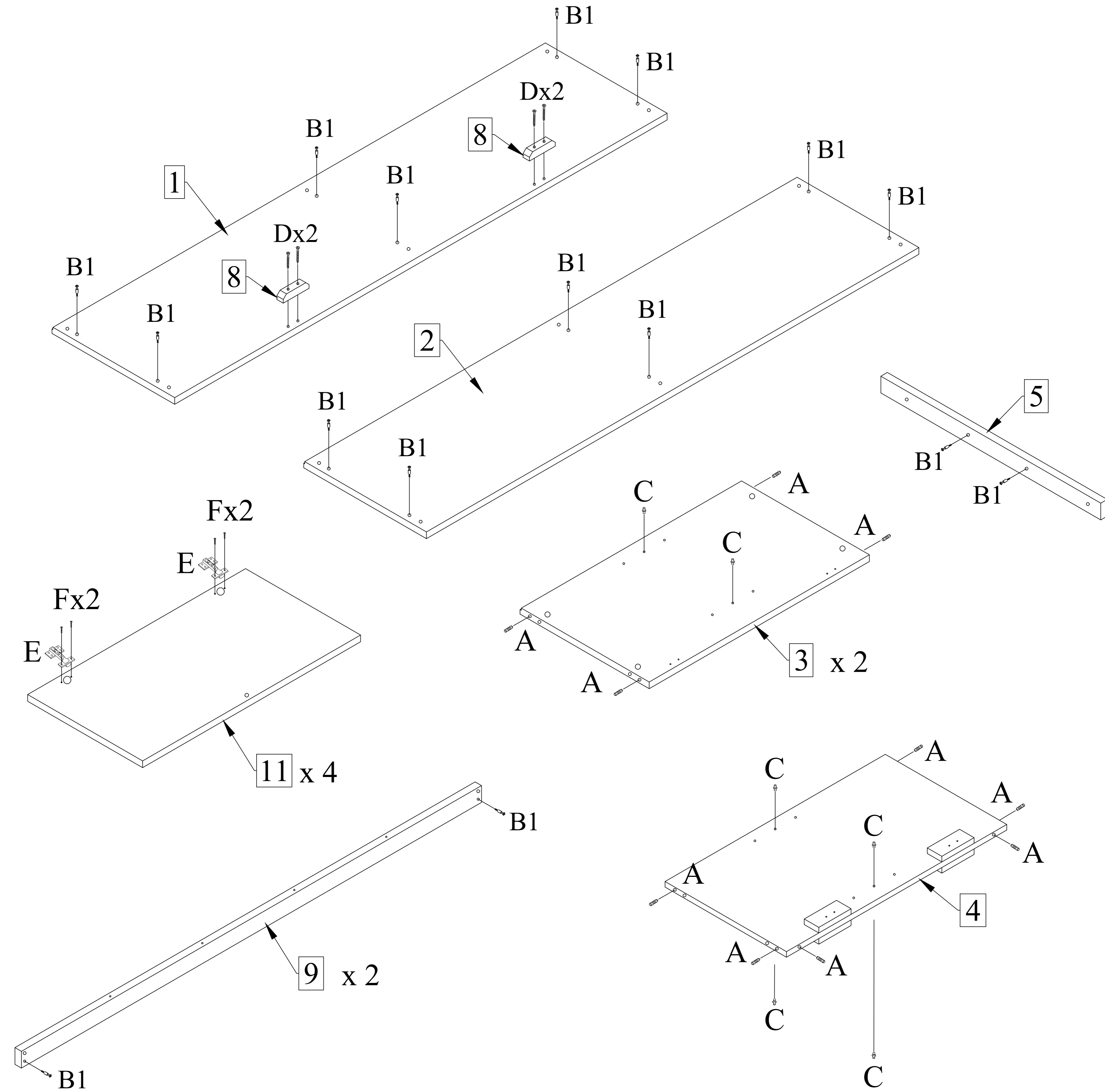

	A	Wood Dowel M8x30MM		18PCS
	B	Minifix + Cap	B1	18PCS
	C	Metal Shelf Support		8PCS
	D	Screw M4 x 32MM		4PCS
	E	Soft Close Hinges 7/8		8PCS
	F	Screw M3.5 x 16MM		16PCS

ASSEMBLY INSTRUCTIONS

Item No : WF318154

Description : SIDEBOARD

Thank you for purchasing this quality product. Be sure to check all packing material carefully for small part that may have come loose inside carton during shipment.

Step 2 : Attach Center Rail (5) to Center Panel (4) and lock Minifix Cap (B2). Connect Leg Frame (9,10) and lock Minifix Cap (B2). Attach the frame onto Bottom Panel (2) using screw (D).

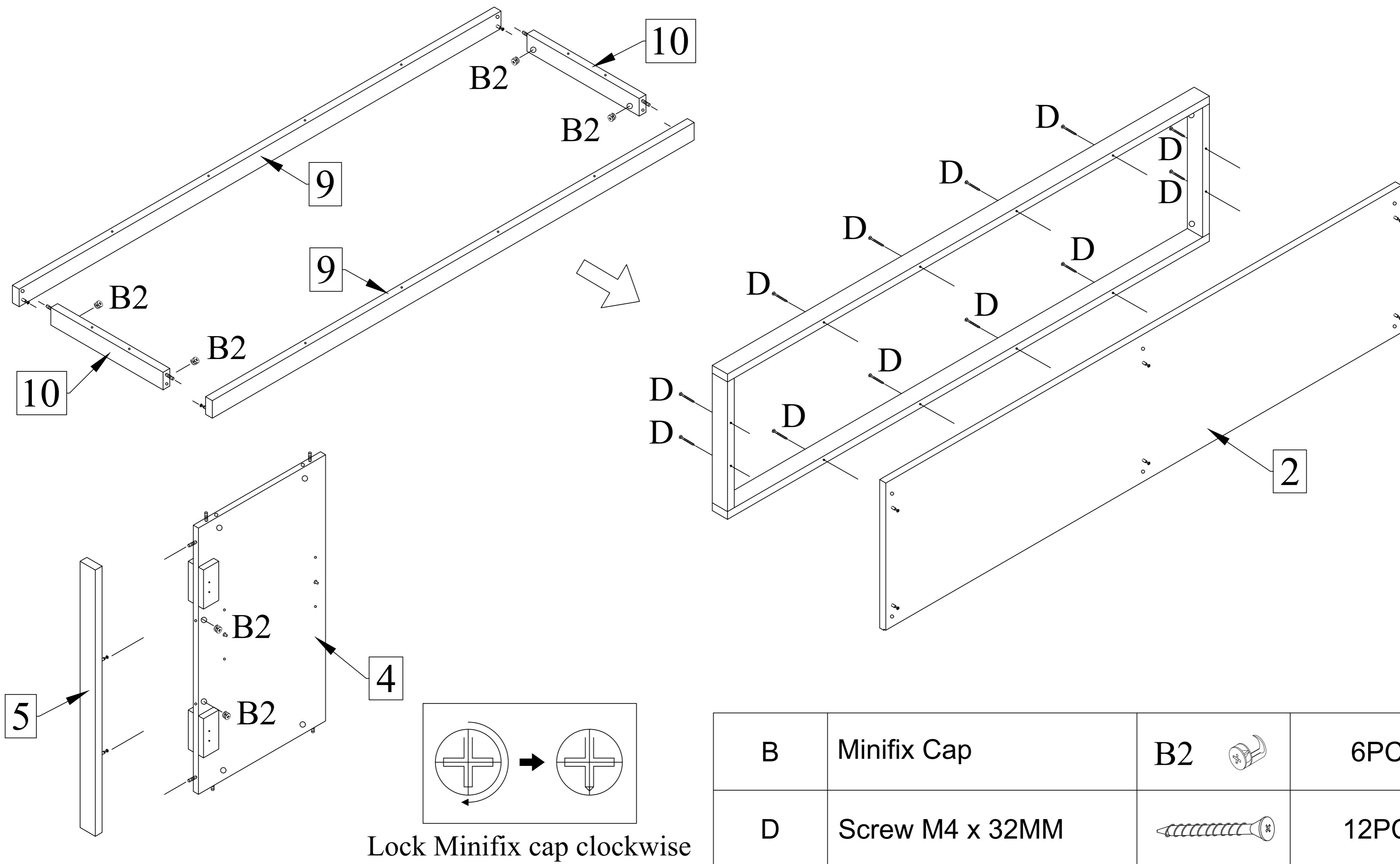

Step 3 : Connect Side & Center Panel (3,4,5) to Bottom Panel (2,9,10) and lock Minifix Cap (B2).

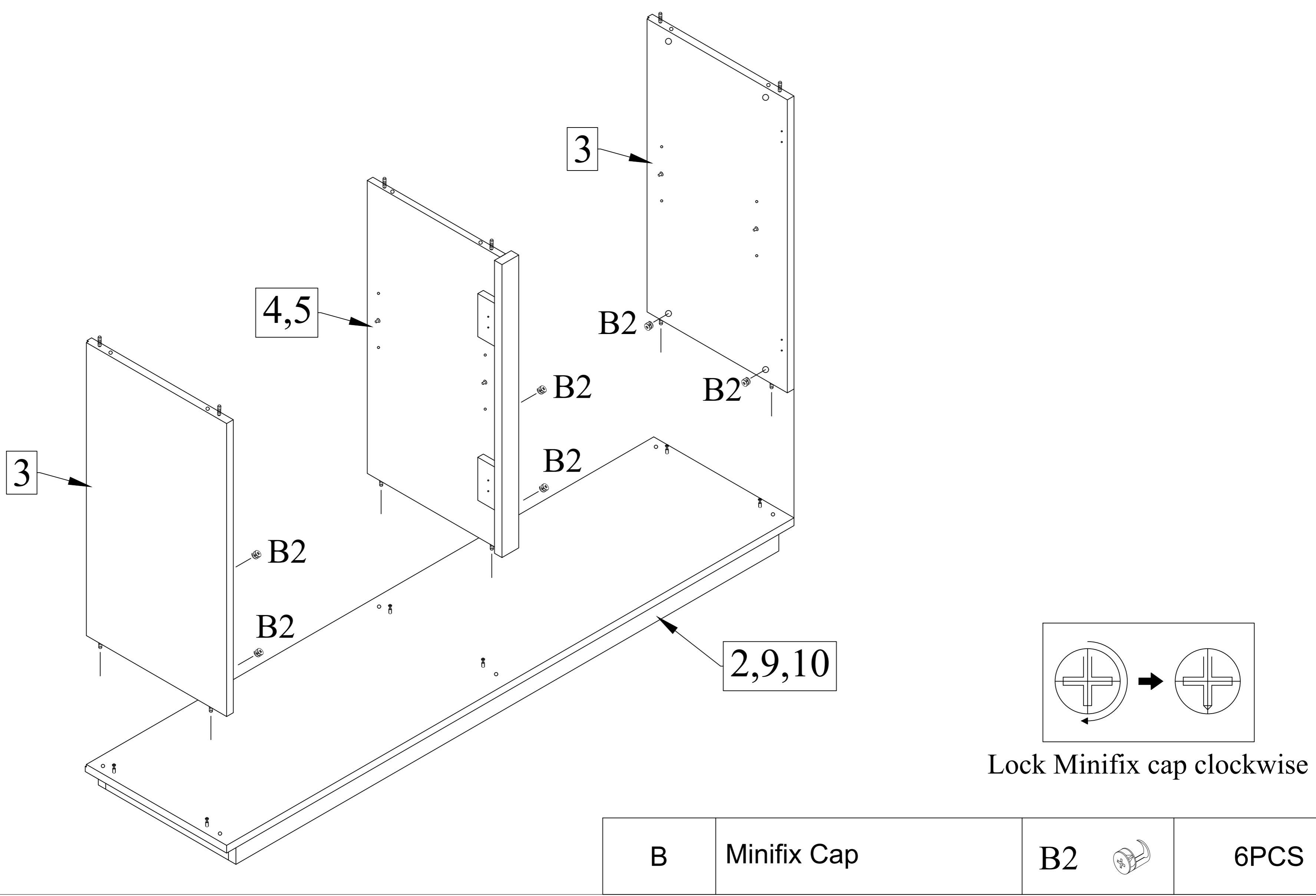

ASSEMBLY INSTRUCTIONS

Item No : WF318154

Description : SIDEBOARD

Thank you for purchasing this quality product. Be sure to check all packing material carefully for small part that may have come loose inside carton during shipment.

Step 4 : Attach Top Panel (1,8) to the assembled parts and lock Minifix Cap (B2)

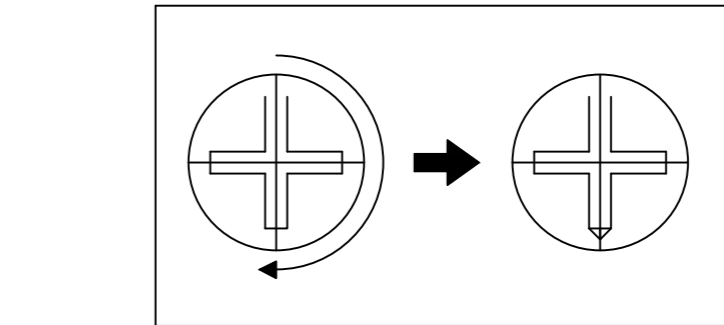
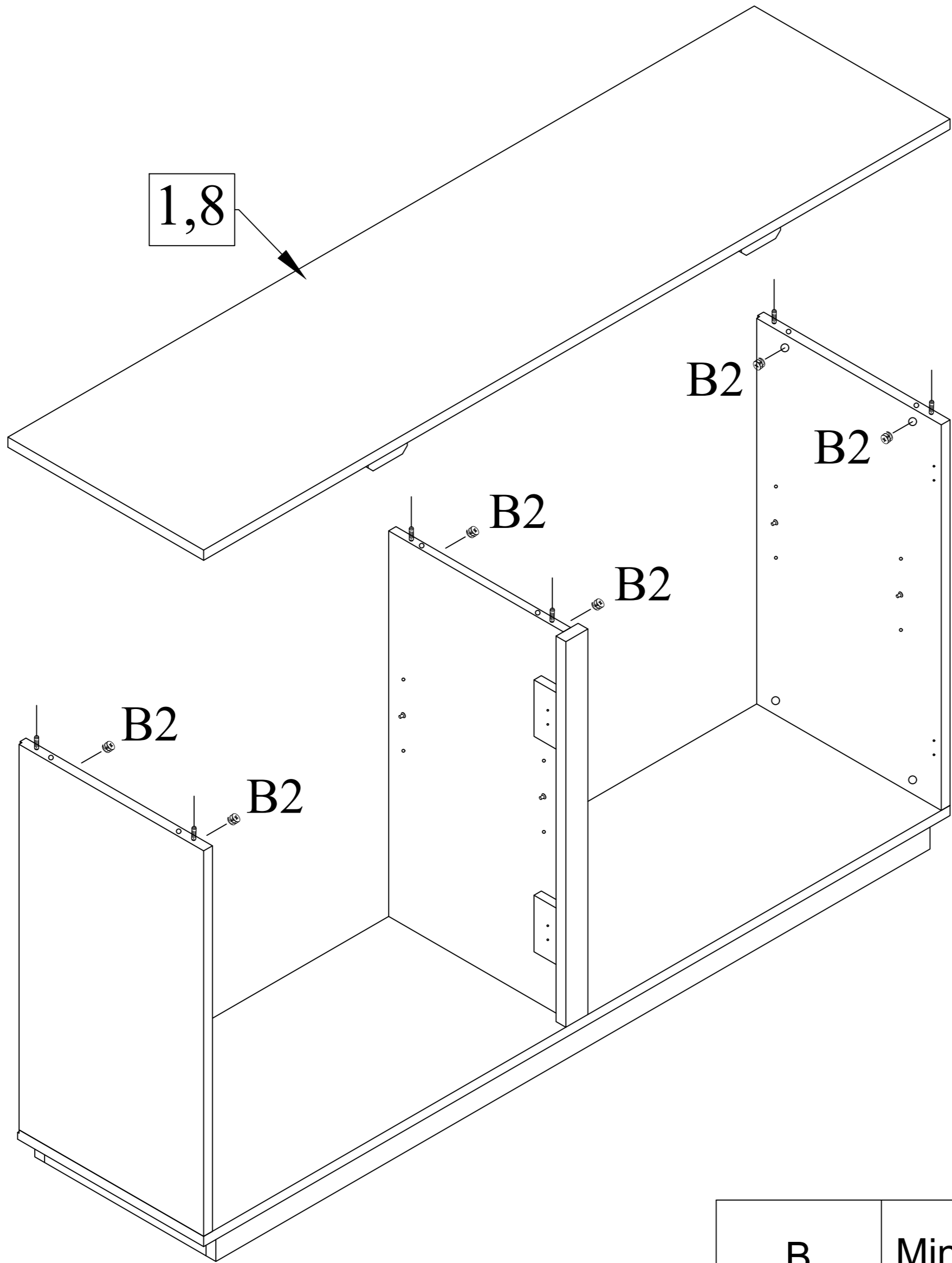

Lock Minifix cap clockwise

B	Minifix Cap	B2 	6PCS
---	-------------	--	------

Step 5 : Slot Back Panel (6) into H Connector (H) and attach it from behind using Screw (G).

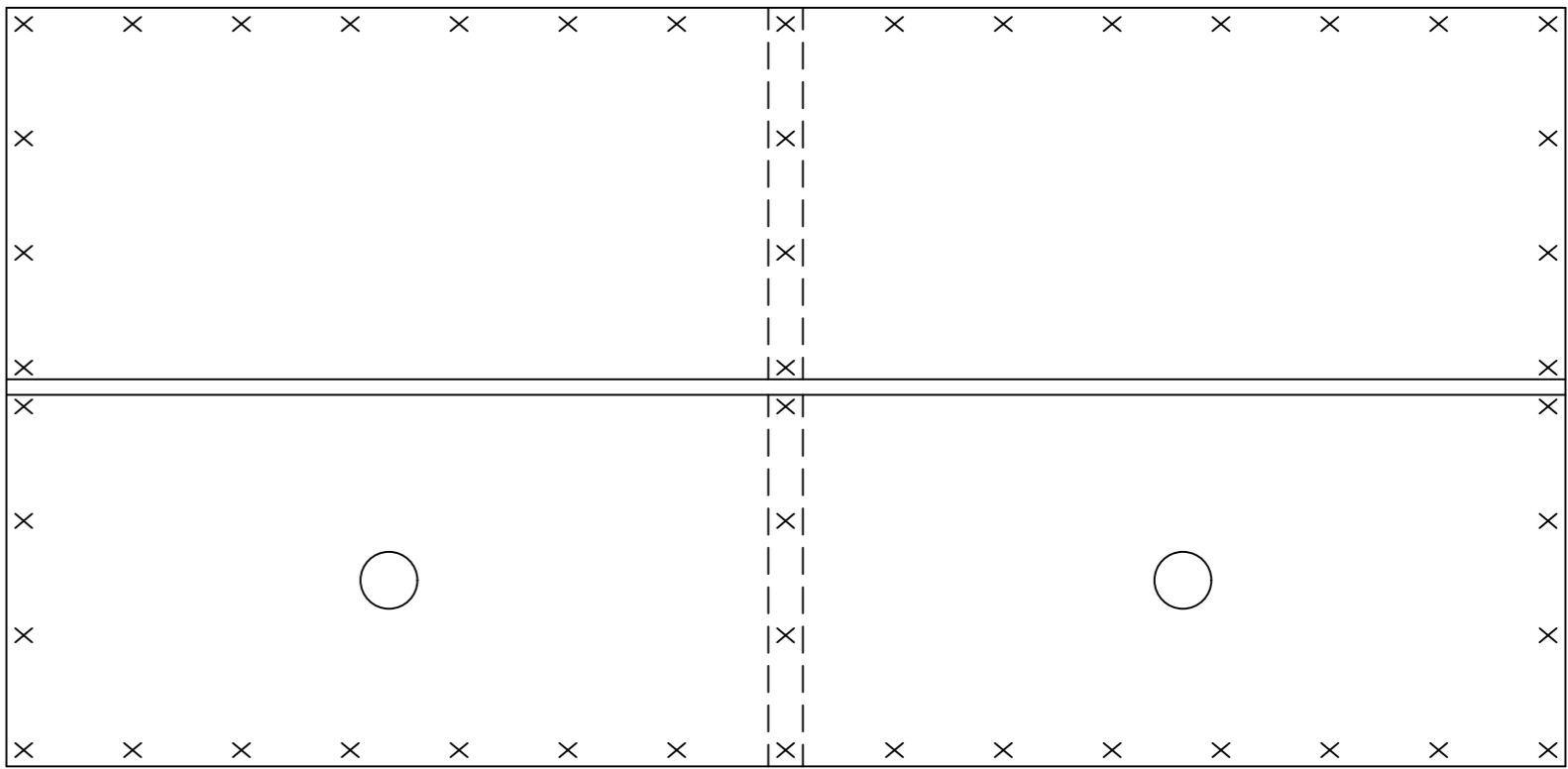
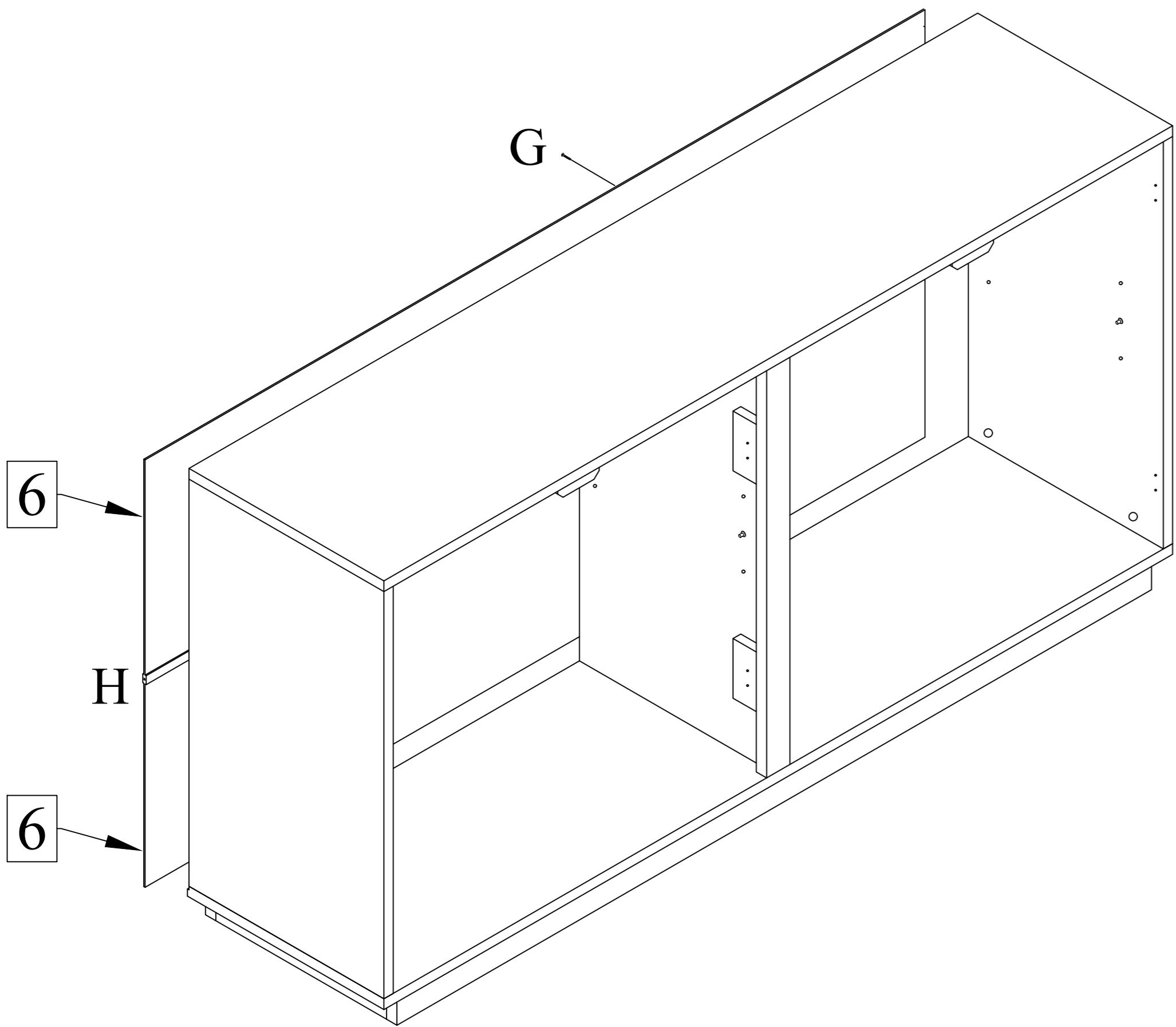

Guidance of screw array

G	Screw M3 x 12MM		48PCS
H	H Connector		1PC

ASSEMBLY INSTRUCTIONS

Item No : WF318154

Description : SIDEBOARD

Thank you for purchasing this quality product. Be sure to check all packing material carefully for small part that may have come loose inside carton during shipment.

Step 6 : Insert Shelves (7).

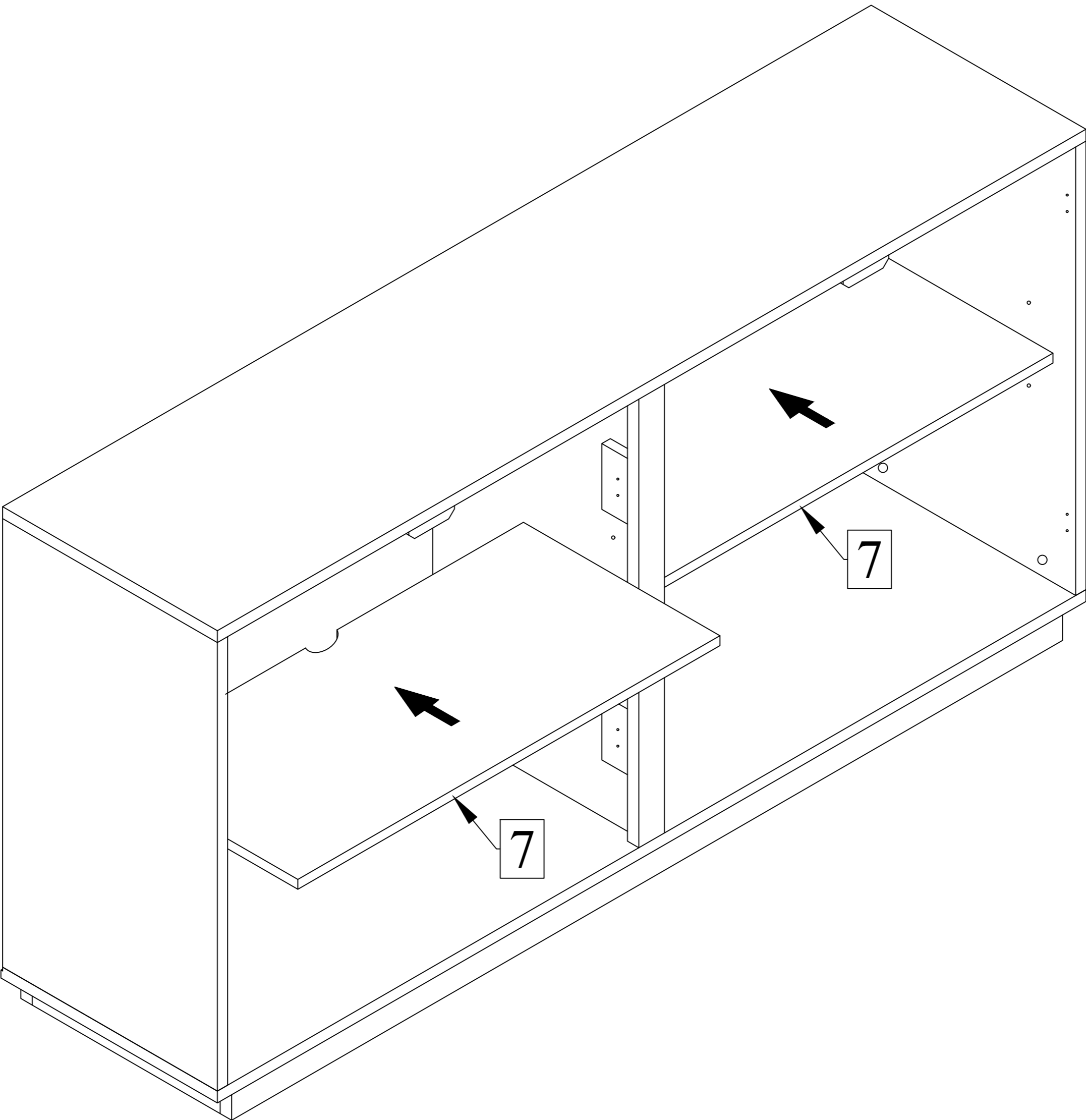

Step 7 : Attach Doors (11) using Screw (F). Attach Handle (I). Completed Assembly.

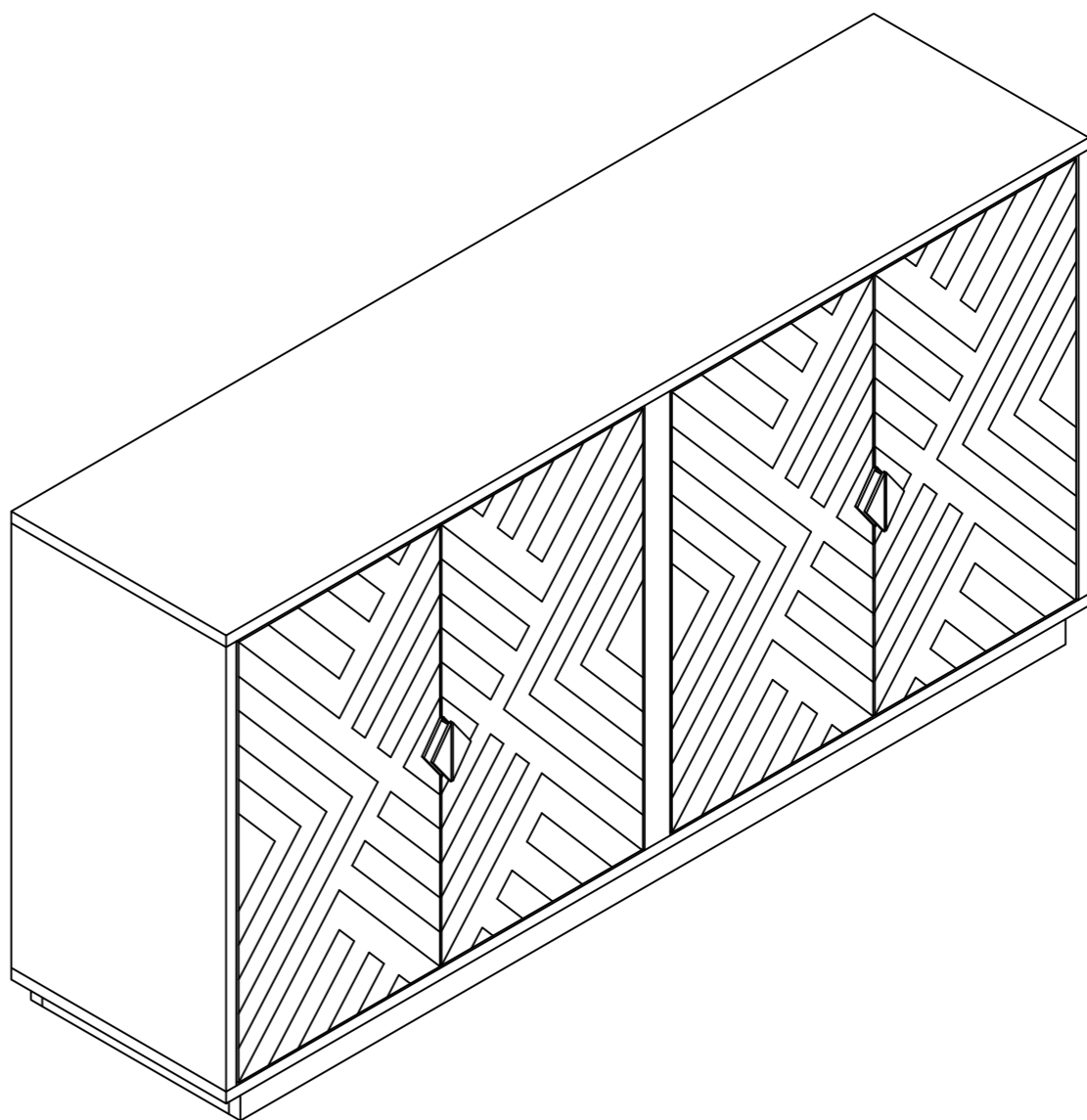
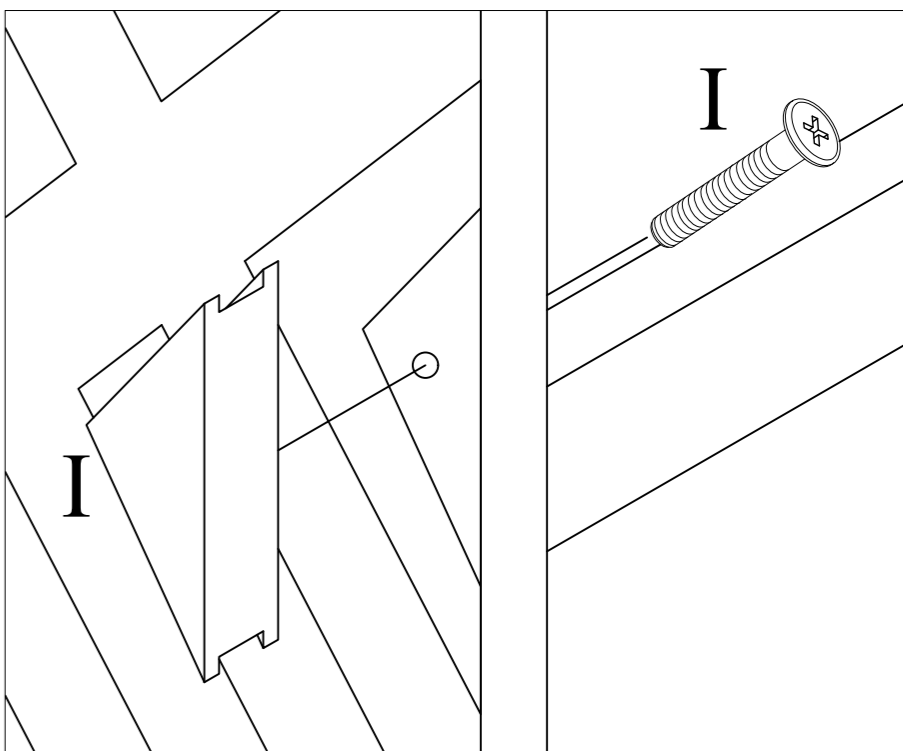
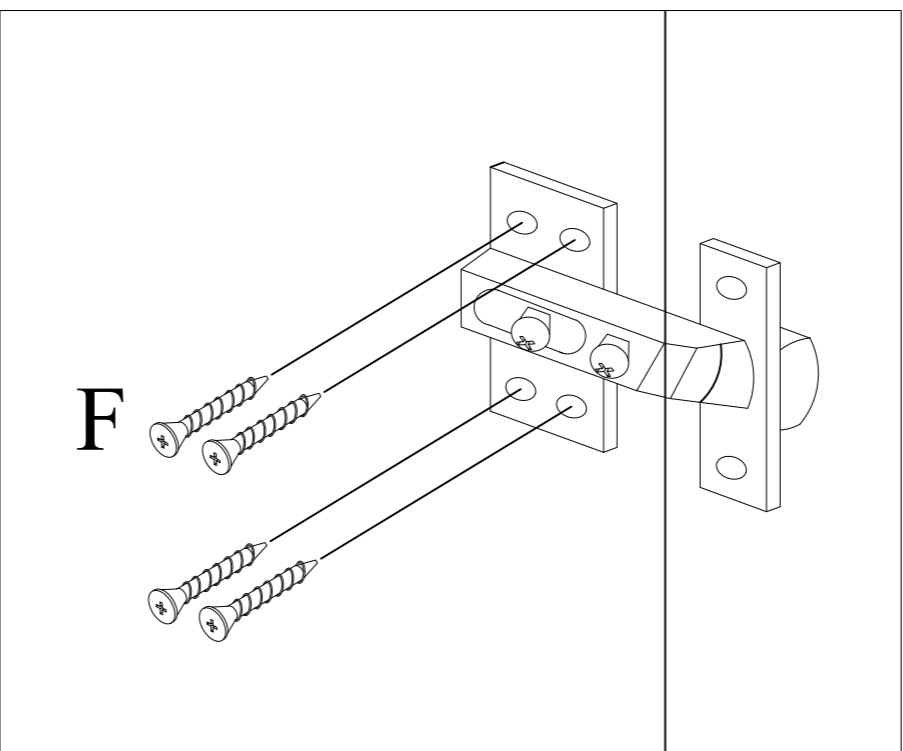
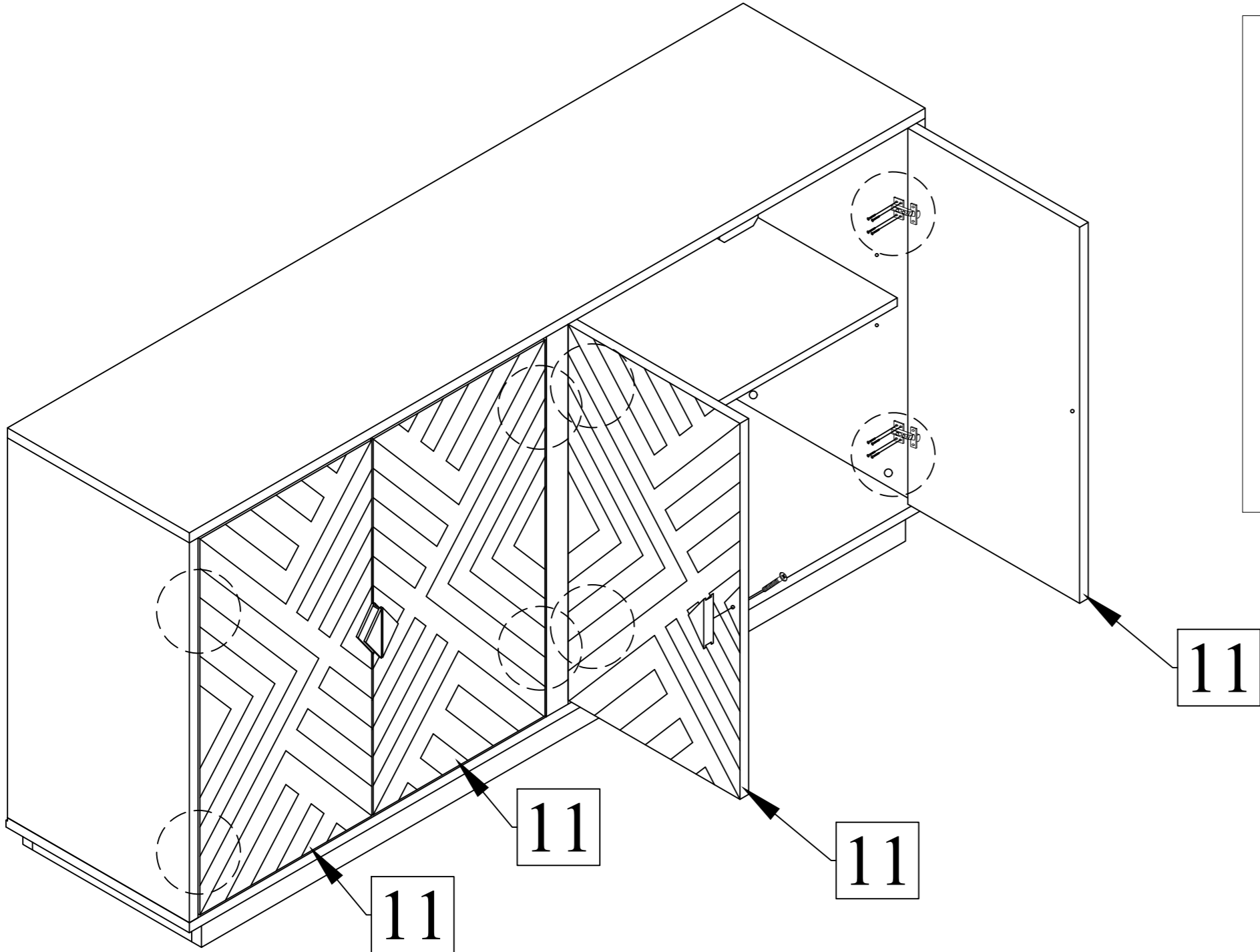

Door Adjustment

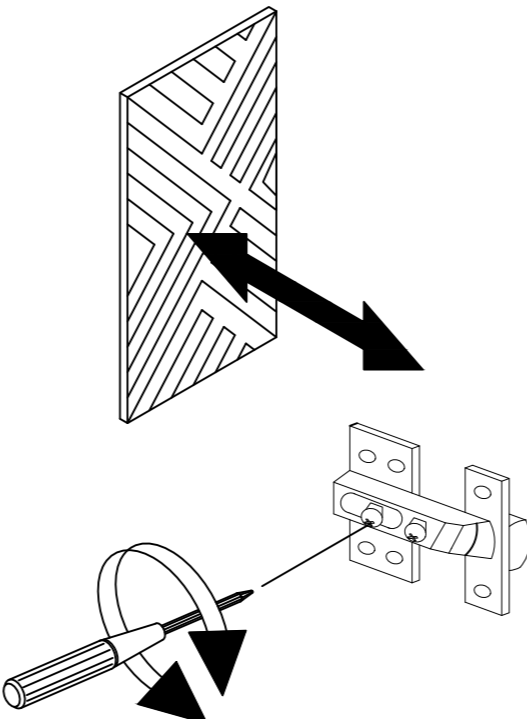
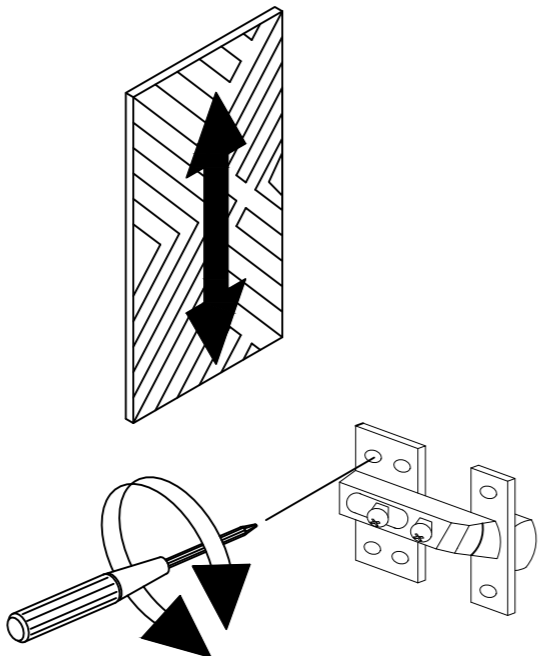
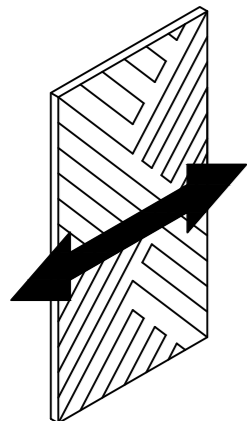

F	Screw M3.5 x 16MM		32PCS
I	Handle with Screw		4SETS