

# ASSEMBLY INSTRUCTIONS

---

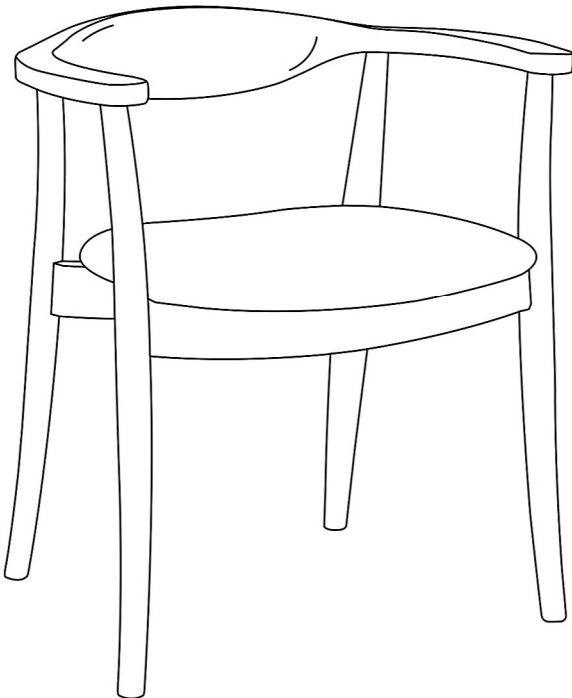

## TOOLS REQUIRED



Screwdriver  
(Not Included)

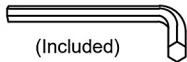

(Included)  
Allen Wrench



2 - People

## ASSEMBLY RATING

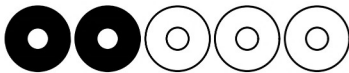

EASY ————— DIFFICULT

The Assembly Rating is a 5-point system showing the level of effort needed to assemble a specific product.



## **CHECK BEFORE STARTING**

☐

### **Are you missing anything?**

Double-check all parts, hardware and accessories listed are all accounted for.

☐

### **Check out our Quick Tips!**

We recommend reviewing the pre-assembly handouts. Even experts need a refresher now and then!

☐

### **Should we send any replacements?**

Are there any irregularities or flaws in the parts? We can send replacements!

☐

### **Prep Time!**

Please review the assembly instructions and all diagrams prior to assembling.

# PRE ASSEMBLY INTRODUCTION

We understand building ready-to-assemble furniture can be a challenging experience for some. To help avoid confusion, we have provided some helpful tips that may speed up the process.

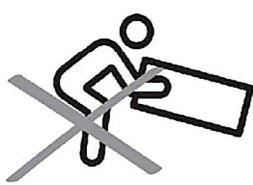

## Teamwork

ALWAYS have at least two people to help with transporting and assembling the product to avoid potential injury and/or damage.



## Suitable Location

Assembling near the area of the intended location is highly recommended.



## Sufficient Space

Make sure you have enough space to move around during the assembly.



## Avoid Scratches

Use cardboard, blankets or a carpeted area while assembling furniture to prevent to prevent scratches and damages.

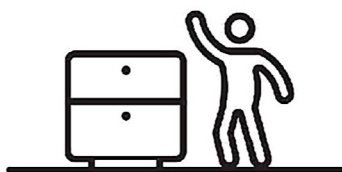
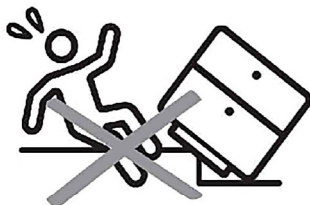

## Flat Surface

Make sure the furniture rests on a flat and level surface with each leg evenly touching the floor.

# ASSEMBLY AND CARE ADVICE



**FAILURE TO FOLLOW THE GUIDELINES BELOW MAY  
RESULT IN INJURY AND/OR PROPERTY DAMAGE.**



Position each part correctly  
and insert screws or bolts into  
their respective holes.



Use the appropriate hand tools  
or power tools for assembly.  
Select steps, such as tightening  
screws and/or bolts, may require  
hand tools to avoid causing  
damage during assembly.

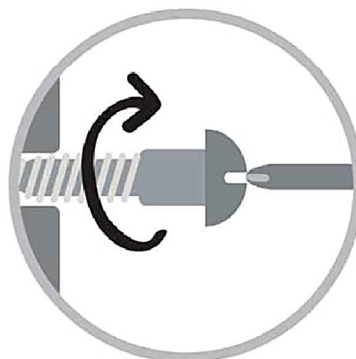

Turn clockwise to tighten and  
only tighten when step is  
completed or when instructed  
to do so.



Save the instructions and store  
any supplied tools for later  
maintenance.

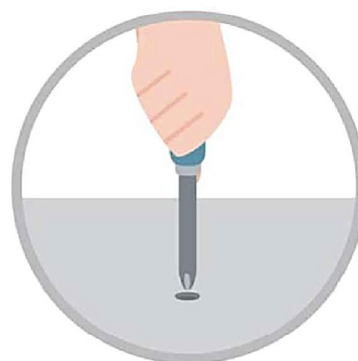

After two weeks, check and  
tighten any loose hardware and  
repeat again every six months  
thereafter.

**IT IS THE USER'S RESPONSIBILITY TO MAINTAIN THE FURNITURE. THE HARDWARE MAY LOOSEN OVER TIME AND MAY CAUSE THE FURNITURE TO BE WOBBLY AND UNABLE TO SUPPORT ITS INTENDED WEIGHT CAPACITY. THIS MAY LEAD TO COLLAPSE AND MAY CAUSE SERIOUS INJURY.**

# DINING SIDE CHAIR



- Please keep instructions for future reference.
- Check the quantity and irregularity of parts and hardware before you start.

## PARTS

① 1pc

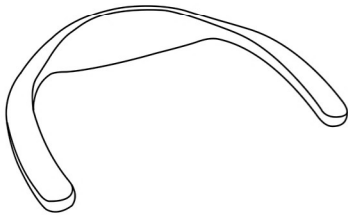

BACK REST

② 1pc

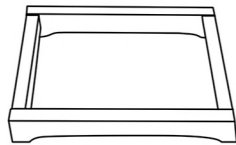

BOX SEAT

③ 1pc

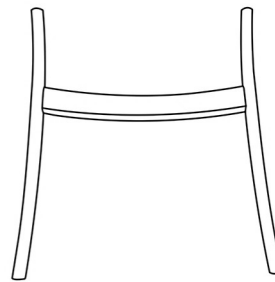

FRONT LEG

④ 1pc

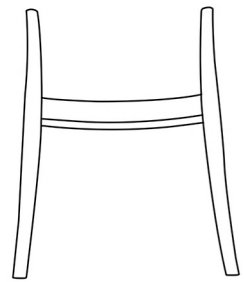

BACK LEG

⑤ 1pc

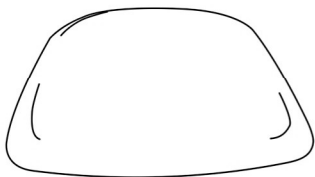

CUSHION SEAT

**HARDWARE**

A 12pcs

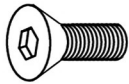

CSK BOLT  
M6 x 20MM

B 8pcs

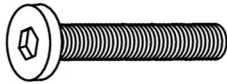

JCBC BOLT  
M6 x 35MM

C 8pcs



LOCK WASHER  
M6

D 8pcs



FLAT WASHER  
M6

E 4pcs



CSK SCREW  
M4 x 32MM

F 1pc



ALLEN KEY  
M4

G 4pcs



METAL PLATE

# ASSEMBLY INSTRUCTIONS

1

- Part (2) x 1pc
- Part (3) x 1pc
- Part (4) x 1pc
- Hardware (A) x 4pcs
- Hardware (B) x 8pcs
- Hardware (C) x 8pcs
- Hardware (D) x 8pcs
- Hardware (F) x 1pc
- Hardware (G) x 4pcs

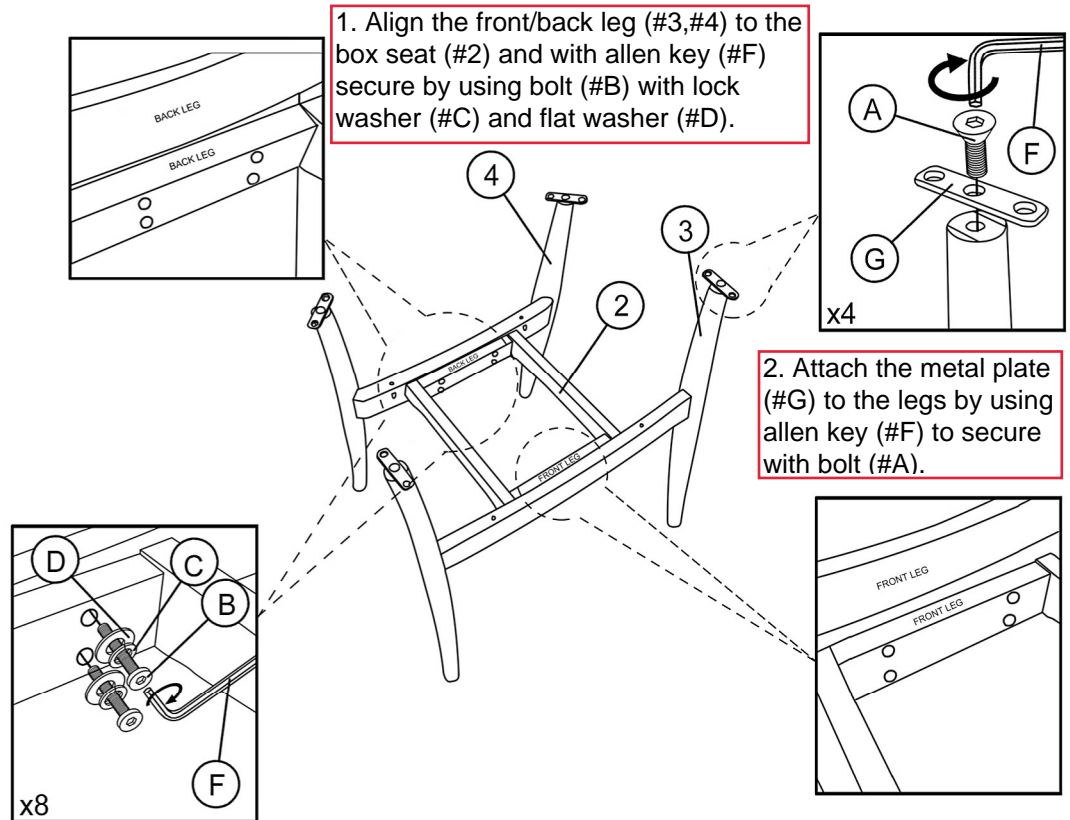

2

- Part (1) x 1pc
- Hardware (A) x 8pcs
- Hardware (F) x 1pc

Align the back rest (#1) to the metal plates (#G) and with allen key (#F) secure using bolt (#A).

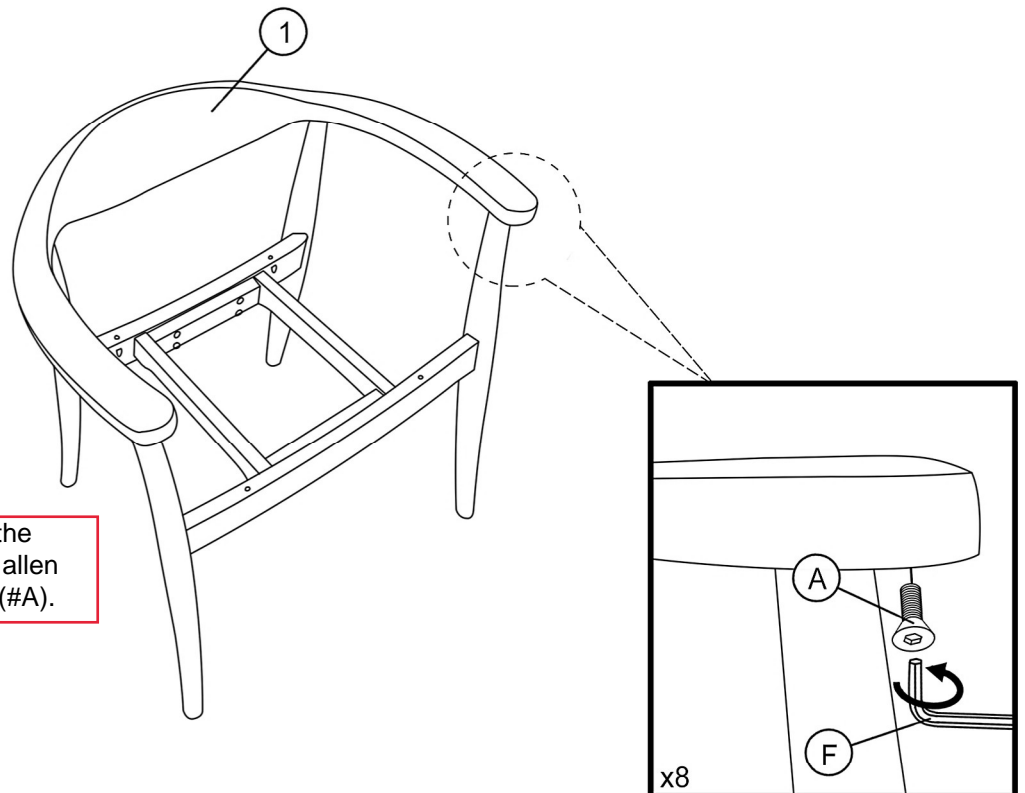



# ASSEMBLY INSTRUCTIONS

3

Part (5) x 1pc

Hardware (E) x 4pcs

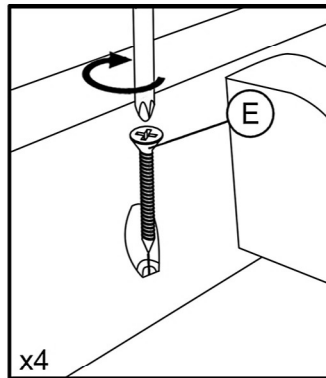

Flip chair over and align the cushion seat (#5) to the frame. Secure by using screw (#E).

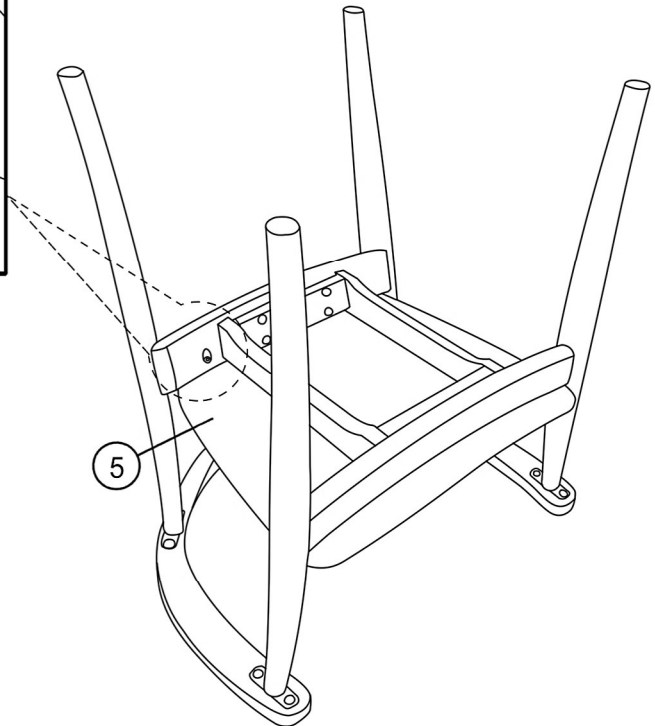

4

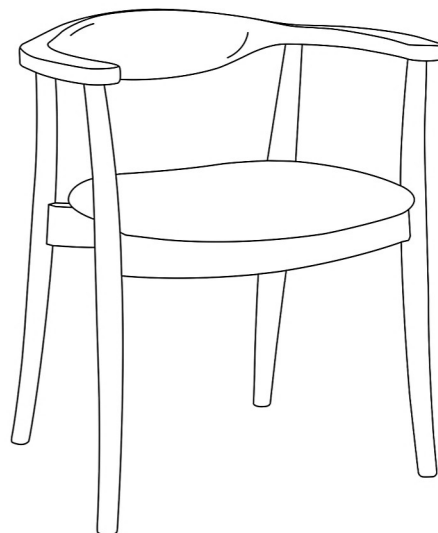

## ASSEMBLY COMPLETED



Please ensure the furniture rests on an even and flat surface. If the product wobbles or feels loose, double-check all bolts and/or screw are properly tightened and secured.



### Keep this handy!

Please retain this instruction manual and any order-related information for future reference.



### Lift, don't drag!

To avoid damage to product please always LIFT the product when transporting or adjusting the placement.

This product is intended for RESIDENTIAL USE ONLY and not for commercial use.