

USE AND CARE GUIDE



01 Table of Contents

Safety Information	02	Remote control manual	07
Warranty	03	Match code	08
Ceiling installation	04	Care and cleaning	09
Accessory drawing	05	Trouble shooting	10
Installation procedure	06		

02 Safety Information

READ ALL SAFETY INFORMATION AND INSTALLATION INSTRUCTIONS BEFORE YOU BEGIN INSTALLING THE FAN AND SANE INSTRUCTIONS.



Warning:
Kindly turn off the power
when connecting cables.



1. To reduce the risk of electric shock, ensure the electricity has been turned off at the circuit breaker or fuse box before you begin.
2. All wiring must be in accordance with the National Electrical Code ANSI/NFPA 70-1999 and local electrical codes. Electrical installation should be performed by a qualified licensed electrician.
3. The outlet box and support structure must be securely mounted and capable of reliably supporting 35 lbs. (15.9 kg). Use only UL Listed outlet boxes marked "Acceptable for Fan Support of 35 lbs. (15.9 kg) or less".
4. The fan must be mounted with a minimum of 7 ft. (2.1 m) clearance from the trailing edge of the blades to the floor.
5. Do not place objects in the path of the blades.
6. To avoid personal injury or damage to the fan and other items, use caution when working around or cleaning the fan.
7. Electrical diagrams are for reference only. Light kits that are not packed with the fan must be UL-listed and marked suitable for use with the model fan you are installing. Switches must be UL General Use Switches. Refer to the instructions packaged with the light kits and switches for proper assembly.
8. After making electrical connections, spliced conductors should be turned upward and pushed carefully up into the outlet box. The wires should be spread apart with the grounded conductor and the equipment-grounding conductor on one side of the outlet box.
9. All setscrews must be checked and re-tightened where necessary before installation



WARNING: To reduce the risk of personal injury, do not bend the blade brackets (also referred to as flanges) during assembly or after installation. Do not insert objects in the path of the blades.



WARNING: To reduce the risk of fire or electric shock, this fan is NOT suitable for use with solid-state speed controls.



WARNING: To avoid possible electrical shock, make sure that the electricity is turned off at the main power box before starting work. If you feel you do not have enough electrical wiring knowledge or experience, contact a licensed electrician.



WARNING: Electrical diagrams are for reference only. Optional use of any light kit shall be UL-listed and marked suitable for use with this fan



WARNING: To reduce the risk of fire, electrical shock or personal injury, ensure that the fan mounting bracket is supported directly from the building structure or the outlet box marked "Acceptable for Fan Support of 35 lbs. (15.9 kg) or less". Use only the screws provided with the outlet box.

04 Three ceiling installation methods

Concrete Ceiling Mounting Bracket

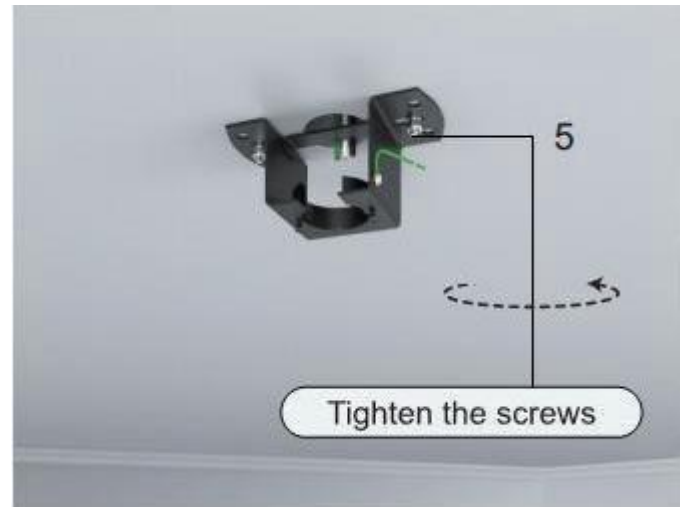
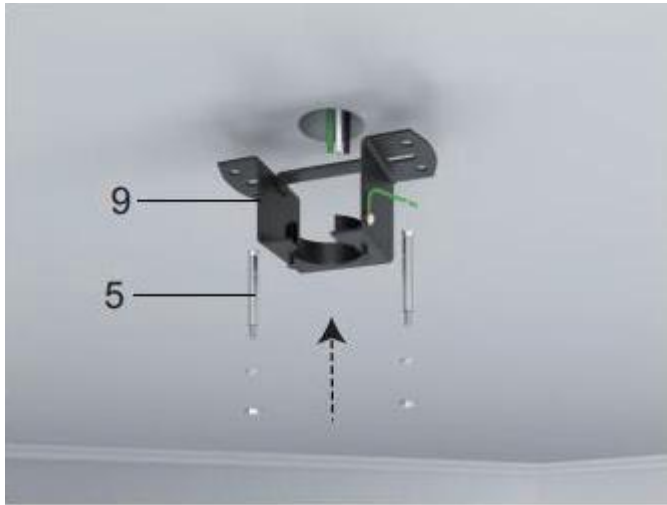

Hanger for Junction Box Mounting Bracket

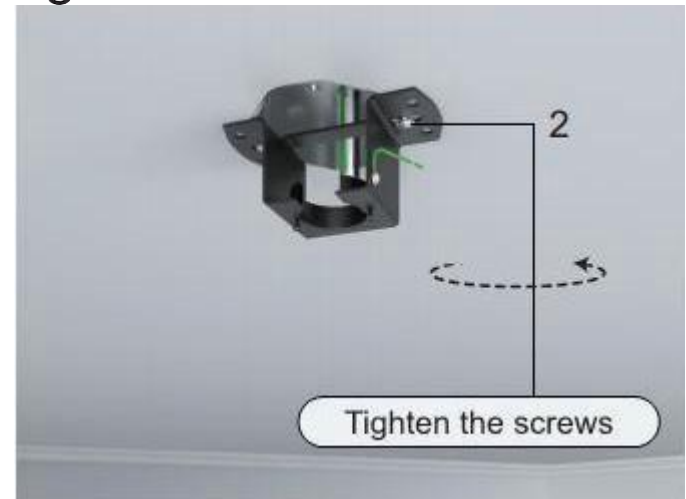
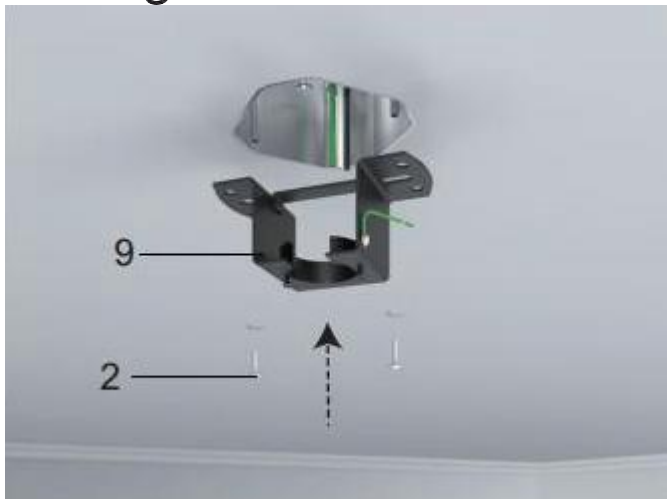

Wooden ceiling Mounting Bracket

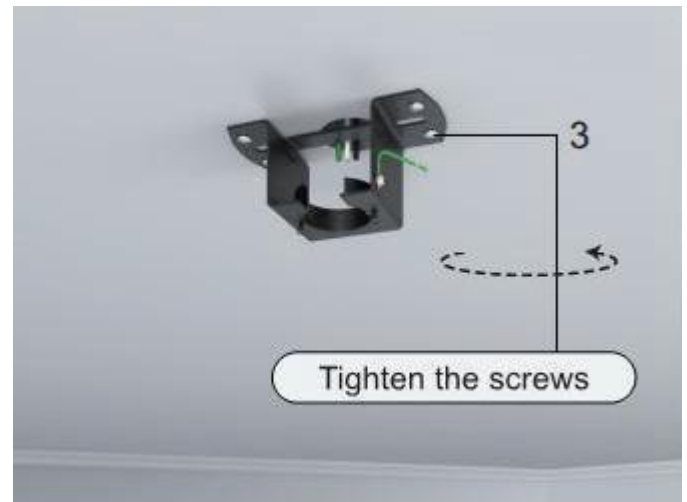
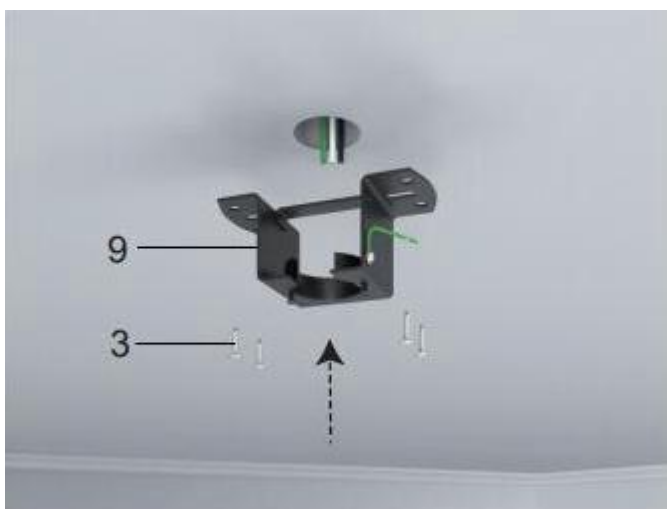

05 Accessory drawing

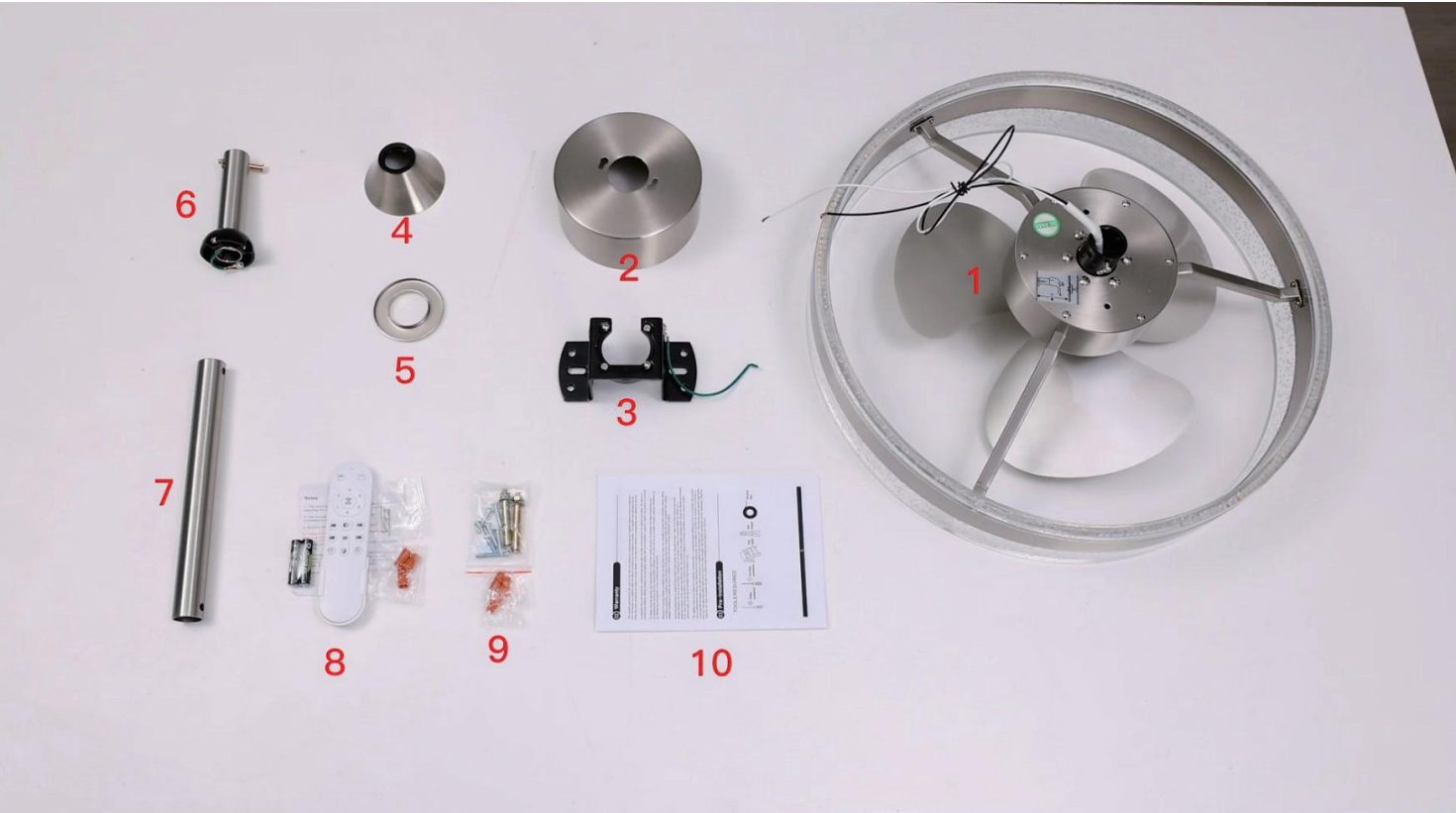
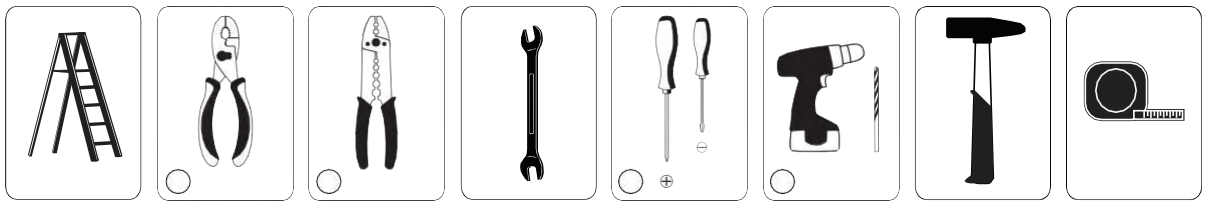

06 Installation procedure

1. Remove the lock pin and the bolt of the base of the downrod



2. Remove 2 screws on the hanger ball. Remove the hanger ball and bolt



3. Loosen the screws



4. Select one downrod and pass all motor wires through the downrod



5. Insert the bolt

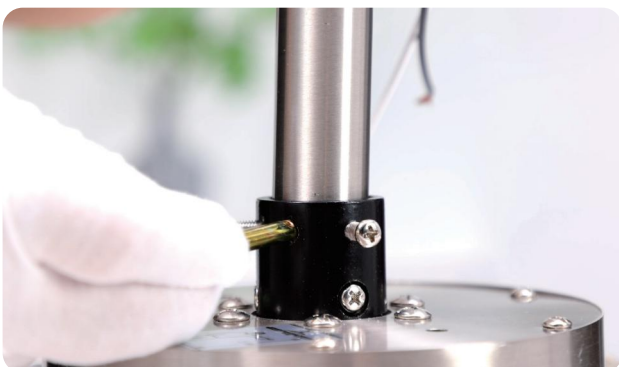

6. Fix the bolt with the lock pin

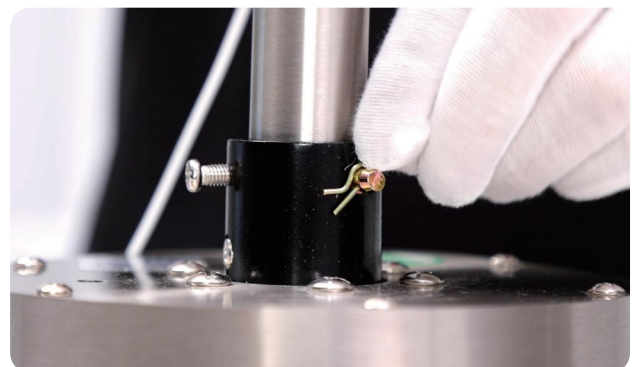

06 Installation procedure

7. Tighten the 2 screws to prevent fan shaking during operation

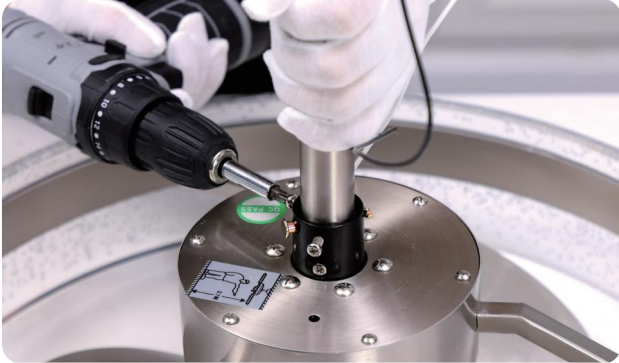

8. Put the decorative cover through the downrod



9. Put the canopy cover through the downrod



10. Put the canopy through the downrod



11. Put the hanger ball through the downrod



12. Insert the bolt



06 Installation procedure

13. Align the screw holes of the hanging ball and boom, use screws to align the screw holes and tighten the screws



14. Loosen 2 screws from the mounting bracket (do not remove them all)



15. Install the mounting bracket, tighten the screws



16. Install the downrod, put the rod ball to the slide-on mounting bracket (both of them have the gaps, align the gap and jam it)

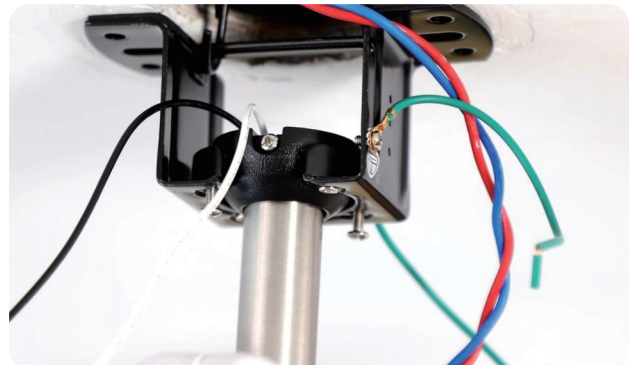

17. Use wire connecting nuts to connect the two ground wires (Green)



18. Connect the fan live wire (black) to your house live wire; Connect the fan neutral wire (white) to your house neutral wire

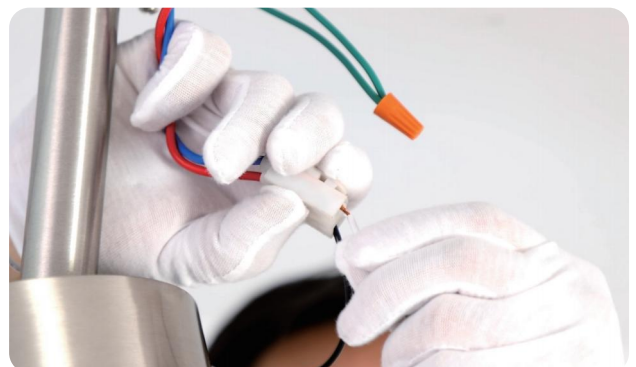

06 Installation procedure

19. Lift the canopy into place so that the screw holes are aligned. Wrap keyhole slots around the screws, twist clockwise and tighten 2 screws

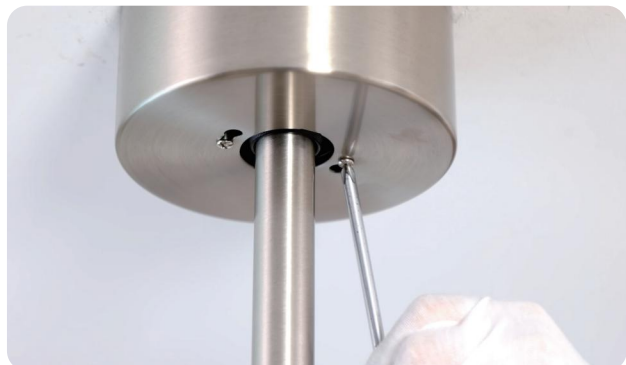

20. Lift the canopy cover to the canopy, then turn and tighten



WARNING: Turn off the electric power during installation and making wire connection.

1. Connect the wire which from ceiling fan into the receiver
2. Connect the wire from receiver with the wire from house.

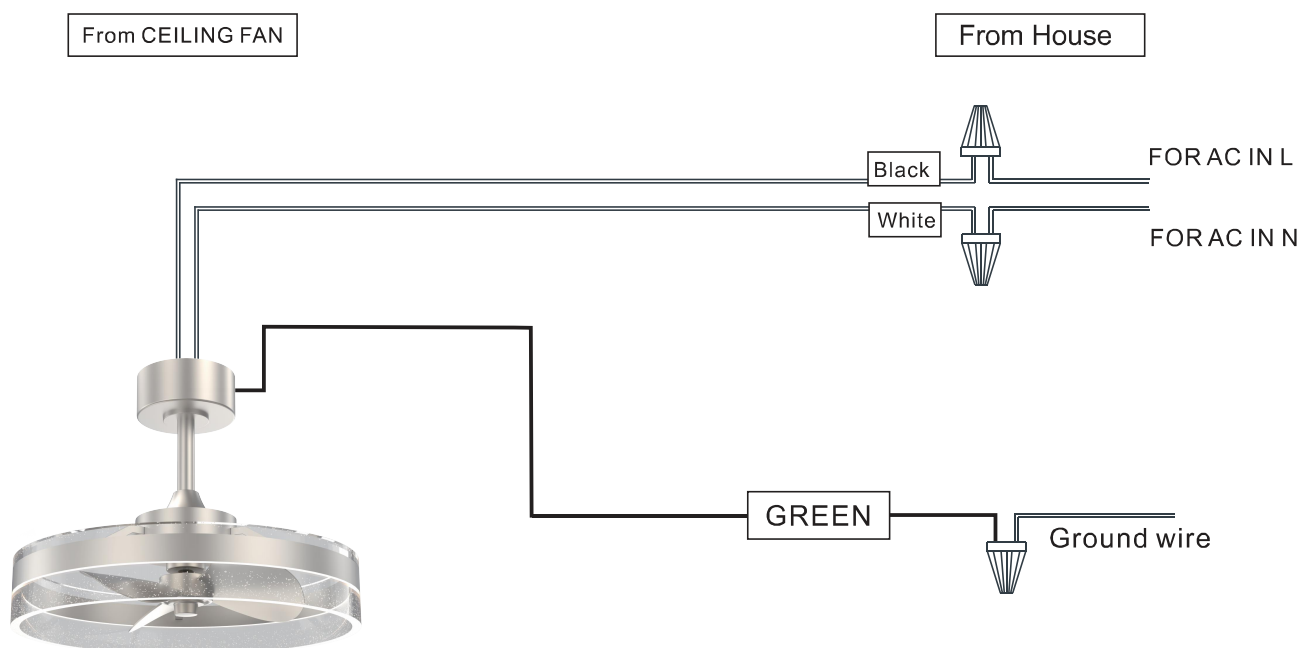

07 Remote control manual

Remote control manual for DC variable frequency (bedroom) fan lights 2.4G Dimming and Color Adjusting Fan Controller



Scan and download the app

Pairing button.
In order to ensure the successful control of the device by the application, please click this button within 5 seconds after the device is powered on.

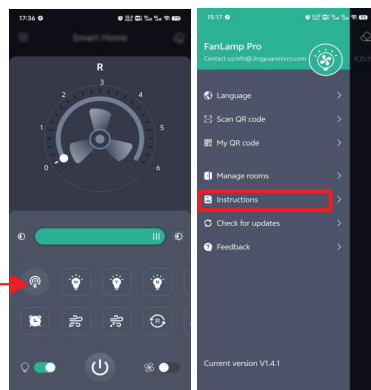

Decoding: Long press for 5 seconds after powering on, The light flashes to complete the decoding.

Wind speed 1-6 gear

White light/yellow light/neutral light switching

Increased brightness

Natural Wind

Reduced brightness

Fan forward/reverse switch

Night light

ON/OFF

General
(turn off all functions)

Turn off the fan
Code: Press and hold within 5 seconds of power on. The light flashes to complete the code.

Increased color temperature

Lower color temperature

2-hour time

model No

AAA 1.5V*2

Turn on the power switch, press the "STOP" button within 5 seconds, and the light will flash 3 times to successfully match the code.

Kind reminder: When the remote control cannot be effectively controlled, please check the battery. If it is not used for a long time, please remove the battery.

- Notes:**
1. The receiver should not be installed upside down to avoid affecting the unevenness of the outer cover and the ceiling.
 2. The receiver is divided into input and output. It is strictly prohibited to switch input and output wiring.
 3. Working voltage of this product: **AC100-265V**.
 4. If there is a wall switch on the fan, it must be in the on state to effectively control.
 5. Please refer to the wire color and sleeve color instructions for wiring.
 6. When using the remote control, please check if the battery is installed correctly (pay attention to the positive and negative poles of the battery). The indicator light will flash every time the handle control button is pressed.

08 Fans Balance



if it does not work

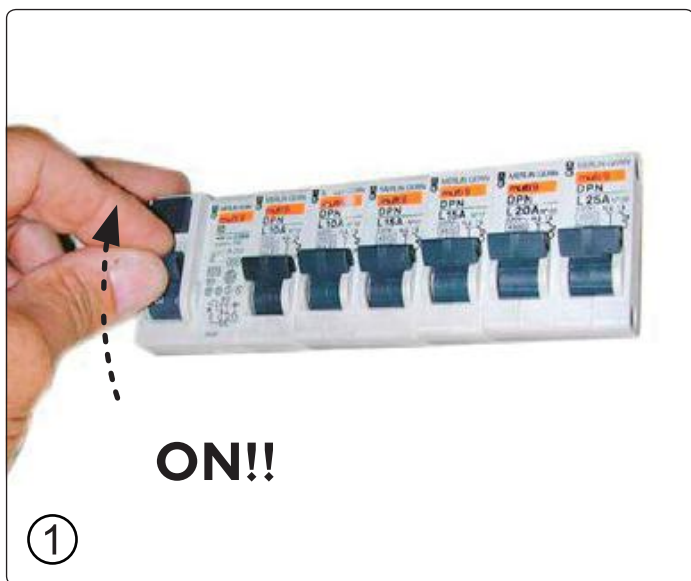

1. Turn on the main switch.



2. Pressing and holding this key for 5 seconds.



09 Care and Cleaning



WARNING: Make sure the power is off before cleaning your fan.

- Because of the fan's natural movement, some connections may become loose. Check the support connections, brackets, and blade attachments twice a year. Make sure they are secure. It is not necessary to remove the fan from the ceiling.
- Clean your fan periodically to help maintain its new appearance over the years. Do not use water when cleaning, as this could damage the motor, or the wood, or possibly cause an electrical shock. Use only a soft brush or lint-free cloth to avoid scratching the finish. The plating is sealed with a lacquer to minimize discoloration or tarnishing.
- You can apply a light coat of furniture polish to the wood for additional protection and enhanced beauty. Cover small scratches with a light application of shoe polish.
- You do not need to oil your fan. The motor has permanently-lubricated sealed ball bearings.

10 Trouble shooting

Problem	Solution
The fan will not start.	<ul style="list-style-type: none">□ Check the main and branch circuit fuses or breakers.□ Check the line wire connections to the fan and switch wire connections in the switch housing.
The fan is noisy.	<ul style="list-style-type: none">□ Ensure all motor housing screws are snug.□ Ensure the screws that attach the fan blade bracket to the motor hub are tight.□ Ensure the wire nut connetions are not ratting against each other or the interior wall of the switch housing.□ Allow a 24-hour "breaking in" period. Most noises associated with a new fan disappear during this time.□ If you are using the Ceiling Fan light kit,ensure the screws securing the glassware are tight.Check that the light bulbs are also secure.□ Ensure the canopy is a short distance from the ceiling.It should not touch the ceiling.□ Ensure your outlet box is secure and rubber isolator pads wereused between the mounting plate and outlet box.
The fan wobbles.	<ul style="list-style-type: none">□ Please check and follow the instructions: Chapitre No.13 Fan balance on page 16

