

CH

The Original CH multi-purpose Strip Lights are offered in a variety of sizes and lamp configurations for a custom lighting design. Labor-saving flip-up sockets simplify installation.

HOUSING Die-formed heavy gauge steel with high-gloss, baked white enamel finish over rust inhibiting phosphate coat with removable wireway access panel. Ample knock outs provided on side, back and ends. Shipped fully wired and assembled, including socket saddle. Simply flip up socket bar and attach wireway cover with turn fastener provided. Machine installed shunts eliminate loose socket bar connections on electronic strips.

OPTIONS Modular wiring, white or silver asymmetric or symmetric reflectors, and emergency lighting battery packs are available options.

ELECTRICAL Fully wired Universal 120-277V, 50-60Hz operation with thermally protected, automatic resetting Class P, sound rated A ballast as standard unless otherwise specified.

LED LAMPS This product offers LED lamps. LED lamps may be ordered as an accessory in place of 2' and 4' T8 fluorescent lamps. Not compatible with emergency lighting or dimming options. See ordering information and performance table for more data.

MOUNTING Combination end plate/joiner connect units for continuous row or wire through, use CHJ. Optional plug-in wiring system available.

LISTINGS C-UL-US Listed damp location.

WARRANTY 5 year manufacturers limited warranty on LED T8 Lamps.

Project _____

Catalog Number _____

Type _____

Date _____

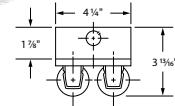

CH Striplite Configuration

| SERIES | # LAMPS | LAMPS* | ELS OPTIONS | BALLAST | SWITCHING | VOLTAGE |
|--------|---|---|--|---|--|--|
| CH | 1 2 4 21 = Tandem, 2 lamps 22 = Tandem, 4 lamps | 14 = 14W 15" T12 14 = 14W 24" T5 15 = 15W 18" T8/T12 17 = 17W 24" T8 20 = 20W 24" T12 21 = 21W 36" T5 24 = 24W 24" T5HO 25 = 25W 36" T8 28 = 28W 48" T5 30 = 30W 36" T12 32 = 32W 48" T8 39 = 36W 36" T5HO 40 = 34/40W 48" T12 40TT = 40W 22" TT T5 54 = 54W 48" T5HO | ELS1 = Emergency Lighting (T8 500 lm, T5 700 lm) ELS2 = Emergency Lighting (T8 700 lm, T5 700 lm) ELS3 = Emergency Lighting (T8 1400 lm, T5 1400 lm) | B5 = Electronic T12 B11 = Electronic T8 B11HP(x) = HP T8* BRES11 = T8** B12 = Electronic T5 B14 = Electronic TT B21 = LPF T8*** D = Dimming (Specify Ballast) CS = Customer Supplied B9 = Customer Specified L/BAL = Less Ballast | For 2 lamp units: Blank = One 2-lamp ballast 2/1L = Two 1-lamp ballasts For 4 lamp units: Blank = Dual Ballasts 4L = (1) 4-lamp ballast | UNV = 120-277V 120 = 120V 277 = 277V |

*CEE listed T8; specify (L)ow, (N)ormal, or (H)igh ballast factor. Contact factory for NEMA Premium. Tube guards are NOT recommended on T5 lamps.
**For 2 and 4 lamp 32W Energy Star fixtures
***Fixtures with B21 are UL only

| OPTIONS | ACCESSORIES | LED LAMPS (SHIPPED SEPARATELY)* |
|---|--|---|
| Cord and Plug CPT(x) (Twist + Lock) 1 = 120V 2 = 277V CP3 = Cord & Plug - 120V Straight blade 5-15P Plug-in connectors <i>Ballast wired to Black:</i> PL1 = One circuit, two wires PL2 BK = Two circuits, three wires <i>Ballast wired to Red:</i> PL2 RD = Two circuits, three wires FB = Fast blow fuse SB = Slow blow fuse BP = Bulk Pack | Reflectors (Not compatible with wire guards) <i>Symmetric</i> SR(x)(y)20 = 24" SR(x)(y)30 = 36" (Order 2 for tandem 72" units) SR(x)(y)40 = 48" (Order 2 for tandem 96" units) <i>Asymmetric</i> AR(x)20 = 24" AR(x)30 = 36" (order 2 for tandem 72" units) AR(x)40 = 48" (order 2 for tandem 96" units) (x) enter (W) for white or (S) for specular aluminum (y) enter # lamps (1 or 2) AC = alignment Clips CA24 = Chain Hanger assembly - (2) 18" chains, (2) "V" hooks, (2) "S" hooks for total drop 24" CS24 = "S" Hook (4) Chain Hanger assembly (24" total drop) PM(x) = Pendant mount, white stem - specify length in inches (24, 36, 48, 60, 72) C = Single white canopy (for use with pendant mount) CHJ = Housing Joiner SN = Snapper brackets (2 lamp and 4 lamp tandem models only) WG(x)20 = 24" (Specify # lamps) (1 or 2) WG(x)30 = 36" (Specify # lamps) (1 or 2) WG(x)40 = 48" (Specify # lamps) (1 or 2) | LE82M3 = 2' 9W 3000K 1150lm LE82M4 = 2' 9W 4000K 1150lm LE82M5 = 2' 9W 5000K 1150lm LE84M3 = 4' 14W 3000K 1800lm LE84M4 = 4' 14W 4000K 1800lm LE84M5 = 4' 14W 5000K 1800lm LE84H3 = 4' 17W 3000K 1800lm LE84H3 = 4' 17W 3000K 1800lm |

LED T8 Replacement Lamp Performance

| LAMP | COLOR TEMPERATURE | NOMINAL LENGTH | CRI | BEAM ANGLE | LAMP WATTAGE | LAMP LUMENS | INITIAL LUMENS | | | LAMP EFFICACY |
|--------|-------------------|----------------|-----|------------|--------------|-------------|----------------|--------|---------|---------------|
| | | | | | | | .78 BF | .88 BF | 1.18 BF | |
| LE82M3 | 3000K | 2' | >80 | 220° | 9W | 1150 | 945 | 1080 | 1370 | 127 lm/W |
| LE82M4 | 4000K | 2' | >80 | 220° | 9W | 1150 | 1020 | 1170 | 1490 | 127 lm/W |
| LE82M5 | 5000K | 2' | >80 | 220° | 9W | 1150 | 1040 | 1200 | 1520 | 127 lm/W |
| LE84M3 | 3000K | 4' | >80 | 220° | 14W | 1800 | 1620 | 1870 | 2490 | 129 lm/W |
| LE84M4 | 4000K | 4' | >80 | 220° | 14W | 1800 | 1670 | 1940 | 2560 | 129 lm/W |
| LE84M5 | 5000K | 4' | >80 | 220° | 14W | 1800 | 1720 | 2000 | 2620 | 129 lm/W |
| LE84H3 | 3000K | 4' | >80 | 220° | 17W | 2200 | 1930 | 2200 | 2800 | 129 lm/W |
| LE84H4 | 4000K | 4' | >80 | 220° | 17W | 2200 | 1990 | 2300 | 2930 | 129 lm/W |
| LE84H5 | 5000K | 4' | >80 | 220° | 17W | 2200 | 2050 | 2370 | 3080 | 129 lm/W |

Dimensions

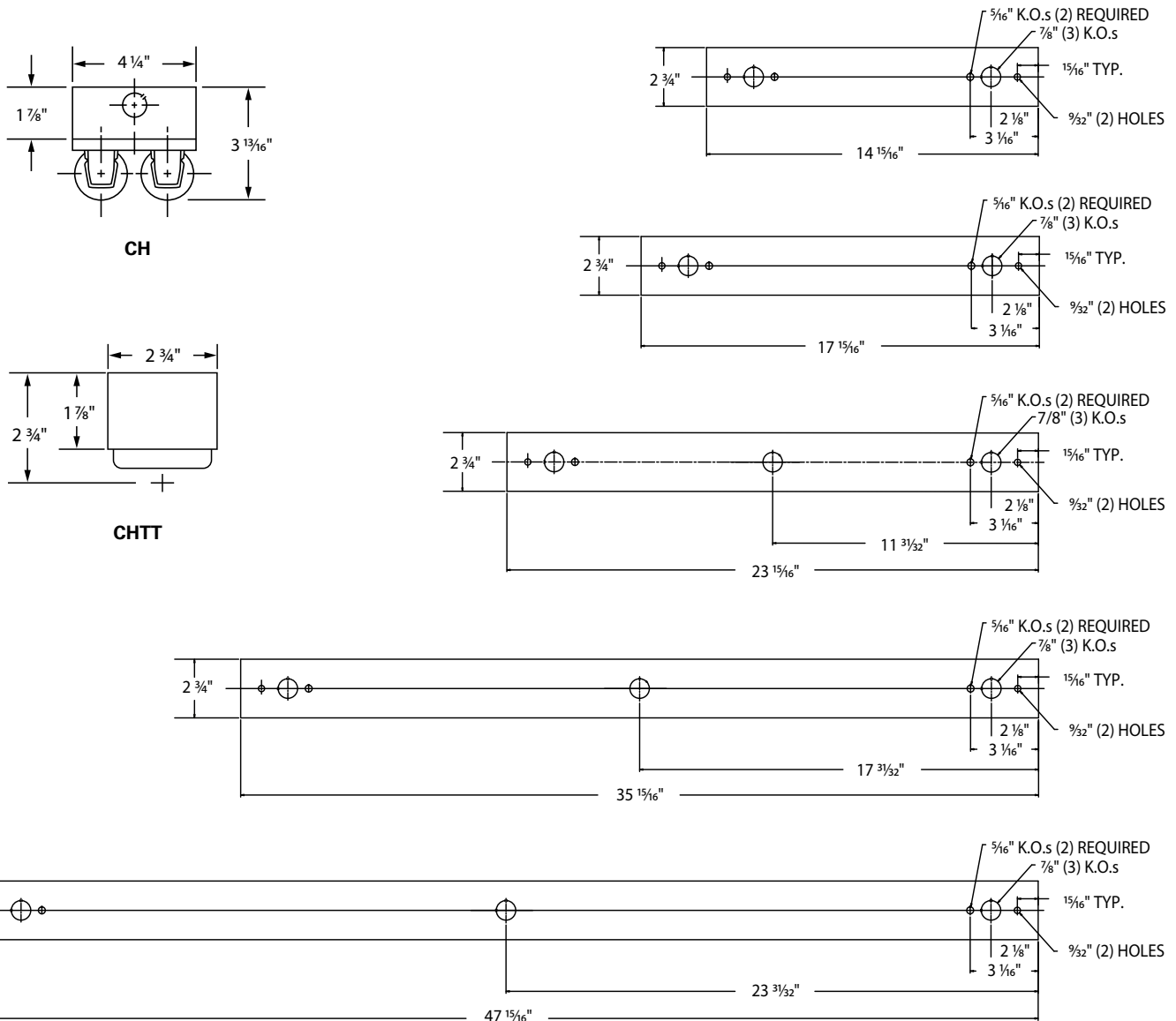

Dimensions

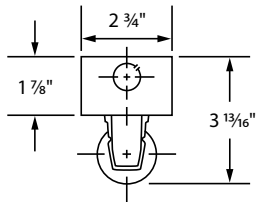
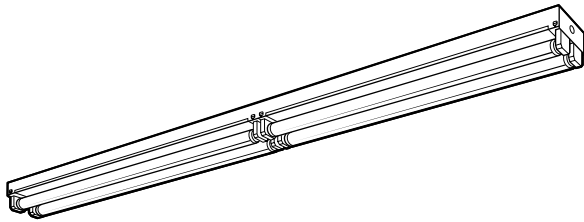
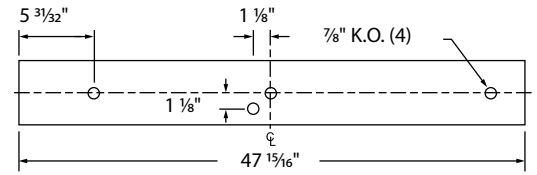
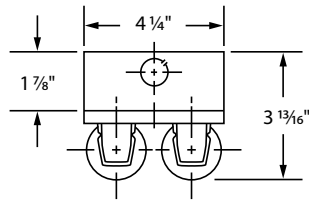
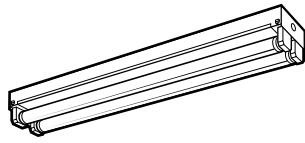

**CH
1 Lamp**

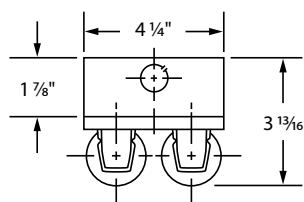

**CH
2 Lamp**

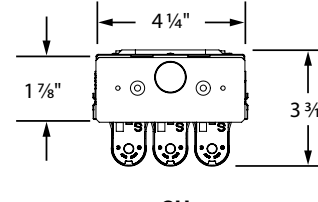

**CH
3 Lamp**

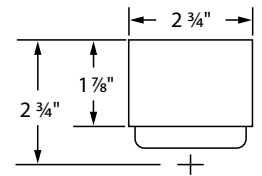

CHTT

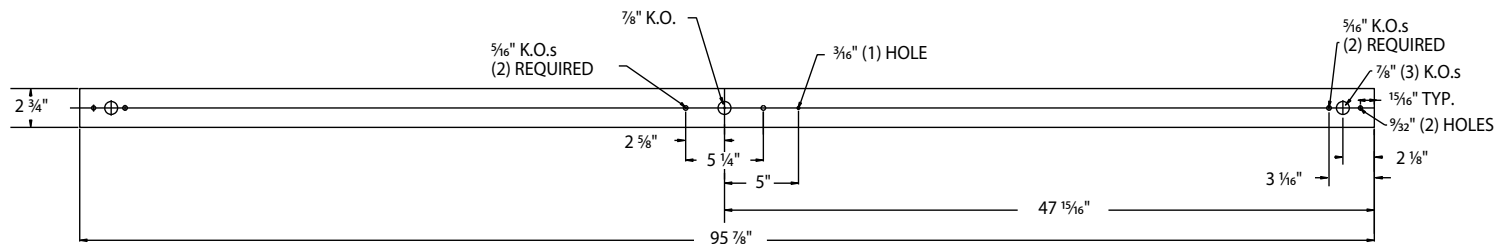

1 LAMP MODELS

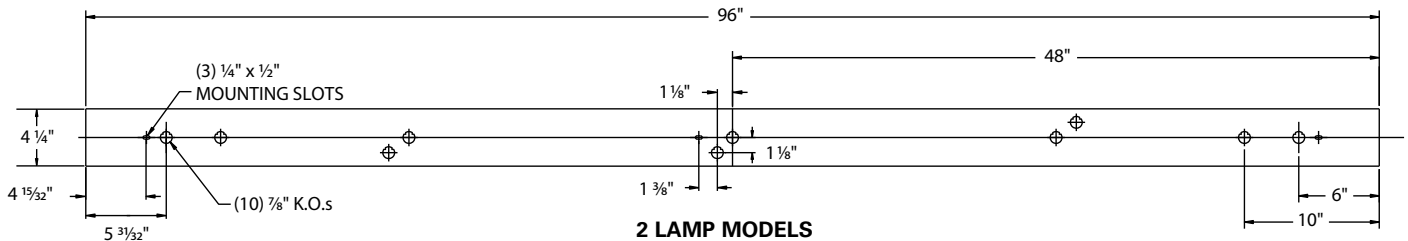

2 LAMP MODELS