

ASSEMBLY INSTRUCTIONS

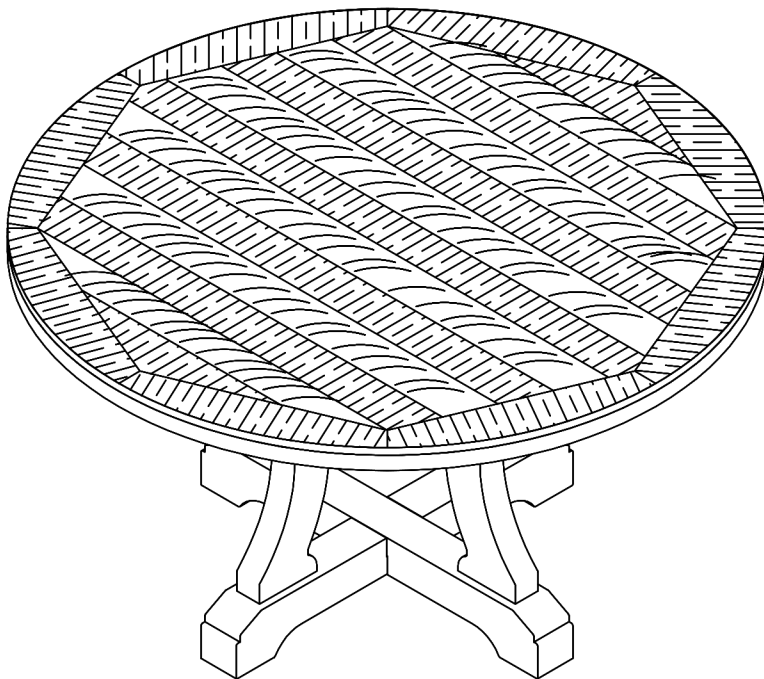

TOOLS REQUIRED



Allen Wrench

(Included)

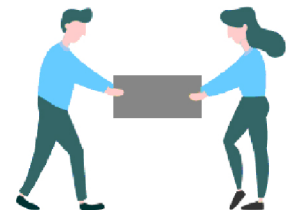

2 - People
Recommended

ASSEMBLY RATING



EASY —————> DIFFICULT

The Assembly Rating is a 5-point system showing the level of effort needed to assemble a specific product.



CHECK BEFORE STARTING

☐

Are you missing anything?

Double-check all parts, hardware and accessories listed on Page 6 are accounted for.

☐

Check out our Quick Tips!

We recommend reviewing the pre-assembly handouts. Even experts need a refresher now and then!

☐

Should we send any replacements?

Are there any irregularities or flaws in the parts? We can send replacements!

☐

Prep Time!

Please review the assembly instructions and all diagrams prior to assembling. Arrange parts as recommended on Page 7 and group identical hardware together to make assembling easier.

PRE ASSEMBLY INTRODUCTION

We understand building ready-to-assemble furniture can be a challenging experience for some. To help avoid confusion, we have provided some helpful tips that may speed up the process.



Teamwork

ALWAYS have at least two people to help with transporting and assembling the product to avoid potential injury and/or damage.

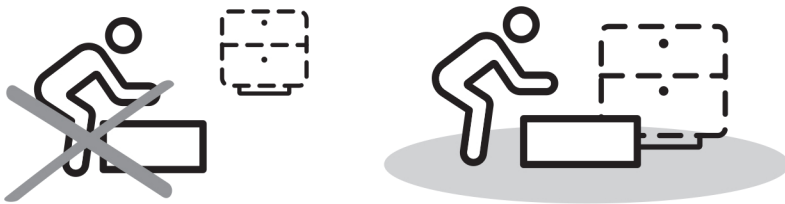

Suitable Location

Assembling near the area of the intended location is highly recommended.



Sufficient Space

Make sure you have enough space to move around during the assembly.

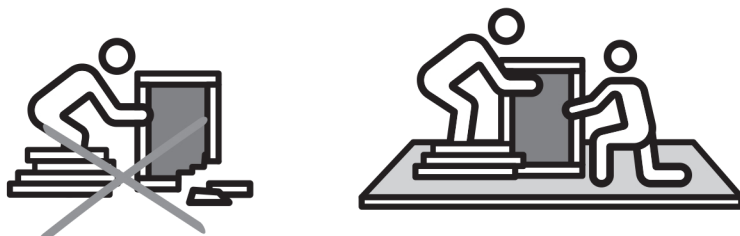

Avoid Scratches

Use cardboard, blankets or a carpeted area while assembling furniture to prevent scratches.

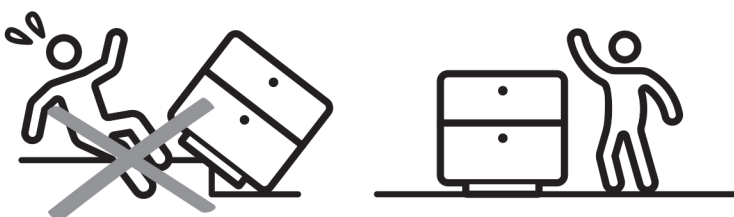

Flat Surface

Make sure the furniture rests on a flat and level surface with each leg evenly touching the floor.

ASSEMBLY AND CARE ADVICE



**FAILURE TO FOLLOW THE GUIDELINES BELOW MAY
RESULT IN INJURY AND/OR PROPERTY DAMAGE.**



Position each part correctly
and insert screws or bolts into
their respective holes.

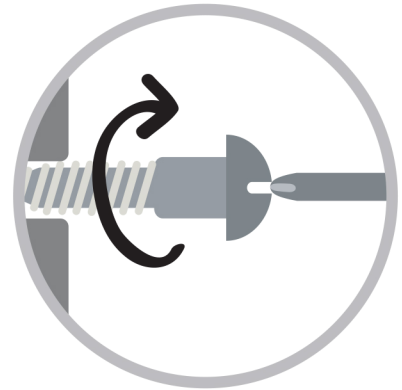

Turn clockwise to tighten and
only tighten when step is
completed or when instructed
to do so.



Save the instructions and store
any supplied tools for later
maintenance.

Use the appropriate hand tools
or power tools for assembly.
Select steps, such as tightening
screws and/or bolts, may require
hand tools to avoid causing
damage during assembly.

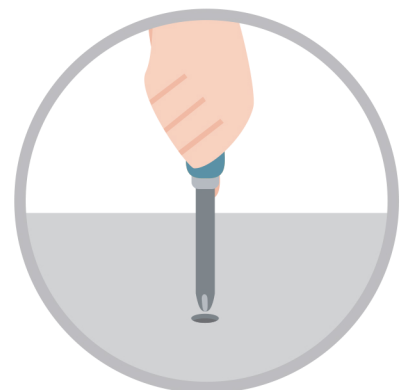

After two weeks, check and
tighten any loose hardware and
repeat again every six months
thereafter.

IT IS THE USER'S RESPONSIBILITY TO MAINTAIN THE FURNITURE. THE HARDWARE MAY LOOSEN OVER TIME AND MAY CAUSE THE FURNITURE TO BE WOBBLY AND UNABLE TO SUPPORT ITS INTENDED WEIGHT CAPACITY. THIS MAY LEAD TO COLLAPSE AND MAY CAUSE SERIOUS INJURY.

TABLE

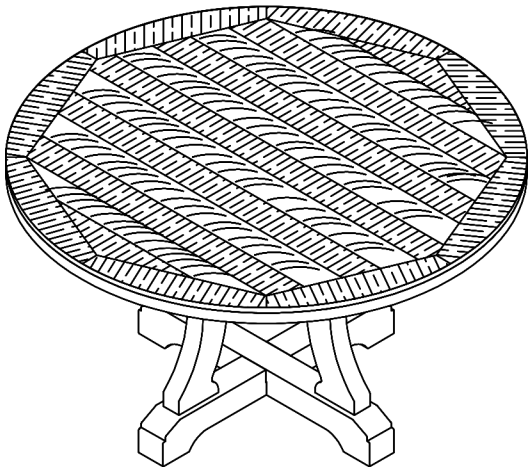
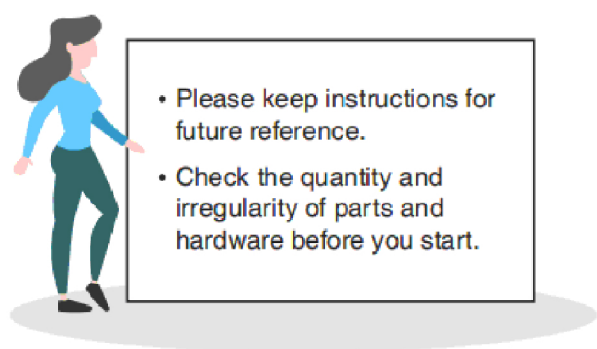

PARTS

#1 1pc



Table Top

#2 4pcs



Legs

#3 1pc

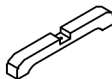

Base Bottom

#4 1pc

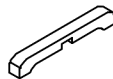

Top Bottom

#5 1pc



Shelf

#6 1pc

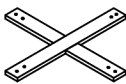

Mounting Plate

HARDWARE

#A 4pcs



Bolt Ø5/16" x 3"

#B 8pcs



Bolt Ø5/16" x 2-3/8"

#C 1pc



Bolt Ø5/16" x 1-3/4"

#D 13pcs



Lock Washer
Ø5/16"x13mm

#E 13pcs



Flat Washer
Ø5/16"x19mm

#F 1pc



Allen Wrench M4

Exploded View

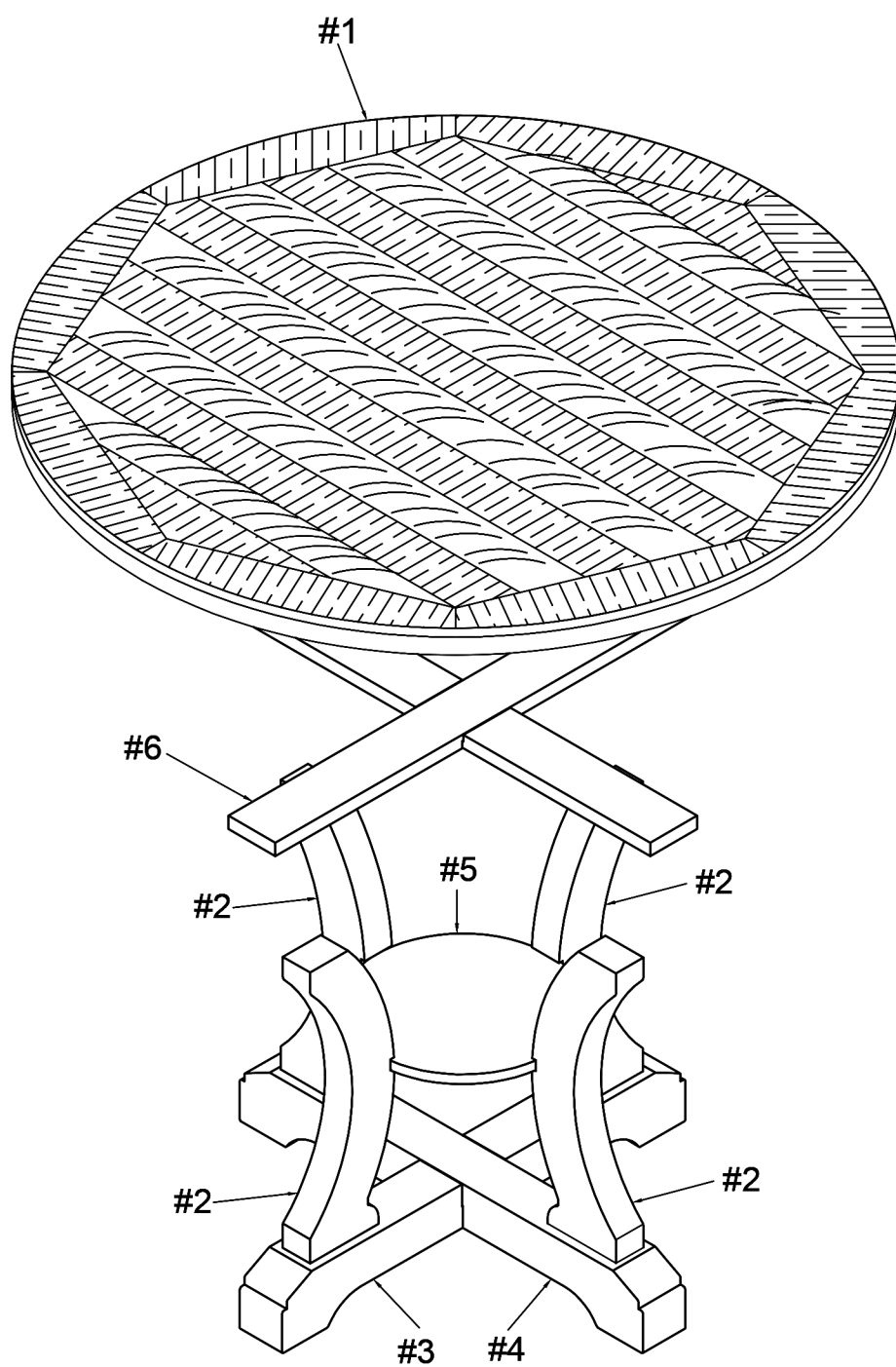

ASSEMBLY INSTRUCTIONS

1

Part #2 x4pcs
Part #5 x1pc
Part #6 x1pc
Hardware #B x4pcs
Hardware #D x4pcs
Hardware #E x4pcs

Align legs (#2) to the mounting plate (#6) and shelf (#5), then secure by using bolts (#B) with washers (#D,E).

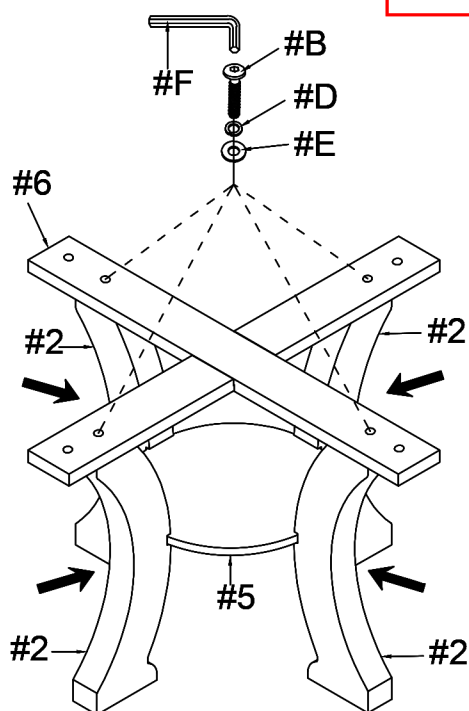

2

Part #3 x1pc
Part #4 x1pc
Hardware #A x4pcs
Hardware #C x1pc
Hardware #D x5pcs
Hardware #E x5pcs

Align base (#3,4) to the legs, then secure by using the following bolts (#A,C) and washers (#D,E) as shown in the diagram.

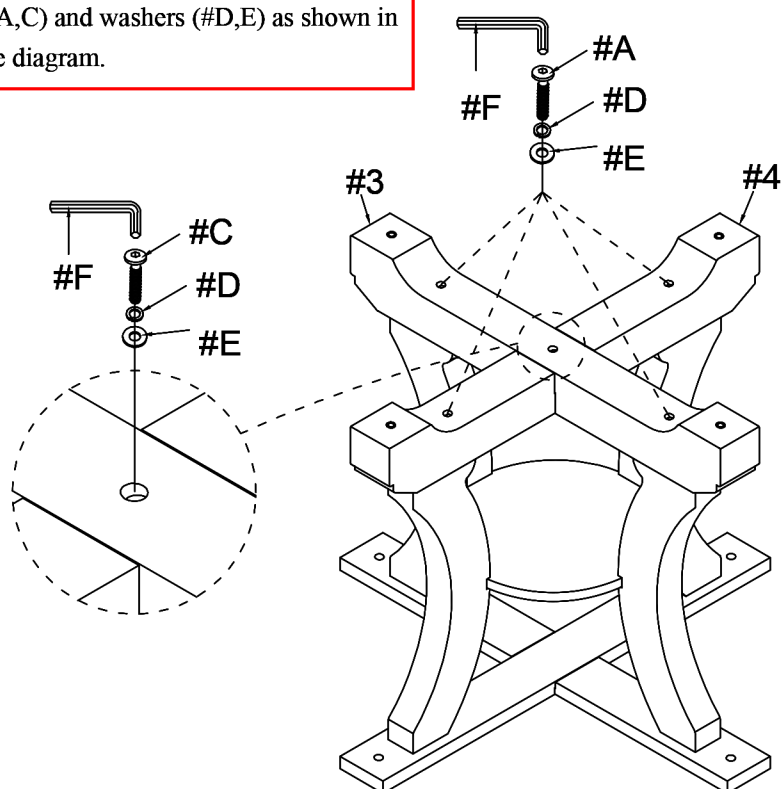

ASSEMBLY INSTRUCTIONS

3

Part #1 x1pc

Hardware #B x4pcs

Hardware #D x4pcs

Hardware #E x4pcs

Align mounting plate to the table top (#1), then secure by using bolts (#B) with washers (#D,E).

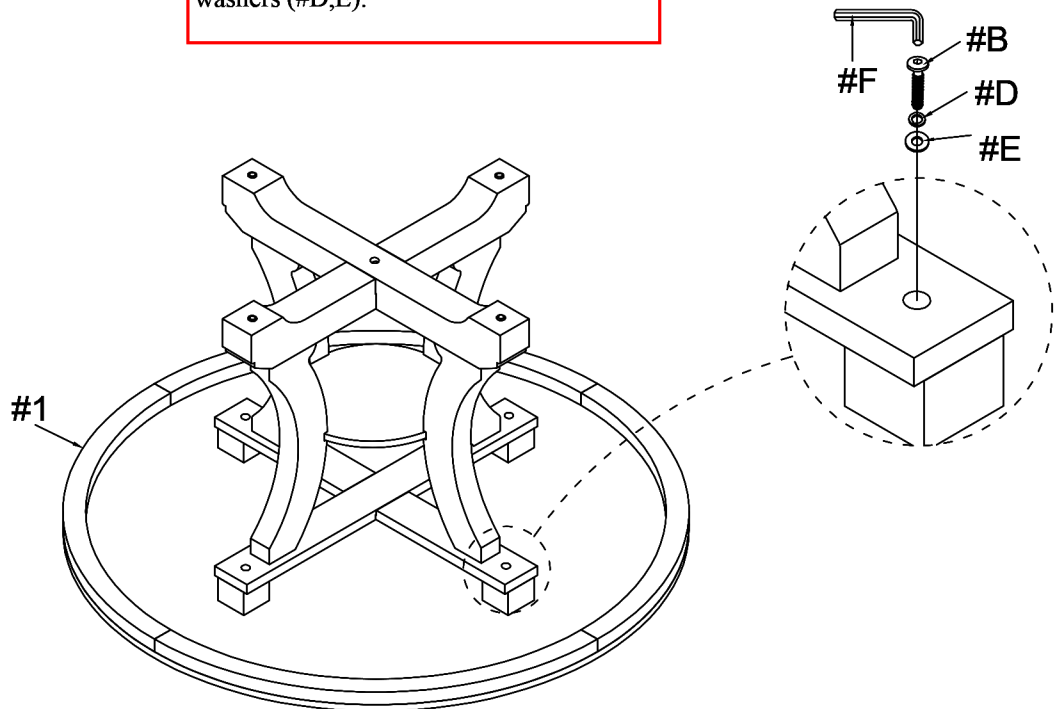

4

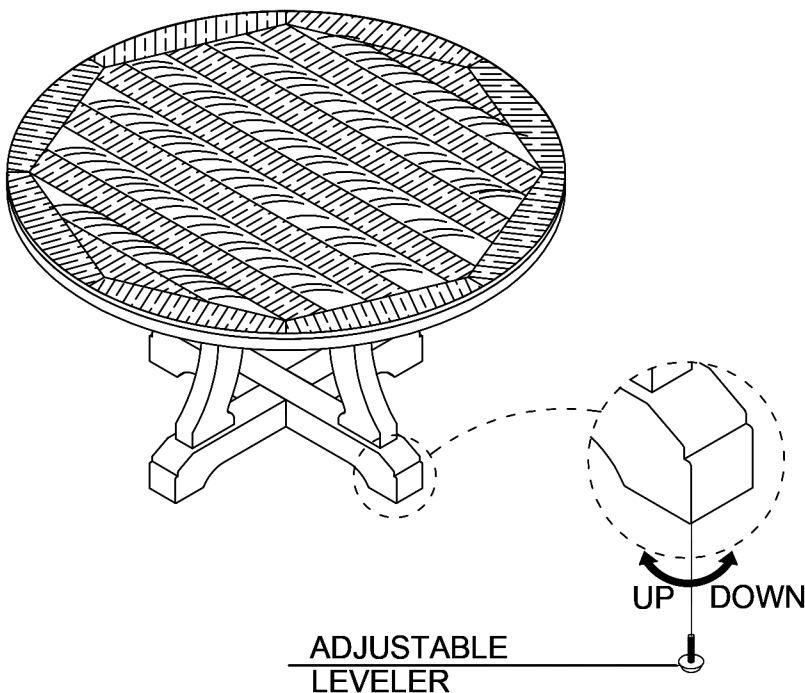

ASSEMBLY COMPLETED



Please ensure the furniture rests on an even and flat surface. If the product wobbles or feels loose, double-check all bolts and/or screws are properly tightened and secured.

✓ Keep this handy!

Please retain this instruction manual and any order-related information for future reference.

✓ Lift, don't drag!

To avoid damage to product please always LIFT the product when transporting or adjusting the placement.