

## ASSEMBLY INSTRUCTIONS



### CAUTION

◆ Inspect the wire insulation for any cuts, abrasions, or exposed copper that may have resulted during shipping. If there is a defect in the wire, do not attempt installation.

◆ Before starting installation of this fixture or removal of a previous fixture, disconnect the power by turning off the circuit breaker or by removing the fuse at the fuse box.

## TOOLS REQUIRED



Ladder



Safety glasses



Electrical tape



Phillips screwdriver



Flat blade screwdriver



Pliers

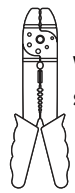

Wire strippers

## HARDWARE INCLUDED

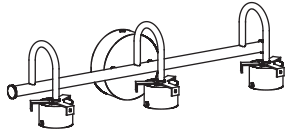

Fixture



Glass

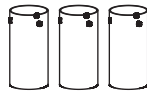

Glass Shade



Decorative Screws



Screws



Screwdriver

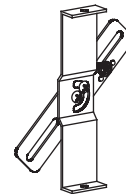

Mounting Unit



Mounting Screws



Wire Nuts

\*PARTS SHOWN MAY DIFFER SLIGHTLY PER LIGHT FIXTURE

## EXPLODED PARTS

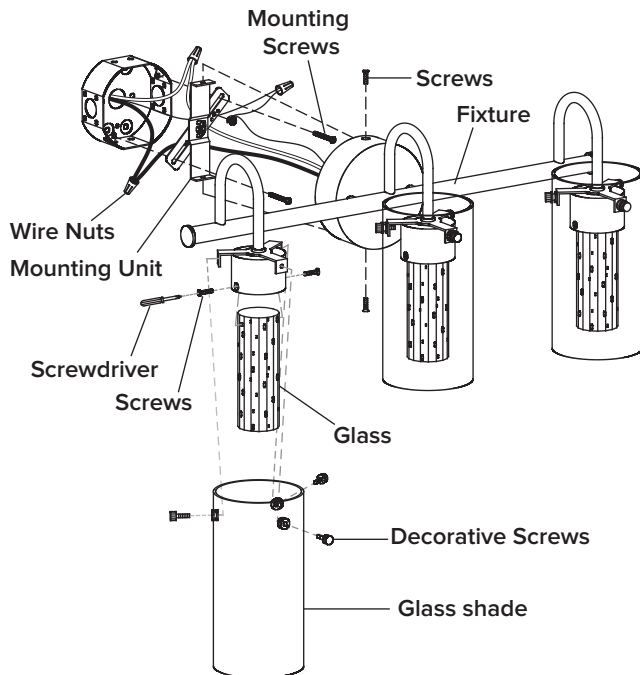

## INSTALLATION

### STEP 1

Use the **mounting screws** to attach the **mounting unit** to the junction box.

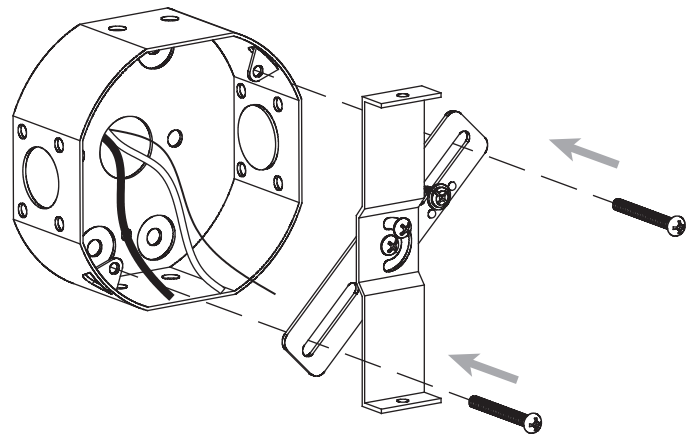

### STEP 2

Make the electrical connection from the junction box to the **fixture**. Connect the ground wire to the **mounting unit** using the preinstalled green ground screw. Then, connect the positive, negative and ground wires with the supplied **wire nuts**. Secure with electrical tape.

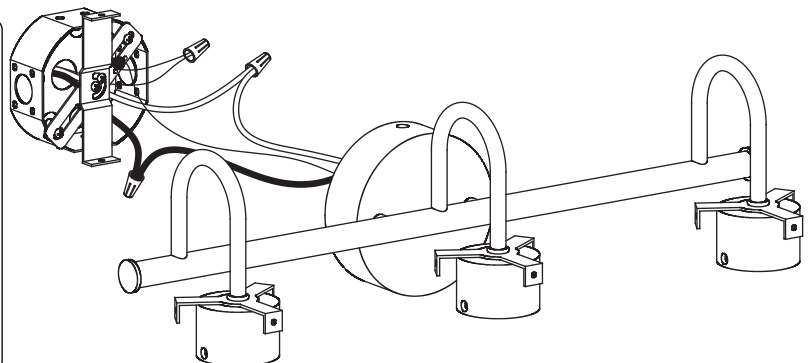
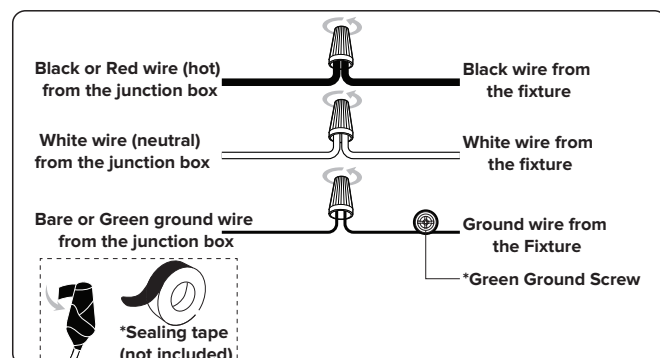

## ASSEMBLY INSTRUCTIONS (INSTALLATION)

---

### STEP 3

Attach the **fixture** to the **mounting unit** through screw holes as shown, and secure it with **screws**. Tighten the **screws** with a **screwdriver**.

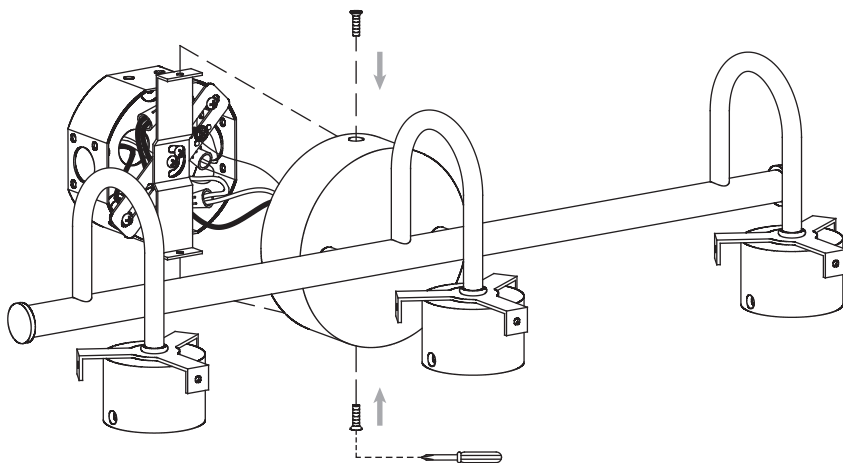

### STEP 4

Attach the **glass** into **fixture** using **screws** as show. Tighten the **screws** with a **screwdriver**.

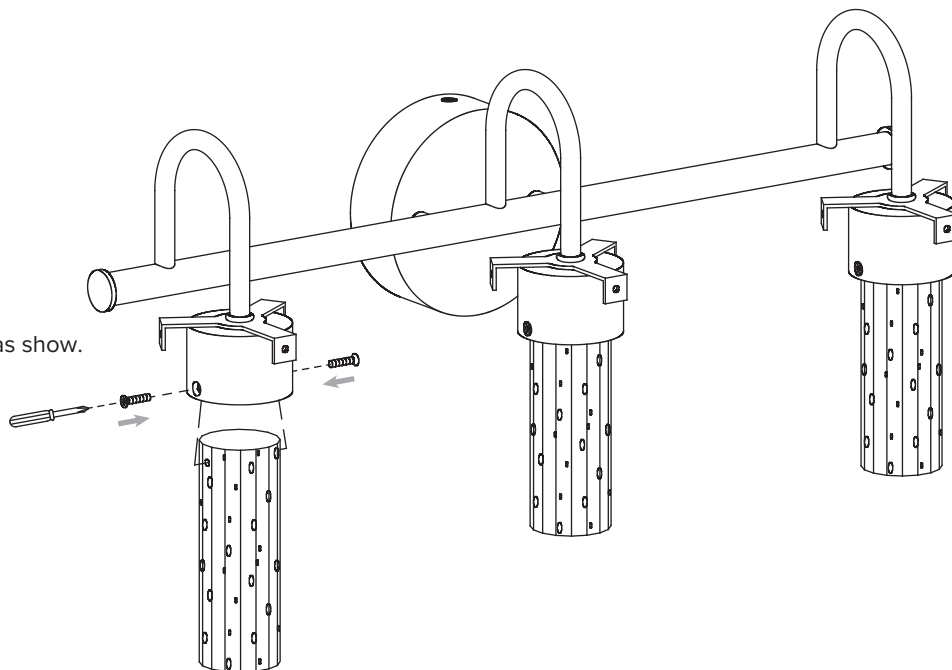

### STEP 5

Attach the **glass shade** onto **fixture** using **decorative screws** as show.

