



Power Brush 28

Operator's Manual Manuel du Utilisateur

ARIENS

Model

921056 – Power Brush 28

(SN 000101 +)

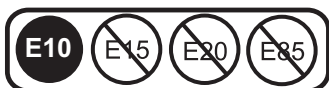
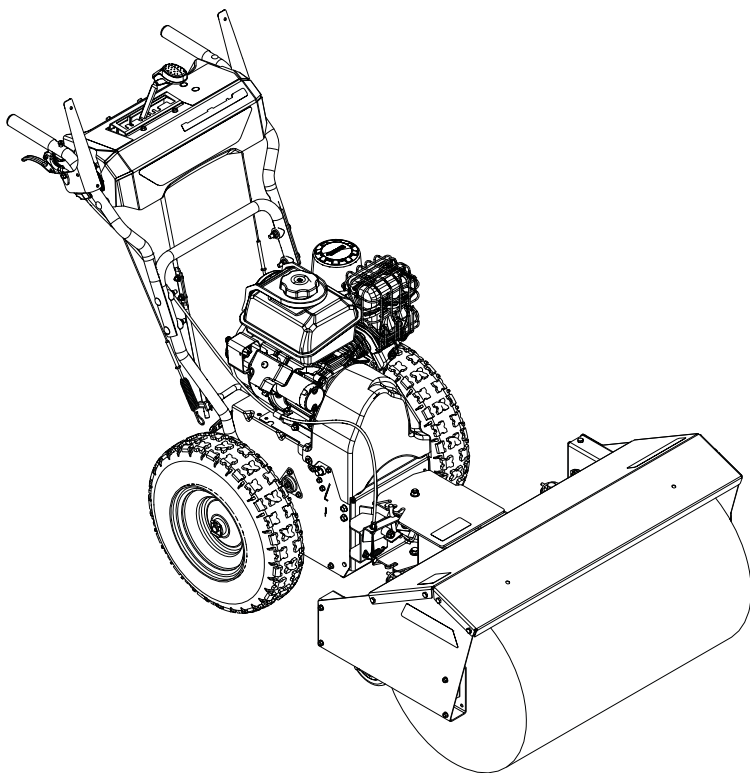

EN ENGLISH

FR FRANÇAIS

05175100 • 11/17

Printed in USA

TABLE OF CONTENTS

WELCOME	1	Set Brush Angle	12
SAFETY	2	Transport Unit	12
Practices & Laws	2	Adjust Engine Air Cleaner	12
Emission Control System	2	MAINTENANCE	13
Required Operator Training	2	Service Position	13
Safety Alert Symbol	2	Return Unit to Operating Position	15
Signal Words	2	Maintenance Schedule	16
Safety Decals	3	Service Parts	16
Safety Rules	4	Check Dual Handle Interlock	16
CONTROLS & FEATURES	8	Check Fasteners	16
Engine Key	9	Check Clutch Cable Adjustments	16
Fuel Valve	9	Check Tire Pressure	16
Electric Start Button	9	Check Engine Oil	16
Choke Control Lever	9	Change Engine Oil	16
Throttle Control Lever	9	Clean Recoil Guard Foam Cover	16
Speed Selector Lever	9	Lubricate Unit	17
Attachment Clutch Lever (Right Side)	9	ADJUSTMENTS	18
Traction Drive Clutch Lever (Left Side)	10	Adjust Speed Selector Lever	18
Brush Lock Trigger	10	Adjust Attachment Clutch & Brake	19
Dual Handle Interlock	10	Adjust Traction Drive Clutch	21
Auto-Turn™ Steering	10	TROUBLESHOOTING	22
OPERATION	10	STORAGE	24
Emergency Stopping	10	Short Term	24
Before Operating Unit	10	Long Term	24
Start The Engine	10	Start-of-Season Fuel Preparation	24
Operate Unit	11	ACCESSORIES	24
Stop the Engine	11	SPECIFICATIONS	25
Set Brush Height	11	WARRANTY	26

WELCOME

Congratulations on your purchase and welcome to the Ariens family! Every power brush in the Ariens lineup is designed for long-lasting and unsurpassed performance. We are confident your machine will be part of your family for many years to come.

Have Questions or Need Assistance?
ariens.custhelp.com • ariensstore.com

A service guide and a parts manual for your unit are available for free download or purchase at www.ariens.com.

PRODUCT REGISTRATION

You or the dealer you purchased the unit from must register the product at the time of purchase. Know the model and serial numbers of your unit and register online at www.ariens.com or return the registration card to Ariens Company. See Figure 1 for label location.

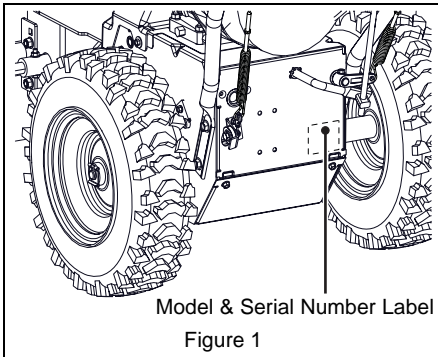

Record model number here.

Record serial number here.

MANUALS

Before operating or servicing the unit, carefully and completely read the manuals provided with the unit. They contain safety instructions and important information about unit controls.

The engine on this unit is covered by a separate manual. Refer to the engine manual for engine service recommendations. Contact the engine manufacturer for a replacement manual if necessary.

It is your responsibility to read and understand all safety precautions and instructions in the manuals. If you do not understand or have difficulty following the instructions, contact your Ariens dealer for assistance. To locate your nearest Ariens dealer, go to www.ariensstore.com.

DISCLAIMER

Ariens reserves the right to discontinue, make changes to, and add improvements upon its products at any time without public notice or obligation. The descriptions and specifications contained in this manual were in effect at printing. Equipment described in this manual may be optional. Some illustrations may not be applicable to your unit.

SAFETY

Read these safety rules and follow them closely. Failure to follow these rules could lead to loss of control of unit, severe personal injury or death to you or bystanders, or result in damage to property or the unit.

PRACTICES & LAWS

Practice usual and customary safe working precautions. Learn applicable rules and laws in your area. ALWAYS follow the practices set forth in this manual.

EMISSION CONTROL SYSTEM

This equipment and/or its engine may include exhaust and evaporative emissions control system components required to meet U.S. Environmental Protection Agency (EPA) and/or California Air Resources Board (CARB) regulations. Tampering with emission controls and components by unauthorized personnel may result in severe fines or penalties. Emission controls and components can only be adjusted by an Ariens Company dealer or an authorized engine manufacturer's service center. Contact your Ariens Company Equipment Retailer concerning emission controls and component questions.

REQUIRED OPERATOR TRAINING



Read and understand the Operator's Manual and decals on the unit. This information is for your safety and the proper use of your equipment. Failure to follow these

instructions and warnings may cause death or serious injury. If you have purchased this product from an Ariens dealer, the dealer can provide you with training.

Familiarize yourself and any other operators with all controls and the safe use of the features of this unit. If you loan, rent or sell this product to others, provide them with all manuals.

If you have any questions, please call our customer support line at 920-756-4688 or contact us at www.ariens.com. Do not use this equipment if, after reading the Operator's Manual and the on-board decals, you have any questions about the safe use of this product.



WARNING: AVOID INJURY. This unit is capable of crushing or amputating body parts. Failure to observe the safety instructions in the manuals and on decals could result in serious injury or death.

SAFETY ALERT SYMBOL



This is the safety alert symbol. It means:

- **ATTENTION!**
- **YOUR SAFETY IS INVOLVED!**

When you see this symbol:

- **BECOME ALERT!**
- **OBEY THE MESSAGE!**

SIGNAL WORDS

The safety alert symbol above and signal words below are used on decals and in this manual. Read and understand all safety messages.

1. Danger



DANGER: Indicates an **IMMINENTLY HAZARDOUS SITUATION!** If not avoided, **WILL RESULT** in death or serious injury.

2. Warning



WARNING: Indicates a **POTENTIALLY HAZARDOUS SITUATION!** If not avoided, **COULD RESULT** in death or serious injury.

3. Caution



CAUTION: Indicates a **POTENTIALLY HAZARDOUS SITUATION!** If not avoided, **MAY RESULT** in minor or moderate injury. It may also be used to alert against unsafe practices.

4. Notice

NOTICE: Indicates information or procedures that are considered important but not hazard related. If not followed, property damage could result.

5. Important

IMPORTANT: Indicates general reference information worthy of special attention.

SAFETY DECALS

The safety decals on your unit are visual reminders of the important safety information in this manual. All messages on your unit must be fully understood and carefully followed. Safety decals on the unit are explained below.

ALWAYS replace missing or damaged safety decals. Replacement decal information is in the parts manual for your unit. Decals can be ordered from your dealer.

See Figure 2 for safety decal locations.

Safety Decal Locations

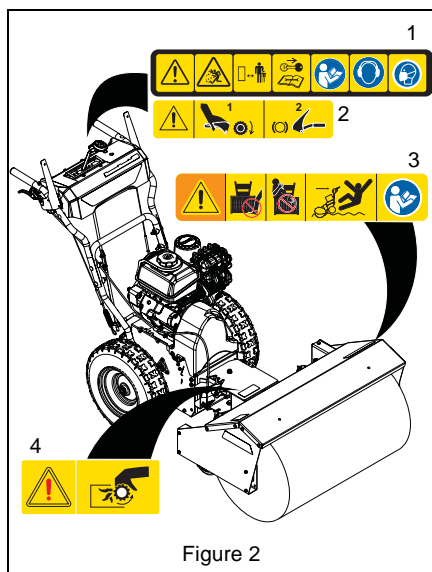

Figure 2

Safety Decal Descriptions

1. WARNING!



WARNING!



NEVER direct discharge towards persons or property that may be injured or damaged by thrown objects.



Keep people away from unit while operating. Keep children out of work area and under watchful care of a responsible adult.



Stop engine, remove key, and read manual before making any repairs or adjustments.



Read operator's manual.



Wear appropriate hearing and eye protection.



Wear a dust particle mask while operating in dusty conditions.

2. CAUTION!



CAUTION!



Be sure to engage the traction drive clutch first. Engaging the attachment clutch before traction drive clutch can cause the unit to travel backwards.

3. DANGER!



DANGER!



Keep clear of brush while engine is running.



NEVER use your hands to clear blockages.



Operating on irregular terrain could cause the brush to dig in and drive the machine rearward.



Read operator's manual.

4. DANGER!



DANGER!



Avoid injury - Stay clear of rotating parts.

SAFETY RULES

The following safety instructions are based on the B71.3 specifications of the American National Standards Institute in effect at the time of production.

Training

Read, understand and follow all instructions on the unit and in the manual(s) before operating this unit. Be thoroughly familiar with the controls and the proper use of the equipment. Know how to stop the unit and disengage the controls quickly.

NEVER allow children to operate or play on or near the equipment. **NEVER** allow adults to operate the equipment without proper instruction.

Keep the area of operation clear of all persons, particularly small children. Be alert and shut off unit if children enter area.

Exercise caution to avoid slipping or falling, especially when operating in reverse.

ALWAYS remove key and/or wire from spark plug before assembly, maintenance or service. Unintentional engine start up can cause death or serious injury.

Complete a walk-around inspection of the unit to understand the unit, your work area and all safety decals.

Understand how to operate all controls, the functions of all controls and how to **STOP** in an emergency.

Preparation

ALWAYS check overhead and side clearances carefully before operation.

ALWAYS be aware of traffic when operating near streets or along curbs.

Thoroughly inspect the area where the equipment is to be used and remove all doormats, sleds, boards, toys, wires and other foreign objects.

Disengage all clutches and shift into neutral before starting the engine.

Use extension cords and receptacles as specified by the manufacturer for all units with electric drive motors or electric starting motors.

<p>Handle fuel with care; it is highly flammable.</p> <ul style="list-style-type: none"> • Use an approved fuel container. • NEVER add fuel to a running engine or hot engine. • Fill fuel tank outdoors with extreme care. NEVER fill fuel tank indoors. • NEVER fill containers inside a vehicle or on a truck or trailer bed with a plastic liner. ALWAYS place containers on the ground, away from your vehicle, before filling. • When practical, remove gas-powered equipment from the truck or trailer and refuel it on the ground. If this is not possible, then refuel such equipment on a trailer with a portable container, rather than from a gasoline dispenser nozzle. • Keep the nozzle in contact with the rim of the fuel tank or container opening at all times, until refueling is complete. DO NOT use a nozzle lock-open device. • Replace gasoline cap securely and wipe up spilled fuel. • If fuel is spilled on clothing, change clothing immediately. <p>NEVER attempt to make any adjustments while the engine is running (except when specifically recommended by manufacturer).</p> <p>ALWAYS allow unit and engine to adjust to outdoor temperature before operating.</p>
--

Operation

Disengage all controls before starting engine.
Adjust brush height before operating. Engage traction drive clutch before attachment clutch. If brush is set too low or if terrain is irregular, brush can drive machine rearward.
NEVER leave a running unit unattended. ALWAYS stop engine and remove key before leaving unit to prevent unauthorized use.
DO NOT put hands or feet near or under rotating parts. Keep clear of the discharge area at all times.
Moving and/or rotating parts can cut off body parts such as fingers or a hand. NEVER place your hands, other body part or clothing near any moving parts while unit is running.
ALWAYS keep hands away from all pinch points.

DO NOT touch parts which might be hot from operation. Allow parts to cool before attempting to maintain, adjust or service.
Thrown objects can cause injury. Check for weak spots on docks, ramps or floors. Avoid uneven work areas and rough terrain and stay alert for hidden hazards.
Exercise extreme caution when operating on or crossing gravel drives, walks or roads. Stay alert for hidden hazards or traffic.
After striking a foreign object, stop the engine, remove the wire from the spark plug, disconnect the cord on electric motors, thoroughly inspect the unit for any damage, and repair the damage before restarting and operating the unit.
If the unit should start to vibrate abnormally, stop the engine and check immediately for the cause. Vibration is generally a warning of trouble.
Stop the engine whenever you leave the operating position and when making any repairs, adjustments or inspections.
When cleaning, repairing or inspecting the unit, stop the engine and make certain that all moving parts have stopped. Disconnect the spark plug wire and keep the wire away from the plug to prevent someone from accidentally starting the engine.
DO NOT run the engine indoors, except when starting the engine and for transporting the unit in or out of the building. Open the outside doors; exhaust fumes are dangerous.
NEVER operate the unit without proper guards, and other safety protective devices in place and working.
ALWAYS stand clear of the discharge area when operating this unit.
NEVER direct the discharge toward people or areas where injury or property damage can occur from thrown objects. Keep children and others away.
DO NOT overload the unit capacity by attempting to operate at too fast a rate.
NEVER operate the unit at high transport speeds on slippery surfaces. Look behind and use care when operating in reverse.
DO NOT operate in reverse unless absolutely necessary. ALWAYS back up slowly and look down and behind before and while backing.
DO NOT carry passengers.

Disengage attachment when not in use and when traveling from one work area to another.	Keep unit free of ice or other debris. Clean up oil or fuel spills.
Disengage power to the attachment when unit is transported or not in use.	ALWAYS keep protective structures, guards, and panels in good repair and secured in place. NEVER modify or remove safety devices.
Use only attachments and accessories approved by the manufacturer of the unit (such as wheel weights, counterweights or cabs).	NEVER store the unit with fuel in the fuel tank inside a building where ignition sources are present such as hot water heaters, space heaters or clothes dryers. Close fuel valve and allow the engine to cool completely before storing in any enclosure or covering the unit.
This product is equipped with an internal combustion engine. DO NOT use unit on or near any unimproved, forest-covered or brush-covered land unless exhaust system is equipped with a spark arrester meeting applicable local, state or federal laws. A spark arrester, if used, must be maintained in effective working order by operator.	ALWAYS refer to operator's manual for important details if the unit is to be stored for an extended period.
NEVER operate the unit without good visibility or light. ALWAYS be sure of your footing, and keep a firm hold on the handles. Walk; NEVER run.	Maintain or replace safety and instruction labels as necessary.
NEVER operate unit after or during the use of medication, drugs or alcohol. Safe operation requires complete and unimpaired attention at all times.	Run the unit a few minutes after removing snow to prevent freeze-up.
NEVER allow anyone to operate this unit when their alertness or coordination is impaired.	
NEVER touch a hot engine or muffler.	Personal Protection
Avoid contact with sharp edges; sharp edges can cut.	DO NOT operate the equipment without wearing adequate clothing. Avoid loose fitting clothing that can get caught in moving parts. Wear footwear that will improve footing on slippery surfaces.
Maintenance and Storage	Wear adequate safety gear, including safety glasses with side shields and protective gloves.
Secure unit so it will not tip over during maintenance.	DO NOT wear loose clothing or jewelry, and tie back hair that may get caught in rotating parts.
Before cleaning, removing obstructions or making any inspections, repairs, etc., disengage clutch(es), stop engine, remove key, allow moving parts to stop and hot parts to cool.	NEVER attempt to clear obstructions or clean unit while engine is running. Rotating attachments can cause serious injury.
Check hardware at frequent intervals for proper tightness to be sure the unit is in safe working condition.	Protect eyes, face and head from objects that may be thrown from unit. Wear appropriate hearing protection.
Check clutch and brake operation frequently.	ALWAYS wear safety glasses or eye shields during operation or while performing an adjustment or repair to protect eyes from foreign objects that may be thrown from the unit.
DO NOT change engine governor settings and DO NOT over-speed engine.	Slope Operation
Adjust and service as required. Motion of drive wheels and attachment must stop quickly when clutch levers are released.	Exercise extreme caution when operating on slopes. DO NOT operate on steep slopes; go up and down. Keep all movement on slopes slow and gradual.
ALWAYS maintain unit in safe operating condition. Damaged or worn out muffler can cause fire or explosion.	

Use a slow speed to avoid stops or shifts on slopes. Avoid starting or stopping on a slope. DO NOT park unit on a slope unless absolutely necessary. When parking on a slope ALWAYS block the wheels.
DO NOT operate near drop-offs, ditches, or embankments. Unit can suddenly turn over if a wheel is over the edge of a cliff or ditch, or if an edge caves in.

Fuel

Remove fuel before separating brush attachment from frame. Ensure unit is secure and will not tip during maintenance.
DO NOT run engine in an enclosed area. ALWAYS provide good ventilation. Fumes from engine exhaust can cause injury or death.
Fuel is highly flammable and its vapors are explosive. Handle with care. Use only an approved gasoline container with an appropriately-sized dispensing spout.
No smoking, no sparks, no flames. ALWAYS allow engine to cool before servicing.
NEVER fill fuel tank when engine is running or hot from operation.
NEVER fill or drain fuel tank indoors.
Replace fuel cap securely and clean up spilled fuel.
NEVER fill fuel containers inside a vehicle or on a truck or trailer bed with a plastic liner. ALWAYS place containers on the ground away from your vehicle before filling.
When practical, remove gas-powered equipment from the truck or trailer and refuel it on the ground. If this is not possible, then refuel on a trailer with a portable container, rather than from a gasoline dispenser nozzle.
Keep the nozzle in contact with the rim of the fuel tank or container opening at all times until fueling is complete. DO NOT use a nozzle lock-open device.
If fuel is spilled on clothing, change clothing immediately.
Properly remove fuel before tipping unit to avoid spills.

Towing/Transporting

ALWAYS stop engine, remove key and close fuel valve or drain fuel when transporting unit on a truck or trailer.
Use extra care when loading or unloading unit onto trailer or truck. Secure unit chassis to transport vehicle. NEVER secure from rods or linkages that could be damaged. DO NOT transport unit while engine is running.

Accessories

Use only Ariens Company-recommended attachments or accessories that are designed for your unit and that are appropriate to your use and can be used safely in your application.

CONTROLS & FEATURES

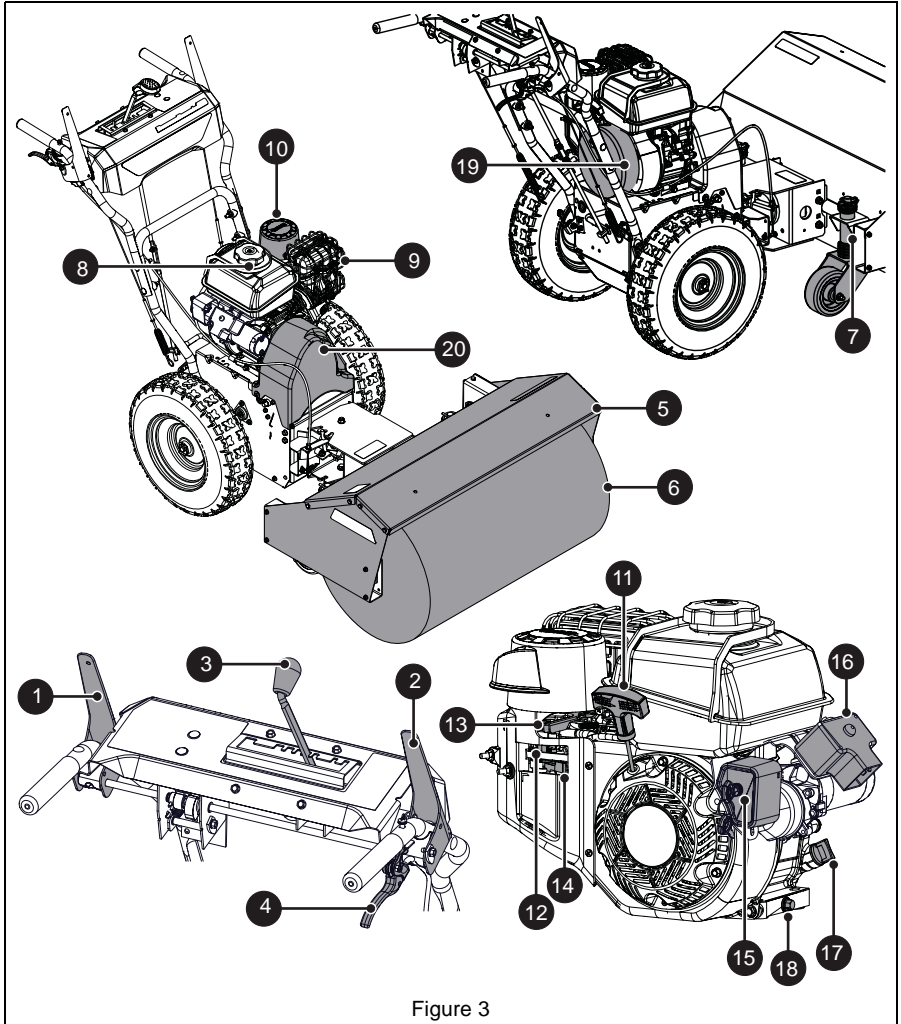

Figure 3

- | | |
|--------------------------------------|-----------------------------|
| 1. Traction Drive Clutch Lever | 11. Recoil Starter Handle |
| 2. Attachment Clutch Lever | 12. Choke Control Lever |
| 3. Speed Selector Lever | 13. Throttle Control Lever |
| 4. Brush Lock Trigger | 14. Fuel Valve |
| 5. Brush Guard | 15. Engine Key |
| 6. Brush | 16. Electric Start Button |
| 7. Caster Wheels & Height Adjustment | 17. Oil Fill / Dipstick |
| 8. Fuel Tank and Cap | 18. Oil Drain |
| 9. Muffler | 19. Recoil Guard Foam Cover |
| 10. Air Cleaner Assembly | 20. Belt Cover |



WARNING: Read and understand the *Safety* section before proceeding.

See Figure 3 for all controls and features locations.

ENGINE KEY

See Figure 4.

Controls power to the engine. The key cannot be removed when in run position.

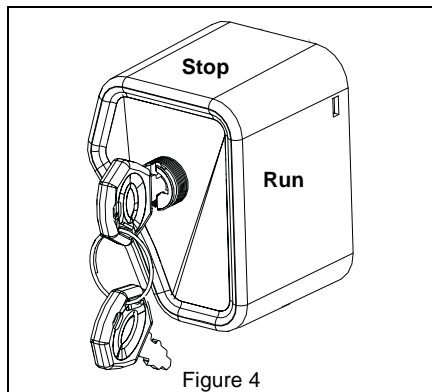

Figure 4

FUEL VALVE

See Figure 5.

Controls fuel flow to the engine.

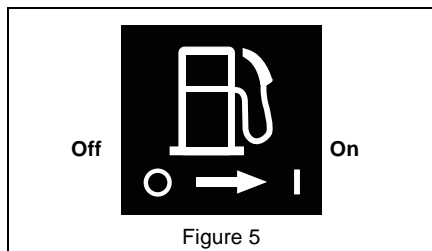

Figure 5

ELECTRIC START BUTTON

Starts a correctly choked engine.

CHOKE CONTROL LEVER

See Figure 6.

Controls airflow to the engine.

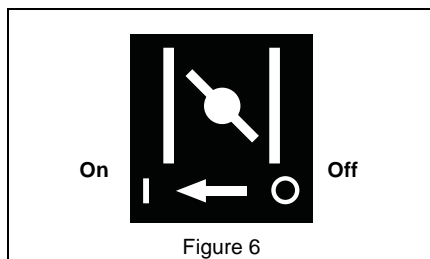

Figure 6

THROTTLE CONTROL LEVER

See Figure 7.

Controls engine speed.

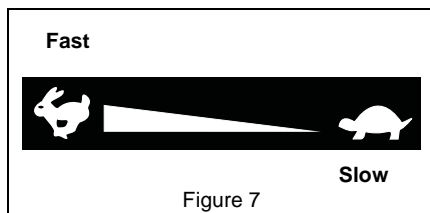

Figure 7

SPEED SELECTOR LEVER

See Figure 8.

Controls the speed of forward and reverse travel.

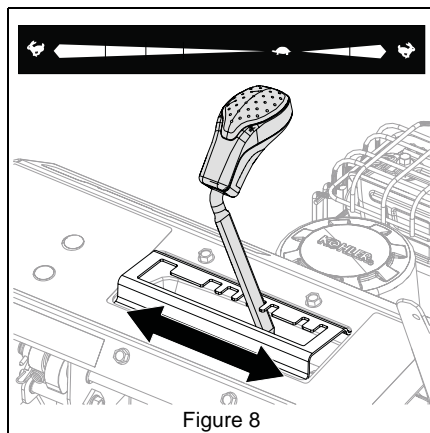

Figure 8

ATTACHMENT CLUTCH LEVER (RIGHT SIDE)

See Figure 9.

Controls brush rotation.

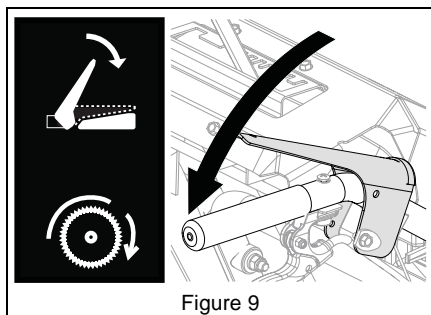

Figure 9

TRACTION DRIVE CLUTCH LEVER (LEFT SIDE)

See Figure 10.

Allows unit to travel forward and in reverse.

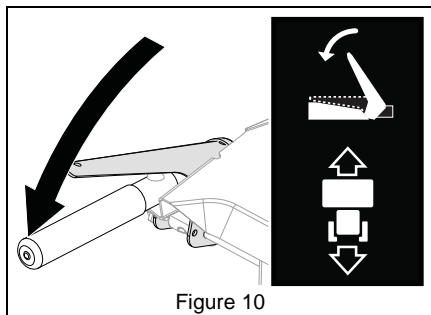

Figure 10

BRUSH LOCK TRIGGER

See Figure 11.

Unlocks and locks brush to change cleaning angle.

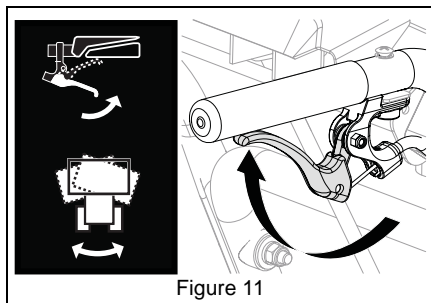

Figure 11

DUAL HANDLE INTERLOCK

Allows brush to rotate without holding attachment clutch lever continuously. Brush continues to turn until both clutch levers are released.

AUTO-TURN™ STEERING

Automatically locks or unlocks wheels to allow unit to turn more precisely.

OPERATION



WARNING: AVOID INJURY.
Read and understand the *Safety* section before proceeding.

IMPORTANT: All references to left, right, front or rear are given from the perspective of operator in operator's position, facing the direction of forward travel.

EMERGENCY STOPPING

1. Release both clutch levers.
2. Turn engine key to stop position and remove key from unit.
3. Wait for all moving parts to stop before leaving operator's position.

BEFORE OPERATING UNIT

1. *During Winter Operation:* Check for frozen components.
 - a. Remove key.
 - b. Engage attachment clutch lever and pull recoil starter handle.
 - c. If handle does not pull, move unit to a warm area to thaw.
2. Check fuel level and add fuel if needed.

IMPORTANT: Use fresh unleaded fuel with an octane rating of at least 87. **DO NOT** use E85 blended fuels; the engine is not E20 / E30 / E85 compatible. The maximum recommended ethanol content is 10%. Ariens recommends using a quality fuel stabilizer in all fuel. See *Short Term* on page 25.

3. Check engine oil level and add oil if needed. Refer to engine manual.
4. Check function of controls.
 - Attachment Clutch Lever
 - Traction Drive Clutch Lever
 - Dual Handle Interlock
5. Know how to stop in an emergency. See *Emergency Stopping* on page 10.

START THE ENGINE

1. *Electric Start Models:* Connect power cord to starter and then into 120V 3-wire grounded outlet.

IMPORTANT: Use a power cord that is UL listed or CSA certified, rated for a minimum of 13 amps, grounded and labeled as suitable for outdoor use.

All Models

2. Turn fuel valve to on position.
3. Insert engine key and turn to run position.
4. Move choke control lever to on position.
5. Move throttle control lever one-third of the way toward full-throttle.
6. *Electric Start:* Press electric start button.
NOTICE: DO NOT run starter more than 10 times at intervals of 5 seconds on / 5 seconds off or overheating and damage may occur.
7. *Recoil Start:* Pull recoil starter handle.
 - a. Grasp handle and pull rope out slowly until it pulls harder.
 - b. Pull handle firmly and quickly with a rapid, continuous full-arm stroke. Repeat until engine starts. If engine does not start, see *Troubleshooting* on page 23.
 - c. Let handle rewind slowly after engine starts. DO NOT let handle snap against engine.
8. Gradually turn choke off as engine warms.
9. *Electric Start:* Disconnect power cord from outlet and then from starter.
10. Move throttle control lever to fast.

OPERATE UNIT

1. Select desired speed.
2. Engage traction drive clutch.
3. Engage attachment clutch.

NOTICE: Stop brush when traveling between work areas.

NOTICE: Release both clutch levers before changing speed. When the unit is turned left or right, the Auto-Turn™ differential automatically unlocks wheels for easier turning. On a straight path, the differential locks both wheels in place for best traction.

STOP THE ENGINE

1. Release attachment drive clutch lever.
2. Release traction clutch lever.
3. Move throttle control lever to the idle position.
4. Stop engine and remove key from unit.
5. Turn fuel valve to off position.

SET BRUSH HEIGHT



CAUTION: AVOID INJURY. If brush height is too low, brush can drive machine rearward when attachment clutch is engaged.

Check Brush Clearing Width

See Figure 12.

1. Move brush to a dusty, flat surface.
2. Start brush at slow speed and run in a stationary position for 30 seconds.
3. Lift brush head and move unit backward.
4. Stop engine. See *Stop the Engine* on page 11.
5. Check width of swept area. Brush pattern should be 5 cm – 7.6 cm (2" – 3") wide along brush length.
 - If clearing width is too wide, raise brush.
 - If clearing width is too narrow, lower brush.

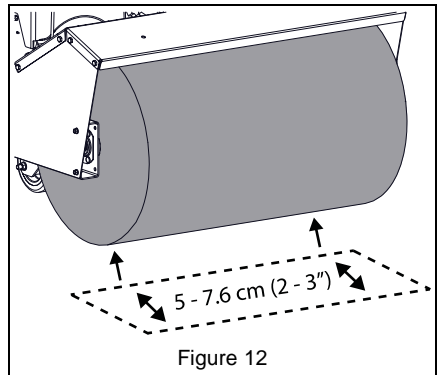

Figure 12

Adjust Brush Height

See Figure 13.

Adjust height so brush rests 3 mm – 6 mm (1/8" – 1/4") above delicate surfaces. For hard surfaces, adjust height so brush lightly touches surface.

IMPORTANT: Spacers on each caster wheel must be adjusted equally.

1. Lower brush:
 - a. Remove lynch pins from caster shaft tops.
 - b. Turn desired amount of height adjuster clips to be removed so they align with flat side of caster shafts and remove clips.
 - c. Install spacers onto caster shaft tops and reinstall lynch pins.

2. Raise brush:
 - a. Remove lynch pins from caster shaft tops.
 - b. Remove desired amount of height adjuster clips from caster shaft tops and install onto lower caster shaft ends.
 - c. Turn height adjuster clips so they DO NOT align with flat side of caster shafts.
 - d. Reinstall lynch pins.

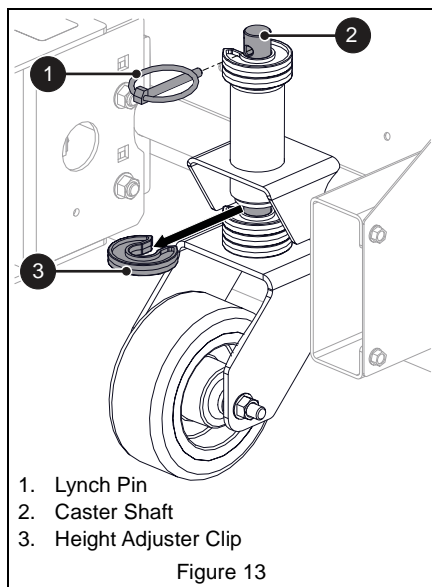

SET BRUSH ANGLE

See Figure 14.

1. Squeeze brush lock trigger to unlock brush position.
2. Move handlebars left or right until brush is in desired position.
3. Release trigger to lock brush position.

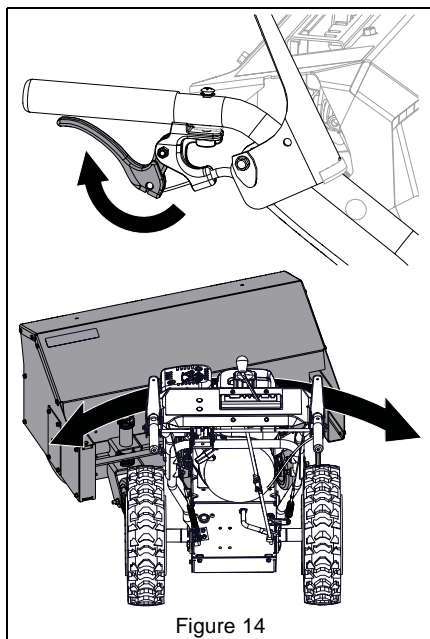

TRANSPORT UNIT

1. Stop engine and close fuel valve.
2. Secure unit chassis to transport vehicle.

NOTICE: NEVER secure from rods or linkages that could be damaged.

For Best Sweeping Results

- Run in an overlapping series of paths.
- Start in the middle of large areas and sweep debris to each side.
- ALWAYS direct discharge with wind direction.
- Snow is most easily removed as soon as snow falls.

For Best De-Thatching Results

IMPORTANT: Front caster kit is required for de-thatching. See *Accessories* on page 25.

- De-thatch in spring to clear winter undergrowth.
- Adjust brush height so it just touches the grass.
- Set brush angle full left or right so thatch gets cleared only once.
- De-thatch dry grass.
- Use a slow speed to clear thatch to avoid damage to lawn.

ADJUST ENGINE AIR CLEANER

1. Pull down latches and move tabs away from base to release air cleaner cover. See Figure 15.

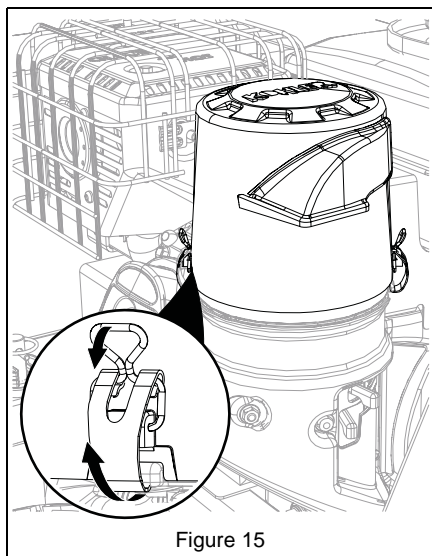
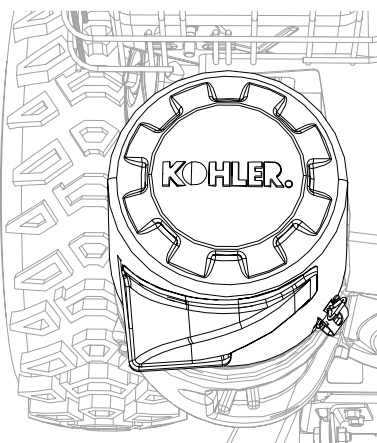

Figure 15

2. Rotate cover to the winter/cold-weather position or summer position. See Figure 16.

NOTICE: DO NOT run engine with air filter cover in the winter/cold-weather position while operating in normal temperatures.

Normal Position



Winter/Cold Weather Position

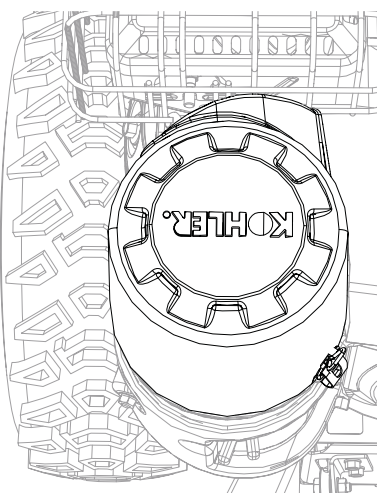

Figure 16

3. Position latches under base and lift up on latches until they lock to secure cover.

MAINTENANCE



WARNING: Read and understand the *Safety* section before proceeding.

Your Ariens dealer can provide service and adjustments to keep your unit operating at peak efficiency. Contact an authorized engine manufacturer's service center for engine service.

SERVICE POSITION



WARNING: AVOID INJURY. Before rotating unit, close fuel valve and drain fuel from tank and fuel system. (Refer to engine manual for instructions.) Make sure unit is secure and will not tip.

IMPORTANT: DO NOT tip unit onto brush. Remove brush attachment if maintenance requires tipping unit forward. Ensure unit is secure and will not tip.

Place Unit in Service Position

1. Move unit to a flat, level surface.
2. Stop engine and wait for moving parts to stop and for hot parts to cool.
3. Loosen, but DO NOT remove hardware securing belt cover and remove belt cover.

See Figure 17.

4. Remove hardware securing belt finger and remove belt finger.
5. Remove attachment drive belt from attachment sheave.

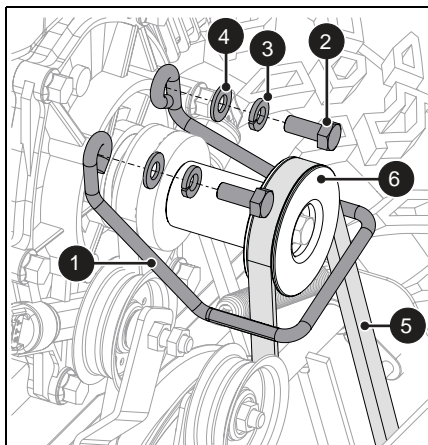

1. Belt Finger
2. Hex Bolt
3. Locking Washer
4. Flat Steel Washer
5. Attachment Drive Belt
6. Attachment Sheave

Figure 17

6. Disconnect brush lock cable from J-clamp on engine mount. See Figure 18.

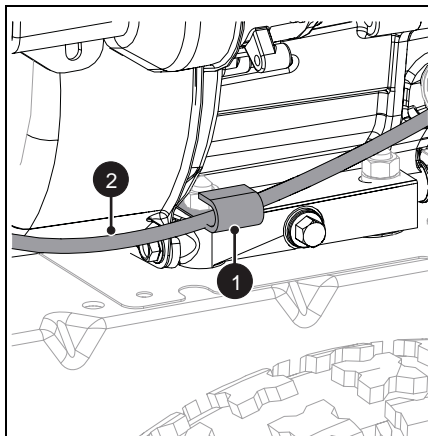

1. J-Clamp
2. Brush Lock Cable

Figure 18

7. Remove hardware securing brush lock trigger to handlebar and allow trigger to rest on brush attachment. See Figure 19.

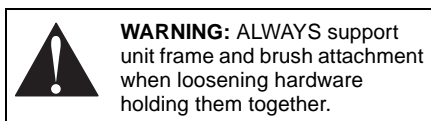
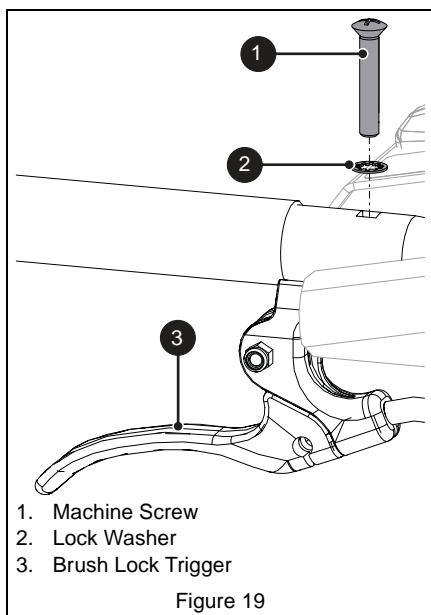

IMPORTANT: Support tractor / frame so it will not tip when disconnected from brush attachment in next step.

See Figure 20.

8. Remove hardware securing brush attachment to tractor / frame.
9. Rotate brush attachment apart from tractor / frame on mount rod and remove from frame.

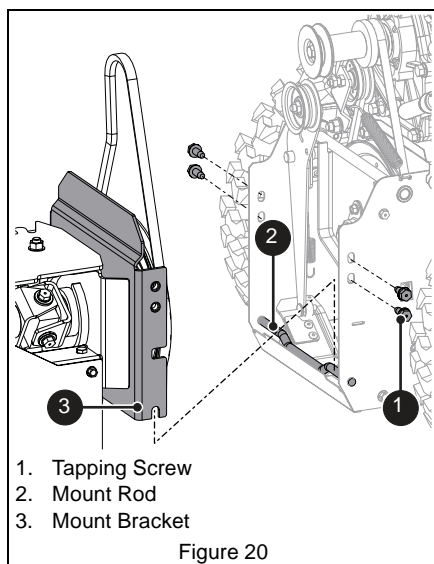

See Figure 21.

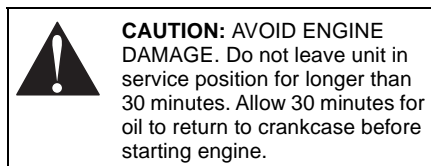

10. Slowly rotate tractor / frame forward so it rests on attachment sheave. Protect attachment sheave so it does not incur damage.
11. Remove hardware securing bottom cover and remove bottom cover.

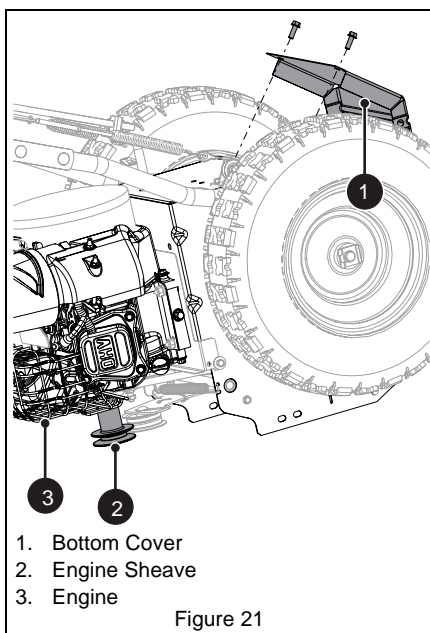

Figure 21

RETURN UNIT TO OPERATING POSITION

1. Reinstall bottom cover and secure with six tapping screws.
2. Return tractor / frame to operating position and onto a support.
3. Lift brush attachment rear and lower into frame so mount brackets rest on mount rod.
4. Secure brush attachment to frame with four tapping screws, but **DO NOT** tighten hardware.
5. Reinstall attachment belt onto attachment sheave.
6. Reinstall belt finger and secure with two flat steel washers, two locking washers and two hex bolts. Tighten hardware.
7. Torque hardware installed in step 4 to 22.8 N•m – 34.1 N•m (16.8 lb-ft – 25.2 lb-ft).
8. Check belt finger clearance:
 - Engage attachment clutch lever and make sure belt finger located opposite belt idler is less than 3.2 mm (1/8") from belt, but not touching the belt. See Figure 22.
 - If needed, adjust clearance by loosening hex bolts, repositioning belt finger, and tightening bolts.

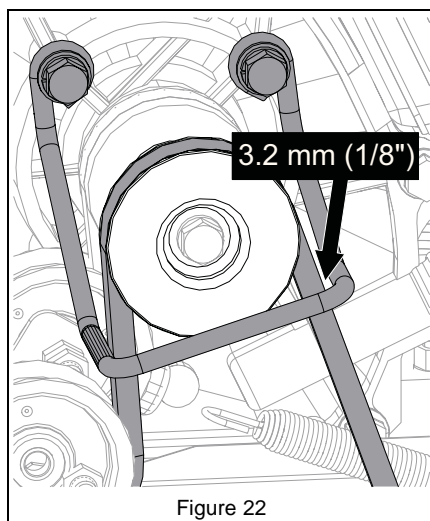

Figure 22

9. Reinstall belt cover and tighten hardware.
10. Reinstall brush lock trigger onto handlebars and route brush lock cable through J-clamp on engine mount.
11. Adjust attachment clutch / brake. See *Adjust Attachment Clutch & Brake* on page 19.



CAUTION: AVOID ENGINE DAMAGE. Allow unit to rest in operating position for 30 minutes before starting engine.

12. Reconnect spark plug wire and fill fuel tank.

IMPORTANT: Check all adjustments after first use.

MAINTENANCE SCHEDULE

Service Performed	Each Use	Every 5 hrs.	Every 25 hrs.	Annually
Check Clutch Lever Operation	•			
Check Dual Handle Interlock	•			
Check Fasteners	•			
Clean Recoil Guard Foam Cover	•			
Check Engine Oil	•			
Check Clutch Cable Adjustments *		•		•
Check Tire Pressure			•	•
Change Engine Oil **				
General Lubrication			•	•
* After first use.				
** Refer to engine manual for instructions.				

SERVICE PARTS

See your Ariens dealer to purchase service parts for your unit.

Description	Part No.
Ariens Hi-Temp Grease	
• 3 oz. cartridges (3)	00036800
• 14 oz. cartridge (1)	00036700
Fuel Stabilizer (4 oz.)	
• Except Canada	04730400
• For Canada Only	04742500
Ariens 5W-30 Engine Oil	
• 16 oz.	00091000
• 32 oz.	00067600

CHECK DUAL HANDLE INTERLOCK

1. Stop engine.
2. Engage traction drive clutch and then the attachment drive clutch.
3. Release the attachment clutch lever. The attachment clutch should stay engaged until the traction drive clutch lever is released.

IMPORTANT: If dual handle interlock does not operate correctly, repair as directed in the service guide for your unit.

CHECK FASTENERS

Check for loose or missing hardware.

CHECK CLUTCH CABLE ADJUSTMENTS

Brush must stop within 5 seconds when attachment clutch lever is released.

Wheels must stop quickly when traction drive clutch lever is released.

If clutches do not engage or disengage correctly, see *Adjust Attachment Clutch & Brake* on page 19 or See *Adjust Traction Drive Clutch* on page 21.

CHECK TIRE PRESSURE

Keep tires inflated to pressure listed on tire sidewall.



WARNING: AVOID INJURY.

Explosive separation of tire and rim parts is possible.

- DO NOT inflate tires above the recommended pressure.
- DO NOT inflate tires with a compressor; use a hand pump.
- DO NOT stand in front of tire assembly when inflating. Use a clip-on chuck and extension hose long enough to allow you to stand to one side.
- DO NOT mount a tire without proper equipment and experience.

CHECK ENGINE OIL

NOTICE: Engine oil level must be maintained at correct level or engine damage may occur. Refer to engine manual.

CHANGE ENGINE OIL

Refer to engine manual.

CLEAN RECOIL GUARD FOAM COVER

The recoil guard foam cover must be kept clean and free of snow and debris.

If cover becomes clogged, remove and gently vacuum or wash with warm water.

IMPORTANT: Cover **MUST** be installed when using unit in winter conditions. The cover prevents snow from entering the recoil guard and freezing the recoil pawls. Cover is not necessary for operation during non-winter months.

IMPORTANT: If cover is clogged with snow, remove it and allow foam to thaw or rinse with warm water. Allow cover to dry before reinstalling.

IMPORTANT: More frequent service may be required in extreme conditions (heavy loads, high ambient temperatures, dusty conditions or airborne debris).

LUBRICATE UNIT

Ariens recommends using Ariens Hi-Temp Grease or equivalent (see *Service Parts* on page 17) to lubricate fittings. Lubricate each season or every 25 hours of operation.

IMPORTANT: Wipe each fitting clean before and after lubrication.

Use the following key for all lubrication procedures.

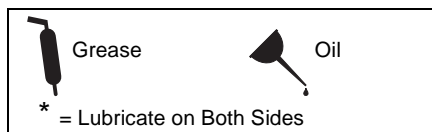

Drive Chains

1. Remove hardware retaining left brush cover and remove cover. See Figure 23.
2. Lubricate entire chain lengths.

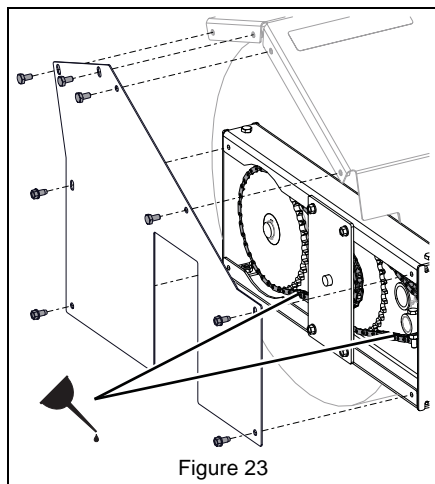

3. Reinstall brush cover and secure with four tapping screws and four hex bolts.

Castors

See Figure 24.

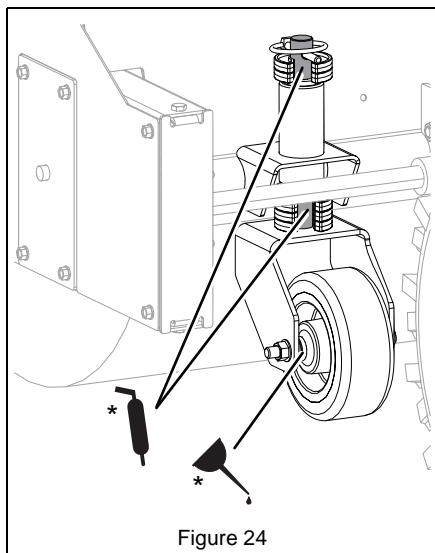

Traction Drive

1. Place unit in service position. See *Service Position* on page 14.
2. Lubricate as shown in Figure 25 and Figure 26.

IMPORTANT: DO NOT allow grease or oil to contact friction disc, swing gate or belts.

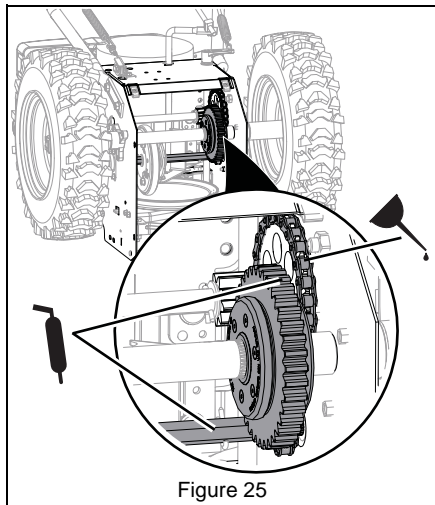

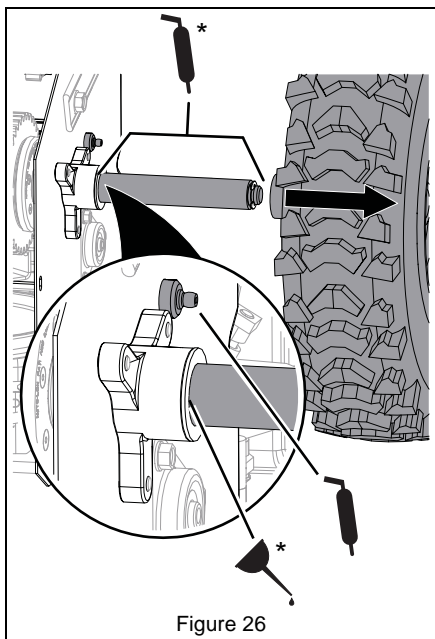

Figure 26

3. Return unit to operating position. See *Return Unit to Operating Position* on page 16.

ADJUSTMENTS



WARNING: AVOID INJURY.
Read and understand the entire *Safety* section before proceeding.

ADJUST SPEED SELECTOR LEVER

See Figure 27.

1. Stop engine and wait for moving parts to stop and for hot parts to cool.
2. Disconnect adjustment pivot pin from speed selector arm. Save hardware for reinstallation.
3. Position speed selector lever in fastest forward position.
4. Turn speed selector arm down as far as it will go.
5. Thread adjustment pivot pin along shift rod until it aligns with the mating hole on the speed selector arm, and then insert the pivot pin in the hole.

6. Connect pivot pin to speed selector arm with hardware removed in step 2 and check forward and reverse speeds.
 - a. Start unit, position speed selector lever in the first forward position and engage traction drive clutch. Unit should move forward.
 - b. Stop unit, position speed selector lever in the first reverse position and engage traction drive clutch. Unit should move in reverse.
 - c. Stop unit. If unit does not travel correctly, repeat adjustments.

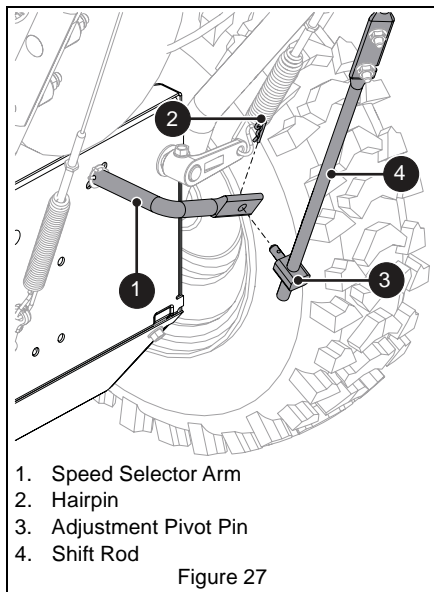

Figure 27

ADJUST ATTACHMENT CLUTCH & BRAKE



WARNING: AVOID INJURY.
Improper adjustment could result in unexpected movement of brush causing death or serious injury. **BRUSH MUST STOP** within 5 seconds when attachment clutch lever is released.

Remove Slack from Attachment Cable

1. Stop engine and wait for moving parts to stop and for hot parts to cool.
2. Disconnect spark plug wire.
3. Loosen hardware securing belt cover to unit and remove belt cover.

IMPORTANT: DO NOT completely remove hardware from unit.

4. Loosen jam nut on cable adjustment barrel, and then turn the adjustment barrel down to shorten cable and remove cable slack. See Figure 28.

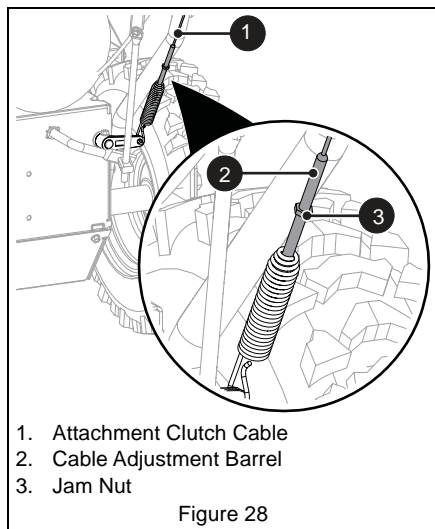

5. With the attachment clutch disengaged, check that the attachment idler arm lightly touches the frame. See Figure 29.

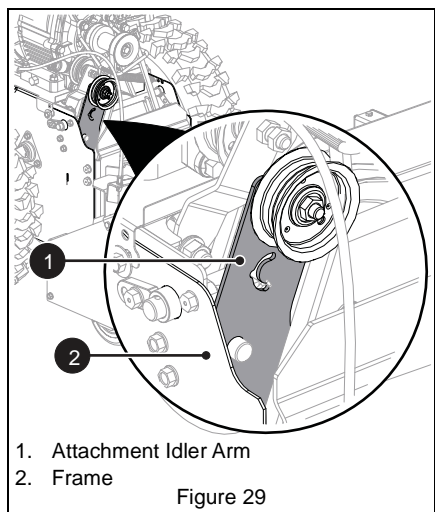

6. Tighten jam nut on cable adjustment barrel. See Figure 28.
7. Reinstall belt cover and tighten hardware.
8. Reconnect spark plug wire.

Check Attachment Idler Arm Roller Clearance

See Figure 30.

1. Place unit in service position and remove bottom cover. See *Service Position* on page 14.
2. Engage attachment clutch and check the clearance between the frame and plastic roller on attachment idler arm. Roller should be 12.7 mm – 22.2 mm (1/2" – 7/8") from frame.

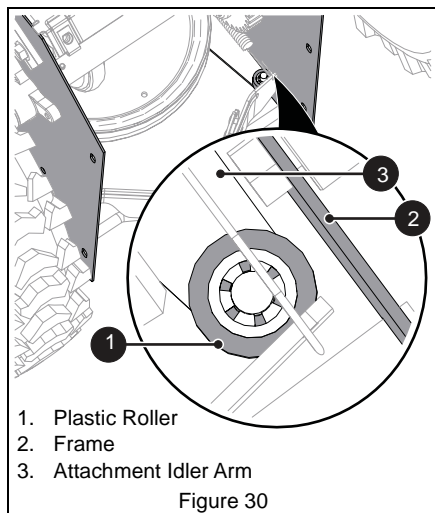

- If roller is 12.7 mm – 22 mm (1/2" – 7/8") from frame, no further adjustment is required.
 - If roller is less than 12.7 mm (1/2") from frame, loosen idler adjustment nut and move idler closer to belt. Tighten adjustment nut and recheck roller clearance.
 - If roller is more than 22.2 mm (7/8") from frame, loosen idler adjustment nut and move idler away from belt. Tighten adjustment nut and recheck roller clearance.
3. Return unit to operating position. See *Return Unit to Operating Position* on page 16.

Check Attachment Brake

See Figure 31.

1. Place unit in service position and remove bottom cover. See *Service Position* on page 14.

With the attachment clutch disengaged, brake pad must contact attachment belt or pulley, whichever is closest. With attachment clutch engaged, brake pad must be a minimum of 1.6 mm (1/16") from belt or pulley.

- If there is less than 1.6 mm (1/16") gap, loosen idler adjustment nut and move idler away from belt or pulley. Position idler to achieve a 1.6 mm (1/16") minimum brake pad gap and a 12.7 mm – 22.2 mm (1/2" – 7/8") gap between the plastic roller and the frame.

IMPORTANT: If adjustments cannot be brought into specified ranges, see your dealer for repair.

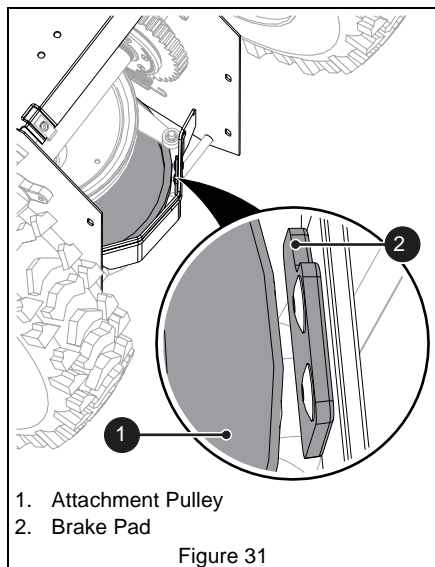

2. Return unit to operating position. See *Return Unit to Operating Position* on page 16.

Check Belt Finger Clearance

See Figure 32.

With the attachment clutch engaged, the belt finger located opposite the belt idler must be less than 3.2 mm (1/8") from belts, but must not touch the belts.

To adjust belt finger:

1. Remove belt cover.
2. Loosen bolts and move belt finger to correct position.
3. Tighten bolts and recheck belt finger clearance.
4. Reinstall belt cover and tighten hardware.

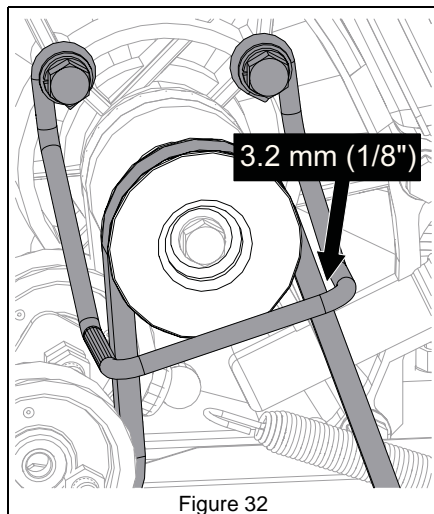

ADJUST TRACTION DRIVE CLUTCH

See Figure 33.

If unit does not drive correctly, adjust traction clutch to compensate for friction disc wear.

1. Stop engine and wait for moving parts to stop and for hot parts to cool.
2. Disconnect spark plug wire.
3. Loosen jam nut on traction cable adjustment barrel, and then turn adjustment barrel down to shorten cable and remove cable slack.

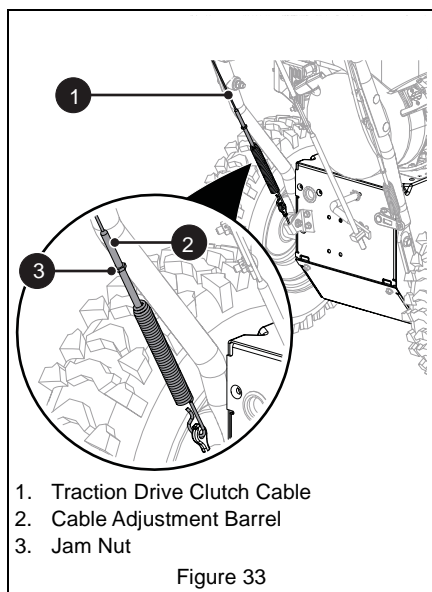

See Figure 34.

4. With traction clutch disengaged, check that swing gate tab touches the front edge of stop hole.

IMPORTANT: Swing gate tab **MUST** touch stop hole edge. Readjust cable as necessary until tab touches stop hole edge.

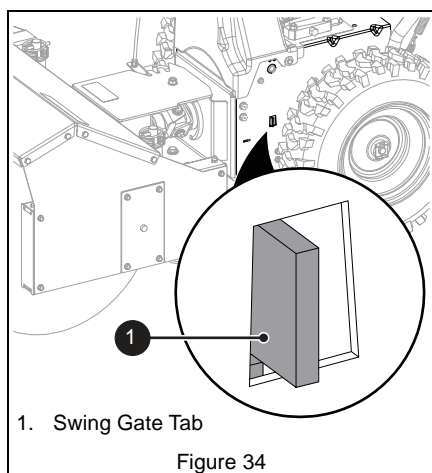

5. Reconnect spark plug wire.

TROUBLESHOOTING

Problem	Probable Cause	Correction
Engine will not start.	Engine key in stop position.	Turn engine key to run position. See <i>Engine Key</i> on page 9.
	Choke is off.	Turn choke control knob to on position. See <i>Choke Control Lever</i> on page 9.
	Fuel valve is closed.	Open valve. See <i>Fuel Valve</i> on page 9.
	Fuel tank is empty.	Fill tank with fuel. See <i>Before Operating Unit</i> on page 10.
	Build up of dirt and residue around governor / carburetor.	Clean area around governor / carburetor. See your Ariens dealer.
	Spark plug wire is disconnected.	Connect spark plug. Refer to engine manual.
	Spark plug is faulty.	Replace spark plug. Refer to engine manual.
	Excessive fuel in engine cylinder (flooded).	Turn choke control knob to off position and reattempt starting. See <i>Start The Engine</i> on page 11.
	Engine is faulty.	See your Ariens dealer or authorized engine manufacturer's service center.
Engine starts hard or runs poorly.	Fuel mixture is too rich.	Turn choke control knob to off position. See <i>Choke Control Lever</i> on page 9.
	Spark plug is faulty, fouled or incorrectly gapped.	Clean and correctly set spark plug gap (refer to engine manual) or see your Ariens dealer.
	Fuel cap vent is blocked.	Install new fuel cap.
Engine stops.	Fuel tank is empty.	Fill tank with fuel. See <i>Before Operating Unit</i> on page 10.
	Fuel valve is closed.	Open valve. See <i>Fuel Valve</i> on page 9.
	Obstruction in brush.	Stop engine and wait for moving parts to stop and for hot parts to cool. Remove obstruction before restarting.
	Contaminated fuel supply.	Replace with clean fuel.
	Spark plug is faulty.	Replace or clean spark plug. Refer to engine manual.
	Fuel cap vent is blocked.	Install new fuel cap.
Unit runs briefly then stops.	A build up of fumes in the fuel tank is creating too much pressure in the fuel tank.	Slowly loosen the fuel tank cap.
Unit does not drive forward or in reverse.	Friction disc is worn.	Replace friction disc. Refer to the service guide for your unit.
	Traction drive cable is not adjusted correctly.	Remove slack from cable. See <i>Adjust Traction Drive Clutch</i> on page 21.
	Traction belt is not functioning.	Repair or replace traction drive belt. Refer to the service guide for your unit.
	Speed selector is not adjusted correctly.	Adjust speed selector. See <i>Adjust Speed Selector Lever</i> on page 19.

TROUBLESHOOTING

Problem	Probable Cause	Correction
Unit sweeps poorly.	Attachment clutch / brake is not adjusted correctly.	See <i>Adjust Attachment Clutch & Brake</i> on page 19.
	Debris is caught in brush.	Stop engine and wait for all moving parts to stop and for hot parts to cool. Remove obstruction before restarting.
	Attachment drive belt is slipping, worn or damaged.	Adjust or replace attachment drive belt. Refer to the service guide for your unit.
	Attachment drive belt is loose or damaged.	Replace belt or adjust attachment control cable. Refer to the service guide for your unit.
Belt squeals continuously.	Attachment clutch needs adjustment.	See <i>Adjust Attachment Clutch & Brake</i> on page 19.
Small rubber beads collect in frame.	Friction disc wear.	This is normal friction disc wear and no correction is needed unless there are chunks or large pieces of rubber collecting in frame. Refer to the service guide for your unit.
U-joint is noisy.	Worn U-joint.	Replace worn parts. Refer to the service guide for your unit.
Caster wheels do not pivot as designed.	Debris in casters.	Clean debris from casters.
	Excessive friction in casters.	Lubricate casters. See <i>Lubricate Unit</i> on page 18.

STORAGE



WARNING: AVOID INJURY.
Read and understand the *Safety* section before proceeding.

SHORT TERM

1. Tighten all hardware to correct specifications.
2. Inspect unit for visible signs of wear or damage. Repair as needed.
3. Apply a light layer of oil or anti-rust compound on bare metal areas.
4. Prepare fuel system for storage.

NOTICE: Ariens recommends using a quality fuel stabilizer in all fuel. Gasoline left in the fuel system without a stabilizer, even for short periods of time, deteriorates and leaves gummy deposits in the system that may damage the carburetor and fuel hoses, filter and tank. For the best effectiveness, add stabilizer to all fuel containers whenever purchasing fuel. Add the stabilizer to the container before adding fuel.

- a. Add Ariens fuel stabilizer (see *Service Parts* on page 17) or equivalent according to manufacturer's instructions to the fuel tank and any fuel containers with remaining fuel.
 - b. Run engine outdoors for at least 5 minutes to allow stabilizer to reach the carburetor.
5. Close fuel valve and allow engine to stop on its own.
 6. Turn engine key to stop position and remove key.
 7. Store unit in a cool, dry, protected area. Do not store unit outdoors.

LONG TERM

1. Perform all short-term storage items.
2. Clean unit thoroughly with mild soap and low-pressure water.

IMPORTANT: Never spray unit with high-pressure water.

3. Lubricate as directed in *Maintenance* on page 14.
4. Touch up all scratched painted surfaces.
5. Remove weight from wheels by putting blocks under frame or axle.
6. Store unit in a cool, dry, protected area. Do not store unit outdoors.

START-OF-SEASON FUEL PREPARATION

Before opening the fuel valve for the first time after long-term storage, add fresh, stabilizer-treated fuel to the fuel tank and any fuel containers with remaining fuel.

ACCESSORIES

See your Ariens dealer for a complete list of compatible accessories and attachments for your unit.

Description	Part No.
Snow Cab	72102600
Turf Caster Brush Kit	72101200
Tire Chain Set	72101600

SPECIFICATIONS

Model Number	921056
Engine	
Engine Model	Kohler CH255
Displacement – cm ³ (in ³)	177 (10.8)
Maximum RPM – No Load	3750 ± 100
Starter	120V Electric and Recoil
Fuel	See Engine Manual
Tank Capacity – L (qt)	2.9 (3.1)
Brush	
Clearing Width – cm (in)	71.2 (28)
Brush Diameter – cm (in)	45.7 (18)
Brush Rotation Speed – RPM	200
Brush Rotation Angle	Total 40° (20° left / right)
Drive	
Drive	Disc-O-Matic
Drive Speeds	6 Forward 2 Reverse
Pneumatic Tires – in	16 x 4.80-8
Axle Control	Auto-Turn™
Size	
Length – cm (in)	165.1 (65)
Height – cm (in)	111.8 (44)
Width – cm (in)	83.8 (33)
Weight – kg (lb)	108 (238)



Sno-Thro[®], Sno-Tek[®] and Finishing Tool Equipment Limited Warranty

Ariens Company (Ariens) warrants to the **original purchaser** that Ariens, Gravely, Parker, and Countax brand chore-performing equipment (including Sno-Thro[®] and Sno-Tek[®] equipment) purchased on or after 1/1/2016 will be free from defects in material and workmanship for the time period noted in the chart below. Equipment put to personal use around a single household or residence is considered "Consumer Use"; equipment put to any business use (agricultural, commercial, or industrial) or used at multiple locations is considered "Commercial Use." If any product is rented or leased, then the duration of these warranties shall be 90 days after the date of purchase.

An authorized Ariens dealer (Ariens brand products), Gravely dealer (Gravely brand products), Parker dealer (Parker brand products), or Countax dealer (Countax brand products) will repair any defect in material or workmanship, and repair or replace any defective part, subject to the conditions, limitations and exclusions set forth herein. Such repair or replacement will be free of charge (labor and parts) to the original purchaser except as noted below.

Warranty Code	Product Group	Warranty Period Consumer Use	Warranty Period Commercial Use
PA	Log Splitters, Brushes, String Trimmers, Edgers	3 Years	90 Days
PB	Professional Powered Brushes	3 Years	1 Year
PC	Tillers	2 Years	90 Days
PD	Vacuums, Blowers, Sweepers, Truck Loaders, Lawn Rakes, Sprayers, Aerators, etc.	1 Year	1 Year
PE	Pressure Washer, Generators	3 Years	1 Year
SA	Professional Sno-Thro [®] , Professional 21	3 Years	1 Year
SB	Compact, Deluxe, Platinum, AMP [™] Sno-Thro [®] , Path-Pro [®]	3 Years	90 Days
SC	Sno-Tek [®]	2 Years	90 Days
SD	EFI Sno-Thro [®]	3 Years	90 Days
UA	Utility Vehicles	1 Year	1 Year
N/A	Service (Replacement) Parts	90 Days (no labor)	90 Days (no labor)
SE	920-Series Classic	3 Years	90 Days

Special Extensions

The chart below details special extensions to this warranty:

Warranty Code	Warranty Exception	Warranty Period	Use	Detail
SA	Cast Iron Auger Gear Case	5 Years	All	5 Years for all users including Commercial
SB, SD	Cast Iron Auger Gear Case	5 Years	Consumer	5 Years for Consumer use; 1 Year for Commercial Use
SB	Batteries for AMP [™] Sno-Thro [®]	2 Years	Consumer	100% first year; prorated second year.
SE	Aluminum Auger Gearcase	3 Years	Consumer	Commercial 90 Days

Exceptions and Limitations

The chart below details special exceptions to this warranty:

Warranty Code	Warranty Exception	Warranty Period	Use	Detail
All (Exc. SB)	Batteries	1 Year	All	Prorated
All	Belts, Muffler, Tires	None	Commercial	These components are not covered when used commercially.
All	Cloth, Plastic, and Rubber Components (Including Belts and Cables)	Maximum 2 Years	All	Warranty is limited to 2 years for consumer use. (1 year for warranty code "PD".) Except as noted above, these components are covered for defect, not for wear.
SA, SB, SC, SD, SE	Idlers	Maximum 2 Years	All	Warranty is limited on idlers to 2 years for consumer use.
All	Engines	See Engine Manufacturer's Warranty	All	Engines are covered by engine manufacturer's warranty. Refer to engine manufacturer's warranty statement.

Customer Responsibilities

Register the product immediately at the time of sale. If the dealer does not register the product, the customer must complete the product registration card in the literature package and return it to Ariens Company, or register the unit online at www.ariens.com, www.gravely.com, www.countax.com or www.parkersweeper.com.

To obtain warranty service, the **original purchaser** must:

- Perform the maintenance and adjustments explained in the Owner's Manual.
- Promptly notify Ariens or an authorized Ariens, Gravely, Parker or Countax service representative of the need for warranty service.
- Transport the product to and from the place of warranty service at owner's expense.
- Have the warranty service performed by an authorized Ariens, Gravely, Parker or Countax service representative.

To Find an Authorized Service Representative:

In the U.S. and Canada:		
Use the dealer locator on our websites: www.ariens.com • www.gravely.com		
Or contact us by mail or by phone:		
In the U.S., Canada, Mexico, Caribbean, Central and South America:	In Europe, Asia, Africa or the Middle East:	In Australia or New Zealand:
Ariens Company 655 W. Ryan Street Brillion, WI 54110 Phone: (920) 756 - 4688 www.ariens.com	Ariens Company Limited Great Haseley, Oxford OX44 7PF United Kingdom Phone: +44 800 597 7777 www.countax.co.uk	Allpower Industries Pty Ltd 128 Bridge Rd Keysborough VIC 3173 Australia Phone: +61 1800 333 428 www.allpower.com.au

Exclusions – Items Not Covered by This Warranty

- Parts that are not genuine Ariens, Gravely, Parker or Countax service parts are not covered by this warranty and may void the warranty.
- Damages resulting from the installation or use of any part, accessory, or attachment which is not approved by the Ariens Company for use with product(s) identified herein are not covered by this warranty.
- The following maintenance, service and replacement items are not covered by this warranty unless they are noted in the Limitations section above: lubricants, spark plugs, oil, oil filters, air filters, fuel filters, brake linings, brake arms, brake shoes, skid shoes, scraper blades, shear bolts, mower blades, mower vanes, brushes, headlights, light bulbs, knives, cutters, and single-stage impellers.
- Any misuse, alteration, improper assembly, improper adjustment, neglect, or accident which requires repair is not covered by this warranty.
- **Use of gasoline blends exceeding 10% ethanol voids any and all warranties.**
- Products are designed to the specifications in the area that the product was originally distributed. Different areas may have significantly different legal and design requirements. This warranty is limited to the requirements in the area in which the unit was originally distributed. Ariens Company does not warrant this product to the requirements of any other area. Warranty service is limited to service within the area originally distributed.
- In countries other than the United States and Canada, contact the Ariens Company dealer for warranty policies that govern within your country. Rights may vary from country to country and within any one country.
- Normal Wear: This warranty does not cover repair when normal use has exhausted the useful life of a part such as a high pressure hose, spray wand, nozzles, trigger handle, supply hoses, quick couplers, gaskets, valves, pistons, pump valve assemblies, o-rings, water and oil seals.

Special Exclusions on Utility Vehicles

The following uses void the warranty terms on Utility Vehicles (Warranty Code UA):

- Renting or leasing the utility vehicle.
- Using the utility vehicle to tow or carry loads in excess of the limits specified in the Owner/Operator Manual.
- Modifying the utility vehicle with parts and accessories that are not genuine or authorized Ariens or Gravely parts or accessories.
- Modifying the utility vehicle without express written authorization from Ariens Company.
- Operating the utility vehicle when it has not been completely and properly assembled and pre-delivered by an authorized Gravely dealer.

Disclaimer

Ariens Company may from time to time change the design of its products. Nothing contained in this warranty shall be construed as obligating Ariens Company to incorporate such design changes into previously manufactured products, nor shall such changes be construed as an admission that previous designs were defective.

LIMITATION OF REMEDY AND DAMAGES

Ariens Company's liability under this warranty, and under any implied warranty that may exist, is limited to repair of any defect in workmanship, and repair or replacement of any defective part. Ariens Company shall not be liable for incidental, special, or consequential damages (including lost profits). Some states do not allow the exclusion of incidental or consequential damages, so the above limitation or exclusion may not apply to you.

AUSTRALIAN CONSUMER LAW

The following applies solely to warranties subject to Subsection 102(1) of the Australian Consumer Law: Our goods come with guarantees that cannot be excluded by the Australian Consumer Law. You are entitled to a replacement or refund for a major failure and for compensation for any other reasonably foreseeable loss or damage. You are also entitled to have the goods repaired or replaced if the goods fail to be of acceptable quality and failure does not amount to a major failure.

DISCLAIMER OF FURTHER WARRANTY

Ariens Company makes no warranty, express or implied, other than what is expressly made in this warranty. If the law of your state provides that an implied warranty of merchantability, or an implied warranty of fitness for particular purpose, or any other implied warranty, applies to Ariens Company, then any such implied warranty is limited to the duration of this warranty. Some states do not allow limitations on how long an implied warranty lasts, so the above limitation may not apply to you.

This warranty gives you specific legal rights, and you may also have other rights which vary from region to region.



ARIENS®

655 West Ryan Street
Brillion, WI 54110

ariensstore.com
ariens.custhelp.com



parts.ariens.com

WARNING

The engine exhaust from this product contains chemicals known to the State of California to cause cancer, birth defects and other reproductive harm.

An *Ariens* Company Brand

