

SERVICE KIT INSTRUCTIONS

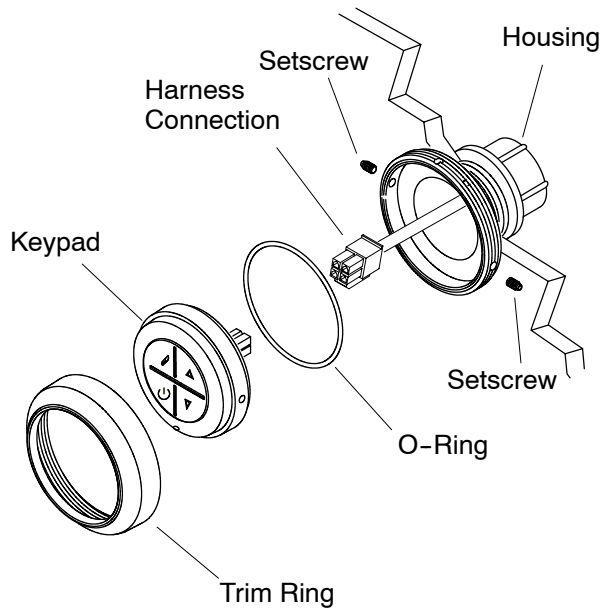

Remove Old Keypad

- Turn power off.
- Inspect new keypad for damage before you begin installation. Verify that new keypad decals are the same as the old keypad.
- Remove the trim ring by turning it counterclockwise.
- Use a 1/16" hex wrench to remove the setscrews located on each side of the keypad. Keep the setscrews in a safe location.
- Carefully pull the keypad out of the housing.
IMPORTANT! Make sure the harness cable does not fall back through the housing.
- Pull a minimum of 12" (30.5 cm) of cable through the housing. Disconnect the harness connection from the keypad.
- Inspect the O-ring for damage. Replace if necessary.

Install New Keypad

- Make sure the O-ring is in the correct location on the back of the keypad.
- Plug the harness into the back of the keypad.
- Align the keypad to the housing. The large tab on the keypad is located on the bottom.
- Carefully press the keypad into the housing. Turn the setscrews into keypad, but do not overtighten.
- Reassemble the trim ring.

Test New Keypad

- Restore power.

NOTE: For Kit 1020679 only - The keypad will automatically download information to the whirlpool control. This process takes approximately five seconds. A light sequence will illuminate up and down the indicator bar until the process is complete.

- Press the power button and verify that all modes work properly. Refer to the Homeowners Guide shipped with your product.
- If a remote control is used, refer to the Homeowners Guide for programming instructions.

USA: 1-800-4-KOHLER
Canada: 1-800-964-5590
Mexico: 001-877-680-1310
kohler.com
© 2004 Kohler Co.

1021551-9-B