

CRAFTSMAN®

INSTRUCTION MANUAL

ELECTRIC POLY CHIPPER SHREDDER

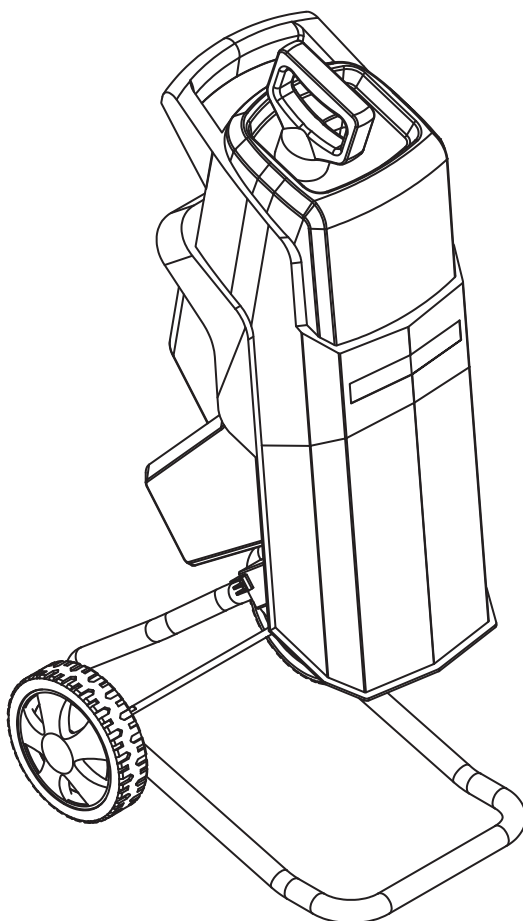

CMXGPXT1500



IF YOU HAVE QUESTIONS OR COMMENTS, CONTACT US.

1-888-331-4569

WWW.CRAFTSMAN.COM

Definitions: Safety Alert Symbols and Words

This instruction manual uses the following safety alert symbols and words to alert you to hazardous situations and your risk of personal injury or property damage.

- ⚠ DANGER:** Indicates an imminently hazardous situation which, if not avoided, **will** result in **death or serious injury**.
 - ⚠ WARNING:** Indicates a potentially hazardous situation which, if not avoided, **could** result in **death or serious injury**.
 - ⚠ CAUTION:** Indicates a potentially hazardous situation which, if not avoided, **may** result in **minor or moderate injury**.
 - ⚠** (Used without word) Indicates a safety related message.
 - NOTICE:** Indicates a practice **not related to personal injury** which, if not avoided, **may** result in **property damage**.
-

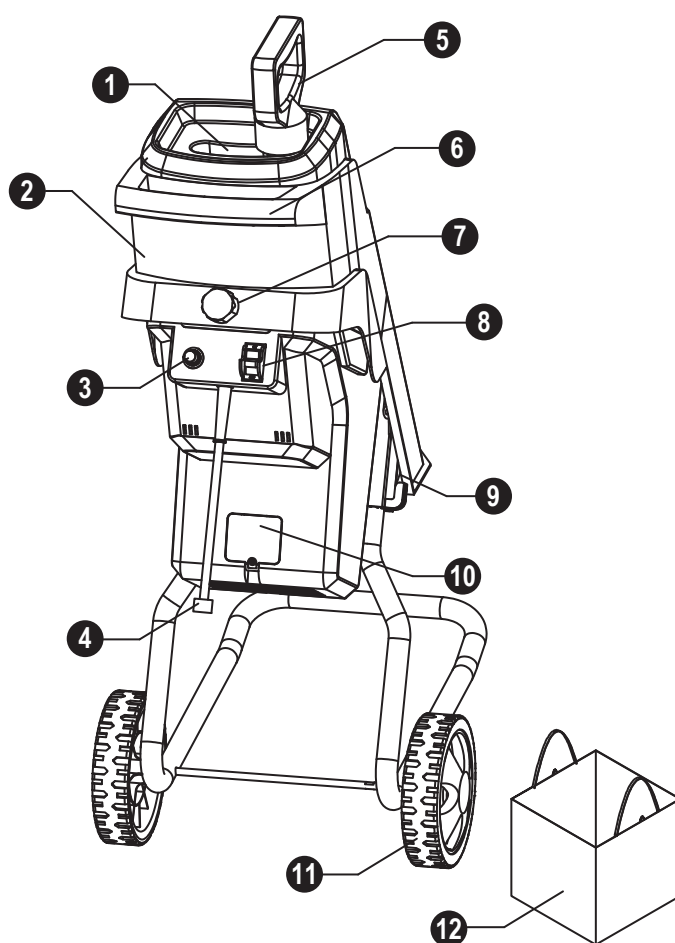

Components

- 1** Feeding Chute
- 2** Hopper
- 3** Reset Button
- 4** Power Plug
- 5** Push Stick
- 6** Handle
- 7** Hopper Lock Knob
- 8** On/Off Switch with Safety Key
- 9** Discharge Chute
- 10** Carbon Brush Cover
- 11** Wheel
- 12** Collection Bag

⚠ WARNING: Read all safety warnings and all instructions. Failure to follow the warnings and instructions may result in electric shock, fire and/or serious injury.

⚠ WARNING: Never modify the product or any part of it. Damage or personal injury could result.

⚠ WARNING: To reduce the risk of injury, read the instruction manual.

If you have any questions or comments about this or any product, call CRAFTSMAN toll free at: 1-888-331-4569.

⚠ WARNING: Read and understand all instructions and safety information in this manual and on safety decals before assembling or operating the chipper shredder. Failure to understand and follow all instructions and safety information may result in serious injury or death. Persons who have not read the manual should never operate the chipper shredder. A chipper shredder can be dangerous when assembled and/or used improperly. Do not operate the chipper shredder if you have any questions concerning safe operation. Please call the technical support department at 1-888-331-4569 for answers to any questions.

⚠ WARNING: This product can expose you to chemicals including lead and lead compounds which are known to the State of California to cause cancer and birth defects or other reproductive harm. For more information, go to www.P65Warnings.ca.gov

⚠ WARNING: IMPORTANT SAFETY INFORMATION

1) GENERAL SAFETY

- Keep work area clean and well lit. Cluttered or dark areas invite accidents.
- Do not operate power tools explosive atmospheres, such as in the presence of flammable liquids, gases or dust. Power tools create sparks which may ignite the dust or fumes.
- Keep children and bystanders away while operating a power tool. Distractions can cause you to lose control.

2) ELECTRICAL SAFETY

- Power tool plugs must match the outlet. Never modify the plug in any way. Do not use any adapter plugs with earthed (grounded) power tools. Unmodified plugs and matching outlets will reduce risk of electric shock.
- Avoid body contact with earthed or grounded surfaces such as pipes, radiators, ranges and refrigerators. There is an increased risk of electric shock if your body is earthed or grounded.
- Do not expose power tools to rain or wet conditions. Water entering a power tool will increase the risk of electric shock.
- Do not abuse the cord. Never use the cord for carrying, pulling or unplugging the power tool. Keep cord away from heat, oil, sharp edges or moving parts. Damaged or entangled cords increase the risk of electric shock.
- **⚠ WARNING:** To reduce the risk of electric shock, use only with an extension cord intended for outdoor use, such as an extension cord of cord type SW, SOW, STW, STOW, SJW, SJOW, SJTW, and SJTOW.
- If operating a power tool in a damp location is unavoidable, use a ground fault circuit interrupter (GFCI) protected supply. Use of a GFCI reduces the risk of electric shock.

3) PERSONAL SAFETY

- Stay alert, watch what you are doing and use common sense when operating a power tool. Do not use a power tool while you are tired or under the influence of drugs, alcohol or medication. A moment of inattention while operating power tools may result in serious personal injury.
- Use personal protective equipment. Always wear eye protection. Protective equipment such as a respiratory mask, non-skid safety shoes and hearing protection used for appropriate conditions will reduce the risk of personal injury.
- Prevent unintentional starting. Ensure the switch is in the off-position before connecting to power source and/or battery pack, picking up or carrying the tool. Carrying power tools with your finger on the switch or energizing power tools that have the switch on invites accidents.
- Remove any adjusting key or wrench before turning the power tool on. A wrench or a key left attached to a rotating part of the power tool may result in personal injury.
- Do not overreach. Keep proper footing and balance at all times. This enables better control of the power tool in unexpected situations.
- Dress properly. Do not wear loose clothing or jewelry. Keep your hair and clothing away from moving parts. Loose clothes, jewelry or long hair can be caught in moving parts.
- If devices are provided for the connection of dust extraction and collection facilities, ensure these are connected and properly used. Use of dust collection can reduce dust-related hazards.

4) POWER TOOL USE AND CARE

- Do not force the power tool. Use the correct power tool for your application. The correct power tool will do the job better and safer at the rate for which it was designed.
- Do not use the power tool if the switch does not turn it on and off. Any power tool that cannot be controlled with the switch is dangerous and must be repaired.
- Disconnect the plug from the power source and/or the battery pack from the power tool before making any adjustments, changing accessories, or storing power tools. Such preventive safety measures reduce the risk of starting the power tool accidentally.
- Store Idle Appliances Indoors – When not in use, appliances should be stored indoors in dry, and high or locked-up place – out of reach of children. Do not allow persons unfamiliar with the power tool or these instructions to operate the power tool. Power tools are dangerous in the hands of untrained users.
- Maintain power tools. Check for misalignment or binding of moving parts, breakage of parts and any other condition that may affect the power tool's operation. If damaged, have the power tool repaired before use. Many accidents are caused by poorly maintained power tools.
- Keep cutting tools sharp and clean. Properly maintained cutting tools with sharp cutting edges are less likely to bind and are easier to control.
- Use the power tool, accessories and tool bits, etc. in accordance with these instructions, taking into account the working conditions and the work to be performed. Use of the power tool for operations different from those intended could result in a hazardous situation.
- Keep guards in place and in working order.

5) SERVICE

Have your power tool serviced by a qualified repair person using only identical replacement parts. This will ensure that the safety of the power tool is maintained.

6) SHREDDER SAFETY

- This shredder is designed for cutting up small branches, using the appropriate accessories. Using the machine for any other purpose for which it is not designed may result in serious injuries, machine damage and voiding of the warranty.
- The use of accessories or attachments not recommended by the manufacturer may result in a risk of personal injury.
- Preventing accidental starting. Make sure the power switch is in the OFF position prior to plugging in the machine. Always make sure the power switch is in the OFF position and the machine is unplugged when doing any cleaning, adjustments, assembly, setup operations, or when not in use.

7) PERSONAL SAFETY

- Do not use the shredder in rainy or wet locations. Do not operate in gaseous or explosive atmospheres or near flammable or combustible liquids. The motor may spark and ignite fumes.
- The shredder must be used in the upright position only. Do not operate the shredder with it lying on its side. Do not tilt the shredder while it is running.
- Wear ANSI Z87.1-approved safety goggles to protect your eyes. Use hearing protection to protect yourself from hearing loss.
- DO NOT wear loose clothing or jewelry as they might get drawn in by the tool. Tie back long hair. Wear rubber gloves and non-slip footwear.
- People with pacemakers should consult their physician(s) before use. Electromagnetic fields in close proximity to pacemakers could cause pacemaker interference or pacemaker failure.
- Chips are harmful to your health. Use NIOSH-approved dust masks or other respiratory protection during operation and cleaning.

8) PREPARING THE SHREDDER

- Use the wheels and handle to transport the shredder. Never carry the device by its guards or its accessories.
- Examine the shredder for any damaged or missing parts. Replace or repair damaged parts before operation. Periodically check that all nuts, bolts and other fasteners are properly tightened.
- Do not operate this tool until it is completely assembled and installed according to the instructions. Make sure all adjustments are correct and all connections are tight. Keep all guards in place. Make sure that the hop-per inlet is empty before starting the shredder.

WARNING: IMPORTANT SAFETY INFORMATION

9) DURING OPERATION

- Examine materials before feeding them into the shredder. Make sure to remove pieces of metal, rocks, bottles, cans or other foreign objects. Before you shred roots, remove any remaining soil and stones from them. Do not shred soft, damp material such as kitchen waste.
- Feed materials slowly. Always use the paddle supplied with your shredder to push items into the hopper. Do not force materials into the hopper. Do not feed materials larger than the recommended diameter of 1.5 inches, otherwise you may clog the shredder and damage the machine.
- Keep clear of moving parts and openings. Keep arms, hands and other vital appendages away from the hopper, blades, and discharge chute. Never put your hands into the hopper while the shredder is running. Always stand clear of the discharge zone when operating the shredder. Never reach under the hopper until the shredder has come to a complete stop and has been disconnected from the power supply.
- Do not use the shredder unless all guards are in place. Do not operate with any guard disabled, damaged, or removed. Moving guards must move freely and close instantly.
- Regularly turn off the machine and clear processed material from the discharge zone. Buildup near the discharge zone may prevent proper discharge and can result in kickback of material through the hopper.
- Turn off the shredder and disconnect it from the power supply before you leave the work area. The blades will continue to rotate for a few seconds after the unit is turned off.
- If the cutting mechanism strikes a foreign object or if the shredder starts making any unusual noise or vibration, turn the unit off and allow it to come to a complete stop. Disconnect from the power supply and inspect the unit for damage. Check for any loose parts and tighten them as necessary.
- Should any component of your shredder be missing/damaged or fail in any way, shut off the switch and remove the plug from power supply outlet. Have a certified technician replace the missing, damaged, or failed parts using only identical replacement parts before resuming operation.
- If the shredder becomes clogged, turn off the shredder and disconnect it from power supply. Wait for the blades to come to a complete stop before clearing debris.
- Maintain the shredder with care. Keep the cutting edges sharp and clean to ensure optimal performance and reduce the risk of injury.

ELECTRICAL INFORMATION

1) DOUBLE-INSULATED TOOLS

The tool's electrical system is double insulated where two systems of insulation are provided. This eliminates the need for the usual three-wire grounded power cord. Double insulated tools do not need to be grounded, nor should a means for grounding be added to the product. All exposed metal parts are isolated from the internal metal motor components with protecting insulation.



IMPORTANT: Servicing a double-insulated product requires extreme care and knowledge of the system, and should be done only by qualified service personnel using identical replacement parts. Always use original factory replacement parts when servicing.

2) USE SAFETY GLASSES - Always use face or dust mask if operation is dusty.

- To reduce the risk of electric shock, this appliance has a polarized plug (one blade is wider than the other) and will require the use of a polarized extension cord. The appliance plug will fit into a polarized extension cord only one way. If the plug does not fit fully into the extension cord, reverse the plug. If the plug still does not fit, obtain a correct polarized extension cord. A polarized extension cord will require the use of a polarized wall outlet. This plug will fit into the polarized wall outlet only one way. If the plug does not fit fully into the wall outlet, reverse the plug. If the plug still does not fit, contact a qualified electrician to install the proper wall outlet. Do not change the equipment plug, extension cord receptacle, or extension cord plug in any way.
- Ground fault circuit interrupter protection (GFCI) should be provided on the circuit or outlet used for this power tool to reduce the risk of electric shock.
- Service and repair. To avoid danger, electrical appliances must only be repaired by qualified service technician using original replacement parts.

3) GUIDELINES AND RECOMMENDATIONS FOR EXTENSION CORDS

When using an extension cord, be sure to use one heavy enough to carry the current your product will draw. An undersized cord will cause a drop in line voltage resulting in loss of power and overheating. The table below shows the correct size to be used according to cord length and ampere rating. When in doubt, use a heavier cord. The smaller the gauge number, the heavier the cord.

To reduce the risk of disconnection of appliance cord from the extension cord during operating:

Make a knot as shown in Figure 1.

Method of securing extension cord

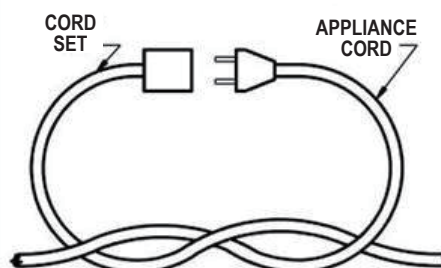

(A) TIE CORD AS SHOWN

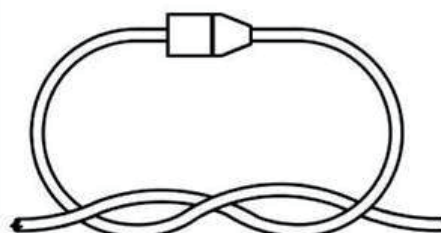

(B) CONNECT PLUG AND RECEPTACLE

Fig. 1

AMPERAGE	REQUIRED GAUGE FOR EXTENSION CORDS			
	25 ft.	50 ft.	100 ft.	150 ft.
15A	14 gauge	12 gauge	Not Recommended by UL	

- Examine extension cord before use. Make sure your extension cord is properly wired and in good condition. Always replace a damaged extension cord or have it repaired by a qualified person before using it.
- Do not abuse extension cord. Do not pull on the cord to disconnect from receptacle; always disconnect by pulling on plug. Disconnect the extension cord from the receptacle before disconnecting the product from the extension cord. Protect your extension cords from sharp objects, excessive heat and damp/wet areas.
- Use a separate electrical circuit for your tool. This circuit must not be less than a 12-gauge wire and should be protected with a 15A time-delayed fuse. Before connecting the motor to the power line, make sure the switch is in the OFF position and the electric current is rated the same as the current stamped on the motor nameplate. Running at a lower voltage will damage the motor.

SPECIFICATIONS

Model Number	CMXGPXT1500
Motor	120V AC, 60Hz, 15A
Maximum Speed	4600 RPM
Recommended Material Diameter	0 to 1 inch (0 to 25.4 mm)
Maximum Material Diameter	1-1/2 inches (38 mm)
Weight	26.5 pounds
Product Dimensions	25.6 x 16.5 x 12.6 inches

UNPACKING & TRANSPORTATION

▲ WARNING! Do not plug in or turn on the tool until it is fully assembled according to the instructions. Failure to follow the safety instructions may result in serious personal injury.

UNPACKING

With the help of an additional person, carefully remove the shredder from the packaging. Make sure to take out all contents and accessories. Do not discard the packaging until everything is removed. Check the packing list below to make sure you have all of the parts and accessories. If any part is missing or broken, please contact our customer service at 1-888-331-4569 (M-F 8-5 PST).

PACKING LIST

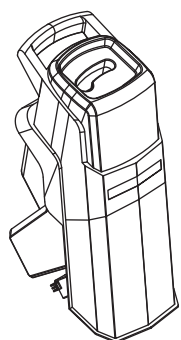

Shredder
1pc

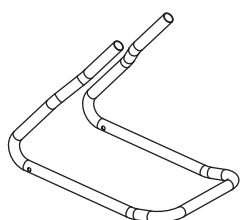

Support Leg
1pc

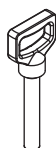

Push Stick
1pc

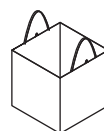

Collection Bag
1pc



Screw ST4.8x19
2pcs



Flat Washer
Ø5
2pcs



Lock Washer
Ø5
2pcs



Wheel Axle
1pc



Bushing
2pcs



Wheel
2pcs



Nylon Lock
Nut M6
2pcs



Wheel Side
Cover
2pcs



10/13mm
Wrench
2pcs



Allen Wrench
1pc

TRANSPORTING

Use the handle and tilt the shredder to pull it with the wheels. Never carry the tool by its guards or its accessories.

ASSEMBLY & ADJUSTMENTS

▲ WARNING! Do not plug in or turn on the tool until it is fully assembled according to the instructions. Read through and become familiarized with the following procedures of handling and adjusting your tool. Failure to follow the safety instructions may result in serious personal injury.

STEP 1: Assembling the Wheels

- 1.1 Insert the wheel axle (#24) through the bottom holes of the support leg (#25).
- 1.2 Slide the bushing (#49) and wheels (#23) to the end of the wheel axle. Secure wheel with a nylon lock nut M6 (#21).
- 1.3 Snap the wheel cover (#20) into the wheel.
- 1.4 Install the wheel to the other side in the same way.

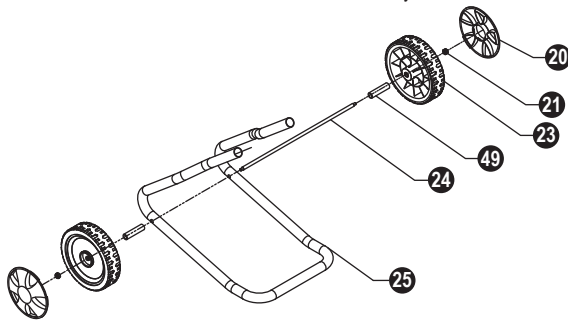

STEP 2: Assembling the Support Leg

- 2.1 Insert the two ends of the support leg assembly into the bottom of the shredder housing.

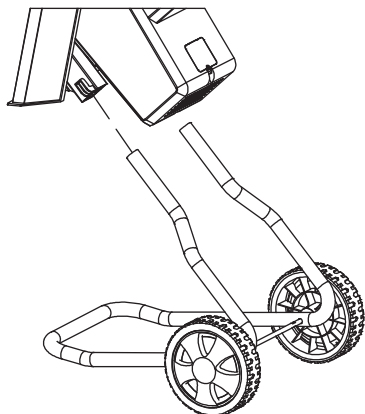

STEP 3: Tighten the Support Leg

- 3.1 Align the holes and tighten the support leg using flat washer Ø5 (#52), lock washer Ø5 (#51) and screw ST4.8x19 (#18).

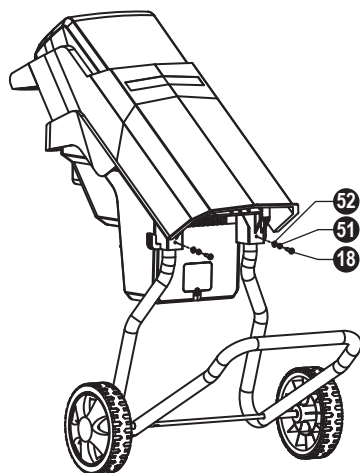

STEP 4: Collecting Shredded Material

- 4.1 The shredder comes with a collection bag. Place the collection bag under the discharge chute to collect shredded material. Place the push stick into the feeding chute every time after using.

OPERATION

▲ WARNING! Do not plug in or turn on the tool until it is fully assembled according to the instructions. Read through and become familiarized with the following procedures of handling and adjusting your tool. Failure to follow the safety instructions may result in serious personal injury.

▲ WARNING! Wear ANSI Z87.1-approved safety glasses, work-appropriate clothing, work gloves, and dust mask. Read through the safety section. Do not allow any part of the body or clothing near the feeding chute or the discharge chute. Never reach under the hopper until the shredder has come to a complete stop and has been disconnected from the power supply.

BASIC SHREDDING OPERATION

- Place the shredder on a dry, level ground in the upright position. Do not operate the shredder if it is tilted or lying on its side.
- Check to make sure that the hopper is empty. Close the hopper tightly by turning the hopper lock knob (A) clock-wise. The shredder will not run if the hopper is open or not fully closed.

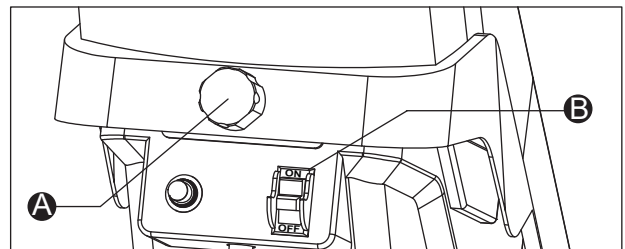

- Inappropriate materials may damage the machine and cutting blades. Examine all materials before feeding them into the shredder:
 - Remove pieces of metal, rocks or other foreign objects that may damage the blades.
 - Do not feed wooden sticks with a diameter larger than 1.5 inch.
 - Before shredding roots, remove any remaining soil and stones.
 - Do not shred soft, damp material such as kitchen waste.
- Connect the shredder to the power source and turn the power switch to ON (B).
- Follow the rules below when feeding materials:
 - Only insert as much material as needed to prevent blockage of the feeding chute.
 - Feed wilted and damp materials alternately with dry branches to prevent cutting blades from blocking up.
 - Branches with leaves must be completely processed before new material is fed. Make sure that the chopped material can fall freely from the discharge chute.
 - Maintain the working speed of the shredder and do not overload it.
 - Keep a few dry branches to be shredded at the end, as they will help clean your shredder.

NOTE: For optimal performance, we recommend shredding materials with diameters less than 1".

NOTE: The power switch is equipped with a safety key to prevent children from accidentally starting the machine. Turn off the power switch and remove the safety key to engage the child-safety lock and prevent unwanted start-ups. The switch cannot be turned on when the safety key is removed.

- Slowly insert the branch into the hopper through the feeding chute. Keep hold of the branch at a safe distance from the feeding chute until it is automatically drawn into the shredder.
- Use the included push stick to push the material inside the hopper, but be careful not to shred the paddle.
- Only switch off the shredder after all of the shredding materials have passed through the discharge chute. Otherwise, the discharge chute may jam the next time the shredder is turned on.
- When all shredding work is complete, switch the machine to OFF and unplug the power cord. Wait for the blades to come to a complete stop before leaving the work area.

OVERLOAD PROTECTION

Your electric shredder is equipped with overload protection. If the shredder is clogged during shredding, the over-load protection will cut the power automatically to protect your shredder. Wait at least 1 minute for the motor to cool down before restarting the unit.

To restart the shredder:

1. Press the reset button (A).
2. Turn the power switch ON (B).
3. If the shredder will not start, it might be jammed inside. Turn the shredder OFF and unplug the power cord. Wait for the blades to come to a complete stop. Clear the clogged materials.



TROUBLESHOOTING

⚠ WARNING! Stop using the tool immediately if any of the following problems occur. Repairs and replacements should only be performed by an authorized technician. For any questions, please contact our customer service at (888) 331 4569, M-F 8-5 PST.

PROBLEM	POSSIBLE CAUSE	SOLUTION
Motor does not start.	1. If a GFCI being used, it could be tripped.	1. Check GFCI and reset if needed.
	2. Power cord or extension cord damaged or not properly plugged in.	2. Check the power cord, extension cord, power plug, and the power outlet. Make sure the tool is properly plugged in. Do not use the tool if any cord is damaged.
	3. Safety key is removed from power switch.	3. Insert the safety key into the power switch.
	4. Motor is overloaded and circuit breaker trips.	4. The material may be too much or too hard for the shredder to handle. Wait for motor too cool down, and press the reset button. Reduce the material load and restart the shredder.
	5. The hopper is open.	5. Check that the hopper is closed and the hopper lock knob is tightened.
Material cannot be fed into the shredder.	1. The material is jammed in the feed inlet.	1. Turn off and unplug the machine. Open the hopper and remove blocked or jammed materials.
	2. The cutting blades are blocked.	2. Turn off and unplug the machine. Open the hopper and blade cover. Remove blocked material from the blade. Close the blade cover and hopper.
	3. The discharge chute is blocked.	3. Turn off and unplug the machine. Open the hopper and the plate of the discharge chute to clear the blocked material. Replace the plate and hopper.
Inefficient cutting.	1. Cutting blade edges are worn.	1. Reverse the blades or replace with new blades.

MAINTENANCE

⚠ WARNING! To avoid accidents, turn OFF and unplug the tool from the electrical outlet before cleaning, adjusting, or performing any maintenance work.

ROUTINE INSPECTION

Before each use, inspect the general condition of the tool. If any of these following conditions exist, do not use until parts are replaced or the tool is properly repaired.

Check for:

- Loose hardware,
- Misalignment or binding of moving parts,
- Damaged cord/electrical wiring,
- Cracked or broken parts,
- Any other condition that may affect its safe operation.

CLEANING & STORAGE

- Keep the ventilation openings free from dust and debris to prevent the motor from overheating.
- Use a vacuum or low-pressure compressed air to remove dust and debris from the tool surfaces, motor housing and work area.
- Wipe the tool surfaces clean with a soft cloth or brush. Make sure water does not get into the tool.

CAUTION! Most plastics are susceptible to damage from various types of commercial solvents. Do not use any solvents or cleaning products that could damage the plastic parts. Some of these include but are not limited to: gasoline, carbon tetrachloride, chlorinated cleaning solvents, and household detergents that contain ammonia.

To clean the inside of the unit, turn the hopper locking knob counterclockwise, and open the hopper. Clean the cutting blades and the discharge area. Remove wood sticks or objects that may clog the blades. Check the blades for damage and replace if they show signs of wear. Replace the hopper and lock the hopper locking knob by turning it clockwise.

- Store the tool in a clean and dry place away from the reach of children.
- Cover the tool in order to protect it from dust and moisture. It is preferable to store it in its original packaging with the instruction manual and all accessories.

PRODUCT DISPOSAL

Used power tools should not be disposed of together with household waste.

This product contains electronic components that should be recycled. Please take this product to your local recycling facility for responsible disposal and to minimize its environmental impact.



Please recycle the packaging and electronic components where facilities exist.

REPLACING CUTTING BLADES

The shredder comes with two cutting blades preinstalled that can be reversed or replaced to keep the cutting edges sharp. The two blades should always be reversed or replaced as a matched set.

It is recommended to replace/reverse the blades when the wood sticks cannot be automatically drawn into the shredder after entering the hopper. One set of sharp edges can cut approximately 400 lbs. of materials, depending on the hardness and quality of the sticks. When the cutting capacity is reached, make sure to replace/reverse the shredder blades to maintain optimal performance.

⚠ WARNING! Wear protective gloves to protect your hands. Cutting blades have sharp edges on both sides and are fragile. Handle the blades carefully to avoid personal injury or damage to the blades.

- Turn off and unplug the machine. Wait for the blades to come to a complete stop.
- Fully unscrew the hopper lock knob until it springs out. Open the hopper to access the cutting head (A).
- Clean out all chips or foreign matter sticking to the cutting head and blades (B) using a soft brush.

- Rotate the cutting head to the configuration. To prevent the cutting head from rotating during blade change, insert a screwdriver through the blade guard hole (C) and the slot in the cutting head.
- Unscrew the two hex bolts (D) on the top blade. Turn the cutting head 180 degrees to remove the other blade.
- The blades may be reversed when one of the cutting edges becomes dull or chipped. Reverse the direction of the original blades, or install two new blades. Make sure to reverse or replace both blades at the same time so they are balanced with one another. Align the slots on the blade with the grooves on the cutting head.
- Secure each blade with two hex bolts, firmly tighten them with a hex wrench. Close the hopper and fully tighten the hopper locking knob.

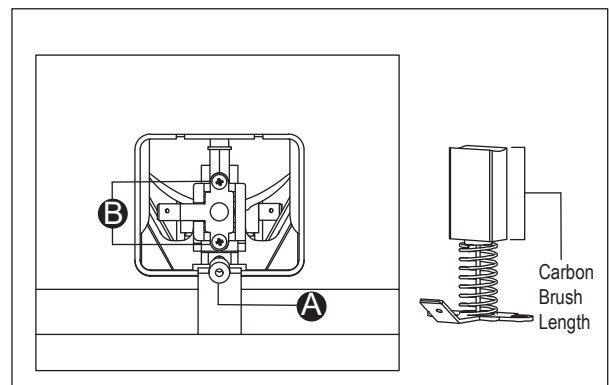
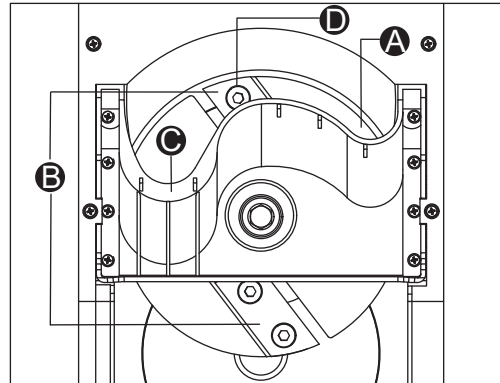

CARBON BRUSH REPLACEMENT

The wear on the carbon brushes depends on how frequently and how heavily the tool is used. To maintain maximum efficiency of the motor, we recommend inspecting the two carbon brushes every 60 hours of operation or when the tool stops working.

- Turn off and unplug the machine. Wait for the blades to come to a complete stop.
- The two carbon brushes can be accessed through the front and back carbon brush cover located on the bottom of the shredder body. Unscrew the Phillips head screw from the housing and open the carbon brush cover (A).
- Unscrew the two small Phillips screws (B) to remove the carbon brush holder. Carefully remove the old carbon brushes using pliers.

NOTE: Keep track of which orientation the old carbon brushes were in to prevent needless wear if they will be reinstalled.

- Measure the length of the brushes. Install the new set of carbon brushes if either carbon brush length is worn down to 3/16" or less. Reinstall the old carbon brushes (in their original orientation) if your brushes are not worn down to 3/16" or less. Both carbon brushes should be replaced at the same time.
- Replace the carbon brush holder and cover. Tighten all screws. Repeat the steps above to replace the carbon brush located on the other side of the motor.

NOTE: New carbon brushes tend to spark for a few minutes during the first use as they wear down.

DRAWING

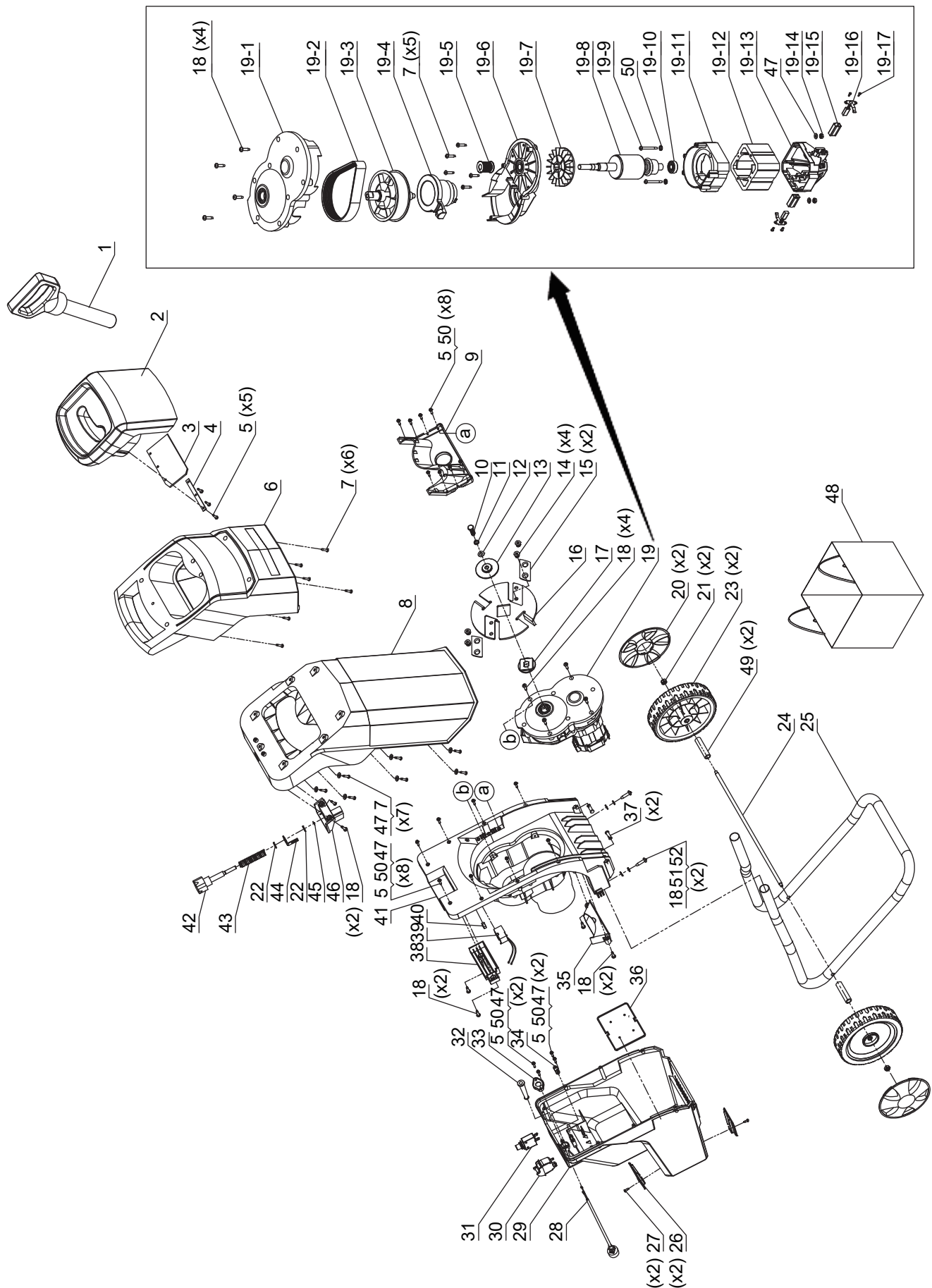

PARTS LIST

Ref#	Drawing No.	Description	Qty.
1	CPY0120-00011	Push Stick	1
2	CPY0120-00001	Hopper	1
3	CPY0120-00025	Preventer Plate	1
4	CPY0120-00026-DX	Press Bar	1
5	9119-03919-DX	Screw ST3.9x19	23
6	CPY0120-00002	Upper Housing	1
7	9119-04219-DX	Screw ST4.2x19	18
8	CPY0120-00003	Large Housing	1
9	CPY0120-00006	Dust Against Plate	1
10	9101-08030-DX8.8	Hex Bolt M8x30	1
11	9306-08000-DX	Lock Washer Ø8	1
12	9302-08000-DX	Large Flat Washer Ø8	1
13	CPY0120-00023-DX	Presser	1
14	CPY0120-00009-DX	Inner Hex Screw M10x12	4
15	CPY0120-00024	Blade	2
16	CPY0120-00019	Cutting Disk	1
17	CPY0120-00022	Transmission Shaft	1
18	9119-04819-DX	Screw ST4.8x19	16
19	CPY0120-01000	Motor Assembly	1
20	CPY0120-03002	Wheel Side Cover	2
21	9216-06000-DX	Nylon Lock Nut M6	2
22	9301-08000-DX	Flat Washer Ø8	2
23	CPY0120-03001	Wheel	2
24	CPY0120-00010-DX	Wheel Axle	1
25	CPY0120-00008	Support Leg	1
26	CPY0120-00007	Front Cover	2
27	9119-039095-DX	Screw ST3.9x9.5	2
28	CPY0120-00028	Power Cord	1
29	CPY0120-00005	Rear Cover	1
30	CPY0120-00030	Power Switch	1
31	CPY0120-00031	Overload Protector	1
32	CPY0120-00029	Power Cord Sleeve	1
33	CPY0120-00017	Sleeve Clamp	1
34	CPY0120-00018	Cable Clamp	1

PARTS LIST

Ref#	Drawing No.	Description	Qty.
35	CPY0120-00015	Heating Vent	1
36	CPY0120-00013	Dust Baffle	1
37	CPY0120-00021	Pin Shaft	2
38	CPY0120-00016	Protector Pressing Plate	1
39	CPY0120-00032	Safety Switch	1
40	9201-08000-DX	Nut M8	1
41	CPY0120-00004	Motor Mounting Bracket	1
42	CPY0120-02000	Handwheel	1
43	CPY0120-00027-DX	Spring	1
44	CPY0120-00020-DX	Inserting Piece	1
45	9304-08000-FH	Shaft Circlip	1
46	CPY0120-00014	Handwheel Fastener	1
47	9301-04000-DX	Flat Washer Ø4	21
48	CPY0120-00033	Collection Bag	1
49	CPY0120-00034-DX	Bushing	2
50	9306-04000-DX	Lock Washer Ø4	22
51	9306-05000-DX	Lock Washer Ø5	2
52	9301-05000-DX	Flat Washer Ø5	2
19-1	CPY0120-01400	Reduction Casing Upper Cover	1
19-2	10EPJ390	Belt	1
19-3	CPY0120-01100	Belt-Wheel	1
19-4	CPY0120-01200	Eccentric Bushing	1
19-5	CPY0120-01001	Belt-Wheel	1
19-6	CPY0120-01300	Reduction Casing Lower Cover	1
19-7	CPY0120-01507	Fan	1
19-8	CPY0120-01503	Rotor Assembly	1
19-9	9110-04080-DX	Screw M4x80	2
19-10	627-2Z	Rolling Bearing	2
19-11	CPY0120-01506	Motor Fixation Bracket	1
19-12	CPY0120-01501	Stator Assembly	1
19-13	CPY0120-01502	Rear Cover	1
19-14	9201-04000-DX	Nut M4	2
19-15	CPY0120-01504	Brush Holder	2
19-16	CPY0120-01505	Carbon Brush Assembly	2
19-17	9119-02908-DX	Screw ST2.9x8	4

LIMITED WARRANTY

Duration of Warranty

For one year from the date of purchase, YTL International will replace or repair the chipper shredder for the original purchaser. The warranty will not apply to any chipper shredder that was incorrectly assembled, misused, overloaded and/or was otherwise used contrarily to the manufacturer's instructions contained in the owner's manual. Any repairs, alterations or modifications to the chipper/shredder made by anyone other than an authorized representative void the warranty.

Warranty Exclusions

The warranty does not cover cosmetic defects, such as paint and decals. The warranty excludes components that wear out with ordinary use over time, such as tires. The warranty will not cover failures or problems due to acts of God, or events or forces beyond the control of the manufacturer.

Normal Wear Exclusions

The chipper shredder requires periodic service to perform well. The warranty does not cover repair when normal use has exhausted the life of a part or the equipment as a whole.

Installation, Use and Maintenance Exclusions

The warranty will not apply to parts and/or labor if the chipper shredder has been misused, neglected, involved in an accident, abused, loaded beyond its limits, modified or assembled incorrectly. Normal maintenance is not covered under the warranty.

Limits of Implied Warranty and Consequential Damage Exclusions

YTL International disclaims any obligation to cover any loss of time, use of this product, freight, or any incidental or consequential claim by anyone incurred from using the chipper shredder. THIS WARRANTY IS IN LIEU OF ALL OTHER WARRANTIES, EXPRESS OR IMPLIED, INCLUDING WARRANTIES OF MERCHANTABILITY OR FITNESS FOR A PARTICULAR PURPOSE.

An exchanged chipper shredder will be subject to the original warranty date. The length of the warranty governing the exchanged unit will be calculated from the purchase date of the original unit. The warranty gives you certain legal rights which may change from state to state. Your state may also have other rights you may be entitled to that are not listed within this warranty.

CRAFTSMAN®

is a registered trademark of Stanley Black & Decker, Inc., used under license.
es una marca registrada de Stanley Black & Decker, Inc., utilizada bajo licencia.
est une marque déposée de Stanley Black & Decker, Inc., utilisée sous licence.

Product manufactured by: YTL International Inc.

Producto fabricado por: YTL International Inc.

Produit fabriqué par: YTL International Inc.

LICENSEE NAME: YTL International Inc.

LICENSEE ADDRESS: 17517 Fabrica Way Suite H Cerritos, CA 90703

For product, service or warranty information contact us at:

Para obtener información sobre el producto, el mantenimiento

o la garantía, comuníquese con nosotros en:

Pour obtenir de l'information sur les produits, les réparations ou

la garantie, prière de nous contacter au:

U.S. & Canada Only • É.-U. et Canada seulement

www.CRAFTSMAN.com • 888-331-4569