

LED MIRROR

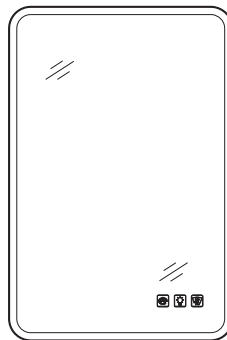
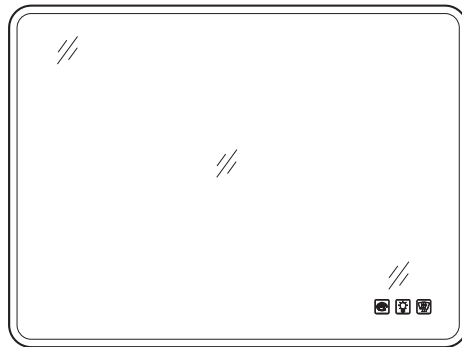
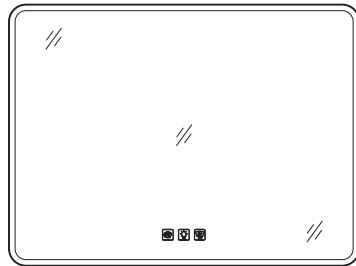

PRODUCT SPECIFICATION

| PARAMETER | SPECIFICATION |
|---------------------|---------------------|
| Color Temperature | 3000K-6000K |
| Input Voltage | AC100-120V |
| Output Voltage | DC 12/24V |
| CRI | ≥90 Ra |
| Working Temperature | -10~45℃ |
| Life Span | 25000 hours |
| Anti-fog | Yes |
| Nema Rate | 3 |
| Wiring Method | Hardwired/Plug in |
| Switch | Touch Sensor Switch |

Installation Instruction

CONTACT US

 **Note:**After opening the package,Please inspect the product immediately for damage in transit or missing parts.If there is any missing,Please contact us or you can contact us at Amazon by following these steps:

- Open "Orders" at Amazon
 - Find the product you have purchased and open the product page
 - Click sold -Click "Ask a question"
 - Click "An order I have placed"
 - Click "Your product" -Click "Other" -Click "Troubleshooting"
- Then you can send us messages,we will reply with 24 hours.

PACKING LIST

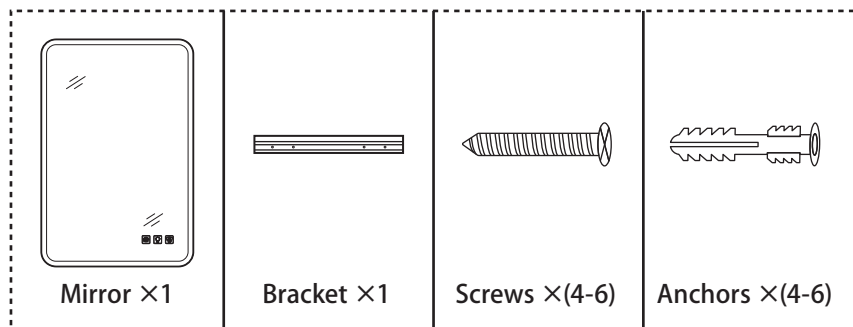

BEFORE INSTALLATION

 **DANGER**Before installation, make sure the main power is cut off.

 **WARNING**Installation must be performed by a qualified licensed electrician.

 **Note:**Thank you very much for using our products,in order to facilitate the use of products,please read this instruction carefully before you begin installation.

IMPORTANT INSTRUCTIONS:

- Please read all instructions carefully before assembling the item.
- This product contains glass parts. Take care while fitting or handling to prevent personal injury or damage to the product; If the glass is broken, please stop using it and replace it from agent or manufacturer.
- Disconnect power before installing,adding or changing any components.
- Ensure the mounting surface is dry and strong enough to bear four times the weight of the product for the safe fitting.
- To connect the wires to electrical junction box,a qualified technician or electrician is highly recommended.
- Special care should be taken when drilling walls to avoid hidden pipes or electrical cables.
- The product covers the outlet box and the wirings after installation.
- Keep the voltages between 100V and 120V .If the voltage exceeds 120V,please use transformer.

FUNCTION :

Please follow the below steps to achieve the functions.

- Switch on/off light by short-touching the button 1 or button 2 .
- Adjusting color temperatures (CCT) between warm white and cool white by long-touching the button 1 .
- Adjusting the brightness (Dimming) by long-touching the button 2 .
- Switch on/off Defogger by short-touching the button 3 .

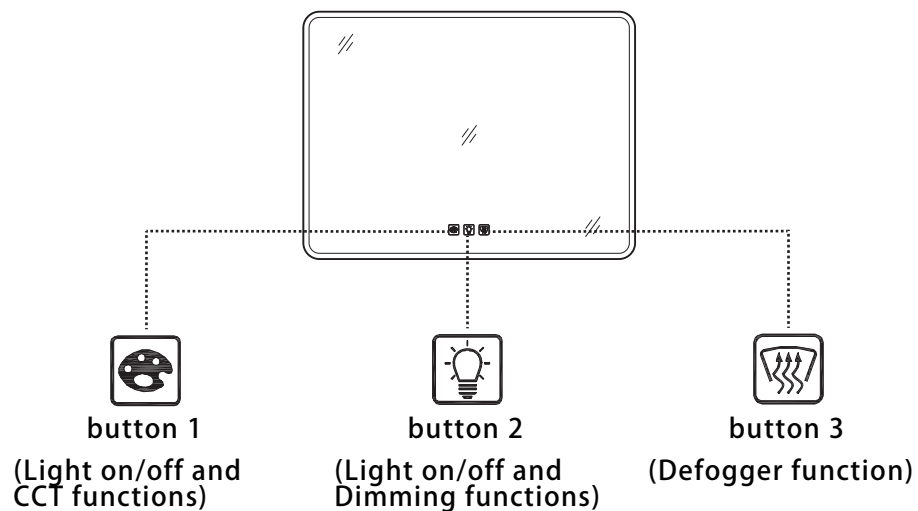

INSTALLATION

INSTALLATION TOOLS

| Description | Parts Image | Description | Parts Image |
|--------------|-------------|------------------------|-------------|
| Tape Measure | | Electric Drill | |
| Spirit Level | | Cross Head Screwdriver | |
| Pencil | | Hammer | |

INSTALLATION STEPS

STEP 1

Before installation, please lift the mirror against the wall, keep an appropriate safety distance from the faucet, confirm the installation position and installation height of the bracket, use a spirit level to level the bracket, and mark the hole position on the wall.

The mirror can be hung horizontally or vertically. You can choose the hanging method according to your preference. Here is the horizontal hanging installation method, the vertical hanging is the same.

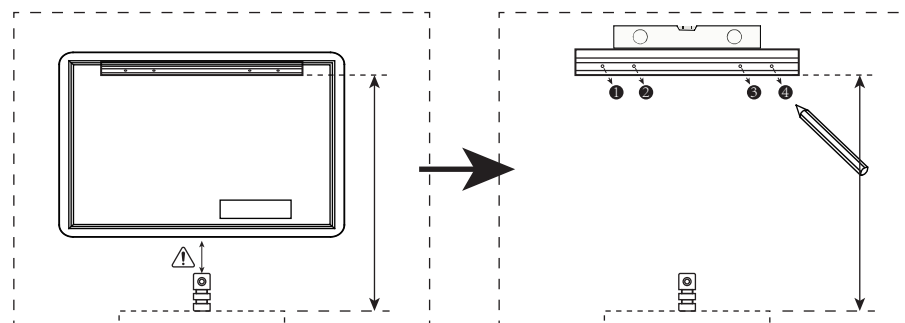

STEP 2

Use an electric drill to punch holes at the marked spots, and then apply wall anchors with hammer.

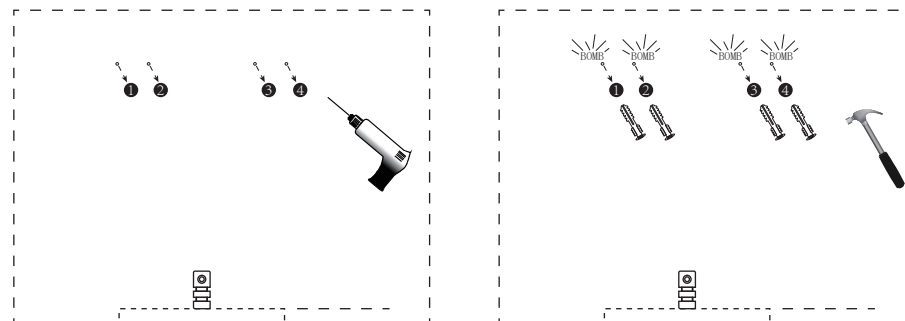

STEP 3

Fasten the bracket to the wall with screws.

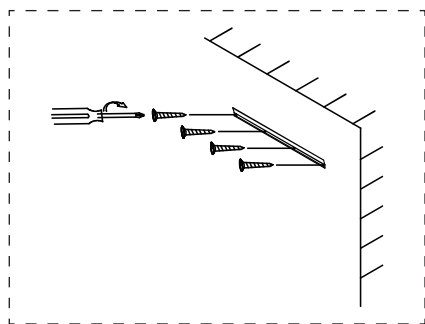

STEP 4

Connect the power. You can use the plug directly or connect the wire to a standard switch lighting circuit.

● Use plug

After hanging the mirror, Plug the AC wire into the receptacle on the wall.

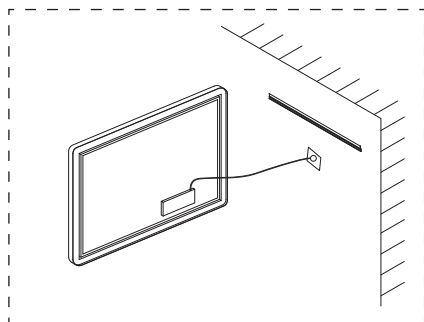
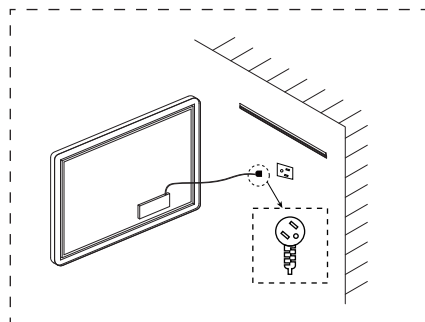

● Installation hardwired

Cut the plug and connect the wires of mirror with the main power by the wire connectors.

⚠ DANGER Before installation, make sure the main power is cut off.

BLACK WIRE---POWER SUPPLY L (LIVE)

WHITE WIRE---POWER SUPPLY N (NEUTRAL)

GREEN WIRE---POWER SUPPLY E (EARTH)

WARNING: This mirror must be earthed.

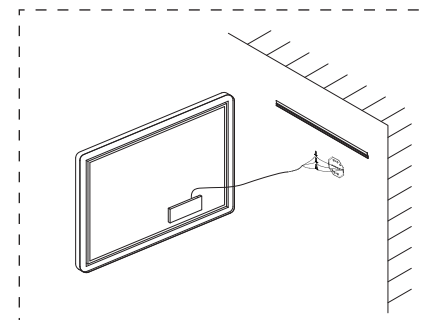
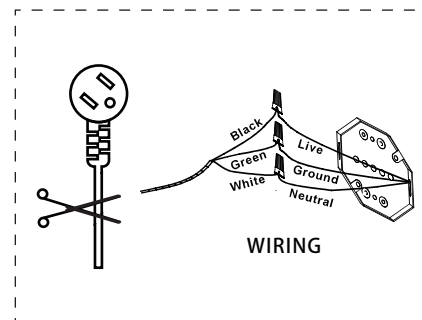

STEP 5

Hang the mirror on the bracket and shake it gently to ensure that the mirror is securely installed.

