



PLEASE READ CAUTIONS

1. In rare instances, some rubber products may stain the tile's surface. Test by placing a single tile under rubber tires, chair bottoms, coasters etc. for 48 hours prior to installation.
2. Check all cartons to ensure they are the **same batch code**. Color variations may occur between batches.
3. Most chemicals will not stain. Pet urine may cause tile to yellow. Remove chemical spills as soon as possible. Petroleum products may cause tile to deteriorate if left unattended.
4. Remove the tiles from the cartons and spread them out on the floor where they can acclimate to room temperature 24 hours prior to installation. Failure to acclimate may cause tiles to buckle.
5. Tile will need to slide across sub-floor as it expands, if laying tile on a rough surfaces like plywood or rough concrete an underlay of .03mm (or thicker) plastic will allow the tile to slide as it expands.
6. Be sure to leave a 1/4" expansion gap around all edges in wall-to-wall installations.
7. Most non-slip vinyl wax or sealer will add to the ease of cleaning. We recommend Seal 365. Always test waxes or sealer before applying.
8. Warranty does not cover dirt or staining when used in garages, areas exposed to dyes, petroleum products, or similar applications. Seal 365 may be used over tile to prevent soiling and staining.
9. Never use bleach to clean tiles. Bleach will discolor vinyl tile. For cleaning or sterilizing, use .3oz of Clean 365.
10. This tile is for Interior Use Only and must be installed between 60°F and 90°F temperatures.
11. Temperature changes of 40°F or more may cause the tile to buckle in areas not climate controlled.

Interlocking Flexi-Tile

~ *Lifetime Residential Warranty ~ 12 Year Commercial Warranty ~*

www.PerfectionFloorTile.com/warranty-activation or fill out and return enclosed warranty card

Your purchase of the world's finest floating vinyl floor comes with the following warranty. It is written to validate your decision to select Luxury Vinyl Floor Tiles from the many choices available. This warranty will provide a lifetime of peace of mind and confidence that your new floor will provide years of outstanding service. "Lifetime" is defined as the length of time the original installation of the floor resides in the dwelling where the floor is installed. "Residential" is defined as a private purchaser single family dwelling or residence, not used for commercial purposes. Warranty is nontransferable.

Guarantee that:

1. This floor will not wear through from normal household foot traffic.
2. Tiles will be free of factory defects.
3. The tile will not permanently indent from normal household use.
4. The tile will not tear; the use of floor protectors are recommended.
5. The tile will lay flat without buckling or warping under normal household conditions.

If you have warranty questions or concerns, contact
assistance@matsinc.com or call
1-800-628-7462 ext 521

Exclusions:

1. The tiles must be visually inspected prior to installation. If a defect is detected, please contact the manufacturer.
2. All installation instructions must be followed as detailed on the Installation Instruction Sheet.
3. Damage caused by natural disasters, including but not limited to earthquakes, hurricanes, etc. is not covered by this warranty.
4. We will not reimburse labor cost for initial installation or re-installation if the installation was done by the homeowner or unlicensed contractor.
5. We may reimburse labor cost for a defective floor if installed by a licensed contractor and homeowner can provide bona fide cost documentation.
6. All reimbursements are subject to prior approval by management and verification of purchase, physical inspection of the floor by our representative, and/or digital pictures submitted by the purchaser.
7. Staining, warranty does not cover tiles without application of Seal 365.

TOOLS NEEDED:

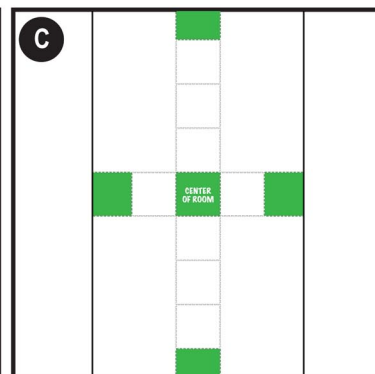
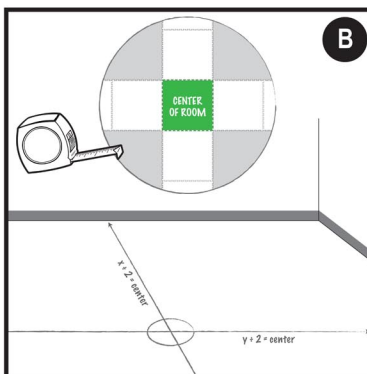
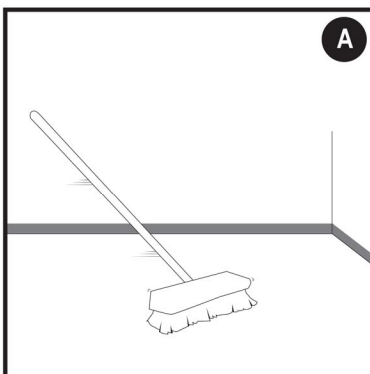

Your new Flexi-Tile Interlocking floor tile is easy to cut and lay, giving you endless possibilities to create an interior with your own personal touch. Flexi-Tile Interlocking tile should be acclimatized to and installed in similar conditions to those that prevail during normal occupancy of the room for 24 hours. In case there are extreme variances in temperature, Exterior applications, direct sun light and/or heavy weight may be rolled across the floor, Flexi-Tile Interlocking tile will require a glue down application. We recommend using a suitable vinyl adhesive. The sub-floor: Flexi-Tile Interlocking tile can be installed onto any floor that is clean, level and firm (A).

You will need:

- A sharp, heavy duty utility knife
- Straight edge
- Rubber Mallet
- Cutting board
- Pencil or Chalk Marker
- Tape Measure

Planning the installation: Measure the length and width of the room and divide the dimensions in two. Locate and mark the center of the room (B). This is the approximate starting point for the installation. Check the number of full tiles and the width of part tiles required to reach the walls in each direction. It is desirable that any part tiles are at least half a full tile in width and that rows of part tiles at opposite sides of the room should be of similar width as this results in a better looking installation (C). Adjust the start point by a half tile length if necessary to achieve this. Draw or chalk line at the start point parallel to the longest dimension. This is to act as a guide for keeping tiles parallel to the walls. To ensure the line is parallel to the walls, measure out from the wall near each end of the room, mark the points on the floor and draw or chalk line between the points. Installing tiles outwards from the center of the room will ensure any rows of part tiles at the sides of the room are of equal width (D).

Installation: Begin installation in the center of the room and work uniformly outwards toward the walls. Use the chalk lines to ensure tiles are straight (E). The tiles are designed to fit tightly together. Use a rubber mallet to tap tiles into position then push the sides together to insure a seamless appearance. On reaching the walls, cut the edge tiles to leave a $\frac{1}{4}$ " wide gap between tiles and wall. This allows for any slight expansion or contraction due to minor temperature changes. Measure between the last row of full tiles and the wall and deduct $\frac{1}{4}$ " to allow for your expansion gap. Mark the tiles and cut to size (G).

Note on cutting: Cutting should be done with a utility knife equipped with a sharp blade. A good non-slip straightedge should be used. It is better to make several light cuts than one heavy cut. Always carefully cut the tile away from your body, using a cutting board to prevent damage.

Doorways: In doorways, a threshold strip can be used if tiles are to meet a different flooring covering. If the tiles are to continue through the doorway, no threshold strip is required but the tiles in the doorway should be adhered with recommended adhesive suitable for use with vinyl or double face tape.

Edging: To create a mat area, interlocking keys can be trimmed with a sharp knife to create the mat area leaving a round edge or use Flexi-Tile Interlocking corners and edges.

Cleaning and Maintenance: Vinyl floors generally only require warm water when cleaning. We do not recommend using a detergent on vinyl floors because it leaves a sticky residue and does not rinse clean, making it more difficult to keep clean. Use a gallon of water and a cup of white vinegar solution which is residue free. If you find your vinyl floor requires a deeper cleaning, you can use any non-citrus cleaner. Rinse thoroughly to avoid sticky build up. Please see website for additional hints under About Us/Installation & Information, or call 1-877-363-7831 for toll-free technical assistance.

