

# ASSEMBLY INSTRUCTION

ITEM: N715P237377

## DINING CHAIR

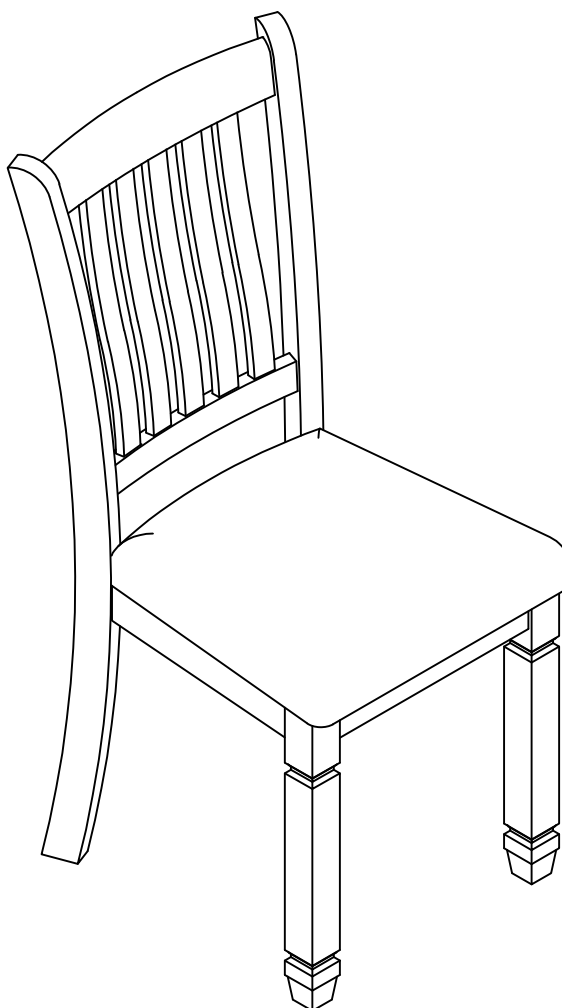

## IMPORTANT NOTE :

Please read these INSTRUCTION fully before starting assembly:

1. Place all wooden parts on a clean and smooth surface such as a rug or carpet to avoid scratching the parts.
2. Kindly follow the assembly INSTRUCTION step by step.
3. Do not tighten all screws and bolts until the table is fully assembled.
4. Unscrew the protective plastique supports from the metal insert of the table legs before assembly.
5. Parts of the assembly will be easier with 2 people.

Care and maintenance:

Only clean using a damp cloth and mild detergent, do no use bleach or abrasive cleaners.

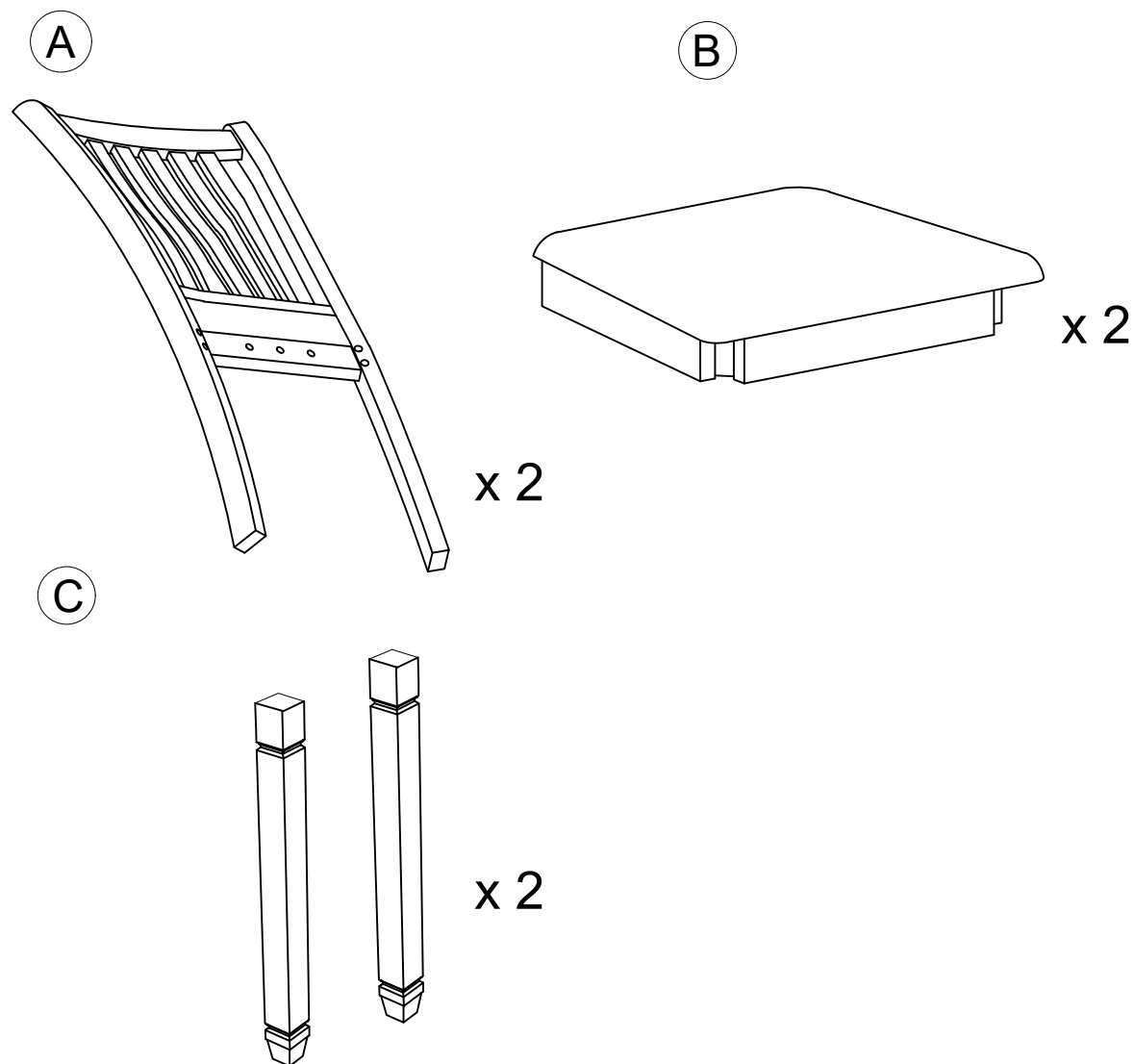

## PART AND HARDWARE LIST

### Part List For Two

①

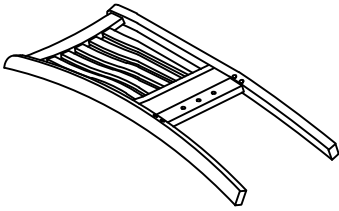

CHAIR BACK (2 pcs)

②

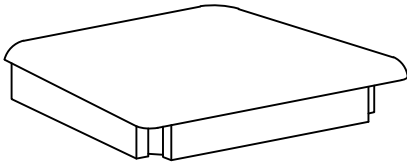

SEAT (2 pcs)

③

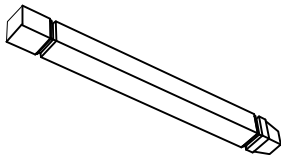

FRONT LEGS (4 pcs)

### Hardware List For Two

①

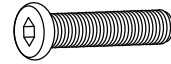

Ø1/4" x 38 mm

BOLT (4 pcs)

②

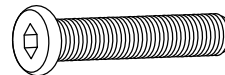

Ø1/4" x 60mm

BOLT (8 pcs)

③

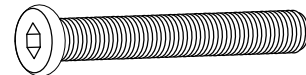

Ø1/4" x 75mm

BOLT (8 pcs)

④

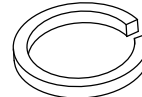

Ø1/4" x 13mm

SPRING WASHER (20 pcs)

⑤

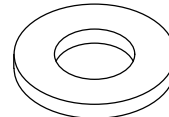

Ø1/4" x 19mm

FLAT WASHER (20 pcs)

⑥



M4 x 60mm

ALLEN WRENCH (2 pcs)

# ASSEMBLY INSTRUCTION



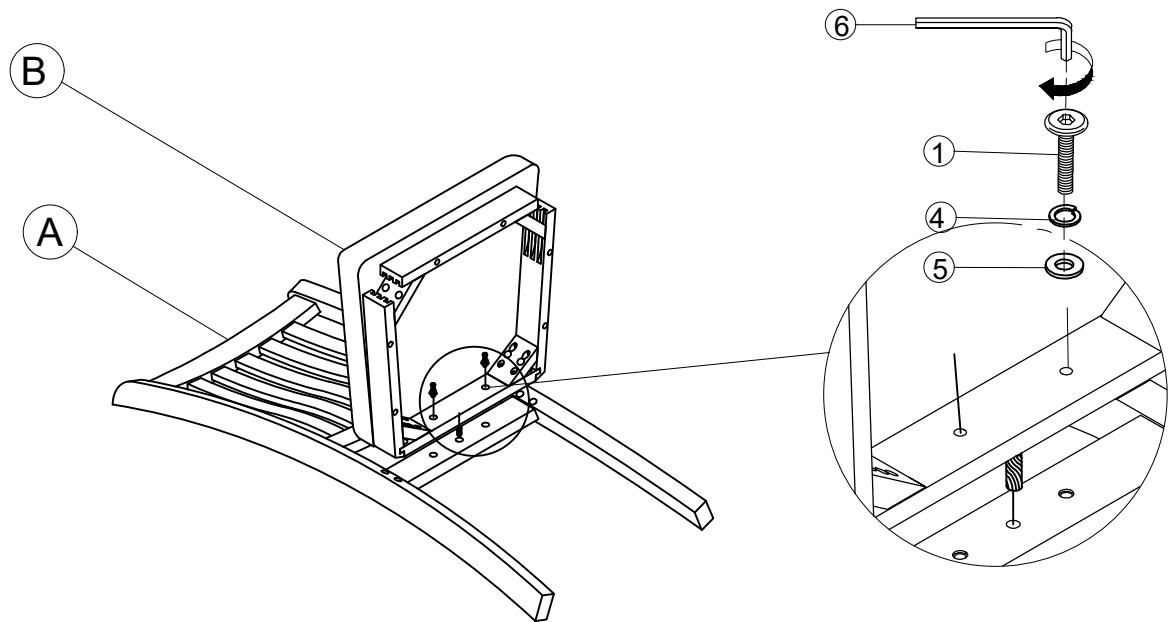

ITEM: N715P237377

## STEP 1:

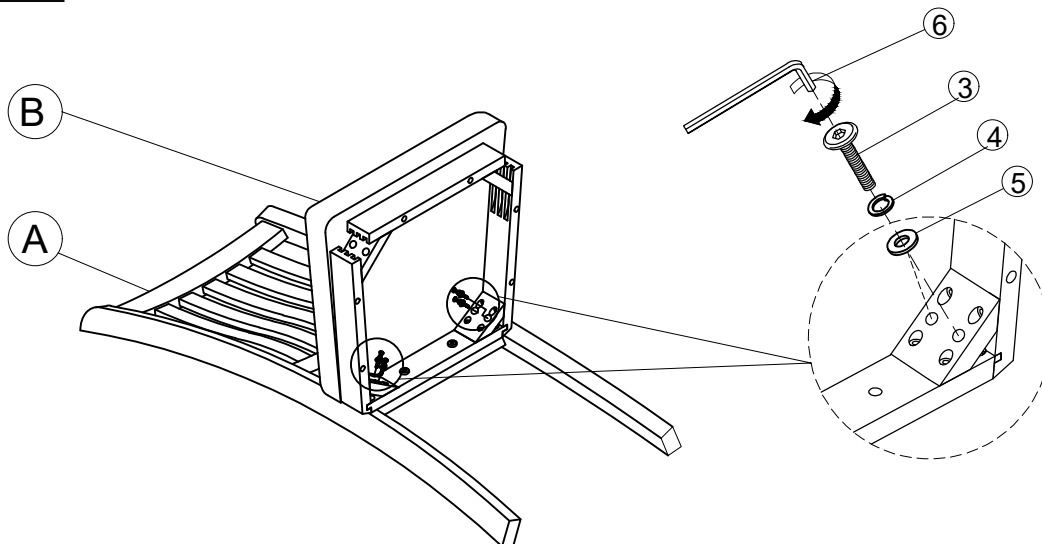

## STEP 2:



Bolts 1/4" x 38mm	Bolts 1/4" x 75mm	Spring Washer 1/4" x 13mm	Flat Washer 1/4" x 19mm	Allen Wrench M4 x 60mm
				
① x 4	③ x 8	④ x 12	⑤ x 12	⑥ x 2
MADE IN VIETNAM				PAGE 4 OF 5

# ASSEMBLY INSTRUCTION

ITEM: N715P237377

## STEP 3:

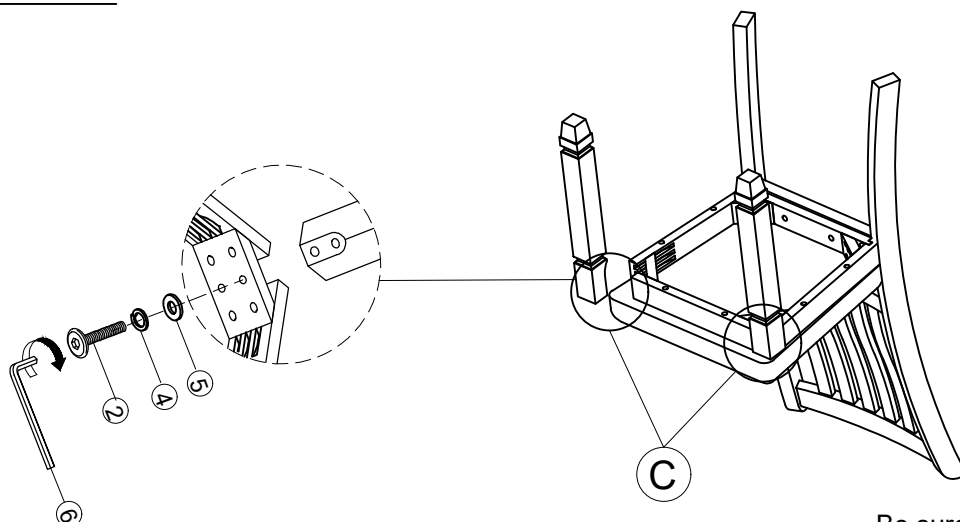

Be sure the legs are level  
then fully tighten the leg bolts!

Bolts 1/4" x 60mm	Spring Washer 1/4" x 13mm	Flat Washer 1/4" x 19mm	Allen Wrench M4 x 60mm
② x 8	④ x 8	⑤ x 8	⑥ x 2

## COMPLETE

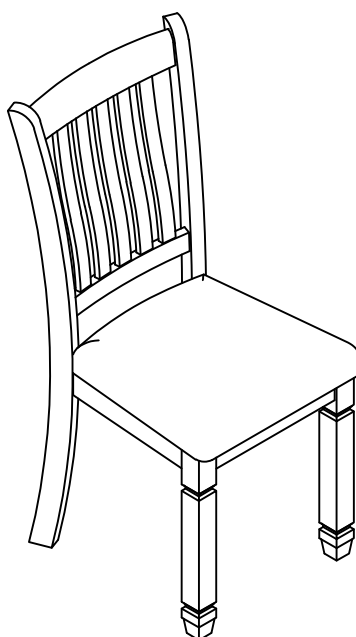

# ASSEMBLY INSTRUCTION

ITEM: N715P237378

## DINING CHAIR

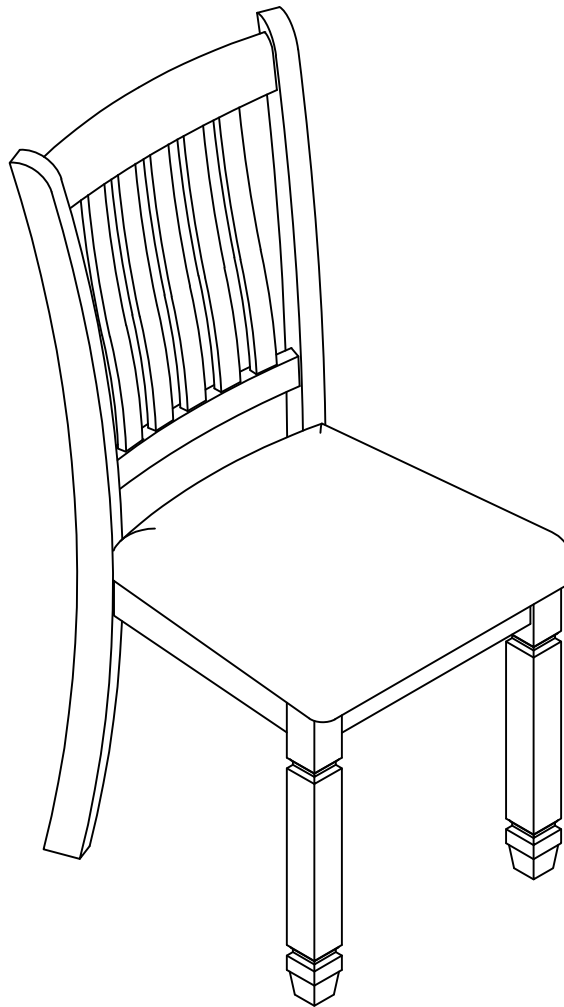

## IMPORTANT NOTE :

Please read these INSTRUCTION fully before starting assembly:

1. Place all wooden parts on a clean and smooth surface such as a rug or carpet to avoid scratching the parts.
2. Kindly follow the assembly INSTRUCTION step by step.
3. Do not tighten all screws and bolts until the table is fully assembled.
4. Unscrew the protective plastique supports from the metal insert of the table legs before assembly.
5. Parts of the assembly will be easier with 2 people.

Care and maintenance:

Only clean using a damp cloth and mild detergent, do no use bleach or abrasive cleaners.

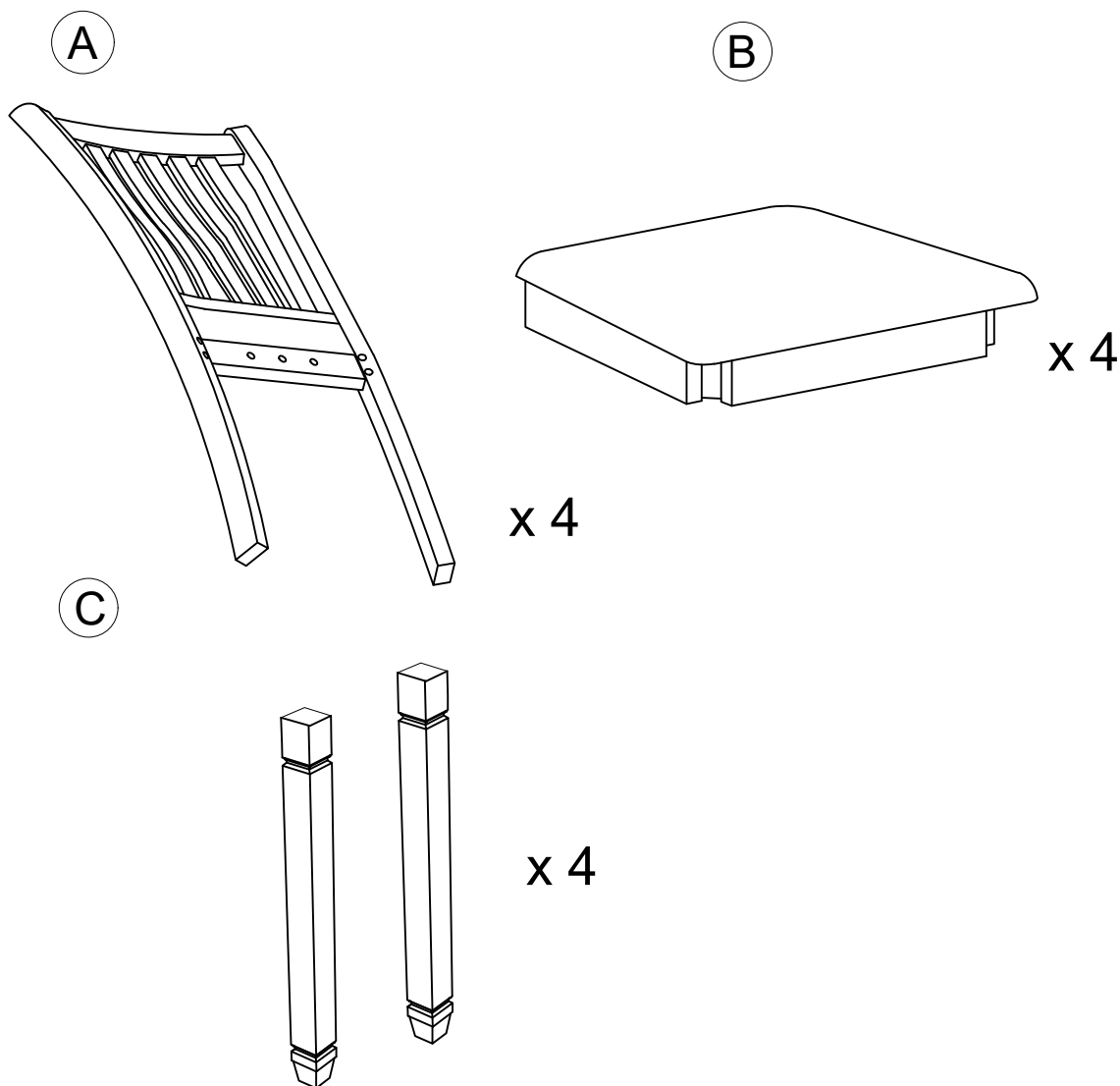

## PART AND HARDWARE LIST

### Part List For Two

① A

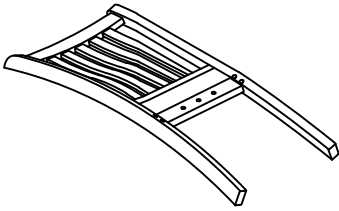

CHAIR BACK (4 pcs)

② B

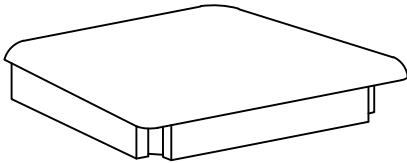

SEAT (4 pcs)

③ C

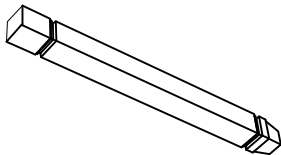

FRONT LEGS (8 pcs)

### Hardware List For Two

①

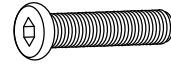

Ø1/4" x 38 mm

BOLT (8 pcs)

②

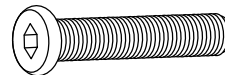

Ø1/4" x 60mm

BOLT (16 pcs)

③

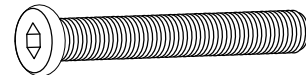

Ø1/4" x 75mm

BOLT (16 pcs)

④

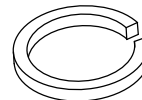

Ø1/4" x 13mm

SPRING WASHER (40 pcs)

⑤

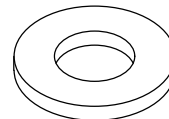

Ø1/4" x 19mm

FLAT WASHER (40 pcs)

⑥

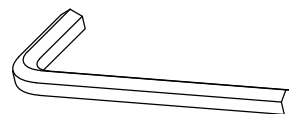

M4 x 60mm

ALLEN WRENCH (4 pcs)



# ASSEMBLY INSTRUCTION



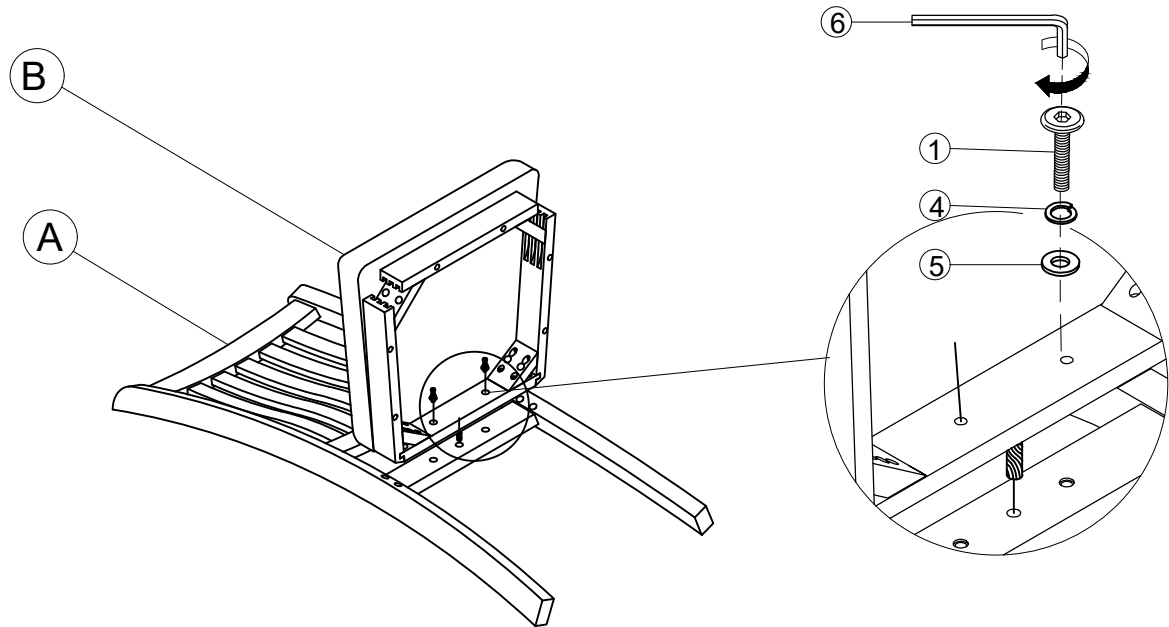

ITEM: N715P237378

## STEP 1:

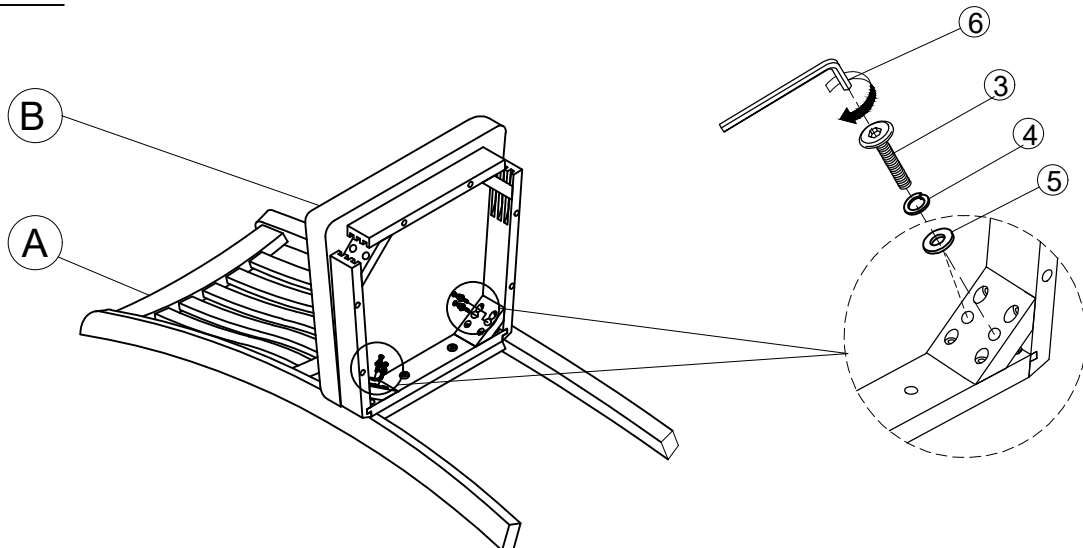

## STEP 2:



Bolts 1/4" x 38mm	Bolts 1/4" x 75mm	Spring Washer 1/4" x 13mm	Flat Washer 1/4" x 19mm	Allen Wrench M4 x 60mm
				
① x 8	③ x 16	④ x 24	⑤ x 24	⑥ x 4
MADE IN VIETNAM				PAGE 4 OF 5

# ASSEMBLY INSTRUCTION

ITEM: N715P237378

## STEP 3:

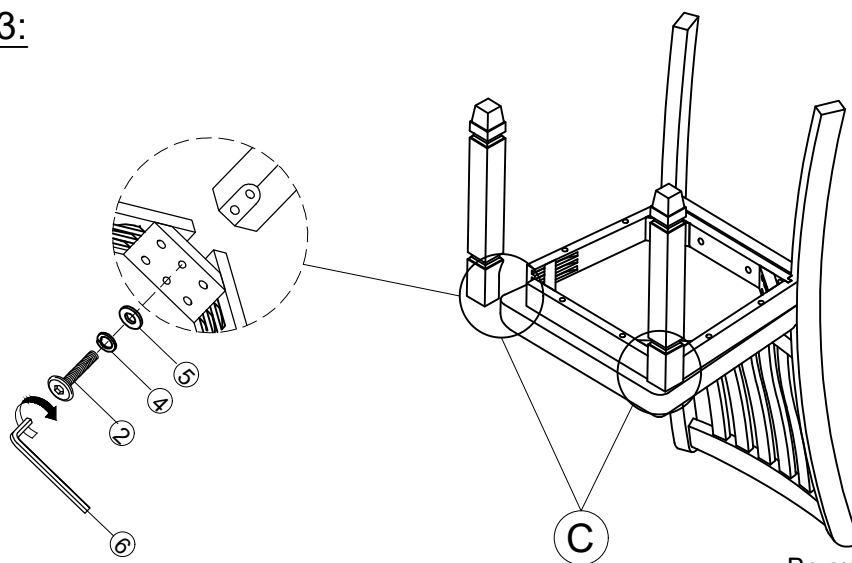

Be sure the legs are level  
then fully tighten the leg bolts!

Bolts 1/4" x 60mm	Spring Washer 1/4" x 13mm	Flat Washer 1/4" x 19mm	Allen Wrench M4 x 60mm
(2) x 16	(4) x 16	(5) x 16	(6) x 4

## COMPLETE

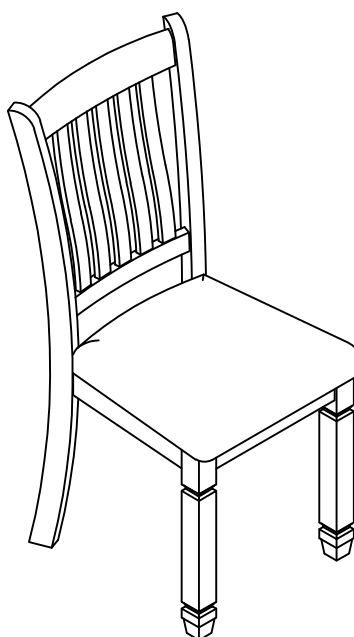

# ASSEMBLY INSTRUCTION

ITEM: N715P237376

## DINING TABLE

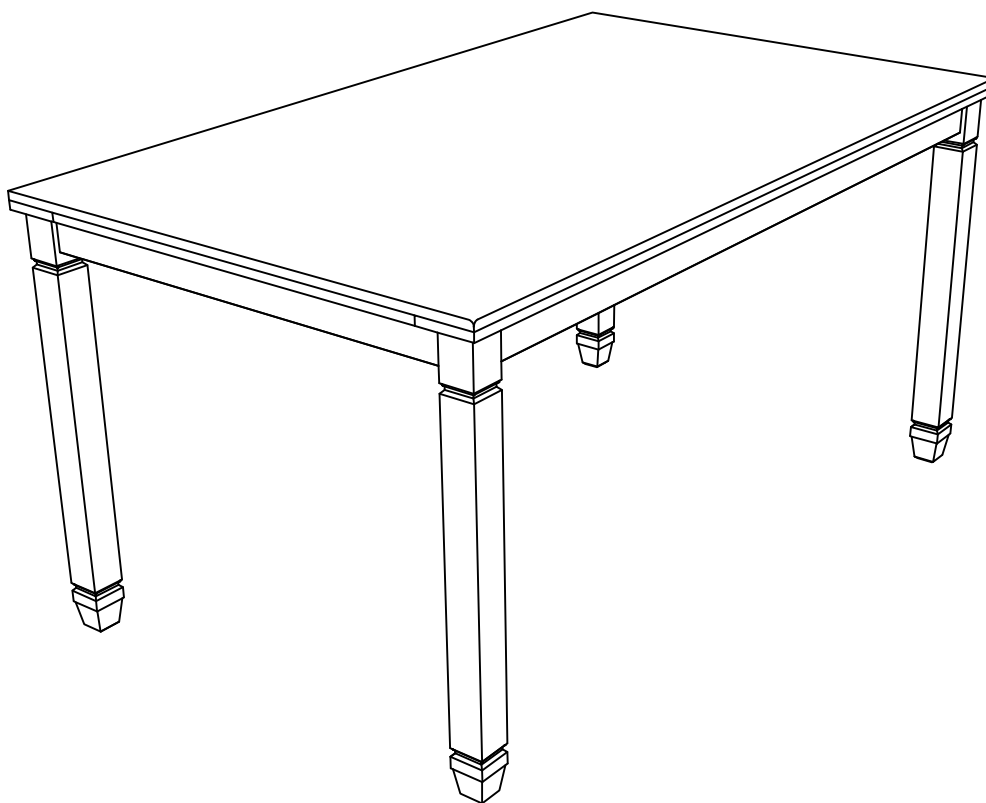

## IMPORTANT NOTE :

Please read these INSTRUCTION fully before starting assembly:

1. Place all wooden parts on a clean and smooth surface such as a rug or carpet to avoid scratching the parts.
2. Kindly follow the assembly INSTRUCTION step by step.
3. Do not tighten all screws and bolts until the table is fully assembled.
4. Unscrew the protective plastique supports from the metal insert of the table legs before assembly.
5. Parts of the assembly will be easier with 2 people.

Care and maintenance:

Only clean using a damp cloth and mild detergent, do no use bleach or abrasive cleaners.

A

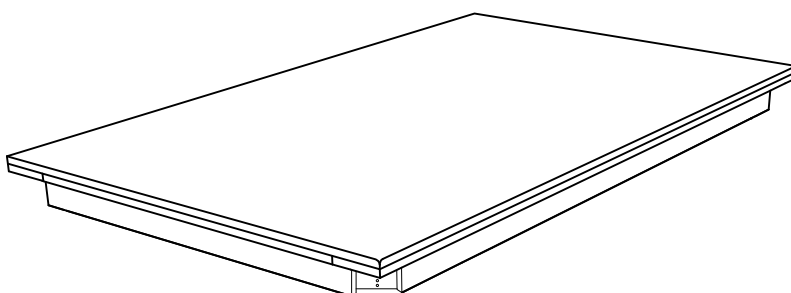

B

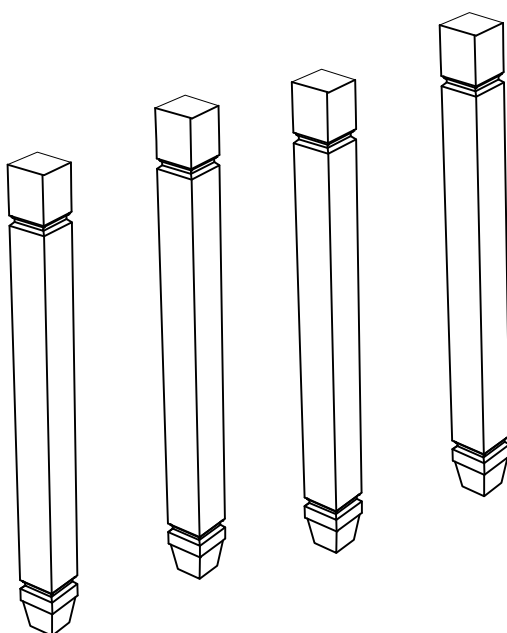

## PART AND HARDWARE LIST

### Part List For One

Ⓐ

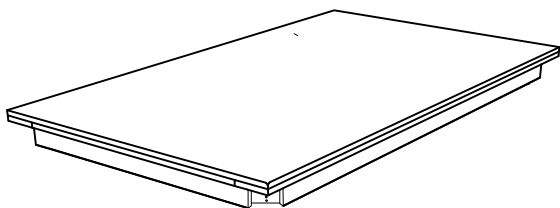
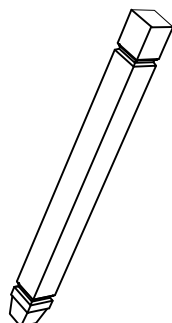

TABLE TOP (1 pc)

Ⓑ



LEG (4 pcs)

### Hardware List For One

①

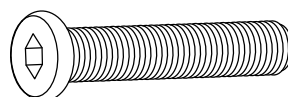

Ø5/16" x 60mm

BOLT (8 pcs)

②

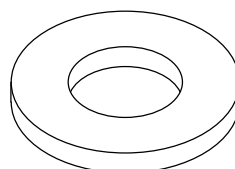

Ø5/16" x 19mm

FLAT WASHER (8 pcs)

③

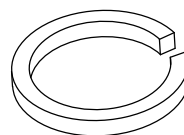

Ø5/16" x 13mm

SPRING WASHER (8 pcs)

④

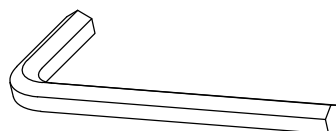

M4 x 60mm

ALLEN WRENCH (1 pc)

# ASSEMBLY INSTRUCTION

ITEM: N715P237376

## STEP 1:

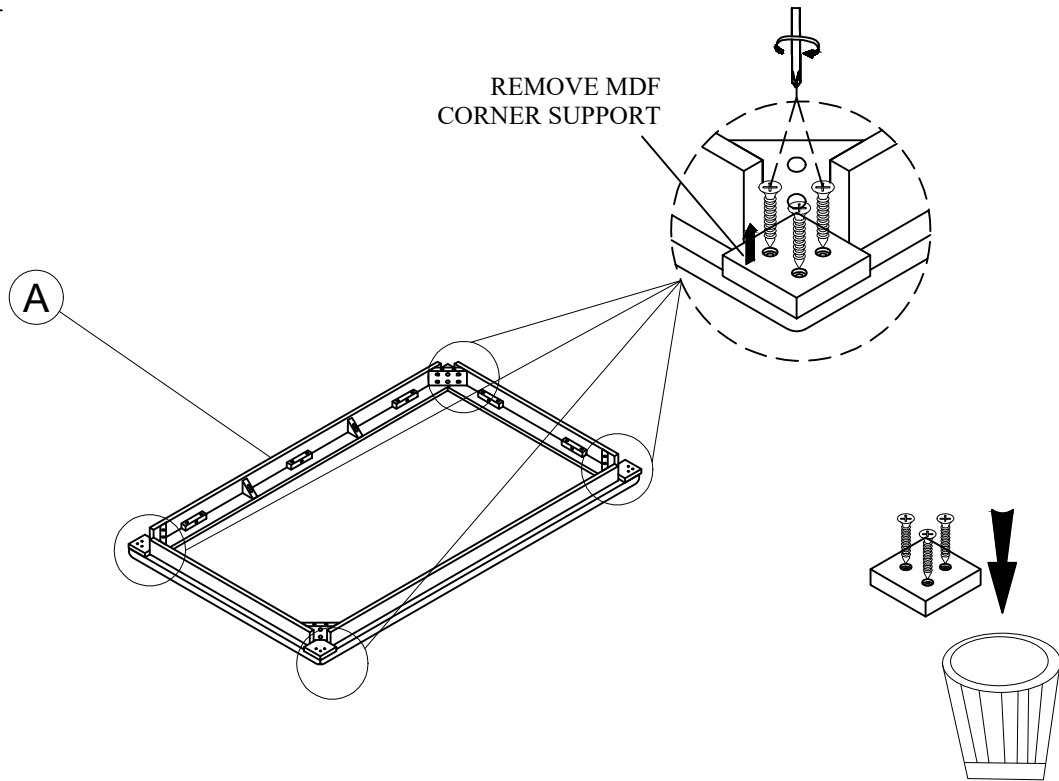

## STEP 2:

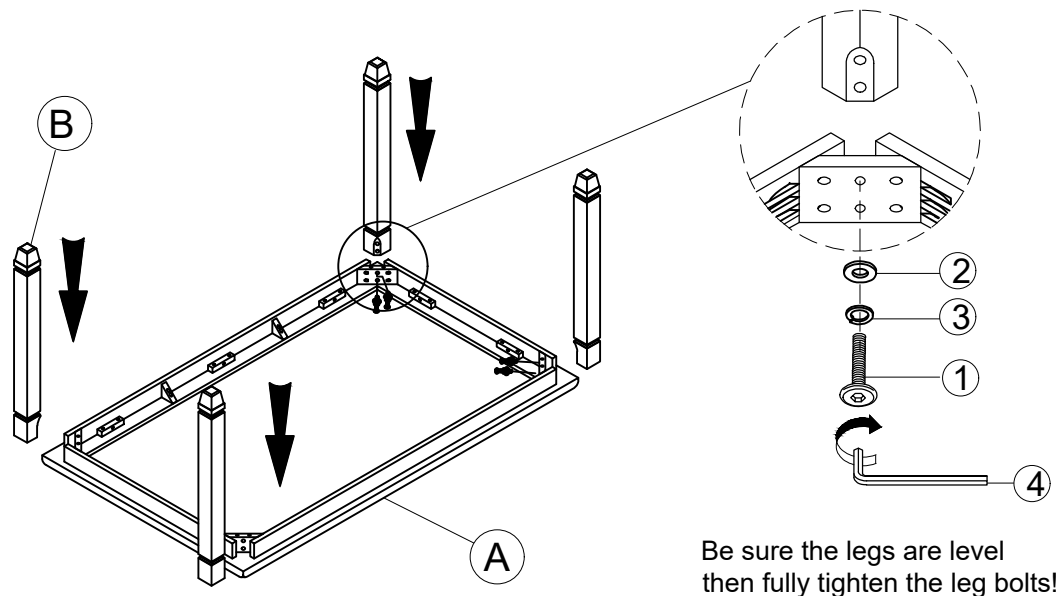

Bolts  
5/16" x 60mm

Flat Washer  
5/16" x 19mm

Spring Washer  
5/16" x 13mm

Allen Wrench  
M4 x 60mm



① x 8



② x 8



③ x 8



④ x 1

MADE IN VIETNAM

PAGE 4 OF 5

# ASSEMBLY INSTRUCTION

ITEM: N715P237376

COMPLETE

