

D-Code Double furniture washbasin & # 03481200002 / 03481200302

< 47 1/4" Inch >

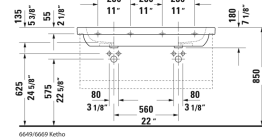
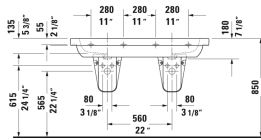
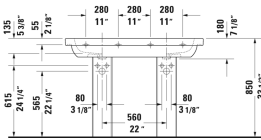
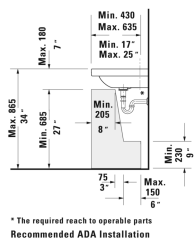
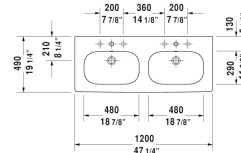
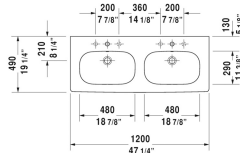

* The required reach to operable parts
Recommended ADA Installation

Double furniture washbasin	Dimension	Weight	Order number
with overflow, with faucet deck, underside fully glazed, hardware included, wall-mounted, 47 1/4" Inch			
Colors			
00 White			
Variant			
●	47 1/4" x 18 7/8" Inch	79.6 lb	03481200002
●●●	47 1/4" x 18 7/8" Inch	79.6 lb	03481200302
Infobox			
When installing ceramics larger than 47 1/4", 2 sets of basin hardware # 6951000000 are required, Washbasin is not ADA compliant in combination with pedestal, siphon cover or metal console			
Towel rail square tube 1/2", Chrome	45 1/4" Inch	1.8 lb	003033
Space-saving siphon	1 1/4" Inch	0.9 lb	005076
Suitable products			
Siphon cover for # 231065, 231060, 231055, 034265, 034285, 034210, 034812,			085718
Pedestal for # 231065, 231060, 231055, 034265, 034285, 034210, 034812,			086327
Vanity unit wall-mounted 1 pull-out compartment, for D-Code # 034812, 45 1/4" x 17 7/8" Inch	45 1/4" x 17 7/8" Inch		KT6669

**D-Code Double furniture washbasin & # 03481200002 /
03481200302**

|< 47 1/4" Inch >|

Vanity unit wall-mounted 2 drawers, upper drawer including
cut-out for siphon and siphon cover, for D-Code # 034812, 45 1/4" x 17 7/8" Inch

KT6649

All drawings contain the necessary measurements which are subject to standard tolerances. They are stated in inch & mm and are non-binding. Exact measurements, in particular for customized installation scenarios, can only be taken from the finished ceramic piece.