

# 88 5543 182 Bermuda Pedestal Desk

## IMPORTANT NOTE

Carefully remove all the parts from the carton and put them individually on a soft cloth to prevent scratches or other damage occurring to the parts.

We have taken great care in the design of this product and request that you carefully and strictly follow our assembly instructions to ensure a completed product as it was designed.

Home  
Styles



## Part List

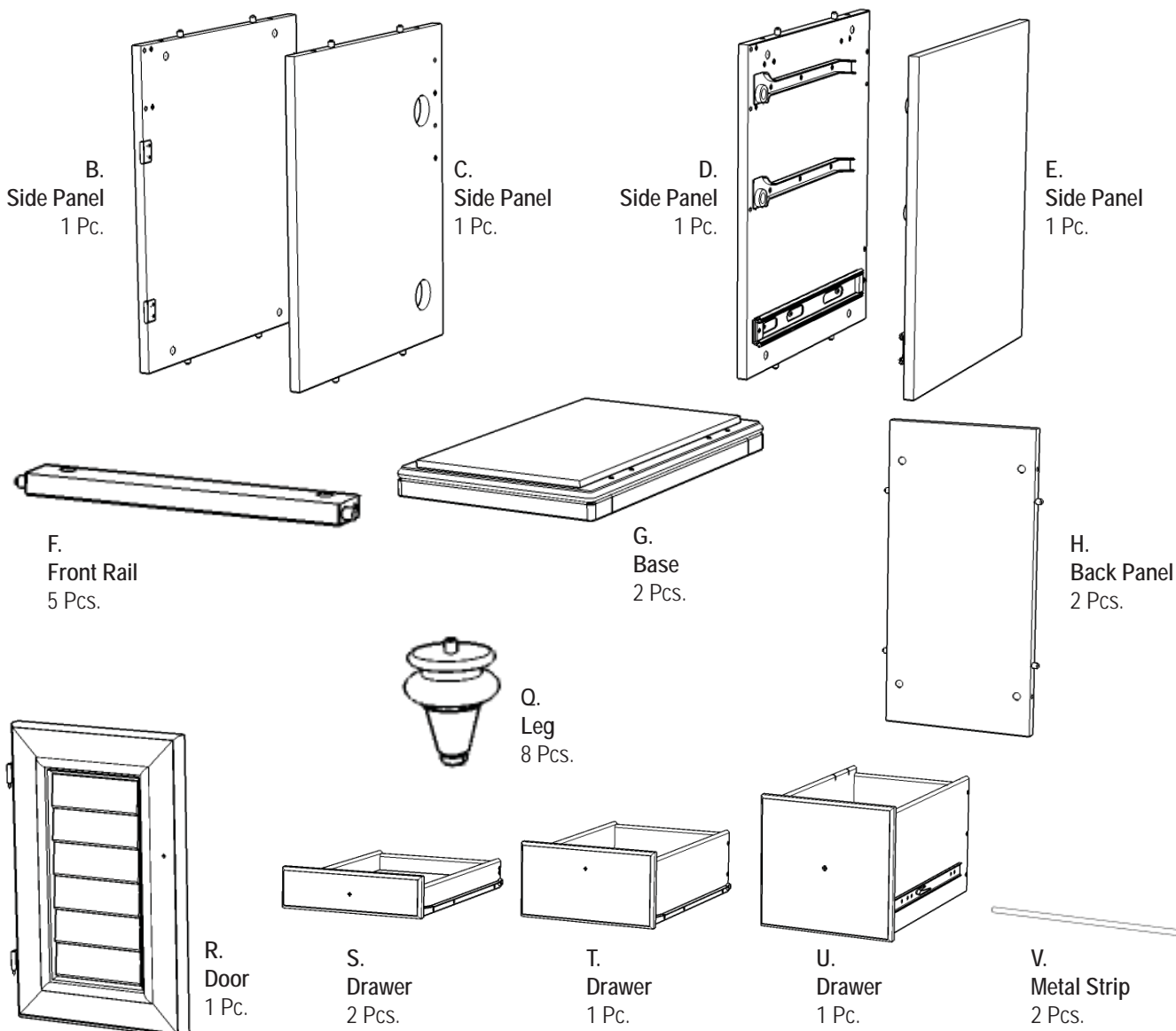

(Knock-Down Construction, please refer to the last page of these instructions for drawers assembly steps.)

Also need the Parts and Hardware in carton 88 5542 181

Tools required for assembly : Phillips screwdriver

Tools recommended for assembly : Level

Home Styles Consumer Assistance: [www.homestyles-furniture.com](http://www.homestyles-furniture.com),  
servicedesk@homestyles-furniture.com, 888-680-7460, 877-831-0319

## IMPORTANT

- \* Please keep Hex Wrench in a safe place as you may need to tighten up the Head Cap Bolts in the future.
- \* Do not tighten up all the screws until each part is properly assembled.
- \* Use a soft cloth between these parts and the floor.
- \* After assembly, item must be level to work properly.  
Use the included adjustable levelers to level.

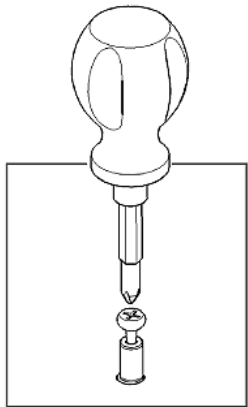

Figure 1

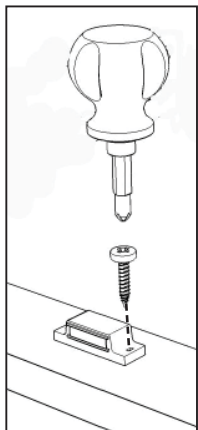
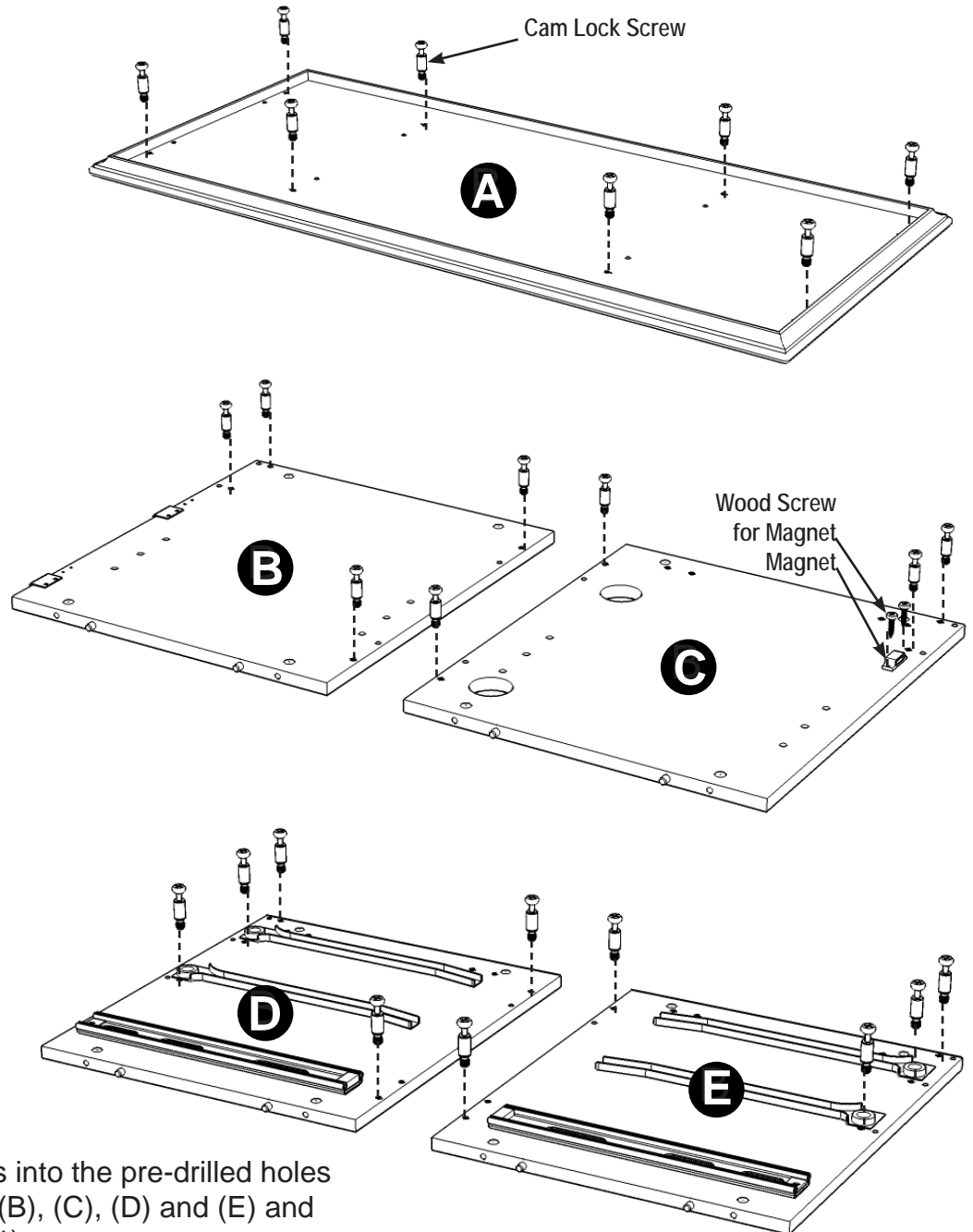

Figure 2



## STEP 1

Insert Cam Lock Screws into the pre-drilled holes of Top (A), Side Panels (B), (C), (D) and (E) and Bases (G). (see Figure 1)

Attach Magnet to Side Panel (C) with Wood Screws for Magnet into the pre-drilled holes. (see Figure 2)

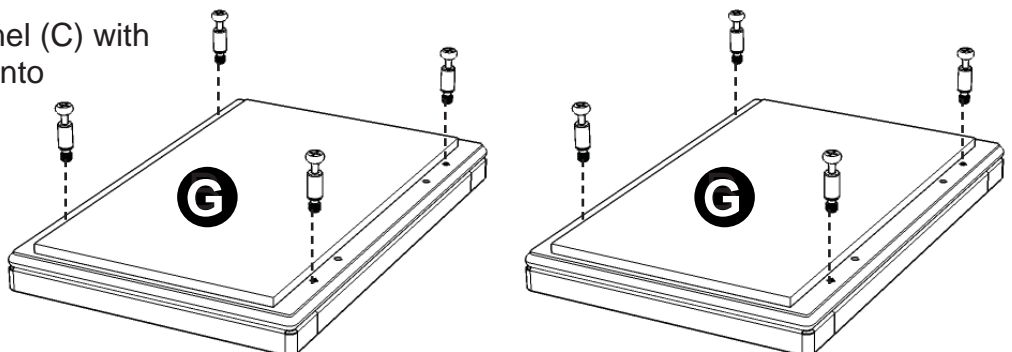

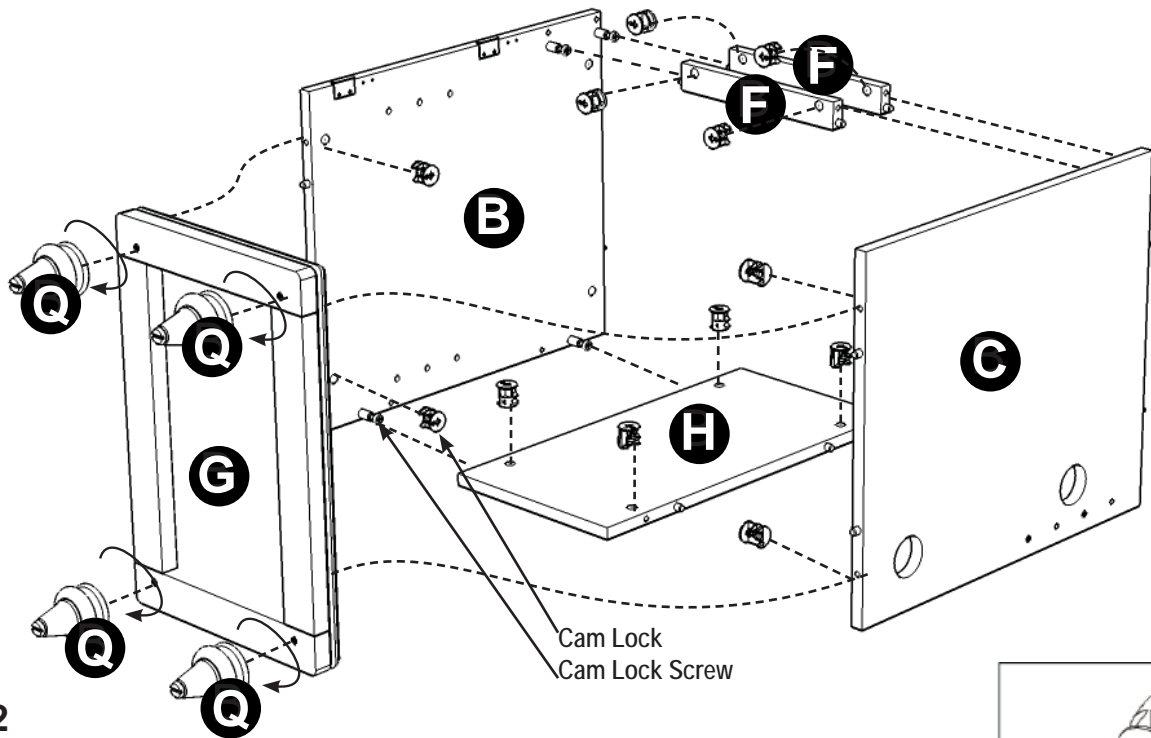

## STEP 2

Attach Front Rails (F), Back Panel (H) and Base (G) to Side Panel (B) with Cam Locks. (see Figure 3)

Attach Side Panel (C) to unit with Cam Locks.

Attach Legs (Q) to Base (G).

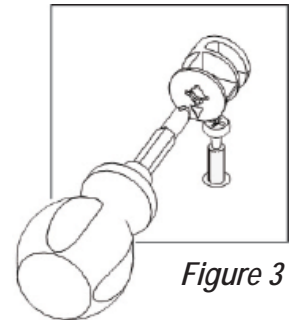
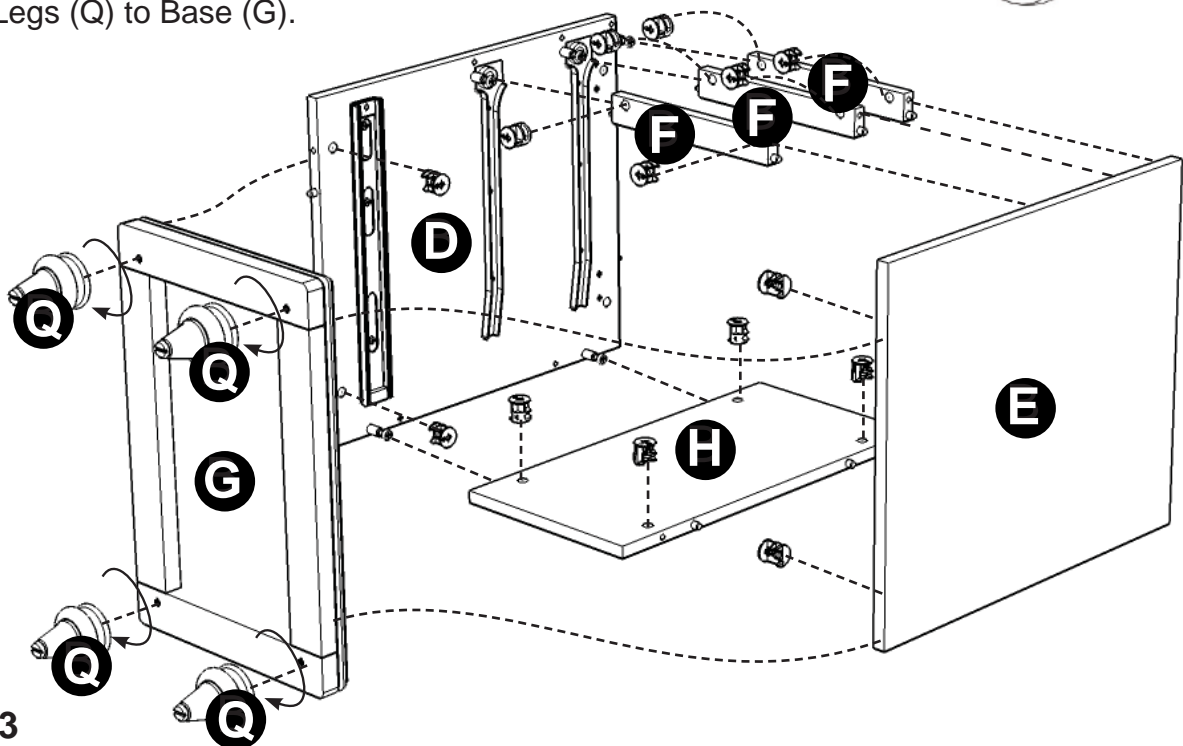

Figure 3



## STEP 3

Attach Front Rails (F), Back Panel (H) and Base (G) to Side Panel (D) with Cam Locks.

Attach Side Panel (E) to unit with Cam Locks.

Attach Legs (Q) to Base (G).

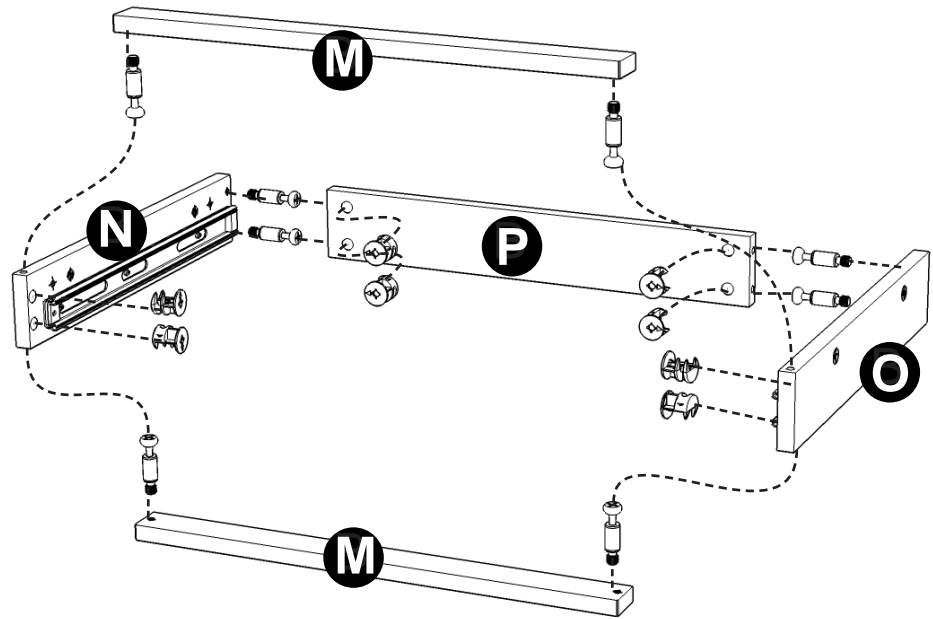

## STEP 4

Insert Cam Lock Screws into the pre-drilled holes of Keyboard Supports (N) and (O).

Attach Keyboard Supports (N) and (O) to Keyboard Support (P) with Cam Locks.

Attach Keyboard Rails (M) to unit with Cam Lock Screws and Cam Locks.

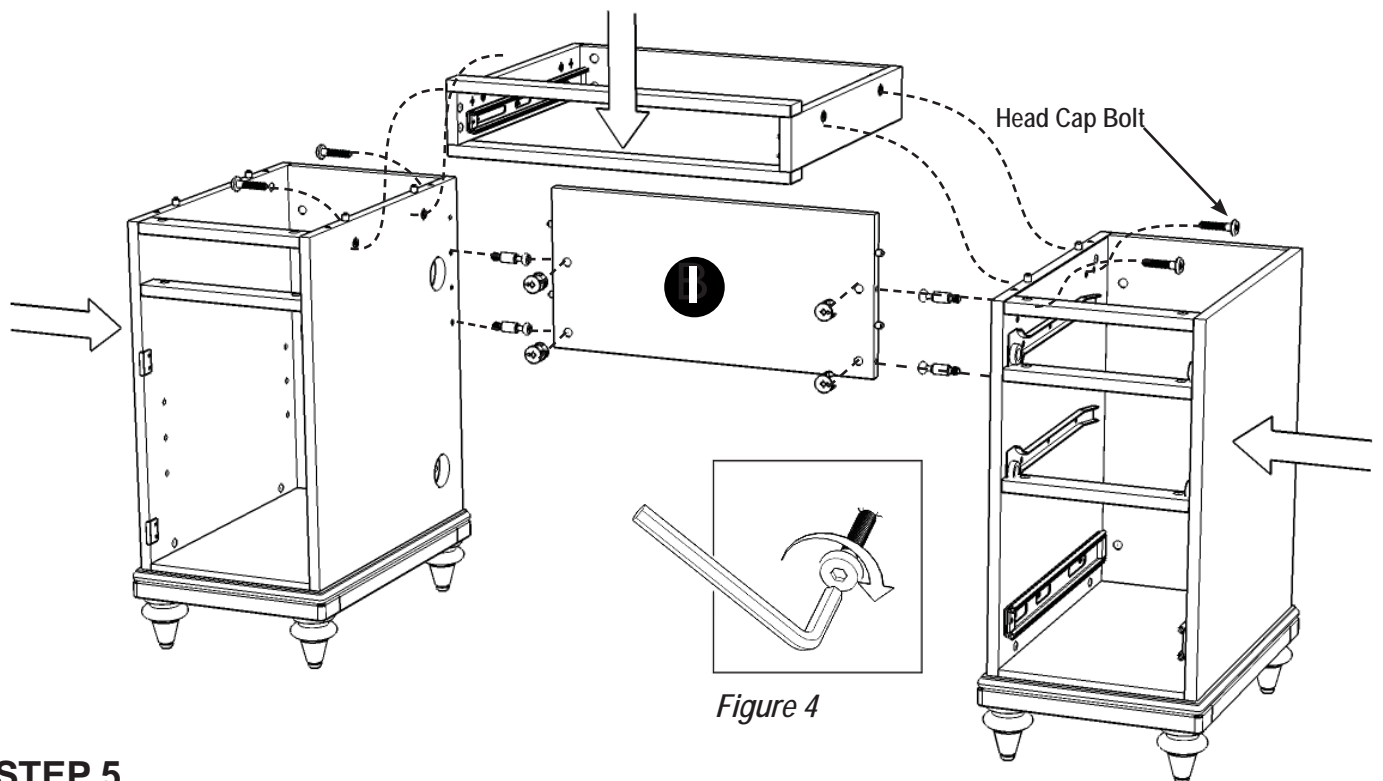

## STEP 5

Attach Back Panel (I) and unit from Step 4 to unit from Step 2 with Cam Lock Screws, Cam Locks and Head Cap Bolts. (see Figure 4)

Attach unit from Step 3 to unit with Cam Lock Screws, Cam Locks and Head Cap Bolts.

## STEP 6

Attach Top (A) to unit with Cam Locks.

Attach Keyboard Front (K) to Keyboard (L) with Wood Screws for hinge. (see Figure 5)

Slide keyboard into position.

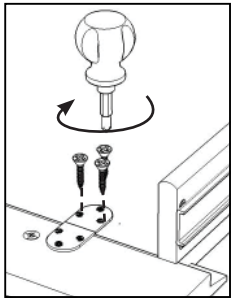

Figure 5

Wood Screw for hinge

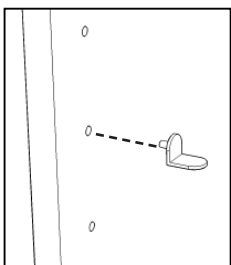
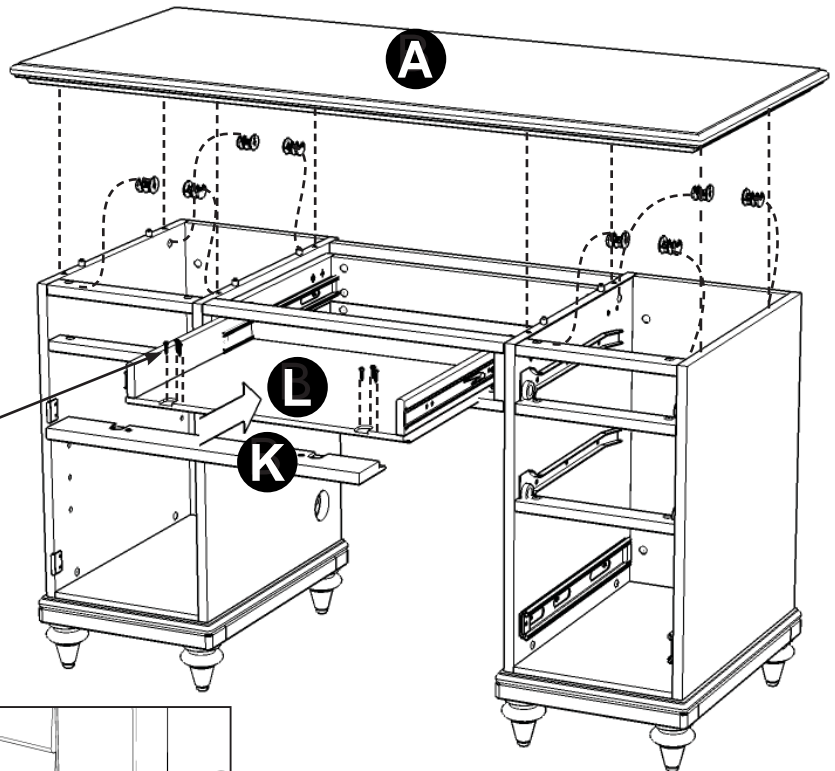

Figure 6

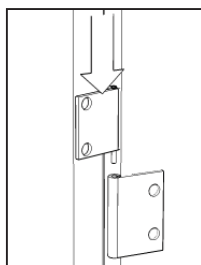

Figure 7

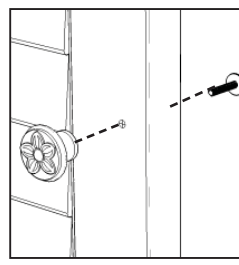

Figure 8

## STEP 7

Insert Adjustable Pins into side panels at the desired level. (see Figure 6)

Place Shelf (J) into position.

Attach Door (R) by sliding the door lift hinges into the side panel lift hinges. (see Figure 7)

Assemble Pull Handle to Door with Machine Screw. (see Figure 8)

Slide Drawers (S), (T) and (U) into position.

To level the unit, adjust the adjustable levelers on the bottom of the legs. (see Figure 9)

**Note: Unit must be level to work properly.**

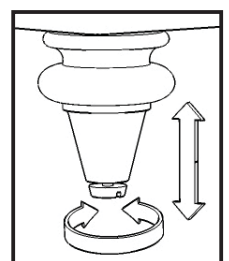
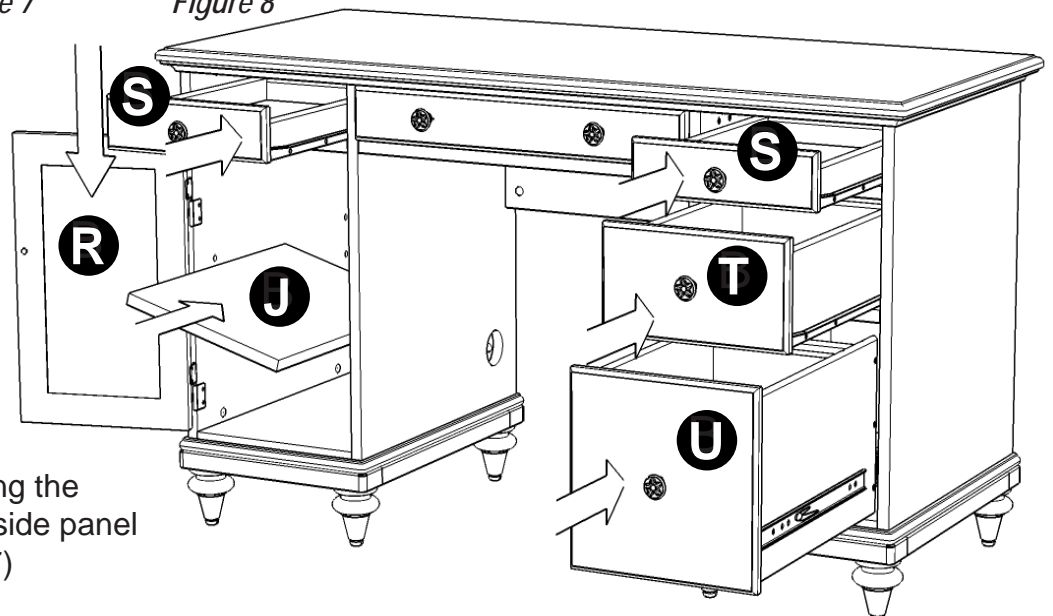

Figure 9

# Keyboard (L)

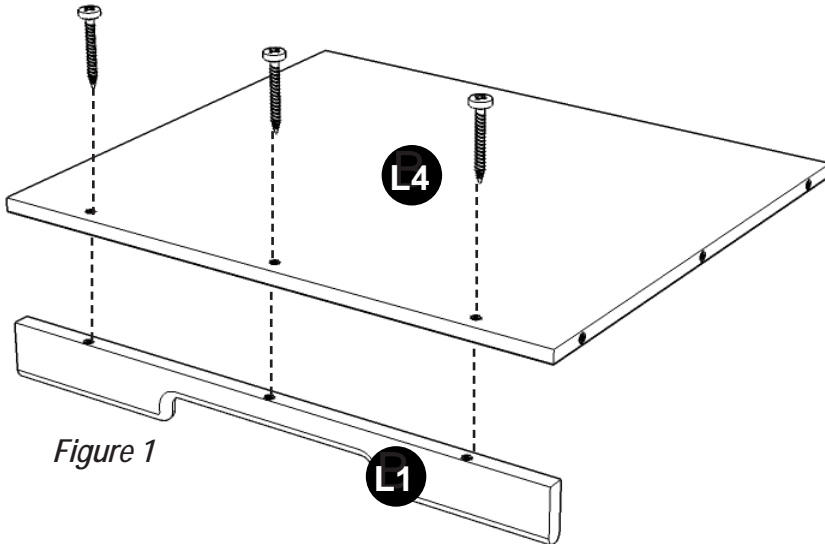
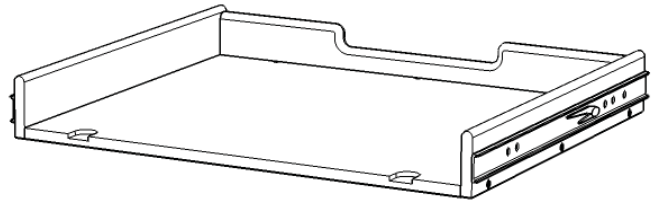

Figure 1

## STEP 1

Attach L1 to L4, using a Phillips screwdriver and long wood screws (3X), tighten halfway. (see Figure 1)

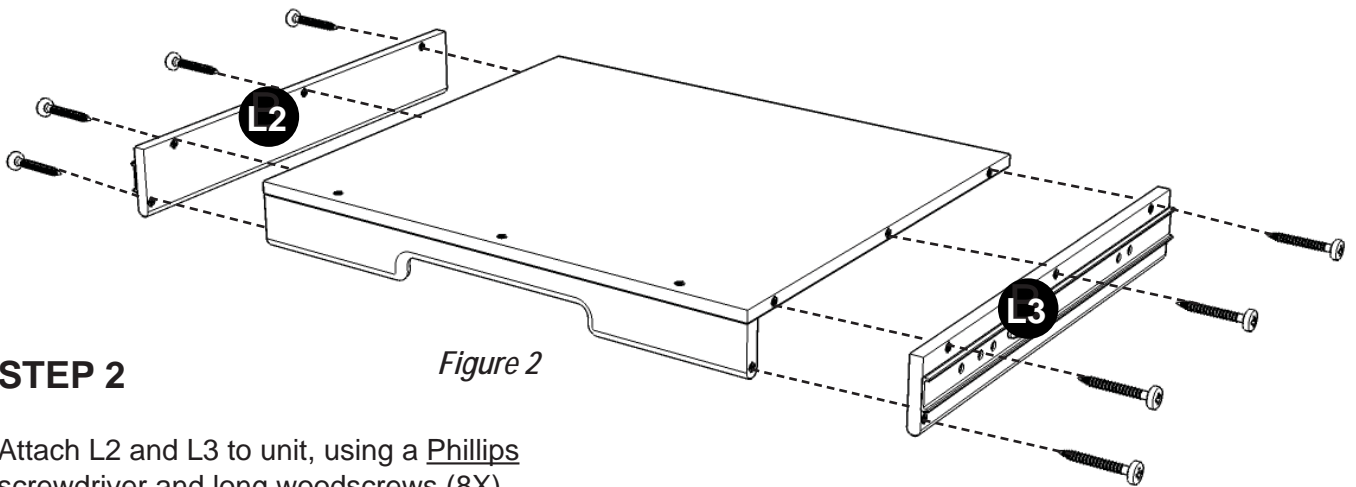

Figure 2

## STEP 2

Attach L2 and L3 to unit, using a Phillips screwdriver and long woodscrews (8X), tighten halfway. (see Figure 2)

**Tighten all screws used in keyboard assembly.**

## Parts List

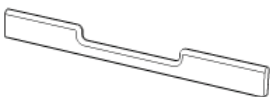

**L1.**  
Back Part  
1 Pc.



**L2.**  
Side Part  
1 Pc.



**L3.**  
Side Part  
1 Pc.

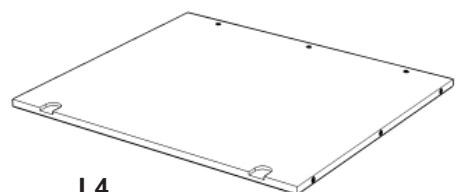

**L4.**  
Base Part  
1 Pc.

# Drawer (S)

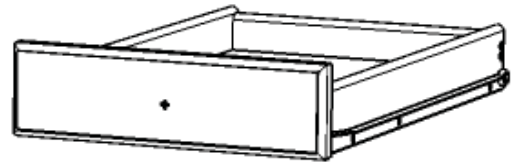

## STEP 1

Attach S1 to S3 and S4, using a Phillips screwdriver and long wood screws (4X), tighten halfway.

Attach S2 to S3 and S4 using long wood screws (4X), tighten halfway. (see Figure 1)

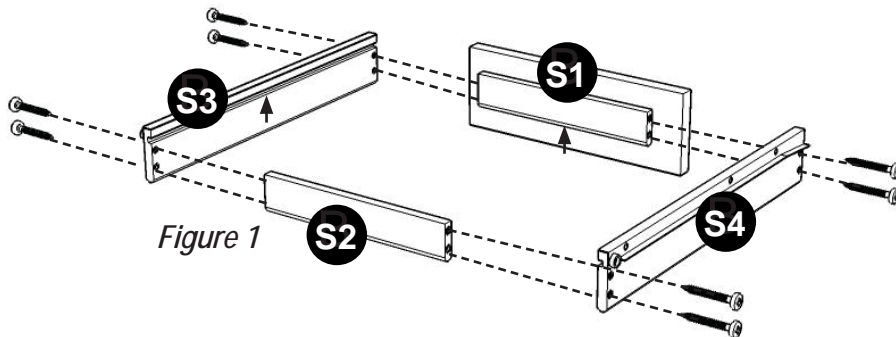

Figure 1

## STEP 2

Slide S5 into the grooves in S3 and S4.

Be sure to push S5 all the way forward so it meets S1. (see Figure 2)

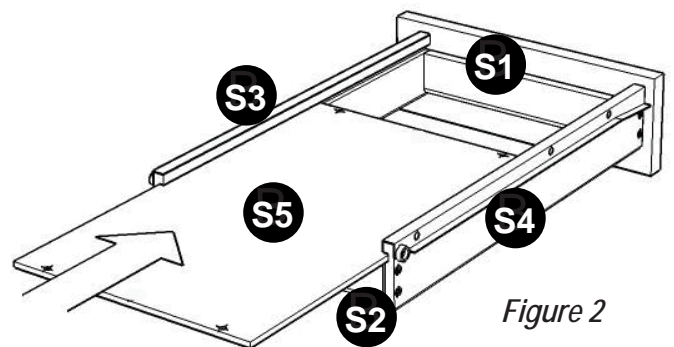

Figure 2

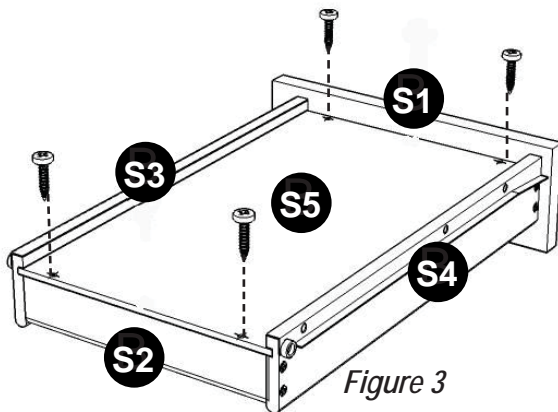

Figure 3

## STEP 3

Insert short wood screws (4X) into the pre-drilled holes in S5, tighten screws.

(see Figure 3)

## STEP 4

Assemble Pull Handle with machine screws. (see Figure 4)

**Tighten all screws used in drawer assembly.**

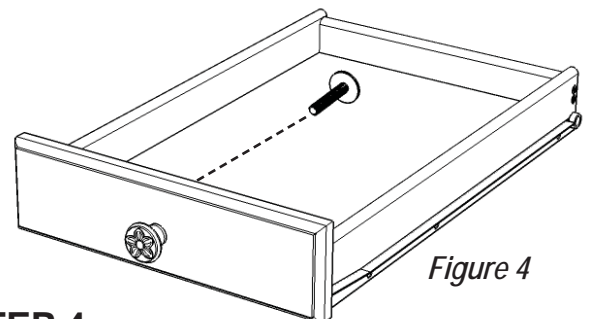
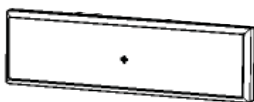

Figure 4

## Parts List



**S1.**  
Front Part  
2 Pcs.



**S2.**  
Back Part  
2 Pcs.

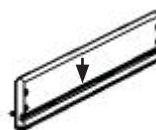

**S3.**  
Side Part  
2 Pcs.



**S4.**  
Side Part  
2 Pcs.



**S5.**  
Base Part  
2 Pcs.

## Drawer (U)

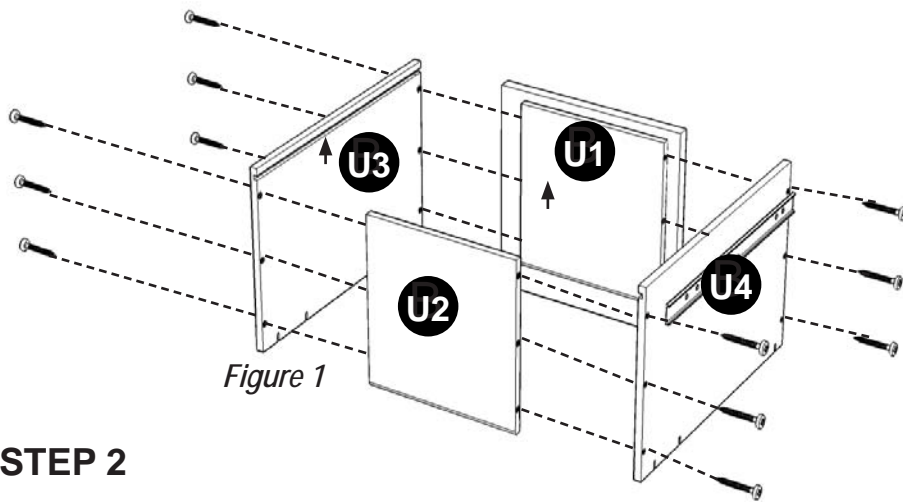
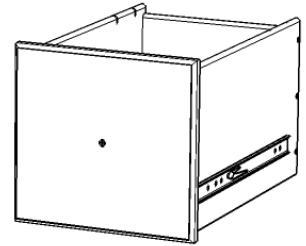

Figure 1

### STEP 1

Attach U1 to U3 and U4, using a Phillips screwdriver and long wood screws (6X), tighten halfway.

Attach U2 to U3 and U4 using long wood screws (6X), tighten halfway. (see Figure 1)

### STEP 2

Slide U5 into the grooves in U3 and U4.

Be sure to push U5 all the way forward so it meets U1. (see Figure 2)

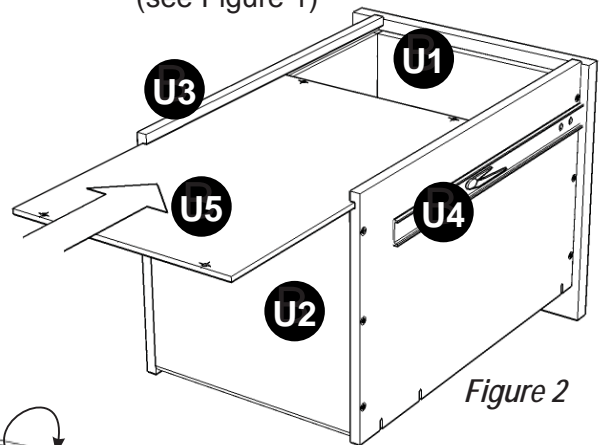

Figure 2

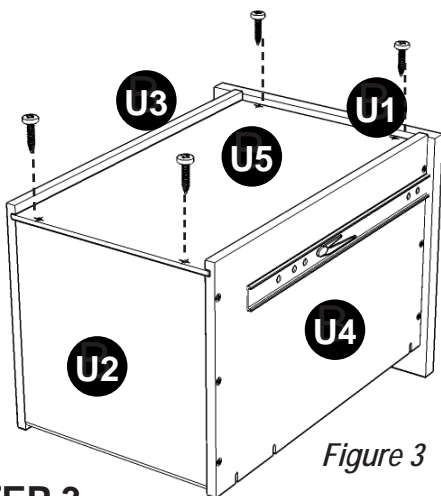

Figure 3

### STEP 3

Insert short wood screws (4X) into the pre-drilled holes in U5, tighten screws. (see Figure 3)

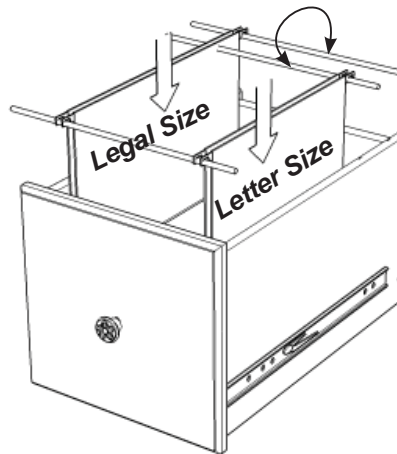

Figure 4

### STEP 4

Assemble Pull Handle with machine screws. (see Figure 4)

**Tighten all screws used in drawer assembly.**

Place Metal Strips (V) into position.

You can move the back Metal Strip for letter size or legal size files as shown.

## Parts List

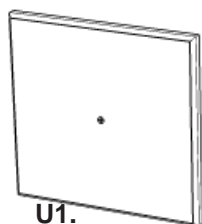

**U1.**  
Front Part  
1 Pc.

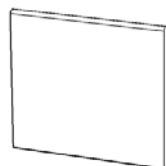

**U2.**  
Back Part  
1 Pc.

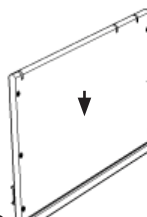

**U3.**  
Side Part  
1 Pc.

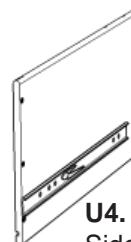

**U4.**  
Side Part  
1 Pc.



**U5.**  
Base Part  
1 Pc.

# Drawer (T)

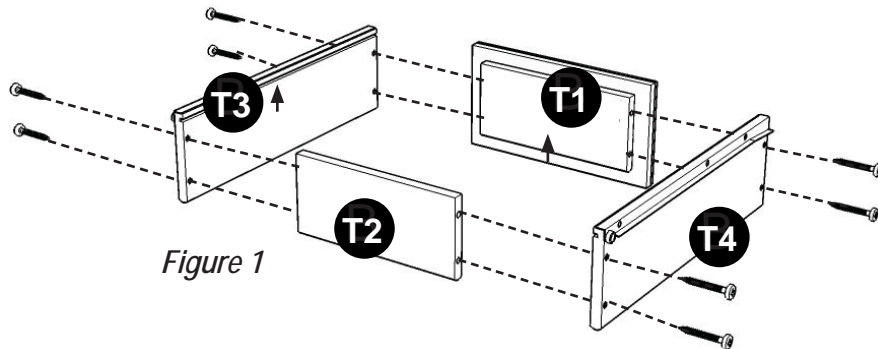
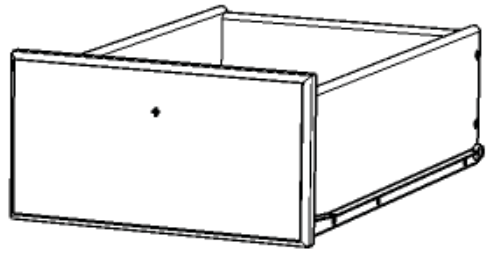

Figure 1



## STEP 1

Attach T1 to T3 and T4, using a Phillips screwdriver and long wood screws (4X), tighten halfway.

Attach T2 to T3 and T4 using long wood screws (4X), tighten halfway. (see Figure 1)

## STEP 2

Slide T5 into the grooves in T3 and T4.

Be sure to push S5 all the way forward so it meets T1. (see Figure 2)

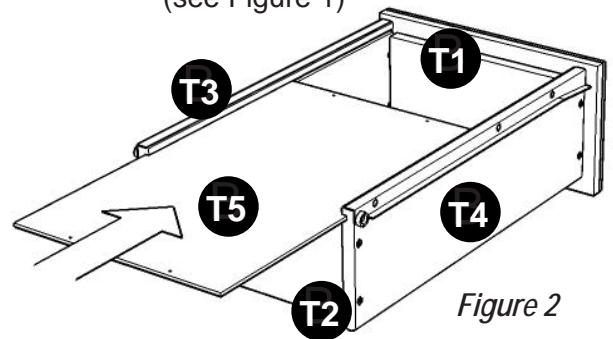

Figure 2

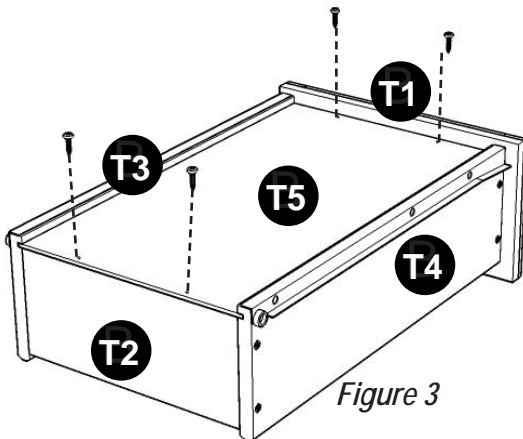

Figure 3

## STEP 3

Insert short wood screws (4X) into the pre-drilled holes in T5, tighten screws. (see Figure 3)

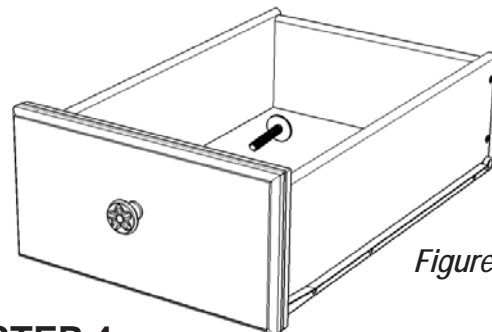

Figure 4

## STEP 4

Assemble Pull Handle with machine screws. (see Figure 4)

**Tighten all screws used in drawer assembly.**

## Parts List

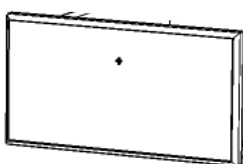

**T1.**  
Front Part  
1 Pc.



**T2.**  
Back Part  
1 Pc.

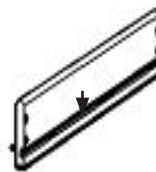

**T3.**  
Side Part  
1 Pc.



**T4.**  
Side Part  
1 Pc.



**T5.**  
Base Part  
1 Pc.