

Shower & Bath Enclosure Installation Instructions

Thank you for purchasing Heirloom Home Showers' products. We are committed to providing our customers with high quality products at a competitive price.

Please read all instructions carefully before and during installation.

Professional help is required for installation.

These installation instructions should be used as a guideline. Your specific shower or bath enclosure may differ from the figures shown in these instructions. This instruction is for shower models as follows: S-1615, SE-1615, and

The shower is delivered in a wood crate with carton box contents as follows:

- Box 1: one big and one small front glass panels (the panels have aluminum frames), and one big and one small glass doors (doors don't have Al frames)
- Box 2: function panel with pressure balance valve, water hoses, body jets, and electronic control box
- Box 3: one big and one small back wall panels (the panels have Al frames)
- Box 4: shower base and top, door tracks tucked under the base, and a hardware box of size 23"X10"X4"

Hardware included:

1. Drain with flexible hose if you ordered 1-1/2" drain. It doesn't come with a drain piece or flexible hose if you ordered 2" drain. You can buy 2" drain at a hardware store.
2. 10 cup washers and decorative chrome covers for mounting the function panel to back walls
3. 7/8" iron screws (8pieces), 1/2" stainless steel screws (20 pieces), and 1/4" (4 pieces) long screws
4. Glass shelf and its mounting bolts, washers, and nuts
5. Shower head sliding bar and its mounting bolts, washers and nuts.
6. Flexible water hose for hand-held shower and through-wall elbow, washers and a ring nut.
7. Hand-held shower head
8. 8 door rollers (four double rollers on top, and four double rollers with springs on the bottom of the doors)
9. 2 door handles
10. Mirror and two big head mounting bolts
11. Shampoo and soap dispensers, their mounting base and its mounting bolts, washers, nuts (4)

1. Pre-installation

Check the area you want to install your unit for the following:

- a. Water hook-ups, one hot and one cold with 1/2" FIP male connectors on 1/2" PEX or flexible hoses (shutoff valves are preferred for both hot and cold water supplies).
- b. Two 3'(or longer) stainless steel braided 1/2" water hoses with both 1/2" FIP female threads at both ends
- c. Floor drain (2" hard-plumbed drain is the US standard)
- d. Wall studs. Measure the area to ensure that once the unit is installed, the screw holes located at the top of the enclosure walls will align with a wall stud.
- e. 120V 15A wall outlet, preferably located at 82" above the floor 16" from the corner so that you can access it easily for the future.

2. Base Preparation

- a. Remove the shower base or from its packaging.
- b. Spray Polyurethane foams to the back side of the base (clear of the passage of drain pipes) (let the foam set)
- c. Remove all protective covering films from the base.
- d. Adjust the feet of the base so that the base is level when lying flat on the ground.
- e. For 1-1/2" using the drain piece provided, check e-j. Remove the plastic tubing and unscrew the top from the white plastic drain.
- f. Place the top portion into the drain hole in your base.
- g. Apply silicone sealant to the bottom portion of the white plastic drain (about 1/4" from the edge of the rim) and place it over the drain hole from the underside of the base.
- h. Screw the top of the plastic drain into the bottom until tight. Do not over tighten as this may crack the plastic.
- i. Reattach the plastic piping to the plastic drain.
- j. Extend the piping and feed it into the floor drain. You may use 1-1/4" to 2" coupling to secure the drain pipe to your floor drain. Make sure there are no KINKS.
- k. For 2" drain, simply hard-plumb the 2" drain with PVC pipe to the base. The base is set and secured to its designed location.

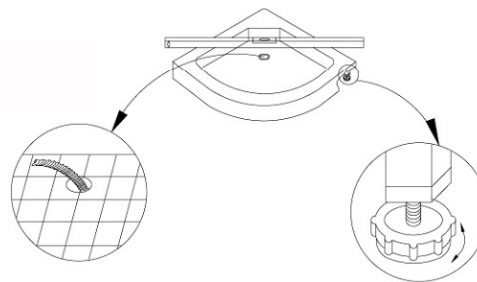
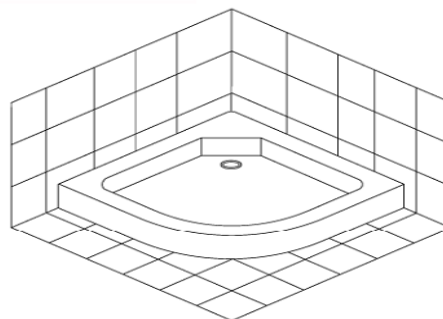

3. Front Frame Assembly

- Connect curved tracks to the vertical stiles (#37)(wider stiles at the ends of the front tinted (or clear) panels) with two metal screws(#27) as shown by the illustration.
- The wider track(#26) is on top. Make sure the U-shaped channel of this track OPENS upwards.
- The narrower track is on the bottom. Make sure that U-shaped channel of this track OPENS downwards.
- Use 8 iron screws (#27)of 7/8" and magnetically tipped screw bit. The iron screws can stand on the tip of the magnetic driver bit for easy positioning.
- Two screws on each corner.

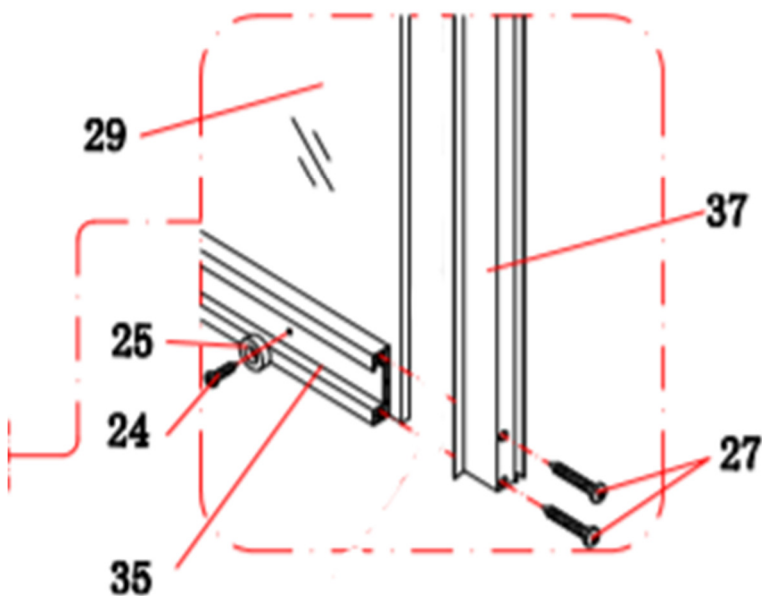
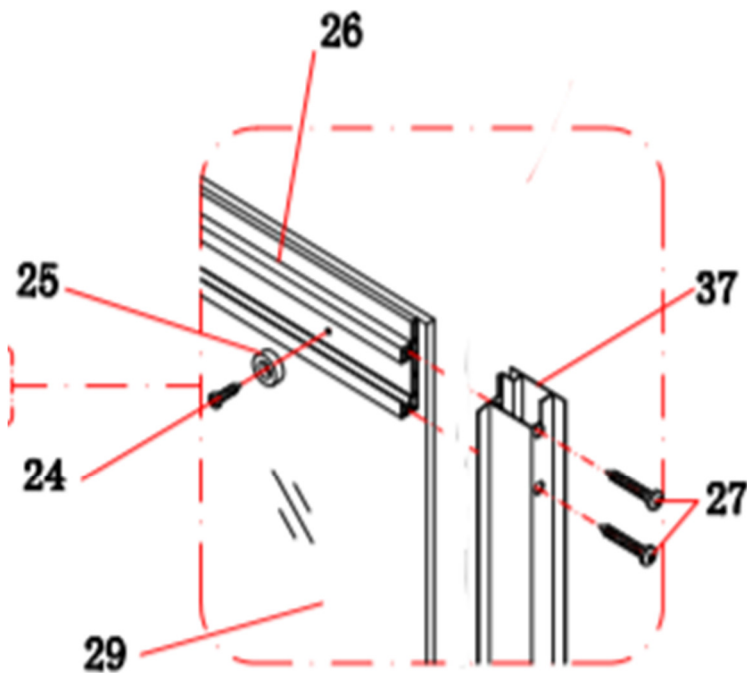

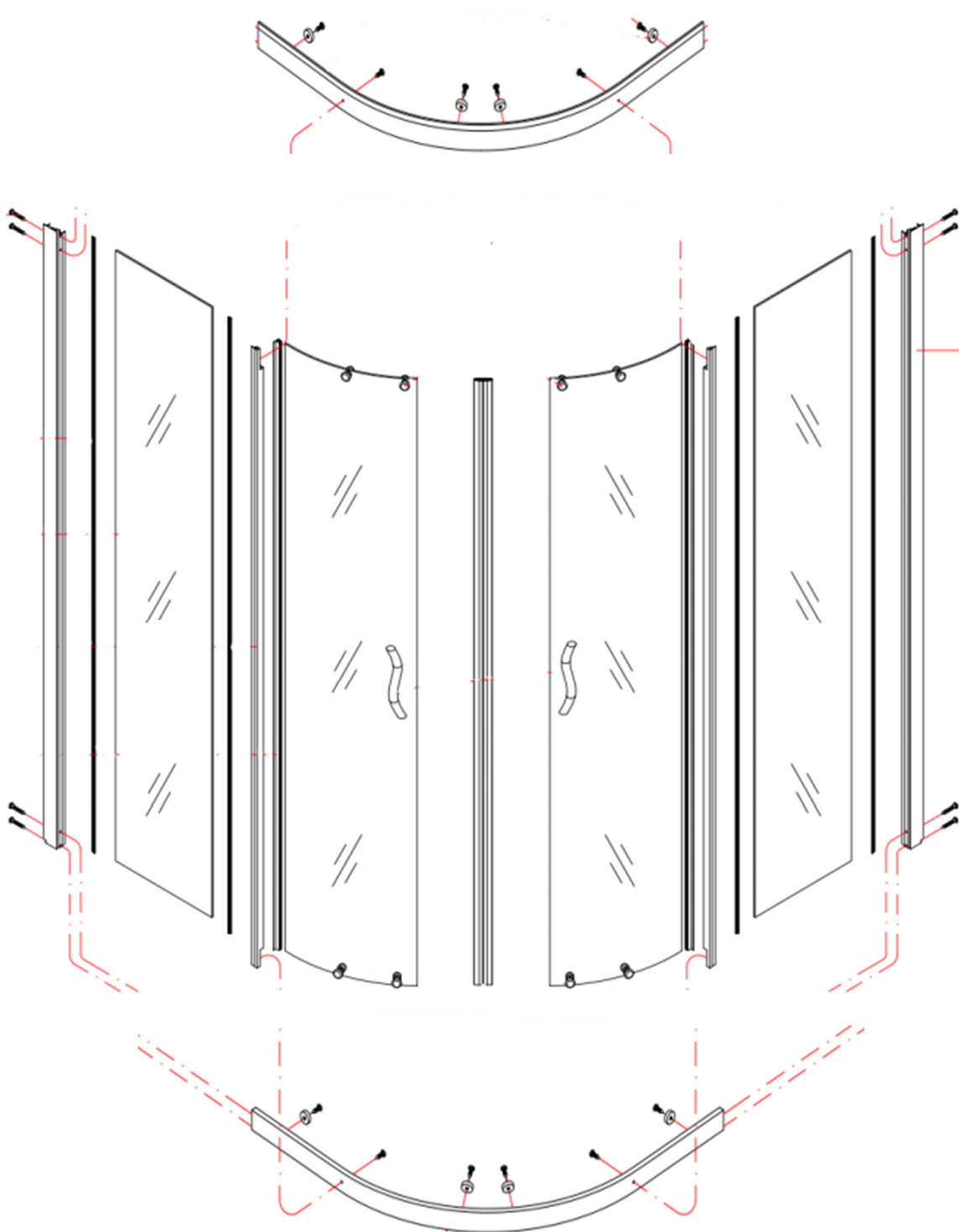

4. Second Points of Attachment of Front Panels to the Tracks

Attach the smaller vertical stiles of the front panels to both the top and bottom tracks.

From inside and in the middle (#24) of the track, use 3/16" drill bit to drill through both layers of the track and first layer of the small stile. Use 3/8" drill bit to drill through the first layer of the track (inside layer). Use 1/4" screw to attach both top and bottom tracks to the small stiles. Repeat the same procedure for the other front panel.

5. Glass Door Assembly

- a. Two types of door rollers are provided: top rollers with threaded shaft for height adjustable, and bottom rollers with spring loaded push-in mechanism.
- b. Locate handle holes on the doors and install water seal strips with magnets (dark brown or white) on the edges near the door handles and clear strips (4) to the other edges as shown by the illustration.

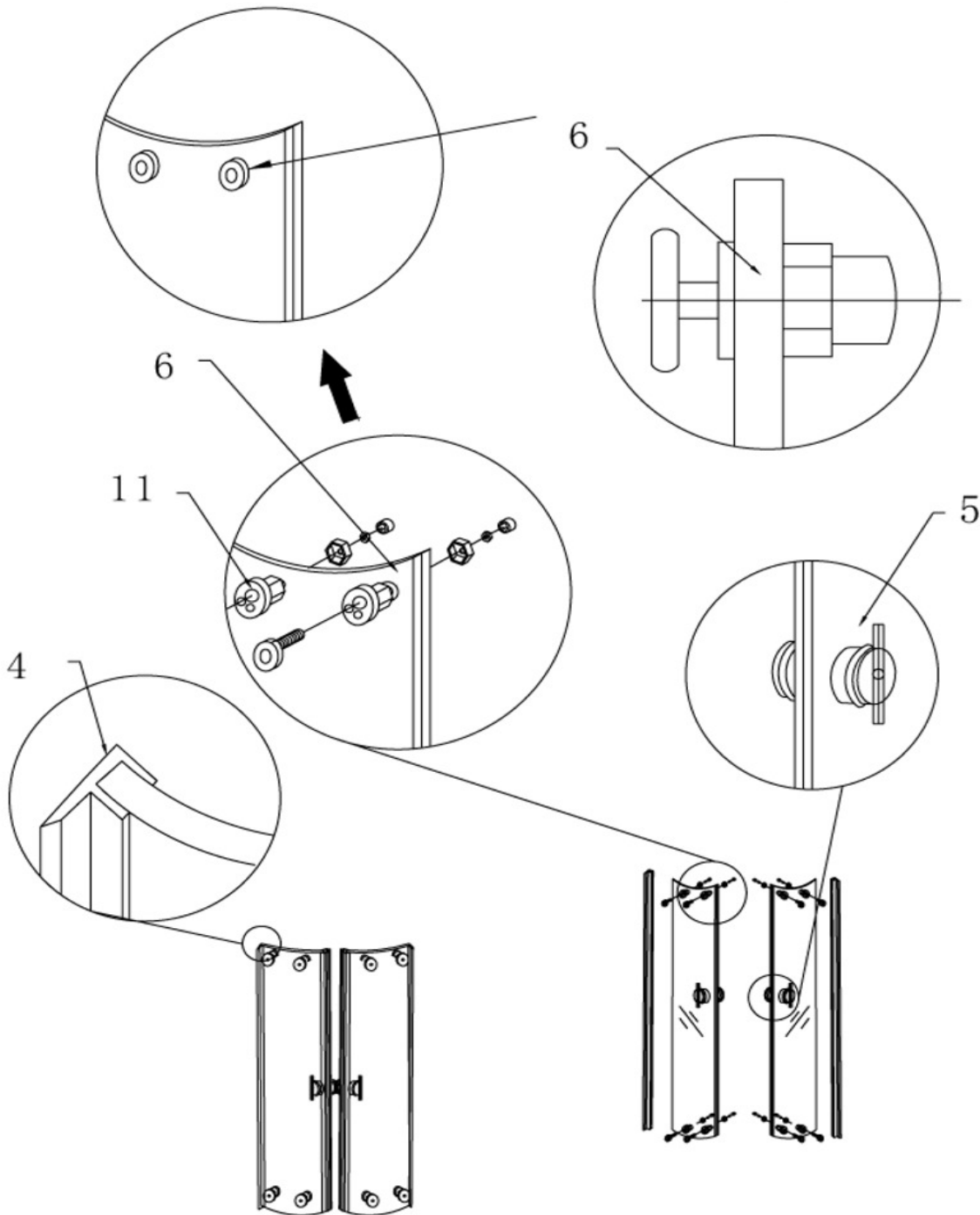

6. Back wall Assembly

- a. Install glass shelf, hand-held sliding bar or mounting bracket, towel bar if applicable, soap/shampoo dispensers, mirror, through-wall elbows to back walls through pre-drilled holes.
- b. Please check the installation diagrams below:

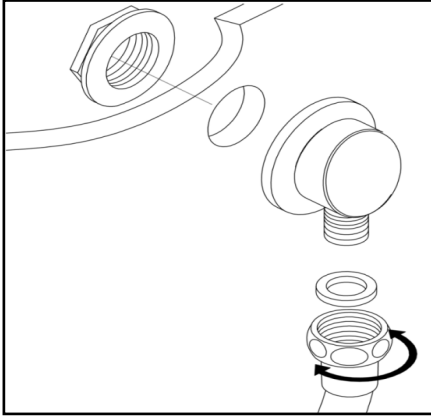

Through-wall elbow installation

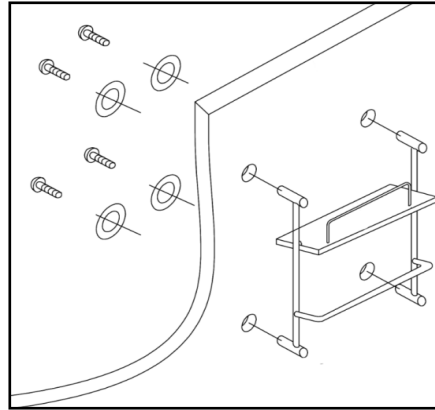

Shelf installation

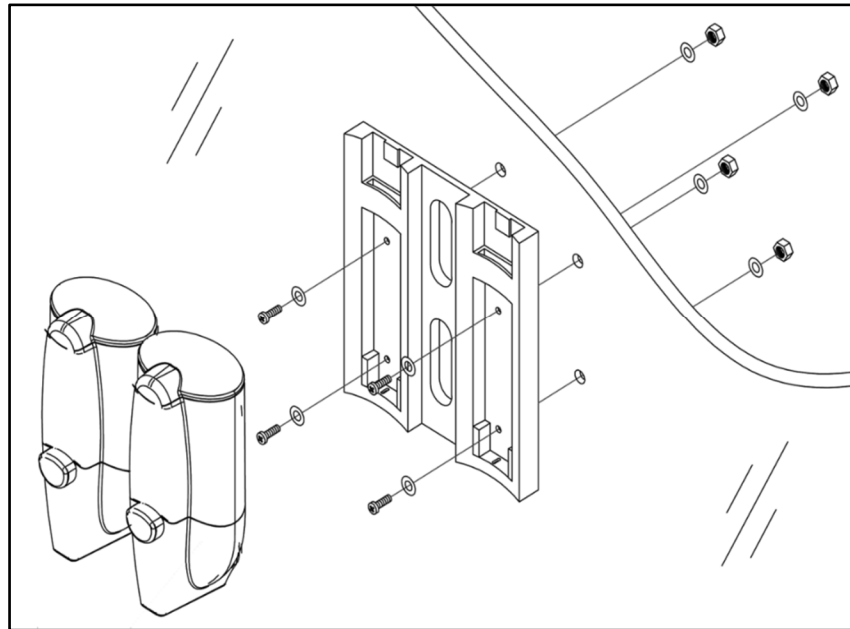
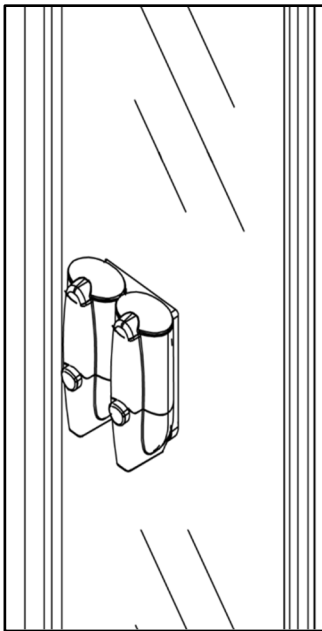

Shampoo dispenser installation

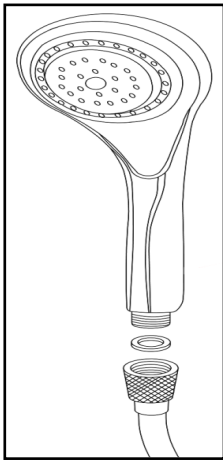

Hand-held shower

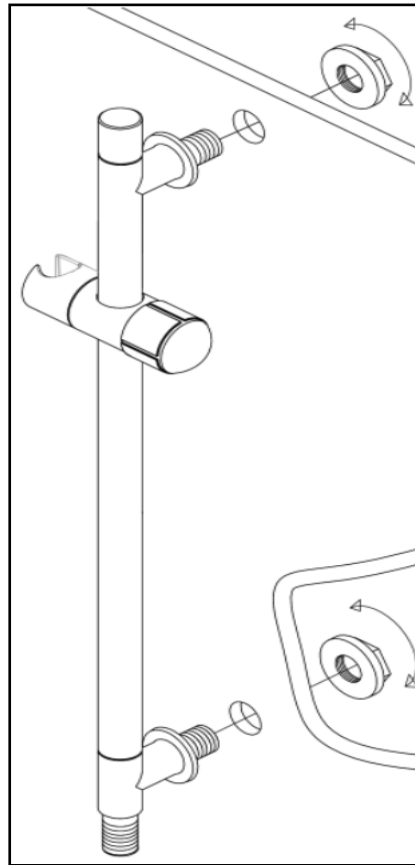

*Hand-held
shower
Head sliding
bar*

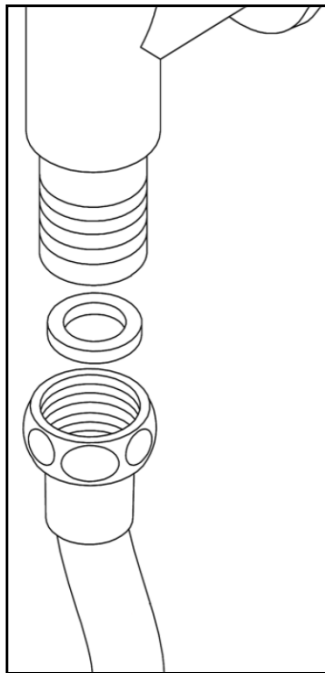

*For some models,
water supply are done
“through-wall elbow”*

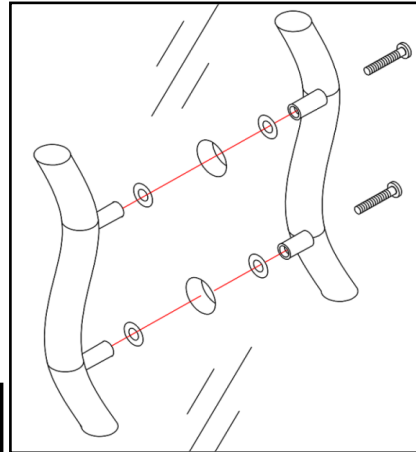

Door Handle Installation

7. Glass Door Installation

- Put rollers on top of the doors into the top rail first.
- Then push the rollers downward to let the rollers to cut into the bottom rail.
- Install the door handles.
- Install the magnetic door seals to the front edges of the doors.
- Install the L door seals to the back edges of the doors, making sure the L pointing outward to the front the glass panels.

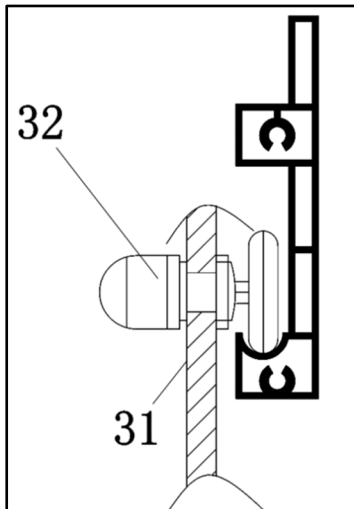

*Door roller
in top track*

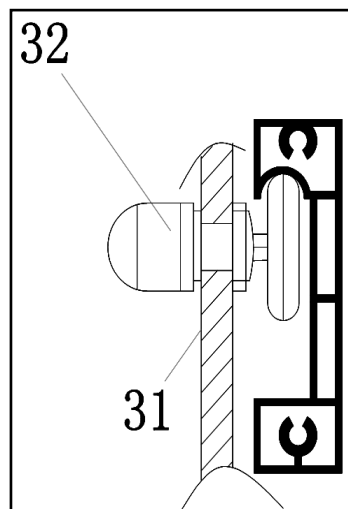

*Door roller
in lower
track
(31 stands
for glass)*

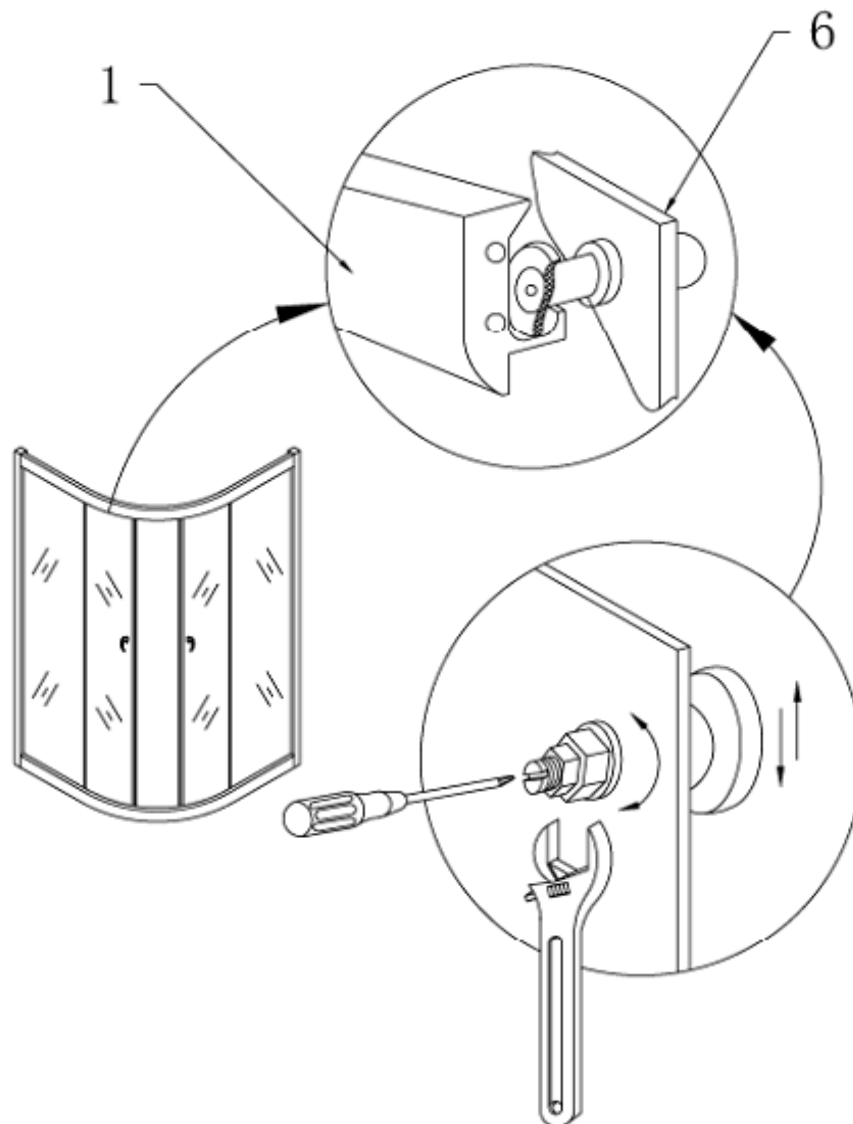

8. Unit Assembly

- a. Connect the front frame with two side-back walls. Set both back panels on top the base and close to their designated locations. Both back walls should have all their necessary components installed.
- b. Set the front frame onto the base. Push a back wall to the frame and pull against L edge of the front frame post #37. Use 5 of ½" stainless steel screws to secure the back wall to the front frame. Repeat the same procedure for the other back wall.
- c. Put the function panel close to its designated place and connect both hot and cold water supplies, water supplies to overhead shower, hand-held shower, body jets. **Make sure all connections are water tight!**
- d. Connect electrical wires to LED lights, Fan, and speaker. The wires have labels of their uses.
- e. Place the roof of the unit on top of the shower enclosure, aligning it with the walls, and fixing it to the wall studs through the edge foldup.
- f. Secure function panel to the back walls with ½" screws, cup washers, and chrome covers.
- g. Secure front frame stiles #37 to drywalls with 3" drywall screws and anchors through the holes at the top at a 45 degree angle.

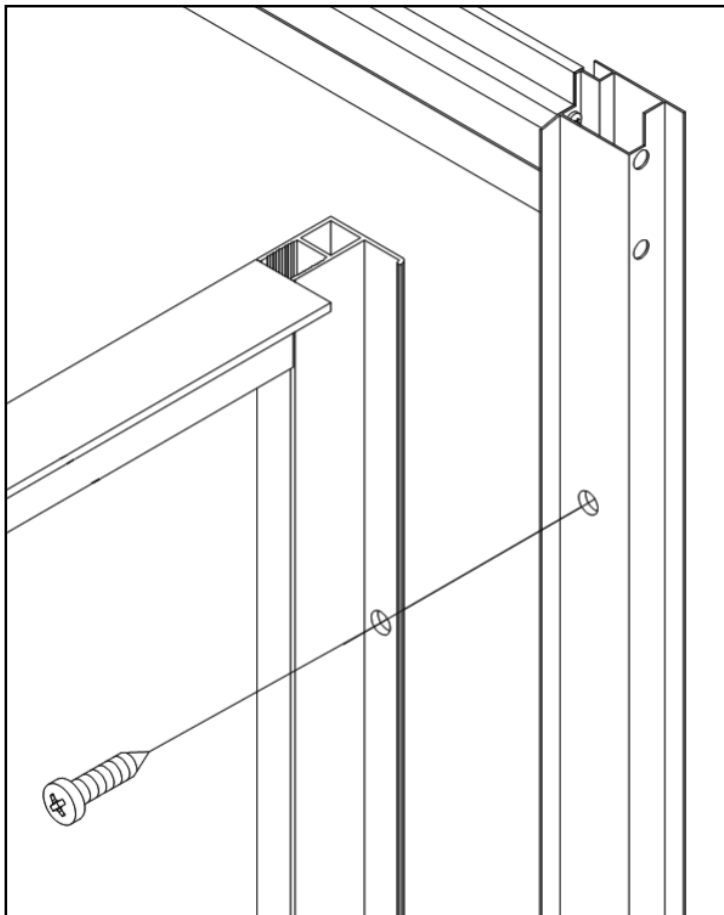

Backwall is attached to the stile of the front frame

10. Caulking

Use silicon sealant to seal all of the seams or joints from inside the shower

