

IM001-B

BULLET ICE MAKER

User Manual

SKU: IM001-BBL-USZX

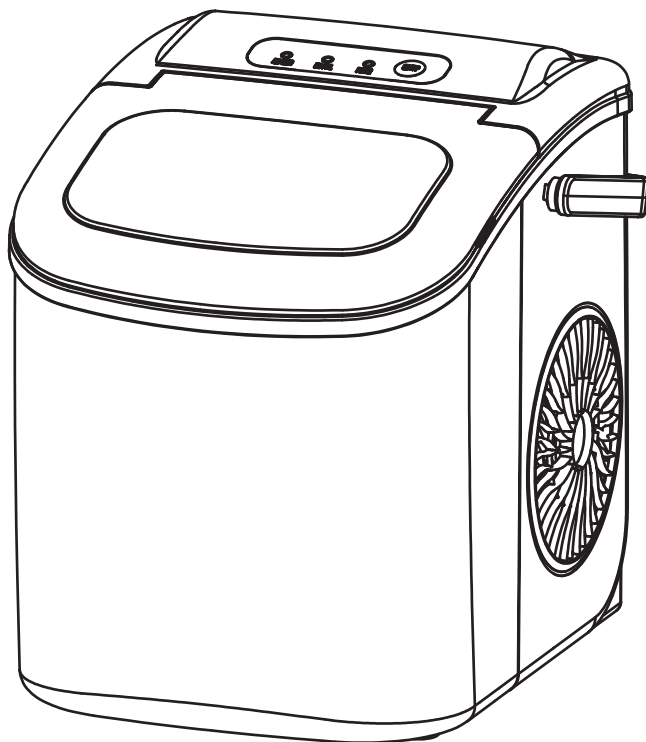

support@homyd.com



1-833-632-0897

Contents

Important Safety Instructions	01
Key Components and Structure	03
Getting to Know Your Ice Maker	04
Circuit Diagram	06
Installation Guide	07
First-Time Cleaning	08
Operate the Ice Maker	09
Storage and Relocation	11
Cleaning Methods	12
FAQs	15
Troubleshooting	17
Warranty Policy	18

IMPORTANT SAFETY INSTRUCTIONS

 Read and review instructions to understand the operation and use of the product.

 This is the safety alert symbol

 All safety messages will follow the safety alert symbol and the words “DANGER” or “WARNING”. Indicates the presence of a hazard that can cause personal injury, death, or substantial property damage if the warning included with this symbol is ignored.

Note

- 1. Indoor household use only.*
- 2. This appliance must be grounded.*
- 3. The wires in the power cord are colored in accordance with the following code:*

COLOR	WIRING
Yellow	Grounding
White	Neutral
Black	Live

To prevent a hazard due to the instability of the appliance, it must be placed on a flat and even surface.

WARNINGS

Failure to follow these instructions could result in electric shock, fire, or burn hazards, which could cause property damage, personal injury, or death. When using electrical appliances, basic safety precautions should always be followed, including the following:

1. Unplug the ice maker before cleaning, repairing, or servicing it.
2. Exercise caution and provide reasonable supervision when using the appliance near children.
3. **Do not** operate this or any other appliance with a damaged cord. If the supply cord is damaged, it must be replaced by the manufacturer, its service agent, or a similarly qualified person in order to prevent hazards. This ice maker must be positioned so that the plug is accessible.
4. To ensure optimal performance and safety, place your ice maker where the plug is easily accessible. Connect it to a polarized exclusive outlet, avoiding overloading the circuit by sharing it with other appliances. For a secure connection, fully insert the plug into the outlet.

5. **Do not** run the power cord over carpeting or other heat insulators. **Do not** cover the cord. Keep the cord away from traffic areas. Do not submerge the cord in water.
6. We **do not** recommend using an extension cord, which may overheat and become a fire hazard. If you must use an extension cord, use a size 14AWG at minimum, rated no less than 1875 watts.
7. **Do not** use the ice maker outdoors.
8. Place the ice maker out of direct sunlight.
9. Be sure that there is at least 6 inches of space between the back of the ice maker and the wall.
10. Keep a minimum of 6 inches clearance around the appliance.
11. **Do not** use liquids other than drinking water to make ice cubes.
12. **Do not** clean your ice maker with flammable fluids. The fumes can create a fire hazard or explosion.
13. **Do not** tip the machine over.
14. If the ice maker has been in a cold environment, give it a few hours to warm up to room temperature before plugging it in.

Risk Of Fire or Explosion-Flammable Refrigerant Used

Consult the Repair Manual/Owner's Guide before attempting to install or service this product. All safety precautions must be followed.

- Dispose of the appliance following federal or local regulations. Follow all handling instructions to ensure safe disposal.
- **DO NOT** use mechanical devices to defrost the ice maker.
- **DO NOT** puncture refrigerant tubing.
- Servicing must be performed by trained personnel only.
- The ice maker should comply with the safety standard for refrigeration systems (ASHRAE15) and should not be installed in corridors or hallways of public buildings.
- Clean and maintain the appliance regularly according to this manual's Cleaning & Maintenance section.

KEY COMPONENTS AND STRUCTURE

- ① Ice Shovel;
- ② Ice Full sensor;
- ③ Ice Basket;
- ④ Top Cover (lid) with See-through Window;
- ⑤ Air Exhaust;
- ⑥ Water Drain Cap: At bottom front of the unit;
- ⑦ Maximum Water Level Indicator: —▲— Remove the ice basket to see the water level mark;
- ⑧ Handle.

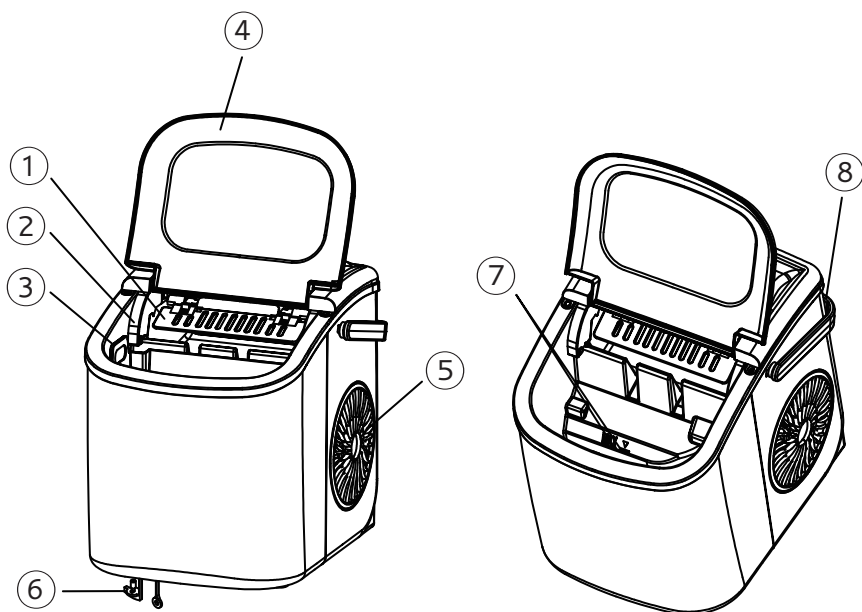

Accessories

- 1 x Bullet Ice Maker
- 1 x Handle
- 1 x Ice Basket

- 1 x Ice Scoop
- 1 x Manual

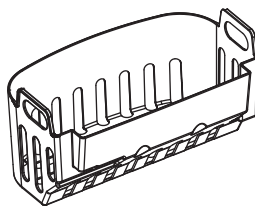
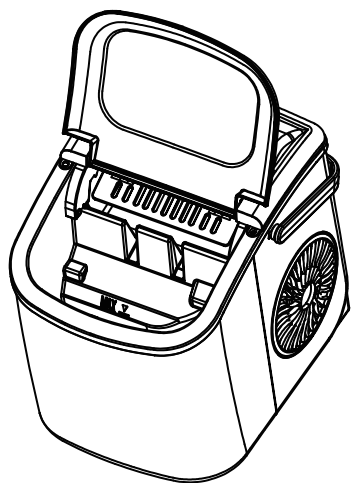

Ice Basket

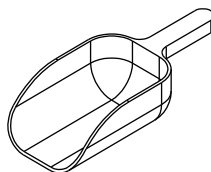

Ice Scoop

GETTING TO KNOW YOUR ICE MAKER

Control Panel & Modes

A. ON/OFF Button:

- In Standby Mode, briefly press the **ON/OFF** button to start the ice-making process, and press again to stop making ice.
- In Standby Mode, press this button for 5 seconds to start the self-cleaning function. The ADD WATER and ICE FULL indicators will flash. Press again to stop the cleaning function.

B. POWER Indicator Light: In Standby Mode and Ice-making Mode, the POWER indicator always stays green.

C. Ice Full Indicator Light: This light turns on to indicate the ice basket is full. The machine will stop making ice when this light is on.

D. Add Water Indicator Light: This light turns on, indicating the water tank lacks water.

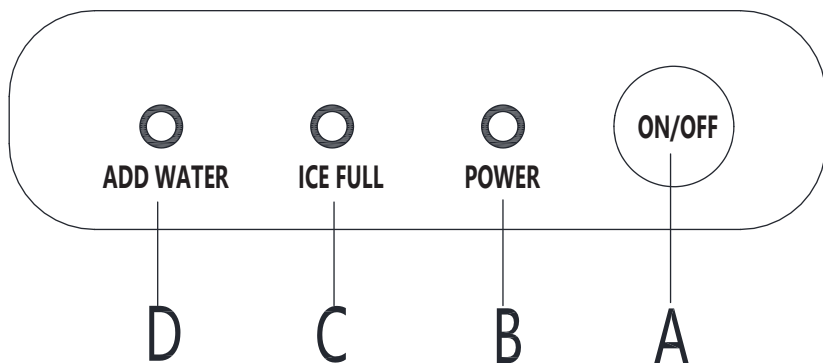

Technical Parameters

MODEL	IM001-B
Protection Type	I
Power	115V/60Hz
Ice-Making Current	1.5A
Ice-Harvest Current	1.8A
Refrigerant	R600a, 0.57oz/16g Δ
Design Pressure, High Side	290psig
Design Pressure, Low Side	88psig
Vesicant	C ₅ H ₁₀
Net Weight	12.43 lbs
Dimensions	9.3*11.6*11.4 inches
Enclosure	SUS

Model Number

SKU	Model Number	Color
IM001-BRD-USZX	IM-06A	Red
IM001-BWH-USZX	IM-06B	White
IM001-BBU-USZX	IM-06C	Blue
IM001-BBL-USZX	IM-06D	Black
IM001-BPU-USZX	IM-06E	Purple
IM001-BPK-USZX	IM-06F	Pink
IM001-BGE-USZX	IM-06H	Green
IM001-BGR-USZX	IM-06G	Grey
IM001-BSI-USZX	IM-06S	Silver

CIRCUIT DIAGRAM

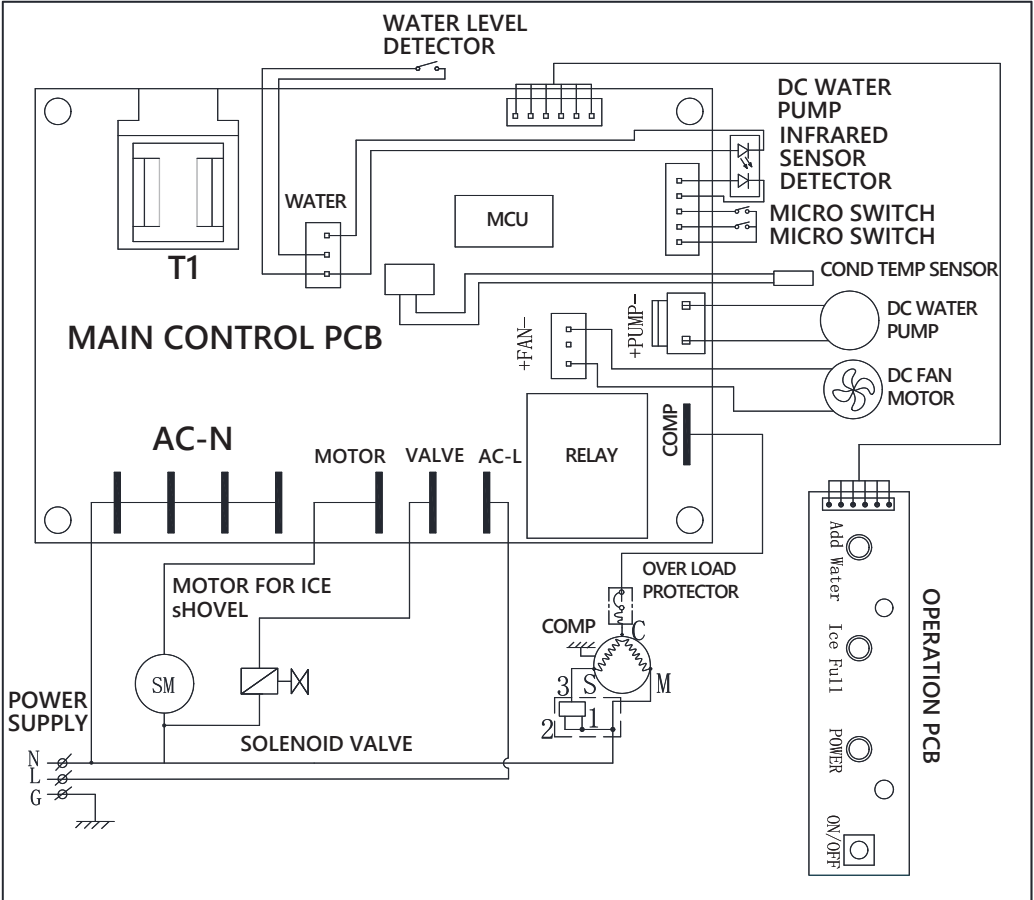

INSTALLATION GUIDE

1. Setup the Ice Maker

A. Unpack and Inspect

Remove all exterior and interior packaging. Confirm all accessories are included. If anything is missing, contact our customer service.

B. Prepare the Ice Maker

Remove all tape and tape strips from the machine; take out the accessory parts that are located inside the ice maker. Clean the inner cabinet and ice scoop with a damp cloth.

C. Position the Ice Maker

Place the machine on a level, flat surface away from direct sunlight and heat sources (e.g., stove, furnace, radiator). Ensure a clearance of at least **15 cm (about 6 inches)**, between the sides and the wall.

D. Allow Refrigerant to Settle

If the machine was tipped during shipping or transportation, let it sit upright for **24 hours** to allow the refrigerant to settle before plugging it in.

E. Plug Accessibility

Position the appliance so that the plug is easily and directly accessible.

Important Safety Warnings

Note: This machine must be grounded

- Plug into a grounded outlet; never remove the ground prong.
- **DO NOT** use an adapter or extension cord. Failure to follow these instructions may cause fire, shock, or death.

Electrical Connection

- Provide a dedicated outlet for the ice maker.
- Use outlets not controlled by a switch.
- For replacement of power cord or plug, contact a qualified technician.
- Requires a 110-120V, 60Hz grounded outlet.

Note: Grounding Method

For safety, the appliance must be grounded. Use the supplied grounding plug and plug it into a compatible grounded outlet. If one is unavailable, contact a qualified electrician to install it.

2. Install the Handle

Rotate the handle to fit the mounting hole on the machine and attach it to it.

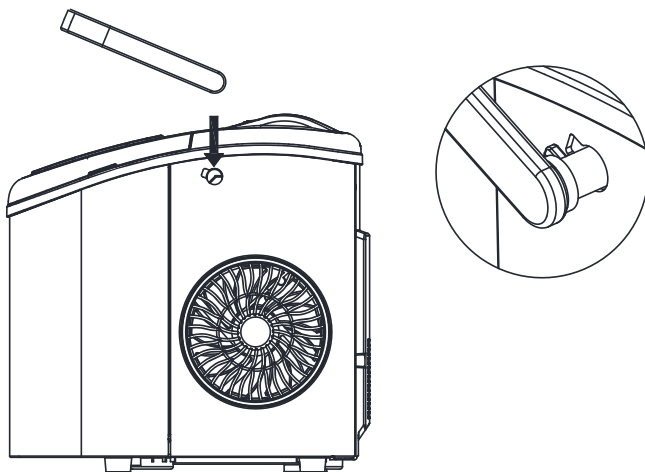

CLEANING YOUR ICE MAKER BEFORE USING FOR THE FIRST TIME

*** We highly recommend using our cleaning solution for product maintenance.**

1. Take out the ice basket.
2. Clean the interior with warm, soapy water and a soft cloth. We highly recommend using our cleaning solution.
3. Rinse the interior and inside parts with clean water. Drain out the water by unplugging the drain cap at the bottom front. Replace the ice basket, and plug in the power supply.
4. Press the ON/OFF button for 5 seconds. The machine will do a 30-minute self-cleaning program while the ICE FULL and ADD WATER indicators flash together.
5. After the self-cleaning process. Unplug and drain the water. Don't forget to reinsert the drain cap.
6. Clean the outside of the ice maker with a mild detergent solution and warm water.
7. Your bullet ice maker is ready to go!

HOW TO OPERATE THE ICE MAKER

WARNINGS

- * *When making ice for the first time or after a long time, it is highly recommended to clean the ice maker first.*
- * *Before making ice, be sure the water drain cap has been inserted into the appliance; otherwise, the ice-making function will not work correctly.*
- * *Fill with potable water only. Only use drinking or distilled water.*

1.Starting up the Machine

Step 1: Take out the ice basket and fill the water tank with potable water.

Step 2: Replace the ice basket.

Step 3: Plug in the power supply, and the ice maker will be in standby mode with the POWER Indicator Light turning red.

2.Ice-making Process

- Press the **ON/OFF** button to start the machine. The machine will begin making ice when the POWER Indicator Light turns green.
- Press the **ON/OFF** button again to stop making ice.

3.Add Water Indicator

- If the ADD WATER indicator light illuminates and the machine ceases operation, please add water to the water tank and the machine will automatically restart.

4.Ice Full Indicator

- When the ICE FULL indicator light illuminates, the machine will stop operating. Remove the ice to resume operation.
- Once the ice shield detects the ice has dropped, it will automatically reset and start a new ice-making cycle.

5.Shutting down the Machine

Step 1: Press the ON/OFF button briefly to stop ice-making and enter standby mode.

Step 2: Unplug the power supply to shut down the ice maker.

6. Automatic Self-Cleaning Program

a. Default Cleaning Time: 30 minutes.

b. How to Start Self-Cleaning

- Insert the water drain cap into the ice maker.
- Fill the water tank with potable water and not exceed the *MAX* line.
- Press the **ON/OFF** button for 3 seconds.
- The ADD WATER and ICE FULL lights will flash alternatively.

c. How to Cancel Self-Cleaning

- The program ends automatically after the cleaning is finished.
- Press **ON/OFF** during the cleaning procedure to cancel it manually during cleaning.

d. How to Clean the Top Cover (The Lid)

- After the cleaning procedure, open the top cover (lid) and remove the ice basket. Rinse the main water tank and the secondary water tank.

e. How to Drain the Dirty Water

- Move the ice maker to the edge of the countertop or table. Be sure that the appliance is stable.
- Make sure you have placed a water container (like a sink) under the appliance.
- Remove the drain cap from the bottom. Allow the dirty water to drain into the water container.
- Then, reinsert the drain cap.

Note: Sanitation Precautions

- Change the water in the tank every 24 hours to ensure reasonable sanitation.
- If the ice maker will not be used for a day or more, drain all water and dry the tank.

PREPARING YOUR ICE MAKER FOR LONG-TERM STORAGE OR RELOCATION

If your ice maker will not be used for an extended period of time, or needs to be moved to a different location, it's essential to operate and maintain it correctly. Check these tips

1. Daily Use Tips

Fill with potable water only. Only use drinking water.

The ice maker is intended for indoor use only. Place the ice maker on a level, flat surface away from direct sunlight and heat sources (e.g., stove, furnace, radiator). Ensure a clearance of at least 6 inches between the sides and the wall.

2. Drain Water Regularly

To maintain optimal sanitary conditions, we recommend replacing the water in the water tank every 24 hours.

To prevent potential issues such as mold or mildew growth, if the machine will not be used for an extended period exceeding 24 hours, it is advisable to thoroughly drain the water tank.

3. Clean and Sanitization

Clean the ice maker at least once a week, and perform a deep clean every month.

Unplug Before Cleaning: Always unplug the ice maker before cleaning.

Avoid using harsh chemicals: Please use a specialized ice machine cleaner for best performance. Avoid using harsh chemicals, including alcohol, vinegar, or other acids, as they can damage evaporator and shorten the life of the unit.

Deep Clean Before Use: If the ice maker has been sitting idle for a long time, thoroughly clean it before using it again.

4. Store Properly

Dry Completely: Ensure the ice maker is completely dry before storing.

Cover: Use a plastic bag to cover the ice maker, protecting it from dust.

CLEAN YOUR ICE MAKER

1.DAILY CLEAN

Step 1: Unplug the ice maker.

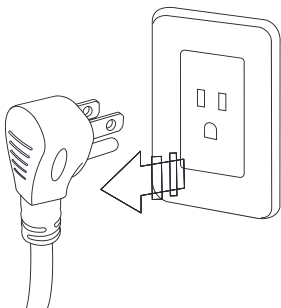

Step 2: Remove the bottom drain cap and drain the water into a sink.

Step 3: Pour water into the water tank, up to the *MAX* water level.

Step 4: Plug in the ice maker. Press and hold the **ON/OFF** button for 5 seconds to activate the 30-minute cleaning process.

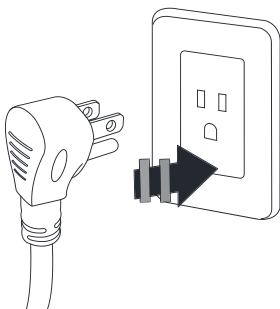

Step 5: When the cleaning process is finished, take off the drain cap and drain the water into a sink. And don't forget to replace the drain cap on the bottom.

Step 6: When completed, fill the unit with potable water. You can press the **ON/OFF** button to start making clean ice again.

2.MONTHLY CLEAN

Step 1: Unplug the ice maker.

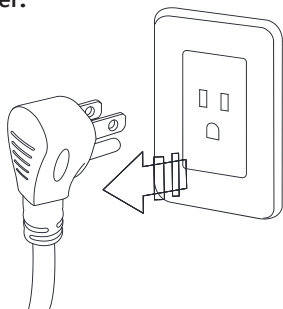

Step 2: Empty the ice cubes, and take off the bottom drain cap and drain the water into a sink by unplugging the drain cap at the bottom front.

Step 3: Reinsert the drain cap. Rinse the interior and inside parts with clean water, and drain.



Step 4: Pour the cleaning solution into the water tank, up to the *MAX* water level.

Step 5: Plug in the ice maker. Press and hold the **ON/OFF** button for 5 seconds to turn on the self-cleaning function

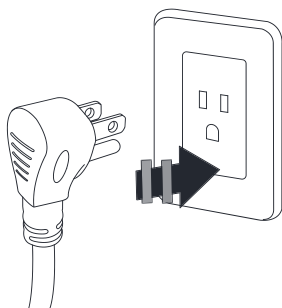

Step 7: Take off the drain cap and drain the water into a sink.

Step 8: Replace the drain cap on the bottom.

Step 9: Run the cleaning function for more cycles if needed.

Step 10: When completed, fill the unit with fresh water. You can press the **ON/OFF** button to start making clean ice again.

Note:

1. Avoid harsh chemicals: Do not use harsh chemicals or abrasive cleaners directly on any part of the ice maker. These can damage the surface and affect the taste of the ice.

2. Regular cleaning: Clean your ice maker regularly for optimal performance.

By following these simple steps, you can keep your ice maker clean and hygienic, ensuring you always have a supply of fresh and clean ice.

CORRECT DISPOSAL OF THIS PRODUCT



When the unit is taken out of service, its disposal and the handling of its materials must comply with national regulations.

FAQs

1. How often should I clean my ice maker?

To ensure optimal performance, clean your ice maker at least once a week, depending on usage. Regular cleaning prevents scale buildup, which can eventually block the pump and cause the machine to malfunction.

2. How do I clean the ice maker?

It is recommended to do the daily cleaning once or twice a week, and do the monthly cleaning once every month. Drain the machine immediately after cleaning and then rinse the machine with pure water.

To maintain an optimal performance and ice quality, it is recommended to drain the water tank at least once every three days. This routine maintenance helps to minimize water hardness, eliminate impurities, and inhibit the formation of scale deposits within the water tank.

3. Why are my ice cubes cloudy?

Cloudy ice cubes often result from using water that is not suitable for making ice. Use drinking water or distilled water for more transparent ice. Consider installing a water filter kit if the water quality is consistently poor.

4. Can I put milk or juice in the water tank?

No, we strongly advise against this. High concentrations of milk or juice can clog the pump and shorten its lifespan. Additionally, milk proteins may calcify and react with the machine's internal PU water pipe, potentially causing damage.

5. Why do my ice cubes melt quickly?

The ice maker does not have a freezing function for keeping the ice. High ambient temperatures, especially in summer, can accelerate melting. Follow these tips to slow the melting:

- Close the top cover (the lid) to maintain the internal temperature.
- Place a fan near the machine to disperse heat.
- For long-term storage, transfer ice cubes to a freezer.

6. Why are my ice cubes stuck together?

- Running the ice-making cycle for too long: Stopping the ice maker and restarting the ice maker once the ice blocks have melted.
- Low water temperature in the water tank: Refill the tank with water at a temperature of 40°F to 90°F.

7. Why do the ice cubes I made smell like plastic or dirty water?

This machine's ice cubes should be free of any taste or odor. If you detect a plastic smell, try the following deep clean steps:

- Unplug the machine for 2 hours to let the ice cubes in the ice maker melt;
- Drain the water from the machine;
- Add about 600ml/20 Oz (approximately 2-1/2 cups or 0.6 liters) of ice maker cleaning solution to the water tank.
- Start the cleaning function until the cleaning is completed;
- Then wait for 4 hours, drain the cleaning solution from the ice maker;
- Add clean potablewater to the water tank and start the cleaning function again.

8. Why does my machine make noise when it is running?

It is normal for the machine to emit a subtle sound during operation. Closing the top cover (the lid) can help minimize noise levels.

If you notice excessive noise from the machine, it is advisable to do a deep clean (See guide in FAQ 7). This action may alleviate the noise issue.

9. Why is water leaking from my machine?

Leaks may occur if the water tube inside the ice maker becomes disconnected during transport. Remove the back cover and reconnect the tube if you're familiar with basic appliance repairs. However, if you're unsure or prefer not to open the machine, don't hesitate to contact after-sales support for a step-by-step guide.

10. Why is there water flowing but not making ice?

Be sure to operate your ice maker at room temperature 50°F to 105°F. Use water temperature of 40°F to 90°F to operate your ice maker. To assist you further, please provide us with a video or photo of the issue. The after-sales team will be happy to offer guidance and support.

TROUBLESHOOTING — SUPPORT@HOMYD.COM

Problem	Possible Cause	Solution
ADD WATER Indicator turns on	Lack of water.	Power off the ice maker, fill water to <i>MAX</i> water line, and press ON/OFF button again to restart the unit.
ICE FULL Indicator turns on	There is too much ice.	Remove any ice cubes.
Ice cubes stick together	The ice-making cycle is too long.	Power off the ice maker and let the ice melt. Then power on the unit.
	Water temperature in inner tank is too low.	Replace the water. Recommended water temperature is 40°F to 90°F.
Ice-making cycle is normal, but no ice forms.	Room temperature or water temperature in inner tank is too high.	Ideal room temperature is 50°F to 105°F. Ideal water temperature is 40°F to 90°F.
	Refrigerant in cooling system leaks.	Please contact support@homyd.com .
	Pipe in the cooling system is blocked.	Please contact support@homyd.com .

If you encounter any issues that cannot be resolved through basic troubleshooting, please contact after-sales support team for assistance.

WARRANTY POLICY

1-Year Limited Warranty

Toll-Free Call: 1-833-632-0897 Mon to Fri, 9AM - 6PM (ET)

Email: support@homyd.com

Thank you for choosing our products. We provide a 1-Year Limited Warranty for items purchased through our official channels. Please kindly note that this warranty is for the original purchaser and is non-transferable. If you purchase from an unauthorized seller, please get in touch with them directly.

We are committed to ensuring that our products are free from defects in materials and workmanship for one year from the date of purchase, as long as they are used under normal household conditions and maintained according to the User Manual. **Please note that certain conditions and exclusions apply:**

Should you find any defects in the original product or its non-wearable parts, we will be happy to repair or replace the item within one year of purchase. If a replacement is necessary, the warranty period will continue from the original purchase date. Please be aware that normal wear and tear or damage due to mishandling, accidents, or failure to follow instructions are not covered. However, replacement parts are available for purchase. Feel free to contact us for more information.

Please also note that this warranty does not cover damage caused by exposure to liquids or foreign materials, unauthorized repairs or modifications, or use in commercial or non-household environments (unless specified for commercial use).

If you encounter any issues with your product, we are here to help. You can reach us by phone at **1-833-632-0897(US)** or email us at **support@homyd.com**. For certain product categories, we also offer the option to upgrade your warranty to our VIP service.

Our friendly phone support team is available from **Monday to Friday, 9 AM - 6 PM (ET)**. To assist you more efficiently, please have your product with you when you call. We aim to respond to emails within 24 business hours. If you don't receive a reply after sending us an email within this time frame, kindly check your spam folder to ensure you don't miss our response.

In addition to the one-year warranty, we also offer lifetime technical support. After the warranty period, service is still available at an additional cost. Please don't hesitate to contact us with any questions or concerns.

SKU: IM001-BBL-USZX

