

Service Manual

Ventilating Fan
(North America Market)

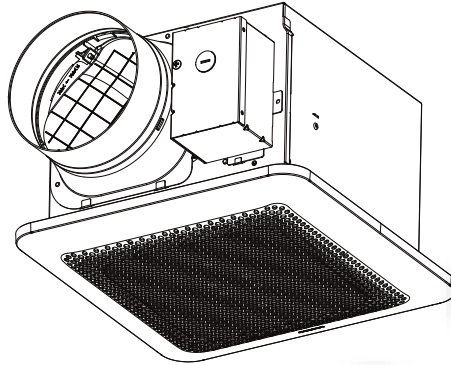

RG-C1315A



WARNING

This service information is designed for experienced repair technicians only and is not designed for use by the general public. It does not contain warnings or cautions to advise non-technical individuals of potential dangers in attempting to service a product. Products powered by electricity should be serviced or repaired only by experienced professional technicians. Any attempt to service or repair the product or products dealt with in this service information by anyone else could result in serious injury or death.

IMPORTANT SAFETY NOTICE

There are special components used in this equipment which are important for safety. These parts are marked by ⚠ in the Schematic Diagrams, Exploded Views and Replacement Parts List. It is essential that these critical parts should be replaced with manufacturer's specified parts to prevent shock, fire or other hazards. Do not modify the original design without the manufacturer's approval.
Please have a static electricity depletion process in place before handling these components..
Please use gloves when handling PCB parts during the repair process..

CONTENTS

PAGE

1.Specification-----	1
2.Parts Identification -----	2~4
3.Wiring Diagram -----	5
4.Parts List-----	6~7

1. Specification

Model No.	Air direction	Voltage (V)	Frequency (Hz)	Duct diameter (inches)	Air volume at 0.1" WG (CFM)	Noise (sones)	Speed (rpm)	Power (W)	Weight lb. (kg)
RG-C1315A	Exhaust	120	60	6	130	0.4	751	10.5	9.5(4.3)
					150	0.6	809	14.2	

HVI Certified performance based on HVI Procedures 915, 916, 920.

1. Parts Identification

RG-C1315A

Main Body Section

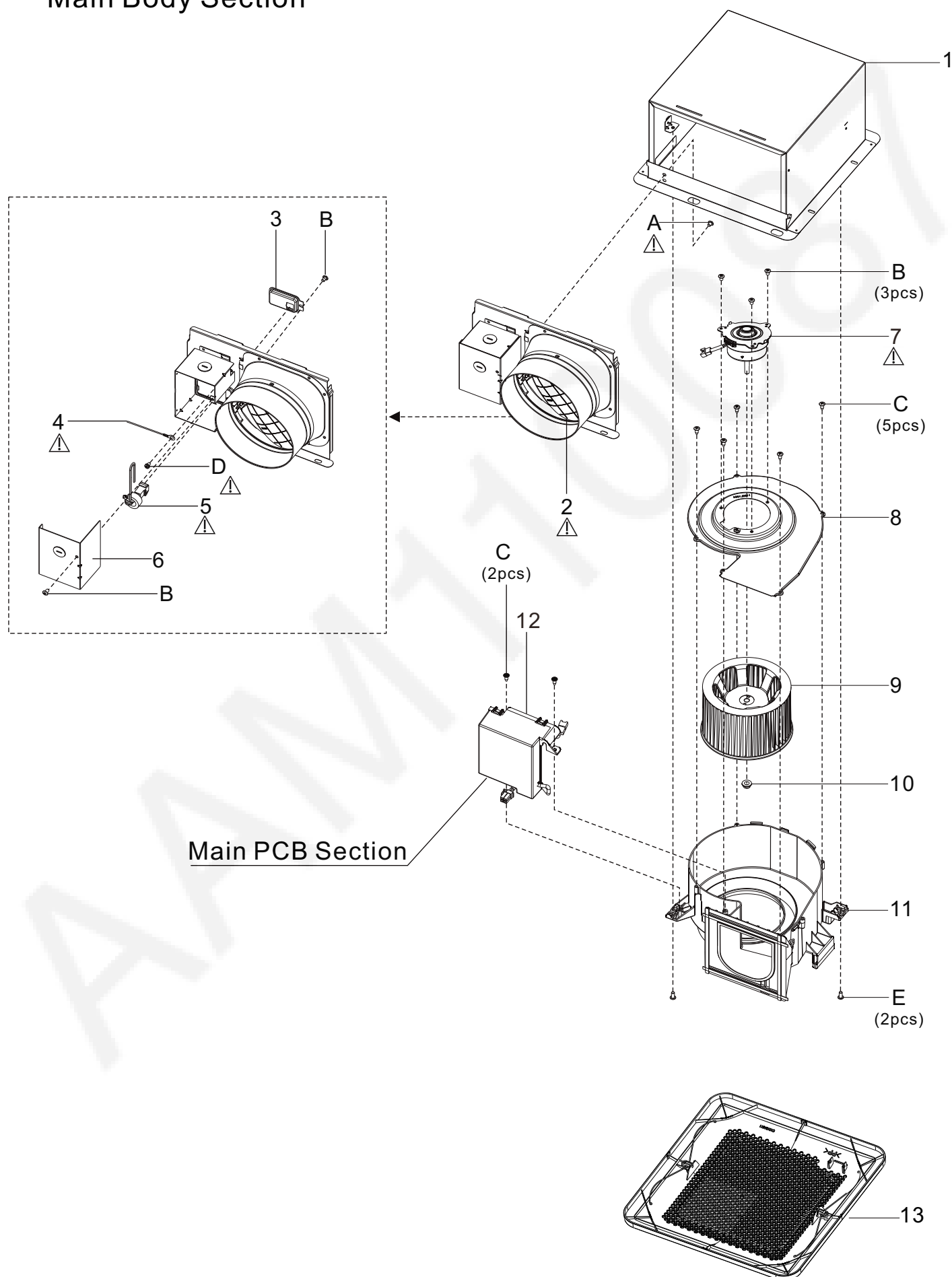

2. Parts Identification

RG-C1315A

Main PCB Section

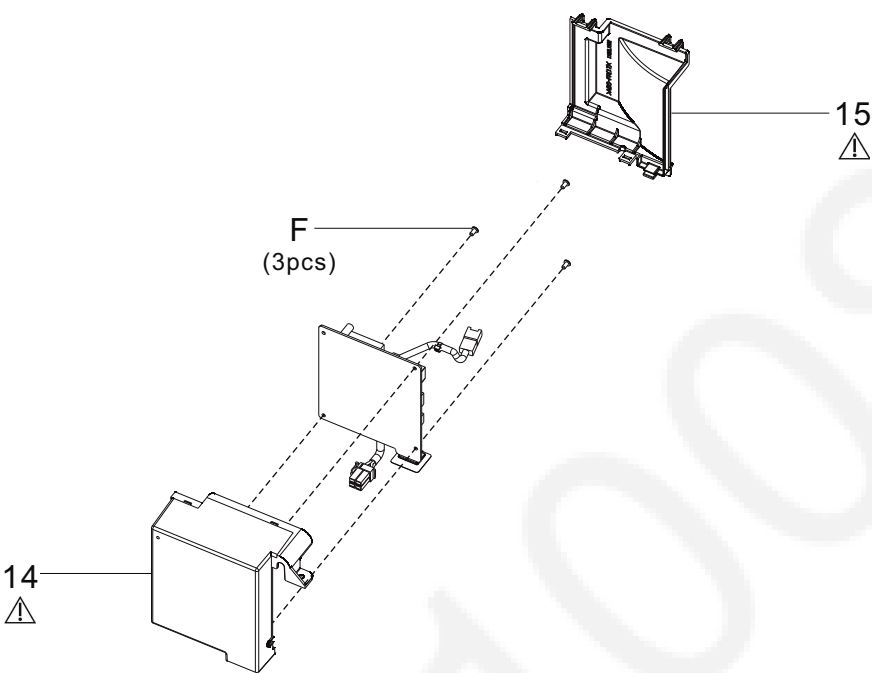

Main Label

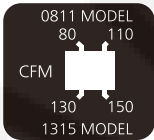

16

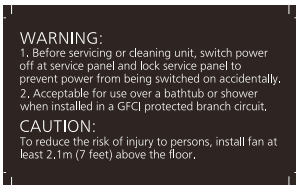

18

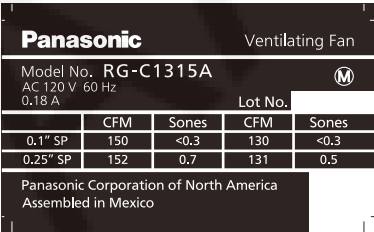

17



19

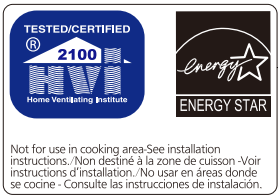

21



20

2. Parts Identification

RG-C1315A

Packing Section

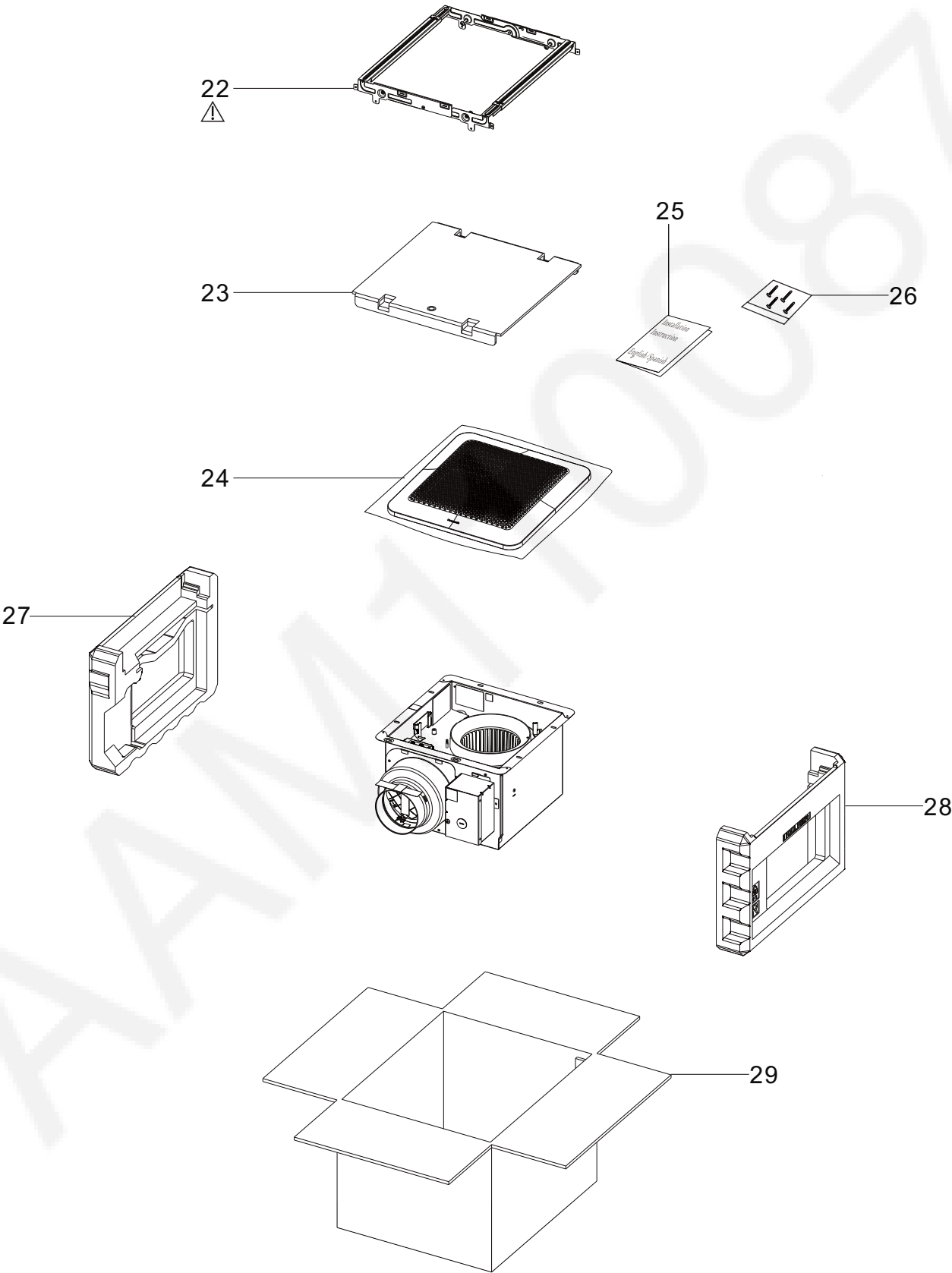

3.Wiring Diagram

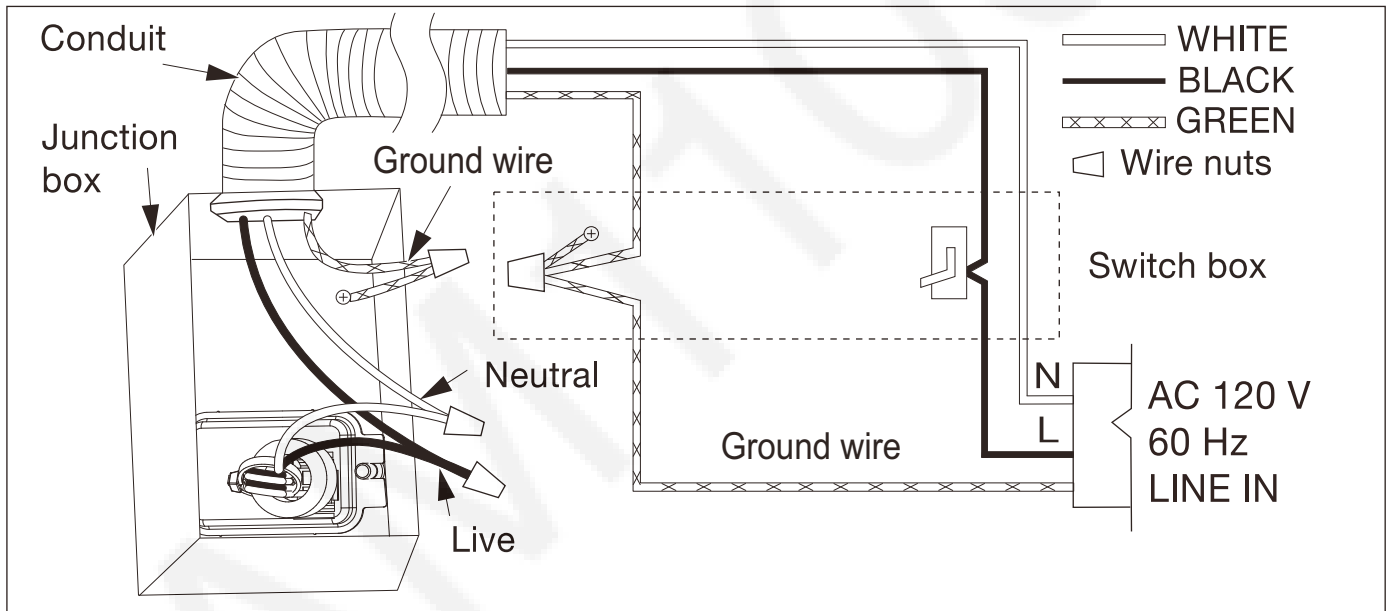
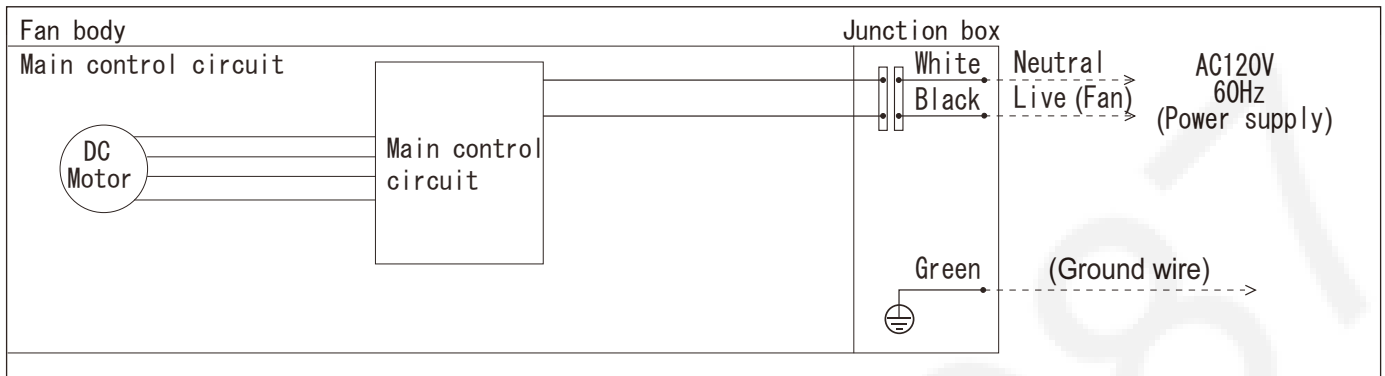

4. Parts List

RG-C1315A

Main Body Section

No.	Part No.	Part Name	Q'ty	Remark
1	FFVC811LH900	Frame Assembly	1	
2	FFV15VQ10910	Adapter Assembly	1	⚠
3	FFV08VKS3M915	Connector Plate	1	
4	FFV11QCL1331	Ground Wire	1	⚠
5	FFV11QCL1301A	Connector Assy	1	⚠
6	FFV11QCL1912A	Junction Cover	1	
7	FFV11QCL1M21AX	Motor	1	⚠
8	FFVM15VQ10904C	Motor Support	1	
9	FFV0400115S	Blade	1	
10	FFV7020021S	Nut	1	
11	FFVM15VQ10906B	Casing	1	
12	FFVC1315PCB	Main PCB section	1	⚠
13	FFV1315A810	Grill Assembly	1	
A	FFVXYM4-E8FJ	Screw (M4-8)	1	⚠
B	FFVXTT4-8FFJ	Screw (ST4-8)	5	
C	FFV7000089S	Screw (ST4-12)	7	
D	FFVXYM4DC8BN	Screw w/Washer (M4-8)	1	⚠
E	FFV7000065S	Screw (M4-12)	2	

Main PCB Section

No.	Part No.	Part Name	Q'ty	Remark
14	FFVC1315A991	Main PCB Box	1	⚠
15	FFV11QCL1992C	MAIN PCB Cover	1	⚠
F	FFVXTN3-8GFJ	Screw (M3-8)	3	

4. Parts List

RG-C1315A

Main Label

No.	Part No.	Part Name	Q'ty	Remark
16	FFV811LH112	Speed Switch Label	1	
17	FFV1315A150	Name Plate	1	
18	FFV811LH183	Caution Label	1	
19	FFV811LH152	Instruction Label	1	
20	FFV2260003S	Holograph Label	1	
21	FFV0810011S	Caution Label 1	1	

Packing Section

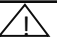
No.	Part No.	Part Name	Q'ty	Remark
22	FFV11QCL1920	Hanger Assy	1	
23	FFV4710381S	Grill Pad Assy	1	
24	FFV4650016S	Poly Cover	1	
25	FFVC1315A420	Installation Inst	1	English / Spanish For USA Market
26	FFV11KSL1M031A	Accessory A	1	
27	FFV11QCL1891	Left Pad	1	
28	FFV11QCL1892	Right Pad	1	
29	FFV1315A400	Packing Case Assy	1	