



STYLE SELECTIONS and logo design are trademarks or registered trademarks of LF, LLC. All rights reserved.

ITEM #1048419  
1048420  
1048421  
1048425

## PENDANT FITTER

MODEL #CPC1CH  
CPC1BNK  
CPC1OSB  
CPC1MBK

Español p. 11

ATTACH YOUR RECEIPT HERE  
ADJUNTE SU RECIBO AQUÍ

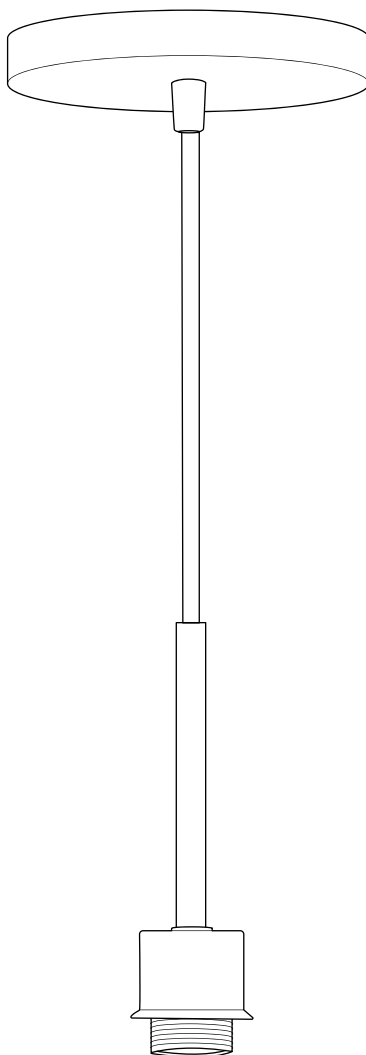

800053

APPROVED FOR USE  
IN DAMP LOCATIONS

Purchase Date \_\_\_\_\_



**Questions, problems, missing parts?** Before returning to your retailer, call our customer service department at **1-877-888-8225**, 8 a.m. - 8 p.m., EST, Monday - Sunday. You could also contact us at [partsplus@lowes.com](mailto:partsplus@lowes.com) or visit [www.lowespartsplus.com](http://www.lowespartsplus.com).

**TABLE OF CONTENTS**

---

Package Contents .....3

Hardware Contents .....4

Safety Information .....4

Preparation .....5

Assembly Instructions .....6

Care and Maintenance .....10

Troubleshooting .....10

Warranty .....10

**PACKAGE CONTENTS**

---

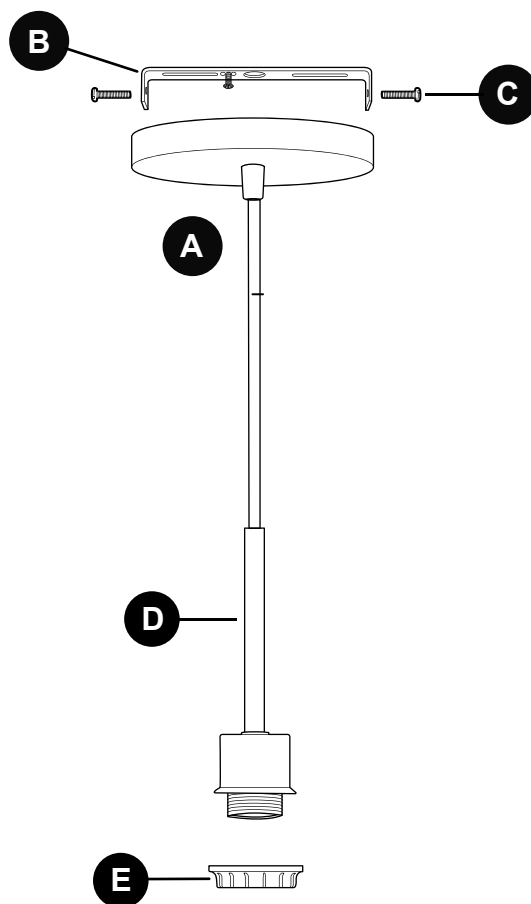

PART	DESCRIPTION	QUANTITY
A	Fixture	1
B	Mounting Strap (pre-assembled to fixture (A))	1
C	Mounting Strap Screw (pre-assembled to mounting strap (B))	2
D	Rod (pre-assembled to fixture (A))	1
E	Socket Ring (pre-assembled to fixture (A))	1

## HARDWARE CONTENTS (shown actual size)

---

AA

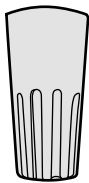

Wire  
Connector

Qty. 3

BB

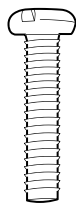

Machine  
Screw

Qty. 2



### SAFETY INFORMATION

---

#### READ AND SAVE THESE INSTRUCTIONS.



#### DANGER

- For your protection and safety, carefully read and understand the information provided in this manual completely before attempting to assemble, install or operate this product. Failure to do so could lead to electrical shock, fire or other injuries that could be hazardous or even fatal.
- DO NOT connect this fixture to an electrical system that does not provide a means for equipment grounding. Never use a fixture in a two-wire system that is not grounded. Installing a fixture into an electrical system not having a proper grounding means could cause metal parts of the fixture to carry electrical currents if any of the fixture wires, wire connections or splices were to become broken, cut or loose during the mounting or normal operation of the fixture. Under this condition, anyone coming in contact with the fixture would be subject to electrical shock, which could cause serious injury or death.
- DO NOT connect the bare or green insulation fixture ground wire to the black (HOT) current-carrying wire or the white (NEUTRAL) house wire. Connection of the bare or green fixture ground wire to the black or white house wires may cause metal parts of the fixture to carry electrical currents. Under this condition anyone coming in contact with the fixture will receive electrical shock, which could cause serious injury or death.
- DO NOT damage or cut the wire insulation (covering) during installation of fixture. DO NOT permit wires to contact any surface having a sharp edge. To do so may damage or cut the wire insulation, which could cause serious injury or death from electrical shock.



#### WARNING

- All electrical connections must be in agreement with local codes and ordinances, the National Electric Code (NEC) and ANSI/NFPA 70-1999. Contact your municipal building department to learn about your local codes, permits and/or inspections. Risk of fire - most dwellings built before 1985 have supply wire rated for 140 °F. Consult a qualified electrician before installation.
- To avoid personal injury, the use of gloves may be necessary while handling fixture parts with sharp edges.

## **SAFETY INFORMATION**

---

### **WARNING**

- DO NOT suspend any fixture by the house wires. A fixture must always be mounted directly to an outlet box or to a mounting strap which is first attached to the outlet box. Wire connectors will not support the weight of a fixture. Suspending a fixture by the house wires and wire connectors will result in the fixture falling, with the possibility of personal injury and the danger of electrical shock or fire.
- To reduce the risk of fire, electrical shock or personal injury, wire connectors provided with this light fixture are designed to accept only one 12-gauge house wire and two lead wires from the light fixture. If your house wire is larger than 12-gauge or there is more than one house wire to connect to the corresponding fixture lead wires, consult an electrician for the proper size wire connectors to use.
- To reduce the risk of damage to the fixture, DO NOT use power tools to assemble any part of the fixture.

### **CAUTION**

- TURN OFF ELECTRICITY at main fuse box (or circuit breaker box) before beginning installation by removing the fuse (or switching the circuit breaker off).
- If you are not sure the lighting system has a grounding means, DO NOT attempt to install this fixture. Contact a qualified, licensed electrician for information regarding the proper grounding methods as required by the local electrical code in your area.
- All fixtures must be mounted to an outlet box that is supported by the building structure.
- DO NOT use bulbs having a wattage greater than the maximum value stated on the fixture. The use of bulbs with higher wattage than specified will increase temperatures and risk of fire.
- If a dimmer control switch is used with this fixture, obtain professional advice to determine the correct type to use as well as the electrical rating required.

## **PREPARATION**

---

Before beginning assembly of product, make sure all parts are present. Compare parts with package contents list and hardware contents list. If any part is missing or damaged, do not attempt to assemble the product.

### **Estimated Assembly Time: 30 minutes**

Tools Required for Assembly (not included): Flathead screwdriver, Phillips screwdriver, wire strippers, pliers, wire cutters, safety glasses, stepladder, electrical tape.

Helpful Tools (not included): A/C tester light, do-it-yourself guide, soft cloth.

## ASSEMBLY INSTRUCTIONS

1. Turn off circuit breakers and wall switch to the fixture supply line leads.

**⚠ DANGER:** Failure to disconnect power supply prior to installation may result in serious injury or death.

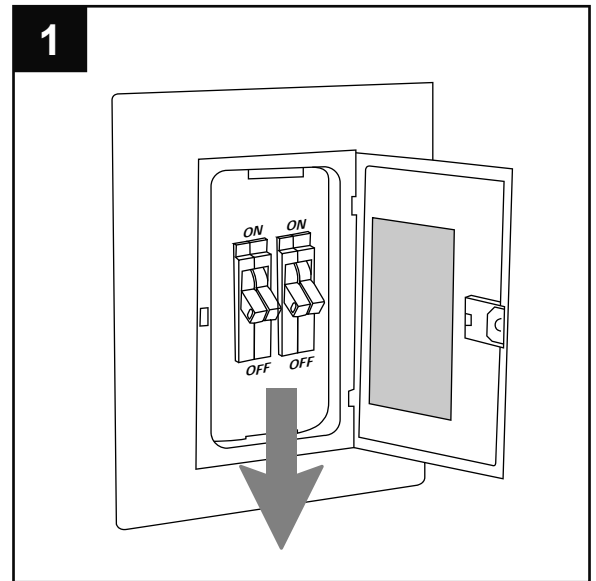

2. Remove existing fixture and disconnect all electrical wiring.

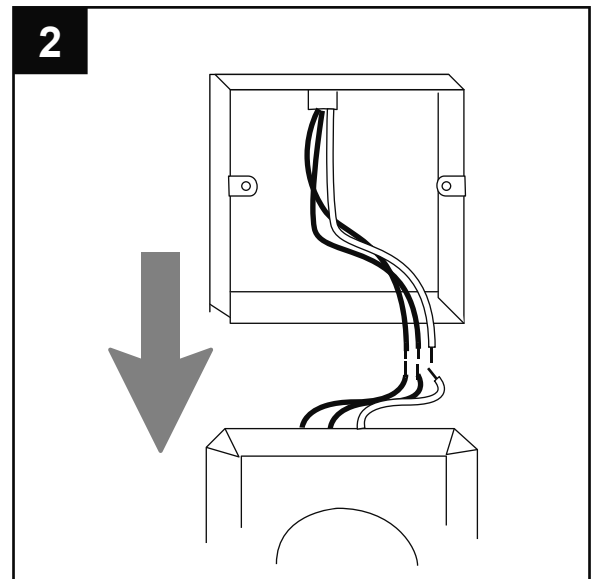

3. Remove mounting strap (B) from fixture (A) by removing mounting strap screws (C) from the edges of the canopy of fixture (A).

Save mounting strap screws (C) for later use.

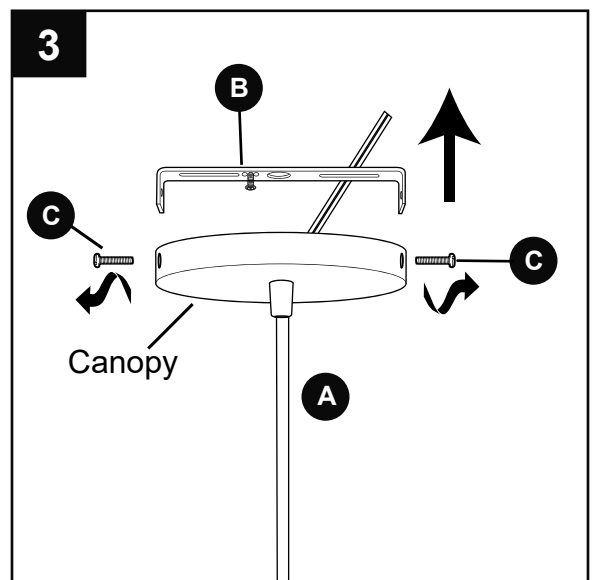

## ASSEMBLY INSTRUCTIONS

4. Attach mounting strap (B) to outlet box (not included) using existing washers and outlet box screws or the machine screws (BB). **NOTE:** If the outlet box screws required for your outlet box are of a different size than the machine screws (BB), consult a licensed electrician before proceeding.

Tighten machine screws (BB) completely to secure mounting strap (B) to outlet box.

**! CAUTION:** Make sure the outlet box can support 35 lbs. hanging weight. Use metal outlet box; plastic outlet boxes are not recommended.

### Hardware Used

**BB** Machine Screw  x 2

5. If you wish to change cord length, loosen (but do **not** remove) plastic piece pre-assembled on cord on inside of canopy of fixture (A).

Loosen cord restraint on underside of canopy and adjust cord to desired hanging length by pulling cord up through canopy until at proper length.

Tighten cord restraint to hold cord at desired length.

**! CAUTION:** DO NOT overtighten cord restraint.

Move plastic piece back over opening on inside of canopy.

6. Screw rod (D) into top of socket cover of fixture (A).

Make sure rod (D) is completely secure before proceeding.

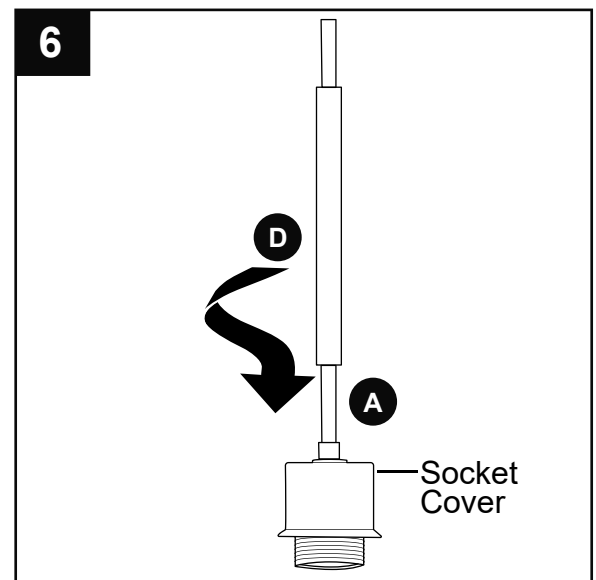
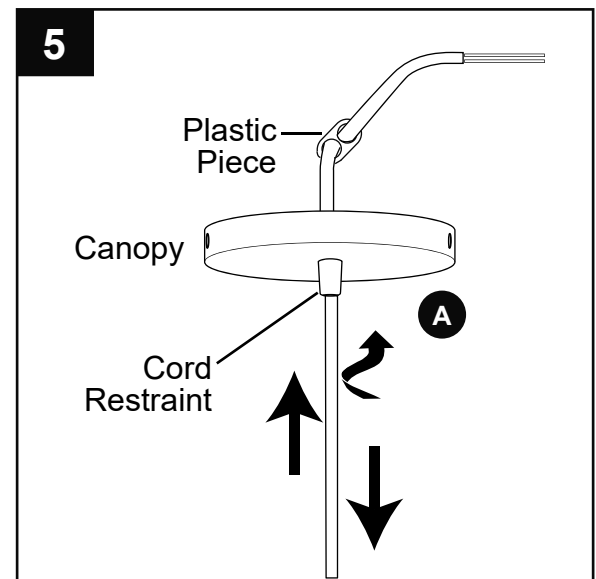
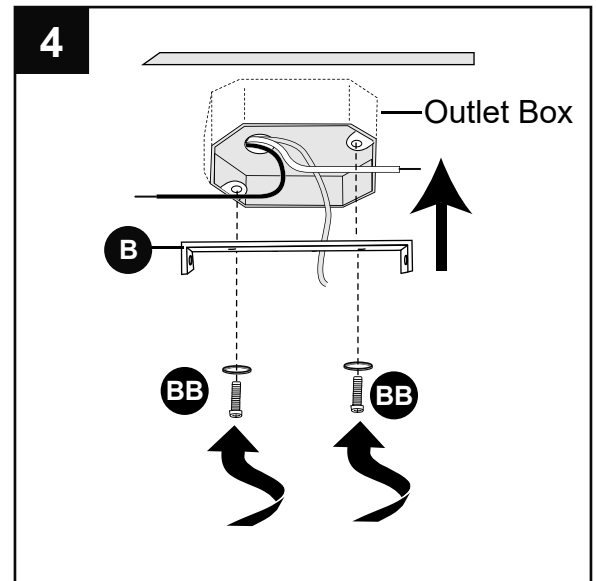

## ASSEMBLY INSTRUCTIONS

- 7a. You may need to cut the excess wire to simplify the wiring. You will need at least 10 in. of wire to work with.

Prepare wire by stripping 3/4 in. of insulation from wire ends using wire strippers (not included).

- 7b. Connect BARE/GREEN ground wire from outlet box to BARE wire from mounting strap (B) using wire connector (AA). Connect BLACK wire from fixture (A) to BLACK wire from outlet box using existing wire connector or wire connector (AA). Connect WHITE wire from fixture (A) to WHITE wire from outlet box using existing wire connector or wire connector (AA).

**NOTE:** Screw wire connectors (AA) on in a clockwise direction.

**⚠ WARNING:** Never connect BARE/GREEN ground wire to WHITE or BLACK power supply wires.

**⚠ WARNING:** To reduce the risk of fire, electrical shock or personal injury, wire connectors (AA) provided with this light fixture are designed to accept only one 12-gauge house wire and two lead wires from the light fixture. If your house wire is larger than 12-gauge or there is more than one house wire to connect to the corresponding fixture lead wires, consult an electrician for the proper size wire connectors to use.

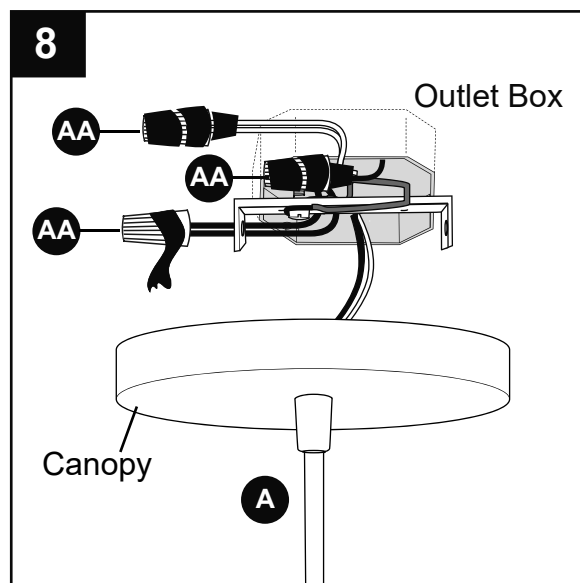
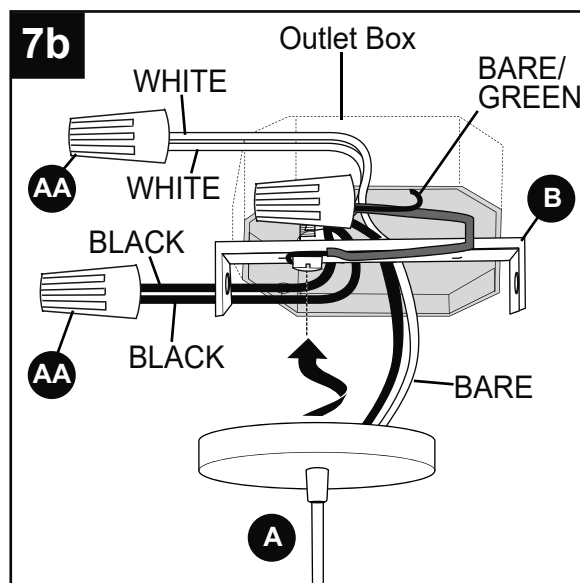
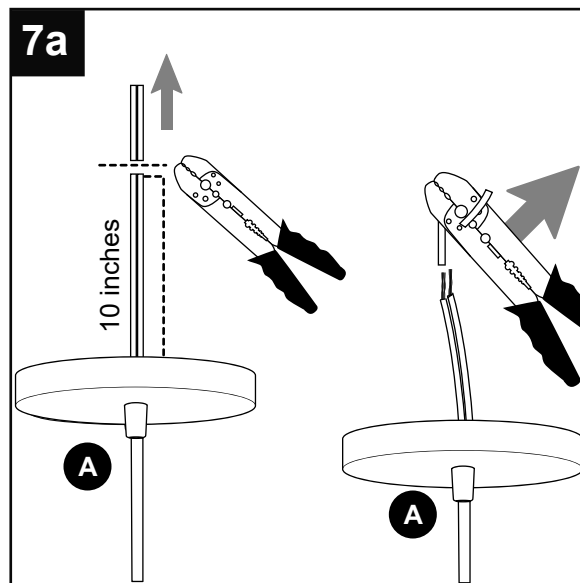

### Hardware Used

**AA** Wire Connector  x 3

8. Wrap electrical tape (not included) around each individual wire connector (AA) down to the wire.

**⚠ WARNING:** Make sure no bare wire or wire strands are visible after making connections.

Carefully arrange excess wiring and wire connectors (AA) within canopy of fixture (A).



## ASSEMBLY INSTRUCTIONS

9. Align holes in edge of canopy with screw holes at ends of mounting strap (B). Secure fixture (A) with mounting strap screws (C) that were removed in Step 3 on page 6.

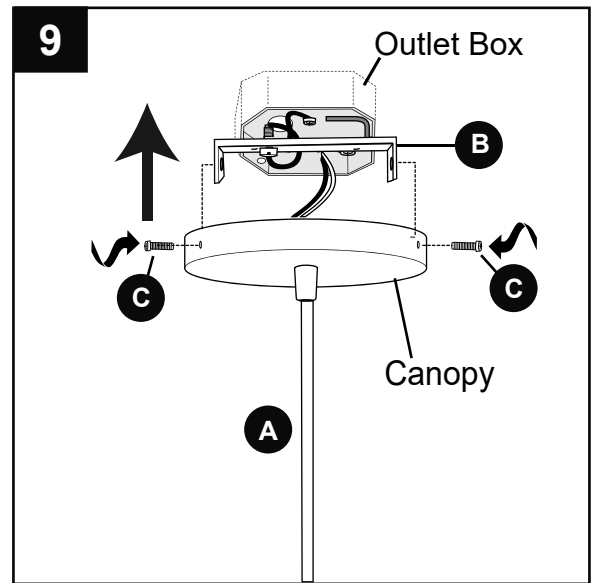

10. Remove socket ring (E) from socket on fixture (A). Attach shade (sold separately) to socket using socket ring (E).

**⚠ WARNING:** Do not overtighten socket ring (E) as shade may crack or break.

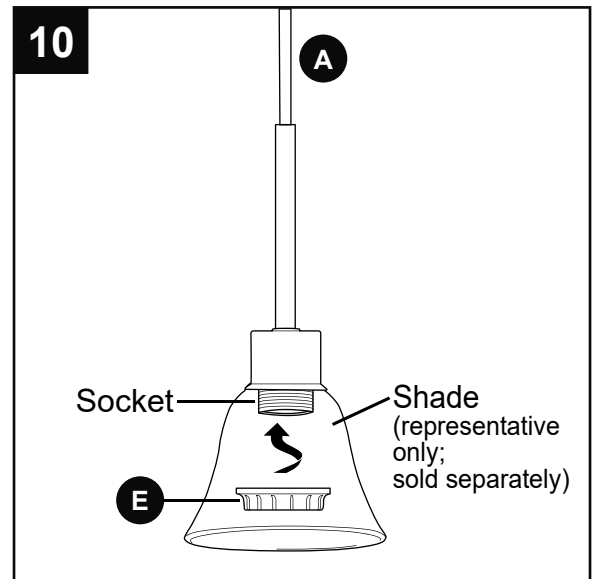

11. Install one 60-watt max. standard-base incandescent bulb (not included) or CFL/LED equivalent.

**⚠ WARNING:** When replacing bulb, please allow bulb and shade to cool down before touching.

Restore power and test fixture (A).

If light does not function, please refer to the TROUBLESHOOTING on the following page.

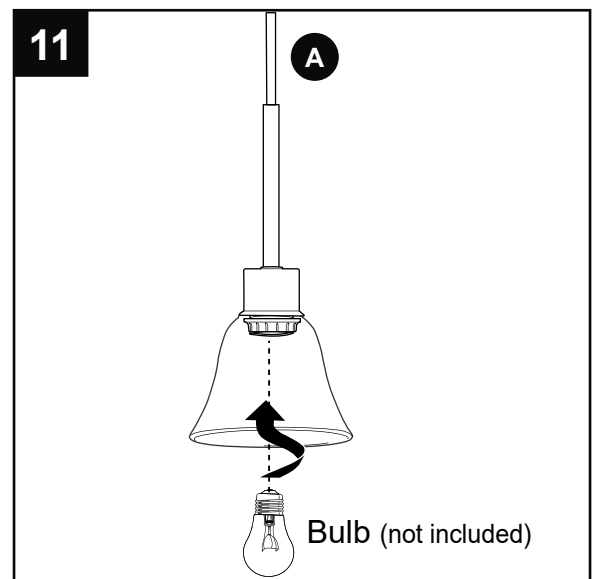

## CARE AND MAINTENANCE

---

- Shut off main power supply. Wipe fixture with soft, damp cloth. Use mild cleaner to clean shade. Do not use an abrasive cleaner on fixture.

## TROUBLESHOOTING

---

**⚠ WARNING:** Before beginning work, shut off the power supply to avoid electrical shock.

PROBLEM	POSSIBLE CAUSE	CORRECTIVE ACTION
Bulb will not light.	1. Bulb is burned out. 2. Power is OFF. 3. Faulty connection.	1. Replace light bulb. 2. Make sure power supply is ON. 3. Check wiring and all connections.
Fuse blows out or circuit breaker trips.	1. Crossed wires. 2. Power wire is grounding out.	1. Check wiring. 2. Check all connections.

## WARRANTY

---

The distributor warrants all of its lighting fixtures against defects in materials and workmanship for one (1) year from the date of purchase. If within this period the product is found to be defective, take a copy of the bill of sale as a proof of purchase and the product in its original carton to the place of purchase. The distributor will, at its option, repair, replace or refund the purchase price to the consumer. All costs of installation and removal of the fixture is the responsibility of the consumer. This warranty does not cover fixtures becoming defective due to misuse, accidental damage or improper handling and/or installation and specifically excludes liability for direct, incidental or consequential damages. As some states do not allow exclusions of limitations on an implied warranty, the above exclusion and limitation may not apply. This warranty gives you specific rights and you may also have other rights which may vary from state to state.