

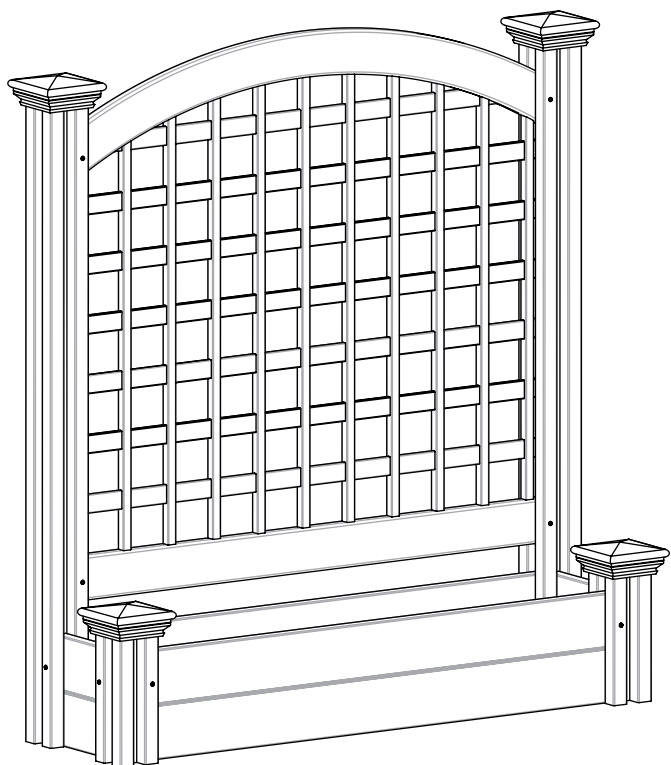

HIDE IT WITH STYLE



## Belmont Freestanding Lattice Screen W/ Planter Box

(45 1/2"H X 42" W X 11 1/4" L)

**45 min**

*Approximate assembly time*



**Scan the QR code**  
*for an assembly video*



## ASSEMBLY INSTRUCTIONS

[www.encloscreens.com](http://www.encloscreens.com)

VER. 111021

## GENERAL INFORMATION



### IMPORTANT

- ◀ A cordless drill with a Phillips head bit will be required for the assembly of this product.
- ◀ Check the inside of the larger pieces in your box for other materials packed inside.
- ◀ When assembling components, place on a non-abrasive surface (i.e. shipping box) to avoid scratching.
- ◀ We recommend an area approximately 5'x 8' for unobstructed assembling.
- ◀ You should not need to use excessive force when assembling components.

## MISSING OR DAMAGED PARTS?

### VISIT OUR WEBSITE FIRST, SO WE CAN HELP YOU RIGHT AWAY!

Although great care has been taken to ensure proper packaging and handling of this product, occasionally problems occur. If you discover any missing, damaged or defective parts, please visit our website to order replacement parts. If you experience any further trouble with your product, please contact our customer service department.

 [parts.nychbrands.com](http://parts.nychbrands.com)

 [support@encloscreens.com](mailto:support@encloscreens.com)

 **704-892-5222 / 877-234-6196**

*Customer service agents are available to take calls weekdays from 9am-5pm EST. If you call outside of business hours, please leave a voicemail.*

To help you quickly and accurately, please have reference item number **EC18005** and the specific part name which can be found on page 4. It is helpful if you can provide the batch lot which is a stamped number on the end of the box.

## NEED ASSEMBLY HELP?

If you are having problems with the assembly or installation of this product, we are happy to assist you with the process, **so please give us a call at 704-892-5222 / 877-234-6196.**

## NEED TO RETURN?

If for some reason you need to return this product, please allow us to help resolve your issues first. If you still decide to return the product, **you will need to initiate the return from the company you originally purchased from.**

## Detailed Product Dimensions & Specifications

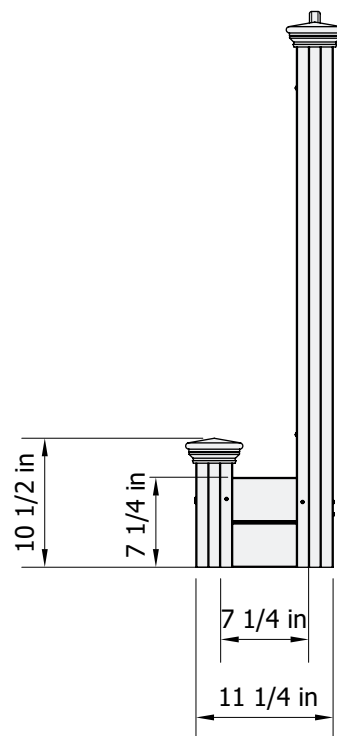
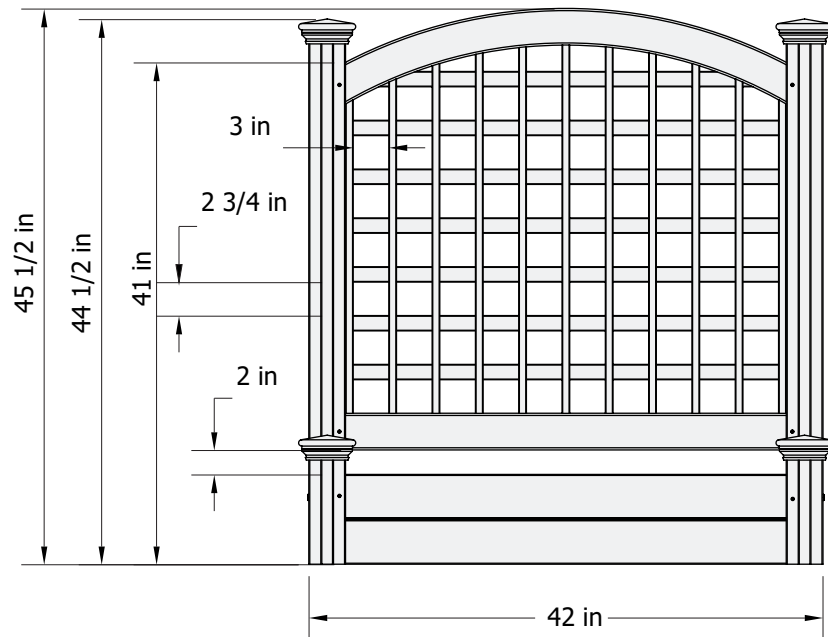

## STEP 1: LAY OUT MATERIALS

A

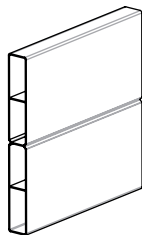

**Side Board (2)**  
 $\frac{7}{8}$ " x  $7\frac{1}{4}$ " x  $7\frac{1}{4}$ "

B

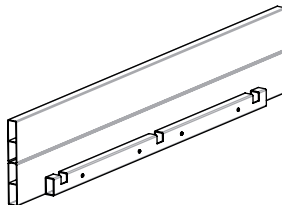

**Long Board (2)**  
 $\frac{7}{8}$ " x  $7\frac{1}{4}$ " x 38"

C

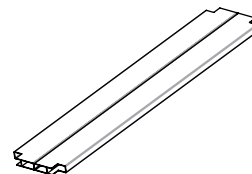

**Floor Board (1)**  
 $\frac{7}{8}$ " x  $7\frac{1}{4}$ " x 38"

D

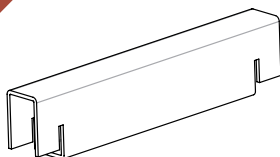

**Floor Support (3)**  
 $\frac{7}{8}$ " x  $1\frac{1}{2}$ " x 7"

E

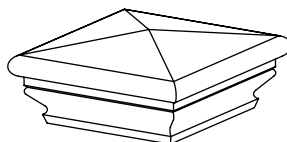

**Post Cap (4)**

F



**Short Post (2)**  
 3" x 3" x 10"

G



**Long Post (2)**  
 3" x 3" x 44"

H

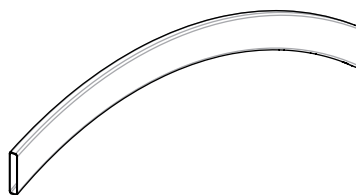

**Arched Top Rail (1)**  
 $\frac{7}{8}$ " x  $8\frac{1}{2}$ " x 38"

I

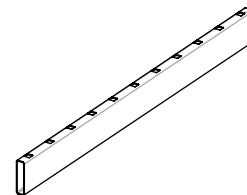

**Bottom Rail (1)**  
 $\frac{7}{8}$ " x 3" x 38"

J

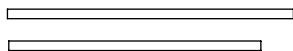

**Horizontal Slat (7)**  
 Slat 1 (6)  $\frac{1}{4}$ " x  $1\frac{1}{4}$ " x 38"  
 Slat 2 (1)  $\frac{1}{4}$ " x  $1\frac{1}{4}$ " x  $33\frac{1}{2}$ "

K

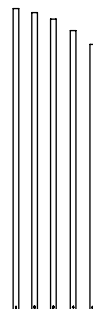

**Vertical Picket (11)**  
 Picket 1 (3)  $\frac{5}{8}$ " x  $\frac{5}{8}$ " x  $35\frac{1}{2}$ "  
 Picket 2 (2)  $\frac{5}{8}$ " x  $\frac{5}{8}$ " x 35"  
 Picket 3 (2)  $\frac{5}{8}$ " x  $\frac{5}{8}$ " x  $34\frac{1}{4}$ "  
 Picket 4 (2)  $\frac{5}{8}$ " x  $\frac{5}{8}$ " x 33"  
 Picket 5 (2)  $\frac{5}{8}$ " x  $\frac{5}{8}$ " x  $31\frac{1}{2}$ "

L



**2 1/2" Self-Drilling  
 Stainless Steel Screw (12)**

## STEP 2: ASSEMBLE PLANTER BOX

### STEP 2.1

1. Lay out the Short Posts (**F**) and slide (1) Long Board (**B**) into the post channels.
2. Rotate the posts and board 180 degrees. Drive (2) 2 1/2" Self-Drilling Stainless Steel Screws (**L**) through the pre-drilled holes in the posts as shown below.

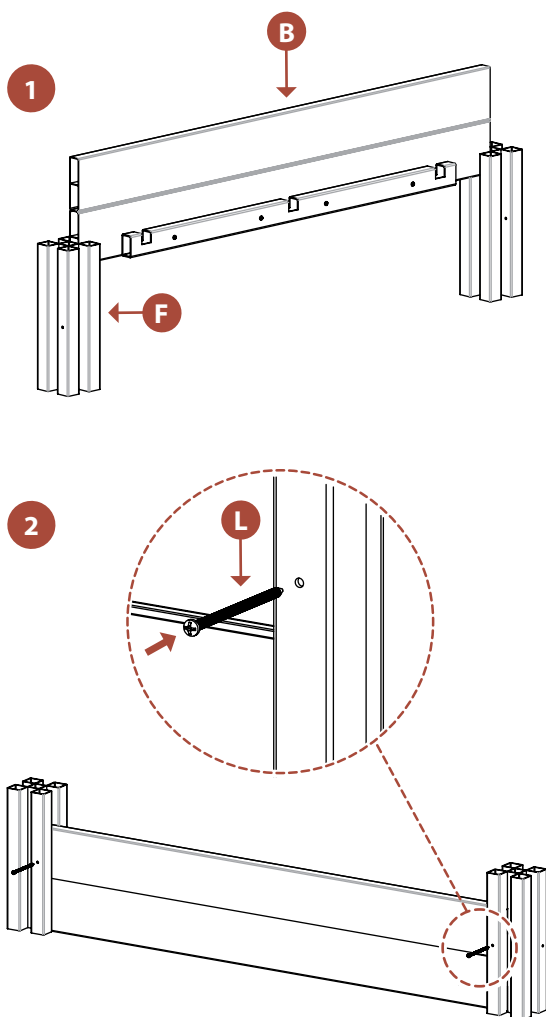

Ensure that the long board is touching the back of the post channels.

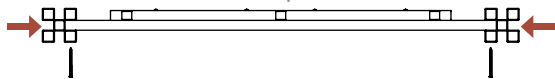

### STEP 2.2

- ◀ Repeat step 2.1 with the Long Posts (**G**). Ensure that the long board is touching the back of the post channels.

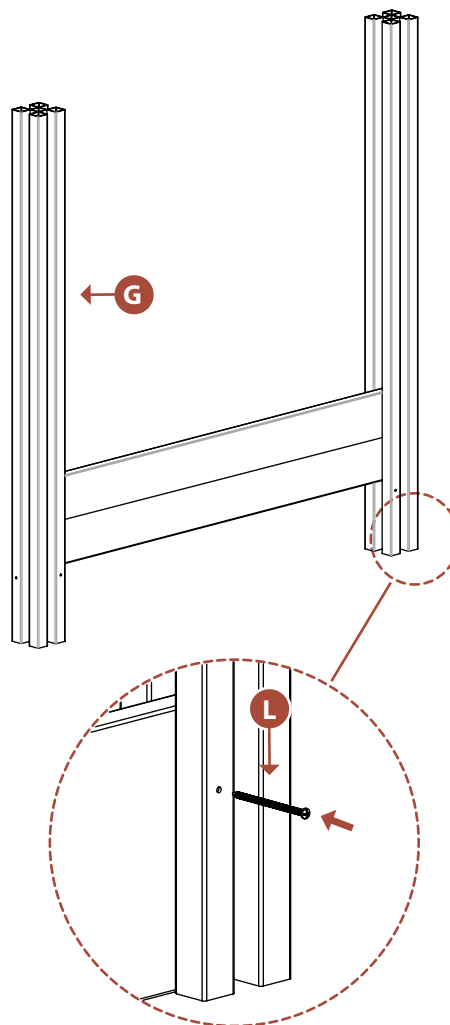

Ensure that the long board is touching the back of the post channels.

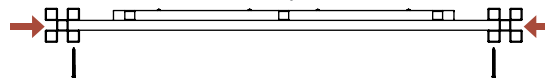

## STEP 2.3

1. Slide the Side Boards (A) between the two assembled planter sections.
2. Drive (4) 2½" self-drilling stainless steel screws through the pre-drilled holes on the inside face of the posts to secure the side boards.

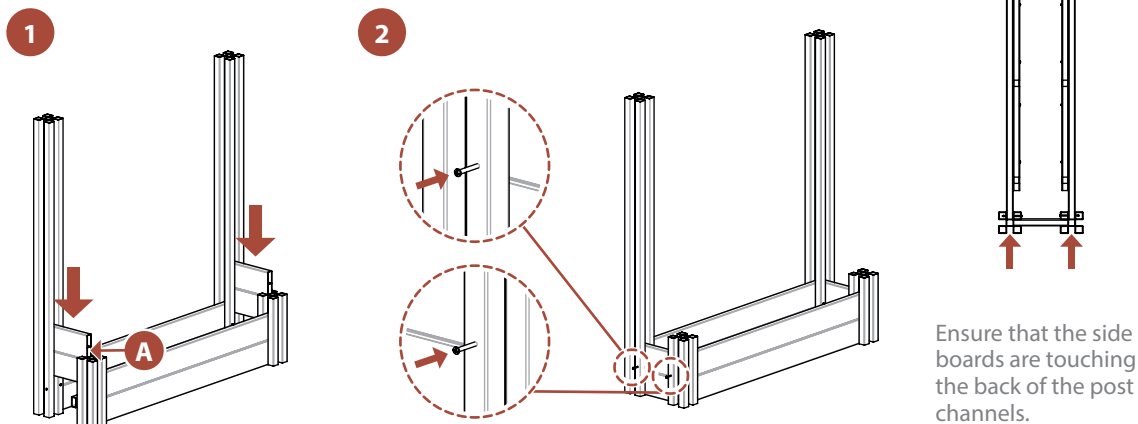

## STEP 2.4

1. Slide the notch of the Floor Supports (D) over the inside wall of the routed section of the long boards.
2. Place the Floor Board (C) inside the planter box until it rests on the floor supports.

## (Optionally)

3. If your planter box will be outside, it is recommended to drill (2) ¾" diameter holes through the floor board for water drainage.

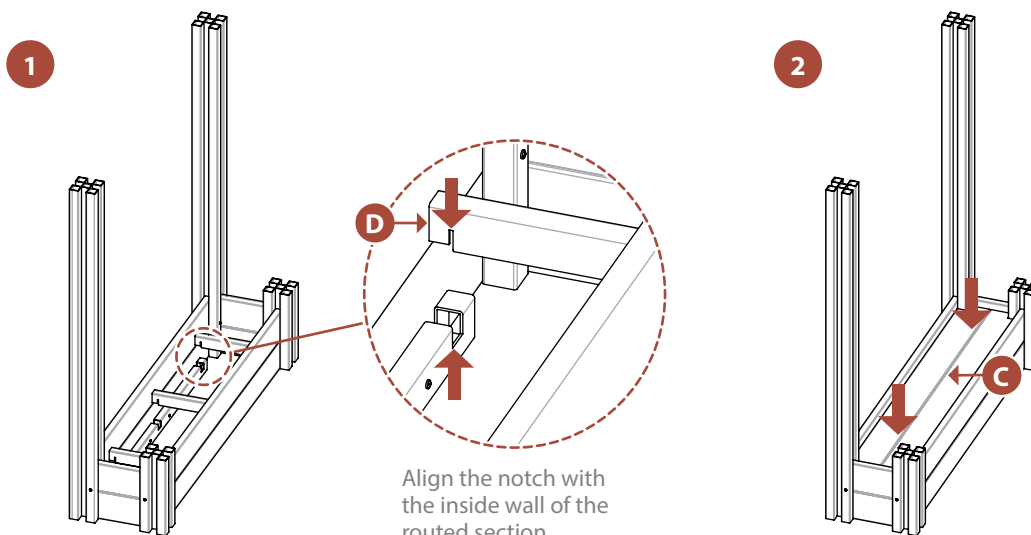

## STEP 3: ASSEMBLE LATTICE SECTION

### STEP 3.1

1. Insert the Vertical Pickets (K) into the Bottom Rail (I) in the pattern shown.
2. Insert the shorter Horizontal Slat 2 (J) into the top routed picket holes.

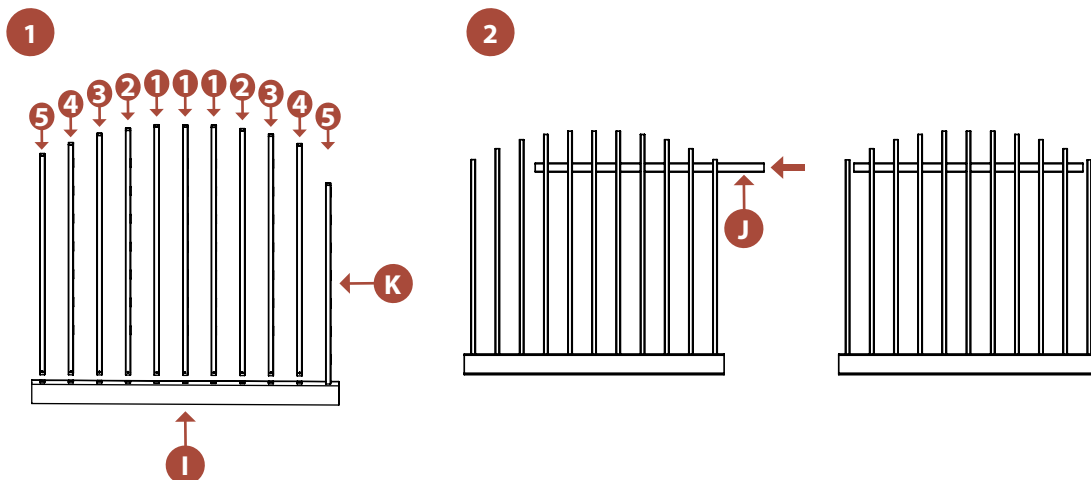

### STEP 3.2

1. Install the Arched Top Rail (H) over the vertical slats and horizontal slat 2.
2. Insert (6) horizontal slat 1 pieces into the routed holes in the vertical pickets.

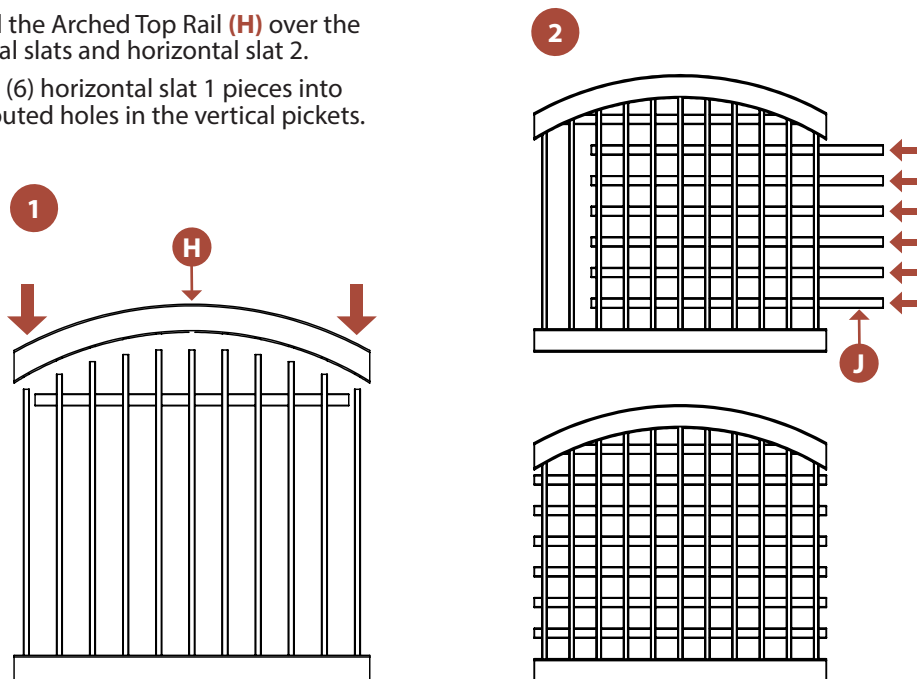

## STEP 4: INSTALL LATTICE SECTION

### STEP 4.1

1. Slide the assembled lattice section into the inner post channels of the long posts until the bottom rail is 2" above the planter box.
2. Drive (4) 2½" self-drilling stainless steel screws into the back of the tall posts as shown below to secure the lattice section.

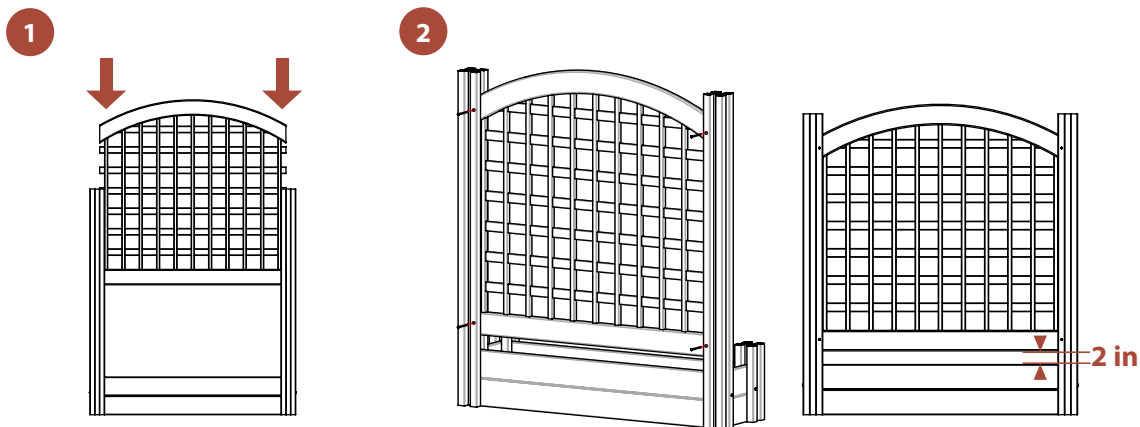

## STEP 5: INSERT POST CAPS

### STEP 5.1

- Fit (4) Post Caps (E) over the short and tall posts.

Note: If you would like to secure your post caps, apply a small amount of vinyl glue to the inside rim of the caps to fix them to the posts.

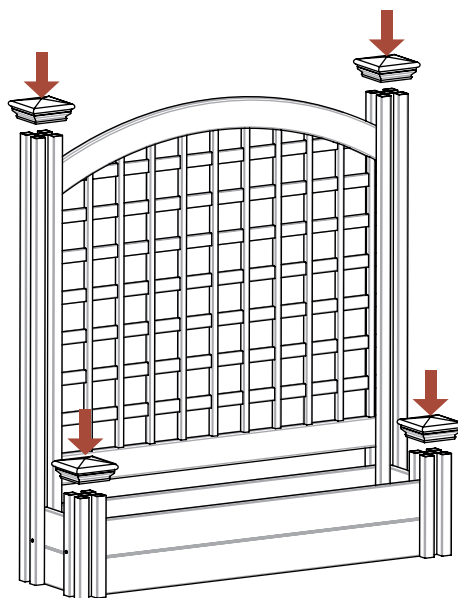







HIDE IT WITH STYLE

[www.encloscreens.com](http://www.encloscreens.com)

[support@encloscreens.com](mailto:support@encloscreens.com)



**704-892-5222**  
**877-234-6196**



*6935 Reames Rd. Ste. K.*  
*Charlotte, NC 28216*



**ASSEMBLY**  
INSTRUCTIONS