

A



Fasteners:

AA



F/H Screw, #8 x 1-3/4"
2 PCS

BB

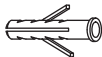

Anchor, M6 x 30 mm
2 PCS

CC



Wood Plug, for natural Bracket
2 PCS



Plastic Plug, for white Bracket
2 PCS

1

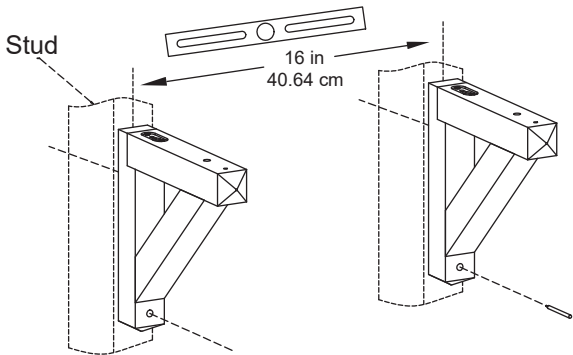

2

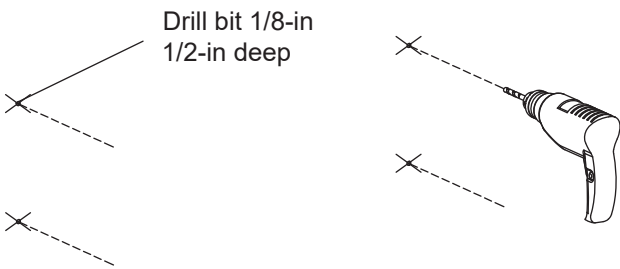

If using anchor, the hole size not less than drill bit 3/16-in 1-3/4" deep

3-1 For drywall or wood

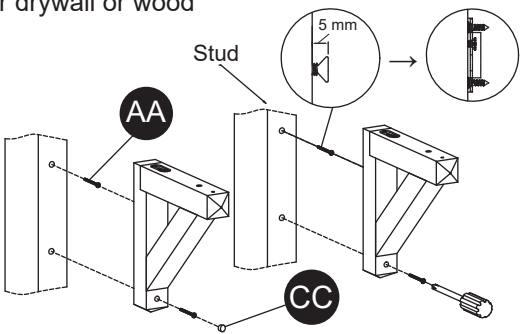

3-2 For Concrete Wall

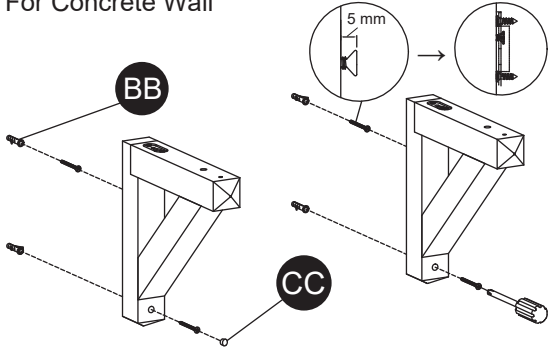

4

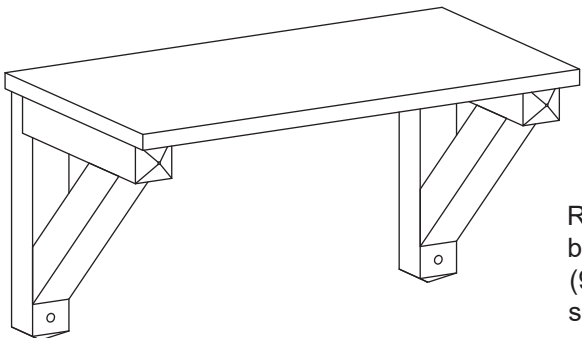

Recommended :
board size: 250 x 15 x 458 mm
(9.85" x 0.59" x 18")
screw size: F/H #8 x 1" x 2