

Product images are for illustration purposes only. Actual product(s) may vary.

## DESCRIPTION:

- Double bowl 10° radius kitchen sink
- Topmount install
- Handcrafted from T-304 brushed stainless steel
- Durable commercial-grade 16 gauge thickness
- Off-set Back Drain location
- Drain groove design
- StoneGuard undercoated over rubber pad
- Sink grids and basket strainers included

## MINIMUM CABINET SIZE:

34" / 864mm

## SINK GRID OPTION

BG3540 (x2)

## FINISH:



BRUSHED STAINLESS STEEL

## SHIPPING INFORMATION:

- Length: 33" / 838mm
- Net Weight: 15 kg / 33 lbs.
- Width: 22" / 559mm
- Gross Weight: 18 kg / 40 lbs.
- Height: 11" / 279mm

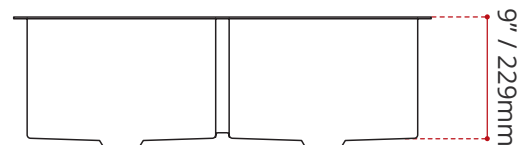
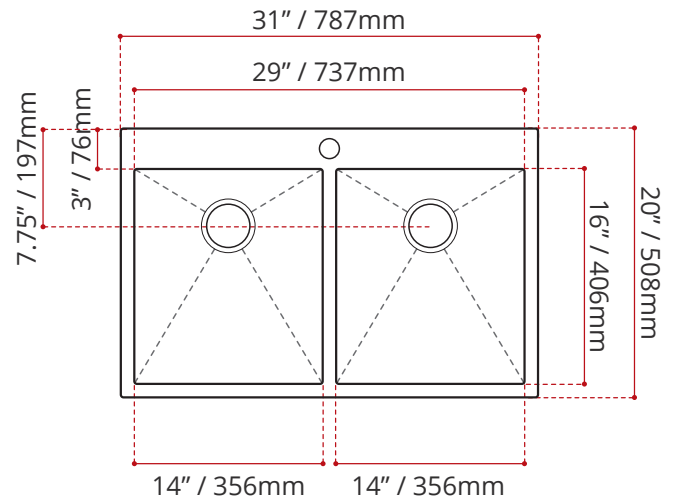

DISCLAIMER:  
Measurements may vary  $\pm \frac{1}{4}$ "  
(Diagram Not to scale)