

## ASSEMBLY INSTRUCTIONS



### CAUTION

◆ Inspect the wire insulation for any cuts, abrasions, or exposed copper that may have resulted during shipping. If there is a defect in the wire, do not attempt installation.

◆ Before starting installation of this fixture or removal of a previous fixture, disconnect the power by turning off the circuit breaker or by removing the fuse at the fuse box.

## TOOLS REQUIRED



Ladder



Safety glasses



Electrical tape



Phillips screwdriver



Flat blade screwdriver



Pliers

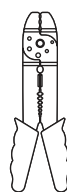

Wire strippers

## HARDWARE INCLUDED

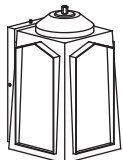

Fixture



Cover

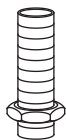

Threaded Pipe and Hex Nut



Rubber Ring A



Nut



Iron



Rubber Ring B



Decorative Nut



Mounting Unit



Screws



Mounting Screws



Wire Nuts

**\*PARTS SHOWN MAY DIFFER SLIGHTLY PER LIGHT FIXTURE**

## EXPLODED PARTS

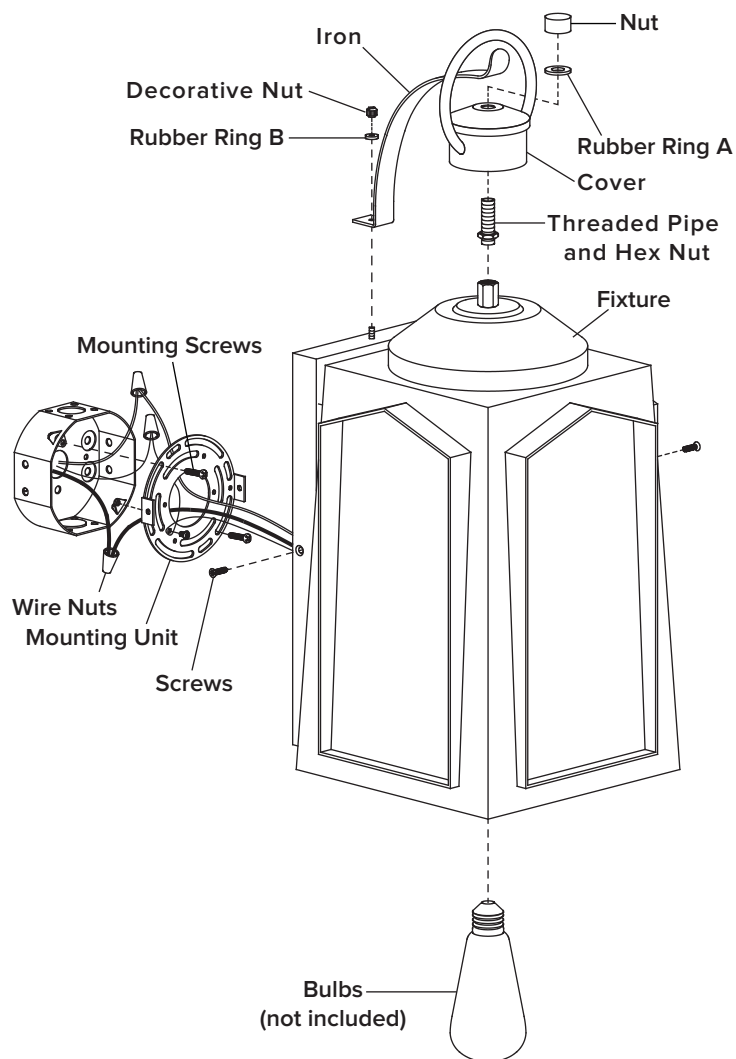

## INSTALLATION

### STEP 1

Unscrew the **rubber rings** and **screws** from the **mounting unit**. Use the **mounting screws** to attach the **mounting unit** to the junction box.

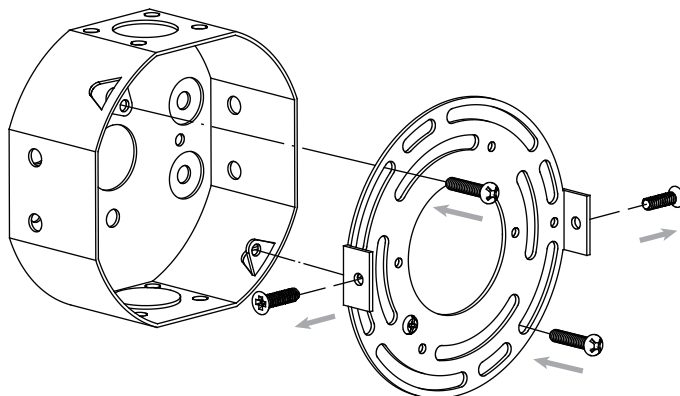

### STEP 2

Screw the **threaded pipe and hex nut** into the **fixture**, then secure it with **hex nut**.

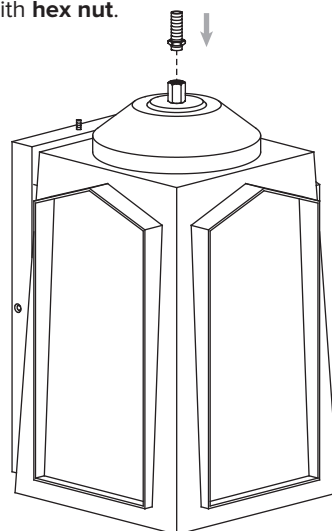

## ASSEMBLY INSTRUCTIONS (INSTALLATION)

### STEP 3

Place the top **cover** onto the **threaded pipe**, then secure with **rubber ring A** and **nut**.

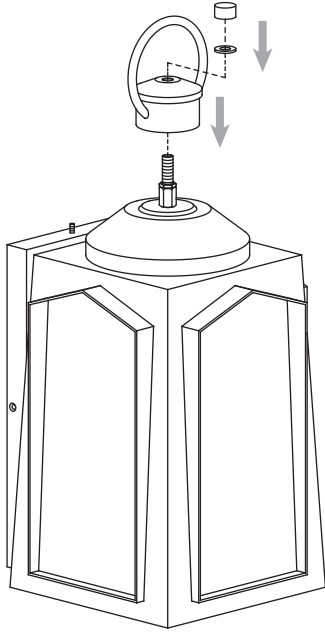

### STEP 4

Attach the **iron** to the **fixture** through screw holes as shown, and secure it **rubber ring B** and **decorative nut**.

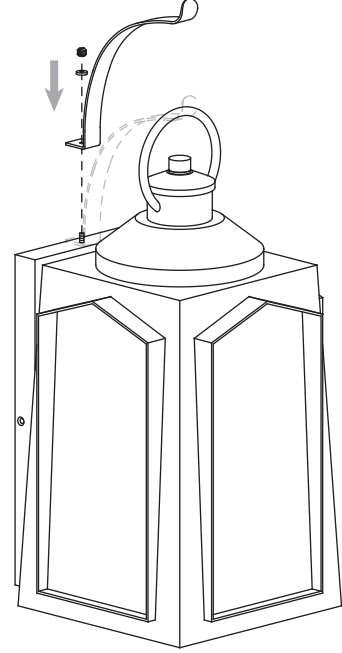

### STEP 5

Make the electrical connection from the junction box to the **fixture**. Connect the ground wire to the **mounting unit** using the preinstalled green ground screw. Then, connect the positive, negative and ground wires with the supplied **wire nuts**. Secure with electrical tape.

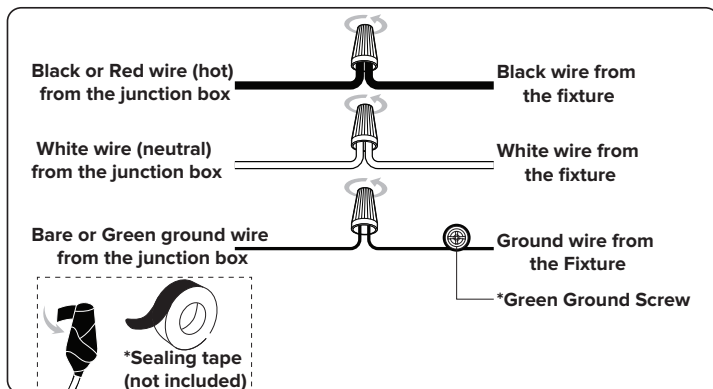

NOTICE: Please use caulk in the back plate and wall mounting surface to prevent water from entering.

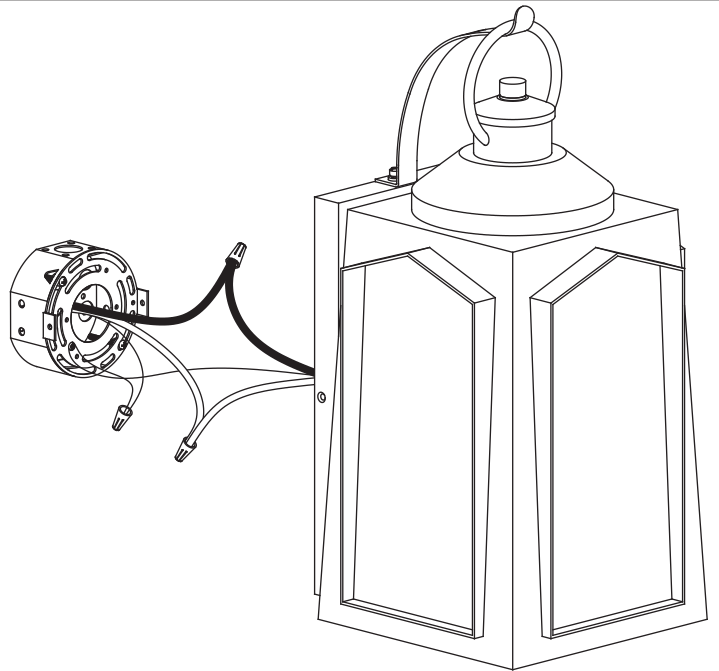

### STEP 6

Attach the **fixture** to **mounting unit** through **screw holes** as shown, and secure it with **screws**.

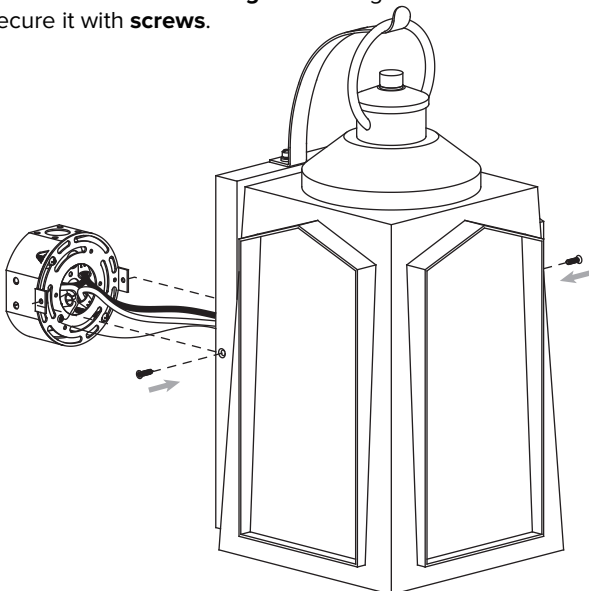

### STEP 7

Install bulbs (not included).

