



ITEM #6020795/6601152/6601148/6601149

MODEL #43582/43565/43566/43567

EDENMORE FANDELIER

Español p. 15

HARBOR BREEZE and logo design are trademarks or registered trademarks of LF, LLC. All rights reserved.

ATTACH YOUR RECEIPT HERE

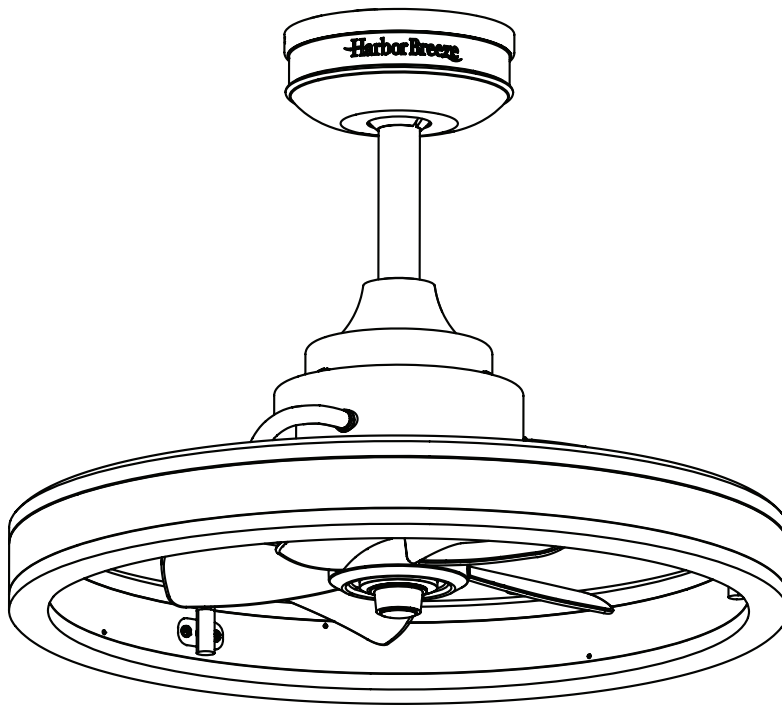

Intertek

Purchase Date _____

Thank you for purchasing this HARBOR BREEZE product.

Questions, problems, or missing parts?

Before returning, contact us at:

888-251-1003, 8 a.m. - 8 p.m., EST, Monday - Sunday or at **ascs@lowes.com**.

TABLE OF CONTENTS

Package Contents. 3

Preparation 3

Safety Information. 4

Initial Installation. 6

Wiring. 9

Final Installation. 10

Operating Instructions. 11

Care and Maintenance. 12

Troubleshooting. 12

Warranty. 13

Replacement Parts List 14

PACKAGE CONTENTS

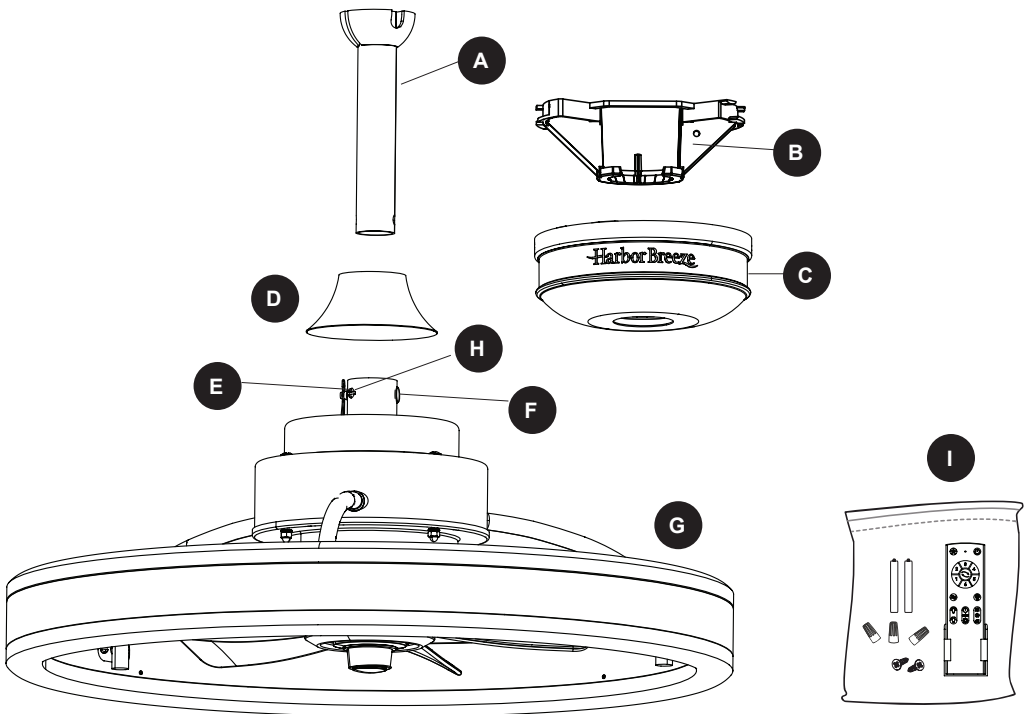

PART	DESCRIPTION	QUANTITY
A	Downrod	1
B	Mounting Bracket (preassembled to Canopy [C])	1
C	Canopy	1
D	Yoke Cover	1
E	Downrod Clip (preassembled to Fan Assembly (G))	1
F	Downrod Pin (preassembled to Fan Assembly (G))	1
G	Fan Assembly	1
H	Set Screw	2
I	Remote Pack	1

PREPARATION

Estimated Assembly Time: 30 minutes

Tools Required for Assembly (not included): Step ladder, Phillips screwdriver, Wire stripper/cutter, safety glasses, and electrical tape.

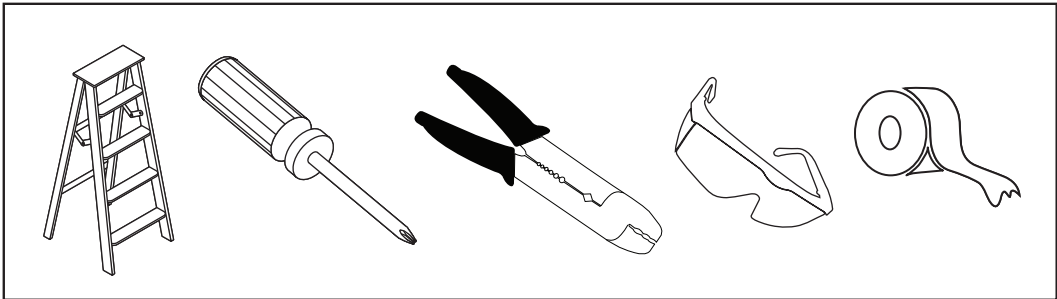

SAFETY INFORMATION

Please read and understand this entire manual before attempting to assemble, operate or install the product. Failure to do so could lead to electrical shock, fire or other injuries that could be hazardous or even fatal.

- Before you begin installing the fixture, disconnect the power by removing fuses or turning off the circuit breakers.
- Make sure that all electrical connections comply with local codes, ordinances, the National Electrical Code, and ANSI/NFPA 70-199. Hire a qualified electrician or consult a do-it-yourself wiring handbook if you are unfamiliar with installing electrical wiring.
- The net weight of the fixture is 9.174 lbs (4.17 kg).
- **RATED FOR INDOOR USE.** This fan is not suitable for damp or outdoor locations.



DANGER:

- **DO NOT** connect this fixture to an electrical system that does not provide a means for equipment grounding. Never use a fixture in a two-wire system that is not grounded. Installing a fixture into an electrical system not having a proper grounding means could cause metal parts of the fixture to carry electrical currents if any of the fixture wires, wire connections or splices were to become broken, cut or loose during the mounting or normal operation of the fixture. Under this condition, anyone coming in contact with the fixture would be subject to electrical shock, which could cause serious injury or death.
- **DO NOT** connect the bare or green insulation fixture ground wire to the black (hot) current-carrying wire or the white neutral house wire. Connection of the bare or green fixture ground wire to the black or white house wires may cause metal parts of the fixture to carry electrical currents. Under this condition anyone coming in contact with the fixture will receive electrical shock, which could cause serious injury or death.
- **DO NOT** damage or cut the wire insulation (covering) during installation of the fixture. **DO NOT** permit wires to contact any surface having a sharp edge. To do so may damage or cut the wire insulation, which could cause serious injury or death from electrical shock.



WARNING:

- All electrical connections must be in agreement with local codes and ordinances, the National Electric Code (NEC) and ANSI/NFPA 70-1999. Contact your municipal building department to learn about your local codes, permits and/or inspections. Risk of fire - most dwellings built before 1985 have supply wire rated for 140°F. Consult a qualified electrician before installation.
- To avoid personal injury, the use of gloves may be necessary while handling fixture parts with sharp edges.
- **DO NOT** suspend any fixture by the house wires. A fixture must always be mounted directly to an outlet box. Wire connectors will not support the weight of a fixture. Suspending a fixture by the house wires and wire connectors will result in the fixture falling, with the possibility of personal injury and the danger of electrical shock or fire.

SAFETY INFORMATION

WARNING:

- To reduce the risk of fire, electrical shock, or personal injury, each wire connector used with this fixture should accept only one 18-gauge wire from the fixture and one 18-gauge wire from the outlet box. If there are three or more wires to connect or any of the wires is larger than 18 gauges, consult an electrician for the proper size wire connectors to use.

CAUTION:

- To reduce the risk of personal injury, do not bend the blades. Do not insert any objects in the path of the blades.
- This device complies with part 15 of FCC Rules. Operation is subject to the following two conditions: 1) This device may cause harmful interference, and 2) this device must accept any interference received, including interference that may cause undesired operation.
- This equipment has been tested and found to comply with the limits for a Class B digital device, pursuant to Part 15 of the FCC Rules. These limits are designed to provide reasonable protection against harmful interference in a residential installation. This equipment generates, uses and can radiate radio frequency energy and, if not installed and used in accordance with the instructions, may cause harmful interference to radio communications. However, there is no guarantee that interference will not occur in a particular installation. If this equipment does cause harmful interference to radio or television reception, which can be determined by turning the equipment off and on, the user is encouraged to try to correct the interference by one or more of the following measures:
 - Reorient or relocate the receiving antenna.
 - Increase the separation between the equipment and receiver.
 - Connect the equipment into and outlet on a circuit different from that to which the receiver is connected.
 - Consult the dealer or an experienced radio/TV technician for help.

Please note changes or modifications not expressly approved by the party responsible for compliance could void the user's authority to operate the equipment.

HKC-US, 3350 Players Club Parkway, Suite 225, Memphis, TN 38125, 1-888-251-1003

INITIAL INSTALLATION

1. Turn off the circuit breakers and the wall switch to the supply line leads.

⚠ DANGER: Failure to disconnect the power supply prior to installation may result in serious injury or death.

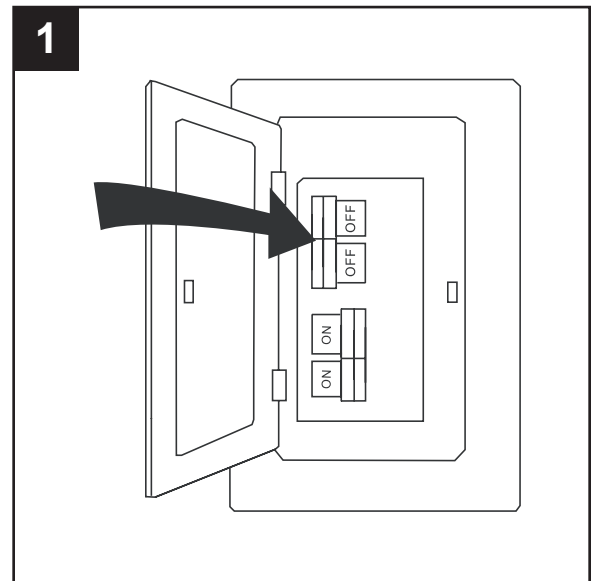

2. Determine the mounting method to use.

Standard Mounting is best suited for ceilings 8 ft. or higher. For taller ceilings you may want to use a longer downrod (not included).

Angle Mounting is best suited for angled or vaulted ceilings. A longer downrod is sometimes necessary to ensure proper blade clearance.

Important: If using the angle mount, check to ensure the ceiling angle is not steeper than 16°.

Flushmount is not available for this item.

Closemount is not available for this item.

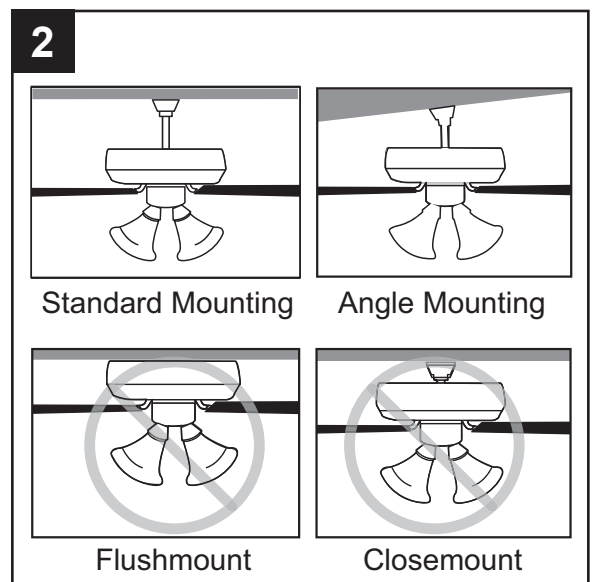

3. Ensure the blades will be at least 30 in. from any obstructions. Also check the downrod (A) length to ensure the blades will be at least 7 ft. above the floor.

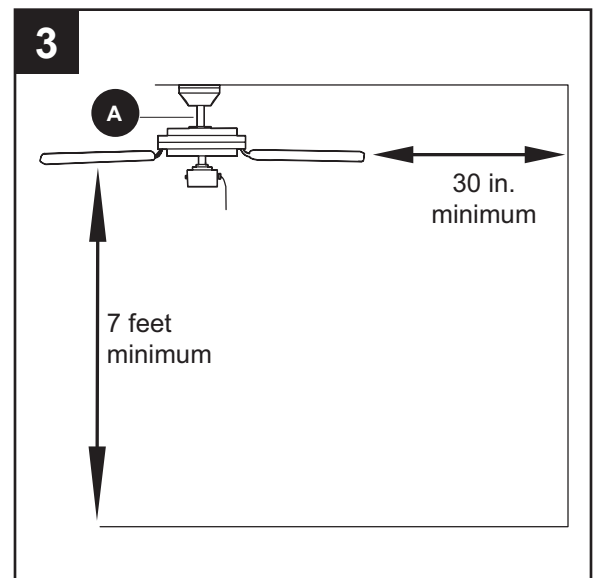

INITIAL INSTALLATION

4. Firmly hold canopy (C) while twisting the mounting bracket (B) counterclockwise to remove.

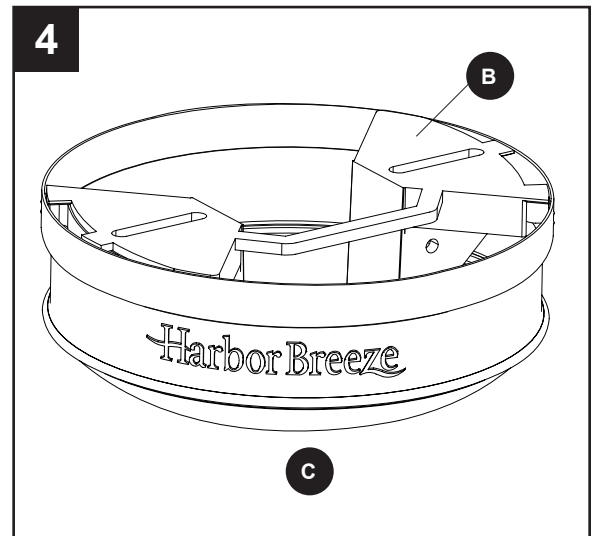

5. Attach mounting bracket (B) to outlet box (not included) using screws and washers provided with the outlet box.

CAUTION: It is very important to use the proper hardware when installing the mounting bracket (B) as this will support the fan.

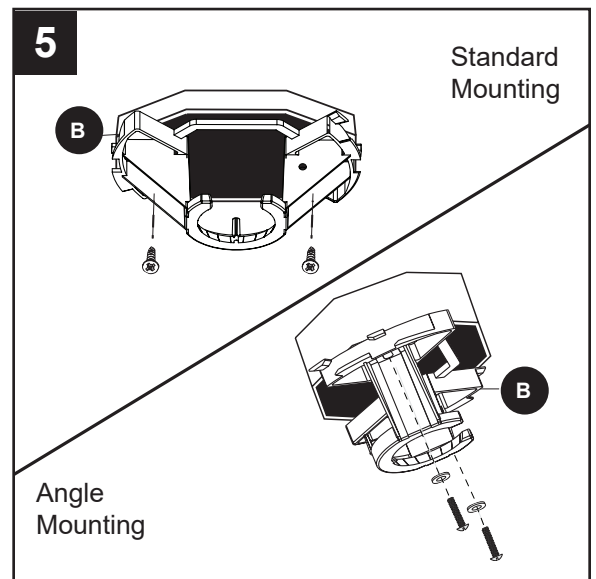

6. Remove the downrod clip (E) and downrod pin (F) from the yoke. Then partially loosen the set screws (H) in the yoke at the top of the fan assembly (G).

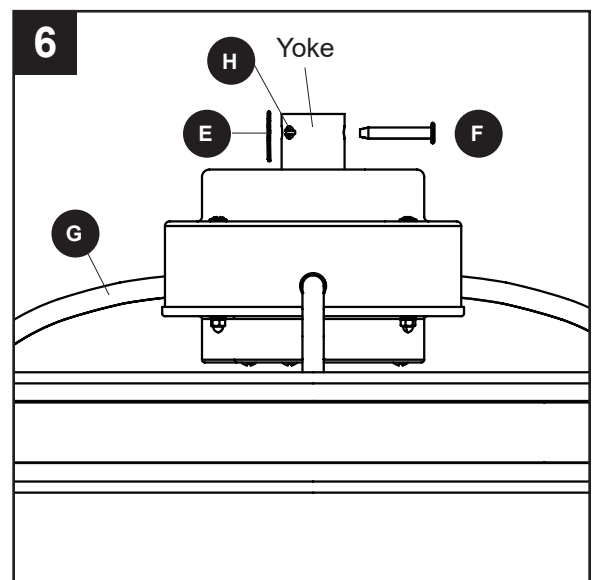

INITIAL INSTALLATION

7. Insert the downrod (A) -- or a longer downrod (not included), if required -- through the canopy (C) and yoke cover (D). Feed the wires from the fan through the downrod (A).

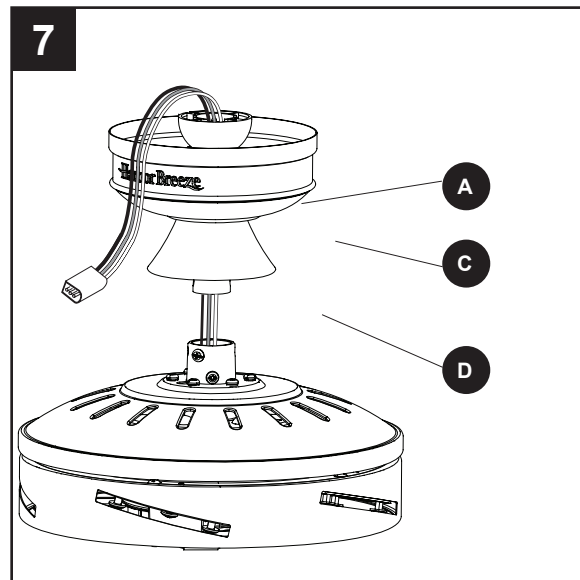

8. Slide the downrod (A) into the yoke, align the holes, then reinstall the downrod pin (F) and downrod clip (E). Secure with set screws (H) and slide the yoke cover (D) down until it rests on top of the fan assembly (G).

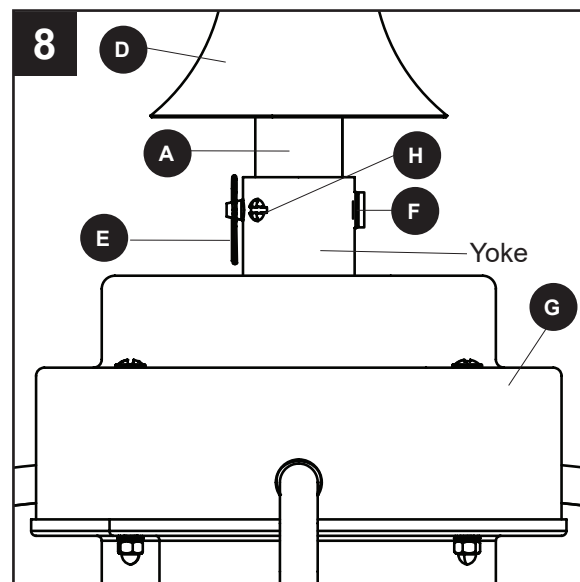

9. Install the ball end of the downrod (A) into the opening of the mounting bracket (B). Align a slot in the ball with the tab in the mounting bracket (B).

Important: The downrod (A) should not rotate in the mounting bracket (B) if installed properly.

DANGER: Failure to align a slot in the ball with the tab may cause the fan to wobble or fall, which could result in serious injury or death.

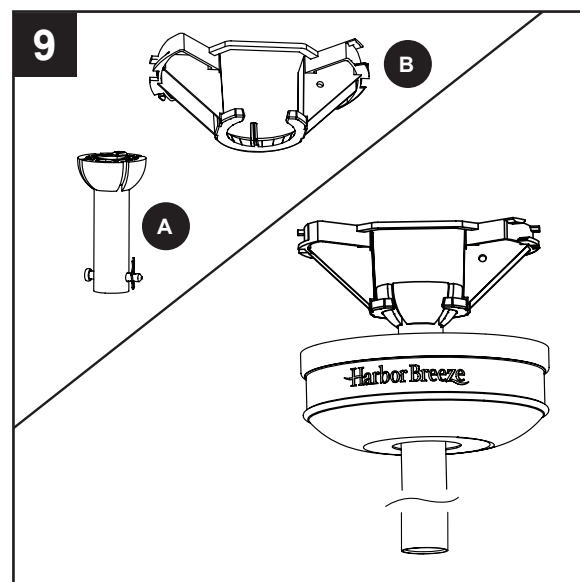

WIRING

⚠ WARNING: To reduce the risk of fire, electrical shock or personal injury, wire connectors provided with this fan are designed to accept only one 12-gauge house wire and two lead wires from the fan. If your house wire is larger than 12-gauge and there is more than one house wire to connect to the two fan lead wires, consult an electrician for the proper size wire connectors to use.

CAUTION: Be sure the outlet box is properly grounded or that a ground (green or bare) wire is present.

1. Secure all wiring connections together with wire connectors from remote pack (I) according to the diagram and these steps:
 - Connect the green wires from the downrod (A) and mounting bracket (B) to the bare/green (ground) supply wire.
 - Connect the Black wire from fan assembly (G) to the Black (hot) supply wire.
 - Connect the White wire from fan assembly (G) to white (neutral) supply wire.

Note: If household supply wires are different colors than referred to above, it is recommended a professional electrician determines the proper wiring.

2. Wrap electrical tape (not included) around each individual wire connector down to the wire.

3. Turn the spliced/taped wires upward and gently push the wires and wire connectors into the outlet box.

⚠ WARNING: Ensure no bare wire or wire strands are visible after making connections. Place the Green and White wire connections on the opposite side of the outlet box from the Black wire connections.

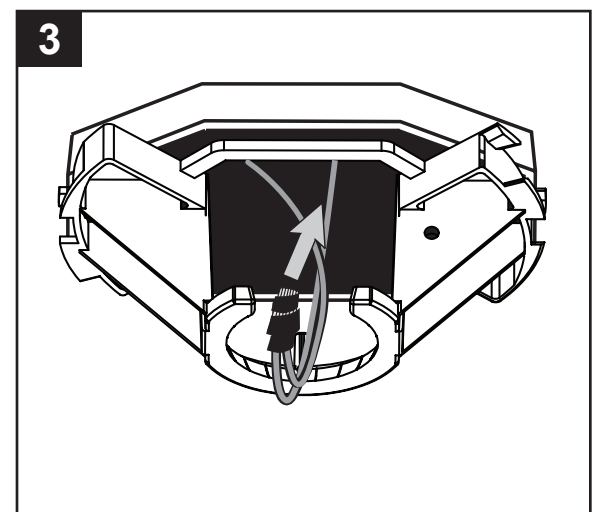
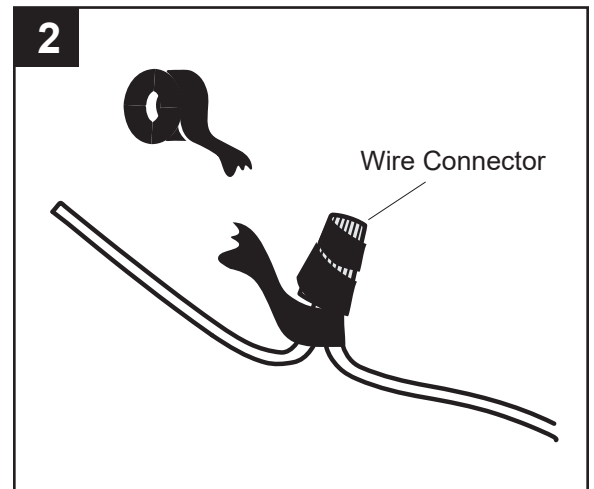
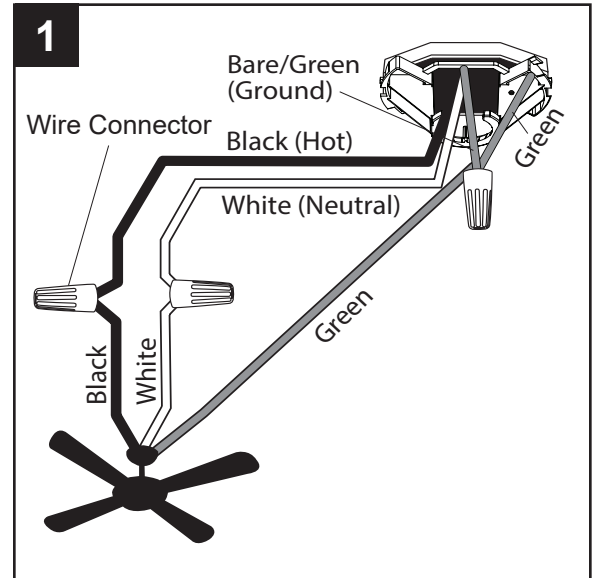

FINAL INSTALLATION

1. Lift the canopy (C) over the mounting bracket (B) and rotate clockwise until secure.

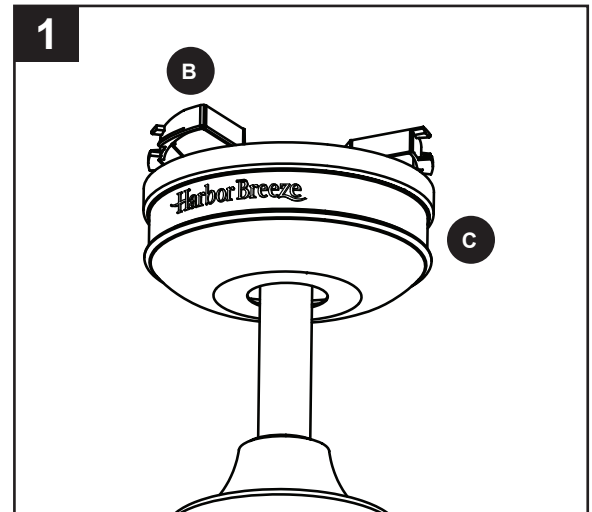

2. Use a flat-head screwdriver, if necessary, to remove the battery cover from the back of the remote found in remote pack (I). Insert two batteries into the remote; ensure polarity of batteries match the polarity indicated in the battery compartment -- positive (+) to positive (+) and negative (-) to negative (-). Replace the back cover and press the fan on/off button on the remote to ensure the LED indicator illuminates and the remote turns on the fan.

Note: If remote does not turn on fan, see TROUBLESHOOTING (page 12).

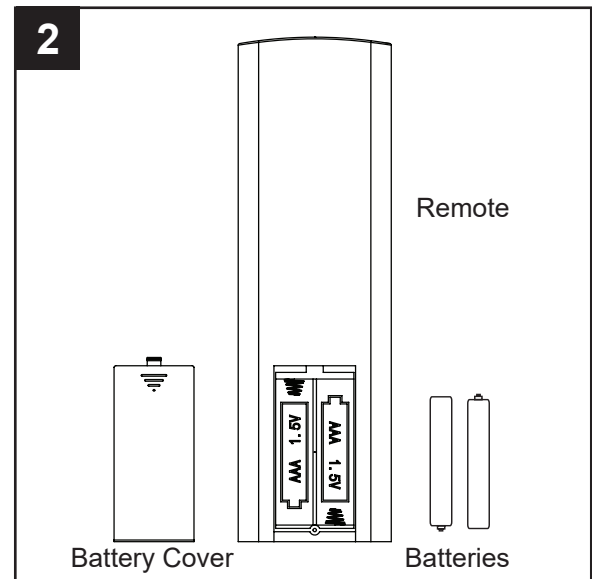

3. If desired, the wall bracket in remote pack (I) can be installed to a wall using the provided mounting screws. The remote can be stored in the wall bracket for easy access.

Turn on the circuit breakers and the wall switch to the fan supply line leads.

Assembly is complete.

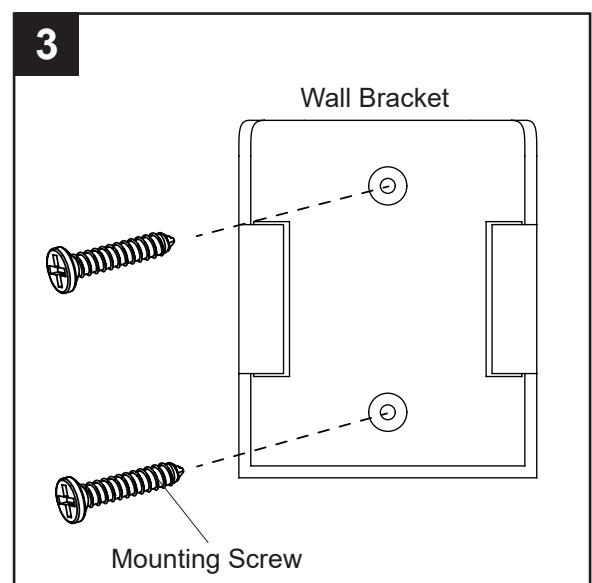

OPERATING INSTRUCTIONS

To operate the fan using the remote, press and release the following buttons:

Note: Remote has memory function to turn on fan and light at last settings.

 **Fan on/off**

 **On/off** - turns fan and light on and off.

 **Fan speed** - 1 (low speed) - 6 (high speed)

 **Reverse Switch** - Changes direction of blade rotation.

 **Variable Breeze** - Simulates a breeze in nature. Press to activate. Press any fan speed button to cancel.

 **Light Power** - Tap button to turn the light off/on.

 **Custom White** - Press and hold button to cycle through the color temperatures from 2700K (warm white) to 6500K (daylight). Tap button to turn on/off.

 **Light Dimming** - Press and hold button to dim or brighten the lights.

 **Sleep Timer** - Turn off fan after 2 or 4 hours.

 **Color On/Off** - Turn RGB colors on/off.

 **RGB Settings** - Tap to access 7 RGB colors and 2 color changing programs.

 **LEARN** - Simultaneously press and hold Variable Breeze and Light Power buttons for 3 seconds until fan turns on low speed to confirm syncing.

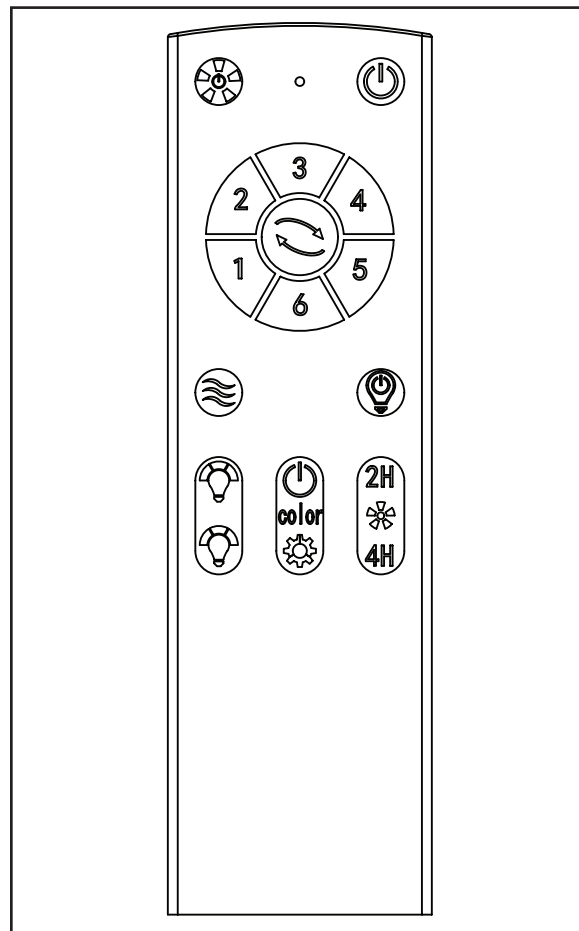

CARE AND MAINTENANCE

Clean the blades with a lint-free cloth.

Battery Replacement: Use 1.5 V (AAA) alkaline batteries. **WARNING:** Keep batteries out of reach of children. May be fatal if swallowed. In the event that a battery is swallowed, immediately consult a doctor. Non-rechargeable batteries are not to be recharged. Do not mix different types of batteries such as alkaline, carbon-zinc, or rechargeable batteries. Do not mix old and new batteries. Batteries are to be inserted with the correct polarity. Exhausted batteries are to be removed from the product. Do not dispose of batteries in fire, as they may explode or leak.

Important: Shut off the main power supply before you begin any maintenance tasks. Do not use water or a damp cloth to clean the ceiling fan.

TROUBLESHOOTING

PROBLEM	POSSIBLE CAUSE	CORRECTIVE ACTION
The fan does not move.	<ol style="list-style-type: none">1. The power is off or the fuse is blown.2. There is a faulty wire connection.	<ol style="list-style-type: none">1. Turn the power on or check the fuse.2. Turn the power off. Loosen the canopy and check all connections.
The fan operates correctly, but the lights are not working.	There is a faulty wire connection.	Turn the power off and check all connections at the ceiling outlet box.
Remote control does not work.	<ol style="list-style-type: none">1. Power surge may have cleared memory and remote needs to be re-synced to the receiver.2. Battery in remote control needs to be replaced.3. Interference from another remote.	<ol style="list-style-type: none">1. After installation is complete, switch the power off and back on again. Within 5 seconds, simultaneously press and hold the "Variable Breeze" and "Light Control" buttons for 3 seconds until fan turns on low speed to confirm syncing.2. Insert new AAA batteries in battery compartment of the remote control (see page 10).3. If there are several fans in proximity, turn power off to other fans and re-sync the remote (see Corrective Action 1 above).

LIMITED LIFETIME WARRANTY

Set forth below, the manufacturer warrants the fan motor for this ceiling fan to be free from defects in workmanship and material for the life of the product. Also, subject to the limitations below, the manufacturer warrants all ceiling fan parts ("ceiling fan parts" excludes the motor and parts made in whole or in part with glass) to be free from defects in workmanship and material for a period of one year after the date of purchase by the original purchaser at retail.

All claims must be made by the original purchaser from an authorized dealer, whether such purchaser purchased the product through a store or contractor. Ceiling fan part defects must be reported within the first year from the date of purchase. Parts made in whole or in part with glass and the finishes of metal and other surfaces are not warranted.

Purchasers are responsible for all costs of removing and reinstalling the product. Any damage to any part caused by ordinary wear and tear, accident, misuse, or improper installation, is not covered by this warranty. The manufacturer assumes no responsibility whatsoever for fan installation. Any service performed by a non-licensed electrician will render the warranty invalid.

The manufacturer's sole responsibility shall be to repair or replace the motor, parts, or product within the terms stated above. The manufacturer shall not be liable for any loss or damage of any kind, including any incidental or consequential damages resulting directly or indirectly, from any breach of warranty, express or implied, or any other failure of this product. Some states do not allow the exclusion or limitation of incidental or consequential damages so this limitation may not apply to you.

If the original purchaser ceases to own the fan, this warranty is voided.

Should the purchaser encounter a problem with your fan related to defects in workmanship or materials within the warranty period associated with the defective part, the manufacturer agrees to replace the defective part without charge, or at its option, to replace the ceiling fan with a comparable or superior model.

The manufacturer's warranties are limited to the written warranties set out in this ceiling fan limited lifetime warranty. All other express and implied warranties, including, without limitation, the implied warranty of fitness for a particular purpose and the implied warranty of merchantability is disclaimed. Some states do not allow the disclaimer of implied warranties, so this disclaimer may not apply to you.

REPLACEMENT PARTS LIST

For replacement parts, call the customer service department at **888-251-1003**, 8 a.m. - 8 p.m., EST, Monday - Sunday. You could also contact us at **ascs@lowes.com**.

PART	DESCRIPTION	#6020795	#6601152	#6601148	#6601149	COVERED UNDER WARRANTY
A	Downrod	4L000019980	4L000020010	4L000020040	4L000020070	YES - 1 YEAR
B	Mounting Bracket	4L000019940	4L000019940	4L000019940	4L000019940	YES - 1 YEAR
C	Canopy	4L000019960	4L000019990	4L000020020	4L000020050	YES - 1 YEAR
D	Yoke Cover	4L000019970	4L000020000	4L000020030	4L000020060	YES - 1 YEAR
I	Remote Pack	4L000019950	4L000019950	4L000019950	4L000019950	YES - 1 YEAR

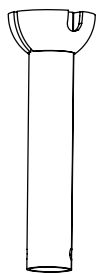

A

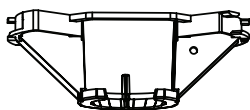

B



C



D

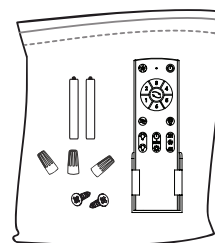

I