

# Mounting instruction

Mirror Back View

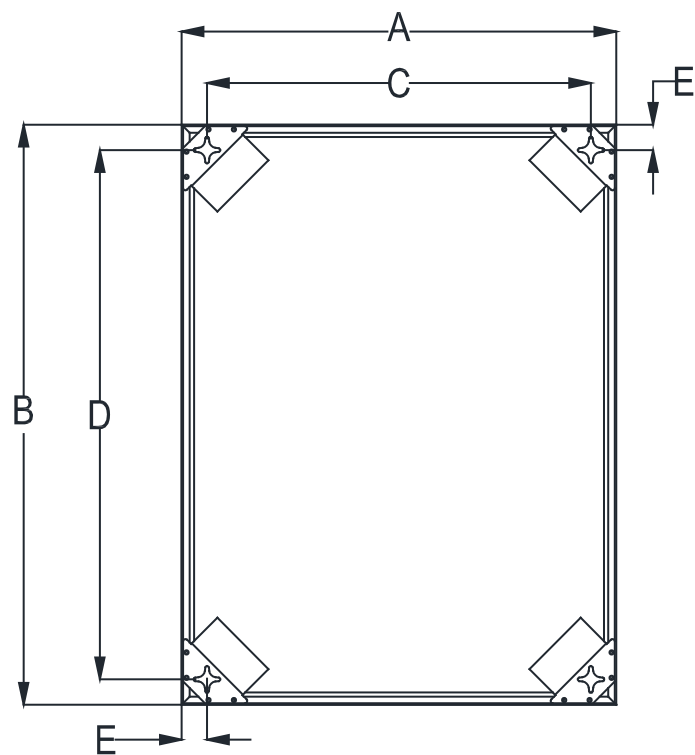

Size & Distance Chart

A	B	C	D	E
20"	30"	17.24"	27.24"	1.378"
20"	36"	17.24"	33.24"	1.378"
20"	40"	17.24"	37.24"	1.378"
24"	30"	21.24"	27.24"	1.378"
24"	36"	21.24"	33.24"	1.378"
24"	40"	21.24"	37.24"	1.378"
27"	36"	24.24"	33.24"	1.378"
27"	40"	24.24"	37.24"	1.378"
30"	30"	27.24"	27.24"	1.378"
30"	36"	27.24"	33.24"	1.378"
30"	40"	27.24"	37.24"	1.378"
30"	48"	27.24"	45.24"	1.378"
36"	36"	33.24"	33.24"	1.378"
36"	48"	33.24"	37.24"	1.378"
23.6"	31.5"	20.84"	28.74"	1.378"

Accessory include  
4pcs Anchors  
4pcs Screws  
1pc Mounting Template

Distance A is the mirror width  
Distance B is the mirror height  
Distance C is screws holes length for vertical mounting.  
Distance D is screws holes length for horizontal mounting.

1

Select a disired position to mount the mirror.  
Put the mounting template paper on wall.

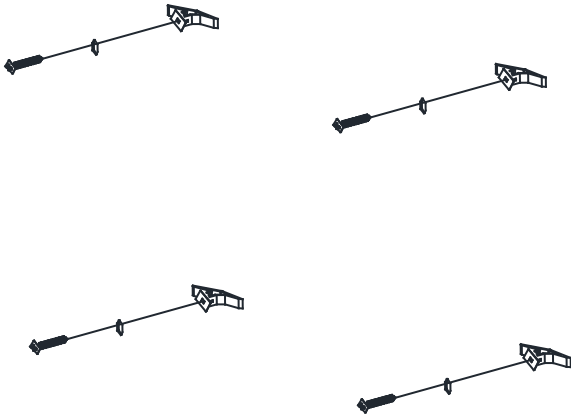
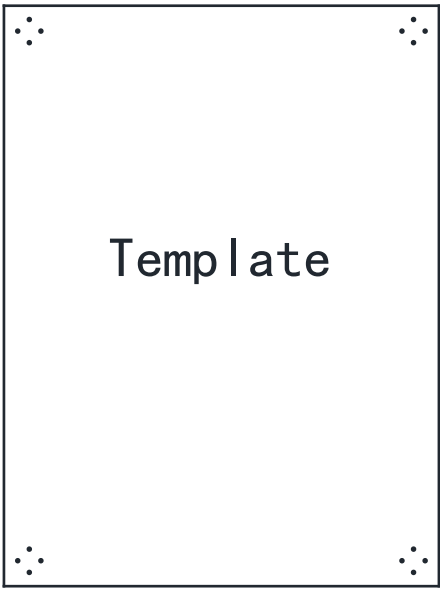

2

Drill holes, insert wall anchors into the holes,  
then insert screws into anchors.

3

Hang mirror onto screws.

