

# VERTICAL FILE CABINET ASSEMBLY INSTRUCTIONS

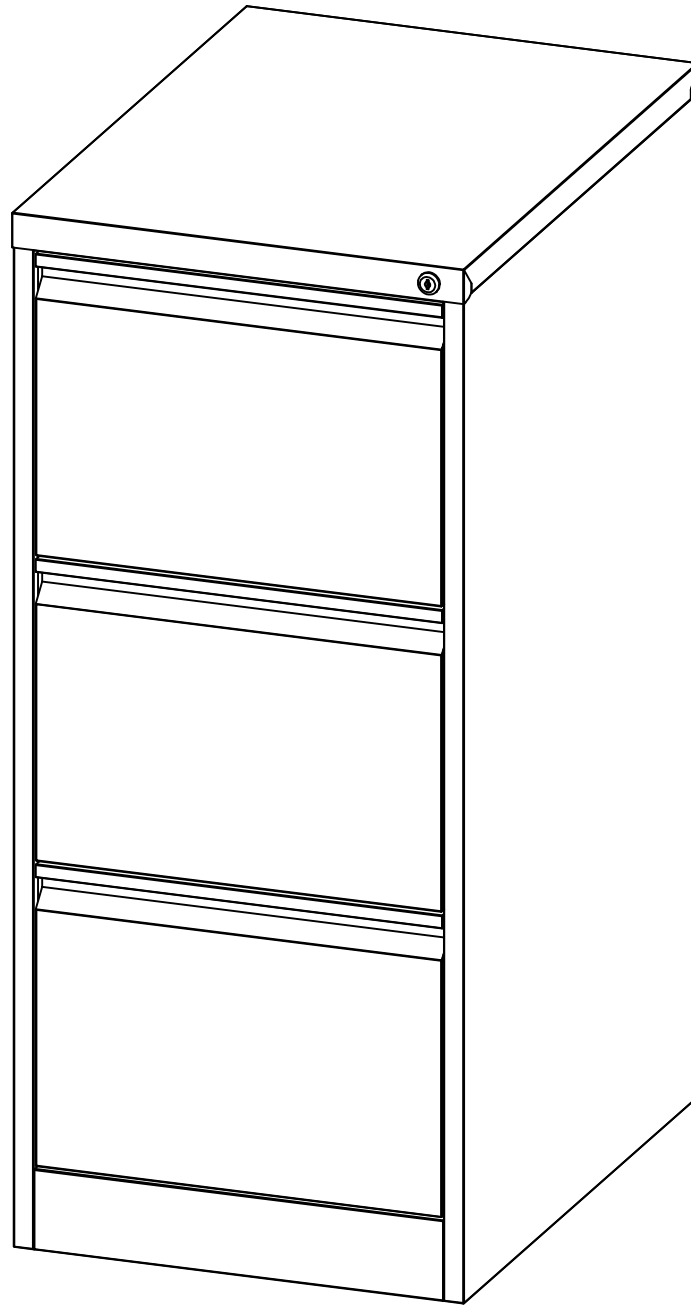

**NOTE:**The assembling task can be performed by one person but availability of a second person will make the task simpler.



Please scan the QR code to check the assemble video

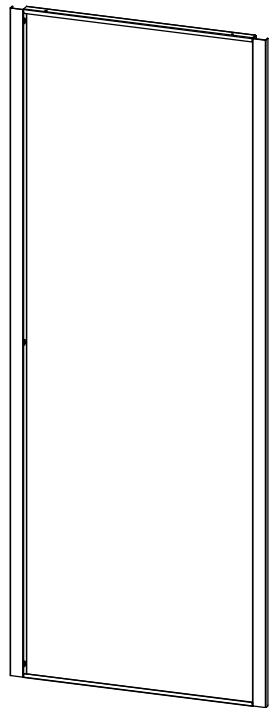

A:Backboard

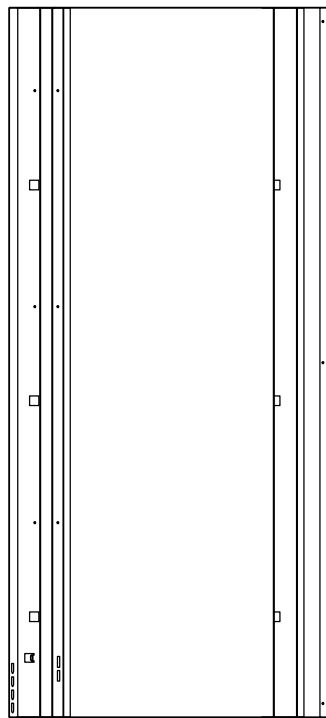

B:Left side

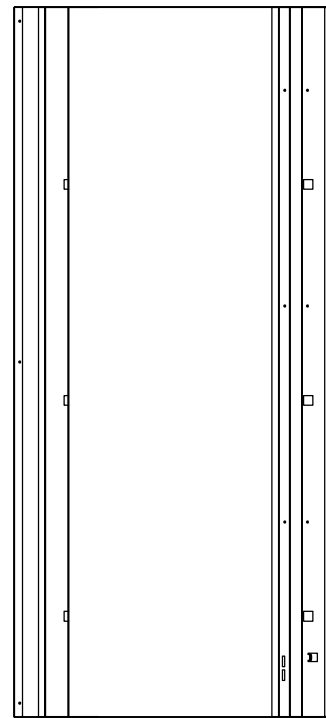

C:Right side



E:lock rod

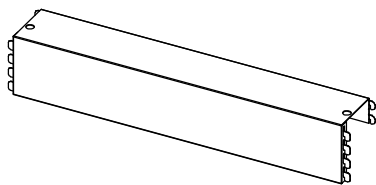

D:Bottom rail

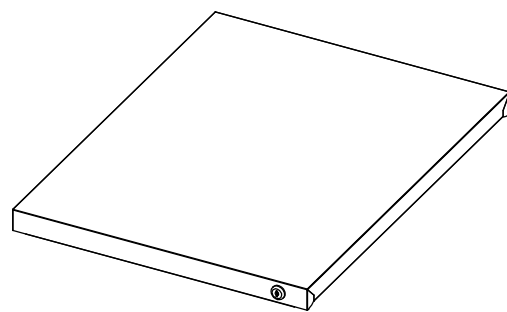

E:Top plate

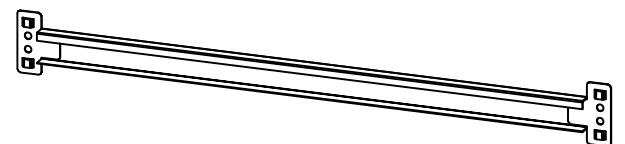

G:pull rod \*2

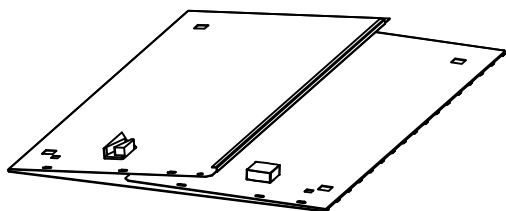

H:Drawer body \*3

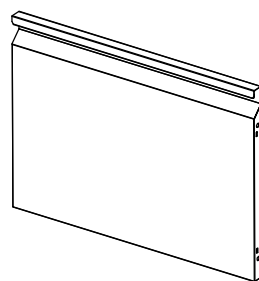

I : Drawer panel \*3

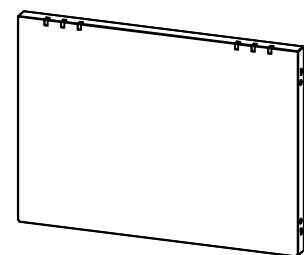

J:Drawer Inside panel \*3

L:Left side rail \*3

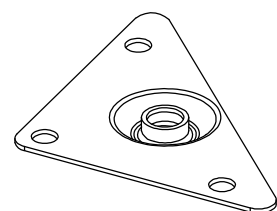

Y:Triangular  
fixing board \*4



K:Folder adjusting  
plate \*3

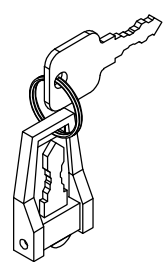

X:Key

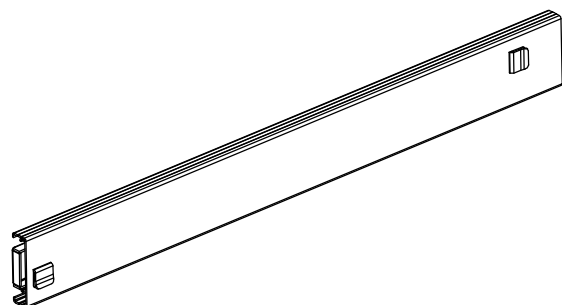

M:Right side rail \*3

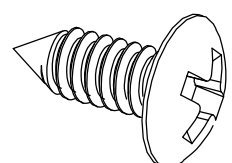

Z:Self-tapping  
yarn \*44

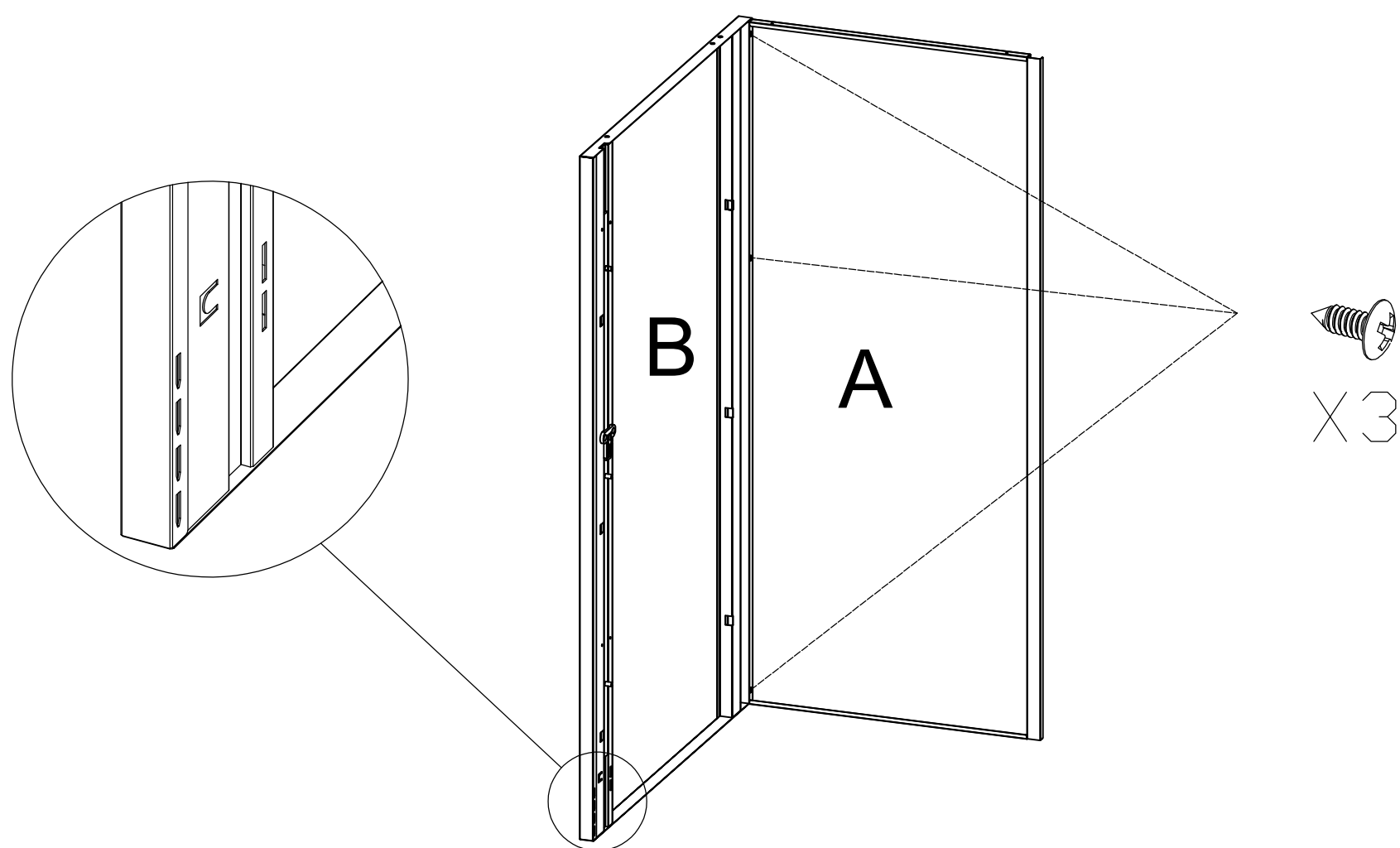

1. Assemble A and B, secure with screw Z

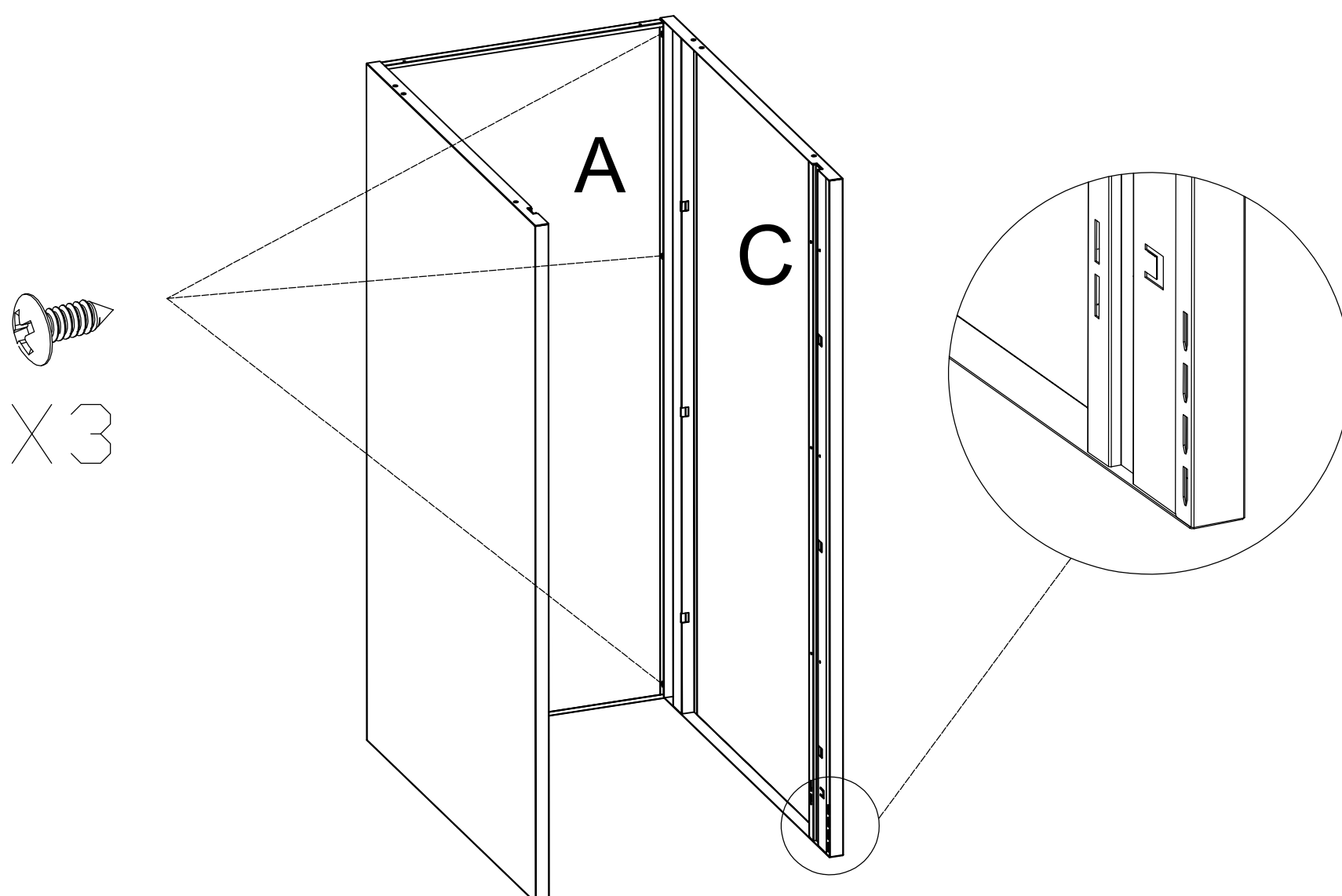

2. Assemble A and C, secure with screw Z

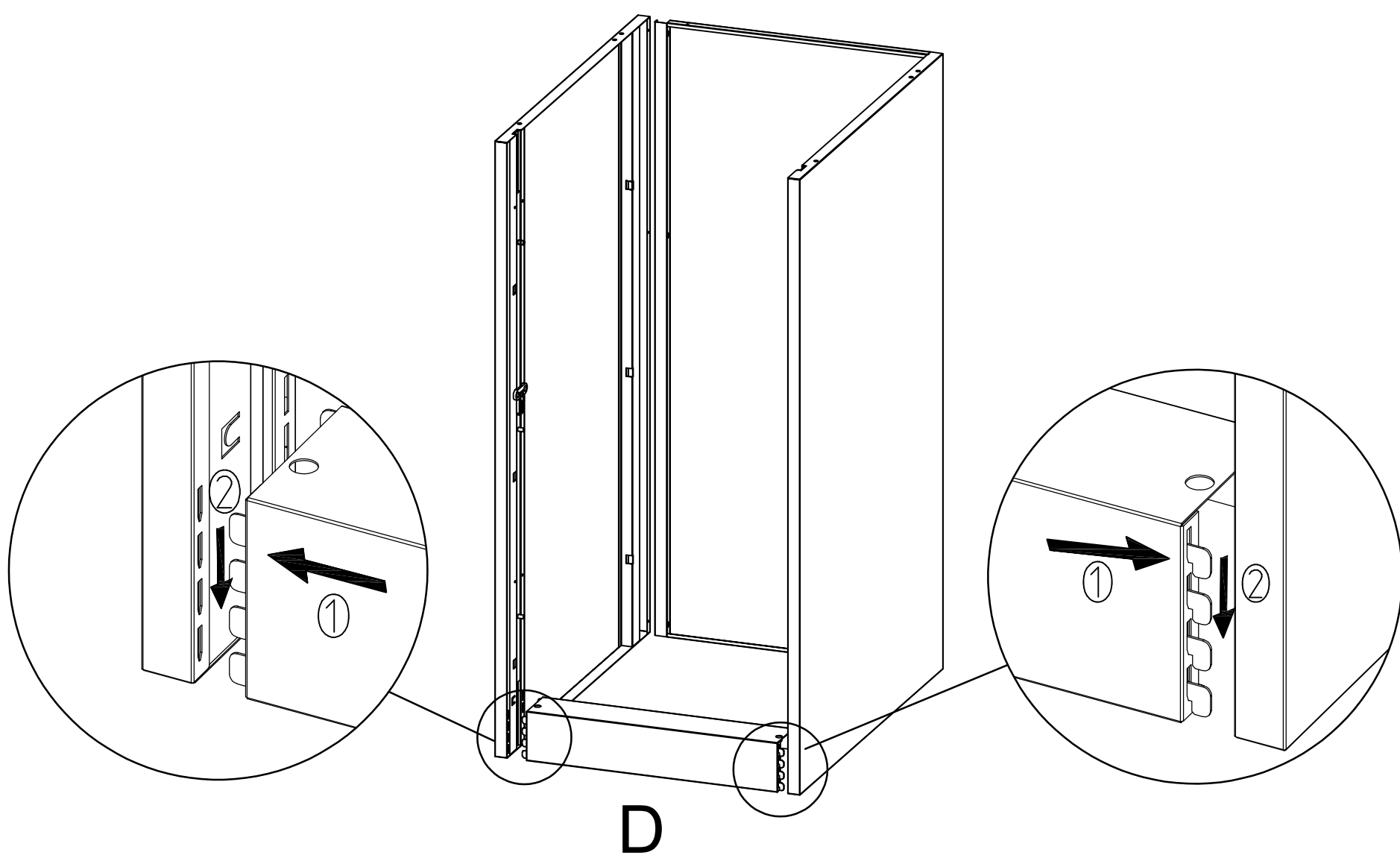

### 3. Install D

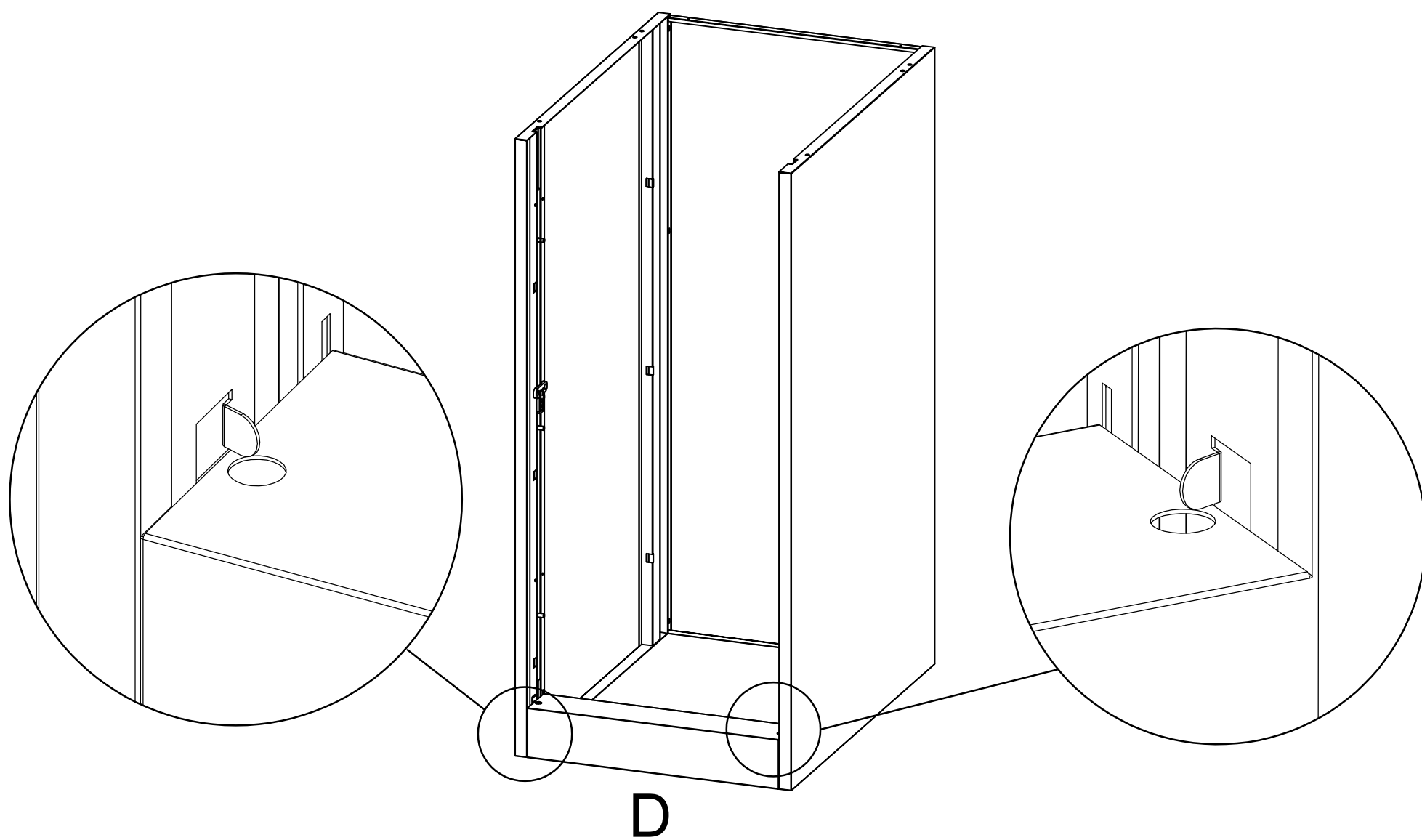

### 4. Open baffle

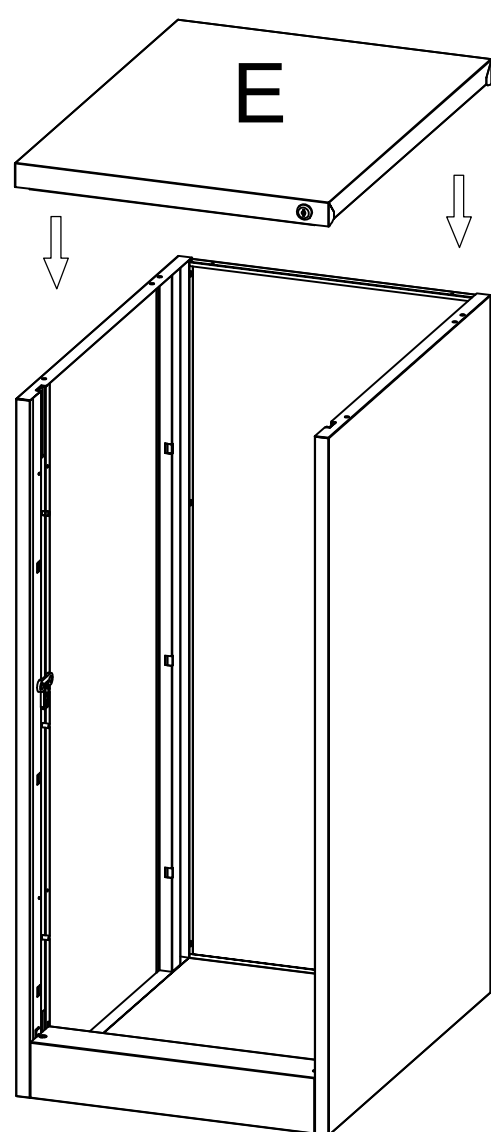

## 5. Install E

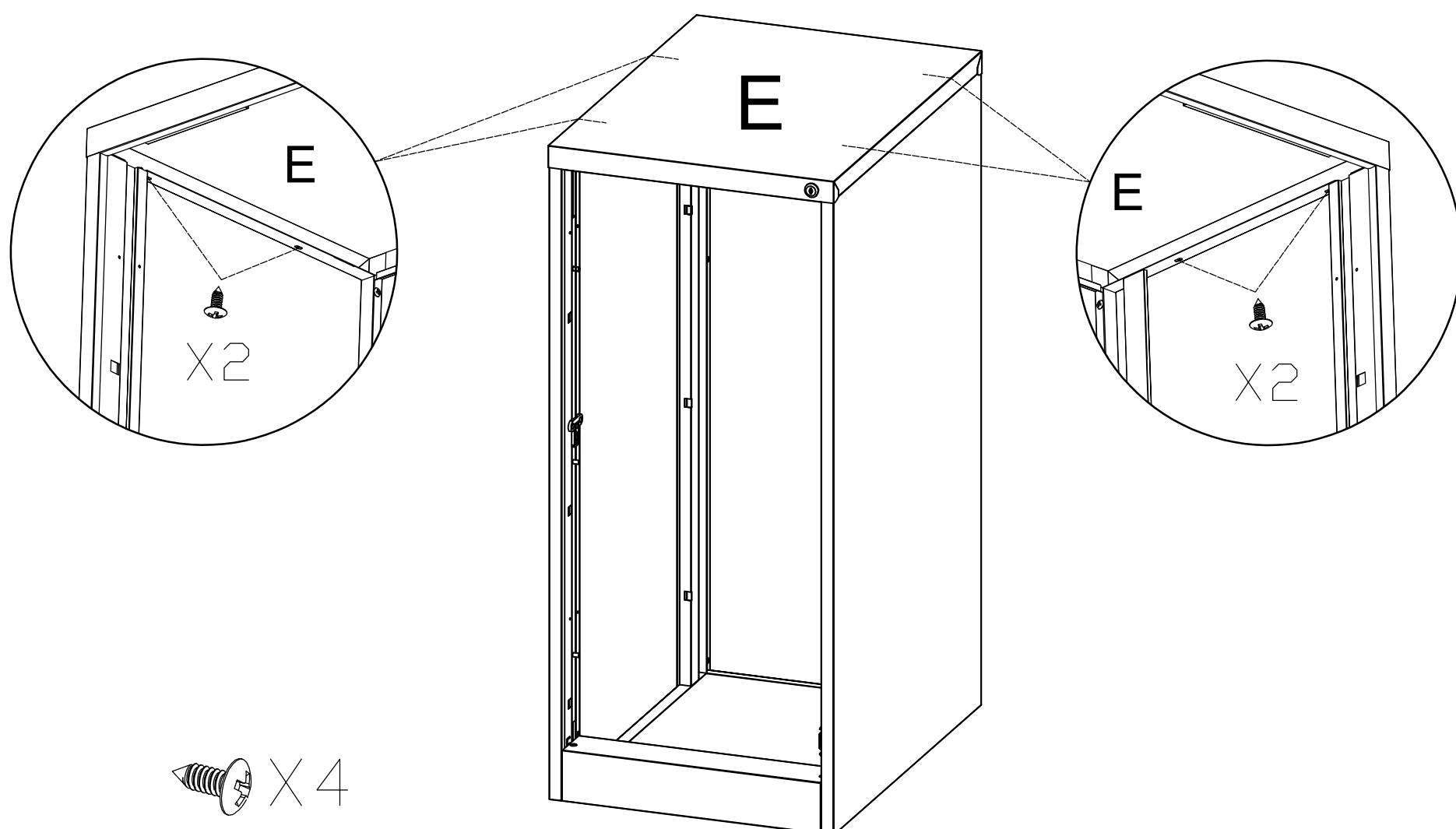

## 6. Secure with screw Z

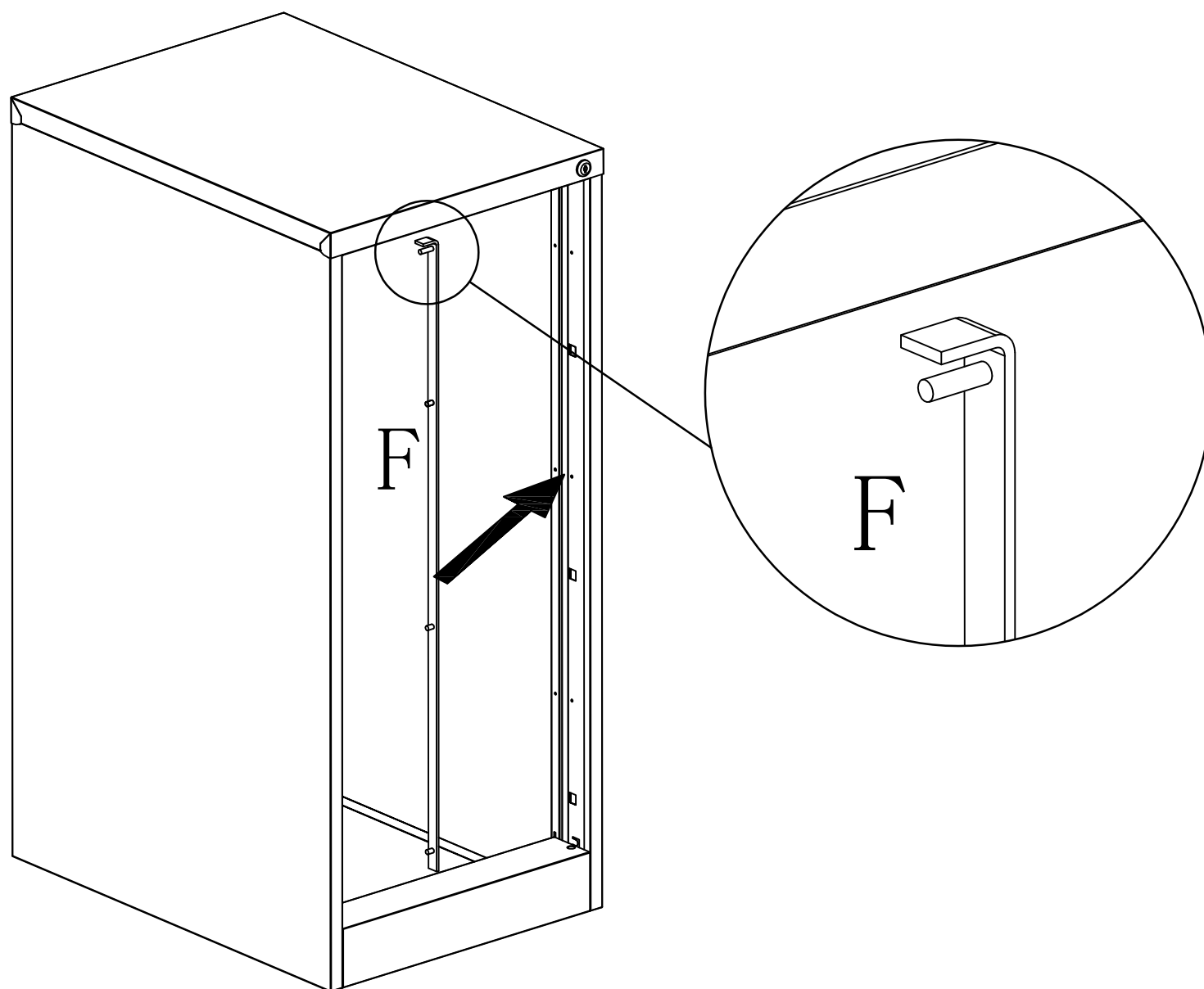

## 7. Install F

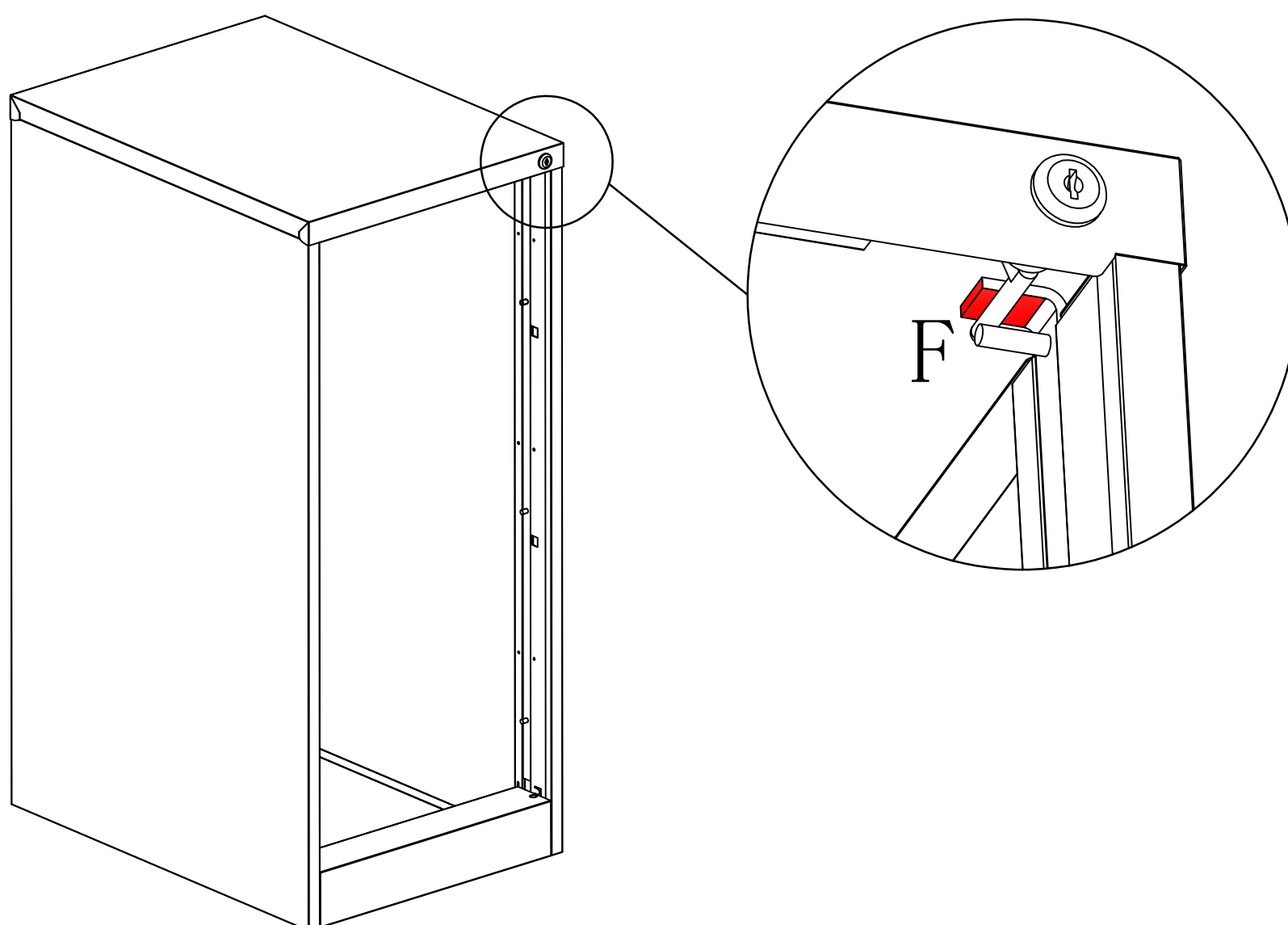

## 8. F Hook the lock

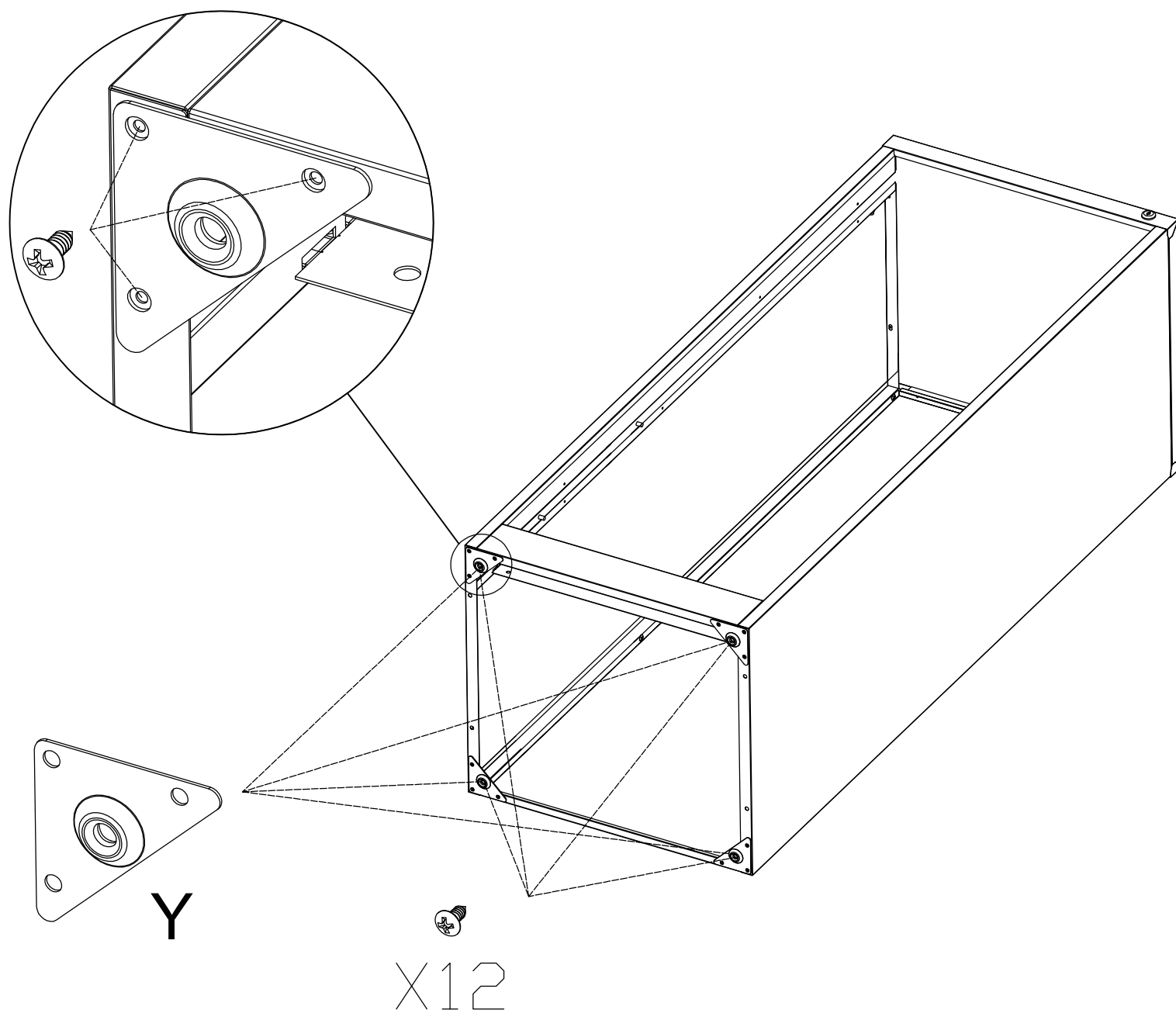

9. Install Y, secure with screw Z

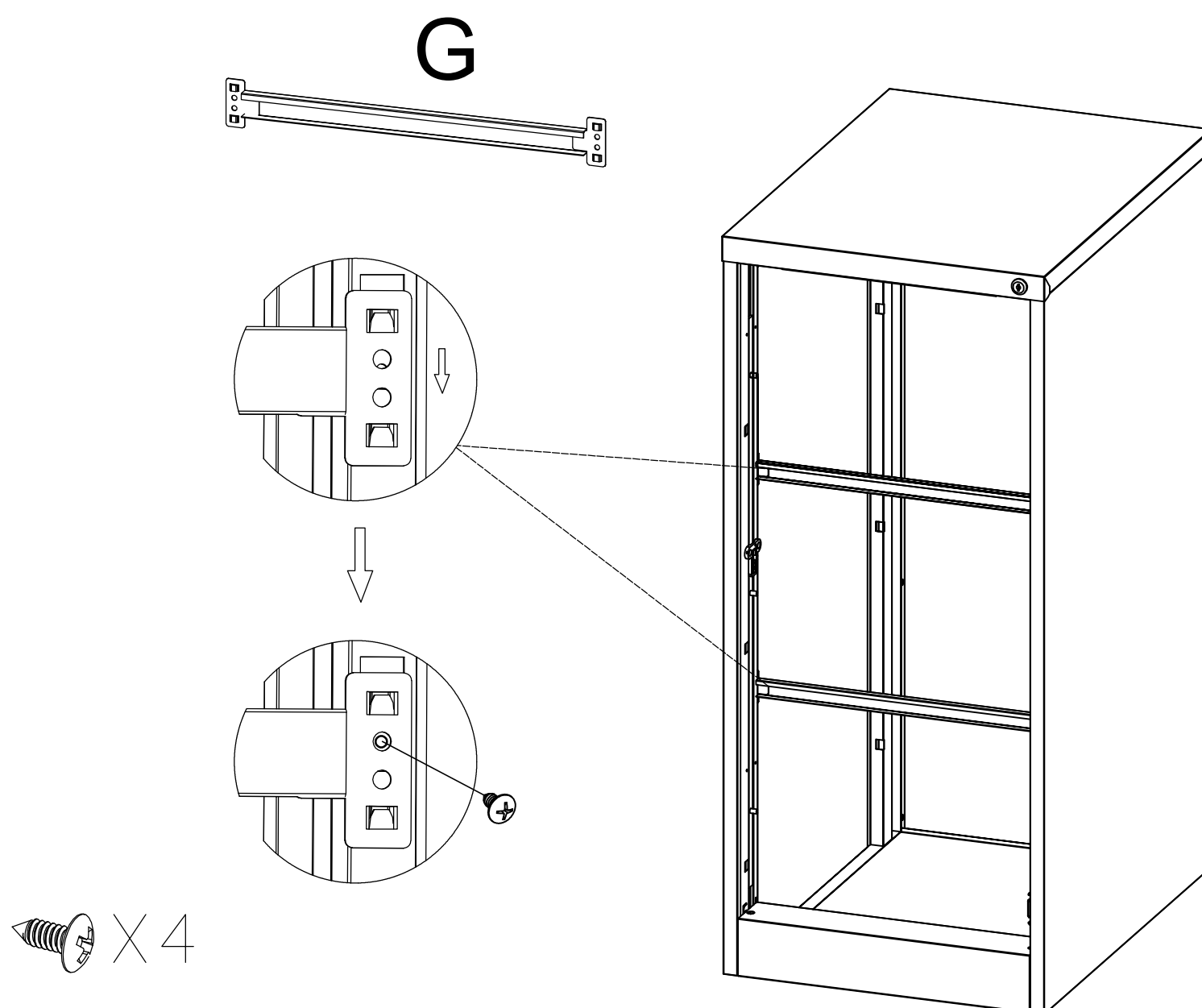

10. Install G, secure with screw Z

11

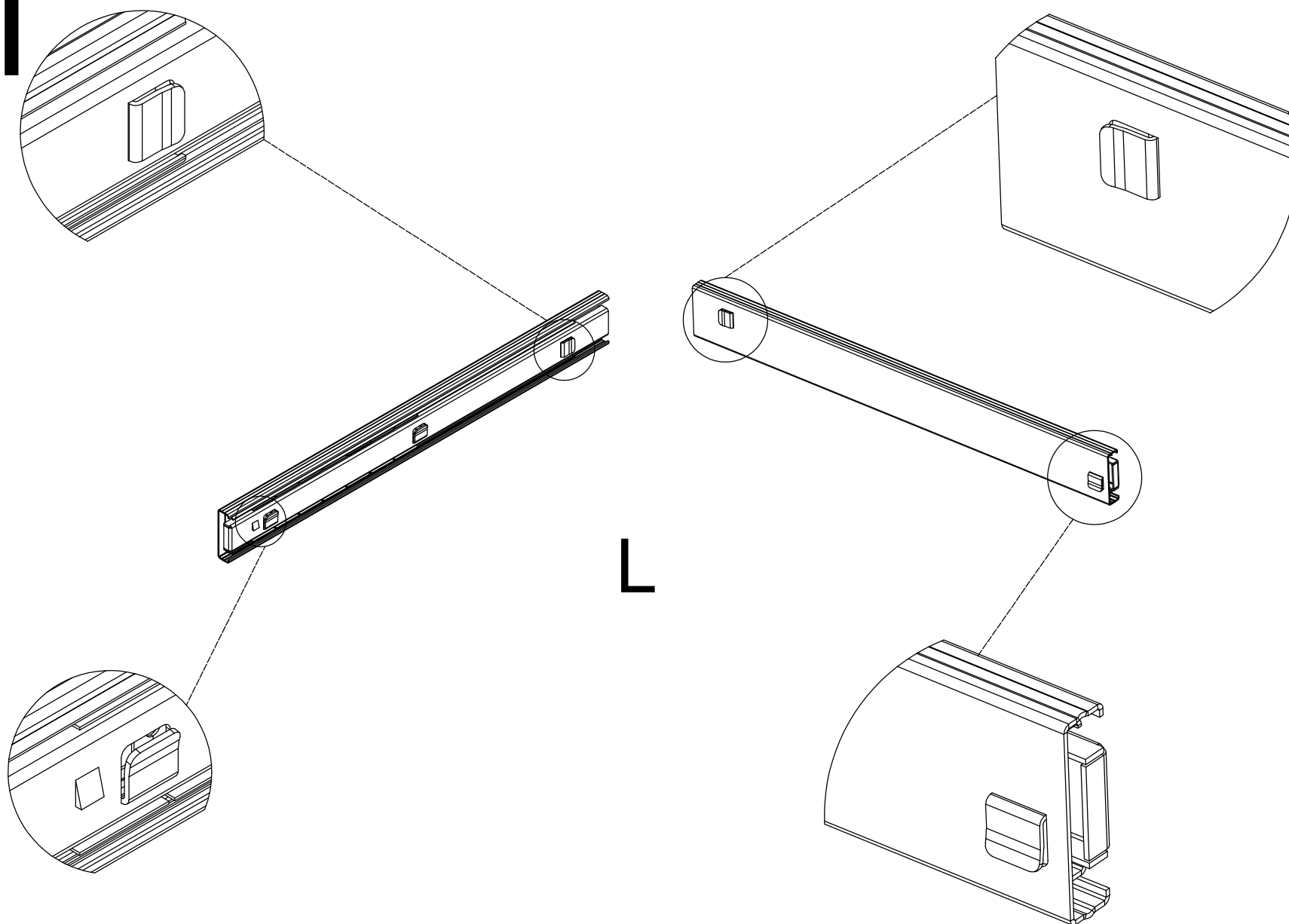

11. Left side rail L

12

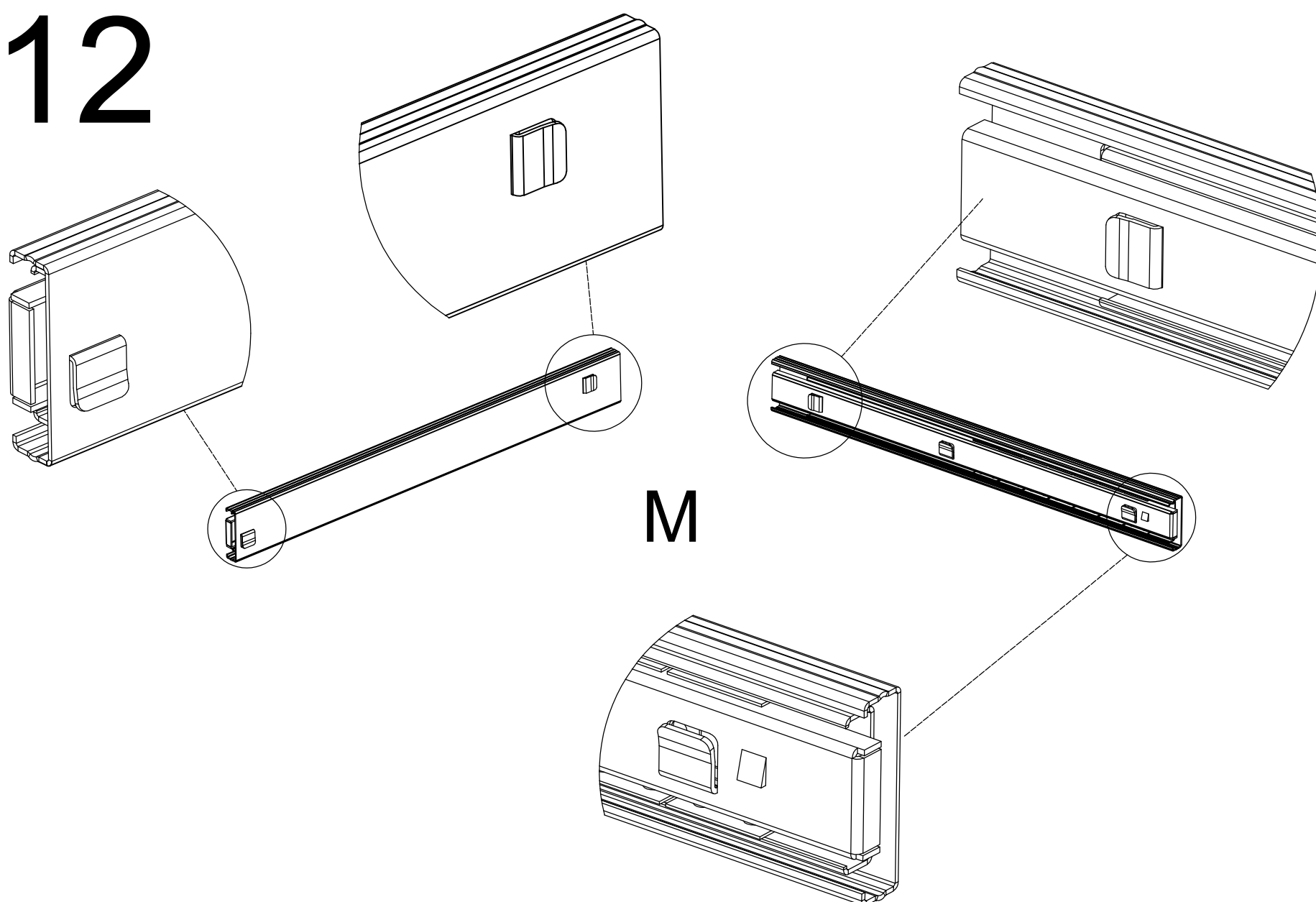

12. Right side rail M



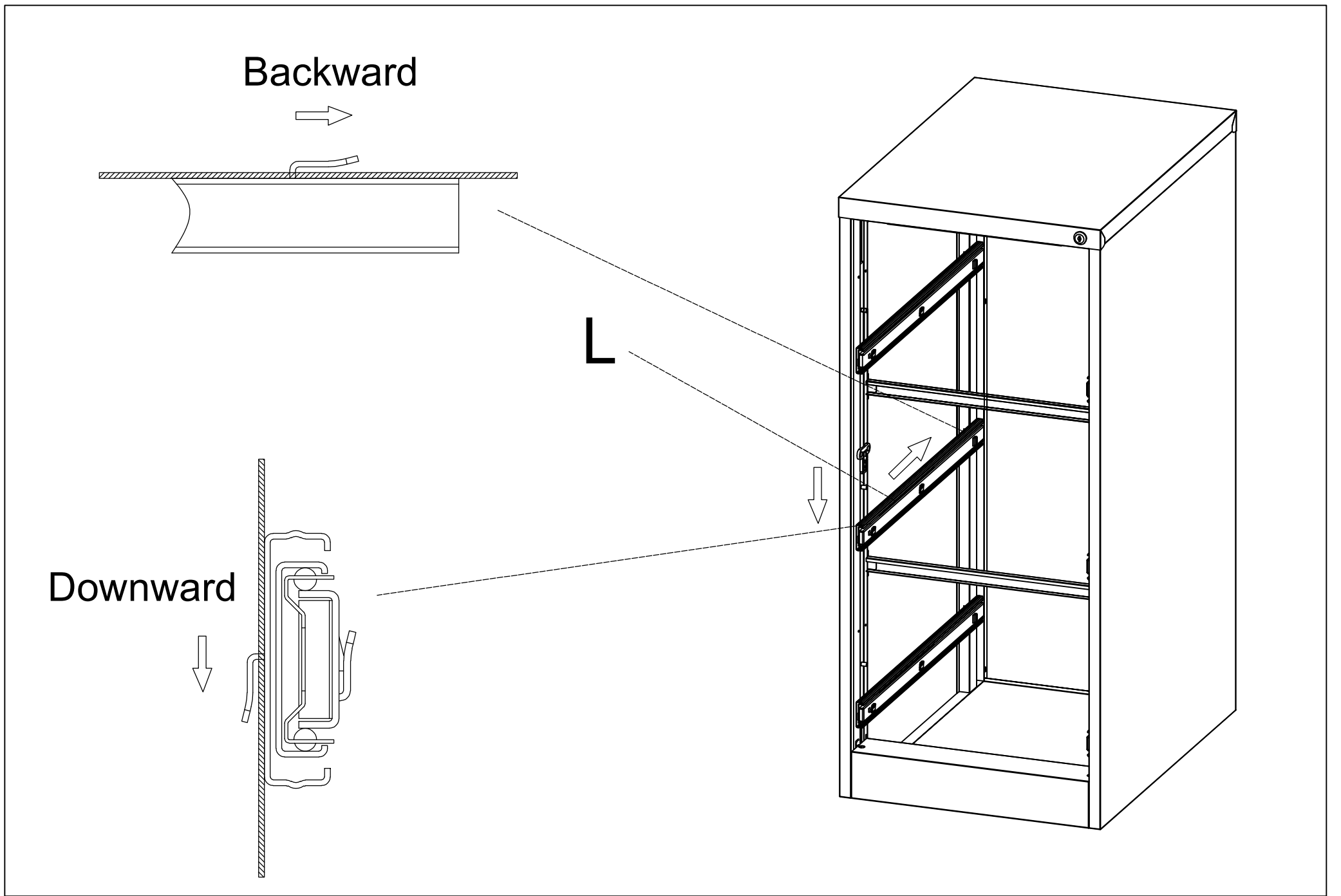

13. Install L

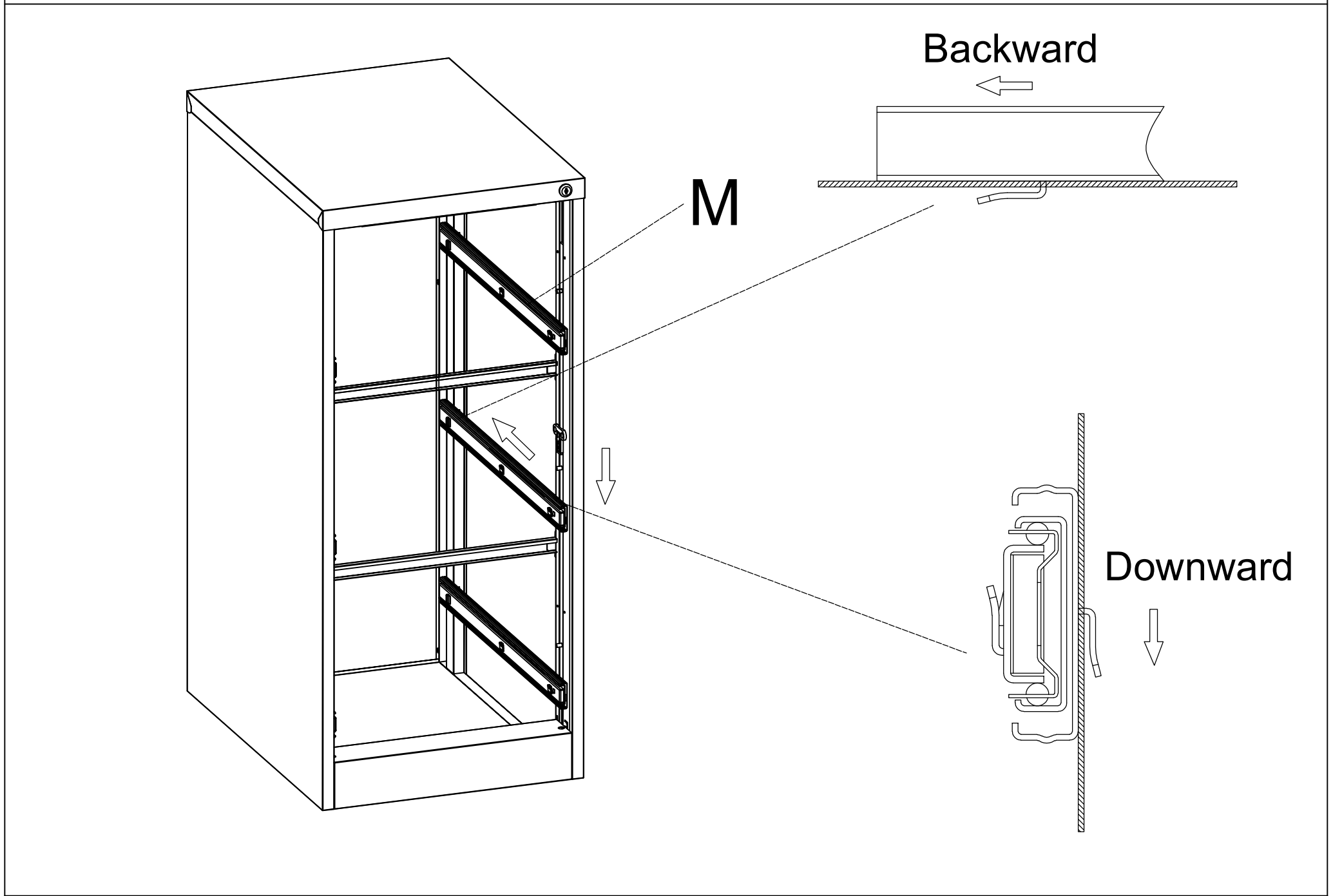

14. Install M

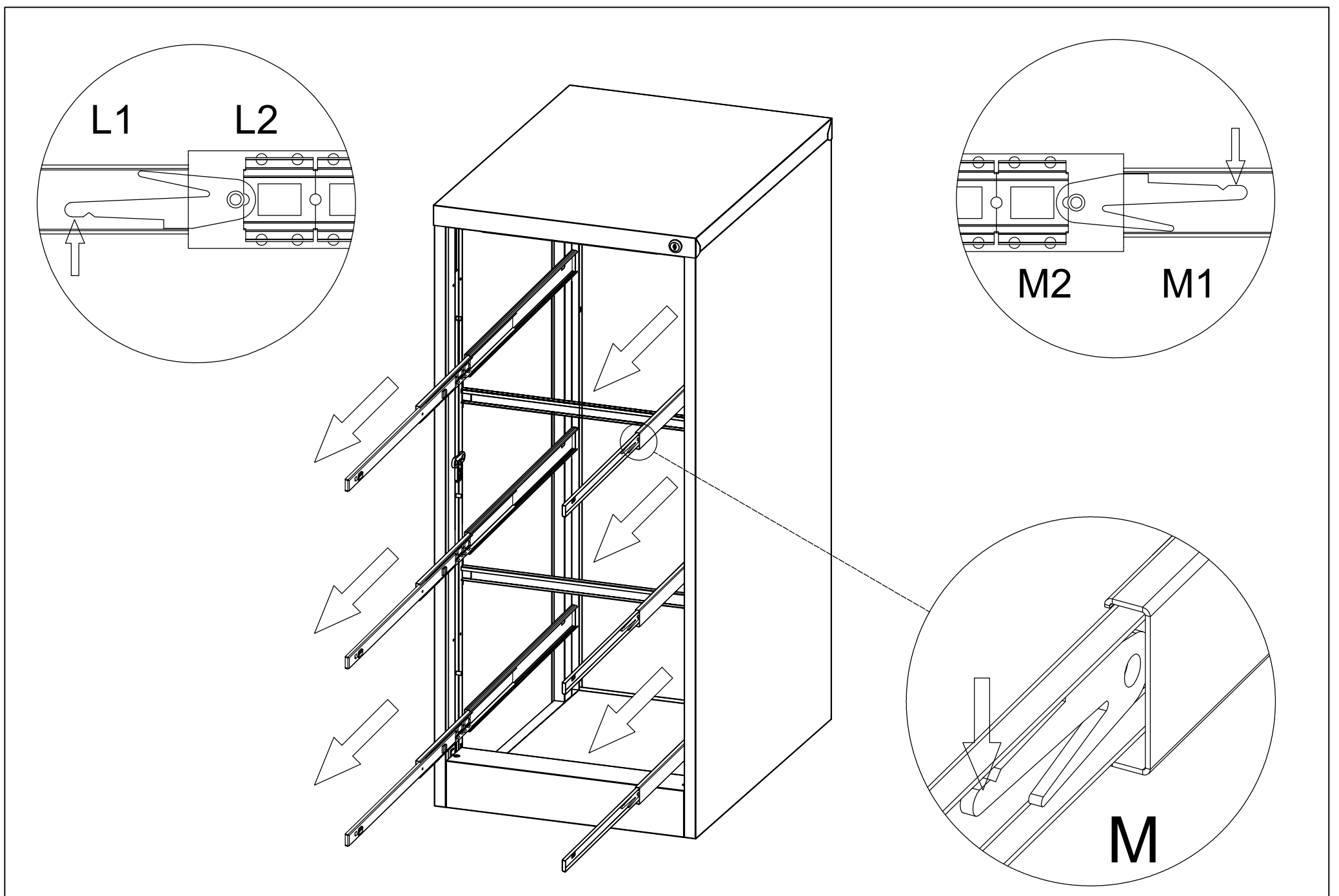

15. Divide the slide rail into L1(M1) and L2(M2)

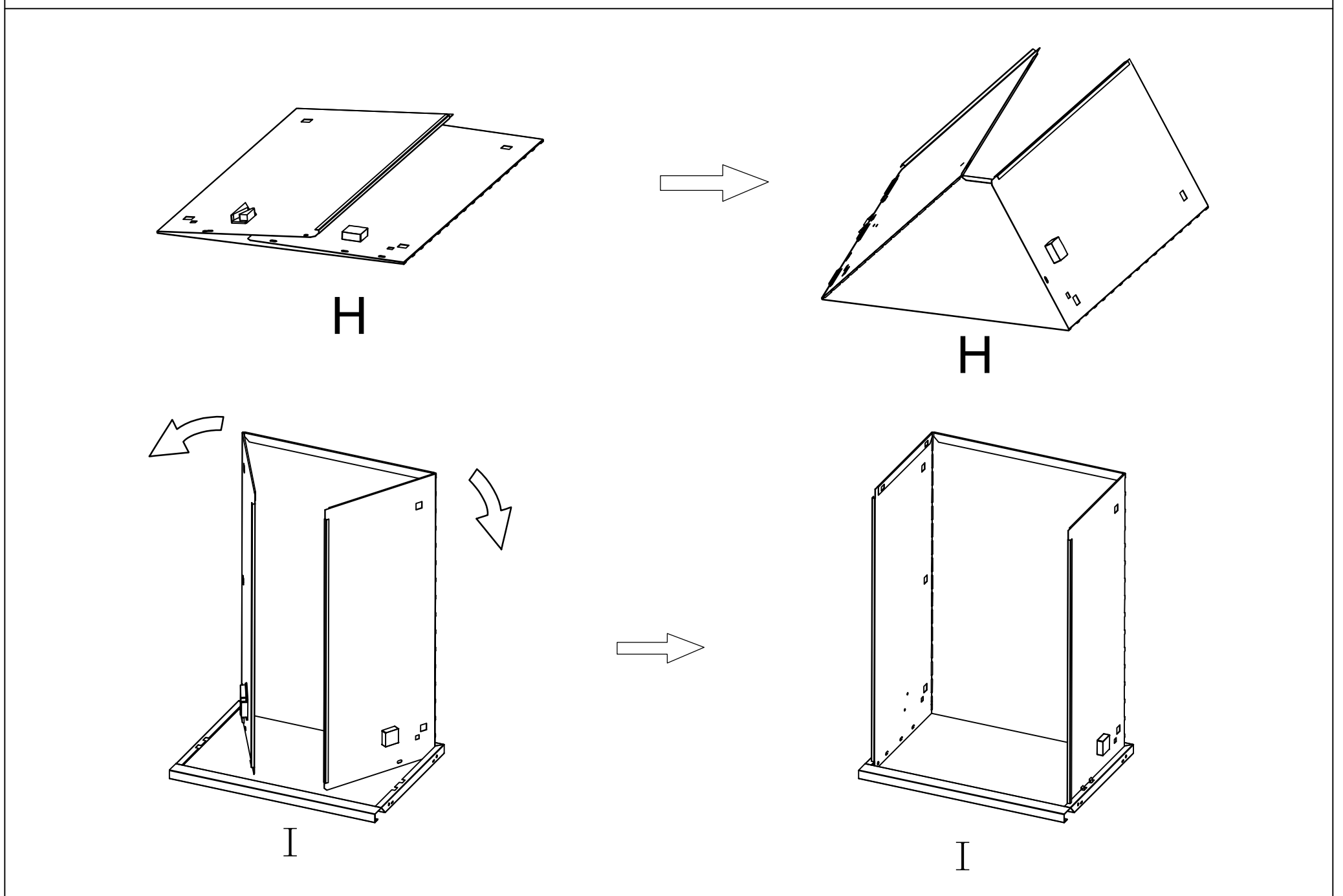

16. Assemble H and I,

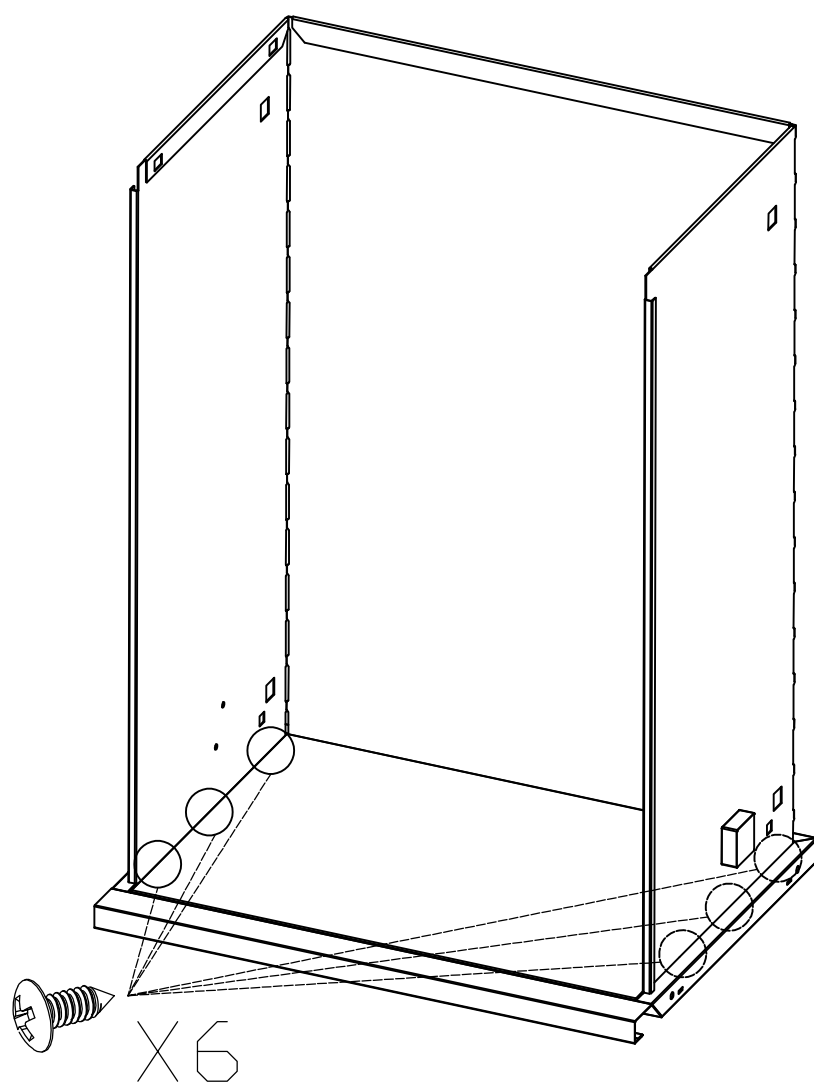

17. Secure with screw Z

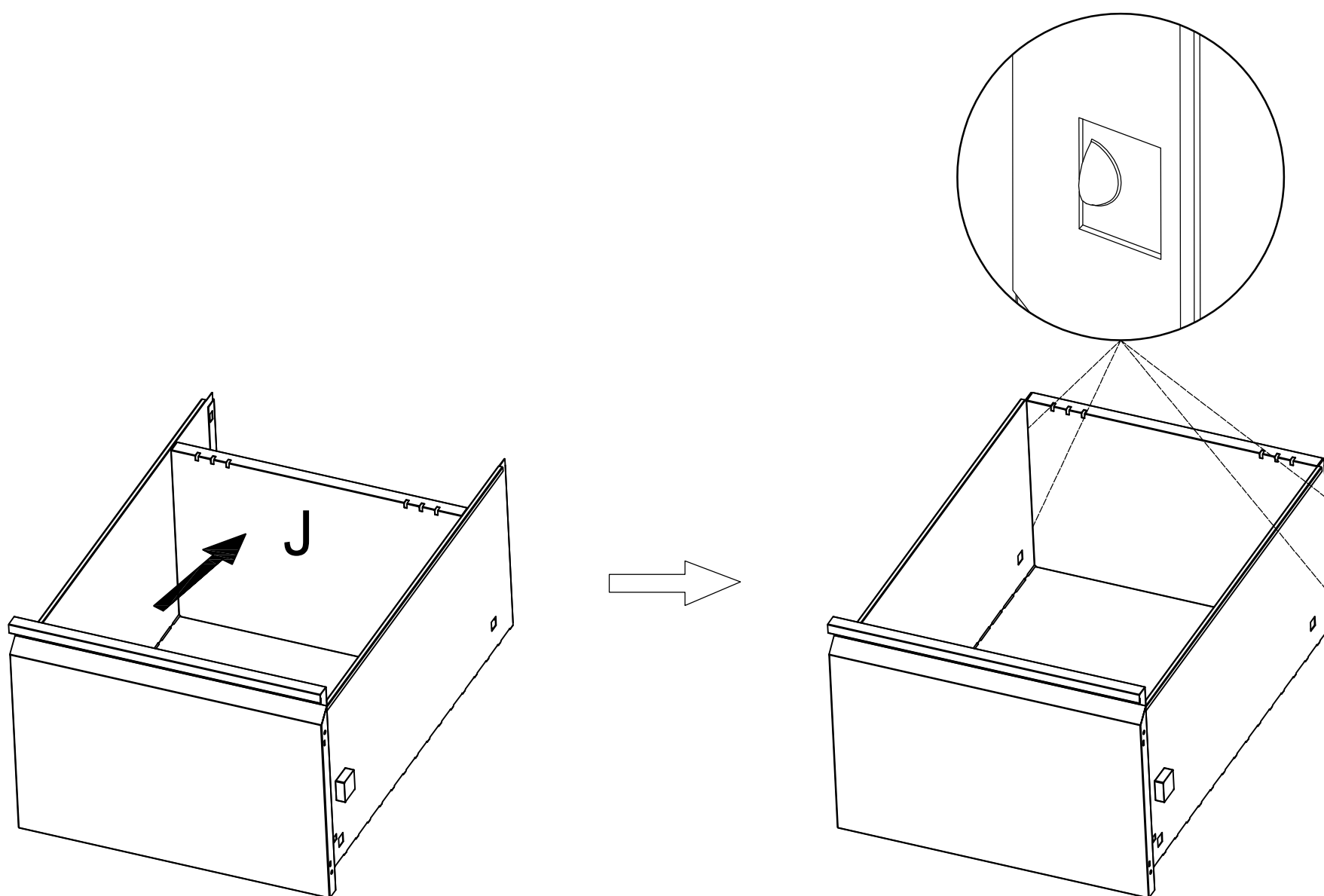

18. Install J

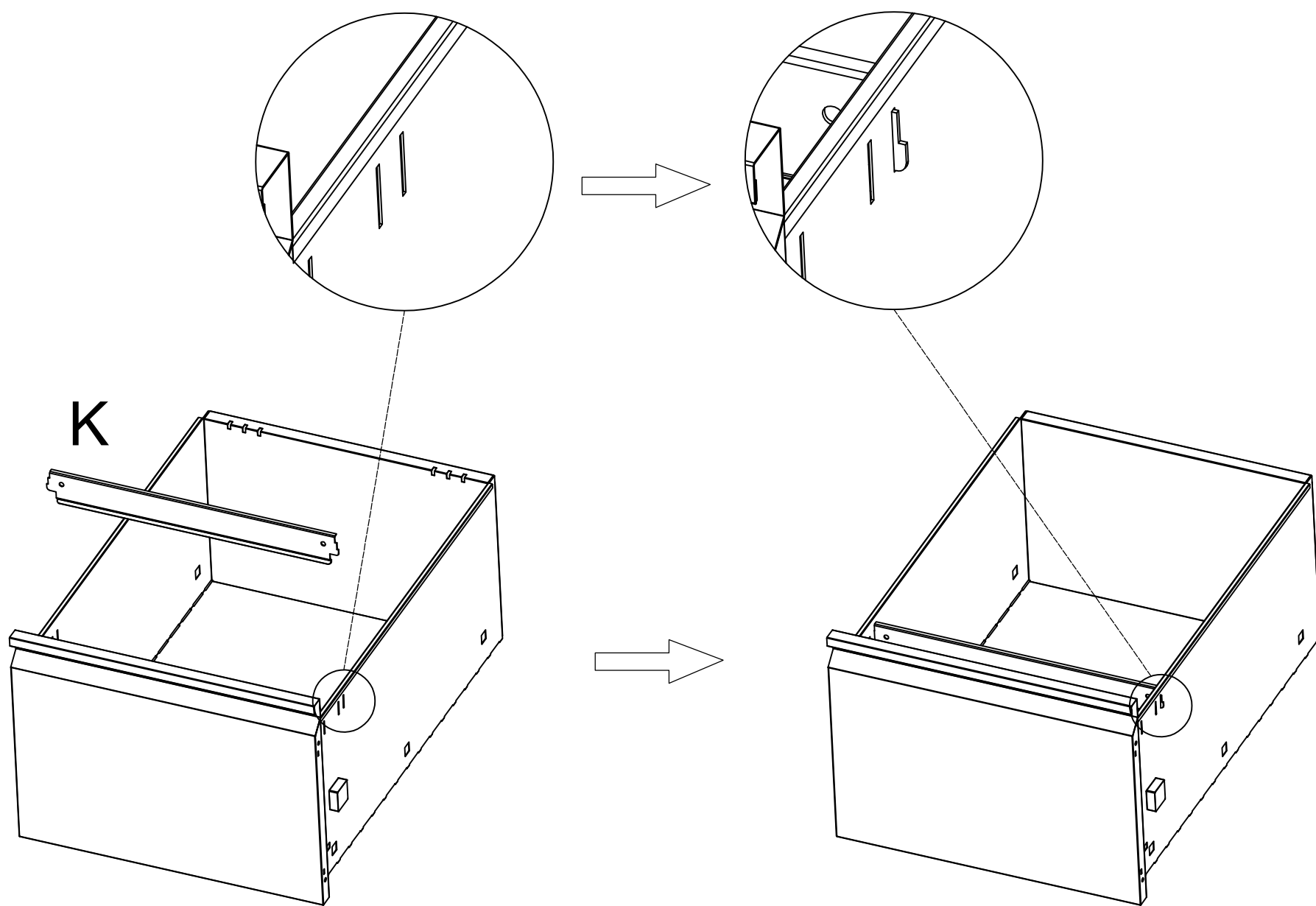

## 19. Install K

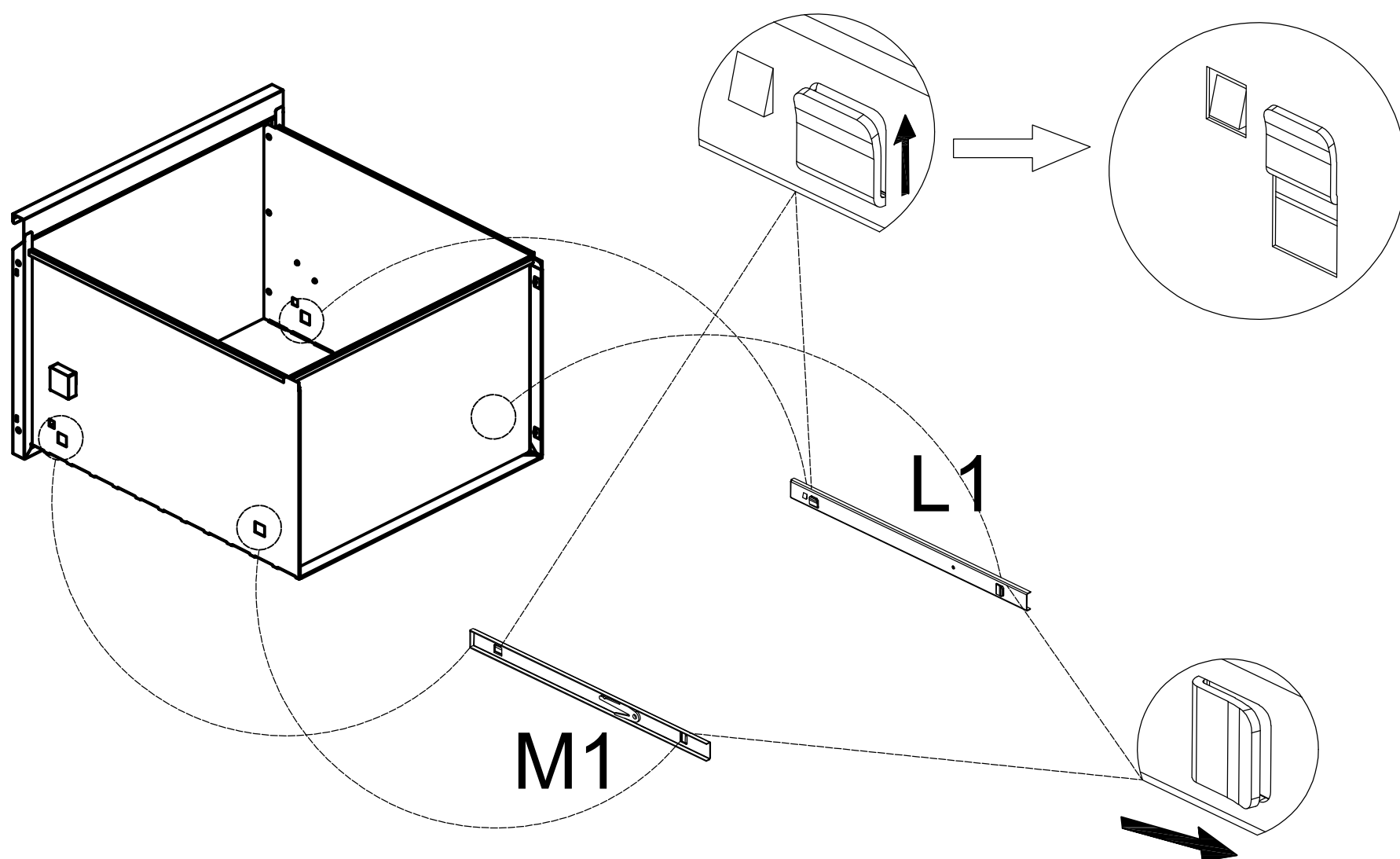

## 20. Install L1 and M1

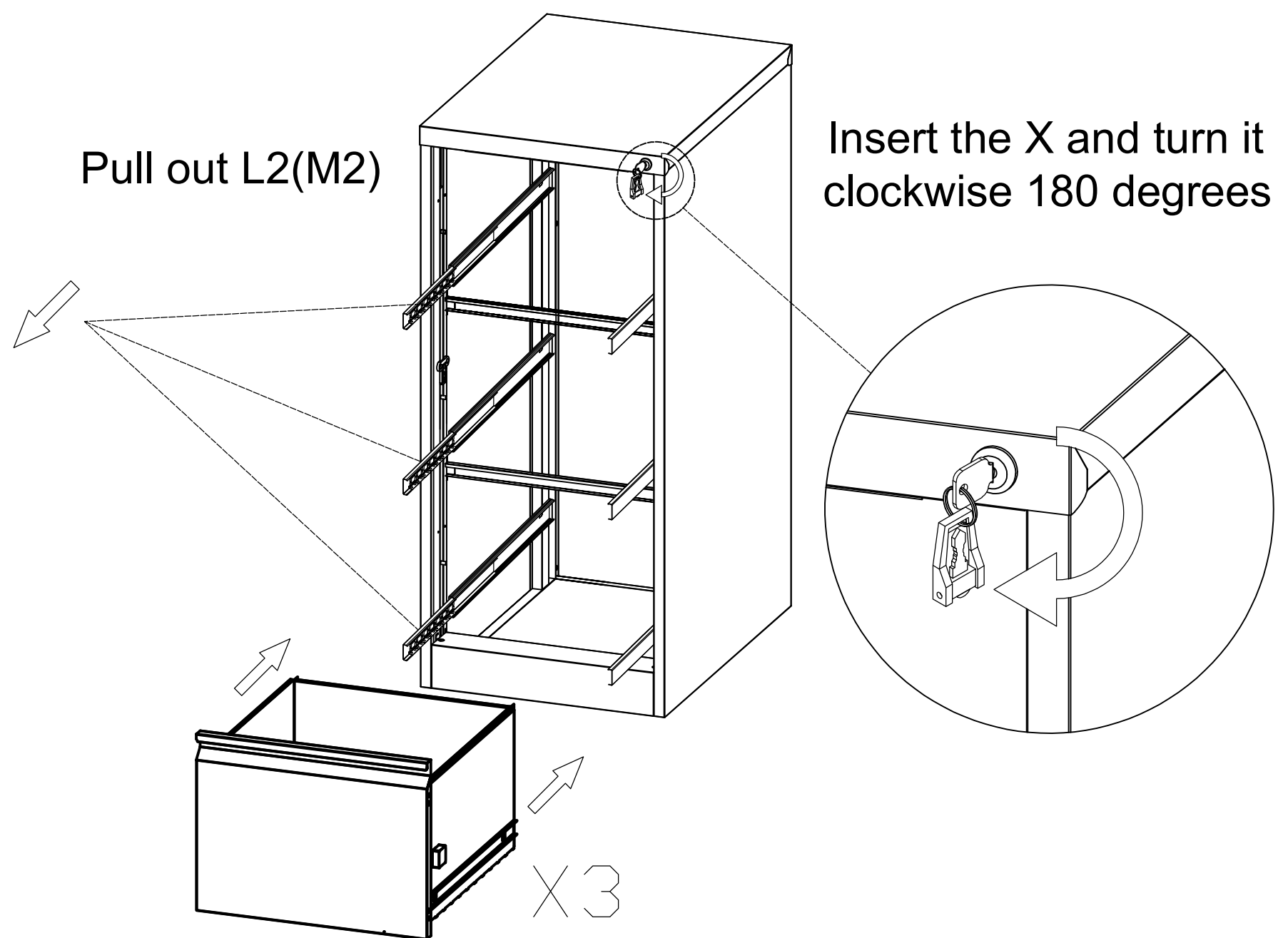

## 21. Install drawer

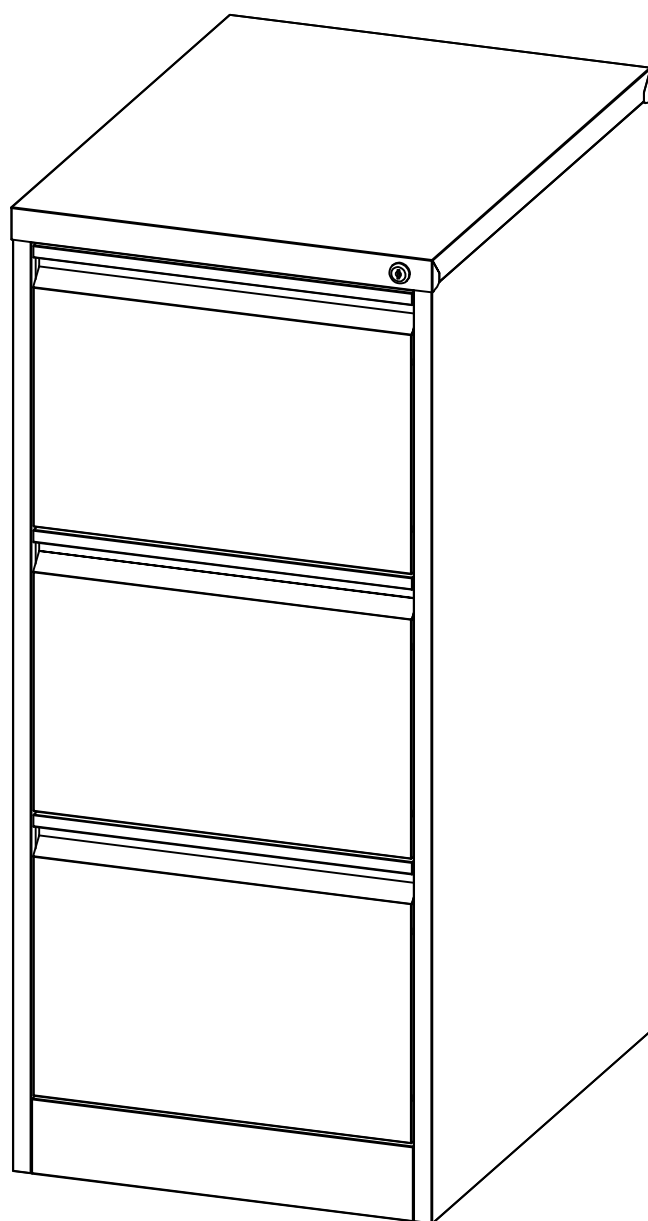

## 22. Assembly completed