



Model No. : 182-6617 Polished Chrome  
182-6618 Brushed Nickel



Casmir Robe Hook

1

## Parts Diagram / List

### Tools

- Level
- Power Drill
- 1/4" Drill Bit
- 1/16" Drill Bit
- Masking Tape
- Pencil
- Hammer
- Phillips Screw Driver
- Safety Glasses
- Stud Finder

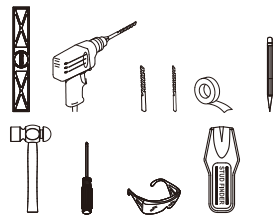

### Maintenance

Your new Bath Accessory is designed for years of trouble-free performance. Keep it looking new by cleaning it periodically with a soft cloth. Avoid abrasive cleaners, steel wool and harsh chemicals as these will dull the finish and void your warranty.

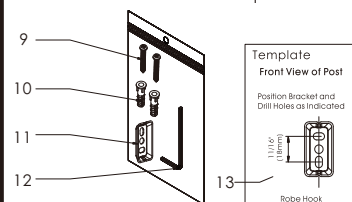
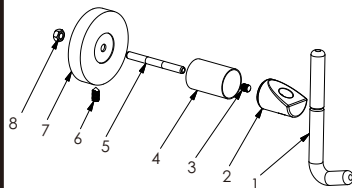

No.	Part Name
1	Robe Hook
2	Decorative Head
3	Set Screw
4	Decorative Bar
5	Mounting Screws
6	Set Screw
7	Base
8	Mounting Nut
9	Mounting Screws
10	Insert Anchors
11	Mounting Bracket
12	Allen wrench
13	Template

2

## Installation Instructions

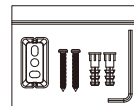

### Step 1

Locate mounting hardware before throwing away any packaging.

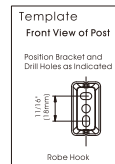

### Step 2

Use the stud finder to locate the stud to determine which mounting method is needed. Place the template on the wall in the desired location and make sure it is level, then tape to the wall.

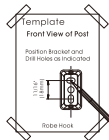

### Step 3

Mark the mounting screw holes through the template with the pencil. (Once holes are marked, you can remove the template)

3

## Installation Instructions

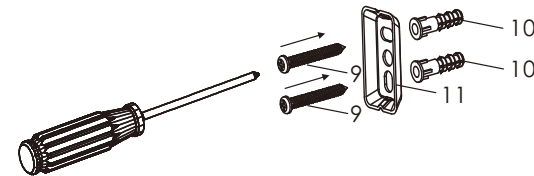
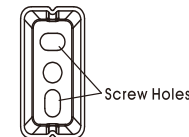

Figure 1

### Drywall Installation

#### Front View



#### Side View

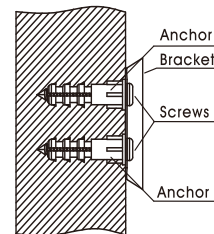

Drywall

### Step 4a - Drywall or Ceramic Tile Installation

In the marked spots drill 1/4" holes in the wall, then insert the insert anchor (10) in the holes, use the hammer to tap them into place. (Be sure not to hit them too hard)

4

## Installation Instructions

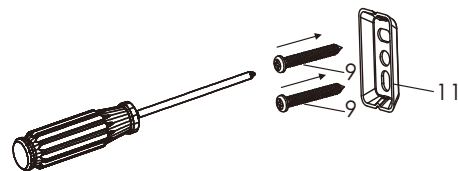
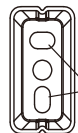

Figure 2

### Wood Wall Stud Installation

Front View



Screw Holes

Side View

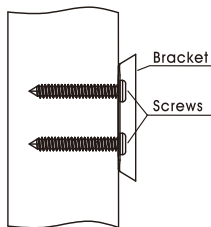

Wood wall

Bracket  
Screws

### Step 4b – Wood Wall Stud Installation

Drill 1/16" holes in the marked spots, be sure to keep the drill level. Insert anchor will not be needed.

5

## Installation Instructions

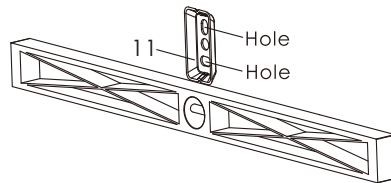

### Step 5

Dry Wall Installation: Attach the mounting bracket (11) using the mounting screws (9) to the insert anchors (10). See Figure 1 For example

Wood Wall Stud Installation: Attach the mounting bracket (11) using the mounting screws directly into the stud. See Figure 2 for an example.

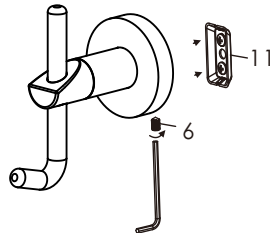

### Step 6

Position the robe hook over the mounting bracket (11) so the set screw socket is facing down to the floor. Tighten the set screw (6) using the supplied allen wrench (12).

6



### LIMITED LIFETIME WARRANTY

Compass Manufacturing International warrants to the original consumer purchaser that the faucet be free from defects in material and workmanship for as long as the original consumer purchaser owns the home in which the faucet was first installed.

In the event that Freendo bathroom accessories are used in a Commercial Application, this warranty is limited for a period of 5 years, unless otherwise specifically stated in the catalog and/or price book.

Compass Manufacturing International will replace, free of charge, during the applicable warranty period, any part or finish that proves defective in material and/or workmanship under normal installation, use and service. This warranty shall not apply to goods which have been subject to accidents, negligence or improper installation. Compass Manufacturing International will not be liable for other damages or losses, including, but not limited to: labor charges and/or damages incurred in installation, repair or replacement as well as any other kind of loss or damage. Proof of purchase from the original consumer purchaser must be made available for all warranty claims.

Compass Manufacturing International recommends using a professional plumber for all installation and repair. Compass Manufacturing International will, at its discretion, provide new or equivalent replacement parts for any product that proves to be defective under normal usage and service. Replacement parts may be obtained by emailing the address below, calling the number below or by writing to:

#### Compass Manufacturing International

Freendo Product Service  
6702 Enterprise Drive  
Louisville, KY 40214  
800.626.3525

[warranty@cmipproduct.com](mailto:warranty@cmipproduct.com)

Revised 7/17/17

[warranty@cmipproduct.com](mailto:warranty@cmipproduct.com)

© Compass Manufacturing International

800.626.3525

7

## Template Front View of Post

### Position Bracket and Drill Holes as Indicated

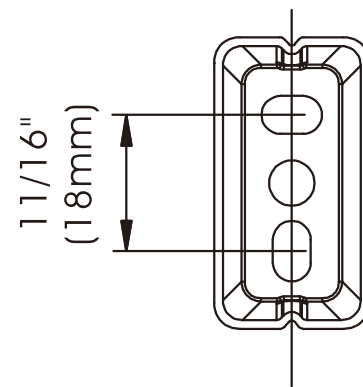

Robe Hook