

CUSTOMIZABLE MODULAR SHELVING AND STORAGE

5 SHELF RACK

6 SHELF RACK

CLOTHING RACK WITH 3 SHELVES

DOOR COMPONENT

HANGER COMPONENT

Contents

Safety Precautions.....	02
Installation Precautions.....	02
Components	04
Common Assembly Steps	05
5 Shelf Rack	08
6 Shelf Rack	10
Clothing Rack With 3 Shelves	12
Door Installation	14
Hanger Installation	16
Configuration Options.....	18

Read this Installation Guide carefully before assembling or disassembling the product. Retain it for future use.

See the Configuration Options at the end of the guide for ideas on combining racks into different configurations.

Safety Precautions

Read these precautions before assembly to ensure your safety and to prevent damage to the product.

Wear gloves during assembly or disassembly.

Do not press against protrusions or edges as doing so may cause injury.

Do not apply excessive force to the product.

Do not climb or hang on the product.

Do not exceed the maximum load capacity of 50 kg/110 lbs per shelf. Ensure that objects on shelves are evenly distributed to maintain balance.

Use a soft, dry cloth to clean regularly. Wipe spills immediately and completely with a dry towel.

Keep the product in a dry and well-ventilated place. Exposure to humidity over a long period may cause shelf boards to bend or twist.

Do not keep the product in a high temperature environment or near heat sources or chemicals.

The warranty does not cover damage caused by misuse or negligence.

Installation Precautions

Required tools

The product cannot be installed without the assembly hammer provided.

Securing the rack to the wall

Secure the rack to the wall per the instructions on page 16. If the rack is not properly secured to the wall, it may fall forward, causing property damage or injury.

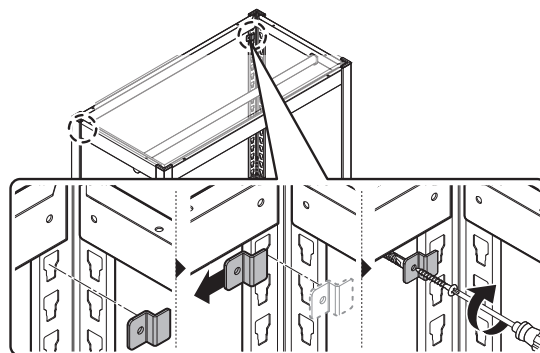

Post assembly

When setting up posts, make sure that the small squares of the post holes face downward.

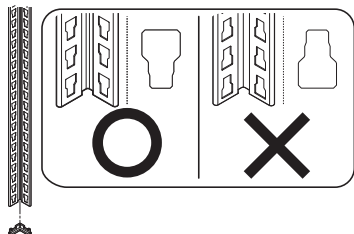

When connecting post connection brackets to the posts, hammer both sides of the top of the post. Hitting only one side may cause the posts to bend or twist.

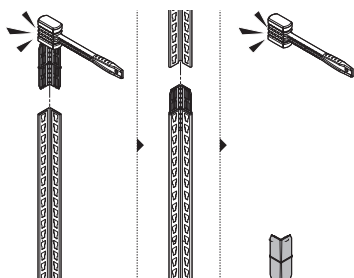

Support beam assembly

Support beams have 2 tabs on each side. Make sure each tab is hooked securely into the smaller squares of the post holes. Failure to do so may cause the beams to shake or tilt.

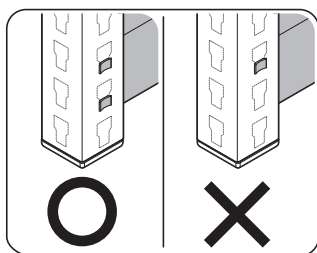

When connecting the opposite end of a support beam, tightly hold its center with one hand to prevent it from bouncing.

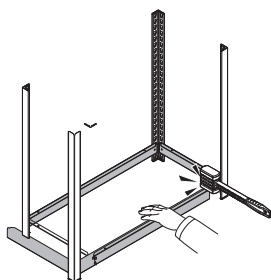

Connection between post and support beam

The top of the circle on the support beam must line up with the post as shown.

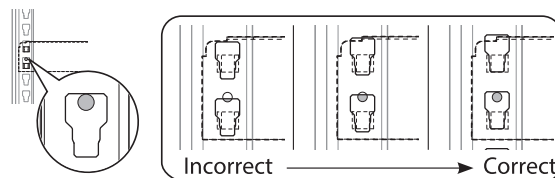

Tip Support beams can be installed in either direction, upward or downward, to create shelves or trays.

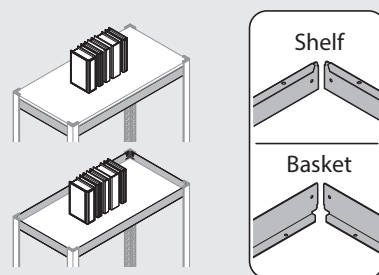

Components

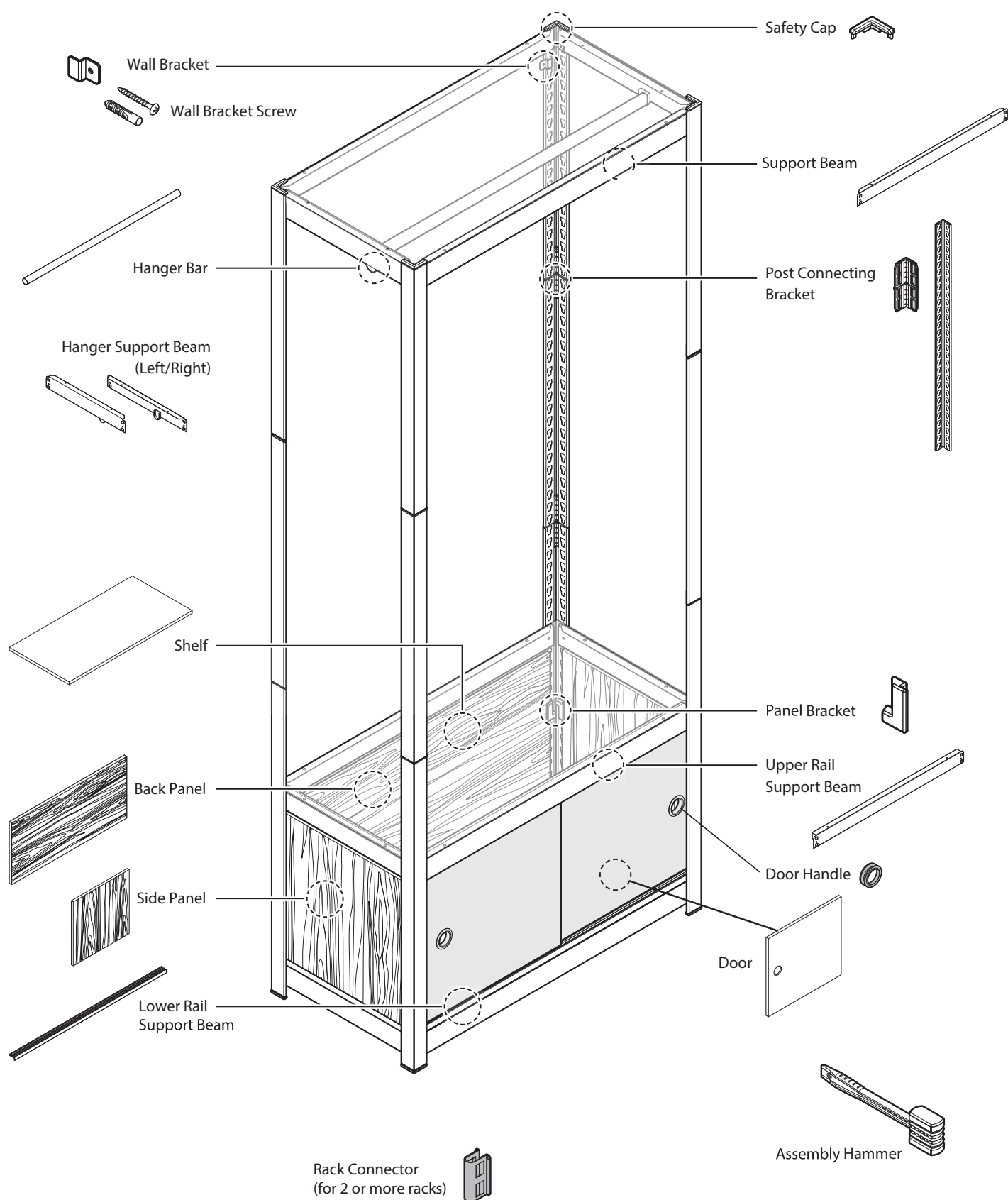

Common Assembly Steps

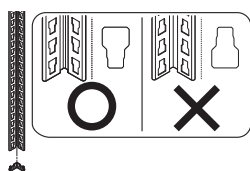
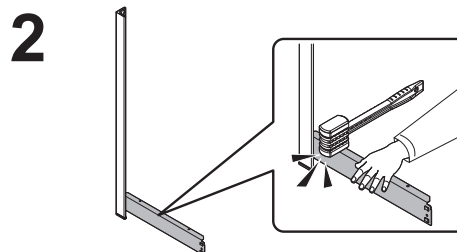
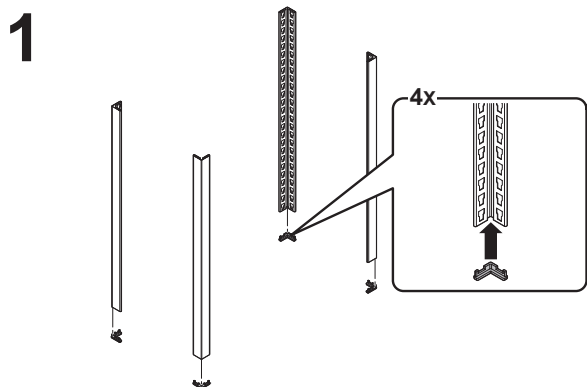

When setting up posts, make sure that the small squares of the post holes face downward.

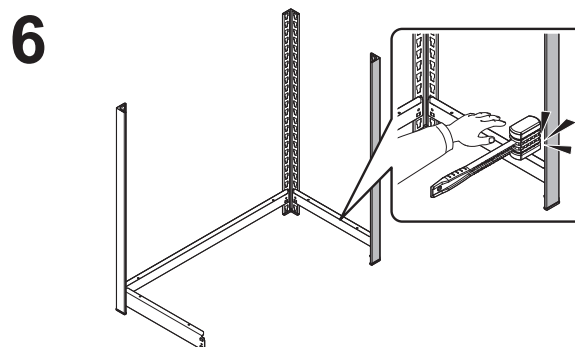
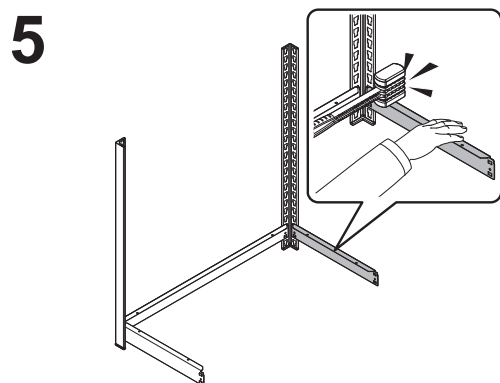
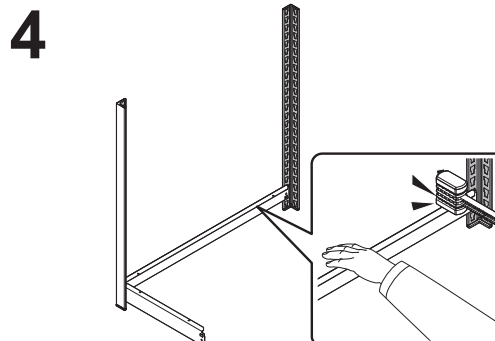
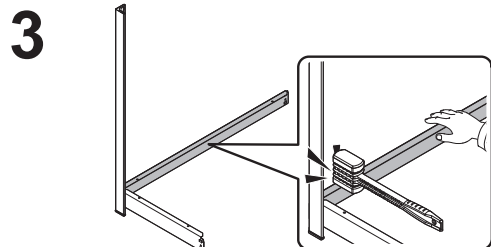

7

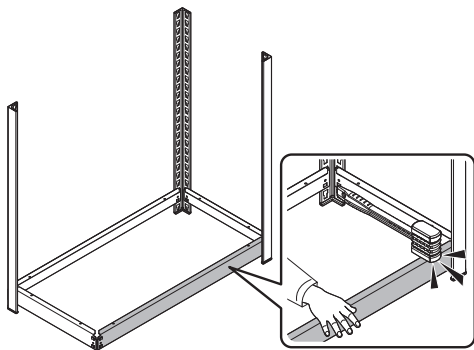

8

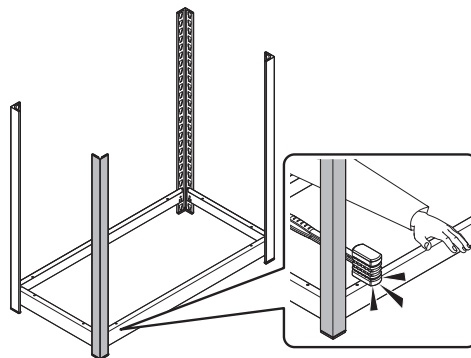

9

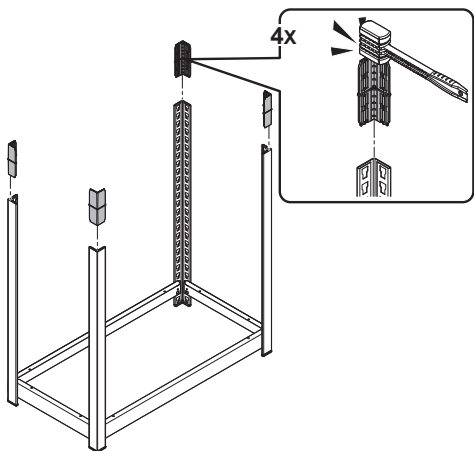

10

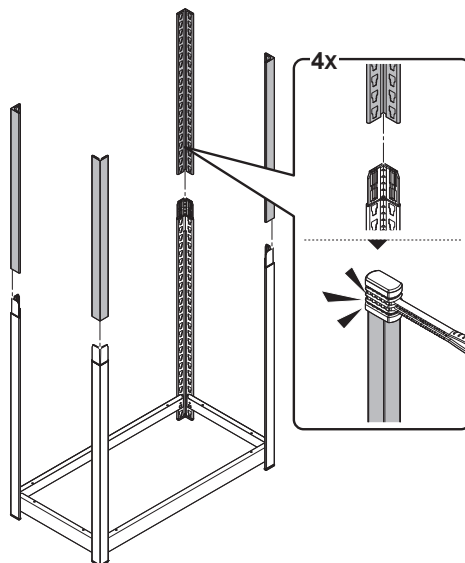

11

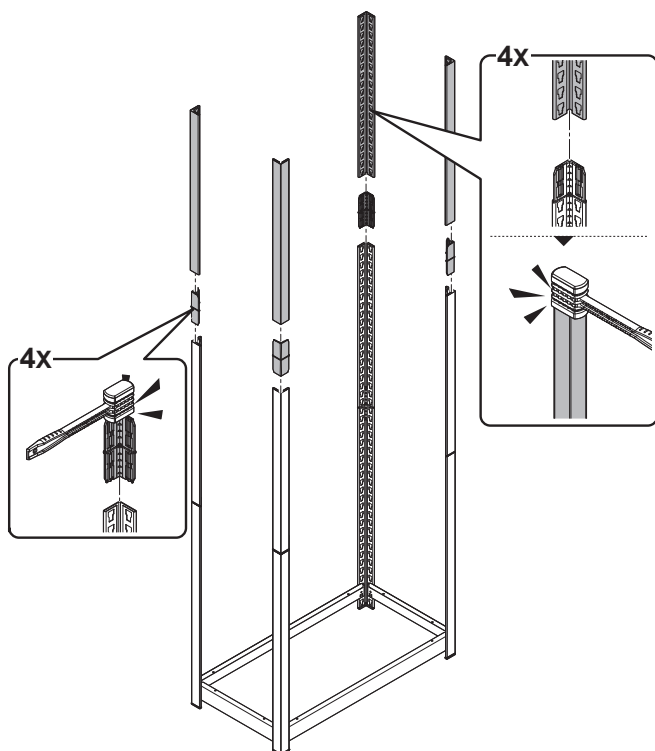

12

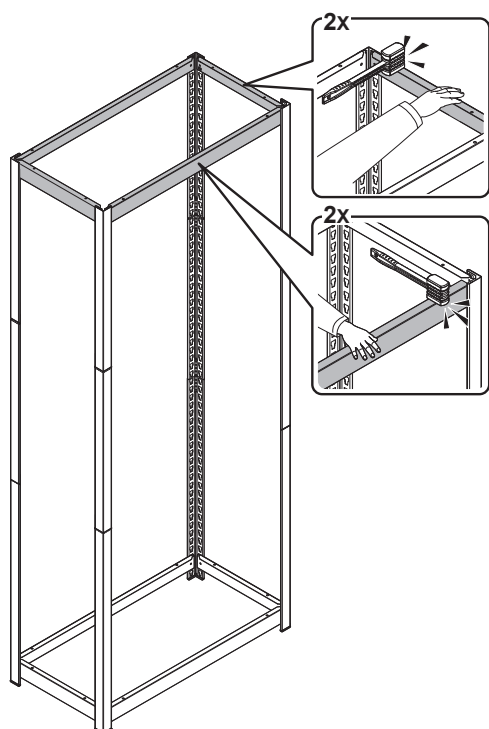

12-1

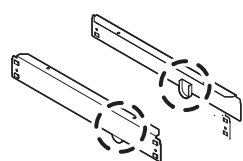
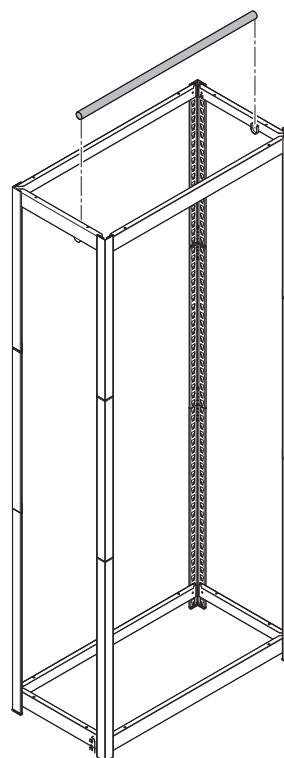

Hanger Support Beam

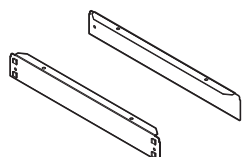

Support Beam

- Hanger Support Beam:
Clothing Rack with 3
Shelves

- Support Beam:
5 Shelf Rack
6 Shelf Rack

For the Clothing Rack with 3 Shelves:

Position the hanger bar into the sockets after the hanger support beams are installed.

Check that the hanger support beams are positioned correctly in relation to the wall.

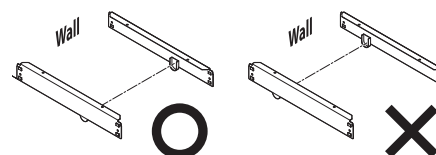

5 SHELF RACK

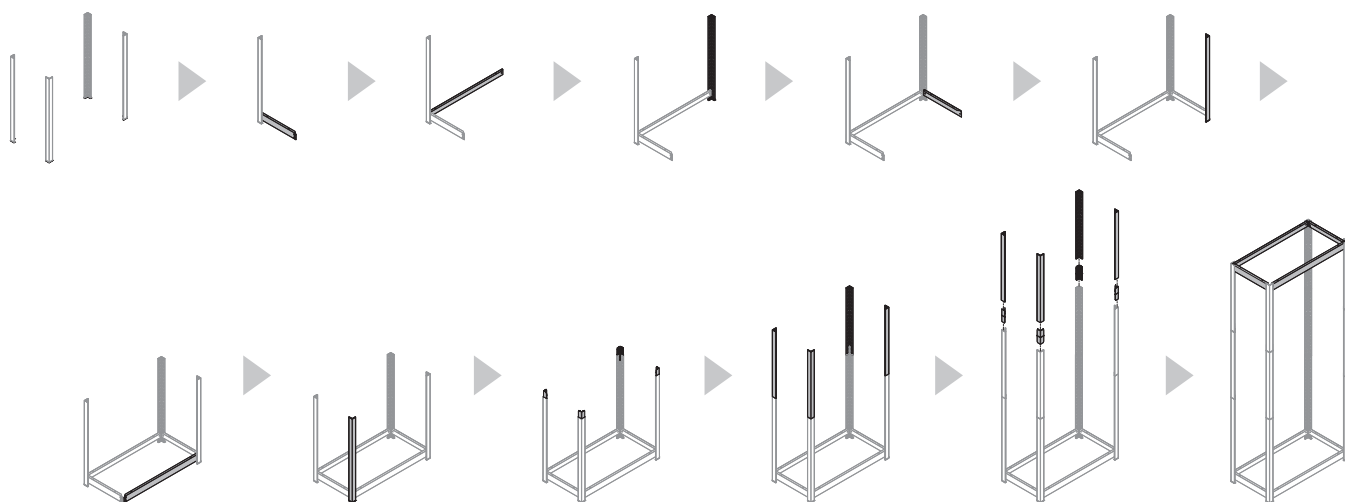
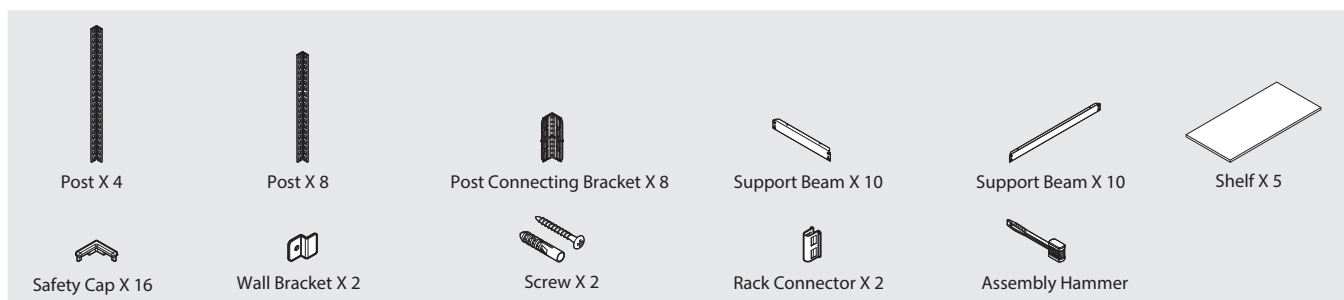
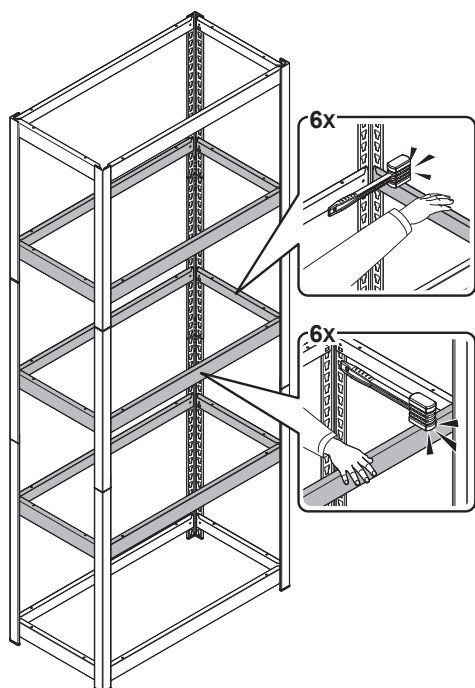
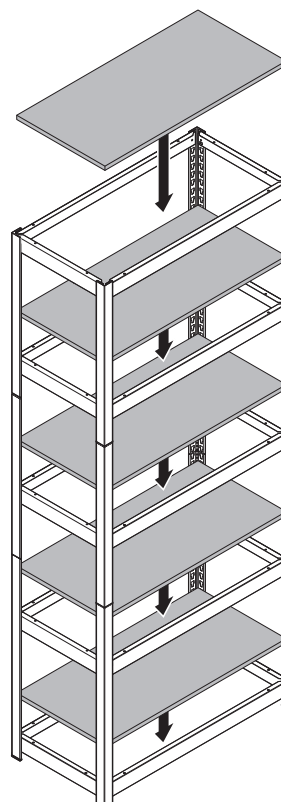
**1****2**

3

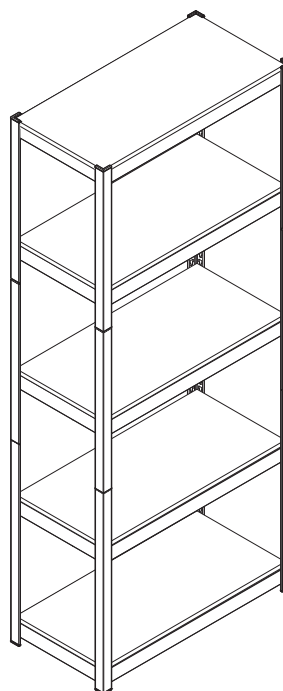
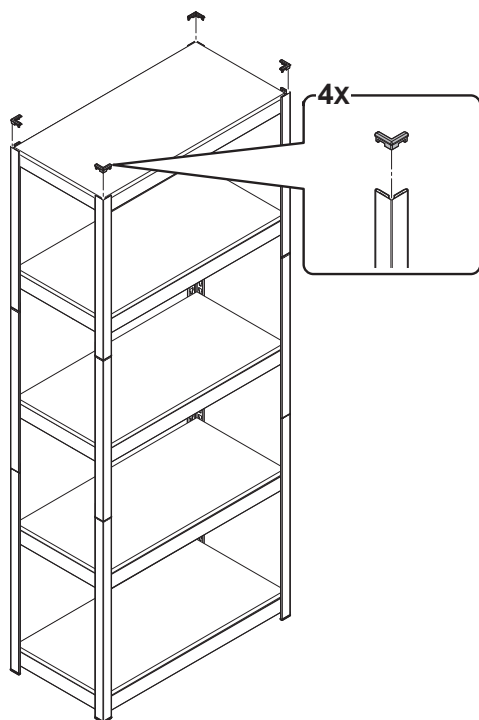

6 SHELF RACK

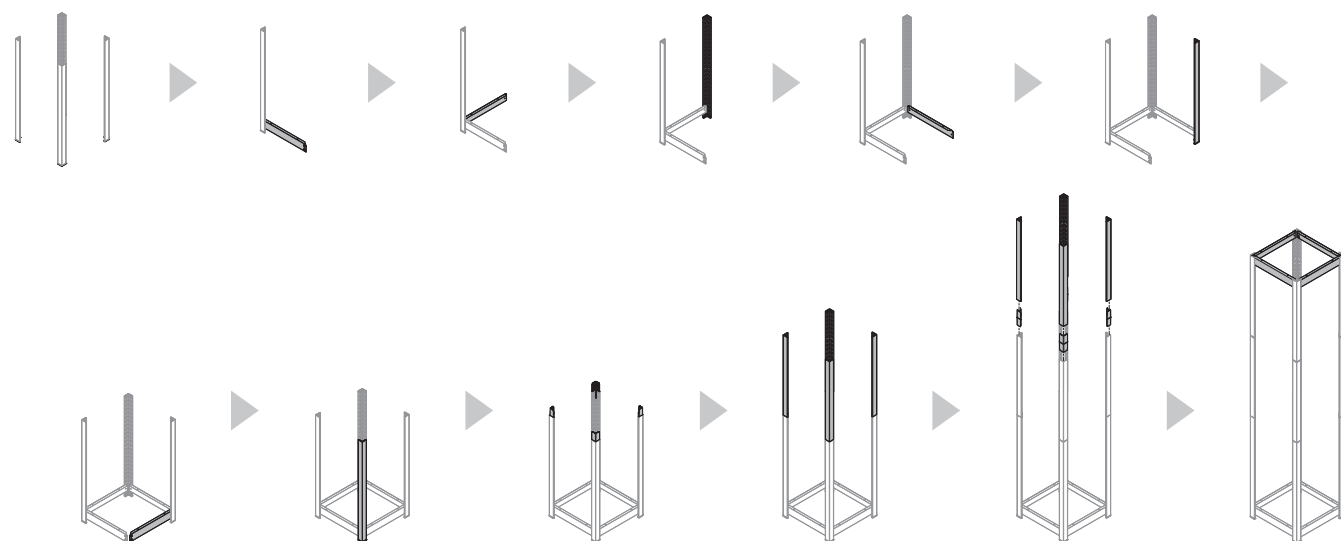
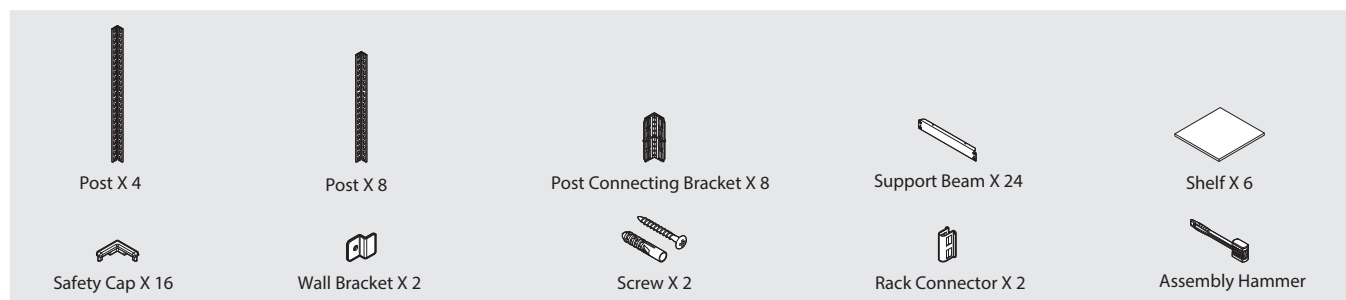

1

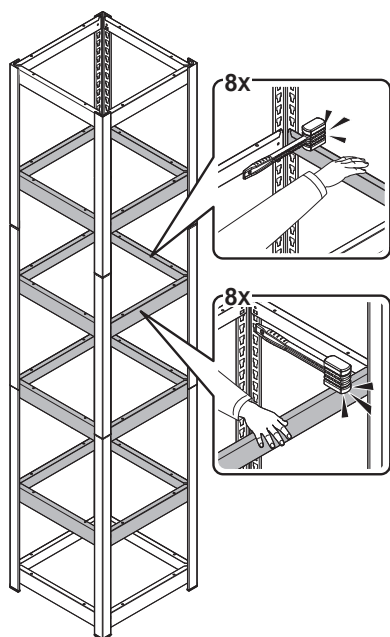

2

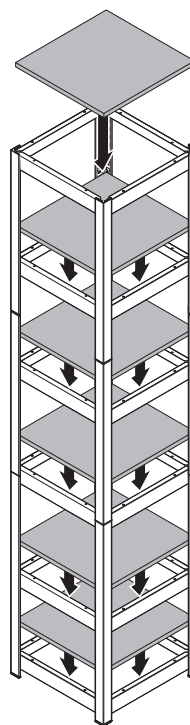

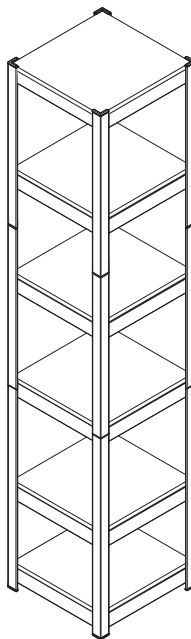
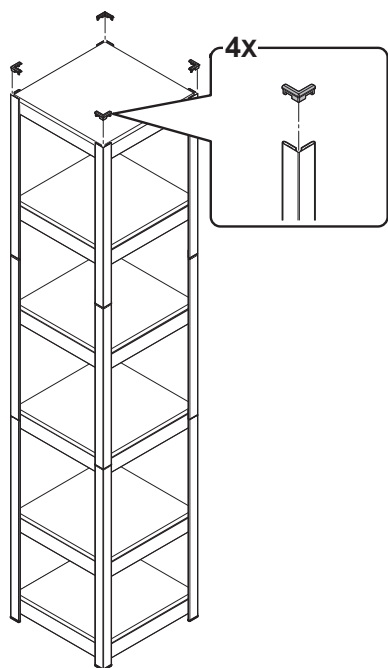
3

CLOTHING RACK WITH 3 SHELVES

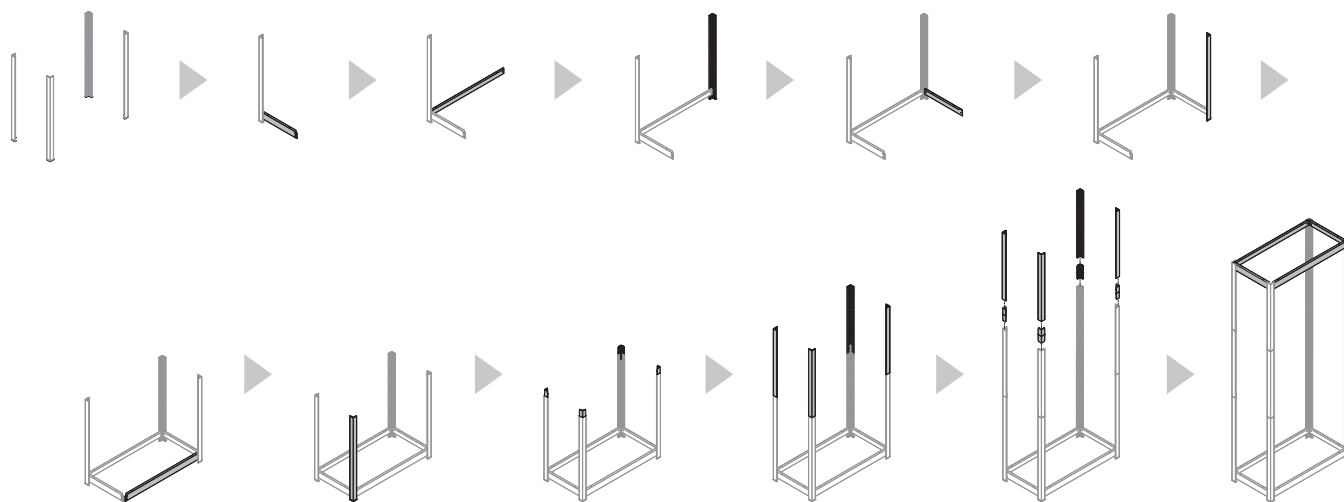
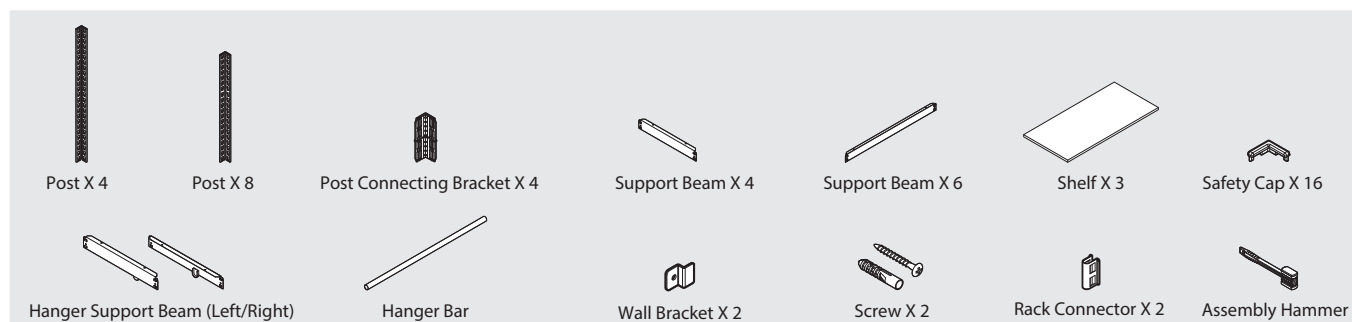

1

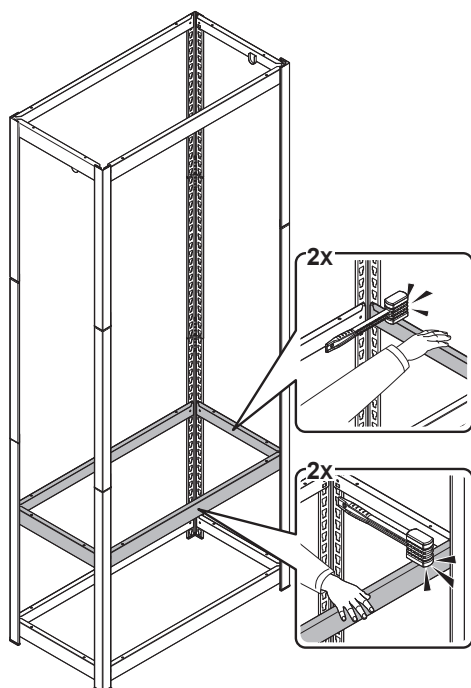

2

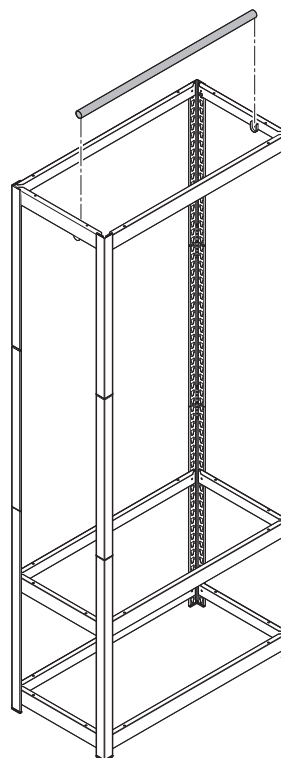

3

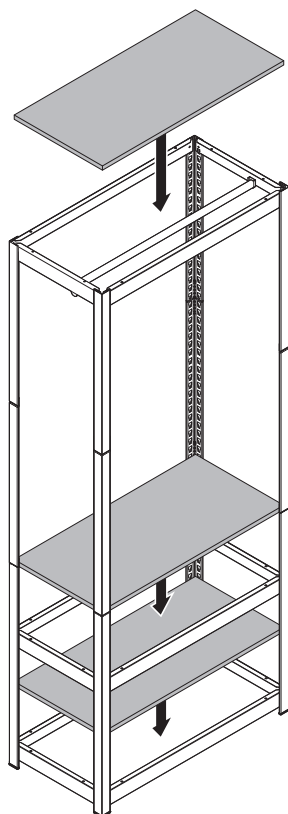

4

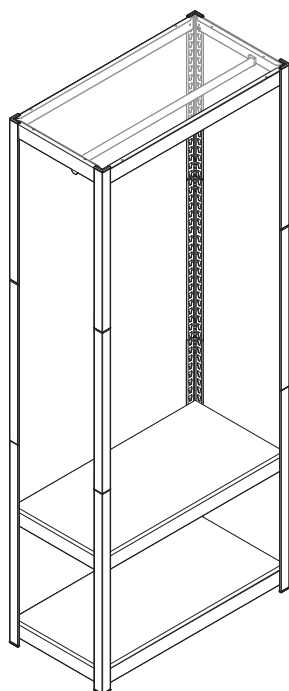
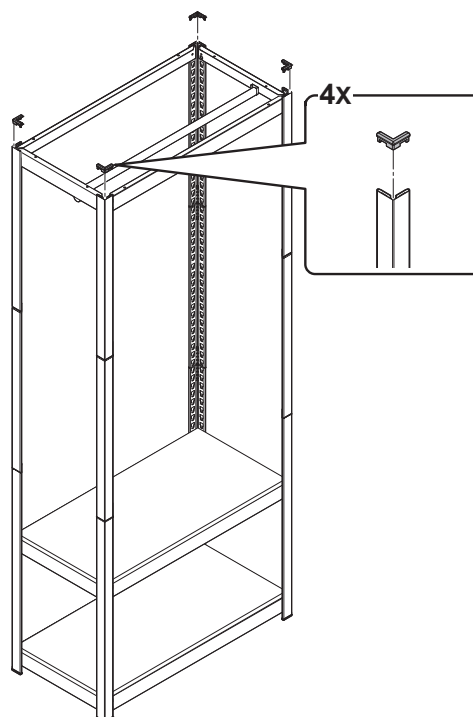

DOOR INSTALLATION

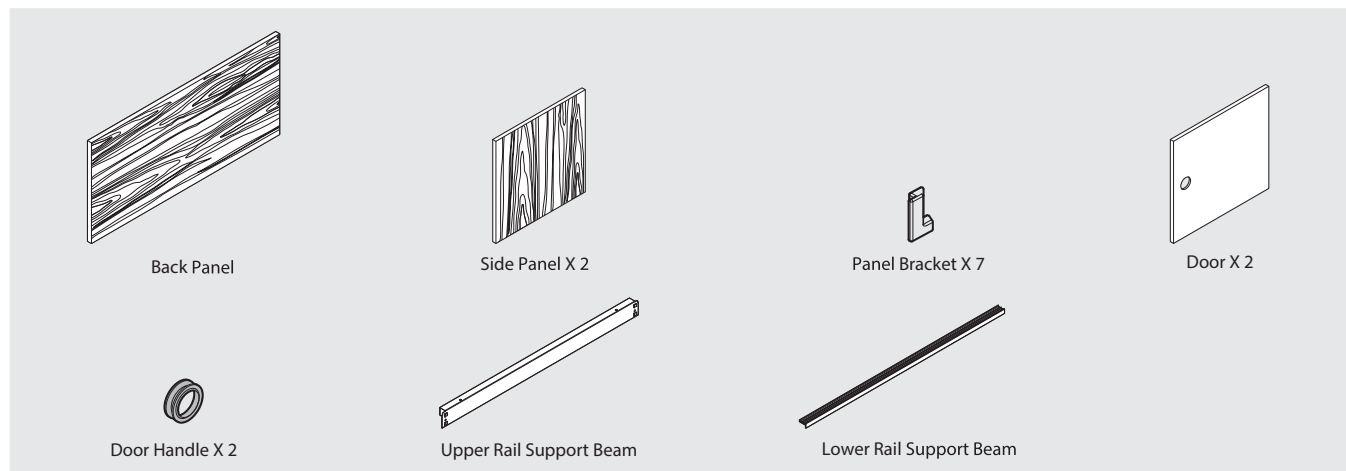

Back panel assembly

- Count up twelve holes from the lower rail support beam. Insert the upper rail support beam into the 13th and 14th holes of the posts.
- Insert the panel bracket into the post.
- Slide cover obliquely (in a slanted position) between the panel bracket and post.
- Insert the panel bracket into the opposite post.

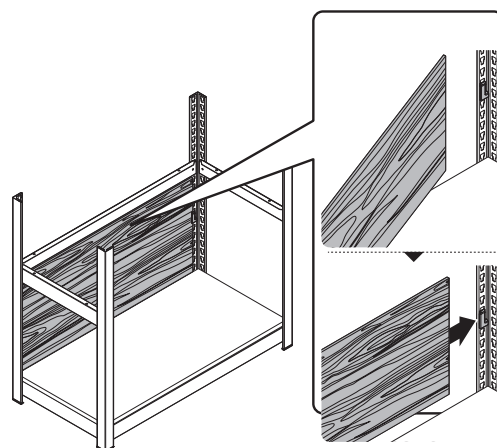
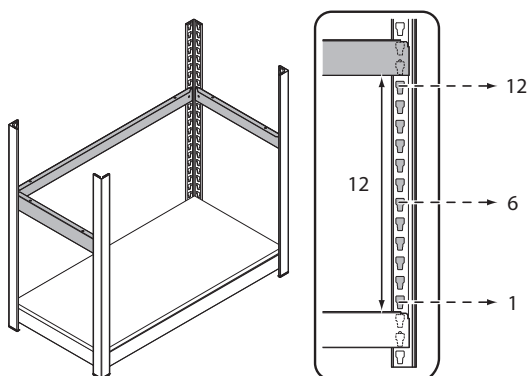

- Insert the panel bracket into the post.

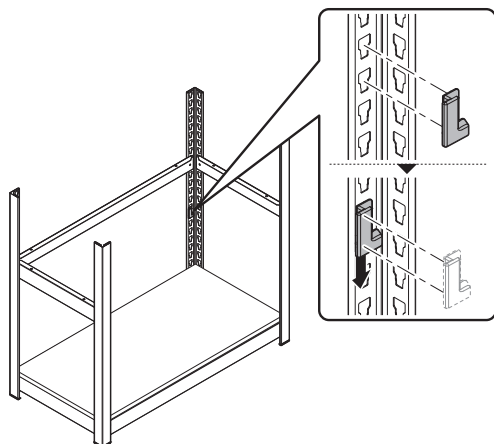

- Insert the panel bracket into the opposite post.

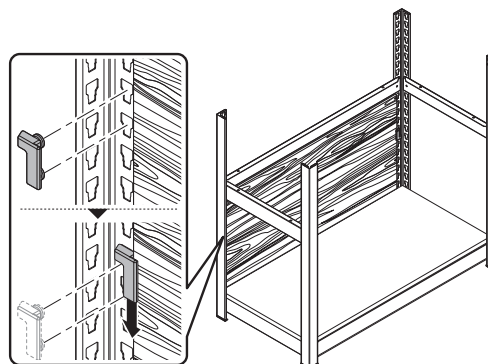

Door assembly

1. Install the lower rail by removing the adhesive strip on the bottom and pressing it into place.

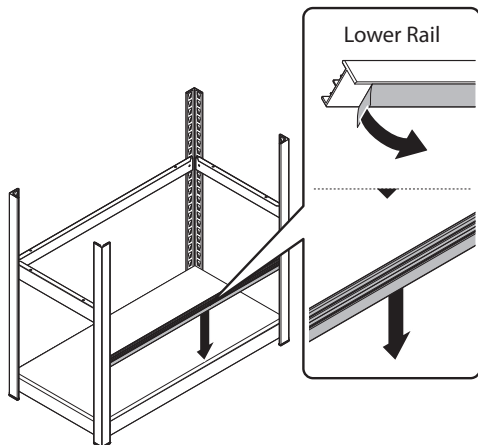

2. Insert the door handles into the panel holes and press firmly.

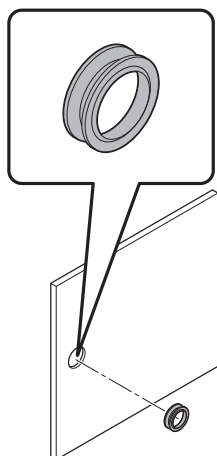

3. Install the upper rail support beam.

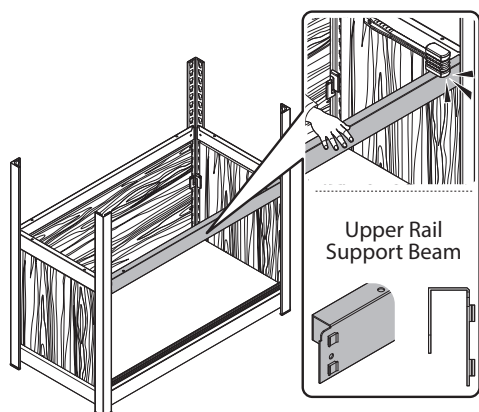

4. Insert the upper part of the door into the upper rail support beam first, and then position the lower part into the lower rail.

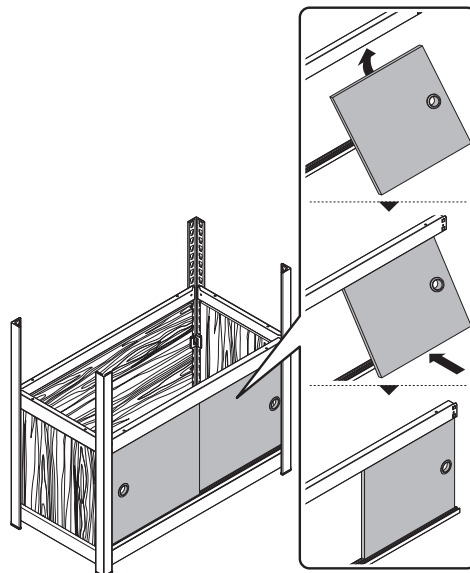

Be sure to correctly position the doors in the lower rail to ensure proper operation.

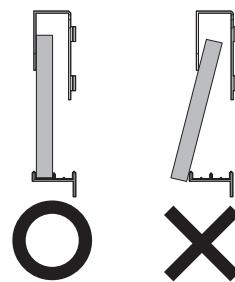

HANGER INSTALLATION

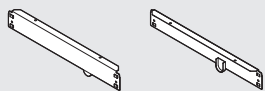

Hanger Support Beam (Left/Right)

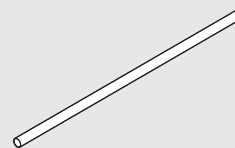

Hanger Bar

■ Hanger support beam assembly

Refer to instructions for the CLOTHING RACK WITH 3 SHELVES on pages 12-13.

Check that the hanger support beams are positioned correctly in relation to the wall.

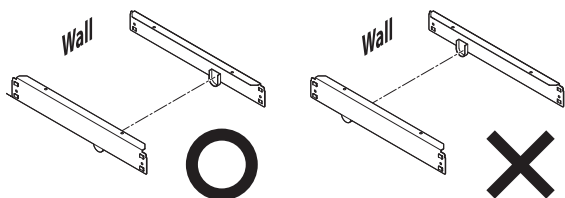

Secure the hanger bar in the sockets *after* the hanger support beams are installed.

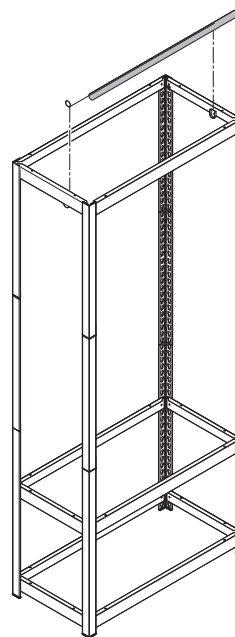

■ Securing the rack to the wall

To prevent the rack from falling forward, secure it to the wall with the wall mounting brackets.

Insert the brackets into the post and secure with screws.

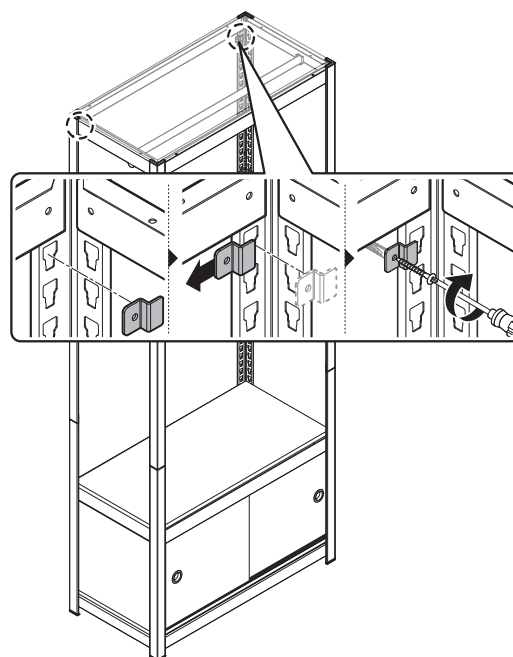

■ Module expansion and separation

When combining two or more racks, clip the rack connector to the front of the top and bottom posts.

Assemble racks and move to their final locations before clipping them together.

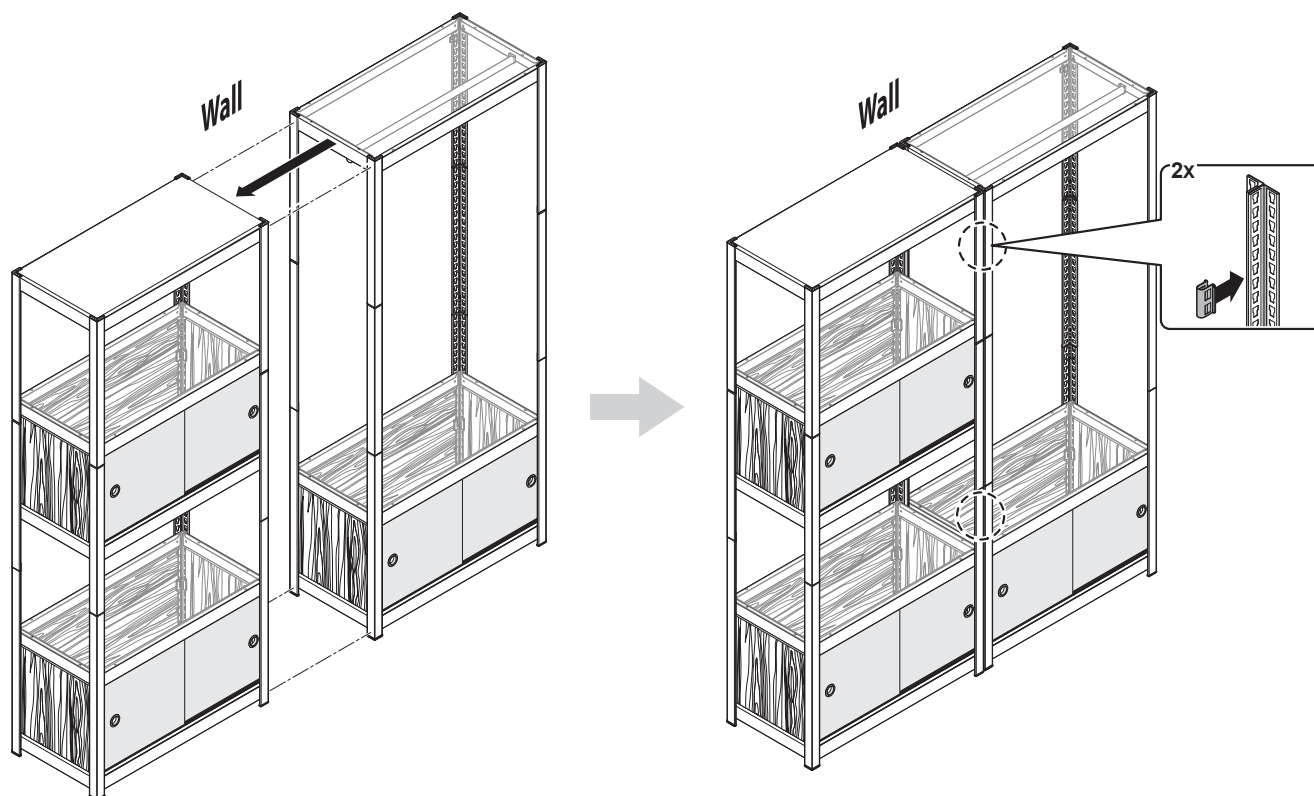

To separate modules, pull one edge of the rack connector by hand, or use the end of the assembly hammer to remove it.

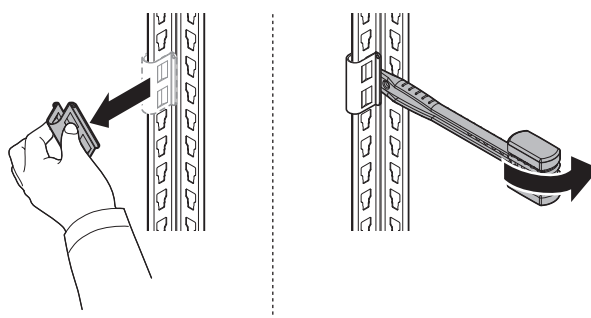

Configuration Options

5 IN 2

5 SHELF RACK + 5 SHELF RACK

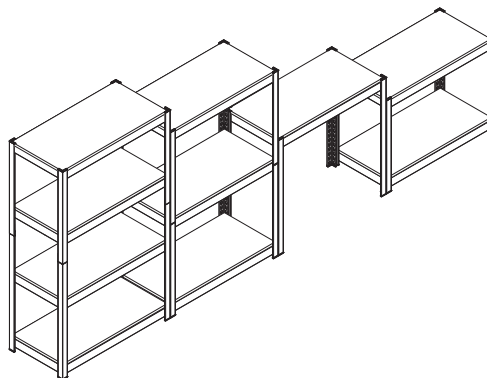
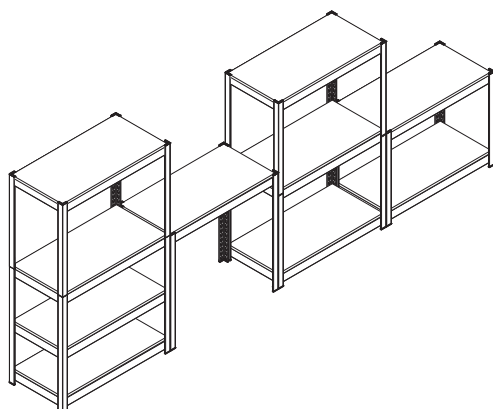
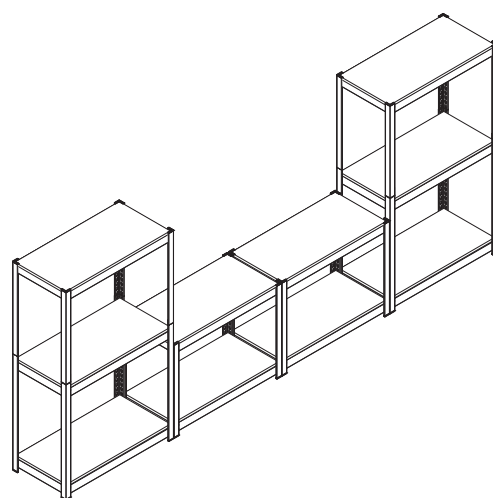
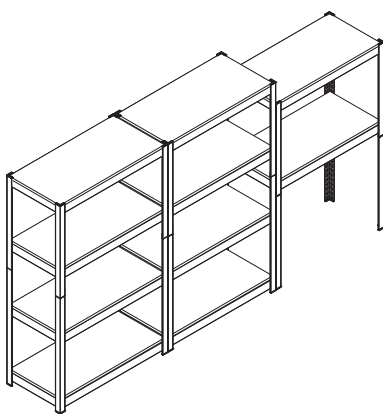
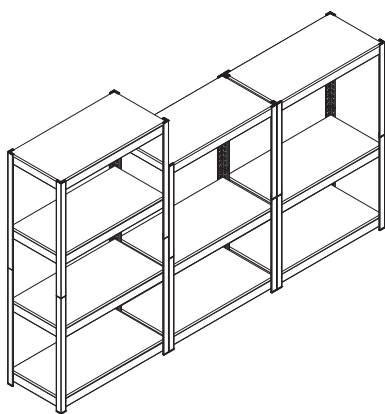
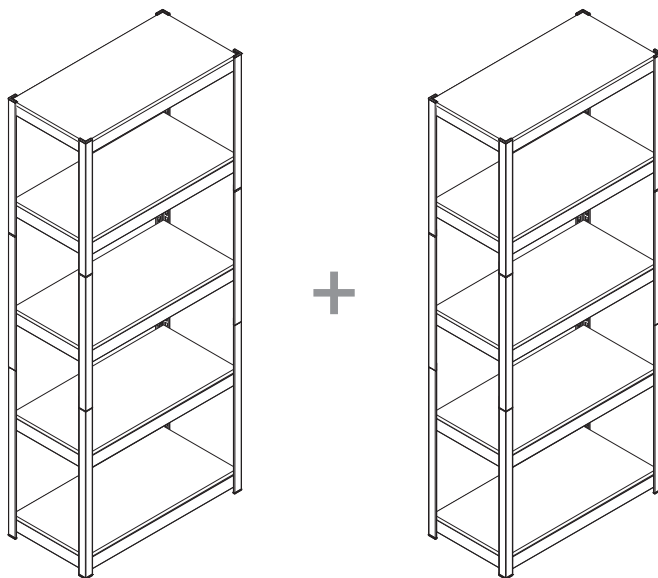

4 IN 2

5 SHELF RACK + CLOTHING RACK WITH 3 SHELVES

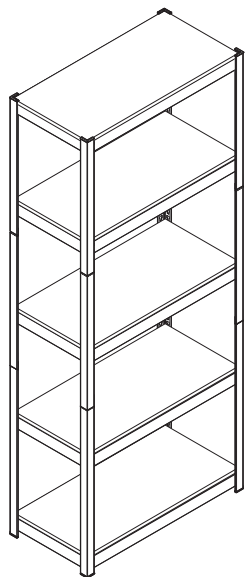

+

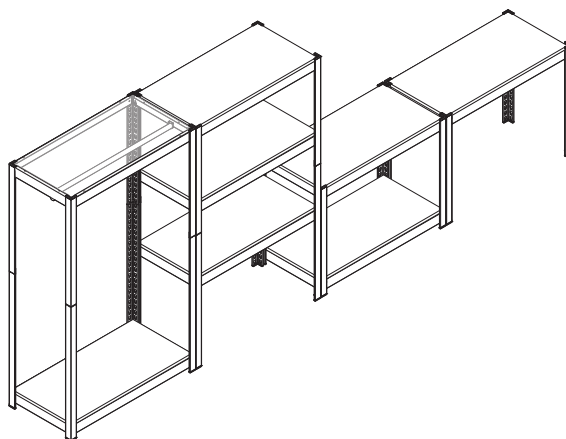
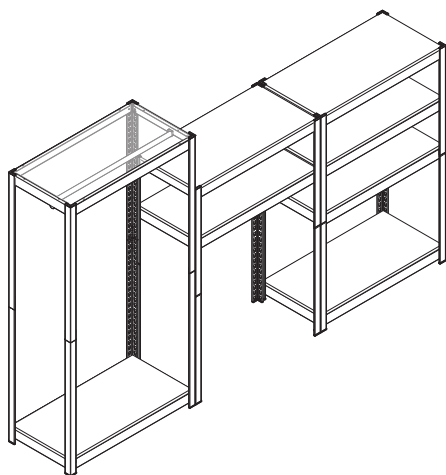
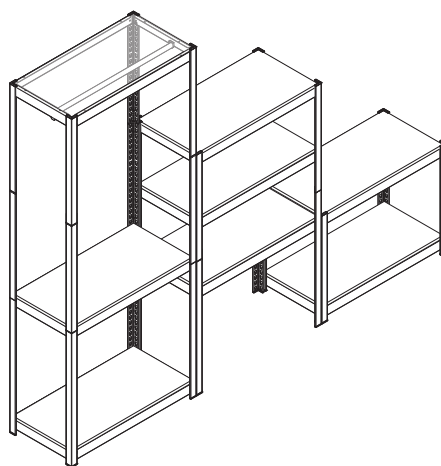
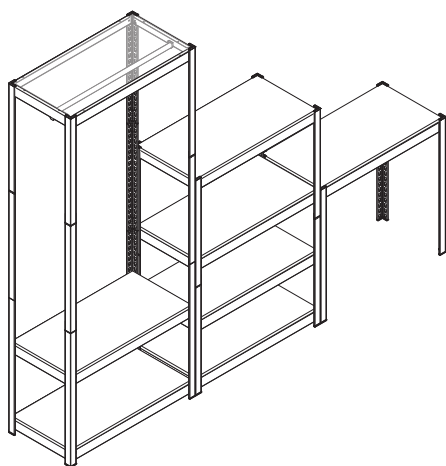
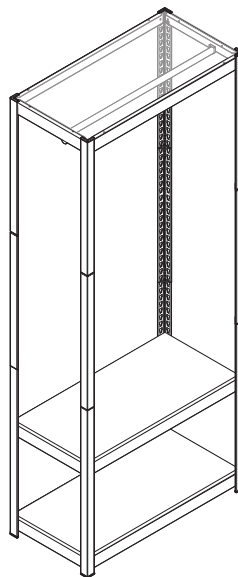

CONFIGURATIONS OPTIONS

4 IN 2

5 SHELF RACK + 6 SHELF RACK

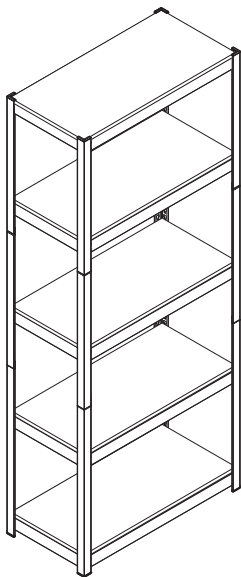

+

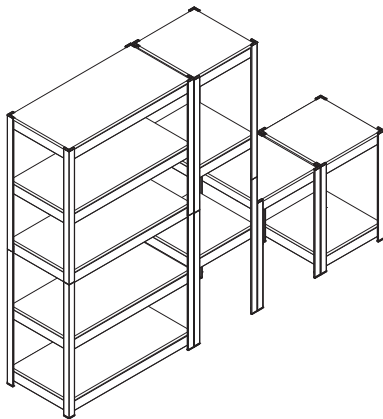
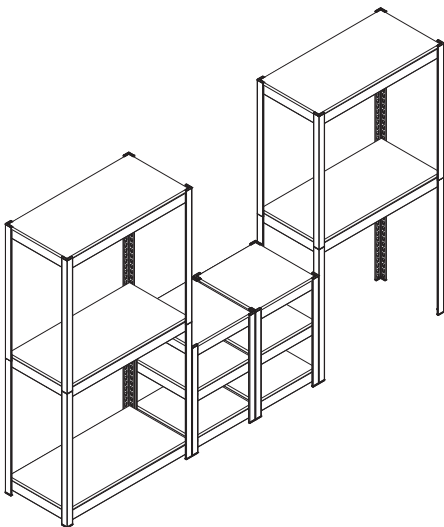
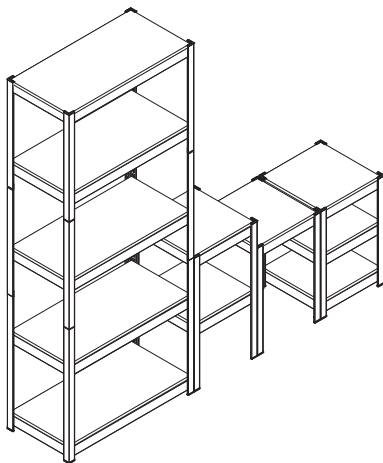
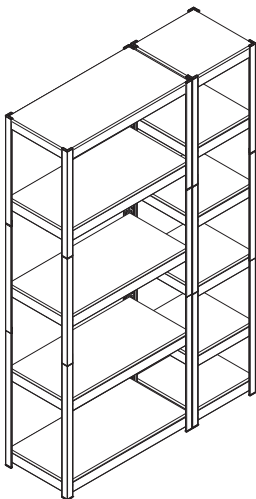
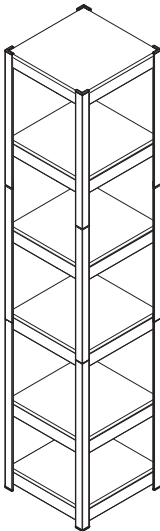

CONFIGURATION OPTIONS

