



Product Submittal	
Name	
Date	
Architect/Owner	
Contractor	
Tag	
Notes	

## Iron Pipe Straight Stop Specification Sheet

### Description

Used to control and shut off water flow to fixtures or appliances for maintenance and repair. 1/2 in. FIP inlet connection makes for quick installation onto iron pipe and quarter-turn full-port brass ball valve makes for easy operation.

### Features And Benefits

- Sleek chrome finish for an attractive appearance.
- Quarter-turn full-port brass ball valve.
- Compatible with MIP threads.
- Can be installed in wet lines.

### Specification Data

Materials	
Valve body	DZR LF brass
Knurled Handle	ABS
Valve ball	DZR LF brass
Seat	PTFE

### Temperature Performance

- Minimum working temperature 33°F
- Maximum working temperature 160°F
- Maximum working pressure is 125 psi

### Flow Rate

- 1/4" Compression 2.2 GPM at 20 psi
- 3/8" Compression 4.0 GPM at 20 psi



## Part Listing

- FIPS3838Z 3/8 in. FIP x 3/8 in. OD Compression
- FIPS1238Z 1/2 in. FIP x 3/8 in. OD Compression
- FIPS1212Z 1/2 in. FIP x 1/2 in. OD Compression
- FIPS1212SZ 1/2 in. FIP x 1/2 in. OD Slip Joint

## Dimensions

Part Number	DIM A (IN)	DIM B (IN)
FIPS3838Z	1.00	1.91
FIPS1238Z	1.00	2.11
FIPS1212Z	1.00	2.22
FIPS1212SZ	1.00	2.13

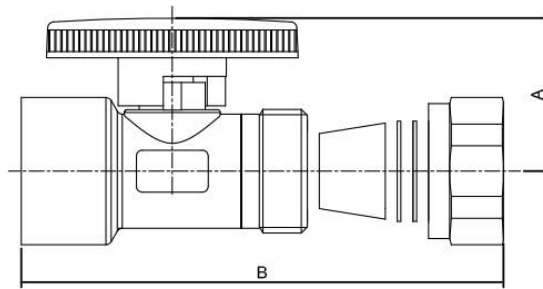
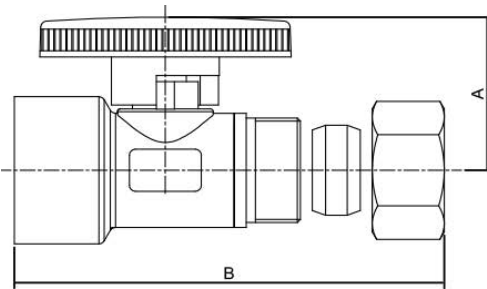

## Codes and Listing

cUPC  
 ASME A112.18.1  
 CSA B125.1  
 NSF/ANSI/CAN 61  
 NSF/ANSI 372

