

# RVH183001LM

UNDERMOUNT WORKSTATION SINK

**RUVATI®**

SPECIFICATION SHEET

## MATERIAL

- True 16 Gauge Thickness
- Premium T304 Grade Stainless Steel  
18/10 Chromium/Nickel Content
- Commercial Brushed Finish

## FEATURES

- Single-Tier Ledge for Accessories
- Slanted bottom with elegant drain grooves for easy draining
- Heavy duty sound guard padding and undercoating



## IN THE BOX

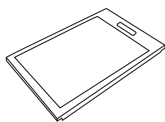

Cutting Board  
[RVA1217]

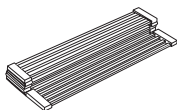

Folding Rack  
[RVA1395]

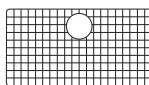

Rinse Grid  
[RVA68300]



Basket Strainer  
[RVA1025]



Drain Cover  
[RVA1035]

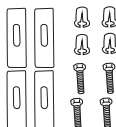

Mounting Clips  
[RVA11031]



Cut-out  
Template

## NOMINAL DIMENSIONS

**Exterior:** 32" (wide) x 19" (front-to-back)

**Interior Bowl:** 30 $\frac{3}{8}$ " (wide) x 16" (front-to-back)

**Bowl Depth:** 10"

**Minimum Cabinet Size:** 36" wide

**Drain Hole Size:** 3 $\frac{1}{2}$ "

**Installation Type:**  
Undermount

**Inside Corners:**  
Sharp

**Drain Location:**  
Rear Center

**RUVATI USA**

www.ruvati.com

Phone: 1.855.478.8284  
Email: support@ruvati.com

OPTIONAL ACCESSORIES (SOLD SEPARATELY)

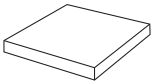

Butcher Block  
[RVA2445ACA]

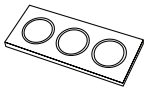

Condiment  
Serving Tray  
[RVA1377]



Caddy  
[RVA1580]

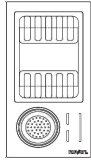

Caddy Drying Rack  
[RVA1542]

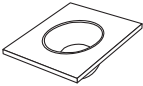

Mixing Bowl  
and Platform  
[RVA1288]



Deep Basket  
Disposal Flange/Stopper  
[RVA1052ST]



Garbage Disposal  
Flange/Stopper  
[RVA1042ST]



Deep Basket Strainer  
and Stopper  
[RVA1027ST]

DIMENSIONS

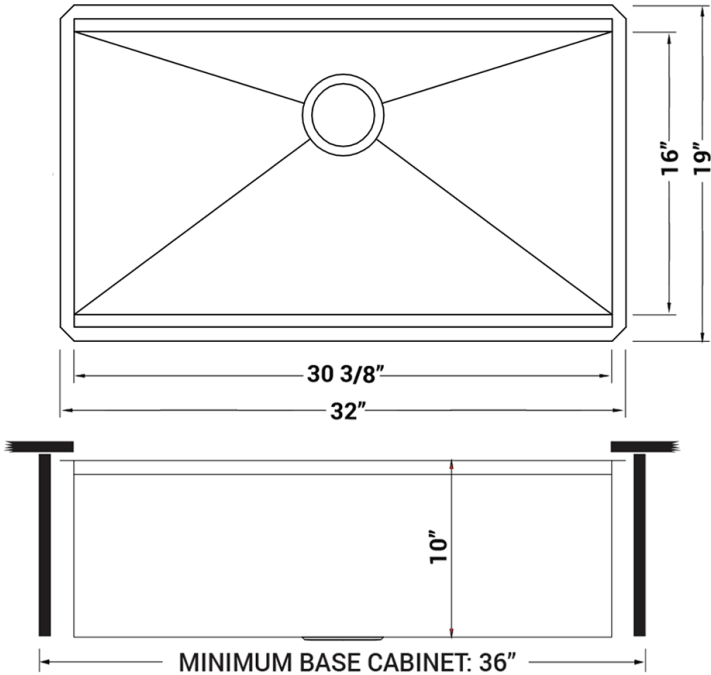

cUPC certified by IAPMO  
to meet US and Canada  
plumbing standards.



SCAN TO REGISTER  
YOUR WARRANTY

or visit  
[ruvati.com/register](http://ruvati.com/register)